

Fitting Instructions:

Thunderbird

A9938099 and A9938100

Thank you for choosing this Triumph genuine accessory kit. This accessory kit is the product of Triumph's use of proven engineering, exhaustive testing, and continuous striving for superior reliability, safety and performance.

Completely read all of these instructions before commencing the installation of the accessory kit in order to become thoroughly familiar with the kit's features and the installation process.

These instructions should be considered a permanent part of your accessory kit, and should remain with it even if your accessory equipped motorcycle is subsequently sold.

A9938099 and A9938100

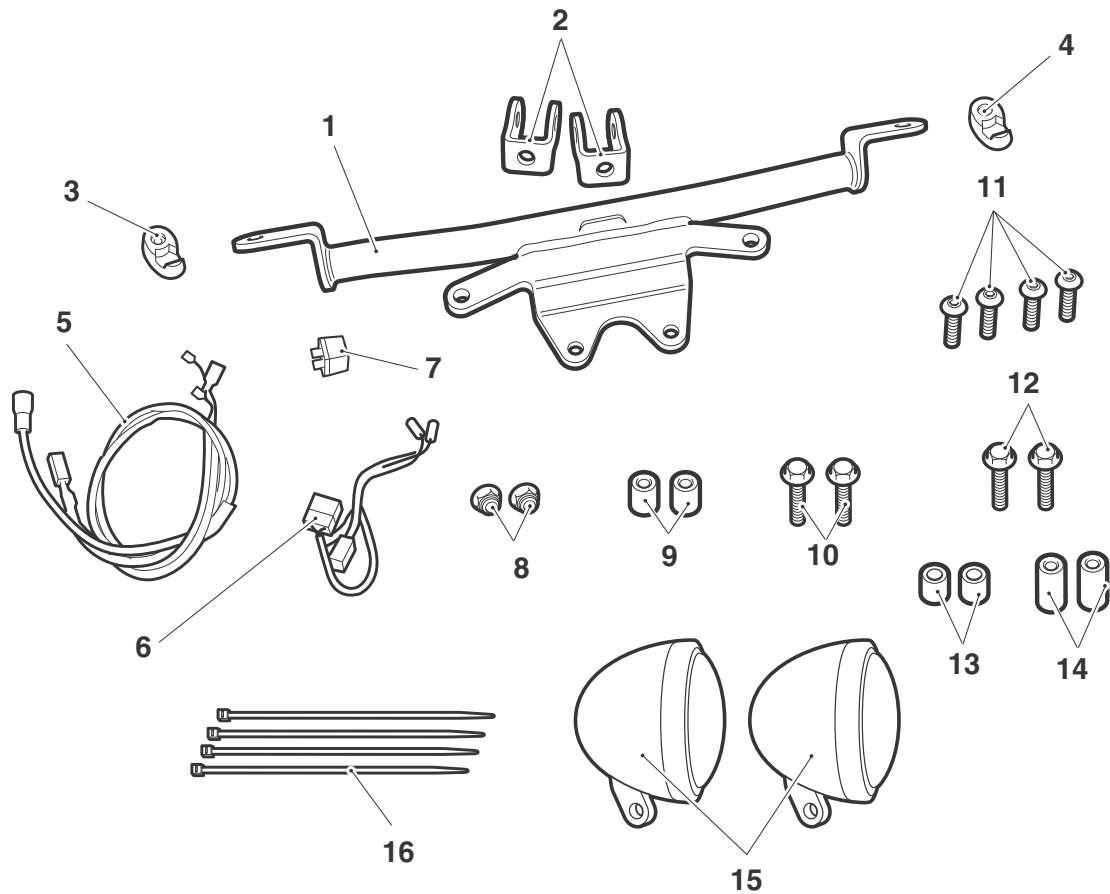

Parts Supplied:

1.	Light bar	1 off	9.	Spacer, M8	2 off
2.	Lamp mounting bracket	2 off	10.	Bolt, M8 x 35 mm	2 off
3.	Indicator mounting spacer, left hand	1 off	11.	Screw, M8 x 25 mm	4 off
4.	Indicator mounting spacer, right hand	1 off	12.	Bolt, M6 x 35 mm	2 off
5.	Lamp wiring harness	2 off	13.	Spacer, 7 x 15 x 18 mm	2 off
6.	Sub-harness	1 off	14.	Spacer, 7 x 15 x 20 mm	2 off
7.	Relay	1 off	15.	Lamp unit	2 off
8.	Nut, M8	2 off	16.	Cable ties	4 off



Warning

This accessory kit is designed for use on Triumph Thunderbird motorcycles only and should not be fitted to any other Triumph model or to any other manufacturer's motorcycle. Fitting this accessory kit to any other Triumph model, or to any other manufacturer's motorcycle, may interfere with the rider and could affect the handling, stability or other aspects of the motorcycle's operation which may result in loss of motorcycle control and an accident.



Warning

Always have Triumph approved parts, accessories and conversions fitted by a trained technician of an authorised Triumph dealer. The fitment of parts, accessories and conversions by a technician who is not of an authorised Triumph dealer may affect the handling, stability or other aspects of the motorcycle's operation which may result in loss of motorcycle control and an accident.



Warning

Throughout this operation, ensure that the motorcycle is stabilised and adequately supported on a paddock stand to prevent risk of injury from the motorcycle falling.



Warning

A torque wrench of known accurate calibration must be used when fitting this accessory kit. Failure to tighten any of the fasteners to the correct torque specification may affect motorcycle performance, handling and stability. This may result in loss of motorcycle control and an accident.

1. Remove the rider's seat, as described in the service manual.
2. Disconnect the battery, negative (black) lead first.
3. Remove the screws securing the headlight to the headlight bowl.

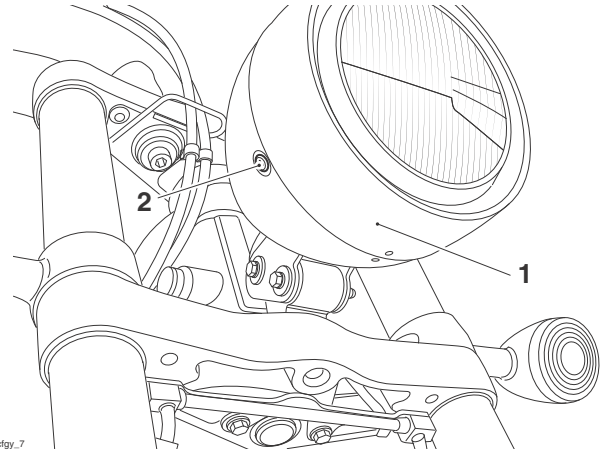

1. Headlight
2. Screw (1 of 2)

4. Detach the headlight from its bowl while supporting it to prevent the cables from being over extended.
5. Disconnect the headlight and position lamp electrical connectors.

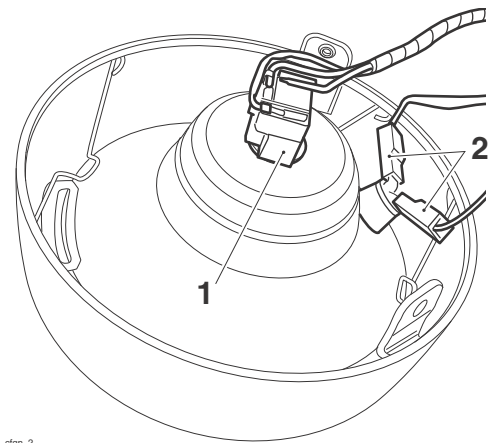

1. Headlight connector
2. Position lamp connectors

6. Locate the indicator harnesses in the headlight bowl and disconnect from the motorcycle wiring harness.

Note:

- **The RH indicator wiring is identified by a section of red tape. Record this to aid assembly.**

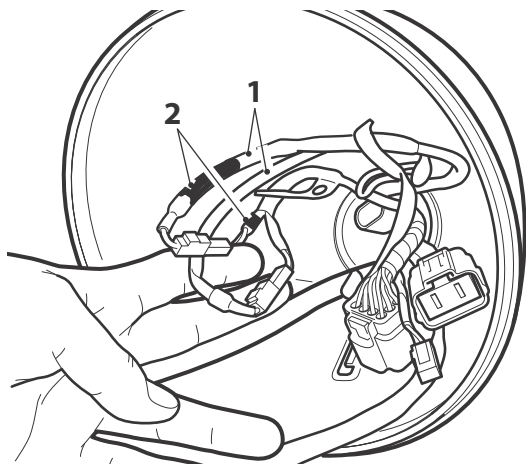

1. Indicator harness
2. Red tape, right hand indicator

7. Release the strap which may be retaining the indicator harness to the headlight bowl.

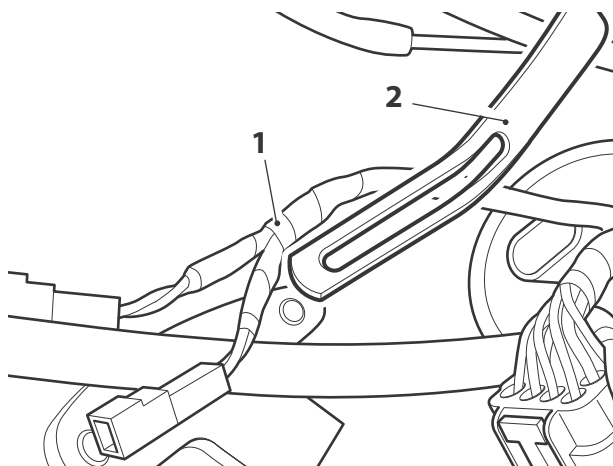

1. Indicator harness
2. Strap

8. Remove the bolts and detach the front brake line assembly from the lower yoke. Retain the bolts if the motorcycle is to be returned to its original condition.

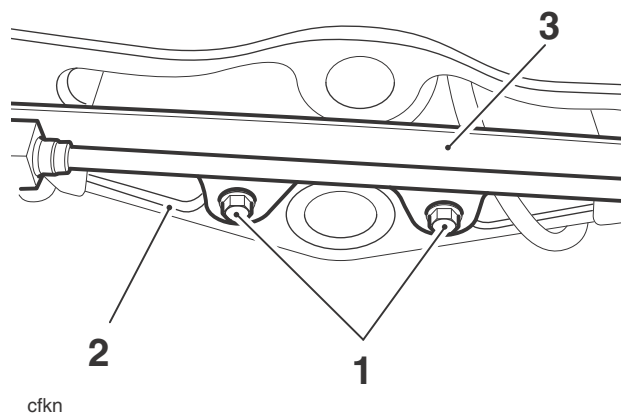

1. Bolts
2. Lower yoke
3. Front brake line

9. Carefully feed both direction indicator harnesses out of the headlight bowl and through the lower yoke.

Motorcycles Fitted with the Windshield Mounting Kit

For motorcycles fitted with the Windshield Mounting Kit - A9758116, the upper mounting plates must be removed.

10. Remove the upper bolt from the headlight mounting. Retain the bolt for re-use.
11. Loosen the lower bolt for the headlight mounting and pivot the headlight down.

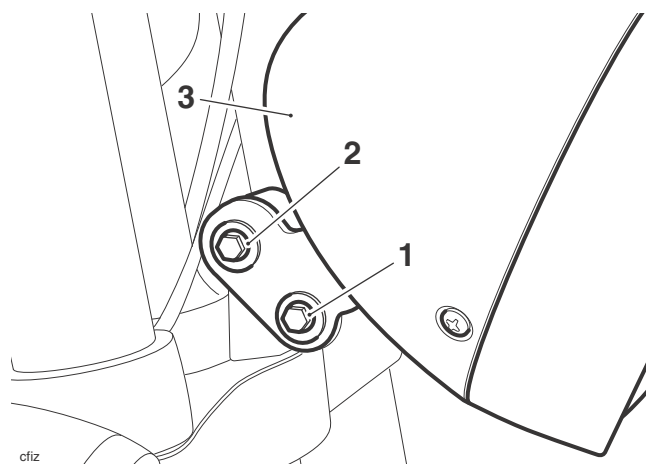

1. Lower bolt
2. Upper bolt
3. Headlight

12. Remove the two carriage bolts securing the upper mounting plate to the lower plate.

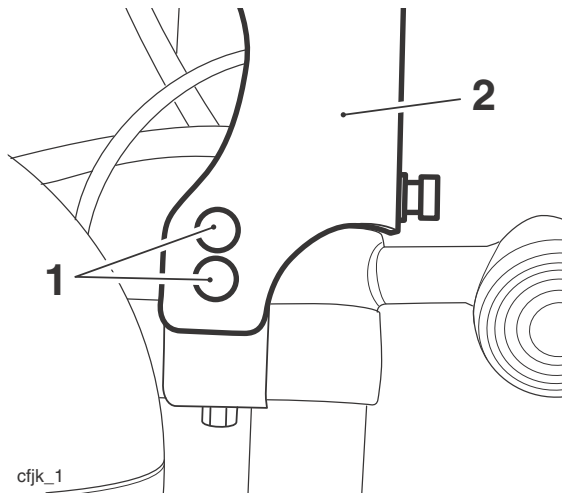

- 1. Carriage bolts**
2. Left hand upper mounting plate

Note:

- **Note the position of the cable guide and its locating tang for installation.**

13. Remove the bolt and remove the upper mounting plate.

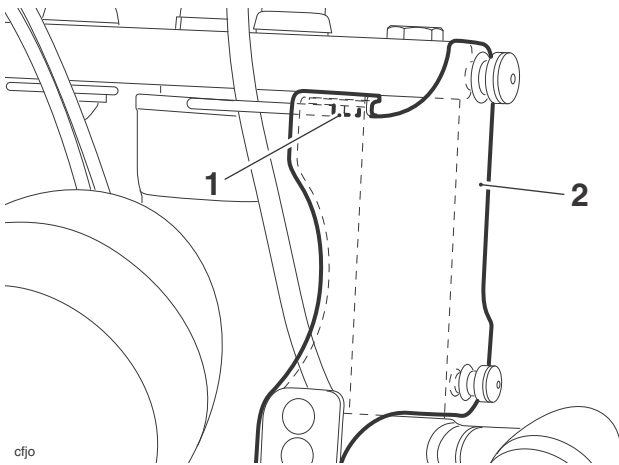

- 1. Bolt**
2. Upper mounting plate

14. Repeat steps 12 and 13 for the right hand mounting plate.

All Models

15. Raise and support the front of the motorcycle.

Warning

Throughout this operation, ensure that the motorcycle is stabilised and adequately supported on a paddock stand to prevent risk of injury from the motorcycle falling.

16. Remove the front wheel, as described in the service manual.

Warning

Never allow the brake calipers to hang on the brake hoses as this may damage the hoses. A damaged brake hose can cause a reduction in braking efficiency leading to loss of motorcycle control and an accident.

17. Remove the front mudguard, as described in the service manual.

Caution

Care must be taken when removing the forks, to ensure that the outer surfaces do not become scratched.

18. Loosen the top yoke clamp, direction indicator clamp and the bottom yoke clamp bolts, on both sides.

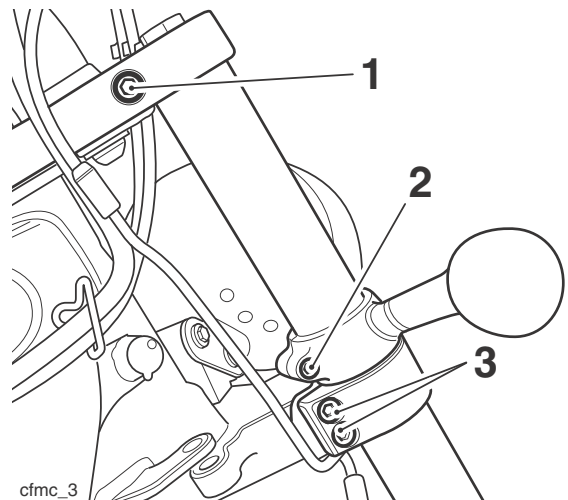

- 1. Top yoke clamp bolt**
2. Direction indicator clamp bolt
3. Bottom yoke clamp bolts

19. Lower the forks from the upper yoke enough to remove the direction indicators.

20. Position the fork through the top yoke so that the flat surface of the top cap is flush with the upper surface of the top yoke.

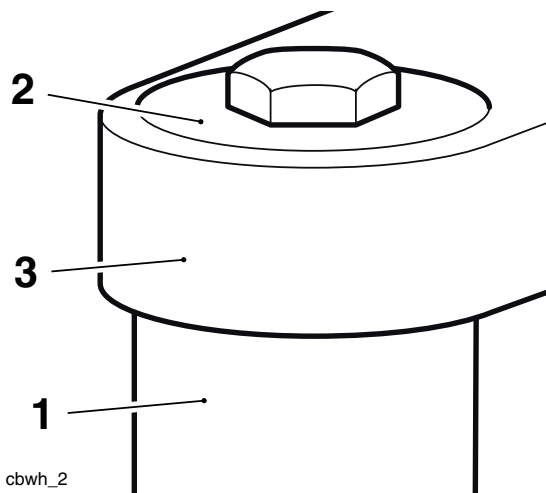

- 1. Outer tube**
2. Outer tube top cap
3. Top yoke

21. Tighten the bottom yoke clamp bolts to **27 Nm**.
 22. Tighten the top yoke clamp bolts to **20 Nm**.
 23. Refit the front mudguard, as described in the service manual.
 24. Refit the front wheel as described in the service manual.

Motorcycles with the Windshield Mounting Kit Fitted

25. Fit the left hand upper mounting plate and cable guide to the upper yoke. Ensure the locating tang for the cable guide is positioned as noted for removal. Do not fully tighten the bolt at this stage.

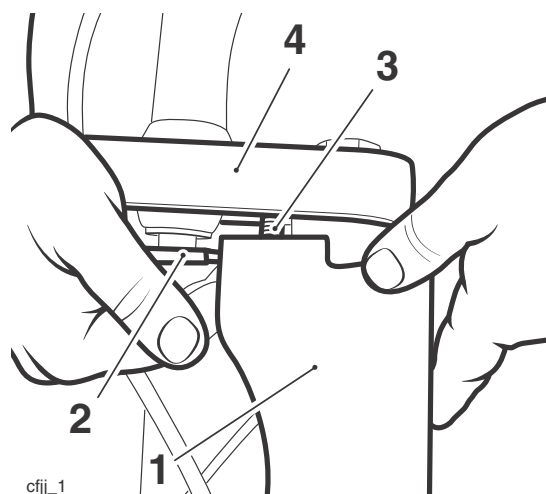

- 1. Left hand upper mounting plate**
2. Left hand cable guide
3. Bolt
4. Top yoke

26. Attach the left hand upper mounting plate with the carriage bolts and nuts. Tighten both carriage bolt nuts to **26 Nm**.

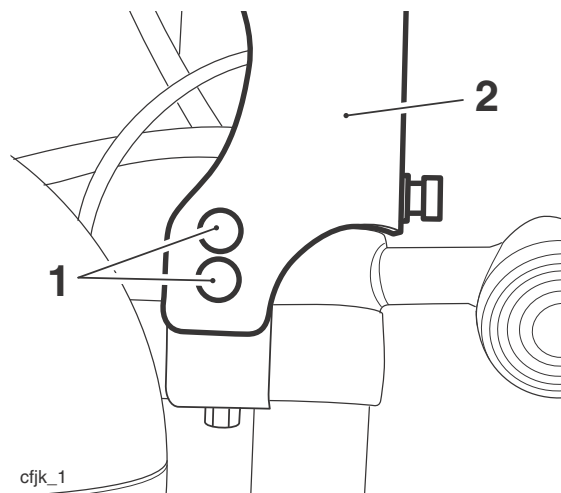

- 1. Carriage bolts**
2. Left hand upper mounting plate

27. Tighten the bolts for the left hand upper mounting plate to **26 Nm**.

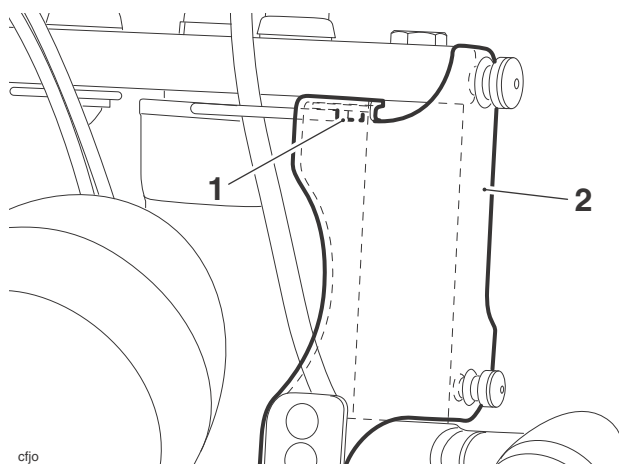

- 1. Bolt**
2. Upper mounting plate

28. Repeat steps 25 to 27 for the right hand upper plate.

29. Raise the headlight and fit the upper bolt. Do not fully tighten the bolt at this stage.

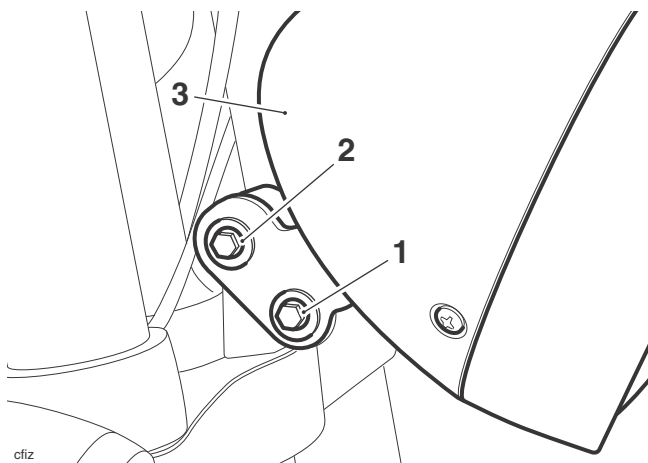

- 1. Lower bolt**
2. Upper bolt
3. Headlight

All Models

30. Remove the screw then remove the clamp and rubber washer from the direction indicator. Retain the clamp, screw and rubber washer if the motorcycle is to be returned to its original condition.

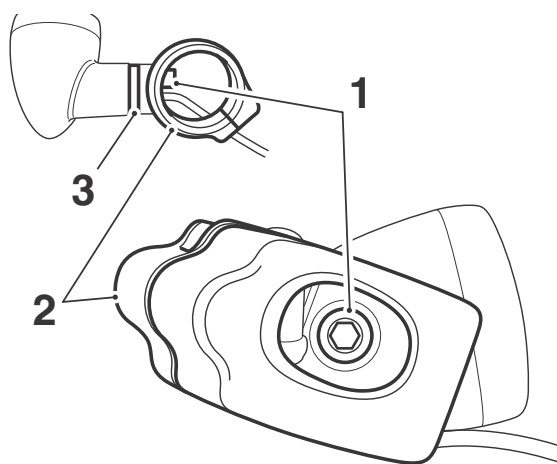

- 1. Screw**
2. Clamp
3. Rubber washer

31. Remove the screw then remove the spacer from the direction indicator. Retain the screw and spacer if the motorcycle is to be returned to its original condition.

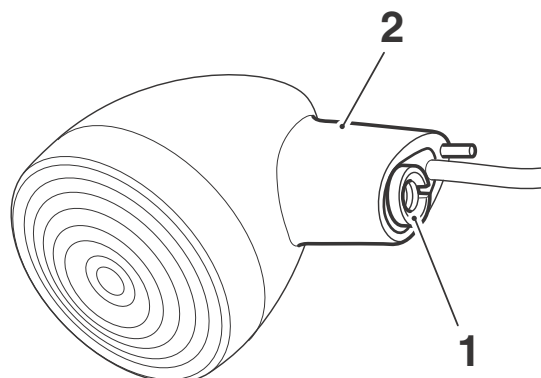

- 1. Screw**
2. Spacer

32. Feed one of the new lamp wiring harnesses through the slot in the new light bar until it emerges from the left hand side of the light bar.

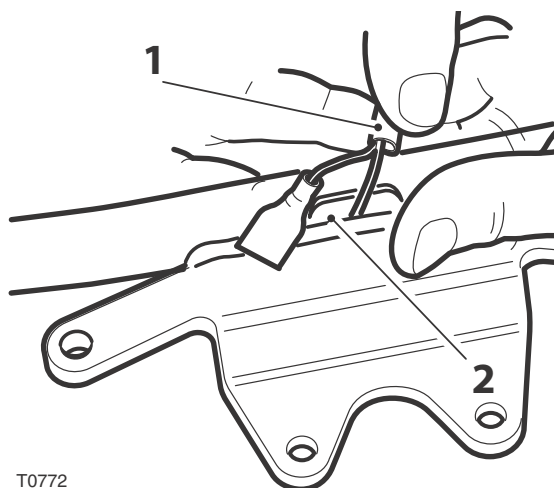

- 1. Lamp harness**
2. Slot, light bar

33. Feed the second lamp harness through the slot, in the opposite direction, until it emerges from the right hand side of the light bar.

34. Carefully feed the right hand indicator harness, identified with the section of red tape, through the right hand side of the light bar.

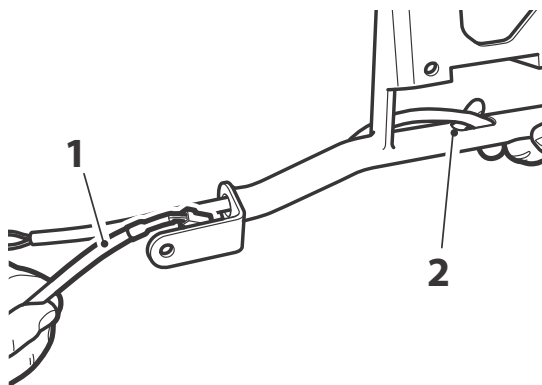

T0240

- 1. Direction indicator harness**
2. Slot, light bar

35. Retrieve the harness through the centre slot in the light bar.
36. Carefully feed the left hand indicator harness through the left hand side of the light bar.
37. Retrieve the harness through the centre slot in the light bar.



Warning

Ensure the wiring harness does not become trapped when fitting the indicator assemblies to the mounting bar. A trapped harness could result in damage to the wiring which could lead to a motorcycle electrical failure resulting in loss of motorcycle control and an accident.

38. Position the left hand indicator mounting spacer onto the left hand indicator as shown.

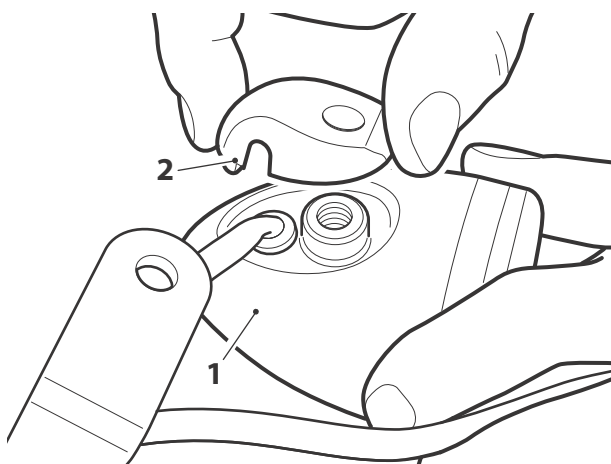

- 1. Indicator, left hand**
2. Mounting spacer, left hand

39. Adjust the harness length to allow the indicator to be positioned correctly on the mounting bar.
40. Fit the lamp mounting bracket, as shown. Secure the bracket and left hand indicator to the mounting bar with a M8 x 25 mm screw.

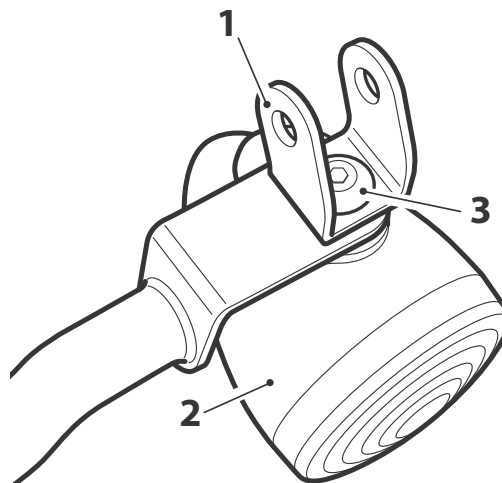

- 1. Lamp mounting bracket**
2. Indicator, left hand
3. Screw M8 x 25 mm

41. Position the left hand indicator and bracket at 90° to the light bar. A suitable bar can be passed through the bracket in order to hold it in position while tightening the M8 x 25 mm screw. Tighten the screw to **18 Nm**.
42. Repeat steps 38 - 41 for the right hand indicator.
43. With both indicator assemblies positioned correctly on the light bar, carefully remove the indicator lenses. Locate a flat bladed screwdriver in the lens drain slot and turn the blade through 90° to release the lens from the indicator body.
44. Rotate the lens through 90° and refit to position the drain slot at the bottom.

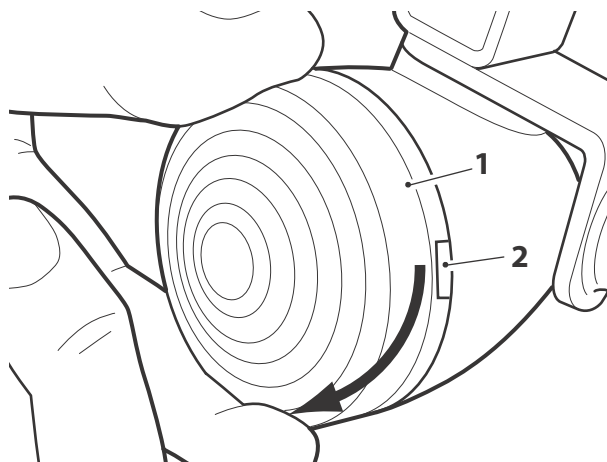

- 1. Indicator lens**
2. Drain slot

45. Remove the lamp from the lamp bowl, as shown below.

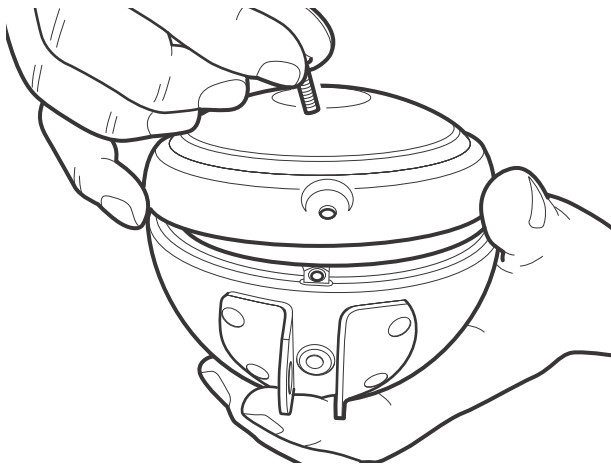

46. Remove the grommet from the lamp bowl.

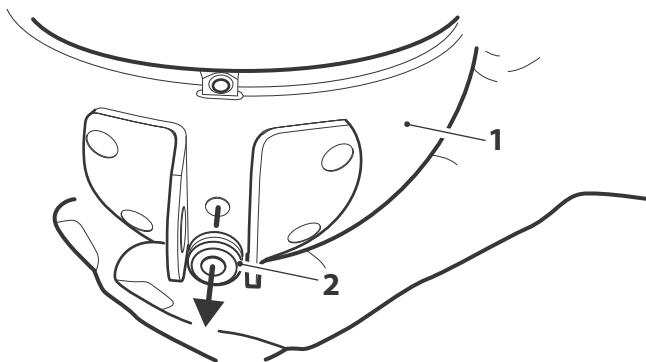

1. Lamp bowl
2. Grommet

47. Feed the left hand lamp harness, at the mounting bar end location, through the grommet.

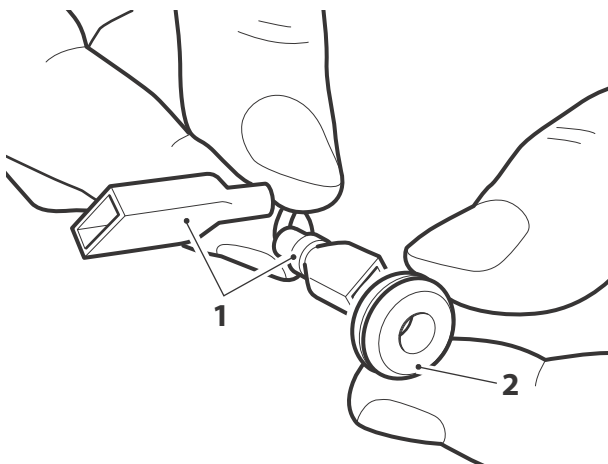

1. Lamp harness
2. Grommet

48. Feed the lamp harness into the lamp bowl and refit the grommet.

49. Position the lamp bowl onto the mounting bar lamp bracket and secure with the M8 x 35 mm screw, spacer and nut as shown below. Do not fully tighten the fixings at this stage.

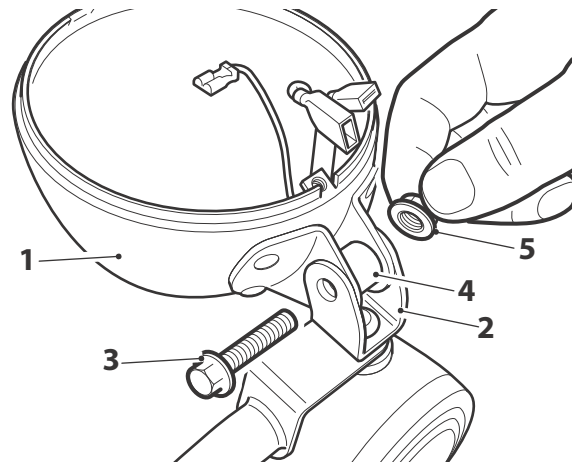

1. Lamp bowl
2. Bracket
3. Screw, M8 x 35 mm
4. Spacer
5. Nut

50. **For kit A9938100:** Connect the white lead on the lamp harness to the white lead on the lens assembly, the black lead on the harness to the black lead on the lens assembly.

For kit A9938099: Connect the white lead on the lamp harness to the white lead on the lamp and the black lead on the harness to the black lead on the inside of the lamp bowl.

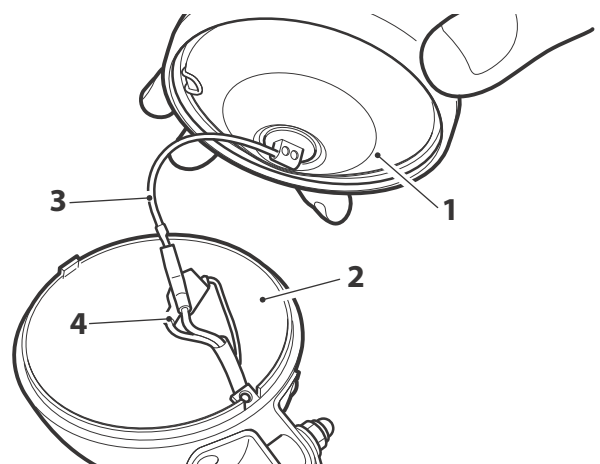

1. Lens assembly (A9938099 shown)
2. Lamp bowl (A9938099 shown)
3. White lead
4. Black lead

51. Refit the lamp to the lamp bowl and secure with the fixing screw.

52. Repeat steps 45 - 51 for the right hand lamp assembly.
53. Align the light bar assembly to the lower yoke. Route the indicator harnesses through the hole in the lower yoke and then into the headlight bowl.
54. Locate the new light bar assembly in position on the lower yoke and secure with two of the new M8 x 25 mm screws at the front mounting points. Tighten the screws to **6 Nm**.

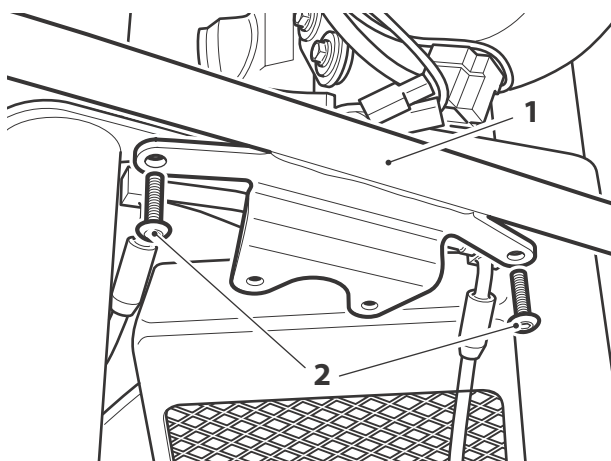

1. Light bar
2. Screws, M8 x 25 mm

Note:

- For motorcycles fitted with the windshield mounting kit, use the 7 x 15 x 20 mm spacer when fitting the rear mounting bolts for the light bar.
 - For motorcycles without the windshield mounting kit, use the 7 x 15 x 18 mm spacer when fitting the rear mounting bolts for the light bar.
55. Carefully align the front brake line assembly to the lower yoke such that it will not trap the indicator harnesses.

56. Using the correct spacer and the M6 x 35 mm bolts, secure the front brake line assembly and the light bar rear mountings to the lower yoke. Tighten the bolts to **6 Nm**.

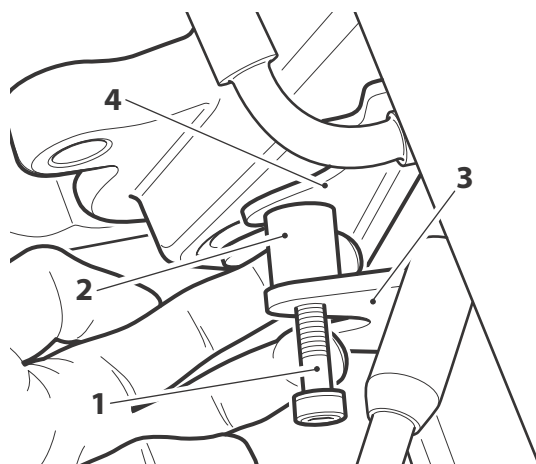

1. Bolt, M6 x 35 mm
2. Spacer
3. Light bar
4. Front brake line assembly

57. Route the new lamp harnesses under the lower yoke then around the back of the lower yoke and into the headlight bowl.

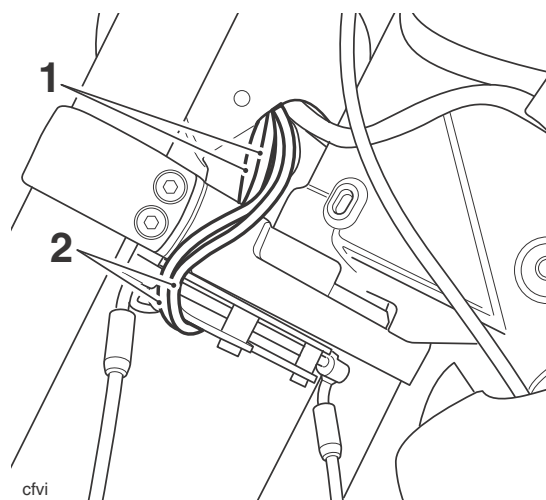

1. Indicator harness
2. New lamp harness



Warning

When securing electrical cables with cable ties, ensure the cable ties are fully tight. Ensure there is slack in the cables.

Failure to follow this warning may result in damage to the electrical cables which may lead to loss of motorcycle control and an accident.

58. Secure the lamp harness to the indicator harness with one of the cable ties from the kit.

Note:

- **Note the right hand indicator harnesses are identified with a section of red tape.**

59. Connect the indicator harnesses to the main wiring harness.

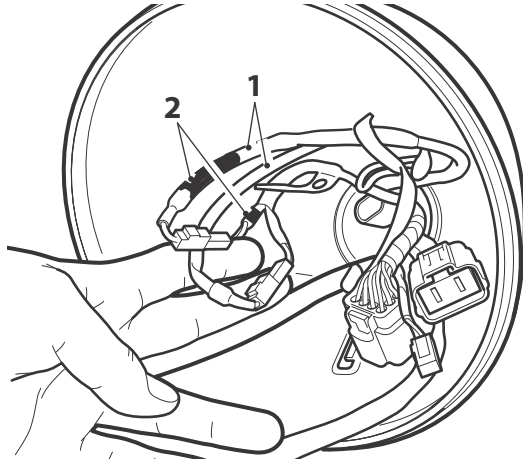

1. Indicator harness

2. Red tape, right hand indicator

60. Connect the new lamp harnesses to the sub-harness connectors.

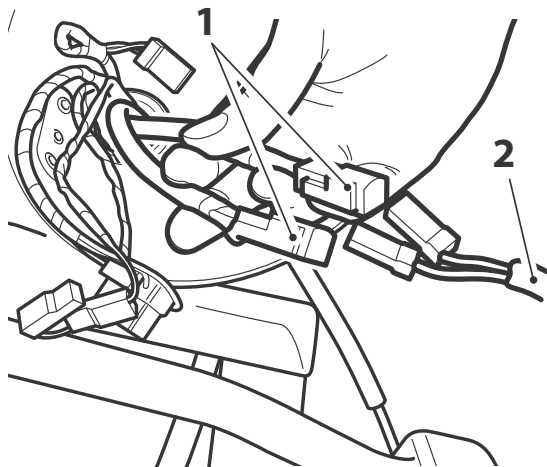

1. New lamp connectors

2. Sub-harness

61. The main harness connector for the auxiliary lamps is located in the headlight bowl and can be identified by the blue tape on it.

62. Connect the sub-harness to the 3 pin connector.

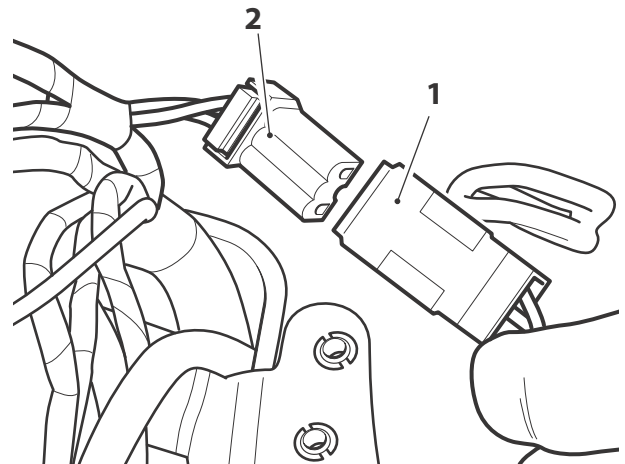

1. 3 pin connector

2. Sub-harness connector

63. Fit the relay provided into the sub-harness relay connector.

64. Ensure the wiring is correctly routed and does not foul or obstruct the steering. Secure in position to the headlight harness with the cable ties provided.

65. Reconnect the headlight and position lamp electrical connectors.

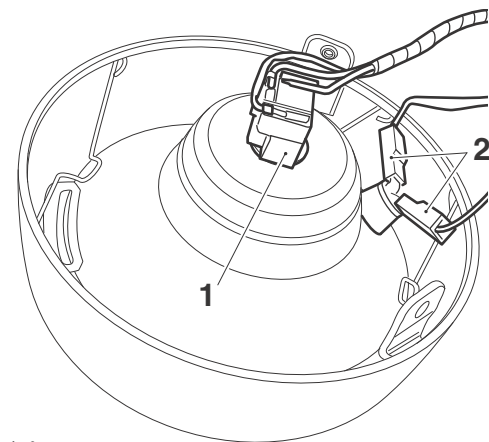

cfgn_2

1. Headlight connector

2. Position lamp connectors

66. Refit the headlight to the headlight bowl. Tighten the screws to **3 Nm**.

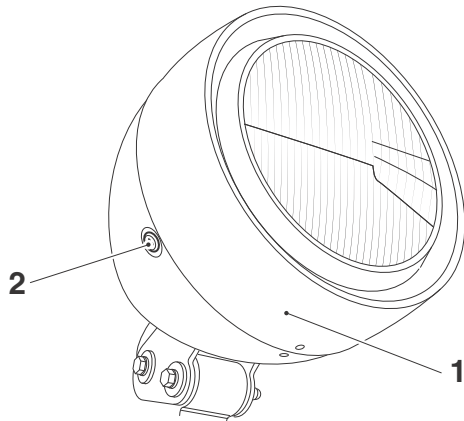

clgy_8

- 1. Headlight
- 2. Screws (1 of 2)

67. Reconnect the battery, positive (red) lead first.

Note:

- The auxiliary/fog lamp operating switch is located on the left hand handlebar switch assembly.

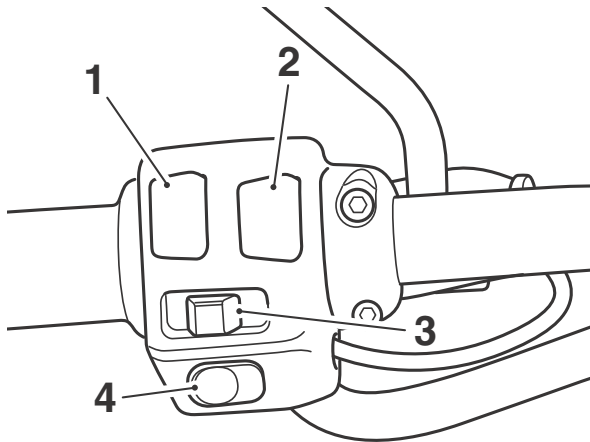

ceof

- 1. Headlight dip switch
- 2. Auxiliary/fog lamp switch
- 3. Direction indicator switch
- 4. Horn button

68. Turn the ignition switch to ON and check that the auxiliary/fog lamps, headlight, indicators and horn operate correctly. Turn the ignition switch to OFF.
69. Check the headlight alignment, as described in the service manual.
70. Tighten the headlight vertical alignment bolts to **9 Nm**.
71. Check the routing of the wiring harnesses and ensure they are not trapped or stressed in any way.



Warning

Move the handlebars to left and right full lock while checking that the cables or harnesses do not bind or restrict full lock operation. Any component, cables or harnesses that will restrict the steering may cause loss of control of the motorcycle and an accident.

72. Refit the rider's seat, as described in the service manual.

Models without ABS: Fuse number 8 protects the auxiliary lamps circuit. Refer to the label in the fuse box lid for fuse amperage.

Models with ABS: Fuse number 6 protects the auxiliary lamps circuit. Refer to the label in the fuse box lid for fuse amperage.

To protect the battery from excessive discharge while using fitted electrical accessories, use the table below as a guide for how much current should be drawn through the auxiliary socket, if fitted.

Fog lights	Heated grips (if fitted)	Auxiliary power socket maximum rated power
OFF	OFF	125 W (10.5 A)
OFF	ON	100 W (8.5 A)
ON	OFF	50 W (4.2 A)
ON	ON	35 W (3 A)



Warning

After fitting the accessory kit, the motorcycle will exhibit new handling characteristics. Operate the motorcycle in a safe area free from traffic to gain familiarity with any new characteristics. Operation of the motorcycle when not familiar with any new handling characteristics may result in loss of motorcycle control and an accident.



Warning

If, after fitment of this accessory kit, you have any doubt about the performance of any aspect of the motorcycle, contact an authorised Triumph dealer and do not ride the motorcycle until the authorised dealer has declared it fit for use. Riding a motorcycle when there is any doubt as to any aspect of the performance of the motorcycle may result in loss of control of the motorcycle leading to an accident.



Warning

Never ride an accessory equipped motorcycle at speeds above 80 mph (130 km/h).

The presence of accessories will cause changes in the stability and handling of the motorcycle. Failure to allow for changes in motorcycle stability may lead to loss of control or an accident.

Remember that the 80 mph (130 km/h) limit will be reduced by the fitting of non-approved accessories, incorrect loading, worn tyres, overall motorcycle condition and poor road or weather conditions.



Warning

The motorcycle must not be operated above the legal road speed limit except in closed course conditions.



Warning

Only operate this Triumph motorcycle at high speed in closed-course on road competition or on closed-course racetracks. High speed operation should only be attempted by riders who have been instructed in the techniques necessary for high speed riding and are familiar with the motorcycle's characteristics in all conditions.

High speed operation in any other circumstances is dangerous and will lead to loss of motorcycle control and an accident.