

## Fitting Instructions: Rocket III, Rocket III Classic and Rocket III Touring Auxiliary Power Socket - A9938047



Thank you for choosing this Triumph genuine accessory kit. This accessory kit is the product of Triumph's use of proven engineering, exhaustive testing, and continuous striving for superior reliability, safety and performance.

Completely read all of these instructions before commencing the installation of the accessory kit in order to become thoroughly familiar with the kit's features and the installation process.

These instructions should be considered a permanent part of your accessory kit, and should remain with it even if your accessory equipped motorcycle is subsequently sold.



### Warning

This accessory kit is designed for use on Triumph Rocket III, Rocket III Classic and Rocket III Touring motorcycles only and should not be fitted to any other Triumph model or to any other manufacturers motorcycle. Fitting this accessory kit to any other Triumph model, or to any other manufacturers motorcycle, may interfere with the rider and could affect the handling, stability or other aspects of the motorcycles operation which may result in loss of motorcycle control and an accident.



### Warning

Always have Triumph approved parts, accessories and conversions fitted by a trained technician of an authorised Triumph dealer. The fitment of parts, accessories and conversions by a technician who is not of an authorised Triumph dealer may affect the handling, stability or other aspects of the motorcycles operation which may result in loss of motorcycle control and an accident.

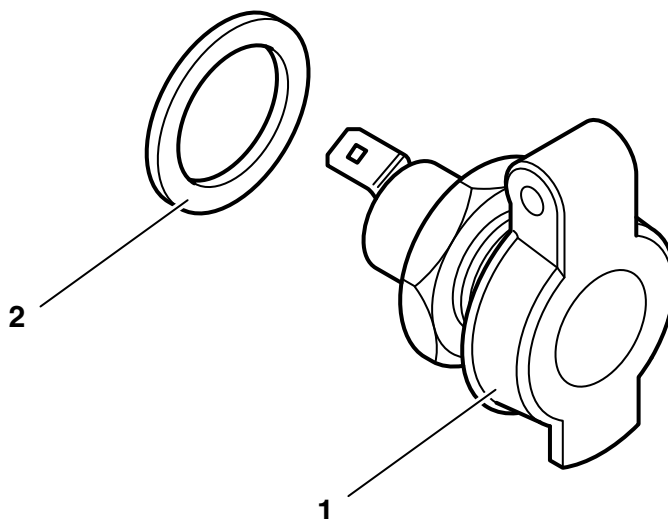

### Parts Supplied:

- |                                     |       |                     |       |
|-------------------------------------|-------|---------------------|-------|
| 1. Auxiliary power socket . . . . . | 1 off | 2. Washer . . . . . | 1 off |
|-------------------------------------|-------|---------------------|-------|



## Warning

Ensure that the motorcycle is stabilised and adequately supported to prevent it from falling and causing damage or injury.



## Warning

A torque wrench of known accurate calibration must be used when fitting this accessory kit. Failure to tighten any of the fasteners to the correct torque specification may result in loss of motorcycle control and an accident.

1. Position the motorcycle on a paddock stand.
2. Remove the seat and disconnect the battery, negative (black) lead first.
3. Refer to the illustration below and remove the two fixings securing the left hand frame infill panel to the motorcycle. Remove the infill panel from the motorcycle.

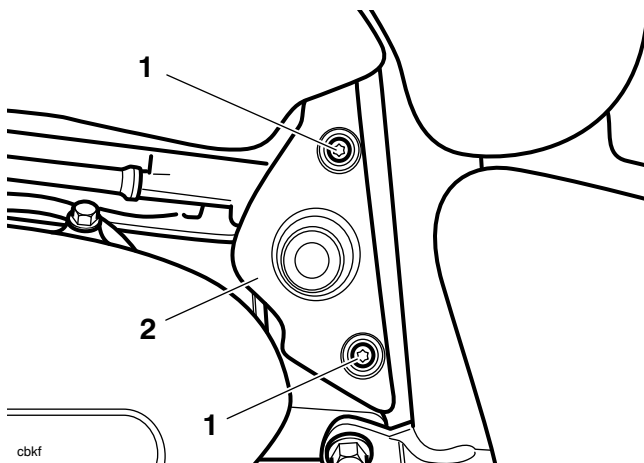

- cbkf
1. Fixing
  2. Infill panel

4. Push the blanking plug out of the infill panel.

### Note:

- **The blanking plug will not be refitted but should be retained for future re-use if the auxiliary power socket kit is ever removed.**

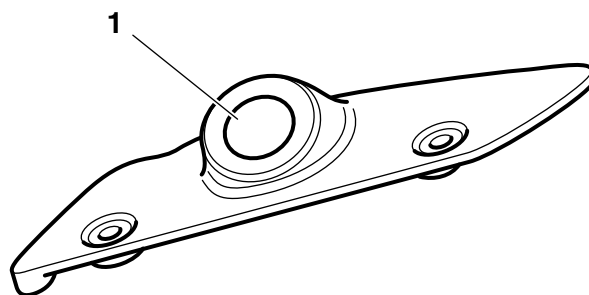

cbkg

1. Blanking plug

5. Fit the auxiliary power socket to the infill panel as shown below using the washer provided in the kit and the nut to secure. Tighten the nut to **5 Nm**.

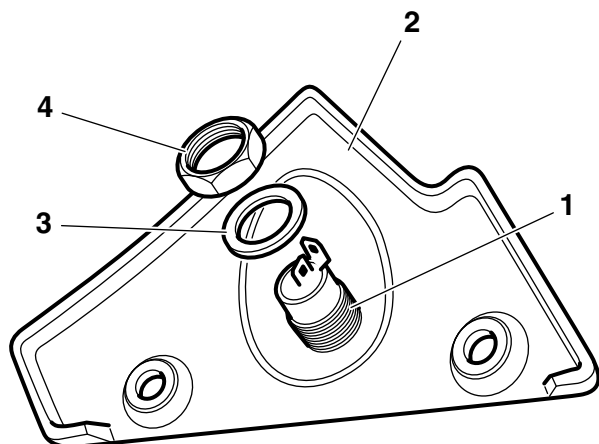

- 1. Auxiliary power socket**  
**2. Infill panel**  
**3. Washer**  
**4. Nut**

6. Locate the two-pin electrical connector marked with blue tape in the main wiring harness. The connector is situated in the area which was covered by the left hand frame infill panel. Fit the connector to the back of the auxiliary power socket.

7. Refit the left hand frame infill panel to the motorcycle. Tighten the two fixings to **4 Nm**.



### Caution

When refitting the left hand frame infill panel, route cables to follow the main wiring harness and ensure no cables can be trapped by the infill panel.

Failure to observe this caution may result in short circuits, a burnt out wiring harness and the possibility of fire.

8. Reconnect the battery, positive (red) lead first.  
9. Refit the seat.  
10. Remove the paddock stand.



## **Warning**

If, after fitment of this accessory kit, you have any doubt about the performance of any aspect of the motorcycle, contact an authorised Triumph dealer and do not ride the motorcycle until the authorised dealer has declared it fit for use. Riding a motorcycle when there is any doubt as to any aspect of the performance of the motorcycle may result in loss of control of the motorcycle leading to an accident.