

Auxiliary Power Socket Fitting Instructions - Bonneville America



! **WARNING:** Always have Triumph approved parts, accessories and conversions fitted by a trained technician of an authorised Triumph dealer. The fitting of parts, accessories and conversions by a technician who is not of an authorised Triumph dealer may affect the handling, stability or other aspects of the motorcycle operation which may result in an accident causing injury or death.

! **WARNING:** This auxiliary power socket is designed for use solely on the Triumph Bonneville America and should not be fitted to any other Triumph model or to any motorcycle of other manufacturers. Fitting this auxiliary power socket to any other Triumph model or to any motorcycle of other manufacturers may interfere with the rider and could affect the stability and handling of the motorcycle leading to an accident causing injury or death.

! **WARNING:** Throughout this operation, ensure that the motorcycle is stabilised and adequately supported to prevent the risk of injury from the motorcycle falling.

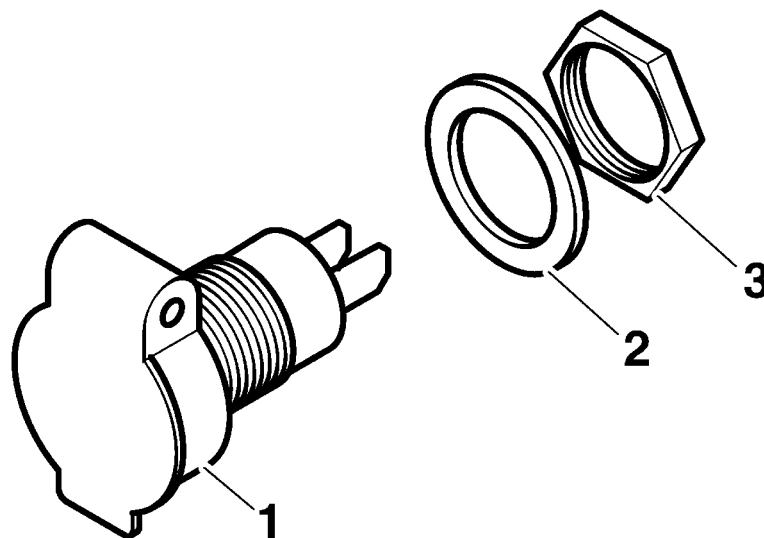

CASS

1	Auxiliary power socket	1
2.	Washer	1
3.	Nut	1

Auxiliary Power Socket Fitting Instructions - Bonneville America



1. Remove the seats and disconnect the battery, negative (black) lead first
2. Turn the fuel tap OFF and disconnect the hose from the tap

⚠ WARNING: Observe the warning advice given in the service manual on the safe handling of fuel and fuel containers.

3. Remove the fuel tank.
4. Locate the power socket mounting bracket to the rear of the cam cover and on the right hand side of the motorcycle.
5. Fit the auxiliary power socket to the bracket using the nut provided.
6. Locate the harness connector on the left-hand side of the motorcycle taped to the harness with blue tape and push onto the terminals at the rear of the auxiliary power socket.

⚠ WARNING: If, after fitment of the power socket, there is any doubt as to any aspect of the performance of the motorcycle, contact an authorised Triumph dealer and do not ride the motorcycle until the authorised Triumph dealer has declared it fit for use. Riding a motorcycle when there is any doubt as to any aspect of the performance of the motorcycle may result in loss of control of the motorcycle leading to an accident causing injury or death.

⚠ WARNING: Failure to tighten any of the fasteners to the correct torque specification may result in an accident causing injury or death.

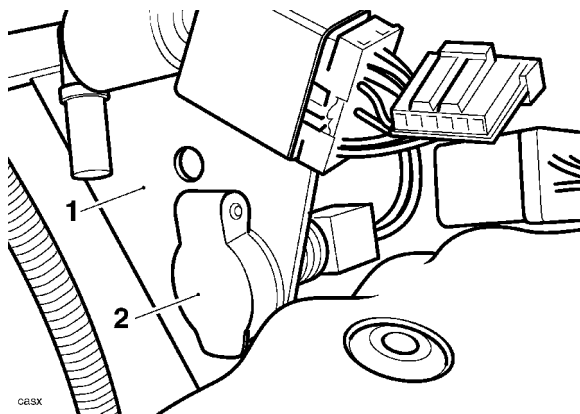

1. **Bracket**
2. **Auxiliary power socket**
7. Refit the fuel tank.
8. Reconnect the battery, positive (+) terminal first.
9. Refit the seats and tighten the seat bolt to **10 Nm**.