



Accessory Fitting Instructions

Thank you for choosing this Triumph genuine accessory kit. This accessory kit is the product of Triumph's use of proven engineering, exhaustive testing, and continuous striving for superior reliability, safety and performance.

Completely read all of these instructions before commencing the installation of the accessory kit in order to become thoroughly familiar with the kit's features and the installation process.

These instructions should be considered a permanent part of your accessory kit, and should remain with it even if your accessory equipped motorcycle is subsequently sold.

Scrolling LED Direction Indicator Kit

| Kit Number | Models |
|------------|---|
| A9838077 | Street Triple S 660cc from VIN 967907, Street Triple R from VIN 982752, Street Triple RS from VIN 966534, Street Triple RS Moto2™, Trident from VIN AC6898 (front fitment only), Speed Triple 1200 RS, Speed Triple 1200 RR (rear fitment only), Daytona Moto2™ 765, Tiger 900, Tiger 900 GT Pro to VIN BM5558, Tiger 1200 XRX Low Ride Height, Tiger 900 GT Aragon Edition, Tiger 900 Rally, Tiger 900 Rally Pro to VIN BM8581, Tiger 900 Rally Aragon Edition, Tiger 850 Sport, Tiger 1200 GT, Tiger 1200 GT Pro, Tiger 1200 Rally Pro, Tiger 1200 GT Explorer, Tiger 1200 Rally Explorer, Rocket 3 R, Rocket 3 GT, Rocket 3 TFC (front fitment only), Rocket 3 GT Triple Black, Rocket 3 R Black (front fitment only) |
| A9838177 | Street Triple S 660cc from VIN 967907, Street Triple R from VIN 982752, Street Triple RS from VIN 966534, Street Triple RS Moto2™, Trident from VIN AC6898 (front fitment only), Speed Triple 1200 RS, Speed Triple 1200 RR (rear fitment only), Daytona Moto2™ 765, Tiger 900, Tiger 900 GT Pro to VIN BM5558, Tiger 1200 XRX Low Ride Height, Tiger 900 GT Aragon Edition, Tiger 900 Rally, Tiger 900 Rally Pro to VIN BM8581, Tiger 900 Rally Aragon Edition, Tiger 850 Sport, Tiger 1200 GT, Tiger 1200 GT Pro, Tiger 1200 Rally Pro, Tiger 1200 GT Explorer, Tiger 1200 Rally Explorer, Rocket 3 R, Rocket 3 R Storm, Rocket 3 GT, Rocket 3 GT Storm, Rocket 3 TFC (front fitment only), Rocket 3 GT Triple Black, Rocket 3 R Black (front fitment only) |
| A9838162 | Speed Triple 1200 RR (front fitment only) |
| A9838098 | Street Triple S 660cc from VIN 967907, Street Triple R from VIN 982752, Street Triple RS from VIN 966534, Daytona Moto2™ 765, Tiger 900, Tiger 900 GT to VIN BM5542, Tiger 900 GT Pro to VIN BM5558, Tiger 900 GT Low Ride Height, Tiger 900 GT Aragon Edition, Tiger 900 Rally, Tiger 900 Rally Pro to VIN BM8581, Tiger 900 Rally Aragon Edition |
| A9838079 | Street Triple S 660cc from VIN 967907, Street Triple R from VIN 982752 up to VIN BF0949 |
| A9838097 | Trident from VIN AC6898 (rear fitment only), Tiger Sport from VIN AU7774, Rocket 3 R, Rocket 3 GT, Rocket 3 TFC (rear fitment only), Rocket 3 GT Triple Black, Rocket 3 R Black (rear fitment only), |
| A9838197 | Trident from VIN AC6898 (rear fitment only), Tiger Sport from VIN AU7774, Rocket 3 R, Rocket 3 R Storm, Rocket 3 GT, Rocket 3 GT Storm, Rocket 3 TFC (rear fitment only), Rocket 3 GT Triple Black, Rocket 3 R Black (rear fitment only), |

Parts supplied

A9838077, A9838098, A9838097, A9838177, A9838197

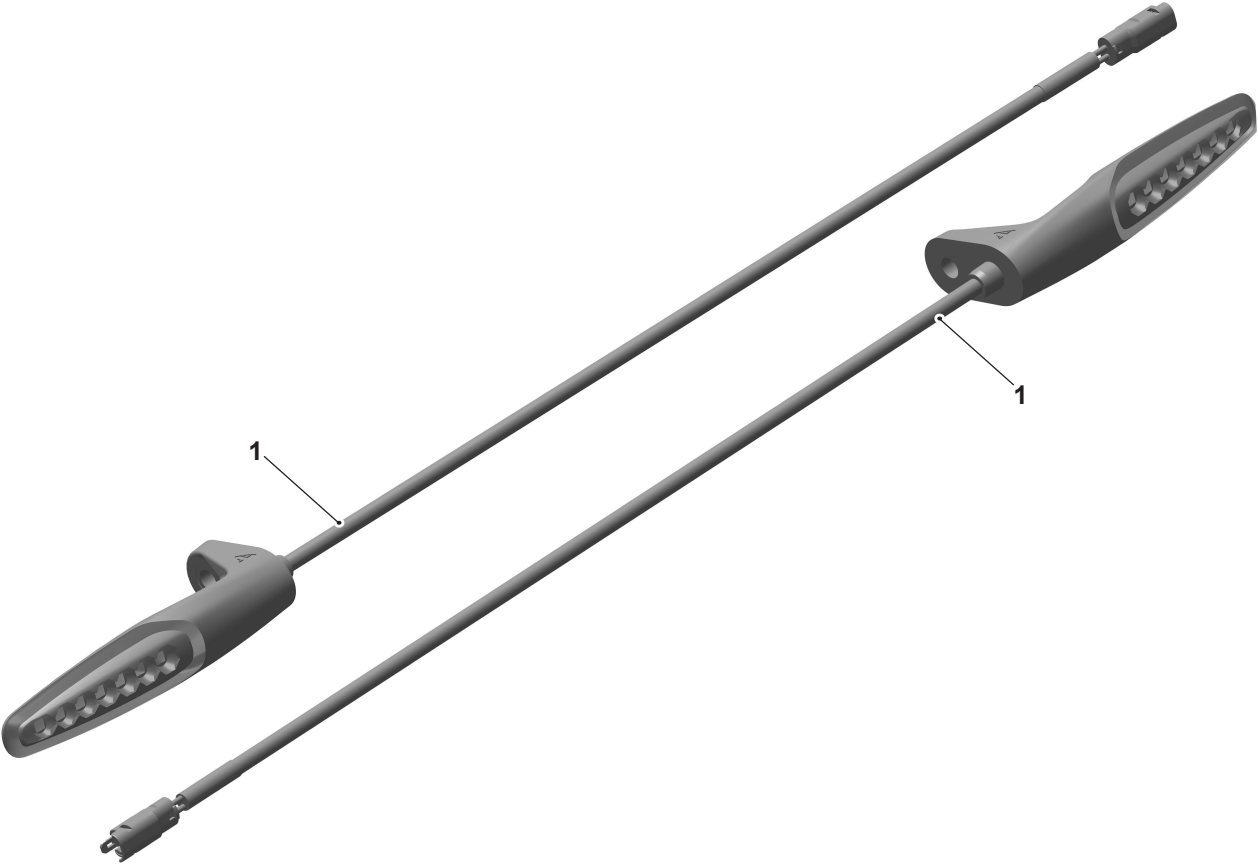

| | |
|------------------------|-------|
| 1. Direction indicator | 2 off |
|------------------------|-------|

A9838162

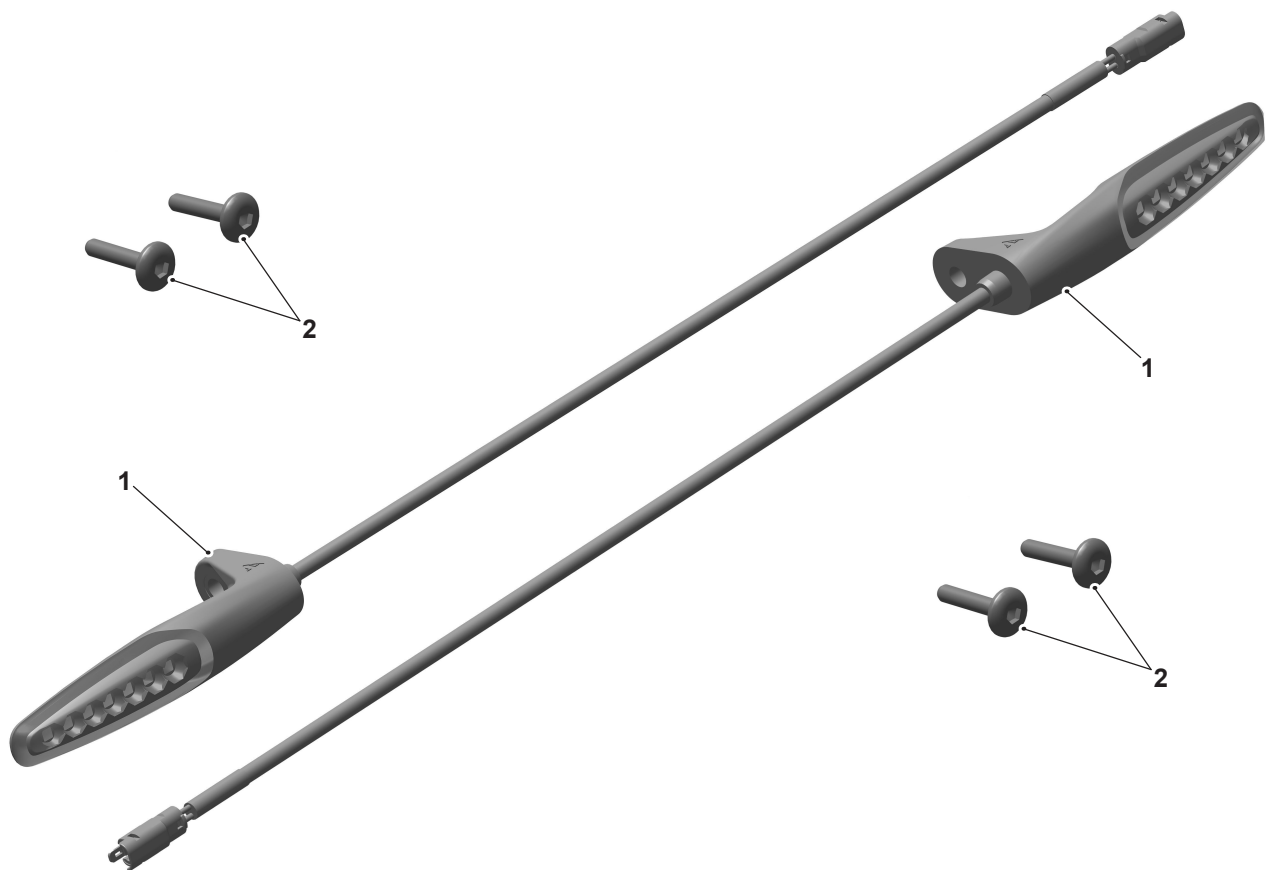

| | | | |
|------------------------|-------|---------------------------------|-------|
| 1. Direction indicator | 2 off | 2. M5 x 25 encapsulated fixings | 4 off |
|------------------------|-------|---------------------------------|-------|

A9838079

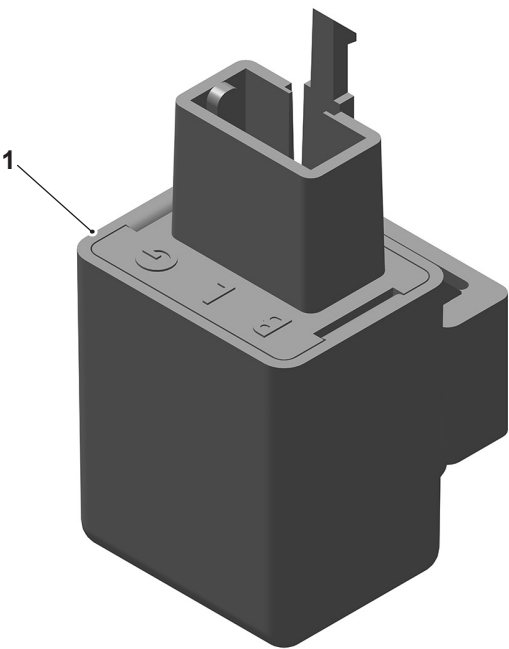

| | |
|----------|-------|
| 1. Relay | 1 off |
|----------|-------|

⚠ WARNING

Fit only genuine Triumph accessories to those models approved by Triumph as listed in the associated Triumph fitting instructions.

The accessory kits covered in this instruction are designed for use on specific models of Triumph motorcycle. The accessory kits and the models applicable are listed at the start of the instruction. They should never be fitted to any other Triumph model or to any other manufacturer's motorcycle.

Fitting an accessory kit to a Triumph model not listed, or to any other manufacturer's motorcycle, will affect the performance, stability and handling of the motorcycle.

Failure to follow the advice above may lead to loss of motorcycle control which could result in serious injury or death.

⚠ WARNING

Always have Triumph approved parts, accessories and conversions fitted by a competent person with the specialist knowledge and technical understanding of motorcycles, such as an authorised Triumph dealer.

The fitment of parts, accessories and conversions by a person without the specialist knowledge and technical understanding of motorcycles may affect the handling, stability or other aspects of the motorcycle's operation.

Failure to follow the advice above may lead to loss of motorcycle control which could result in serious injury or death.

⚠ WARNING

A torque wrench of known accurate calibration must be used when fitting this accessory kit.

Failure to tighten any of the fasteners to the correct torque specification may affect motorcycle performance, handling and stability.

Failure to follow the advice above may lead to loss of motorcycle control which could result in serious injury or death.

⚠ WARNING

Make sure the motorcycle is stabilised and adequately supported.

Do not support the motorcycle on any ancillary component, the exhaust system or any other non structural parts of the motorcycle frame.

A correctly supported motorcycle will help prevent it from falling.

An unstable motorcycle may fall resulting in motorcycle damage, serious injury or death.

NOTICE

Triumph offers a broad range of approved genuine accessories for your motorcycle.

We cannot therefore cover all possible equipment variations in these instructions. For removal and installation of Triumph Genuine Accessories, always refer to the instructions supplied with the respective accessory kit.

To obtain additional copies of any Triumph accessory instructions, visit www.triumphinstructions.com or contact your authorised Triumph dealer.

NOTICE

Before fitting this accessory kit, make sure the owner of the motorcycle has been informed of the warnings contained in this instruction.

⚠ WARNING

LED indicators must be fitted to the front and rear of the motorcycle at the same time and they must be fitted as a set of the same type. If LED indicators are fitted to the front or rear only, or different types of LED indicators are fitted to the front and rear, they will not be recognized by the motorcycle's electrical system and will not work. Riding a motorcycle with any of its lights not working is illegal and dangerous.

NOTICE

For the US and Canadian markets only, this accessory kit does not comply with F/CMVSS 108. The fitting of this accessory kit is at the owner's risk. If you use a motorcycle fitted with this kit on public roads, you may be prosecuted.

NOTICE

Make sure that a relevant Triumph Service Manual is available for reference during the fitting of this accessory kit.

All Models

1. Remove the seats as described in the Service Manual.
2. Disconnect the battery as described in the Service Manual.

Front and Rear Direction Indicators

3. If necessary, remove any body panels to access the direction indicator connectors, as described in the Service Manual.

4. Release the fixing securing the direction indicator. Retain the fixing for reuse.

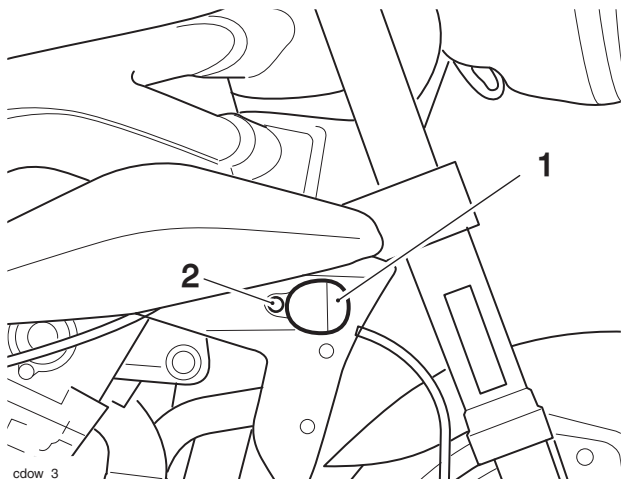

1. Direction indicator, front shown
2. Fixings

Trident Models from VIN AC6898 Only

5. When removing the rear indicators make sure the standard fit indicator support brackets are also removed. Retain the support brackets for reuse if the motorcycle is to be returned to its original condition. Retain the fixings for reuse.

All Models

NOTICE

Note the routing of the direction indicator harness for installation.

6. Follow the route of the direction indicator harnesses, disconnect them from the main harness and remove the indicators. Retain the indicators if the motorcycle is to be returned to its original condition.
7. Fit the direction indicators from the kit and tighten the fixings to the torque figure stated in the Service Manual.
8. Route the direction indicators harness as noted for removal and connect to the main harness. Make sure that the black cable is connected to the black cable on the main harness.
9. Refit any body panels that may have been removed as described in the Service Manual.

Speed Triple 1200 RR Only

Front Direction Indicators

NOTICE

New encapsulated fixings are provided in the kit for use when refitting the radiator cowls as described in the Service Manual.

⚠ WARNING

The cable routing of the accessory indicators must replicate the routing of the removed standard parts. Failure to do so may result in an electrical malfunction.

Street Triple 660cc Models from VIN 967907, Street Triple R Models from VIN 982752 up to VIN BF0949

10. Remove the seat bridge fixings as described in the Service Manual and move the seat bridge aside to allow access to the indicator relay. Retain the seat bridge fixings for reuse.
11. Note the position of the indicator relay on the undertray and detach it from its mounting. Disconnect the electrical connector and remove the relay. Retain the relay if the motorcycle is to be returned to its original condition.

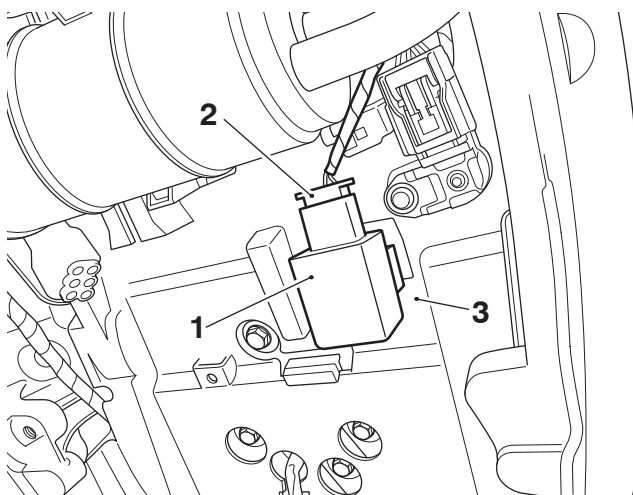

1. Indicator relay
2. Electrical connector
3. Undertray

12. Collect the indicator relay from the kit and connect the wiring harness connector to the relay.
13. Fit the indicator relay to the mounting on the undertray.
14. Refit the seat bridge, as described in the Service Manual.

All Models

15. Reconnect the battery, as described in the Service Manual.
16. Check the operation of the direction indicators. Rectify as necessary.
17. Refit the seats, as described in the Service Manual.

NOTICE

Before returning the motorcycle to the customer, make sure to download the latest instruments software using the current version of the Triumph diagnostic software.

⚠ WARNING

After fitting the accessory kit the motorcycle will exhibit new handling characteristics.

Operate the motorcycle in a safe area free from traffic to gain familiarity with any new characteristics.

Operation of the motorcycle when not familiar with any new handling characteristics may lead to loss of motorcycle control which could result in serious injury or death.

⚠ WARNING

If, after fitting this accessory kit, you have any doubt about the performance of any aspect of the motorcycle, contact a competent person with the specialist knowledge and technical understanding of motorcycles, such as an authorised Triumph dealer.

Riding a motorcycle when there is any doubt as to any aspect of the performance of the motorcycle may lead to loss of motorcycle control which could result in serious injury or death.

⚠ WARNING

Never ride an accessory-equipped motorcycle at speeds above 80 mph (130 km/h).

Remember that the 80 mph (130 km/h) limit will be reduced by the fitting of non-approved accessories, incorrect loading, worn tyres, overall motorcycle condition and poor road or weather conditions.

The presence of accessories will cause changes in the stability and handling of the motorcycle. Failure to allow for changes in motorcycle stability may lead to loss of motorcycle control which could result in serious injury or death.

⚠ WARNING

High-speed operation should only be attempted by riders who have been instructed in the techniques necessary for high-speed riding and are familiar with the motorcycle's characteristics in all conditions.

Only operate this Triumph motorcycle at high speed in closed-course, on-road competition or on closed-course racetracks.

High-speed operation in any other circumstances is dangerous and may lead to loss of motorcycle control which could result in serious injury or death.

NOTICE

The motorcycle must not be operated above the legal road speed limit except in closed-course conditions.