



Accessory Fitting Instructions

Thank you for choosing this Triumph genuine accessory kit. This accessory kit is the product of Triumph's use of proven engineering, exhaustive testing, and continuous striving for superior reliability, safety and performance.

Completely read all of these instructions before commencing the installation of the accessory kit in order to become thoroughly familiar with the kit's features and the installation process.

These instructions should be considered a permanent part of your accessory kit, and should remain with it even if your accessory equipped motorcycle is subsequently sold.

Headlight Grille Kit	
Kit Number	Models
A9838068	Scrambler 1200 XC, Scrambler 1200 XE to VIN BN8495
A9838104	Scrambler 1200 XE from VIN BP0885, Scrambler 1200 X

Parts Supplied: A9838068

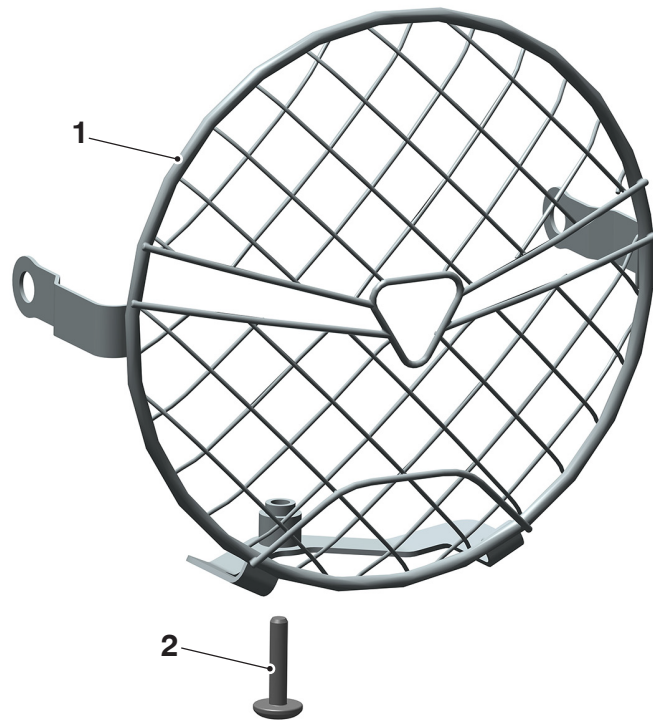

1. Headlight Grille	1 off	2. Fixing, M5 x 25 mm	1 off
---------------------	-------	-----------------------	-------

Parts Supplied: A9838104

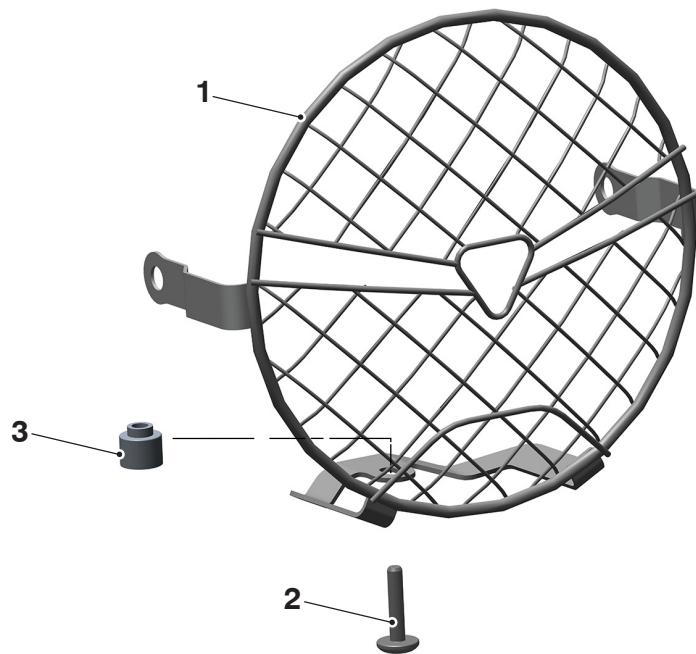

1. Headlight Grille	1 off	3. Spacer	1 off
2. Fixing, M5 x 25 mm	1 off		

⚠ WARNING

Fit only genuine Triumph accessories to those models approved by Triumph as listed in the associated Triumph fitting instructions.

The accessory kits covered in this instruction are designed for use on specific models of Triumph motorcycle. The accessory kits and the models applicable are listed at the start of the instruction. They should never be fitted to any other Triumph model or to any other manufacturer's motorcycle.

Fitting an accessory kit to a Triumph model not listed, or to any other manufacturer's motorcycle, will affect the performance, stability and handling of the motorcycle.

Failure to follow the advice above may lead to loss of motorcycle control which could result in serious injury or death.

⚠ WARNING

Always have Triumph approved parts, accessories and conversions fitted by a competent person with the specialist knowledge and technical understanding of motorcycles, such as an authorised Triumph dealer.

The fitment of parts, accessories and conversions by a person without the specialist knowledge and technical understanding of motorcycles may affect the handling, stability or other aspects of the motorcycle's operation.

Failure to follow the advice above may lead to loss of motorcycle control which could result in serious injury or death.

⚠ WARNING

A torque wrench of known accurate calibration must be used when fitting this accessory kit.

Failure to tighten any of the fasteners to the correct torque specification may affect motorcycle performance, handling and stability.

Failure to follow the advice above may lead to loss of motorcycle control which could result in serious injury or death.

⚠ WARNING

Make sure the motorcycle is stabilised and adequately supported.

Do not support the motorcycle on any ancillary component, the exhaust system or any other non structural parts of the motorcycle frame.

A correctly supported motorcycle will help prevent it from falling.

An unstable motorcycle may fall resulting in motorcycle damage, serious injury or death.

NOTICE

Triumph offers a broad range of approved genuine accessories for your motorcycle.

We cannot therefore cover all possible equipment variations in these instructions. For removal and installation of Triumph Genuine Accessories, always refer to the instructions supplied with the respective accessory kit.

To obtain additional copies of any Triumph accessory instructions, visit www.triumphinstructions.com or contact your authorised Triumph dealer.

1. Remove the lower fixing from the headlight which prevents rotation of the headlight cover fixing. Do not rotate or remove the headlight cover fixing. Retain the fixing for reuse if the motorcycle is to be returned to its original condition.

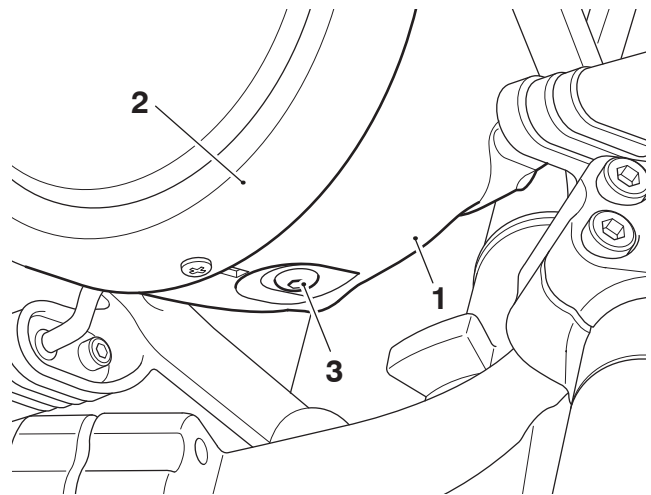

1. Headlight
2. Headlight cover fixing
3. Fixing

- Remove the headlight mounting fixings and detach the headlight from the headlight mounting brackets. Support the headlight and do not allow it to hang from the wiring harness.

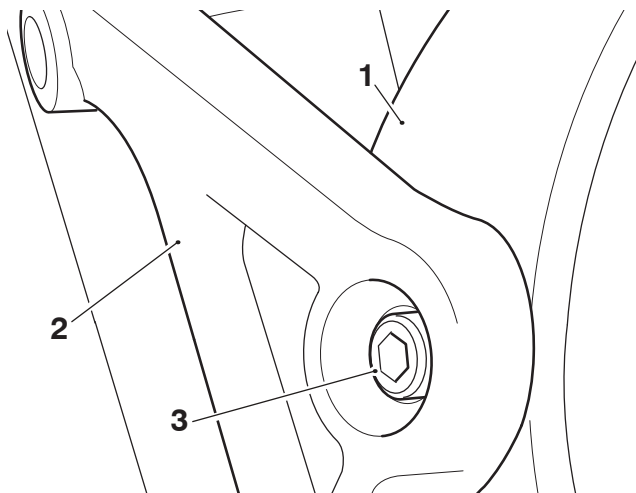

- Headlight
- Headlight mounting bracket, right hand side shown
- Fixing

- Insert the spacer in the lower fixing hole and fit the headlight grille over the headlight. Where the spacer is a separate item use the lower mounting bracket to hold the spacer in place.

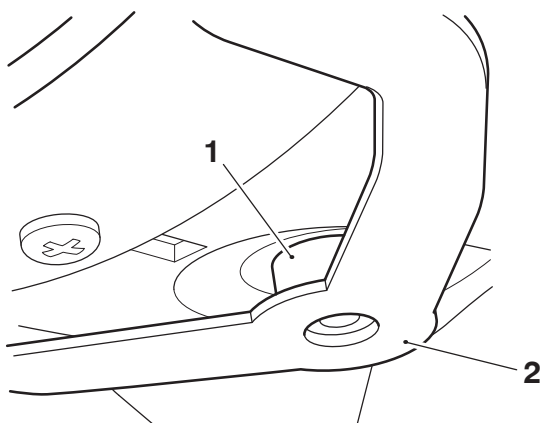

- Spacer
- Headlight grille lower mounting bracket

- Position the headlight and headlight grille side brackets between the headlight mounting brackets. Make sure the lower headlight grille mounting bracket aligns with the lower fixing hole underneath the headlight.

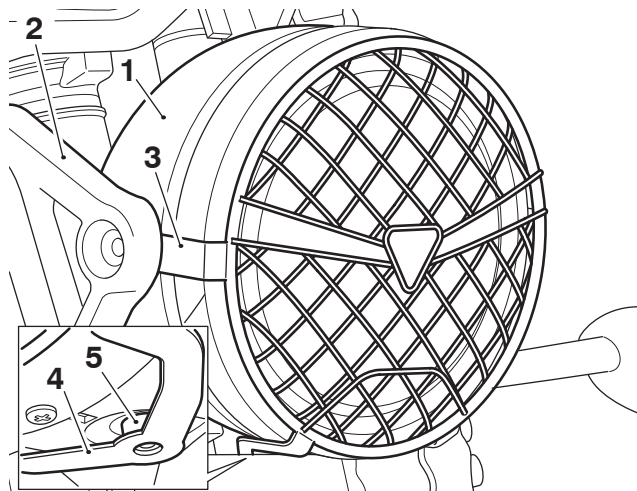

- Headlight
- Headlight mounting bracket, right hand side shown
- Headlight grille side bracket, right hand side shown
- Headlight grille lower mounting bracket
- Lower fixing hole, headlight

- Align the headlight and headlight grille with the fixing positions in the headlight mounting brackets and fit the two original fixings. Do not fully tighten the fixings at this point.

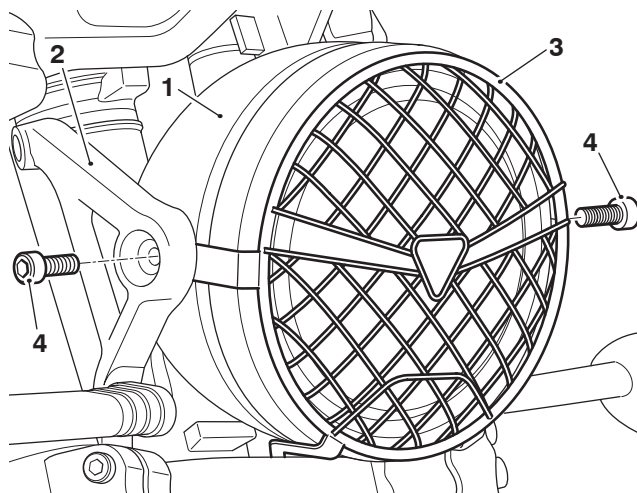

- Headlight
- Headlight mounting bracket, right hand side shown
- Headlight grille
- Fixings

6. Collect the M5 x 25 mm fixing from the kit. Make sure the headlight cover fixing has not rotated around the headlight. Fit the M5 x 25 mm fixing through the headlight grille and headlight cover fixing. Tighten the fixing to **6 Nm**.

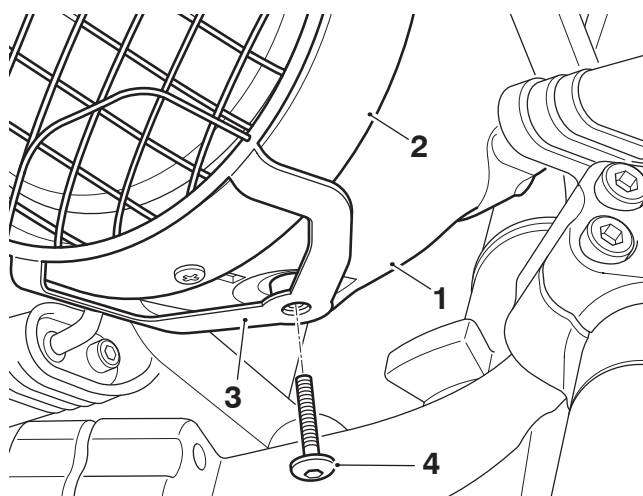

1. Headlight
2. Headlight cover fixing
3. Headlight grille
4. Fixings, M5 x 25 mm

7. Adjust the alignment of the headlamp and tighten the headlight fixings, as described in the Service Manual.

NOTICE

Ensure the grille remains parallel with the headlight whilst tightening the fixings.

⚠ WARNING

After fitting the accessory kit the motorcycle will exhibit new handling characteristics.

Operate the motorcycle in a safe area free from traffic to gain familiarity with any new characteristics.

Operation of the motorcycle when not familiar with any new handling characteristics may lead to loss of motorcycle control which could result in serious injury or death.

⚠ WARNING

If, after fitting this accessory kit, you have any doubt about the performance of any aspect of the motorcycle, contact a competent person with the specialist knowledge and technical understanding of motorcycles, such as an authorised Triumph dealer.

Riding a motorcycle when there is any doubt as to any aspect of the performance of the motorcycle may lead to loss of motorcycle control which could result in serious injury or death.

⚠ WARNING

Never ride an accessory-equipped motorcycle at speeds above 80 mph (130 km/h).

Remember that the 80 mph (130 km/h) limit will be reduced by the fitting of non-approved accessories, incorrect loading, worn tyres, overall motorcycle condition and poor road or weather conditions.

The presence of accessories will cause changes in the stability and handling of the motorcycle. Failure to allow for changes in motorcycle stability may lead to loss of motorcycle control which could result in serious injury or death.

⚠ WARNING

High-speed operation should only be attempted by riders who have been instructed in the techniques necessary for high-speed riding and are familiar with the motorcycle's characteristics in all conditions.

Only operate this Triumph motorcycle at high speed in closed-course, on-road competition or on closed-course racetracks.

High-speed operation in any other circumstances is dangerous and may lead to loss of motorcycle control which could result in serious injury or death.

NOTICE

The motorcycle must not be operated above the legal road speed limit except in closed-course conditions.