



Accessory Fitting Instructions

Thank you for choosing this Triumph genuine accessory kit. This accessory kit is the product of Triumph's use of proven engineering, exhaustive testing, and continuous striving for superior reliability, safety and performance.

Completely read all of these instructions before commencing the installation of the accessory kit in order to become thoroughly familiar with the kit's features and the installation process.

These instructions should be considered a permanent part of your accessory kit, and should remain with it even if your accessory equipped motorcycle is subsequently sold.

LED Fog Light Kit	
Kit Number	Models
A9830174	Tiger 900 GT from VIN BP6441

Parts supplied

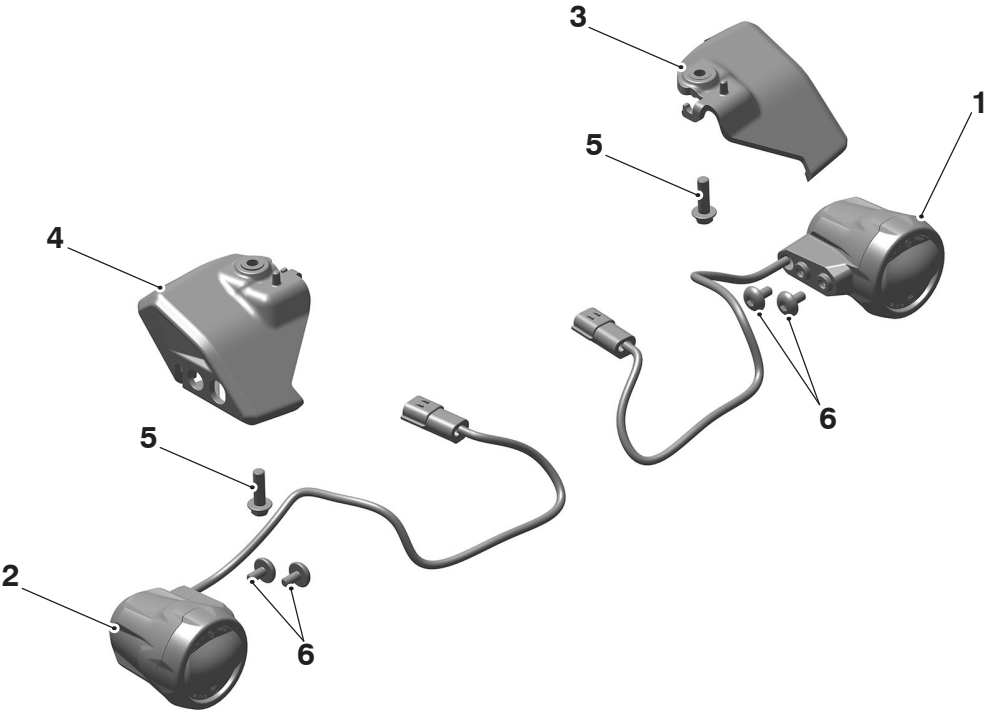

1. LED fog light, left hand	1 off	4. Shroud, right hand	1 off
2. LED fog light, right hand	1 off	5. Fixing, M6 x 20 mm	2 off
3. Shroud, left hand	1 off	6. Fixing, M5 x 10 mm	4 off

⚠ WARNING

Fit only genuine Triumph accessories to those models approved by Triumph as listed in the associated Triumph fitting instructions.

The accessory kits covered in this instruction are designed for use on specific models of Triumph motorcycle. The accessory kits and the models applicable are listed at the start of the instruction. They should never be fitted to any other Triumph model or to any other manufacturer's motorcycle.

Fitting an accessory kit to a Triumph model not listed, or to any other manufacturer's motorcycle, will affect the performance, stability and handling of the motorcycle.

Failure to follow the advice above may lead to loss of motorcycle control which could result in serious injury or death.

⚠ WARNING

Always have Triumph approved parts, accessories and conversions fitted by a competent person with the specialist knowledge and technical understanding of motorcycles, such as an authorised Triumph dealer.

The fitment of parts, accessories and conversions by a person without the specialist knowledge and technical understanding of motorcycles may affect the handling, stability or other aspects of the motorcycle's operation.

Failure to follow the advice above may lead to loss of motorcycle control which could result in serious injury or death.

⚠ WARNING

A torque wrench of known accurate calibration must be used when fitting this accessory kit.

Failure to tighten any of the fasteners to the correct torque specification may affect motorcycle performance, handling and stability.

Failure to follow the advice above may lead to loss of motorcycle control which could result in serious injury or death.

⚠ WARNING

Make sure the motorcycle is stabilised and adequately supported.

Do not support the motorcycle on any ancillary component, the exhaust system or any other non structural parts of the motorcycle frame.

A correctly supported motorcycle will help prevent it from falling.

An unstable motorcycle may fall resulting in motorcycle damage, serious injury or death.

NOTICE

Triumph offers a broad range of approved genuine accessories for your motorcycle.

We cannot therefore cover all possible equipment variations in these instructions. For removal and installation of Triumph Genuine Accessories, always refer to the instructions supplied with the respective accessory kit.

To obtain additional copies of any Triumph accessory instructions, visit www.triumphinstructions.com or contact your authorised Triumph dealer.

Fog Light Installation

1. Remove the front beak as described in the Service Manual.
2. Collect the right hand LED fog light and right hand shroud from the kit. Attach the fog light to the shroud using the M5 x 10 mm fixings. Tighten the fixings to **4 Nm**.

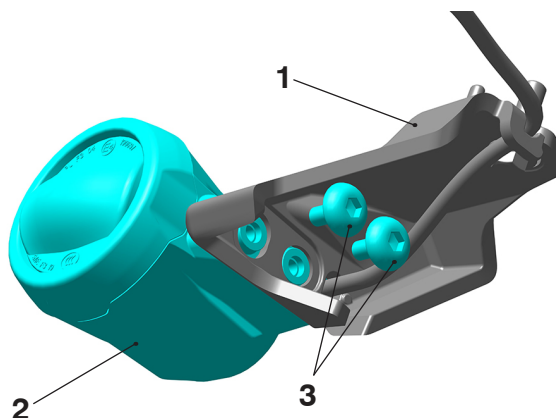

1. Shroud, right hand side
2. LED fog light, right hand side
3. Fixings, M5 x 10 mm

3. Align the marker pin on the fog light assembly with the hole on the subframe mount.

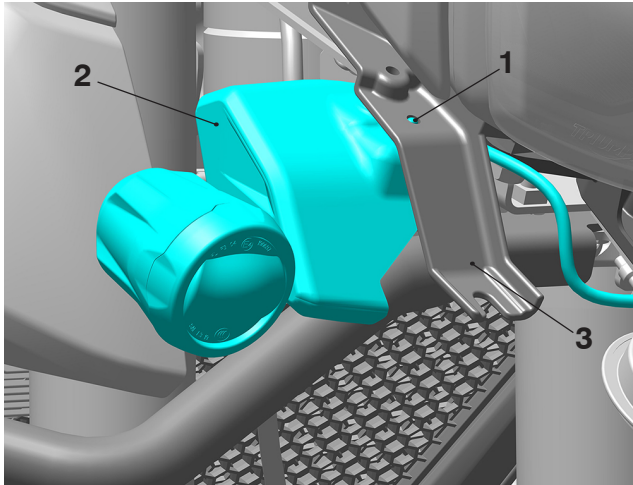

1. Marker pin
2. Fog light assembly
3. Subframe mount

4. Secure the fog light assembly to the subframe mount using the M6 x 20 mm fixing. Tighten the fixings to **8 Nm**.

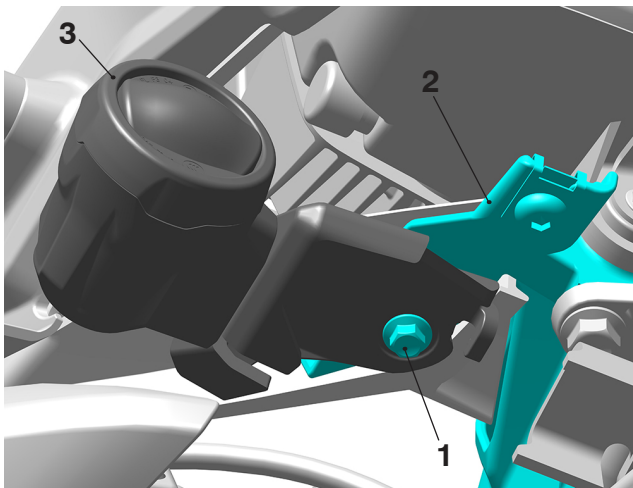

1. M6 x 20 mm fixing
2. Subframe mount
3. Fog light assembly

5. Repeat step 2 to 4 for the left hand side fog light.
6. Refit the front beak as described in the Service Manual.

7. Route the fog light subharness along the underside of the beak and through the right hand the clip.

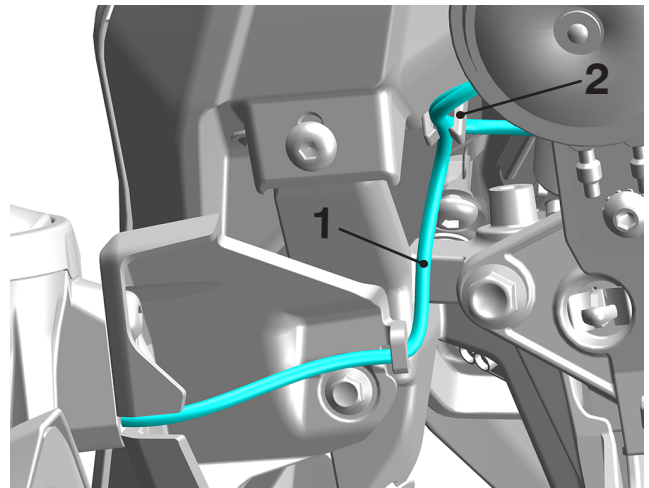

1. Fog light harness
2. Clip, right hand shown

8. Secure the subharness under the retaining feature on the cable tidy.

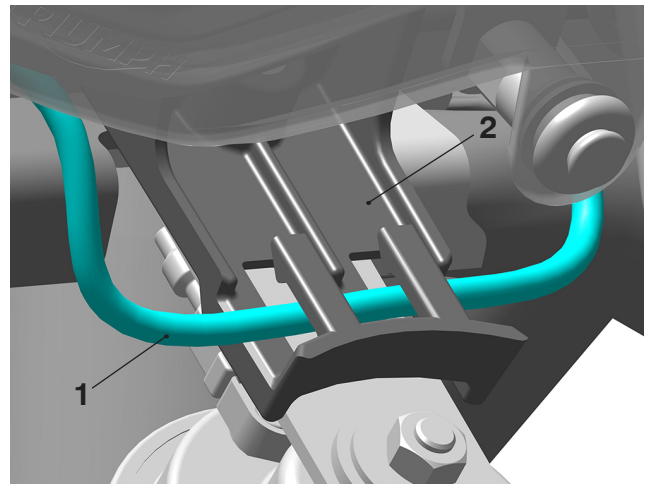

1. Fog light harness connector, right hand side
2. Cable tidy

9. Route the right hand subharness along the left side of the beak and secure in the left hand clip.
10. Repeat steps 7 to 9 for the left hand side harness, securing to the left side clip first.
11. Locate the main harness connectors and remove the blanking plugs.

12. Connect the left hand side fog light to its main harness connector. Repeat for the right hand side fog light.

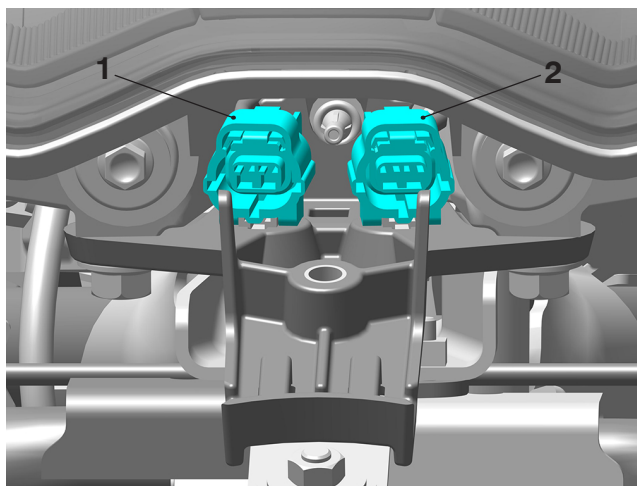

1. Fog light harness connector, left hand side
2. Fog light harness connector, right hand side

Operation

NOTICE

The fog light switch will only operate when the headlights are on.

The fog light switch will reset to OFF when the ignition is turned off, then on again.

1. To turn the fog lights ON or OFF press and release the fog light switch.



1. Fog light switch

2. When the fog lights are turned on the fog light indicator will illuminate in the multifunction display.

The fog lights are protected by a chassis ECM which will automatically cut power in the event of an overload.

Power can be restored to the fog lights by turning the ignition switch off, then on again, provided that the condition that caused the fault has been rectified.

In the event of a more serious overload, fuse number PS 1 protects the fog lights. Refer to the label in the fuse box lid for fuse amperage.

Fog Light System Testing

Operate the fog light switch and check that the fog lights come on. While sitting on the motorcycle, check the fog light alignment against a wall and adjust as required.

⚠ WARNING

After fitting the accessory kit the motorcycle will exhibit new handling characteristics.

Operate the motorcycle in a safe area free from traffic to gain familiarity with any new characteristics.

Operation of the motorcycle when not familiar with any new handling characteristics may lead to loss of motorcycle control which could result in serious injury or death.

⚠ WARNING

If, after fitting this accessory kit, you have any doubt about the performance of any aspect of the motorcycle, contact a competent person with the specialist knowledge and technical understanding of motorcycles, such as an authorised Triumph dealer.

Riding a motorcycle when there is any doubt as to any aspect of the performance of the motorcycle may lead to loss of motorcycle control which could result in serious injury or death.

⚠ WARNING

Never ride an accessory-equipped motorcycle at speeds above 80 mph (130 km/h).

Remember that the 80 mph (130 km/h) limit will be reduced by the fitting of non-approved accessories, incorrect loading, worn tyres, overall motorcycle condition and poor road or weather conditions.

The presence of accessories will cause changes in the stability and handling of the motorcycle. Failure to allow for changes in motorcycle stability may lead to loss of motorcycle control which could result in serious injury or death.

⚠ WARNING

High-speed operation should only be attempted by riders who have been instructed in the techniques necessary for high-speed riding and are familiar with the motorcycle's characteristics in all conditions.

Only operate this Triumph motorcycle at high speed in closed-course, on-road competition or on closed-course racetracks.

⚠ WARNING Continued

High-speed operation in any other circumstances is dangerous and may lead to loss of motorcycle control which could result in serious injury or death.

NOTICE

The motorcycle must not be operated above the legal road speed limit except in closed-course conditions.