



## Accessory Fitting Instructions

Headlight Protector	
Kit Number	Models Affected
A9830148	Tiger 1200 GT, Tiger 1200 Rally, Tiger 1200 Rally Pro, Tiger 1200 GT Explorer, Tiger 1200 Rally Explorer

Thank you for choosing this Triumph genuine accessory kit. This accessory kit is the product of Triumph's use of proven engineering, exhaustive testing, and continuous striving for superior reliability, safety and performance.

Completely read all of these instructions before commencing the installation of the accessory kit in order to become thoroughly familiar with the kit's features and the installation process.

These instructions should be considered a permanent part of your accessory kit, and should remain with it even if your accessory equipped motorcycle is subsequently sold.

**Parts Supplied:**

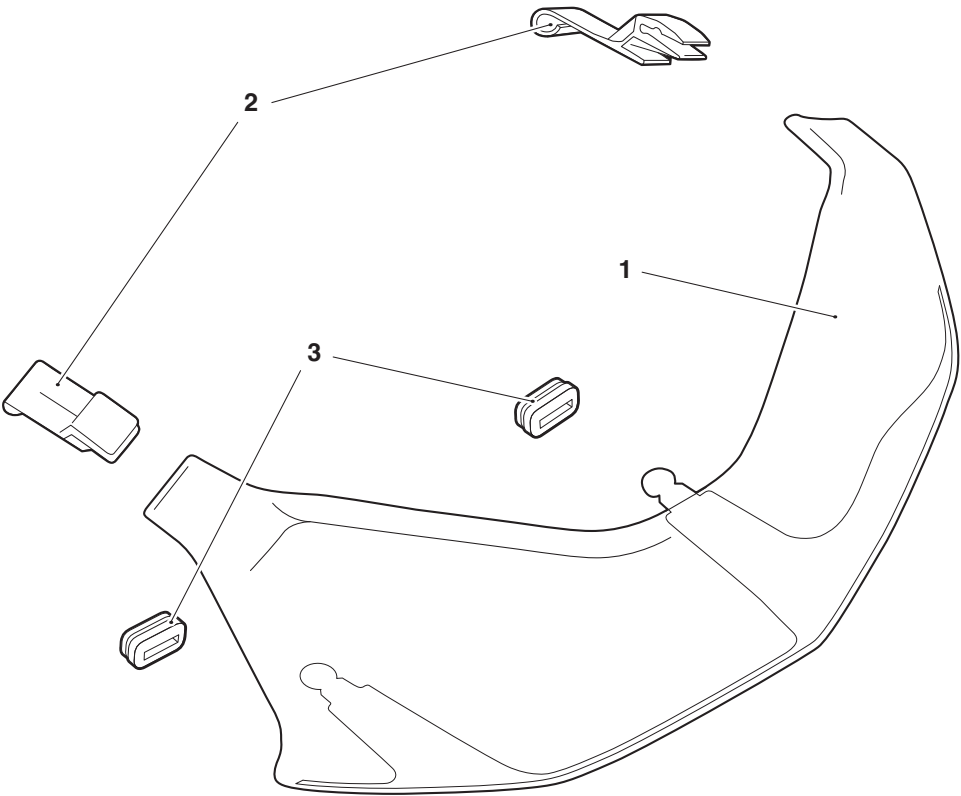

1. Headlight protector	1 off	3. Grommets	2 off
2. Upper mount moulding	2 off		

## Notice

OFF ROAD USE ONLY. In some countries, use of a motorcycle fitted with this accessory kit on public roads may render the user liable to prosecution. Always remove the headlamp protector before using the motorcycle on public roads.



## Warning

Fit only genuine Triumph accessories to those models approved by Triumph as listed in the associated Triumph fitting instructions. The accessory kits covered in this instruction are designed for use on specific models of Triumph motorcycle. The accessory kits and the models applicable are listed at the start of the instruction. They should never be fitted to any other Triumph model or to any other manufacturer's motorcycle. Fitting an accessory kit to a Triumph model not listed, or to any other manufacturer's motorcycle will affect the performance, stability and handling of the motorcycle. This may affect the rider's ability to control the motorcycle and could result in an accident causing severe injuries or death.



## Warning

Always have Triumph approved parts, accessories and conversions fitted by a trained technician of an authorised Triumph dealer. The fitment of parts, accessories and conversions by a technician who is not of an authorised Triumph dealer may affect the handling, stability or other aspects of the motorcycle's operation which may result in loss of motorcycle control and an accident.



## Warning

Throughout this operation, make sure that the motorcycle is stabilised and adequately supported to prevent risk of injury from the motorcycle falling.



## Warning

A torque wrench of known accurate calibration must be used when fitting this accessory kit. Failure to tighten any of the fasteners to the correct torque specification may affect motorcycle performance, handling and stability. This may result in loss of motorcycle control and an accident.

## Note:

- Triumph offers a broad range of approved genuine accessories for your motorcycle. We cannot therefore cover all possible equipment variations in these instructions. For removal and installation of Triumph Genuine Accessories, always refer to the instructions supplied with the respective accessory kit. To obtain additional copies of any Triumph accessory instructions, visit [www.triumphinstructions.com](http://www.triumphinstructions.com) or contact your authorised Triumph dealer.

- Remove the high level mudguard as described in the Service Manual.
- Remove the two M3 x 12 mm fixings holding the headlight infill inserts in place from each side of the headlight. Retain the fixings for reuse. Retain the headlight infill inserts if the motorcycle is to be returned to its original condition.

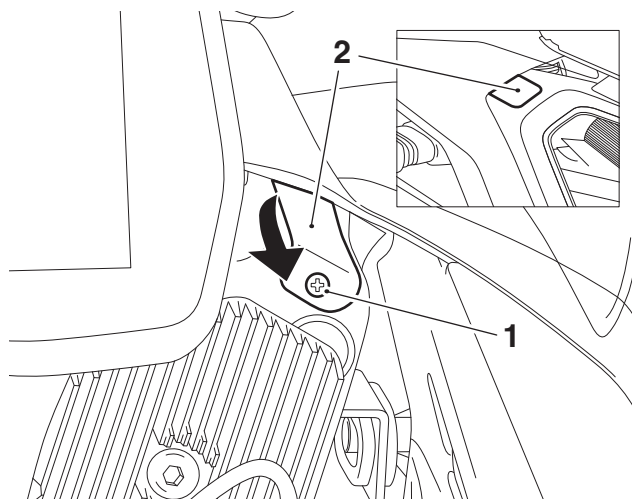

- Fixing, M3 x 12 mm
- Headlight infill insert

3. Fit the two upper mount mouldings from the kit to the headlight, using the M3 x 12 fixings. Tighten the fixings to **1 Nm**.

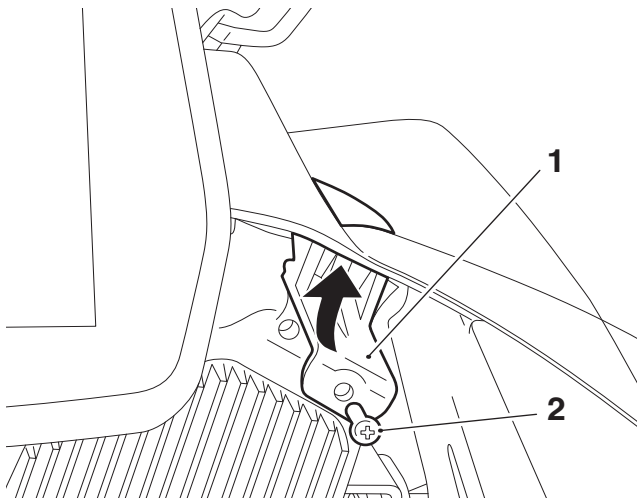

1. Upper mount moulding
2. Fixing, M3 x 12 mm

4. Fit the two grommets from the kit to the underside of the headlight.

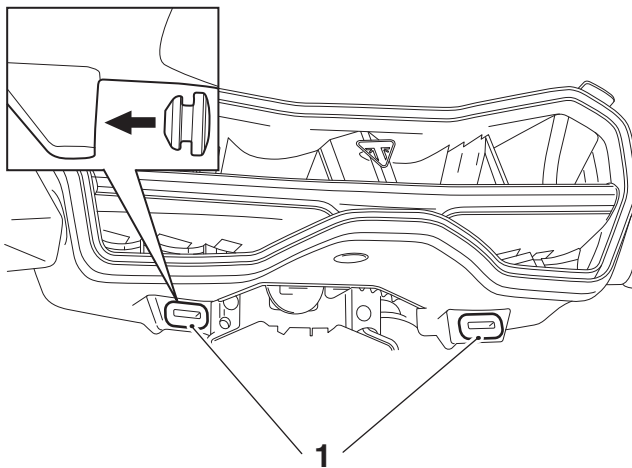

1. Grommets

5. Locate the two headlight protector lower mount tabs into the grommets on each side of the headlight.

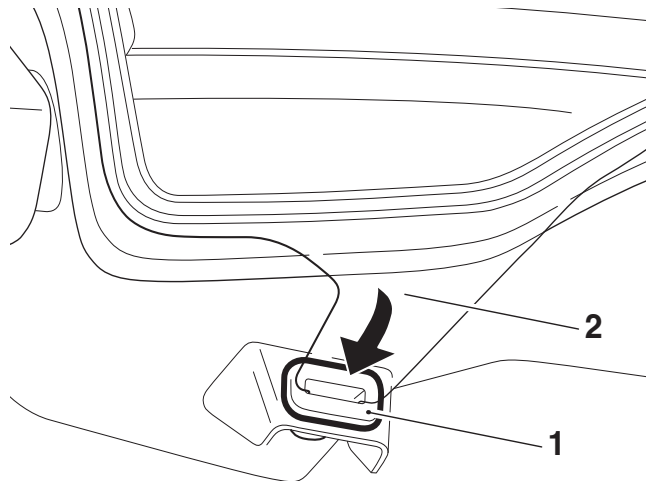

1. Grommet, right hand shown
2. Headlight protector

6. Push the top of the headlight protector into the two upper mount mouldings, until an audible click is heard on both sides.

**Note:**

- The lip of the headlight protector should sit within a recess in the upper mount mouldings.

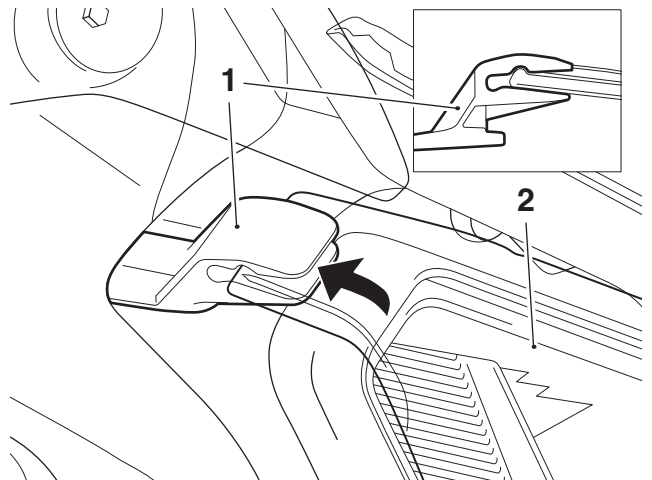

1. Upper mount moulding, right hand shown
2. Headlight protector

7. Refit the high level mudguard as described in the Service Manual.

---

## Cleaning



### Caution

Products such as window cleaning fluids, insect remover, rain repellent, scouring compounds, petrol or strong solvents such as alcohol, acetone, carbon tetrachloride, etc. will damage the headlamp protector. Never allow these products to contact the headlamp protector.

Clean the headlamp protector with a solution of mild soap or detergent and lukewarm water. After cleaning, rinse well and then dry with a soft, lint free cloth.



### Warning

After fitting the accessory kit the motorcycle will exhibit new handling characteristics. Operate the motorcycle in a safe area free from traffic to gain familiarity with any new characteristics. Operation of the motorcycle when not familiar with any new handling characteristics may result in loss of motorcycle control and an accident.



### Warning

Never ride an accessory equipped motorcycle at speeds above 80 mph (130 km/h). The presence of accessories will cause changes in the stability and handling of the motorcycle. Failure to allow for changes in motorcycle stability may lead to loss of control or an accident. Remember that the 80 mph (130 km/h) limit will be reduced by the fitting of non-approved accessories, incorrect loading, worn tyres, overall motorcycle condition and poor road or weather conditions.



### Warning

This motorcycle must not be operated above the legal road speed limit except in authorised closed-course conditions.



### Warning

Only operate this Triumph motorcycle at high speed in closed-course on-road competition or on closed-course racetracks. High-speed operation should only be attempted by riders who have been instructed in the techniques necessary for high-speed riding and are familiar with the motorcycle's characteristics in all conditions. High-speed operation in any other circumstances is dangerous and may result in loss of motorcycle control and an accident.