



Accessory Fitting Instructions

LED Headlight Kit	
Kit Number	Models Affected
A9830104	Bonneville Bobber up to VIN AE7434 with Euro 4 ECM (see below)
To allow correct functioning of the Daytime Running Light (DRL) when fitting this LED headlight kit, one of the following accessory Switch Housings must also be fitted - either A9630248 (refer to the individual instructions for fitment of this switch housing) or A9630249 (fitment of this switch housing is covered in the Service Manual).	
DRL Switch Housing Kit	
Kit Number	Models Affected
A9630249	Bonneville Bobber (without cruise control) up to VIN AE7434 with Euro 4 ECM (see below)

Thank you for choosing this Triumph genuine accessory kit. This accessory kit is the product of Triumph's use of proven engineering, exhaustive testing, and continuous striving for superior reliability, safety and performance.

Completely read all of these instructions before commencing the installation of the accessory kit in order to become thoroughly familiar with the kit's features and the installation process.

These instructions should be considered a permanent part of your accessory kit, and should remain with it even if your accessory equipped motorcycle is subsequently sold.

Note:

- The engine ECM is located under the seat.

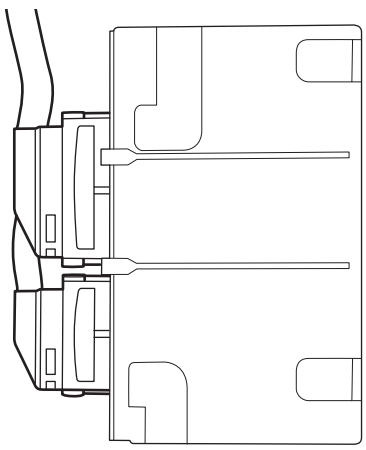
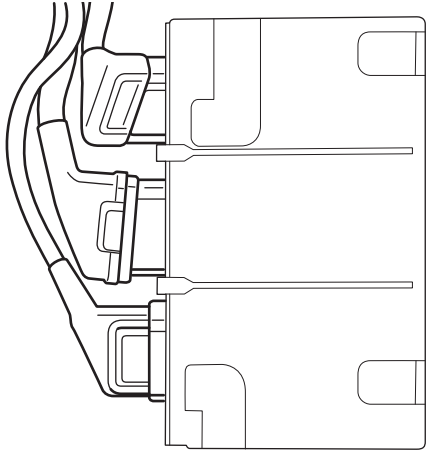
Engine ECM Identification	
Euro 4 ECM	Euro 5 ECM
	
Two connectors	Three connectors

Parts Supplied: A9830104

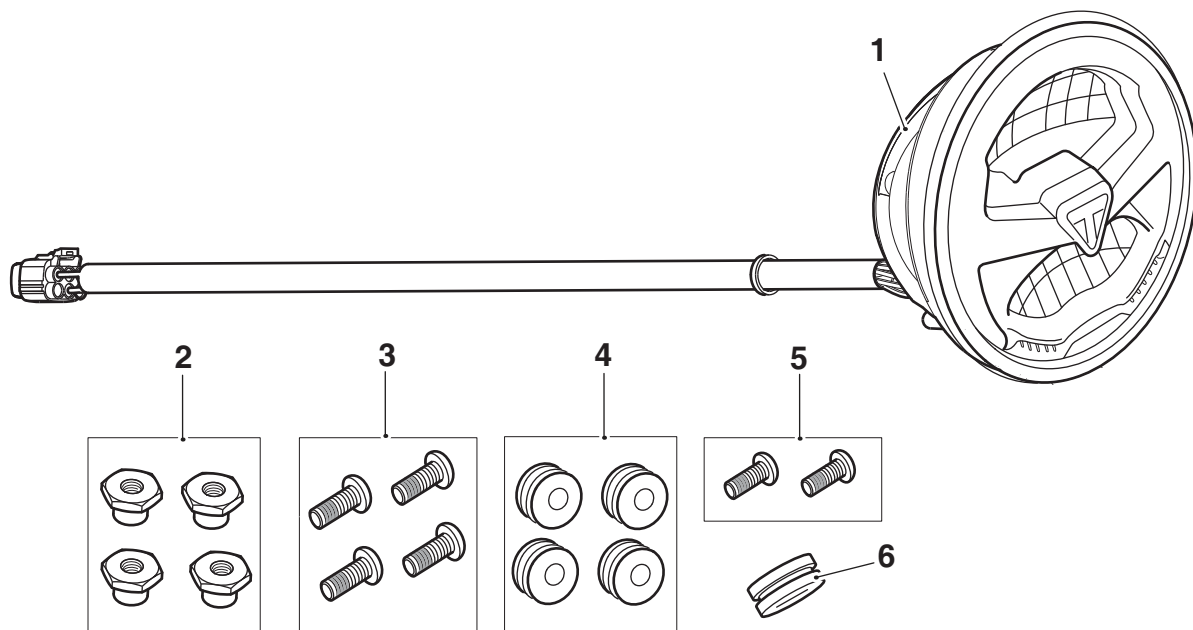

1. LED headlight	1 off	4. Grommet	4 off
2. Flanged nut	4 off	5. Fixing, M5 x 12 mm (encapsulated)	2 off
3. Fixing, M6 x 12 mm (encapsulated)	4 off	6. Split Grommet (if supplied)	1 off

Parts Supplied: A9630249

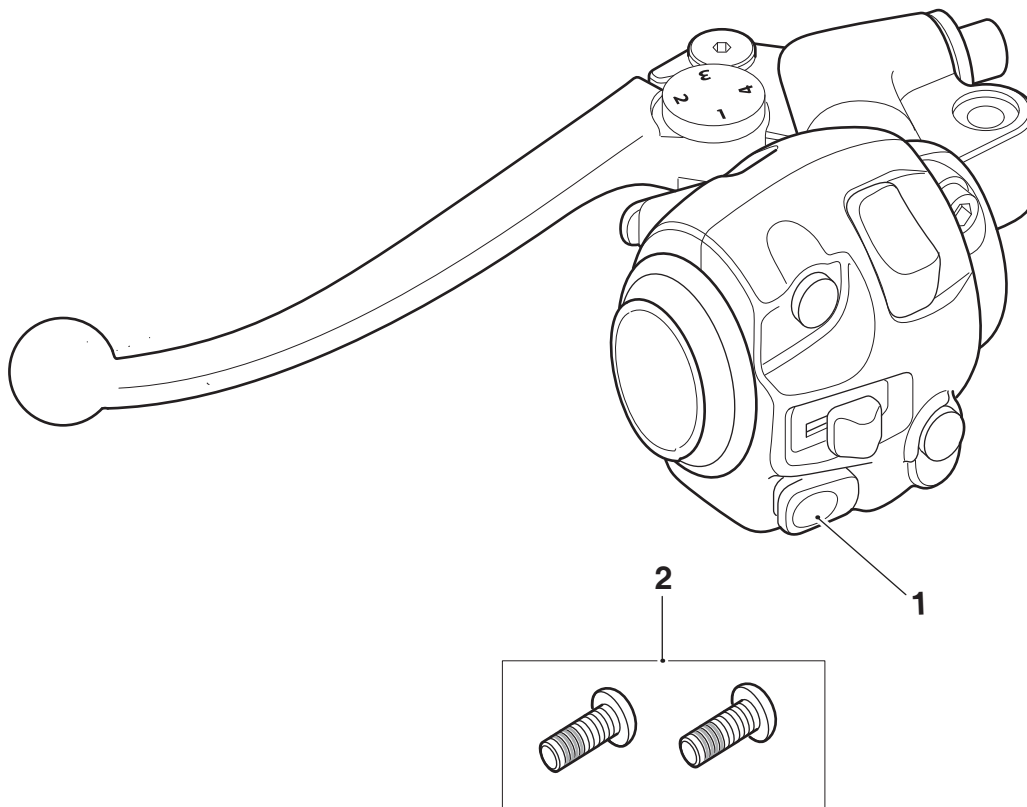

1. Switch housing assembly	1 off	2. Fixing, M5 x 12 mm (encapsulated)	2 off
----------------------------	-------	--------------------------------------	-------

Warning

Fit only genuine Triumph accessories to those models approved by Triumph as listed in the associated Triumph fitting instructions. The accessory kits covered in this instruction are designed for use on specific models of Triumph motorcycle. The accessory kits and the models applicable are listed at the start of the instruction. They should never be fitted to any other Triumph model or to any other manufacturer's motorcycle. Fitting an accessory kit to a Triumph model not listed, or to any other manufacturer's motorcycle will affect the performance, stability and handling of the motorcycle. This may affect the rider's ability to control the motorcycle and could result in an accident causing severe injuries or death.

Warning

Always have Triumph approved parts, accessories and conversions fitted by a trained technician of an authorised Triumph dealer. The fitment of parts, accessories and conversions by a technician who is not of an authorised Triumph dealer may affect the handling, stability or other aspects of the motorcycle's operation which may result in loss of motorcycle control and an accident.

Warning

Make sure the motorcycle is supported. A correctly supported motorcycle will help prevent it from falling. An unstable motorcycle may fall, causing injury to the operator or damage to the motorcycle.

Warning

A torque wrench of known accurate calibration must be used when fitting this accessory kit. Failure to tighten any of the fasteners to the correct torque specification may affect motorcycle performance, handling and stability. This may result in loss of motorcycle control and an accident.

Note:

• Triumph offers a broad range of approved genuine accessories for your motorcycle. We cannot therefore cover all possible equipment variations in these instructions. For removal and installation of Triumph Genuine Accessories, always refer to the instructions supplied with the respective accessory kit. To obtain additional copies of any Triumph accessory instructions, visit www.triumphinstructions.com or contact your authorised Triumph dealer.

1. Disconnect the battery, negative (black) lead first.
2. Remove the fuel tank, as described in the Service Manual.
3. Remove the left hand switch housing and clutch lever assembly, as described in the Service Manual. Retain the switch housing and clutch lever assembly for reuse if the motorcycle is to be returned to its original condition.
4. Fit either of the following accessory switch housing kits;
 - A9630248 which incorporates cruise control; refer to individual fitting instructions.
 - A9630249 which does not incorporate cruise control; fit as described in the Service Manual.
5. Remove the headlight bezel. Retain the headlight bezel, fixing and nut for reuse.

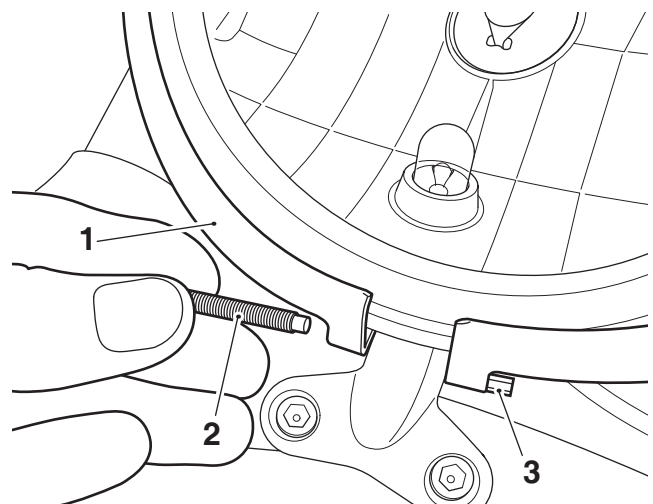

1. Headlight bezel
2. Fixing
3. Nut

6. Disconnect the headlight harness connector.

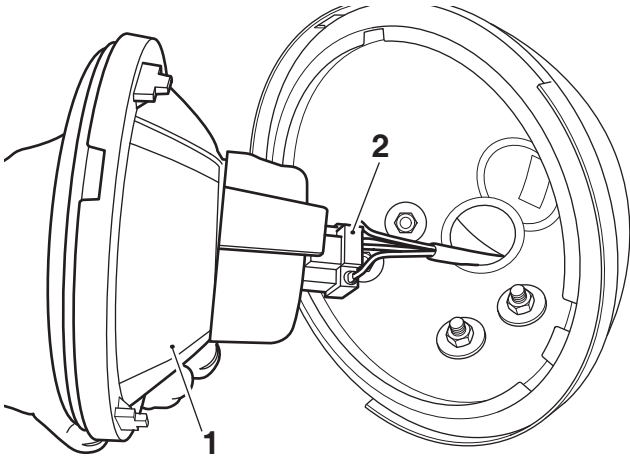

- 1. Headlight
- 2. Headlight harness connector

7. Remove the running light from the headlight.

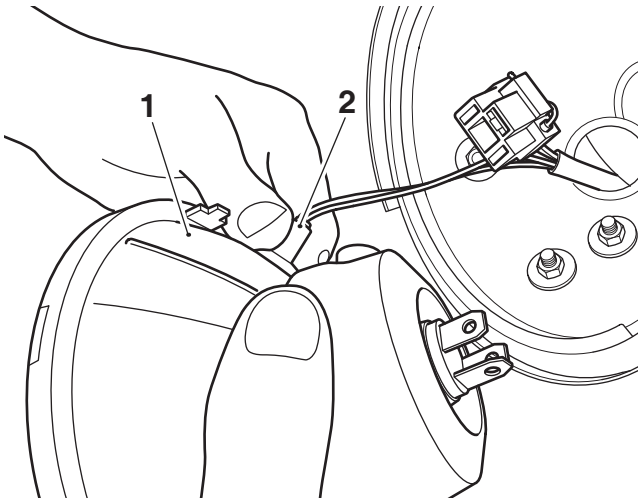

- 1. Headlight
- 2. Running light

8. Remove the headlight. Retain the headlight for reuse if the motorcycle is to be returned to its original condition.

9. Remove the headlight support ring noting its orientation. Retain the support ring for reuse.

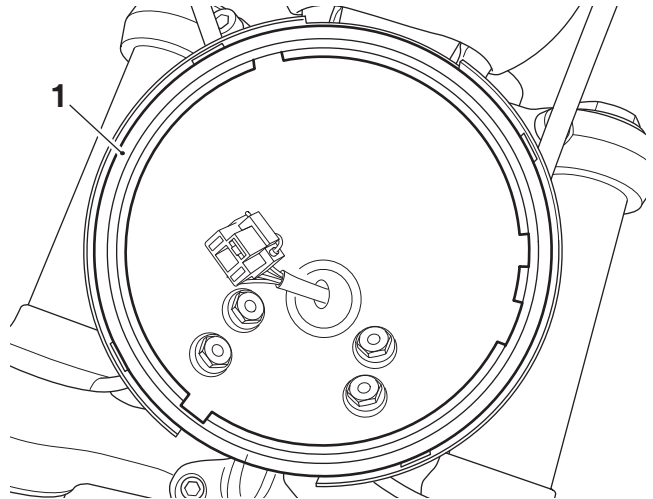

- 1. Headlight support ring

10. Remove the harness guide from the left hand side of the motorcycle headstock. Retain the harness guide for reuse. Discard the fixings.

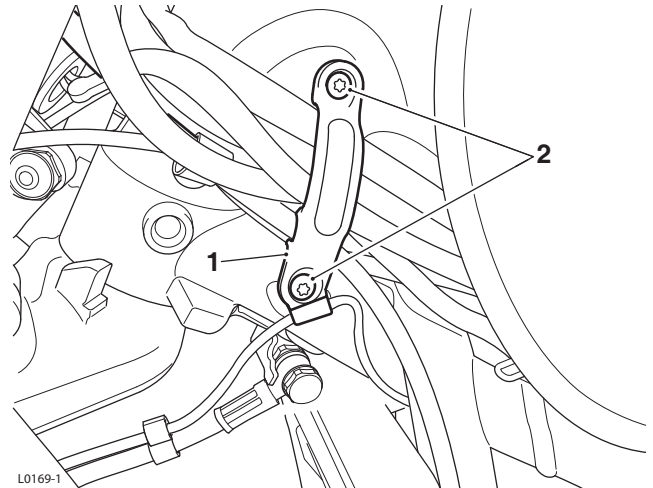

- 1. Harness guide
- 2. Fixings

11. Remove the snap on wiring harness cover from the left hand side of the motorcycle releasing all seven cover retaining clips. Retain the harness cover for reuse.

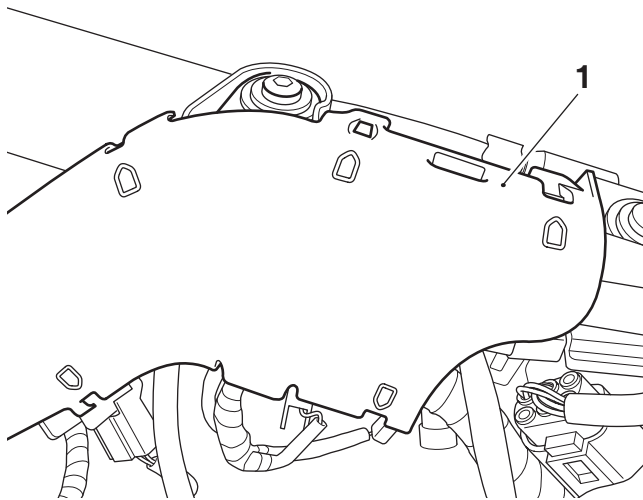

1. Wiring harness cover

12. Disconnect the headlight harness connector from the main wiring harness connector.

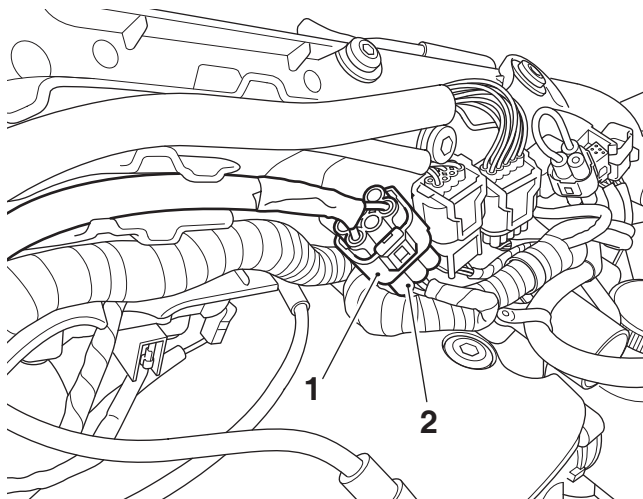

1. Headlight harness connector
2. Main wiring harness connector

13. Carefully pull the headlight wiring harness back past the headstock and through the grommet in the rear of the headlight bowl. Retain the headlight wiring harness for reuse if the motorcycle is to be returned to its original condition. If a new grommet is supplied in the kit remove the original grommet and replace with the new one provided. If the kit does not include a new grommet ensure the original grommet remains fitted to the headlight bowl.

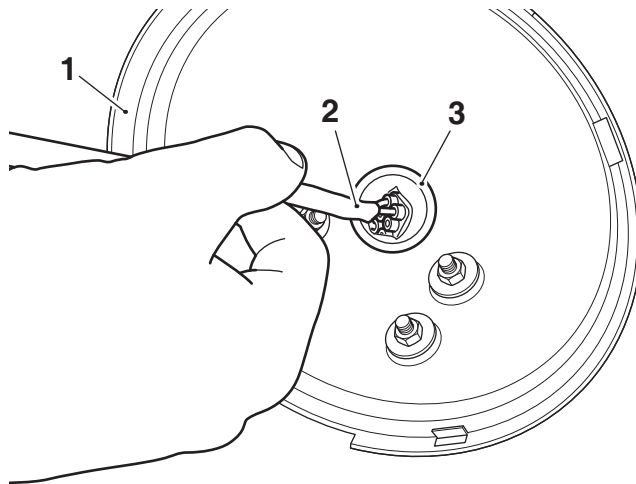

1. Headlight bowl
2. Headlight wiring harness
3. Grommet

Note:

- There are alternative headlight bowl fixings in service. Early models use fixings, washers and nuts, as shown below. Later models use M6 x 12 mm fixings and flanged nuts, as shown below. For early models follow steps 14 to 16, then continue from step 20. For later models continue from step 17.

Early Models

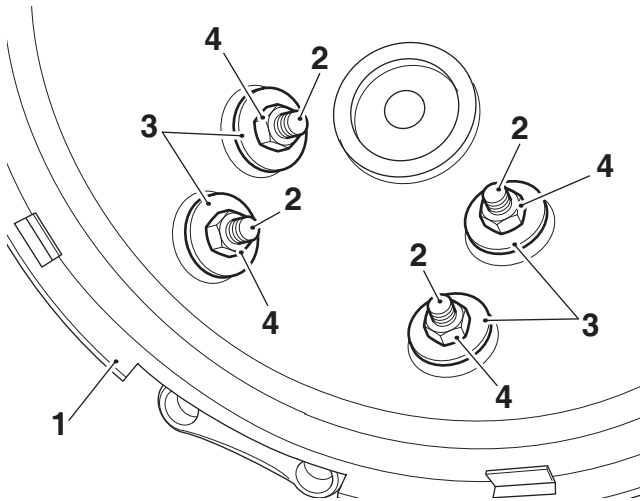

1. Headlight bowl
2. Fixings
3. Washers
4. Nuts

Later Models

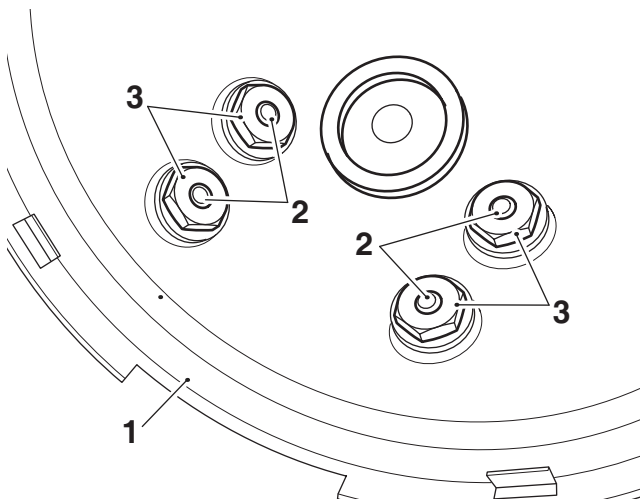

1. Headlight bowl
2. Fixings, M6 x 12 mm
3. Flanged nuts

Early Models Only

14. Remove all of the headlight bowl fixings. Discard the fixings, washers and nuts.

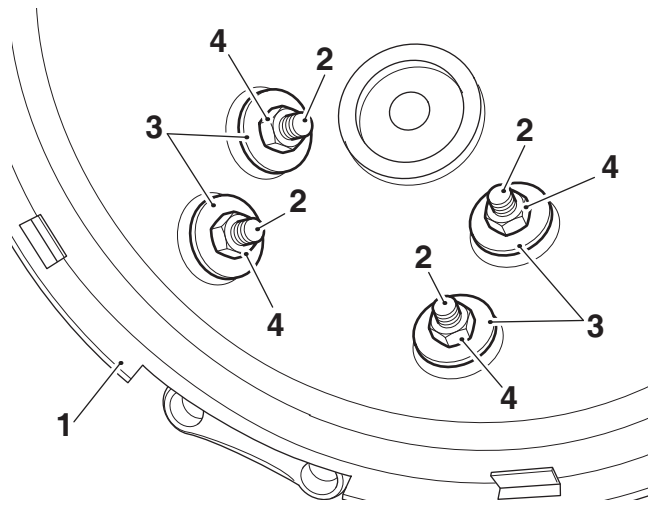

1. Headlight bowl
2. Fixings
3. Washers
4. Nuts

15. Remove the four original grommets from the headlight bowl and replace them with the grommets from the kit, as shown.

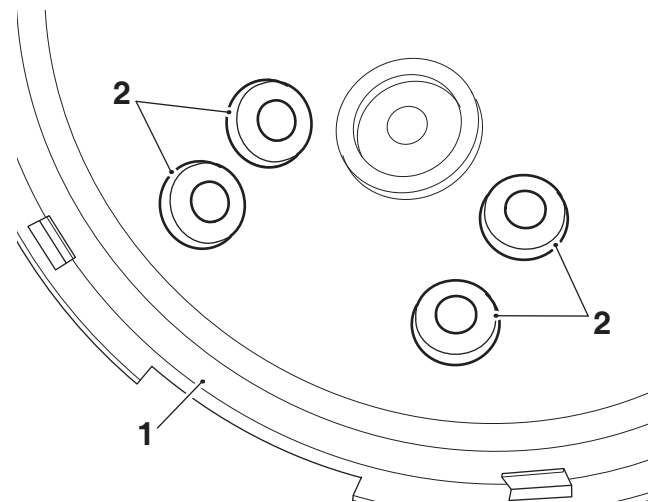

1. Headlight bowl
2. Grommets

16. Fit all of the flanged nuts from the kit in to the headlight bowl and secure using the M6 x 12 mm fixings from the kit. Tighten the fixings to **8 Nm**.

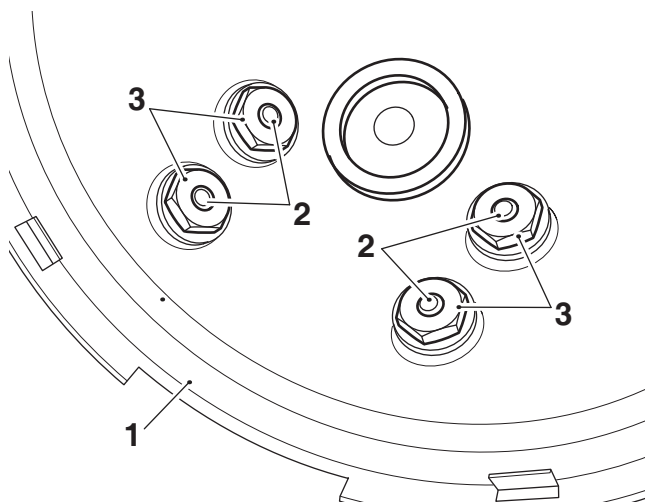

1. Headlight bowl
2. Fixings, M6 x 12 mm
3. Flanged nuts

Later Models Only

17. Remove the four headlight bowl fixings and discard the fixings. Remove the four flanged nuts and retain them for reuse.

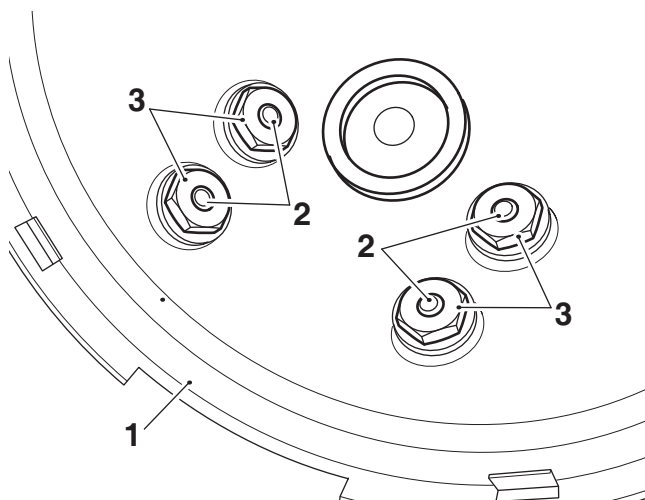

1. Headlight bowl
2. Fixings
3. Flanged nuts

18. Remove the four original grommets from the headlight bowl and replace them with the grommets from the kit, as shown.

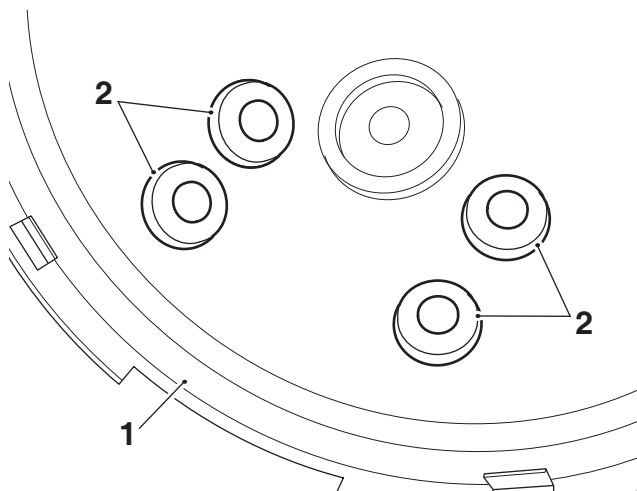

1. Headlight bowl
2. Grommets

19. Refit the original flanged nuts to the headlight bowl and secure using the M6 x 12 mm fixings from the kit. Tighten the fixings to **8 Nm**.

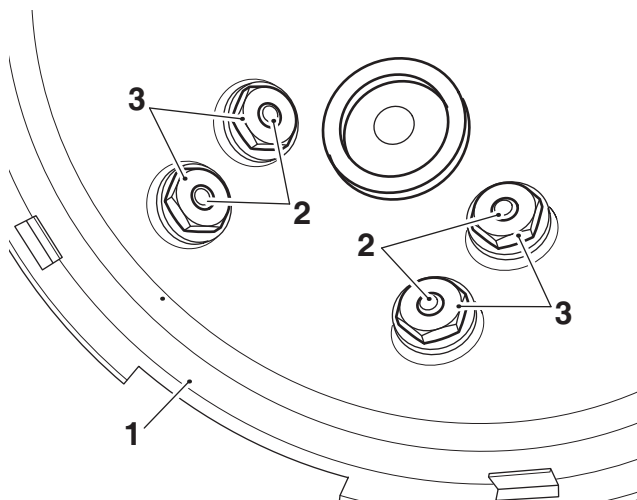

1. Headlight bowl
2. Fixings, M6 x 12 mm
3. Flanged nuts

All Models

20. Refit the original headlight support ring into the headlight bowl noting the orientation in step 9.
21. Collect the LED headlight from the kit.
22. Route the LED headlight wiring harness through the grommet in the rear of the headlight bowl as shown. Ensure the grommet is correctly located in the headlight bowl.

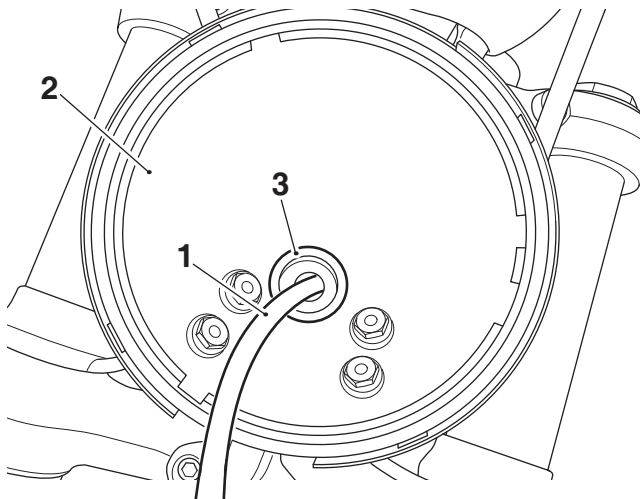

1. LED wiring harness
2. Headlight bowl
3. Grommet

23. Fit the LED headlight into the headlight bowl in the orientation shown.

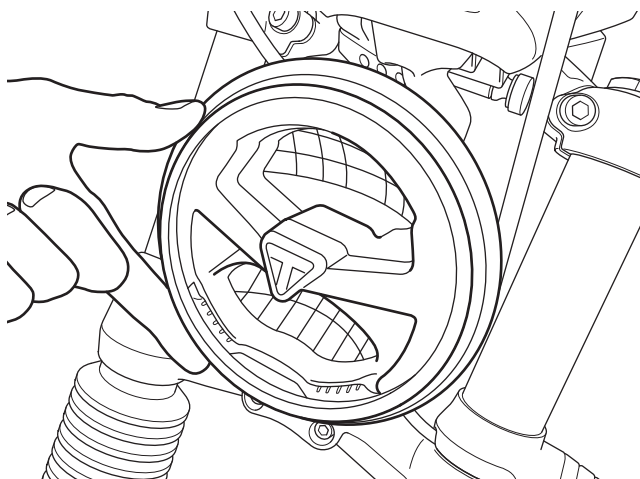

24. Refit the original headlight bezel and secure with the original fixing and nut. Tighten the fixing to **2 Nm**.

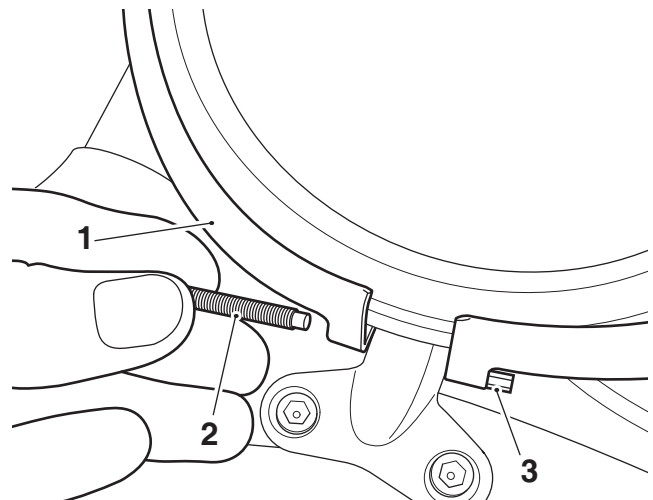

1. Headlight bezel
2. Fixing
3. Nut

25. Route the LED headlight wiring harness to the left hand side of the motorcycle following the routing of the left hand switch harness.
26. Connect the LED headlight wiring harness connector to the main wiring harness connector and ensure the wiring harness is positioned correctly in the cable moulding, as shown.

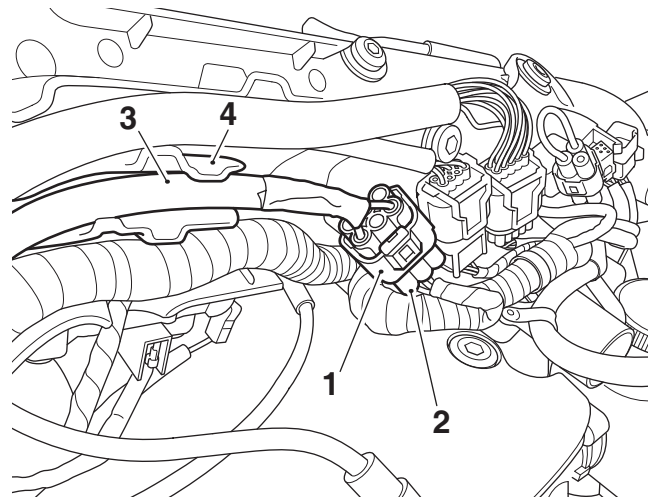

1. LED headlight wiring harness connector
2. Main wiring harness connector
3. LED wiring harness
4. Cable moulding

27. Refit the harness guide on the left hand side of the motorcycle ensuring the clutch cable is positioned at the bottom of the harness guide, as shown. Fit the M5 x 12 mm fixings provided in the kit. Tighten the fixings to **2.5 Nm**.

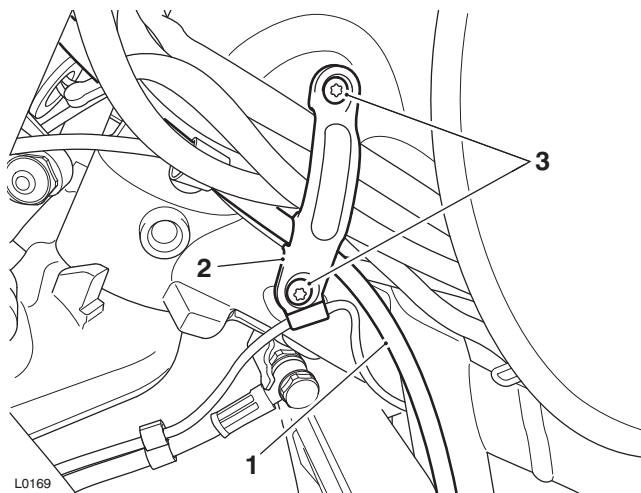

- 1. Clutch cable**
2. Harness guide
3. Fixing, M5 x 12 mm

28. Refit the snap on wiring harness cover ensuring the wiring harness does not trap any wiring harness. Ensure all seven cover retaining clips are fully engaged.

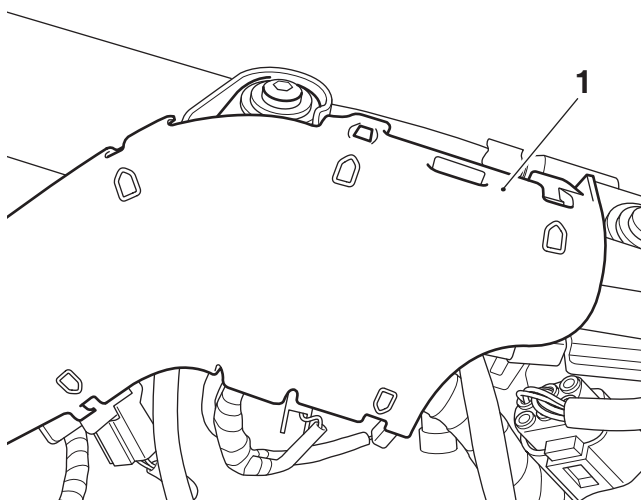

1. Wiring harness cover

29. Refit the fuel tank, as described in the Service Manual.
30. Reconnect the battery, positive (red) lead first and tighten the battery terminals to **4.5 Nm**.
31. Test the direction indicators, rear light, headlight and all other switch gear functions to confirm they function correctly.
32. Check the headlight alignment and adjust accordingly, as described in the Service Manual.

Warning

After fitting the accessory kit the motorcycle will exhibit new handling characteristics. Operate the motorcycle in a safe area free from traffic to gain familiarity with any new characteristics. Operation of the motorcycle when not familiar with any new handling characteristics may result in loss of motorcycle control and an accident.

Warning

Never ride an accessory equipped motorcycle (including those fitted with Triumph approved windscreens and luggage systems) at speeds above 80 mph (130 km/h).

The presence of accessories such as windscreens and luggage systems will cause changes in the stability and handling of the motorcycle. Failure to allow for changes in motorcycle stability may result in loss of motorcycle control and an accident.

Remember that the 80 mph (130 km/h) limit will be reduced by the fitting of non-approved accessories, incorrect loading, worn tyres, overall motorcycle condition and poor road or weather conditions.

Warning

This motorcycle must not be operated above the legal road speed limit except in authorised closed-course conditions.

Warning

Only operate this Triumph motorcycle at high speed in closed-course on road competition or on closed course racetracks. High speed operation should only be attempted by riders who have been instructed in the techniques necessary for high speed riding and are familiar with the motorcycle's characteristics in all conditions.

High speed operation in any other circumstances is dangerous and may result in loss of motorcycle control and an accident.