



## Accessory Fitting Instructions

Thank you for choosing this Triumph genuine accessory kit. This accessory kit is the product of Triumph's use of proven engineering, exhaustive testing, and continuous striving for superior reliability, safety and performance.

Completely read all of these instructions before commencing the installation of the accessory kit in order to become thoroughly familiar with the kit's features and the installation process.

These instructions should be considered a permanent part of your accessory kit, and should remain with it even if your accessory equipped motorcycle is subsequently sold.

USB Charger Kit	
Kit Number	Models
A9828058	Trident from VIN AC6898, Tiger Sport from VIN AU7774
A9828073	Daytona 660, Trident from VIN AC6898, Tiger Sport from VIN AU7774

### Parts supplied

#### A9828058

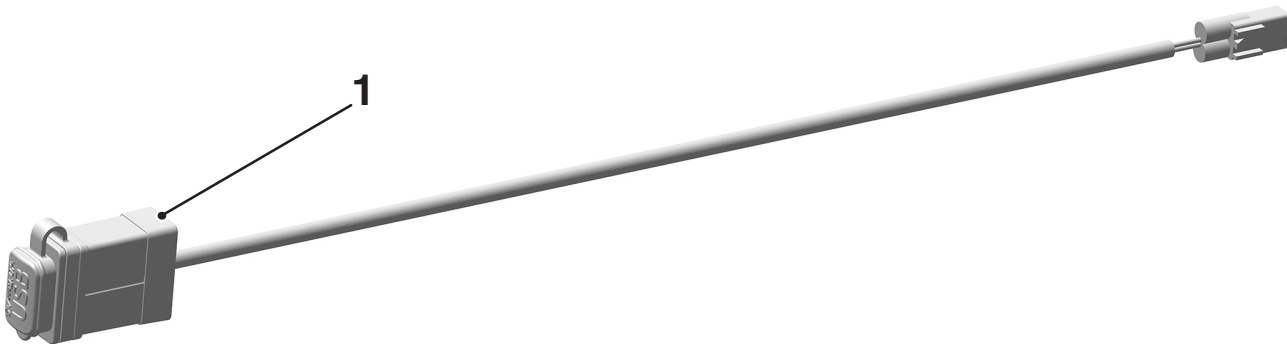

1. USB charger unit	1 off
---------------------	-------

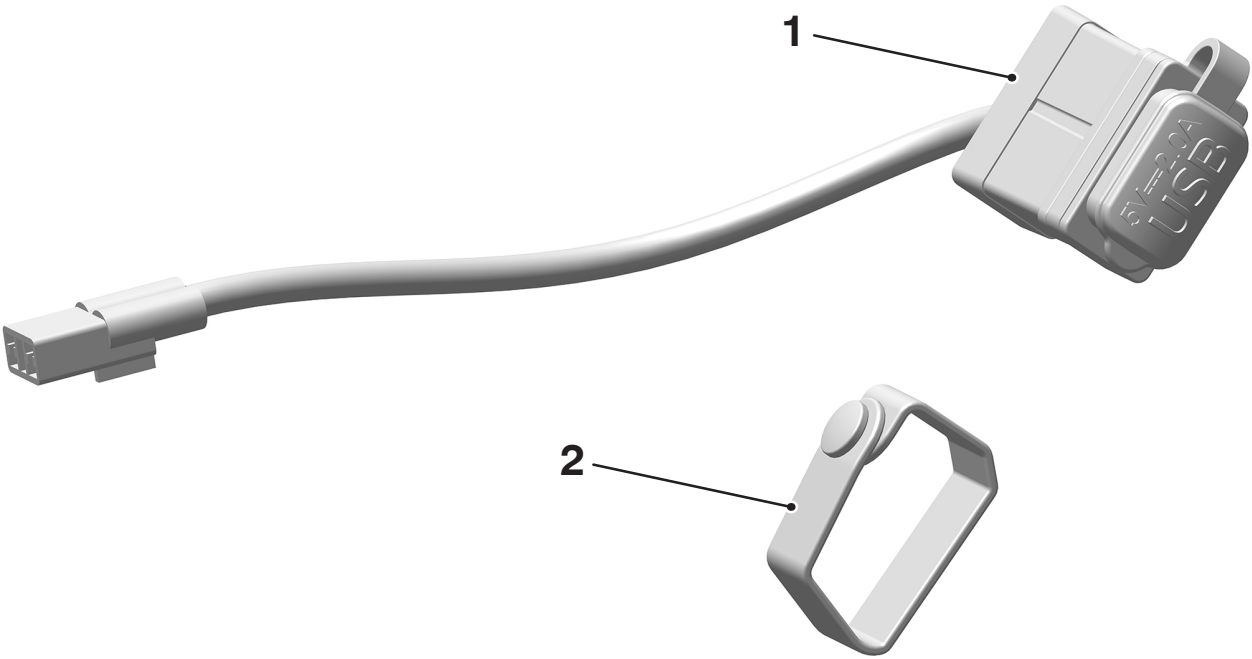

1. USB charger unit	1 off	2. Rubber strap	1 off
---------------------	-------	-----------------	-------

### **⚠ WARNING**

Fit only genuine Triumph accessories to those models approved by Triumph as listed in the associated Triumph fitting instructions.

The accessory kits covered in this instruction are designed for use on specific models of Triumph motorcycle. The accessory kits and the models applicable are listed at the start of the instruction. They should never be fitted to any other Triumph model or to any other manufacturer's motorcycle.

Fitting an accessory kit to a Triumph model not listed, or to any other manufacturer's motorcycle, will affect the performance, stability and handling of the motorcycle.

Failure to follow the advice above may lead to loss of motorcycle control which could result in serious injury or death.

### **⚠ WARNING**

Always have Triumph approved parts, accessories and conversions fitted by a competent person with the specialist knowledge and technical understanding of motorcycles, such as an authorised Triumph dealer.

The fitment of parts, accessories and conversions by a person without the specialist knowledge and technical understanding of motorcycles may affect the handling, stability or other aspects of the motorcycle's operation.

Failure to follow the advice above may lead to loss of motorcycle control which could result in serious injury or death.

### **⚠ WARNING**

A torque wrench of known accurate calibration must be used when fitting this accessory kit.

Failure to tighten any of the fasteners to the correct torque specification may affect motorcycle performance, handling and stability.

Failure to follow the advice above may lead to loss of motorcycle control which could result in serious injury or death.

### **⚠ WARNING**

Make sure the motorcycle is stabilised and adequately supported.

Do not support the motorcycle on any ancillary component, the exhaust system or any other non structural parts of the motorcycle frame.

A correctly supported motorcycle will help prevent it from falling.

An unstable motorcycle may fall resulting in motorcycle damage, serious injury or death.

### **NOTICE**

Triumph offers a broad range of approved genuine accessories for your motorcycle.

We cannot therefore cover all possible equipment variations in these instructions. For removal and installation of Triumph Genuine Accessories, always refer to the instructions supplied with the respective accessory kit.

To obtain additional copies of any Triumph accessory instructions, visit [www.triumphinstructions.com](http://www.triumphinstructions.com) or contact your authorised Triumph dealer.

1. Remove the seat as described in the Service Manual.
2. Disconnect the battery as described in the Service Manual.

#### **Daytona 660 Only**

3. Locate the USB main harness connector on the right hand side of the motorcycle under the ECU mounting bracket, as shown below (seat bridge omitted for clarity).
4. Remove the blanking plug and retain for reuse if the motorcycle is to be returned to its original condition.

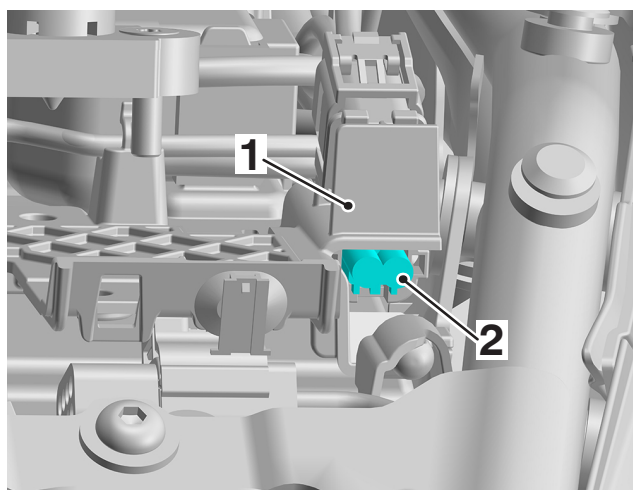

1. ECU mounting bracket
2. Blanking plug

5. Fit the rubber strap to the slots in the battery tray moulding under the rear bridge as shown below.

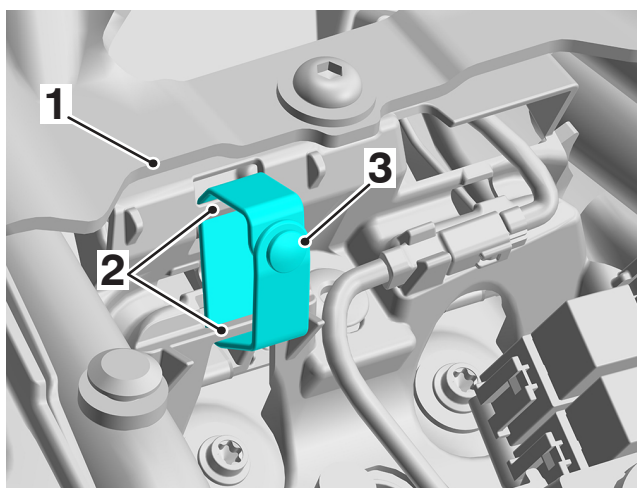

1. Rear bridge
2. Battery tray moulding slots
3. Rubber strap

6. Fit the USB charger to the battery tray using the rubber strap in the orientation shown below.

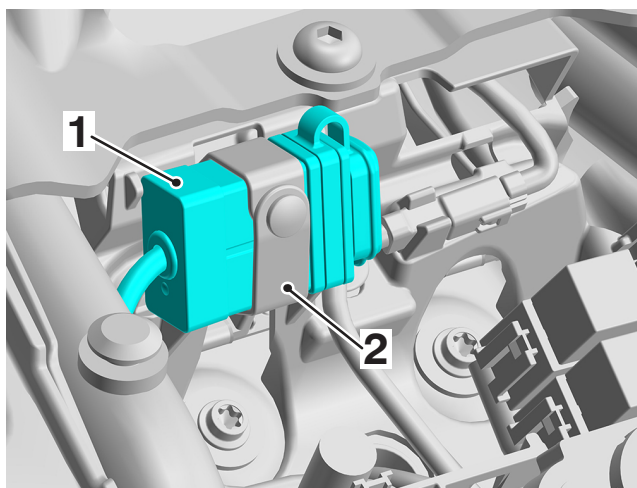

1. USB charger
2. Rubber strap

7. Route the USB charger harness as shown below and connect the USB charger harness connector to the main harness USB connector, as shown below (seat bridge omitted for clarity).

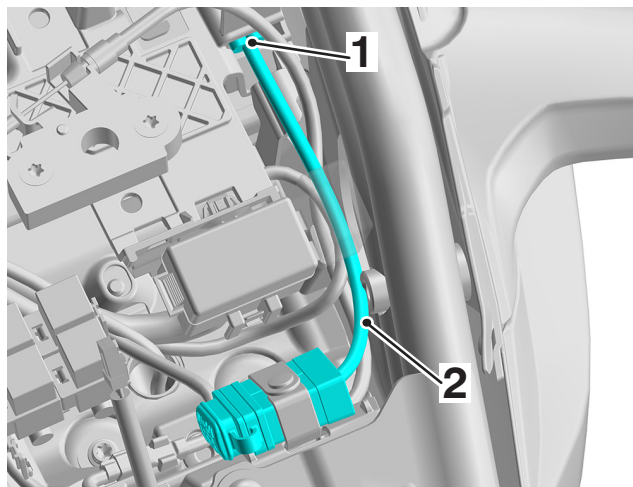

1. Main harness USB connector
2. USB charger harness

#### Trident Models from VIN AC6898 Only

8. Locate the USB main harness connector on the right hand side of the relay block and remove the blanking plug. Retain the blanking plug for reuse if the motorcycle is to be returned to its original condition.

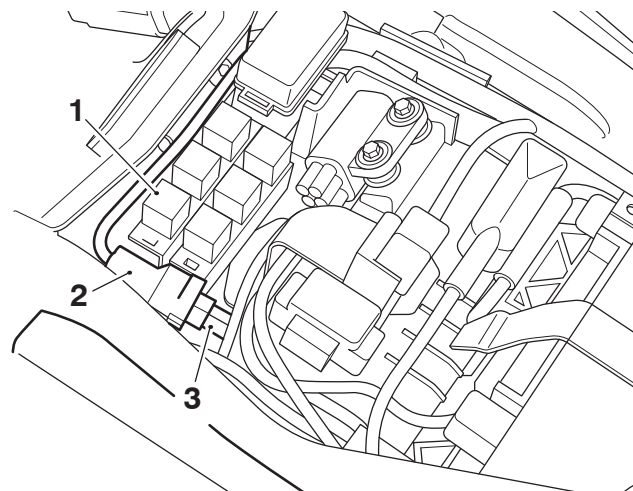

1. Relay block
2. USB main harness connector
3. Blanking plug

9. Locate the USB charger mounting which is integrated in to the battery strap.

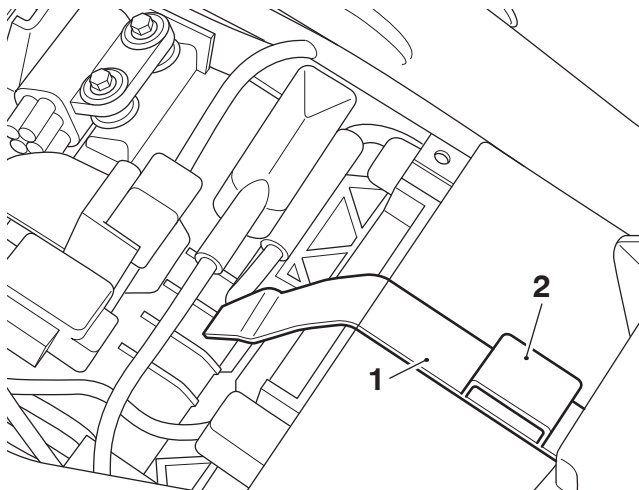

1. Battery strap  
2. USB charger mounting

10. Fit the USB charger in to the mounting in the battery strap in the orientation shown below.

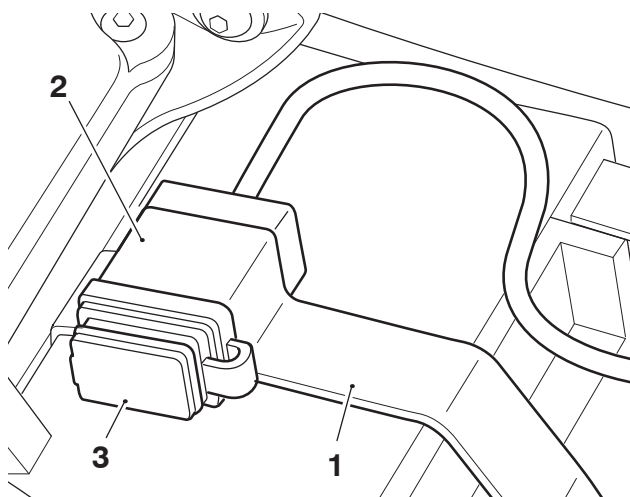

1. Battery strap  
2. USB charger mounting  
3. USB charger

11. Connect the USB charger harness connector to the main harness USB connector, and route the USB charger harness as shown below.

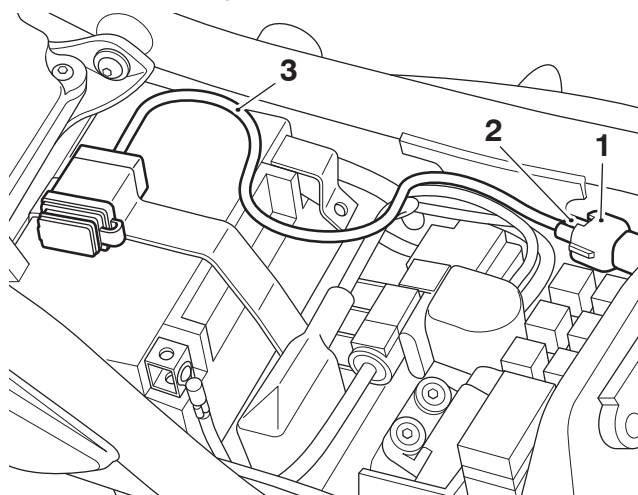

1. Main harness USB connector  
2. USB charger harness connector  
3. USB charger harness

**Tiger Sport Models from VIN AU7774 Only**

12. Remove the right hand side panel as described in the Service Manual. Retain the side panel and scrivet fixing for reuse.

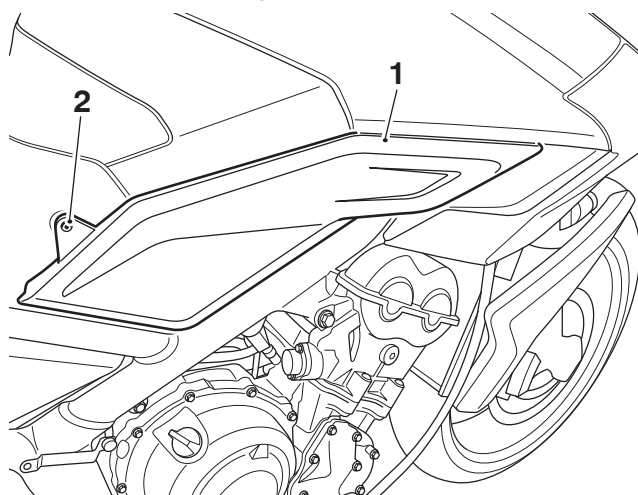

1. Side panel, right hand side  
2. Scrivet fixing

13. Locate the USB main harness connector secured to the main wiring harness with blue electrical tape, on the right hand side of the motorcycle. Remove the blue electrical tape to release the USB connector.

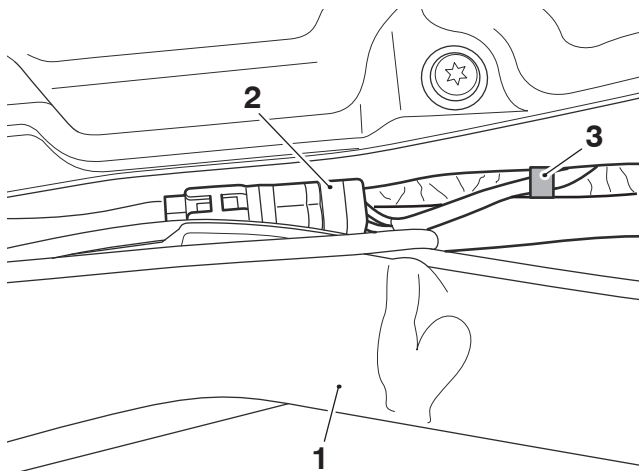

- 1. Motorcycle frame, right hand side
- 2. USB main harness connector
- 3. Blue electrical tape

14. Remove the blanking plug from the USB main wiring harness connector and retain for reuse if the motorcycle is to be returned to its original condition.

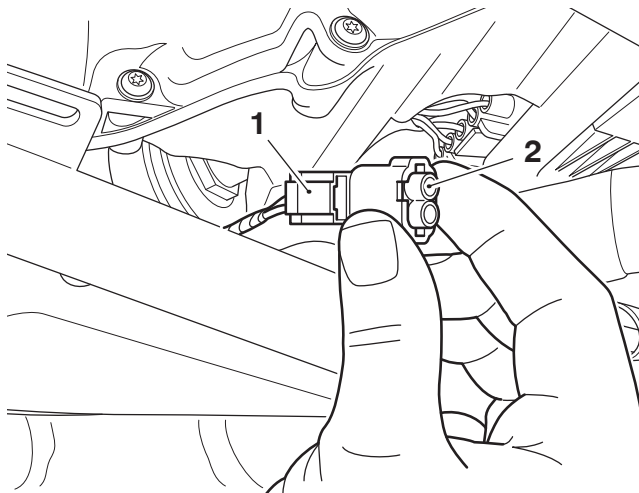

- 1. USB main harness connector
- 2. Blanking plug

15. Locate the USB charger mounting which is integrated in to the battery strap.

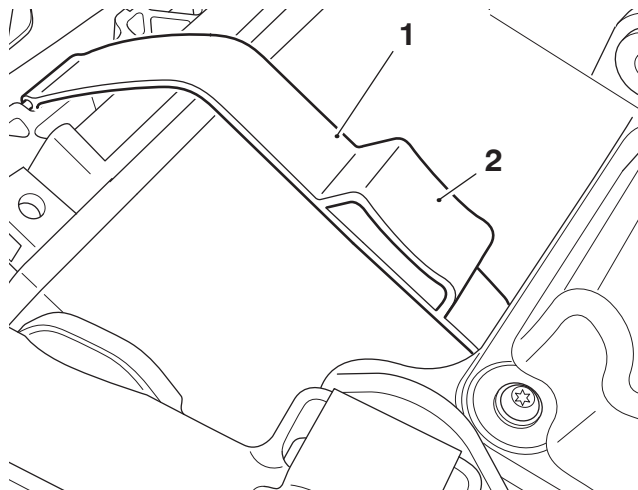

- 1. Battery strap
- 2. USB charger mounting

16. Fit the USB charger in to the mounting in the battery strap in the orientation shown below.

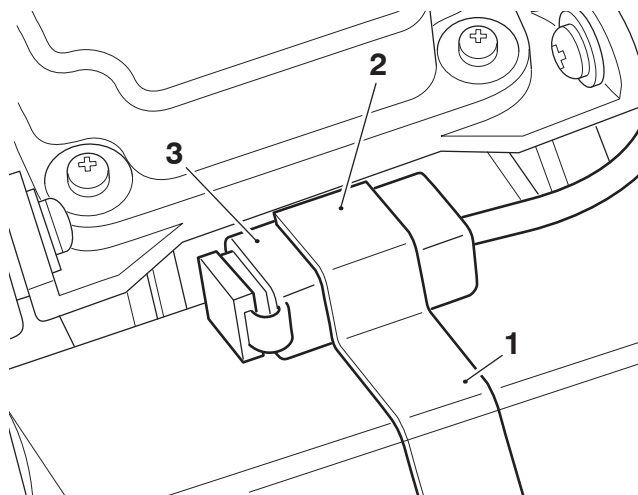

- 1. Battery strap
- 2. USB charger mounting
- 3. USB charger



17. Route the USB charger harness under the airbox mount on the right hand side of the motorcycle. Connect the USB charger harness connector to the USB main wiring harness connector charger harness as shown below.

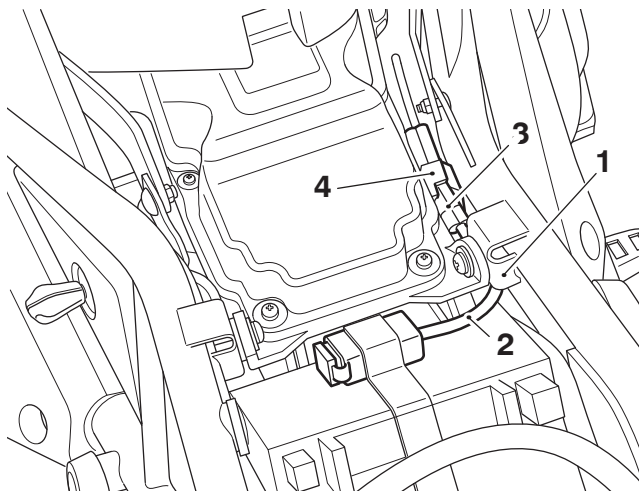

1. Airbox mount  
2. USB charger harness  
3. USB charger harness connector  
4. Main harness USB connector

18. Refit the right hand side panel with the original scrivet fixing as described in the Service Manual.

#### All Models

19. Reconnect the battery as described in the Service Manual.

#### NOTICE

A wiring harness which becomes trapped or kinked during installation, or motorcycle operation, may result in wiring harness damage and electrical malfunctions.

#### NOTICE

When refitting the seat make sure the USB charger harness is not trapped or pinched between the seat and any other part of the motorcycle.

20. Refit the seat as described in the Service Manual.

#### ⚠ WARNING

After fitting the accessory kit the motorcycle will exhibit new handling characteristics.

Operate the motorcycle in a safe area free from traffic to gain familiarity with any new characteristics.

Operation of the motorcycle when not familiar with any new handling characteristics may lead to loss of motorcycle control which could result in serious injury or death.

#### ⚠ WARNING

If, after fitting this accessory kit, you have any doubt about the performance of any aspect of the motorcycle, contact a competent person with the specialist knowledge and technical understanding of motorcycles, such as an authorised Triumph dealer.

Riding a motorcycle when there is any doubt as to any aspect of the performance of the motorcycle may lead to loss of motorcycle control which could result in serious injury or death.

#### ⚠ WARNING

Never ride an accessory-equipped motorcycle at speeds above 80 mph (130 km/h).

Remember that the 80 mph (130 km/h) limit will be reduced by the fitting of non-approved accessories, incorrect loading, worn tyres, overall motorcycle condition and poor road or weather conditions.

The presence of accessories will cause changes in the stability and handling of the motorcycle. Failure to allow for changes in motorcycle stability may lead to loss of motorcycle control which could result in serious injury or death.

#### ⚠ WARNING

High-speed operation should only be attempted by riders who have been instructed in the techniques necessary for high-speed riding and are familiar with the motorcycle's characteristics in all conditions.

Only operate this Triumph motorcycle at high speed in closed-course, on-road competition or on closed-course racetracks.

High-speed operation in any other circumstances is dangerous and may lead to loss of motorcycle control which could result in serious injury or death.

#### NOTICE

The motorcycle must not be operated above the legal road speed limit except in closed-course conditions.