



Accessory Fitting Instructions

Thank you for choosing this Triumph genuine accessory kit. This accessory kit is the product of Triumph's use of proven engineering, exhaustive testing, and continuous striving for superior reliability, safety and performance.

Completely read all of these instructions before commencing the installation of the accessory kit in order to become thoroughly familiar with the kit's features and the installation process.

These instructions should be considered a permanent part of your accessory kit, and should remain with it even if your accessory equipped motorcycle is subsequently sold.

Alarm Kit	
Kit Number	Models
A9800100	Daytona 660, Tiger Sport from VIN AU7774
Alarm Fitting Kit	
A9808148	Daytona 660, Tiger Sport from VIN AU7774

Parts supplied

A9800100

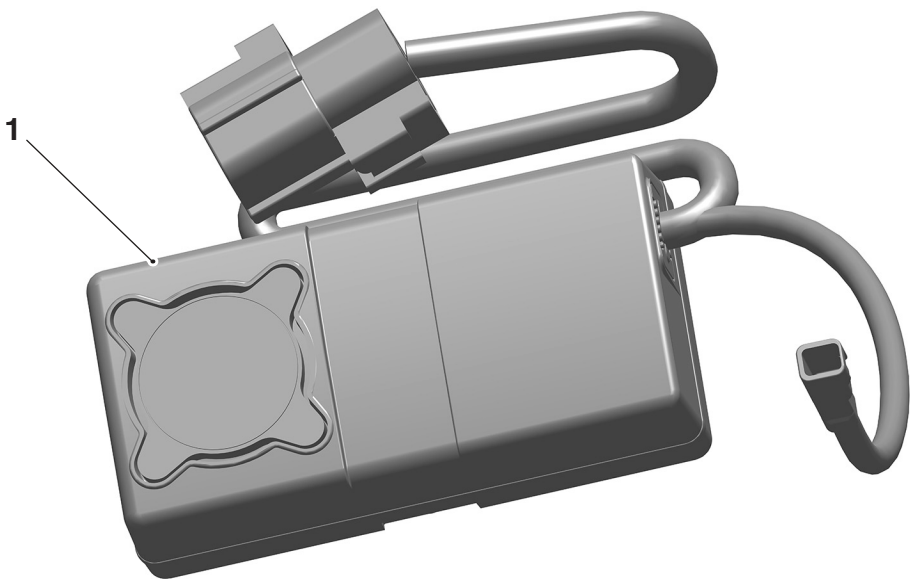

1. Alarm unit	1 off	3. Quick reference guide (not shown)	1 off
2. Key fob (not shown)	1 off		

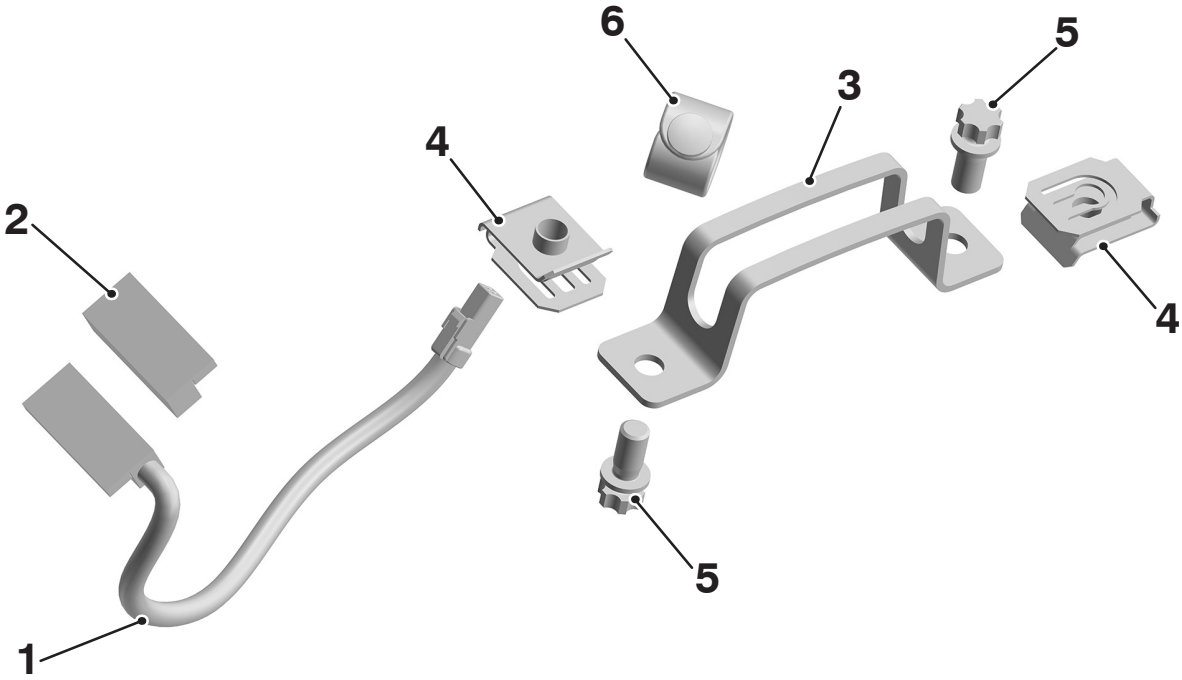

1. Reed-switch	1 off	5. Shear bolt	2 off
2. Reed-switch magnet	1 off	6. Rubber strap	1 off
3. Mounting bracket	1 off	7. Cleaning wipe (not shown)	1 off
4. Captive nut	2 off		

⚠ WARNING

Fit only genuine Triumph accessories to those models approved by Triumph as listed in the associated Triumph fitting instructions.

The accessory kits covered in this instruction are designed for use on specific models of Triumph motorcycle. The accessory kits and the models applicable are listed at the start of the instruction. They should never be fitted to any other Triumph model or to any other manufacturer's motorcycle.

Fitting an accessory kit to a Triumph model not listed, or to any other manufacturer's motorcycle, will affect the performance, stability and handling of the motorcycle.

Failure to follow the advice above may lead to loss of motorcycle control which could result in serious injury or death.

⚠ WARNING

Always have Triumph approved parts, accessories and conversions fitted by a competent person with the specialist knowledge and technical understanding of motorcycles, such as an authorised Triumph dealer.

The fitment of parts, accessories and conversions by a person without the specialist knowledge and technical understanding of motorcycles may affect the handling, stability or other aspects of the motorcycle's operation.

Failure to follow the advice above may lead to loss of motorcycle control which could result in serious injury or death.

⚠ WARNING

A torque wrench of known accurate calibration must be used when fitting this accessory kit.

Failure to tighten any of the fasteners to the correct torque specification may affect motorcycle performance, handling and stability.

Failure to follow the advice above may lead to loss of motorcycle control which could result in serious injury or death.

⚠ WARNING

Make sure the motorcycle is stabilised and adequately supported.

Do not support the motorcycle on any ancillary component, the exhaust system or any other non structural parts of the motorcycle frame.

A correctly supported motorcycle will help prevent it from falling.

An unstable motorcycle may fall resulting in motorcycle damage, serious injury or death.

NOTICE

Triumph offers a broad range of approved genuine accessories for your motorcycle.

We cannot therefore cover all possible equipment variations in these instructions. For removal and installation of Triumph Genuine Accessories, always refer to the instructions supplied with the respective accessory kit.

To obtain additional copies of any Triumph accessory instructions, visit www.triumphinstructions.com or contact your authorised Triumph dealer.

All Models

NOTICE

Prolonged storage of the machine with the alarm armed will result in battery drain.

Excessive battery drain will cause permanent damage to the battery.

The machine should be connected to an appropriate battery conditioner to maintain good battery condition.

NOTICE

Once the alarm unit has been fitted, it will become an integral part of the motorcycle and cannot be removed.

Prior to installation, record the serial number from the underside of the alarm unit on the alarm installation certificate.

NOTICE

An alarm user guide is available online. Please visit: www.triumphinstructions.com User Guide: A9800100

Completely read all of the instructions before commencing the installation and set up of the accessory kit in order to become thoroughly familiar with the kit's features and the installation process.

NOTICE

Power supply voltage range - 12 volt DC negative earth.

System current consumption <2.5 mA in armed condition.

NOTICE

The alarm unit is protected by fuse number 1 (10 Amp.) in the motorcycle fuse box.

1. Remove the seat as described in the Service Manual.

2. Disconnect and remove the battery as described in the Service Manual.

Fitment to Tiger Sport

1. Remove the rear lower fuel tank bodywork and side panels, as described in the Service Manual.
2. Remove the airbox, as described in the Service Manual.
3. Lift the small cover on the left hand side of the undertray moulding and fit the captive nuts from the kit to the undertray moulding in the orientation shown below.

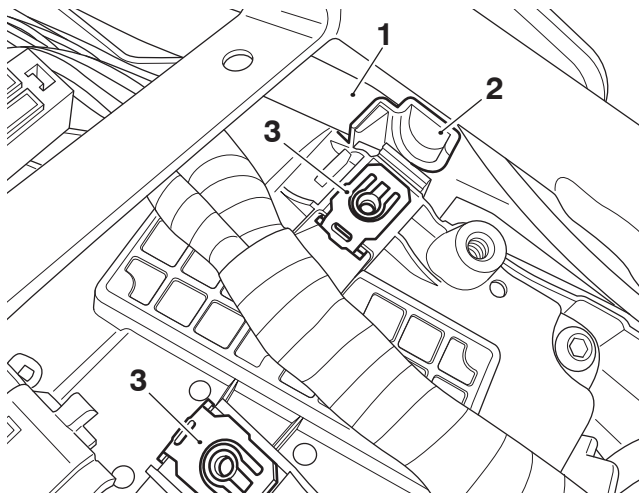

1. Undertray moulding
2. Cover
3. Captive nuts

4. Fit the alarm unit and mounting bracket into the undertray moulding with the alarm harness positioned towards the front of the motorcycle, as shown. Align the mounting bracket with the captive nuts and fit the shear bolts from the kit.

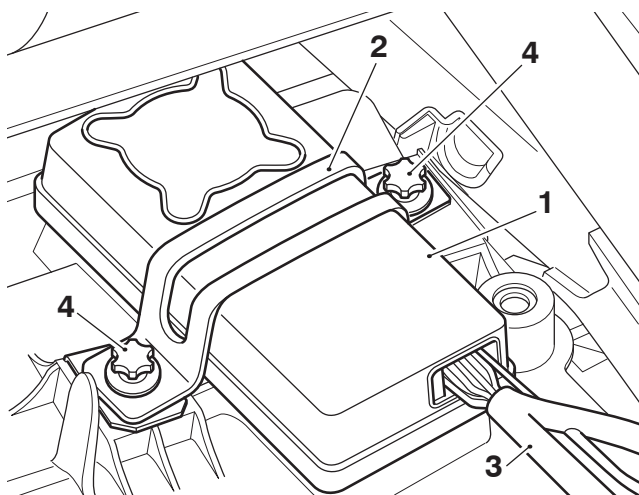

1. Alarm unit
2. Mounting bracket
3. Alarm unit harness
4. Shear bolts

5. Tighten the shear bolts to break.
6. Lower the small cover over the alarm bracket on the left hand side of the undertray moulding, as shown.

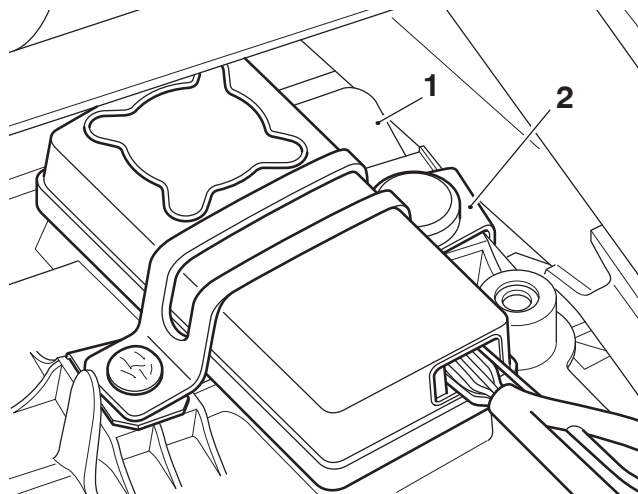

1. Undertray moulding
2. Cover

7. Locate the alarm connector on the main wiring harness which is attached to the underseat moulding at the left hand side of the motorcycle.

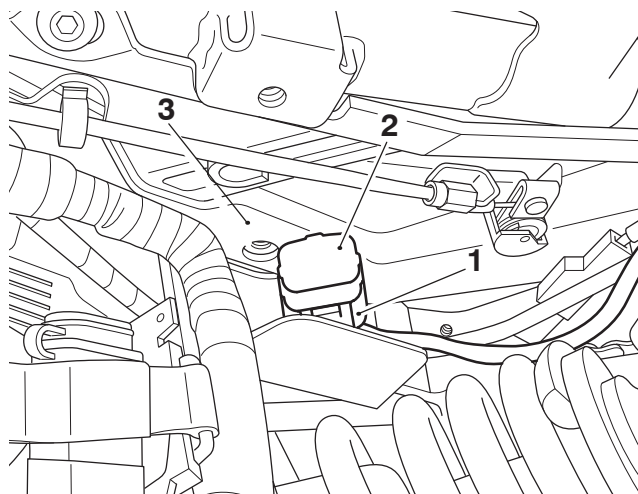

1. Alarm connector, main wiring harness
2. Blanking plug
3. Underseat moulding

8. Remove the blanking plug from the main wiring harness alarm connector. Retain the blanking plug for reuse if the motorcycle is to be returned to its original condition.

9. Route the alarm unit wiring harness along the main wiring harness on the left hand side of the motorcycle and connect the alarm unit wiring harness connector to the main wiring harness alarm connector.

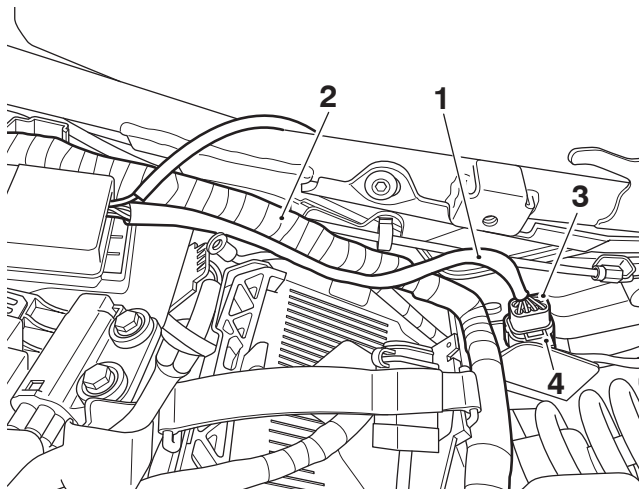

1. Alarm unit wiring harness
2. Main wiring harness
3. Alarm unit wiring harness connector
4. Main wiring harness alarm connector

10. Secure the alarm unit wiring harness to the main wiring harness with the rubber strap from the fitting kit.

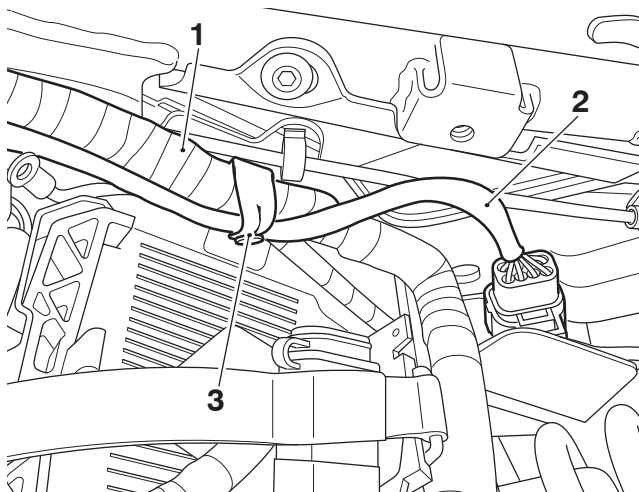

1. Main wiring harness
2. Alarm unit wiring harness
3. Rubber strap

Fitment of the Reed Switch

NOTICE

When fitting self-adhesive parts care must be taken to make sure positioning is correct and accurate.

Once the adhesive has been attached to the mounting surface, there is no satisfactory method of removal and re-positioning if incorrectly aligned.

Initial bonding is instant, full bonding is achieved after 72 hours.

NOTICE

Read the warning notices printed on the cleaning wipe packet in the fitting kit

NOTICE

The surface to which the reed switch is affixed must be clean and dry to make sure that the adhesive has a sound base to adhere to. Use the cleaning wipe supplied for this purpose.

11. Peel off the backing strip from the adhesive pad on the reed switch magnet.
12. Attach the reed switch to the motorcycle frame aligning it within the indentations in the motorcycle frame, in the orientation shown. Apply firm and even pressure to the reed switch to make sure a good bond is achieved.

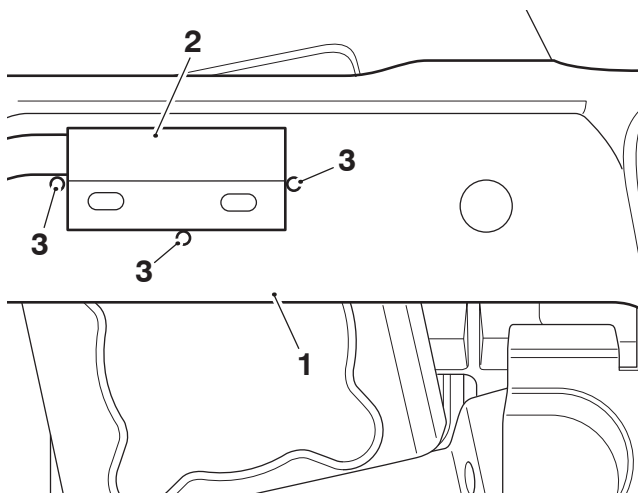

1. Motorcycle frame
2. Reed switch
3. Alignment indentations

13. Route the reed switch wiring harness under the relay clip towards the right hand side of the motorcycle. Route the alarm unit reed switch wiring harness under the solenoid block towards the reed switch harness connector, as shown.

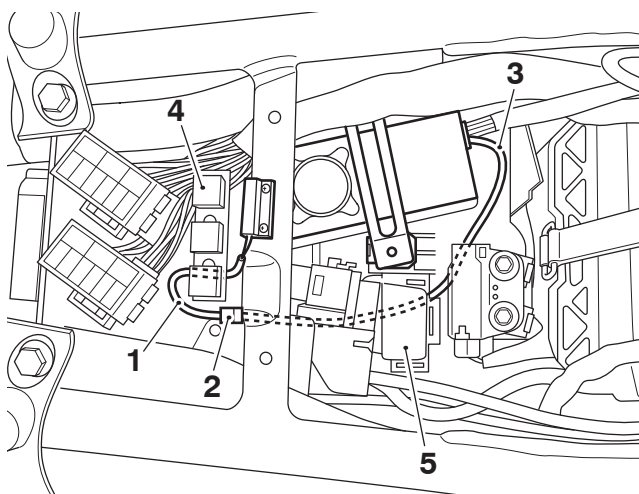

1. Reed switch wiring harness
2. Reed switch wiring harness connector
3. Alarm unit reed switch wiring harness
4. Relay clip
5. Solenoid block

14. Connect the reed switch wiring harness connector to the alarm unit wiring harness connector.

NOTICE

A wiring harness which becomes trapped or kinked during installation, or motorcycle operation, may result in wiring harness damage and electrical malfunctions.

15. Refit the airbox, as described in the Service Manual.
16. Refit the rear lower fuel tank bodywork and side panels with the original fixings, as described in the Service Manual.

Fitment of the Reed Switch Magnet

NOTICE

When fitting self-adhesive parts care must be taken to make sure positioning is correct and accurate.

Once the adhesive has been attached to the mounting surface, there is no satisfactory method of removal and re-positioning if incorrectly aligned.

Initial bonding is instant, full bonding is achieved after 72 hours.

NOTICE

Read the warning notices printed on the cleaning wipe packet in the fitting kit

NOTICE

The surface to which the reed switch is affixed must be clean and dry to make sure that the adhesive has a sound base to adhere to. Use the cleaning wipe supplied for this purpose.

17. Place the seat on a clean non-abrasive surface and locate the reed-switch magnet mounting area on the underside of the seat, as shown below.

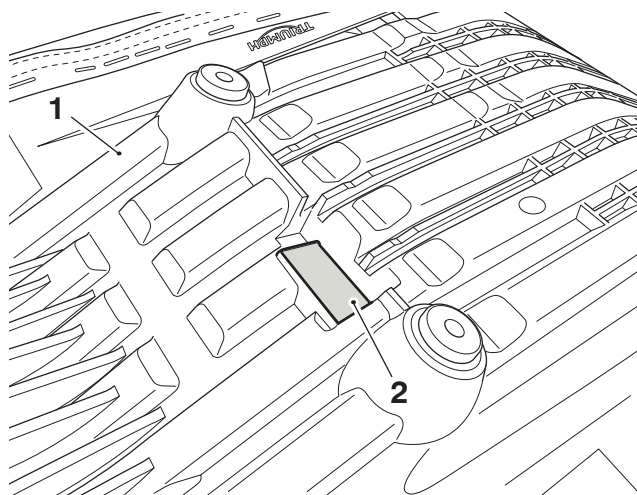

1. Seat base
2. Mounting area, reed switch magnet

18. Peel off the backing strip from the adhesive pad on the reed-switch magnet.
19. Align the reed-switch magnet on the underside of the seat, in the orientation shown. Apply firm and even pressure to the magnet to make sure a good bond is achieved.

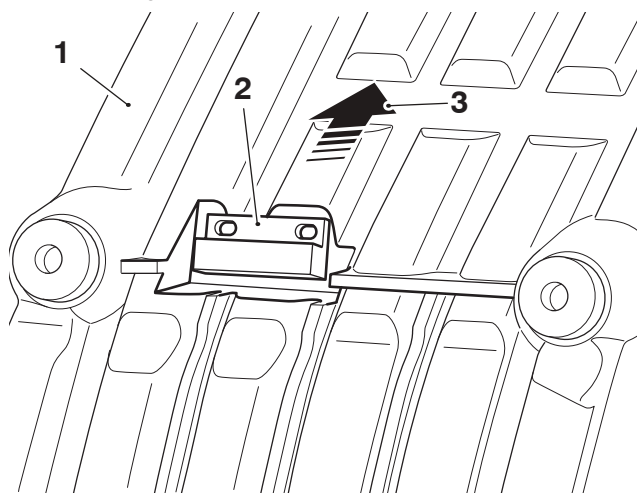

1. Seat base
2. Reed-switch magnet
3. Towards the front of the seat

20. Secure any excess alarm wiring harness with the rubber strap from the kit and stow under the engine ECM cover.
21. Refit and reconnect the battery as described in the Service Manual.
22. Refit the seat as described in the Service Manual and check all the functions of the alarm, as detailed in the user guide.

Fitment to Daytona 660

1. Remove the engine ECM cover as described in the Service Manual.
2. Collect the captive nuts from the kit and fit one to the engine ECM cover in the orientation shown below.

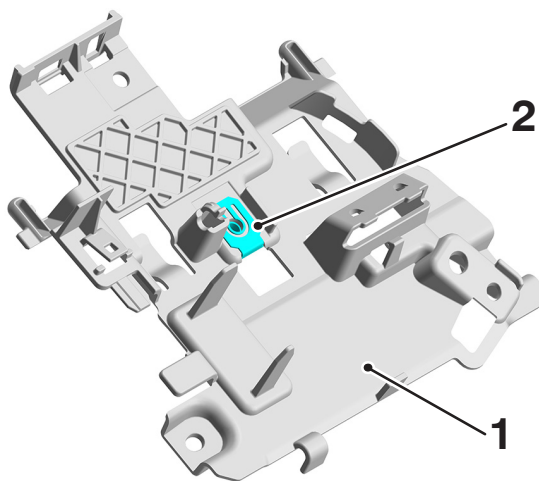

1. Engine ECM cover
2. Captive nuts

3. Fit the other captive nut to the mounting bracket in the orientation shown below.

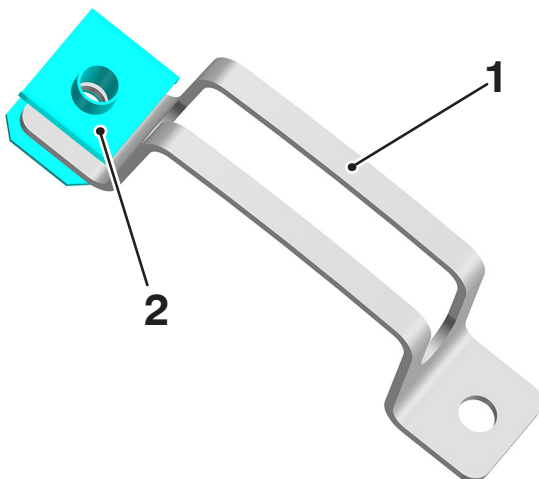

1. Engine ECM cover
2. Captive nuts

4. Place the alarm unit and mounting bracket from the kit into the engine ECM cover with the tracker unit in the orientation shown.

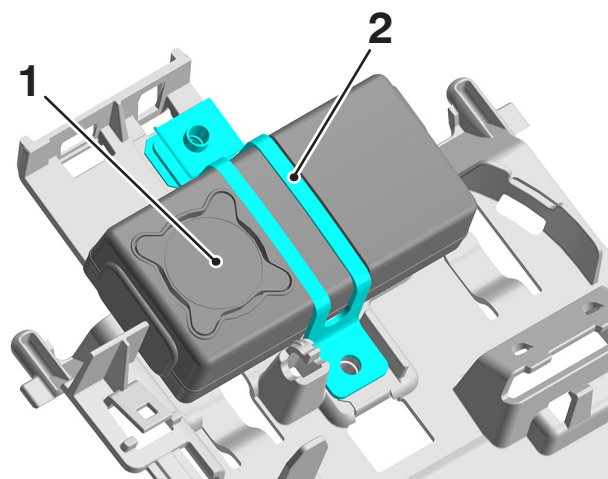

1. Tracker unit
2. Mounting bracket

5. Fit the shear bolts from the kit as shown below and tighten to break.

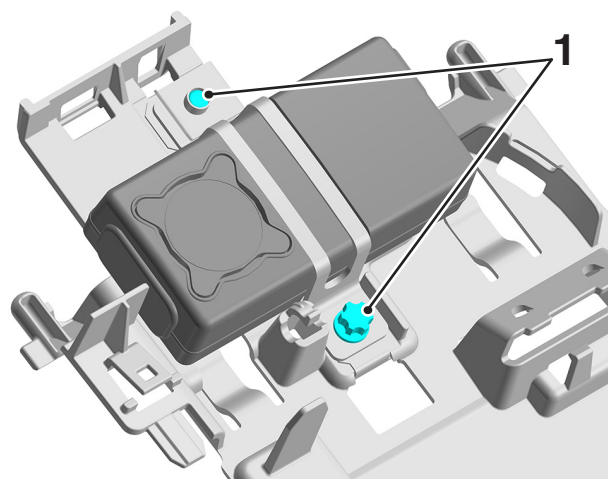

1. Shear bolts

6. Refit the engine ECM cover as described in the Service Manual. Do not reattach the fusebox at this stage.

7. Locate the main harness connector under the engine ECM cover, and remove the blanking plug. Retain the blanking plug for reuse if the motorcycle is to be returned to its original condition.

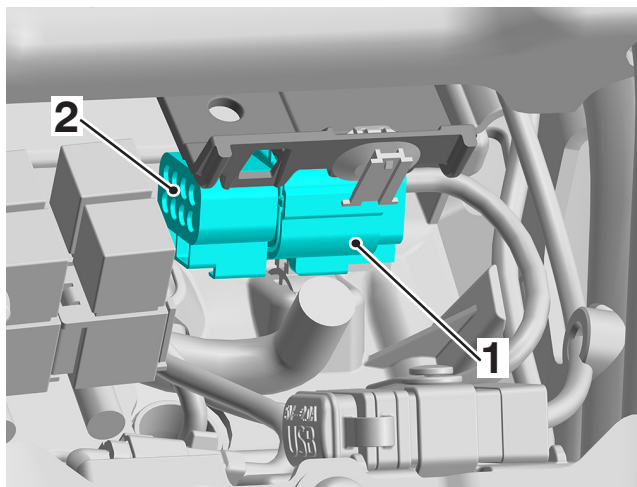

1. Main wiring harness connector
2. Blanking plug

8. Connect the alarm harness connector to the to the main wiring harness connector.

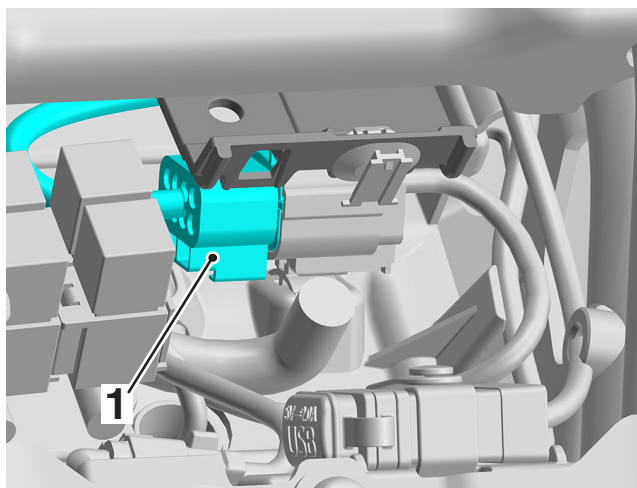

1. Alarm wiring harness

9. Reattach the fuse box to the engine ECM cover.

Fitment of the Reed Switch Magnet

NOTICE

When fitting self-adhesive parts care must be taken to make sure positioning is correct and accurate.

Once the adhesive has been attached to the mounting surface, there is no satisfactory method of removal and re-positioning if incorrectly aligned.

Initial bonding is instant, full bonding is achieved after 72 hours.

NOTICE

Read the warning notices printed on the cleaning wipe packet in the fitting kit

NOTICE

The surface to which the reed switch magnet is affixed must be clean and dry to make sure that the adhesive has a sound base to adhere to.

Use the cleaning wipe supplied for this purpose.

10. Place the seat on a clean non-abrasive surface and locate the reed-switch magnet mounting area on the underside of the seat.
11. Peel off the backing strip from the adhesive pad on the reed-switch magnet.
12. Align the reed-switch magnet on the underside of the seat, in the orientation shown. Apply firm and even pressure to the magnet to make sure a good bond is achieved.

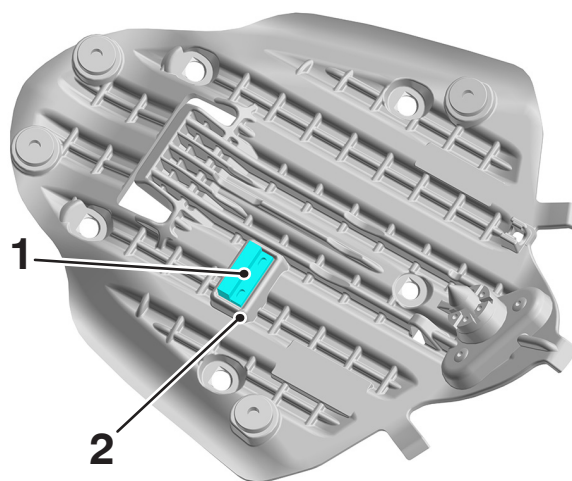

1. Reed-switch magnet
2. Mounting area

Fitment of the Reed Switch

13. Peel off the backing strip from the adhesive pad on the reed-switch.

14. Align the reed switch on the underside of the battery tray moulding in the orientation shown. Apply firm and even pressure to make sure a good bond is achieved

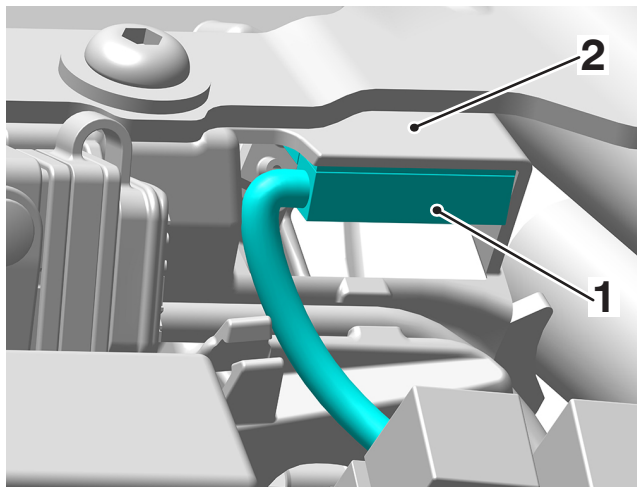

1. Reed switch
2. Motorcycle frame

15. Route the reed switch cable around the relay block and connect to the alarm unit connector (battery tray moulding omitted for clarity).

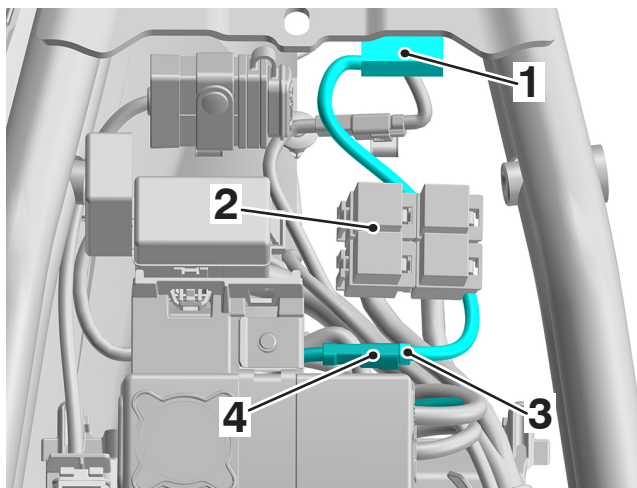

1. Reed switch
2. Relay block
3. Reed switch connector
4. Alarm unit connector

NOTICE

A wiring harness which becomes trapped or kinked during installation, or motorcycle operation, may result in wiring harness damage and electrical malfunctions.

16. Secure the alarm connector and any excess alarm wiring harness with the rubber strap from the kit and stow under the engine ECM cover.
17. Refit and reconnect the battery as described in the Service Manual.
18. Refit the seat as described in the Service Manual and check all the functions of the alarm, as detailed in the user guide.

All Models

Post Installation Checks

Check all the functions of the alarm as described in the User Guide. The Triumph Protect+ User Guide is available online at www.triumphinstructions.com using reference A9800100.

The checks and adjustments will reduce the possibility of false alarm activation.

Installation Certificate

The installation certificate is issued by the Triumph dealer. Dealer to visit: www.TriumphProtectPlus.com

The dealer should click the link to 'Apply for Dealer Access' the first time visiting the website.

The installation certificate will be emailed to the customer. The certificate must be retained by the customer as proof of alarm fitment.

⚠ WARNING

After fitting the accessory kit the motorcycle will exhibit new handling characteristics.

Operate the motorcycle in a safe area free from traffic to gain familiarity with any new characteristics.

Operation of the motorcycle when not familiar with any new handling characteristics may lead to loss of motorcycle control which could result in serious injury or death.

⚠ WARNING

If, after fitting this accessory kit, you have any doubt about the performance of any aspect of the motorcycle, contact a competent person with the specialist knowledge and technical understanding of motorcycles, such as an authorised Triumph dealer.

Riding a motorcycle when there is any doubt as to any aspect of the performance of the motorcycle may lead to loss of motorcycle control which could result in serious injury or death.

⚠ WARNING

Never ride an accessory-equipped motorcycle at speeds above 80 mph (130 km/h).

Remember that the 80 mph (130 km/h) limit will be reduced by the fitting of non-approved accessories, incorrect loading, worn tyres, overall motorcycle condition and poor road or weather conditions.

The presence of accessories will cause changes in the stability and handling of the motorcycle. Failure to allow for changes in motorcycle stability may lead to loss of motorcycle control which could result in serious injury or death.

⚠ WARNING

High-speed operation should only be attempted by riders who have been instructed in the techniques necessary for high-speed riding and are familiar with the motorcycle's characteristics in all conditions.

Only operate this Triumph motorcycle at high speed in closed-course, on-road competition or on closed-course racetracks.

High-speed operation in any other circumstances is dangerous and may lead to loss of motorcycle control which could result in serious injury or death.

NOTICE

The motorcycle must not be operated above the legal road speed limit except in closed-course conditions.