



Accessory Fitting Instructions

Thank you for choosing this Triumph genuine accessory kit. This accessory kit is the product of Triumph's use of proven engineering, exhaustive testing, and continuous striving for superior reliability, safety and performance.

Completely read all of these instructions before commencing the installation of the accessory kit in order to become thoroughly familiar with the kit's features and the installation process.

These instructions should be considered a permanent part of your accessory kit, and should remain with it even if your accessory equipped motorcycle is subsequently sold.

Alarm Kit	
Kit Number	Models
A9800100	Scrambler 1200 XC from VIN AE9098, Scrambler 1200 XE from VIN AC8499
To be used with the alarm fitting kits listed below.	
Alarm Fitting Kit	
A9800172	Scrambler 1200 XC from VIN AE9098, Scrambler 1200 XE from VIN AC8499 to VIN BN8495
A9800175	Scrambler 1200 XE from VIN BP0885, Scrambler 1200 X

Parts Supplied: A9800100

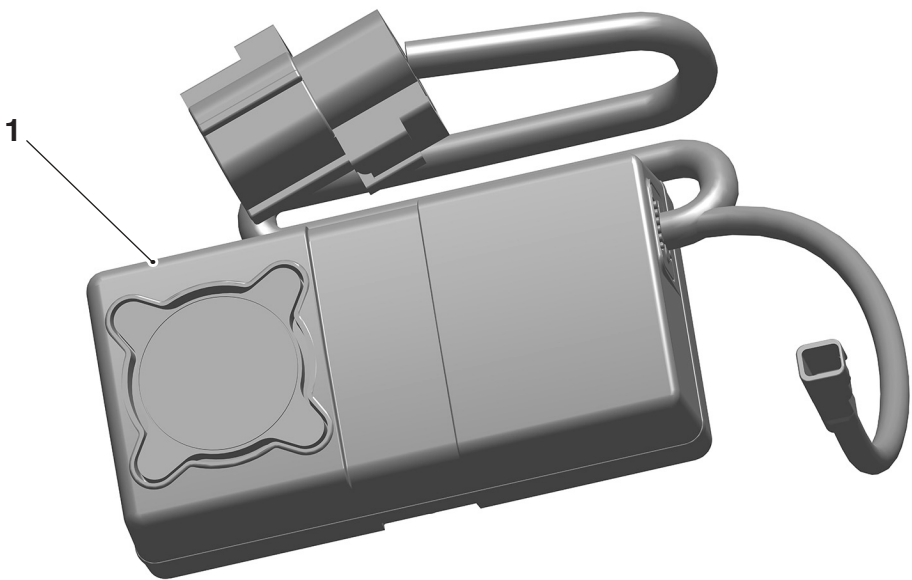

1. Alarm unit	1 off	3. Quick reference guide (not shown)	1 off
2. Key fob (not shown)	1 off		

Parts Supplied: A9800172

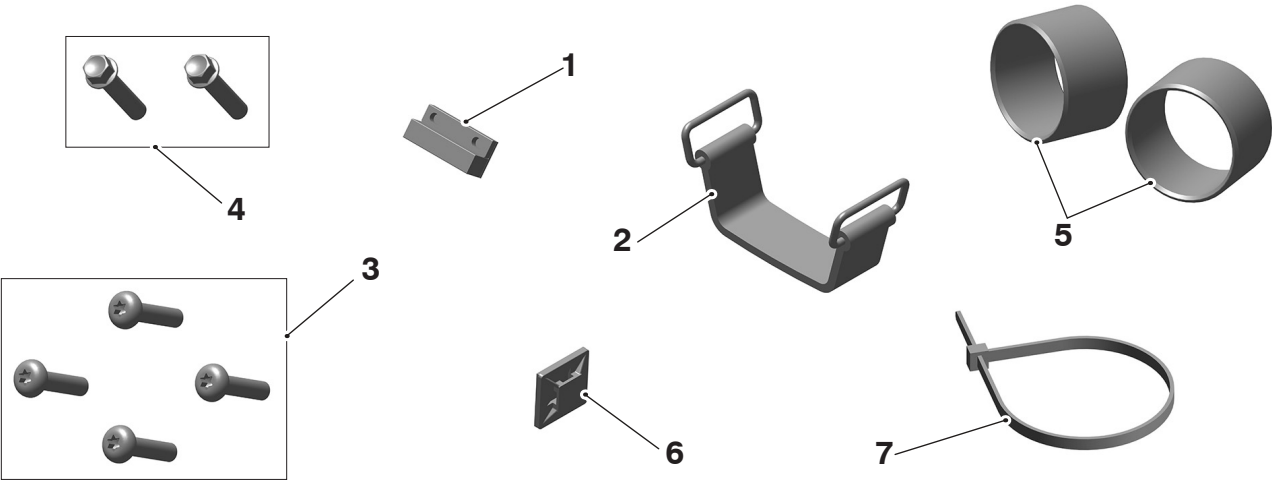

1. Reed-switch magnet	1 off	5. Exhaust gasket	2 off
2. Rubber strap	1 off	6. Cable tie holder	1 off
3. Fixing, M6 x 25 mm	4 off	7. Cable tie	1 off
4. Fixing, M6 x 28 mm	2 off	8. Cleaning wipe (not shown)	1 off

Parts Supplied: A9800175

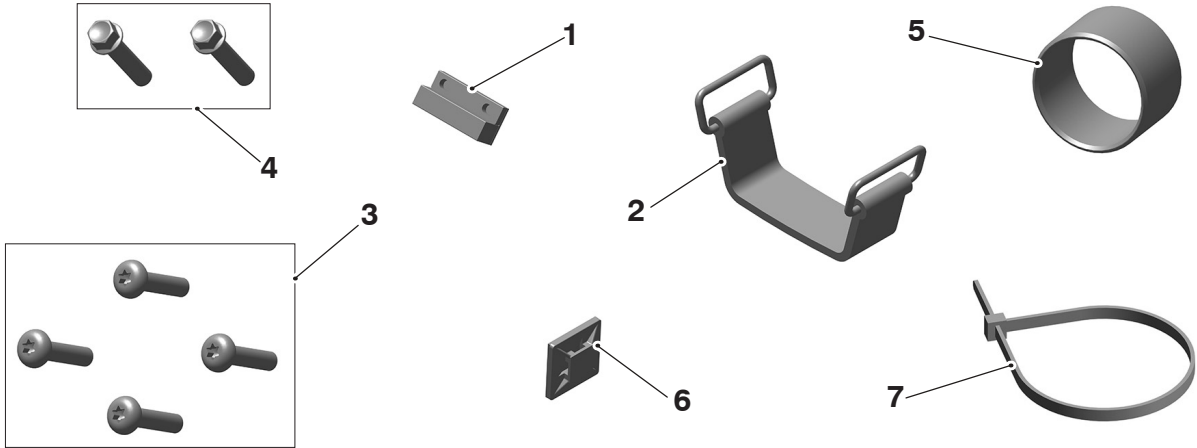

1. Reed-switch magnet	1 off	5. Exhaust gasket	1 off
2. Rubber strap	1 off	6. Cable tie holder	1 off
3. Fixing, M6 x 25 mm	4 off	7. Cable tie	1 off
4. Fixing, M6 x 28 mm	2 off	8. Cleaning wipe (not shown)	1 off

⚠ WARNING

Fit only genuine Triumph accessories to those models approved by Triumph as listed in the associated Triumph fitting instructions.

The accessory kits covered in this instruction are designed for use on specific models of Triumph motorcycle. The accessory kits and the models applicable are listed at the start of the instruction. They should never be fitted to any other Triumph model or to any other manufacturer's motorcycle.

Fitting an accessory kit to a Triumph model not listed, or to any other manufacturer's motorcycle, will affect the performance, stability and handling of the motorcycle.

Failure to follow the advice above may lead to loss of motorcycle control which could result in serious injury or death.

⚠ WARNING

Always have Triumph approved parts, accessories and conversions fitted by a competent person with the specialist knowledge and technical understanding of motorcycles, such as an authorised Triumph dealer.

The fitment of parts, accessories and conversions by a person without the specialist knowledge and technical understanding of motorcycles may affect the handling, stability or other aspects of the motorcycle's operation.

Failure to follow the advice above may lead to loss of motorcycle control which could result in serious injury or death.

⚠ WARNING

A torque wrench of known accurate calibration must be used when fitting this accessory kit.

Failure to tighten any of the fasteners to the correct torque specification may affect motorcycle performance, handling and stability.

Failure to follow the advice above may lead to loss of motorcycle control which could result in serious injury or death.

⚠ WARNING

Make sure the motorcycle is stabilised and adequately supported.

Do not support the motorcycle on any ancillary component, the exhaust system or any other non structural parts of the motorcycle frame.

A correctly supported motorcycle will help prevent it from falling.

An unstable motorcycle may fall resulting in motorcycle damage, serious injury or death.

NOTICE

Triumph offers a broad range of approved genuine accessories for your motorcycle.

We cannot therefore cover all possible equipment variations in these instructions. For removal and installation of Triumph Genuine Accessories, always refer to the instructions supplied with the respective accessory kit.

To obtain additional copies of any Triumph accessory instructions, visit www.triumphinstructions.com or contact your authorised Triumph dealer.

⚠ WARNING

Prolonged storage of the machine with the alarm armed will result in battery drain.

Excessive battery drain will cause permanent damage to the battery.

The machine should be connected to an appropriate battery conditioner to maintain good battery condition.

NOTICE

Power supply voltage range - 12 volt DC negative earth.

NOTICE

System current consumption <2.5 mA in armed condition.

NOTICE

Once the alarm unit has been fitted, it will become an integral part of the motorcycle and cannot be removed.

NOTICE

Completely read all of the instructions before commencing the installation and set up of the accessory kit in order to become thoroughly familiar with the kit's features and the installation process.

NOTICE

Prior to installation, record the serial number from the underside of the alarm unit on the alarm installation certificate.

1. Remove the seat, as described in the Service Manual.
2. Remove the seat underseat moulding, as described in the Service Manual.
3. Disconnect and remove the battery, as described in the Service Manual.

4. Remove the rear mudguard assembly, as described in the Service Manual.
5. Remove the silencer, as described in the Service Manual, and discard gaskets.
6. Remove the left hand and right hand side panels, as described in the Service Manual.
7. Lower the mudguard tray.

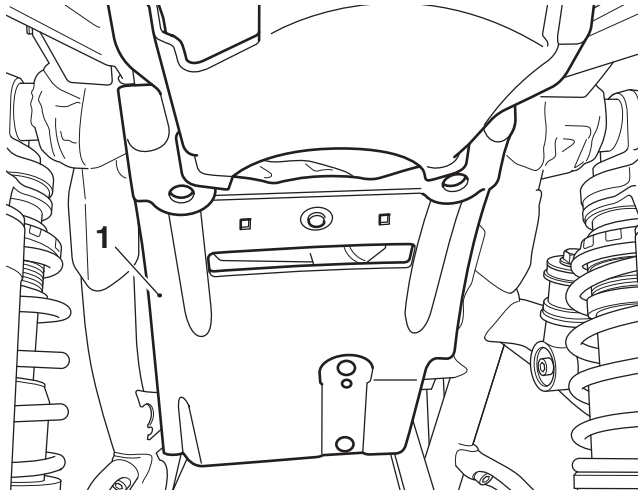

1. Mudguard tray

8. Remove the cable tie retaining the main wiring harness eight way alarm connector to the mudguard tray.
9. Disengage the front of the mudguard tray from the grommets on the motorcycle frame.

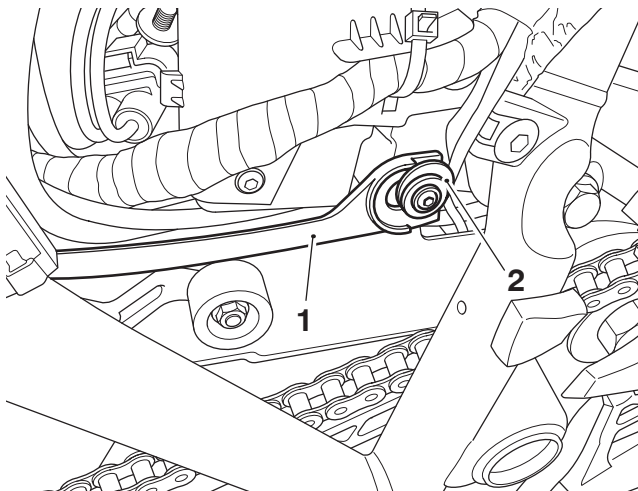

1. Mudguard tray, right hand side shown
2. Grommet, right hand side shown

⚠ WARNING

When cutting cable ties, always use the correct tools and personal protection equipment. Failure to use these may result in personal injury.

10. Release the locking tabs and disconnect both electrical connectors from the regulator/rectifier. Remove the mudguard tray.

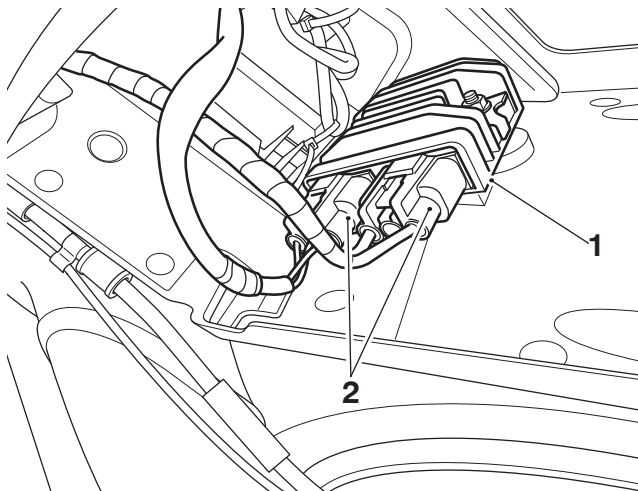

1. Rectifier
2. Main wiring harness connections

11. Locate the eight way alarm connector on the main wiring harness which is situated on the right hand side of the mudguard tray.
12. Remove the blanking plug.

Alarm Unit Fitment

⚠ CAUTION

When fitting self-adhesive parts care must be taken to make sure positioning is correct and accurate.

Once the adhesive has been attached to the mounting surface, there is no satisfactory method of removal and re-positioning if incorrectly aligned.

Initial bonding is instant, full bonding is achieved after 72 hours.

NOTICE

Read the warning notices printed on the cleaning wipe packet in the fitting kit

13. Using the cleaning wipe clean the area of the mudguard tray, as shown below.

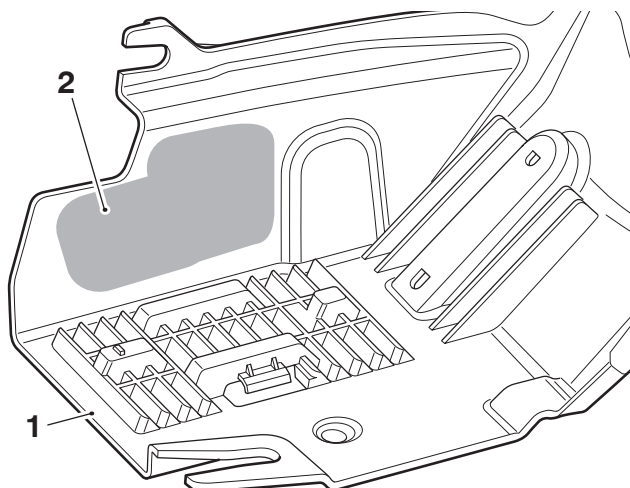

1. Mudguard tray
2. Cleaning area

14. Peel off the backing strip from the adhesive pad on the cable tie holder.
15. Attach the cable tie holder to the mudguard tray in the position and orientation shown below. Apply firm and even pressure to the cable tie holder to make sure a good bond is achieved.

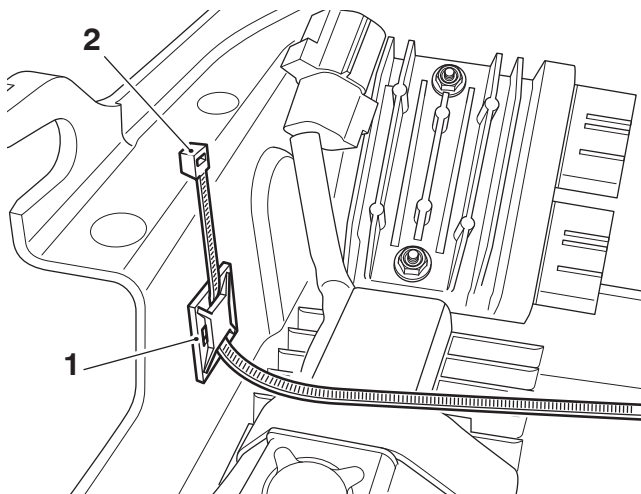

1. Mudguard tray
2. Cable tie holder

16. Place the alarm unit onto the mudguard tray in the orientation shown. Make sure the wiring harness exits the alarm unit towards the rear of the mudguard tray.
17. Route the alarm wiring harness around the right hand side of the alarm unit and loop back towards the rear of the mudguard tray, as shown.

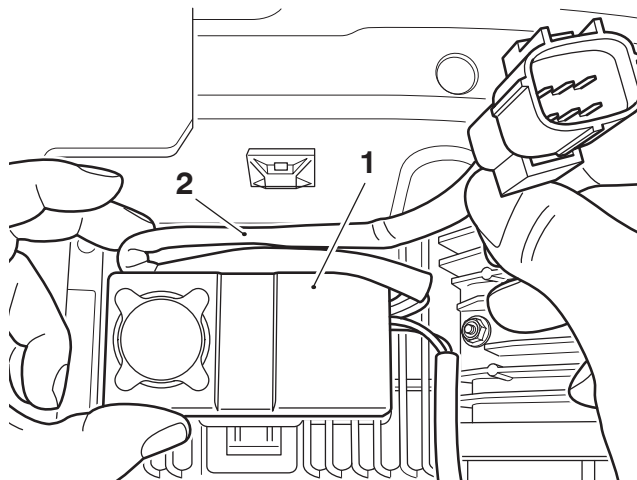

1. Alarm unit
2. Alarm wiring harness

18. Secure the alarm unit to the mudguard tray with the retaining strap from the kit, as shown below.

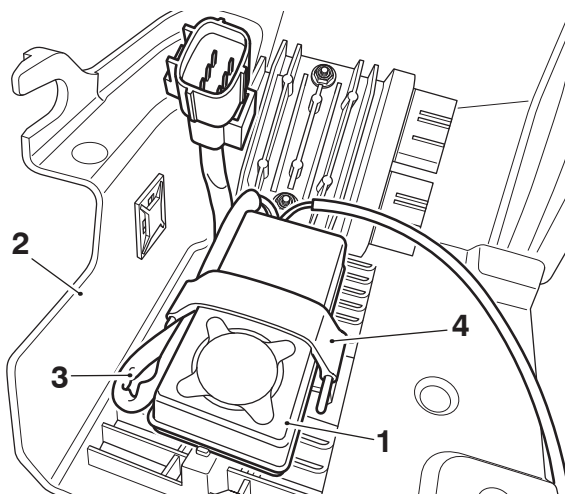

1. Alarm unit
2. Mudguard tray
3. Alarm wiring harness
4. Retaining strap

19. Collect the cable tie from the kit and feed through the cable tie holder as shown.

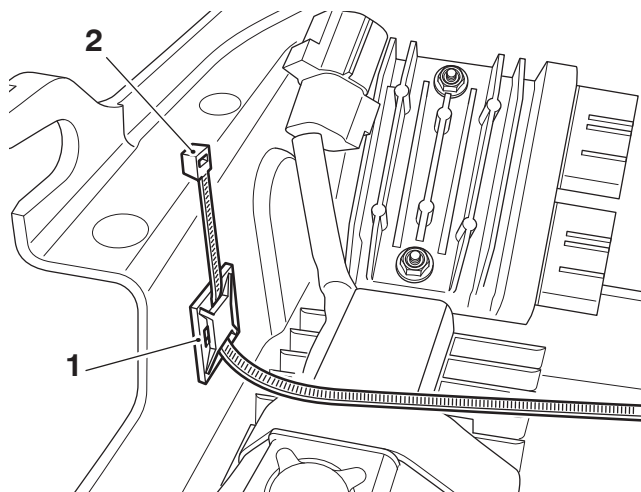

1. Cable tie holder
2. Cable tie

20. Loosely fit the cable tie around the alarm wiring harness connector with the connector facing towards the front of the mudguard tray, as shown.

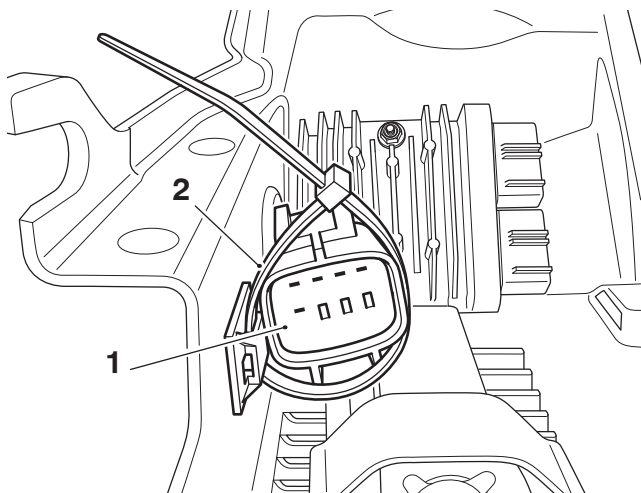

1. Alarm wiring harness connector
2. Cable tie

21. Whilst resting the mudguard tray on the rear tyre, connect the alarm wiring harness connector to the main wiring harness eight way connector.

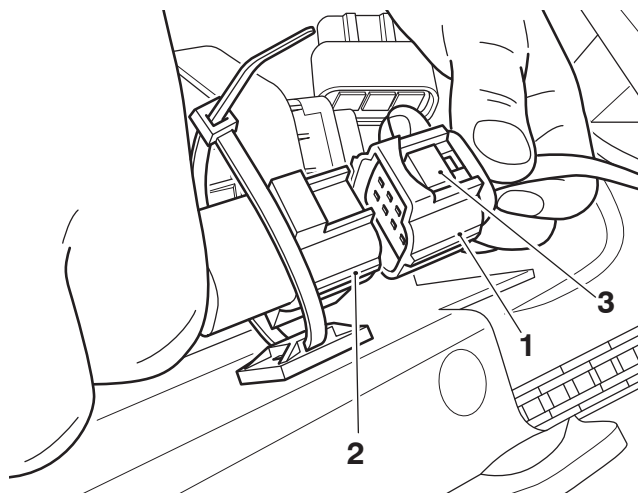

1. Main harness eight way connector
2. Alarm wiring harness connector
3. Connector release button

22. Rotate the connectors so that the connector release button is facing the cable tie holder. Tighten the cable tie making sure the cable tie is located between the retaining features on the connectors.

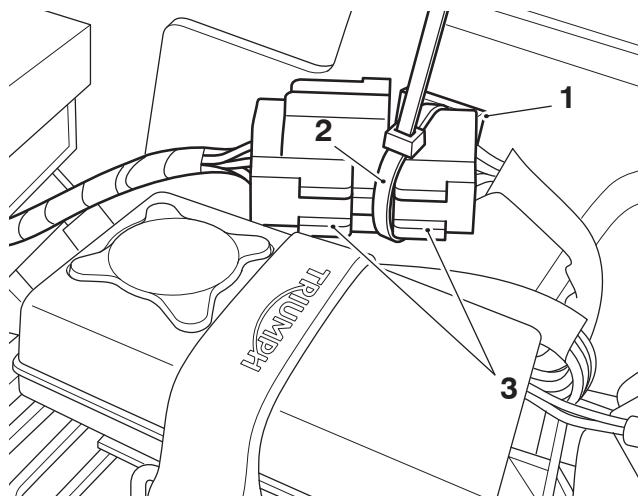

1. Cable tie holder
2. Cable tie
3. Connector retaining features

⚠ WARNING

When cutting cable ties, always use the correct tools and personal protection equipment. Failure to use these may result in personal injury.

23. Trim off any excess cable tie.

24. Route the alarm unit reed-switch harness through past the front of the battery tray, as shown.

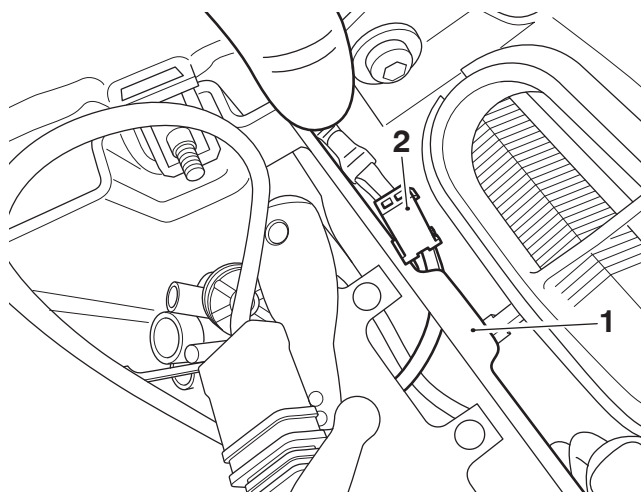

1. Battery tray
2. Alarm unit reed-switch harness

25. Reconnect both electrical connectors to the regulator/rectifier. Make sure the locking tabs are fully inserted.

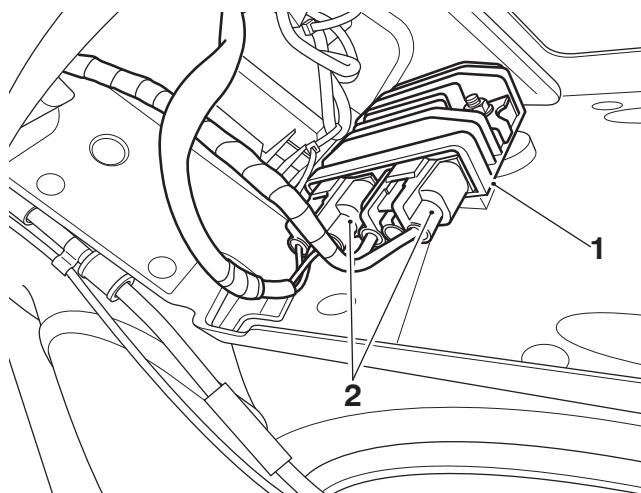

1. Rectifier
2. Main wiring harness connectors

Reed-Switch Fitment

26. Locate the reed-switch mounting area on the underside of the seat underseat moulding.

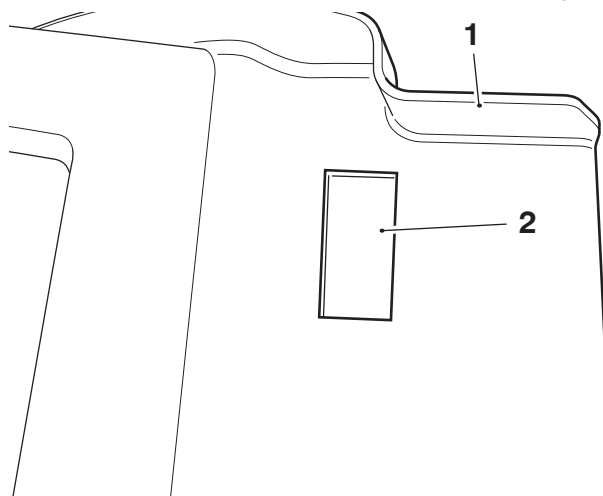

1. Seat underseat moulding
2. Reed-switch mounting area

⚠ CAUTION

When fitting self-adhesive parts care must be taken to make sure positioning is correct and accurate.

Once the adhesive has been attached to the mounting surface, there is no satisfactory method of removal and re-positioning if incorrectly aligned.

Initial bonding is instant, full bonding is achieved after 72 hours.

NOTICE

Read the warning notices printed on the cleaning wipe packet in the fitting kit

NOTICE

The surface to which the reed-switch is affixed must be clean and dry to make sure that the adhesive has a sound base to adhere to. Use the cleaning wipe supplied for this purpose.

27. Peel off the backing strip from the adhesive pad on the reed-switch.

28. Attach the reed-switch to the underside of the seat underseat moulding in the orientation shown. Apply firm and even pressure to the reed-switch to make sure a good bond is achieved.

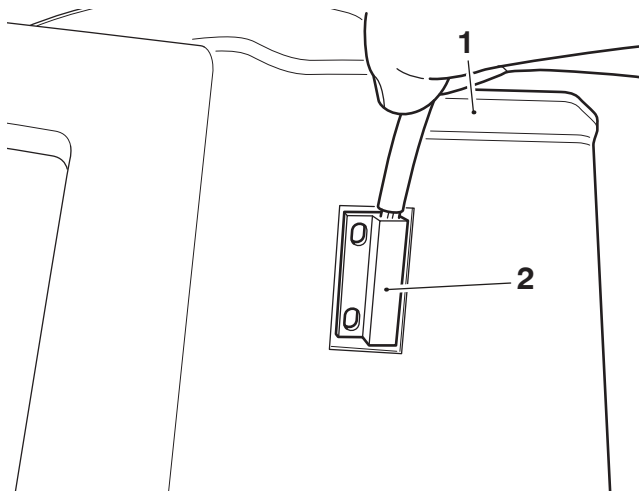

1. Seat underseat moulding
2. Reed-switch

29. Connect the reed-switch wiring to the alarm/immobiliser wiring harness.

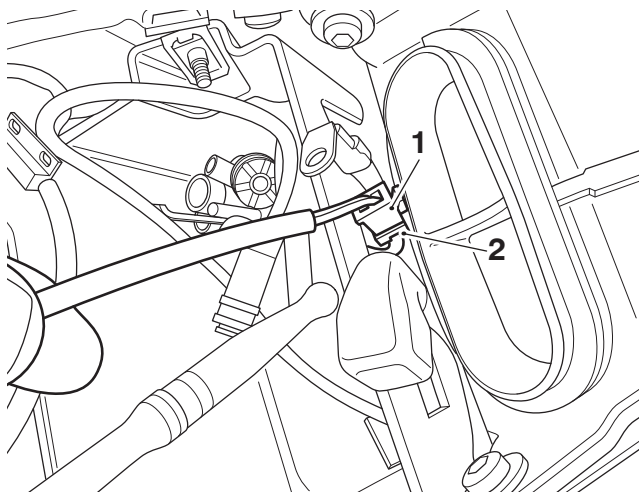

1. Reed-switch wiring connector
2. Alarm/immobiliser wiring connector

Reed-Switch Magnet Fitment

⚠ CAUTION

When fitting self-adhesive parts care must be taken to make sure positioning is correct and accurate.

Once the adhesive has been attached to the mounting surface, there is no satisfactory method of removal and re-positioning if incorrectly aligned.

Initial bonding is instant, full bonding is achieved after 72 hours.

NOTICE

Read the warning notices printed on the cleaning wipe packet in the fitting kit

NOTICE

The surface to which the reed-switch magnet is affixed must be clean and dry to make sure that the adhesive has a sound base to adhere to. Use the cleaning wipe supplied for this purpose.

30. Refit and reconnect the battery as described in the Service Manual.
31. Peel off the backing strip from the adhesive pad on the reed-switch magnet.
32. Align the reed-switch magnet in the centre of the mounting position on the battery, in the orientation shown. Apply firm and even pressure to the magnet to make sure a good bond is achieved.

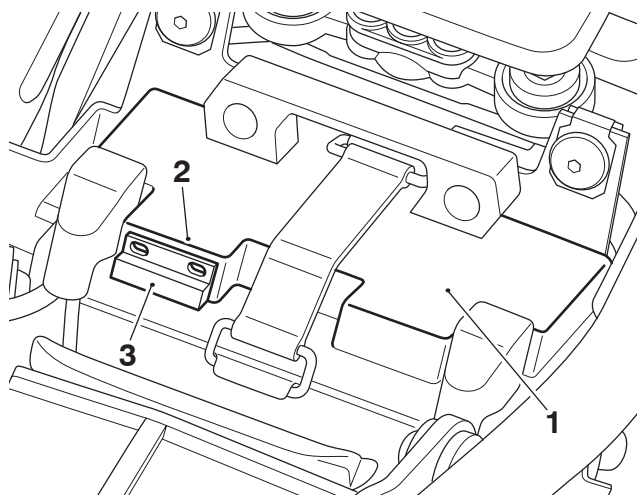

1. Battery
2. Reed-switch mounting area
3. Reed-switch magnet

⚠ CAUTION

A wiring harness which becomes trapped or kinked during installation, or motorcycle operation, may result in wiring harness damage and electrical malfunctions.

33. Refit the seat underseat moulding as described in the Service Manual making sure the reed-switch harness does not become trapped

⚠ CAUTION

Check and make sure that all wiring harnesses are positioned correctly inside the mudguard tray when refitting the mudguard tray to the motorcycle.

Incorrectly positioned harnesses may result in wiring harness damage and electrical malfunctions.

⚠ CAUTION

Check and make sure that no wiring harness is located near to the motorcycle chain and all wiring harnesses are secured and cannot move from the secured position. Loose harnesses may result in wiring harness damage and electrical malfunctions.

34. Fit the front of the mudguard tray on to the grommets on the motorcycle frame.

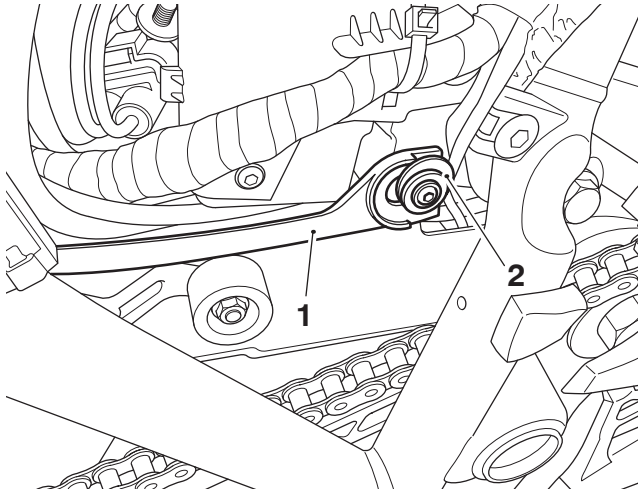

1. Mudguard tray, right hand side shown
2. Grommet, right hand side shown

35. Check along the motorcycle chain to make sure no wiring harness has become displaced and is positioned outside the mudguard tray.
36. If any wiring harness has been displaced and is outside the mudguard undertray the mudguard undertray must be removed and refitted, making sure all harnesses remain correctly positioned inside the mudguard tray.
37. Raise the rear of the mudguard tray.

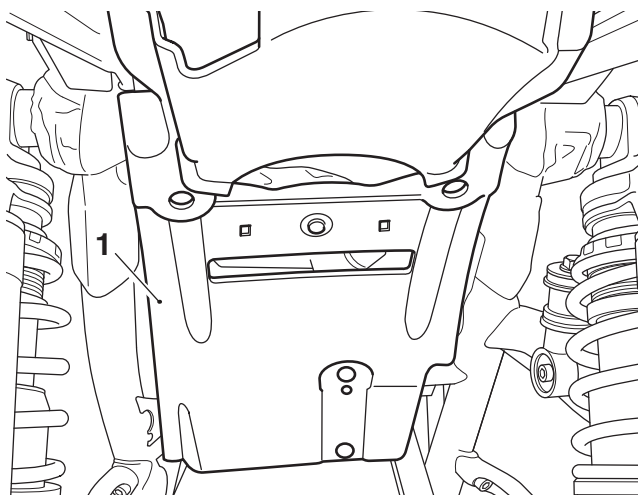

1. Mudguard tray

38. Refit the rear mudguard assembly with the new fixings from the kit, as described in the Service Manual.

39. Refit the left hand and right hand side panels, as described in the Service Manual.
40. Refit the silencer using the new gaskets from the kit, as described in the Service Manual.
41. Reconnect the battery, as described in the Service Manual.
42. Refit the seat underseat moulding, as described in the Service Manual.
43. Refit the seat, as described in the Service Manual.

NOTICE

The alarm unit is protected by fuse number 1 (10 Amp.) in the motorcycle fuse box.

Post Installation Checks

Check all the functions of the alarm, as described in the User Guide.

The checks and adjustments will reduce the possibility of false alarm activation.

Installation Certificate

The installation certificate is issued by the Triumph dealer. Dealer to visit: www.TriumphProtectPlus.com

The dealer should click the link to 'Apply for Dealer Access' the first time visiting the website.

The installation certificate will be emailed to the customer. The certificate must be retained by the customer as proof of alarm fitment.

Installation Certificate

The installation certificate is issued by the Triumph dealer. Dealer to visit www.TriumphTrackPlus.com. Please inform the customer that the installation certificate is available on the website if required for insurance purposes. The installation certificate is available to the customer on the website and is valid when a subscription is active. Customer to visit www.TriumphTrackPlus.com.

⚠ WARNING

After fitting the accessory kit the motorcycle will exhibit new handling characteristics.

Operate the motorcycle in a safe area free from traffic to gain familiarity with any new characteristics.

Operation of the motorcycle when not familiar with any new handling characteristics may lead to loss of motorcycle control which could result in serious injury or death.

⚠ WARNING

If, after fitting this accessory kit, you have any doubt about the performance of any aspect of the motorcycle, contact a competent person with the specialist knowledge and technical understanding of motorcycles, such as an authorised Triumph dealer.

Riding a motorcycle when there is any doubt as to any aspect of the performance of the motorcycle may lead to loss of motorcycle control which could result in serious injury or death.

⚠ WARNING

Never ride an accessory-equipped motorcycle at speeds above 80 mph (130 km/h).

Remember that the 80 mph (130 km/h) limit will be reduced by the fitting of non-approved accessories, incorrect loading, worn tyres, overall motorcycle condition and poor road or weather conditions.

The presence of accessories will cause changes in the stability and handling of the motorcycle. Failure to allow for changes in motorcycle stability may lead to loss of motorcycle control which could result in serious injury or death.

⚠ WARNING

High-speed operation should only be attempted by riders who have been instructed in the techniques necessary for high-speed riding and are familiar with the motorcycle's characteristics in all conditions.

Only operate this Triumph motorcycle at high speed in closed-course, on-road competition or on closed-course racetracks.

High-speed operation in any other circumstances is dangerous and may lead to loss of motorcycle control which could result in serious injury or death.

NOTICE

The motorcycle must not be operated above the legal road speed limit except in closed-course conditions.