



Accessory Fitting Instructions

Thank you for choosing this Triumph genuine accessory kit. This accessory kit is the product of Triumph's use of proven engineering, exhaustive testing, and continuous striving for superior reliability, safety and performance.

Completely read all of these instructions before commencing the installation of the accessory kit in order to become thoroughly familiar with the kit's features and the installation process.

These instructions should be considered a permanent part of your accessory kit, and should remain with it even if your accessory equipped motorcycle is subsequently sold.

Frame Protectors Kit

Kit Number	Models
A9780131	Tiger Sport from VIN AU7774

⚠ WARNING

If the motorcycle is involved in an accident, collision or fall, it must be taken for inspection and repair.

Inspections and repairs must be completed by a competent person with the specialist knowledge and technical understanding of motorcycles, such as an authorised Triumph dealer.

Any accident can cause damage to the motorcycle that, if not correctly repaired, may cause a second accident which could result in serious injury or death.

NOTICE

Frame protectors are intended to protect the motorcycle in the event of a static drop only.

Parts supplied

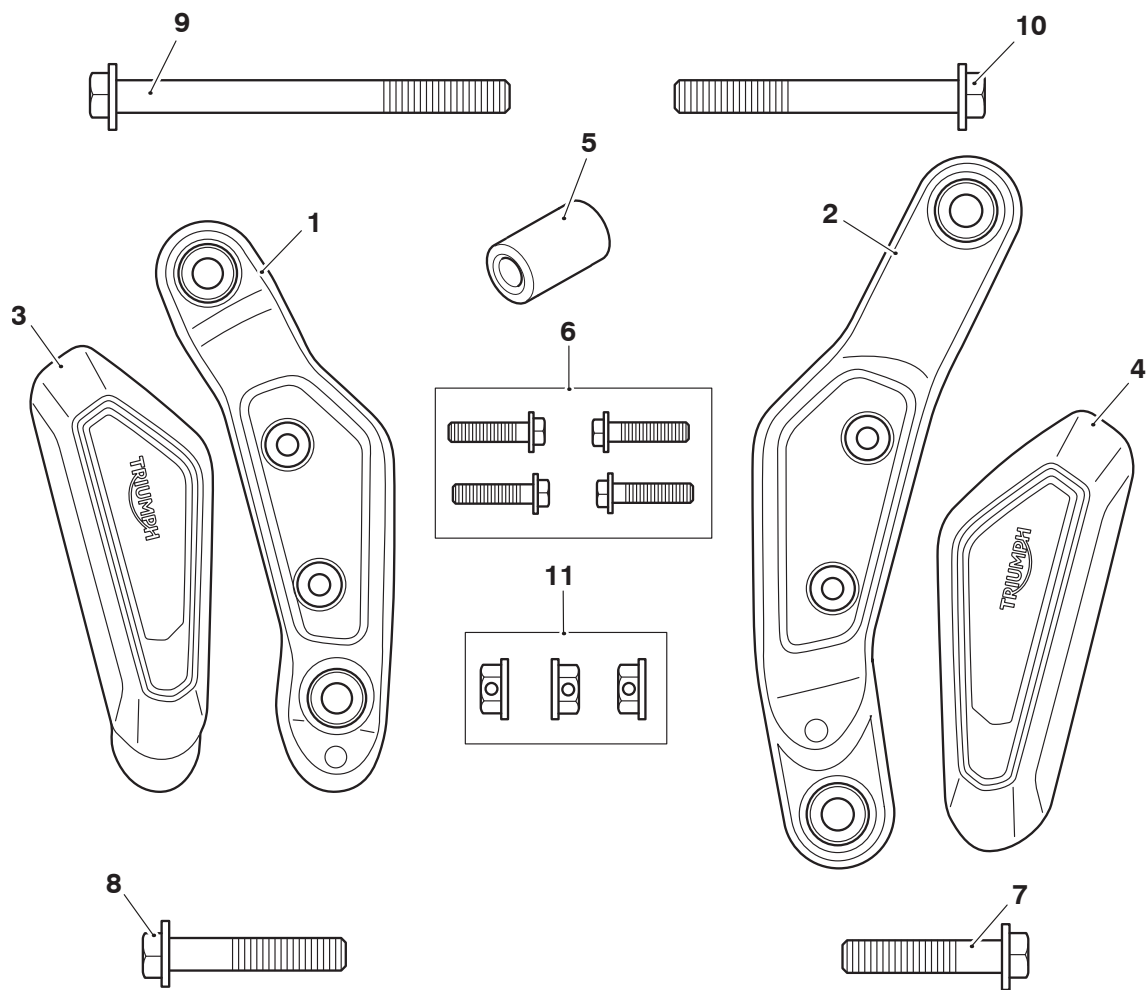

1. Support moulding, left hand	1 off	7. Fixing, M10 x 45 mm	1 off
2. Support moulding, right hand	1 off	8. Fixing, M10 x 55 mm	1 off
3. Cover moulding, left hand	1 off	9. Fixing, M10 x 130 mm	1 off
4. Cover moulding, right hand	1 off	10. Fixing M10 x 90 mm	1 off
5. Spacer	1 off	11. Lock nut, M10	3 off
6. Fixing, M6 x 25 mm	4 off		

⚠ WARNING

Fit only genuine Triumph accessories to those models approved by Triumph as listed in the associated Triumph fitting instructions.

The accessory kits covered in this instruction are designed for use on specific models of Triumph motorcycle. The accessory kits and the models applicable are listed at the start of the instruction. They should never be fitted to any other Triumph model or to any other manufacturer's motorcycle.

Fitting an accessory kit to a Triumph model not listed, or to any other manufacturer's motorcycle, will affect the performance, stability and handling of the motorcycle.

Failure to follow the advice above may lead to loss of motorcycle control which could result in serious injury or death.

⚠ WARNING

Always have Triumph approved parts, accessories and conversions fitted by a competent person with the specialist knowledge and technical understanding of motorcycles, such as an authorised Triumph dealer.

The fitment of parts, accessories and conversions by a person without the specialist knowledge and technical understanding of motorcycles may affect the handling, stability or other aspects of the motorcycle's operation.

Failure to follow the advice above may lead to loss of motorcycle control which could result in serious injury or death.

⚠ WARNING

A torque wrench of known accurate calibration must be used when fitting this accessory kit.

Failure to tighten any of the fasteners to the correct torque specification may affect motorcycle performance, handling and stability.

Failure to follow the advice above may lead to loss of motorcycle control which could result in serious injury or death.

⚠ WARNING

Make sure the motorcycle is stabilised and adequately supported.

Do not support the motorcycle on any ancillary component, the exhaust system or any other non structural parts of the motorcycle frame.

A correctly supported motorcycle will help prevent it from falling.

An unstable motorcycle may fall resulting in motorcycle damage, serious injury or death.

NOTICE

Triumph offers a broad range of approved genuine accessories for your motorcycle.

We cannot therefore cover all possible equipment variations in these instructions. For removal and installation of Triumph Genuine Accessories, always refer to the instructions supplied with the respective accessory kit.

To obtain additional copies of any Triumph accessory instructions, visit www.triumphinstructions.com or contact your authorised Triumph dealer.

1. Remove the seat as described in the Service Manual.
2. Disconnect the battery as described in the Service Manual.
3. Collect the right hand support moulding, right hand cover moulding and two M6 x 25 mm fixings from the kit.

NOTICE

When fitting the cover moulding to the support moulding make sure the locating feature on cover moulding aligns with corresponding feature in support moulding, as shown.

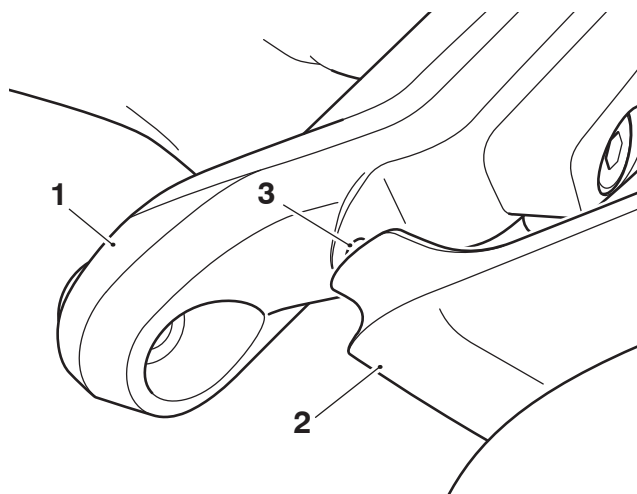

1. Support moulding
2. Cover moulding
3. Locating feature

4. Fit the cover moulding onto the support moulding in the orientation shown making sure the locating feature on the cover moulding is aligned with the support moulding. Fit the M6 x 25 mm fixings and tighten to 9 Nm.

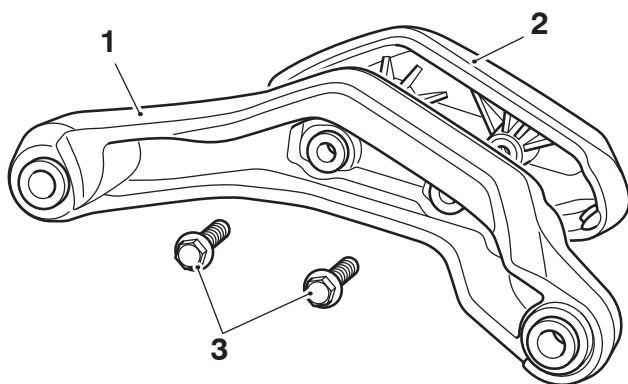

1. Support moulding
2. Cover moulding
3. Fixings, M6 x 25 mm

5. Remove the right hand and left hand side panels. Retain the fixings for reuse.

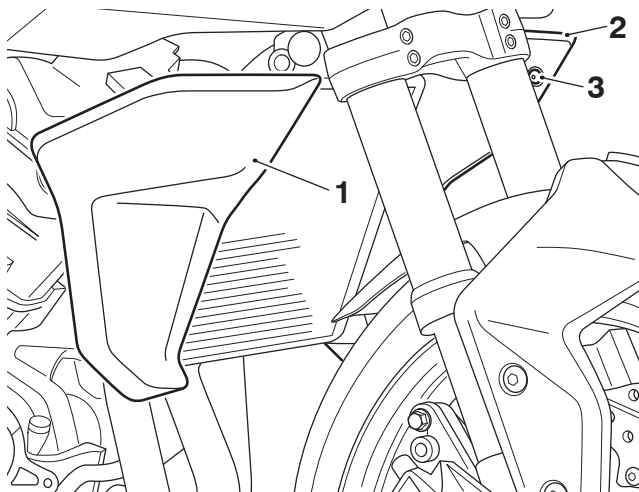

1. Side panel, right hand
2. Side panel, left hand
3. Fixings, left hand side shown

6. Remove the lower radiator bracket fixing. Retain the fixing for reuse.

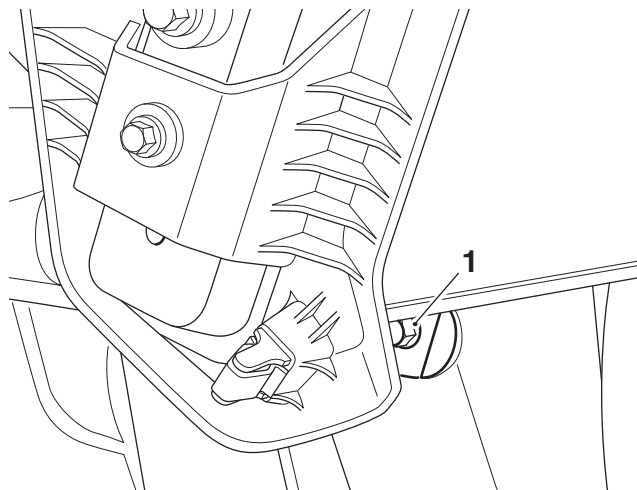

1. Lower radiator bracket fixing

NOTICE

If accessory fog lights are fitted note the position of the fog light harness and fog light subharness connectors on the radiator infill panels.

Pay particular attention to the routing and retention of the fog light harness on the infill panel.

NOTICE

Disconnect the fog light harness connectors from the fog light subharness connectors before removing the radiator infill panels.

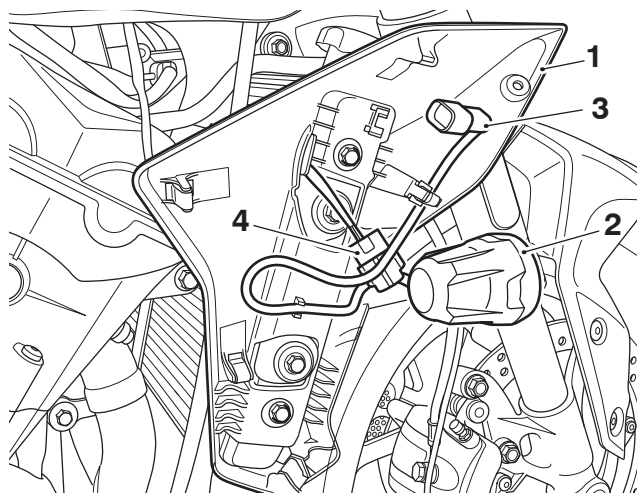

1. Radiator infill panel, right hand shown
2. Fog light, when fitted
3. Fog light harness connector
4. Fog light subharness connector

7. Remove the right hand radiator infill panel. Retain the fixings and compression limiters for reuse.

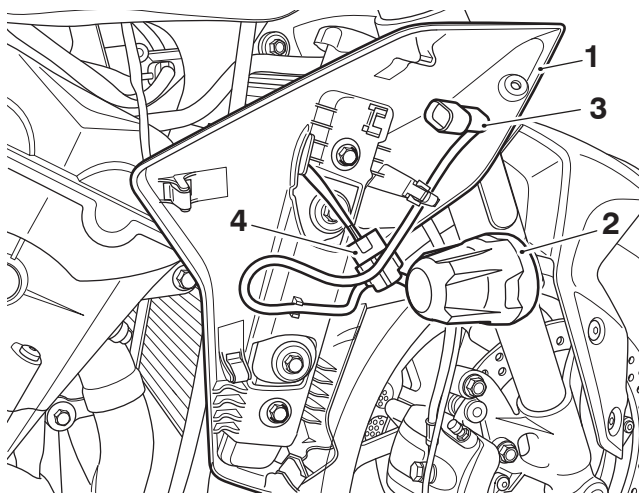

1. Radiator infill panel, right hand shown
2. Fixings
3. Compression limiters

8. Disconnect the horn, as described in the Service Manual.

9. Remove the left hand radiator infill panel. Retain the fixings and compression limiters for reuse.

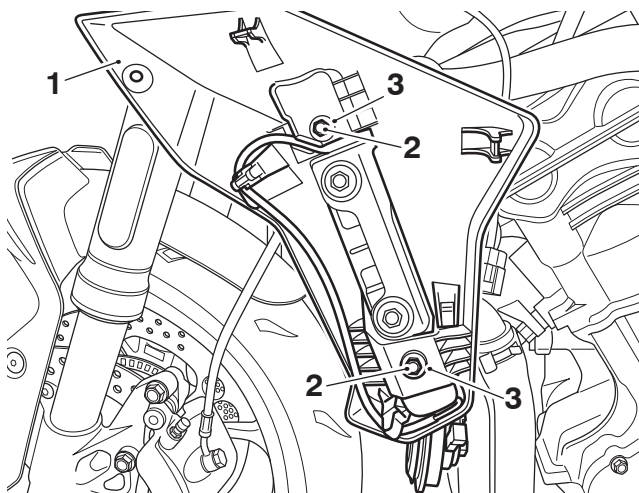

1. Radiator infill panel, left hand shown
2. Fixings
3. Compression limiters

10. Remove the fixings securing the radiator to the radiator support brackets on the left hand side and right hand side of the radiator. Retain fixings and compression limiters for reuse.

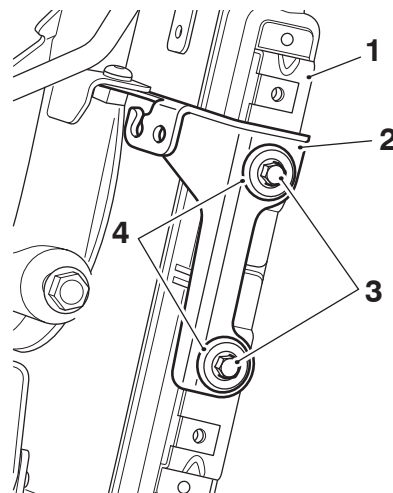

1. Radiator
2. Radiator support bracket, right hand side shown
3. Fixings
4. Compression limiters

NOTICE

Remove the engine mounting fixings in the sequence detailed in this document only.

Do not remove the left hand and right hand engine mounting fixings at the same time.

This could result in the engine moving within the frame and misalignment of the engine mounting positions, preventing fitment of the new fixings.

11. Loosen the upper radiator mount fixing. Do not remove the fixing.

Right Hand Side

12. Carefully rotate the radiator forwards to allow access to the front top engine mounting fixing lock nut. Remove the two top engine mounting fixings. Retain the fixings for reuse if the motorcycle is returned to its original condition. Discard the lock nut.

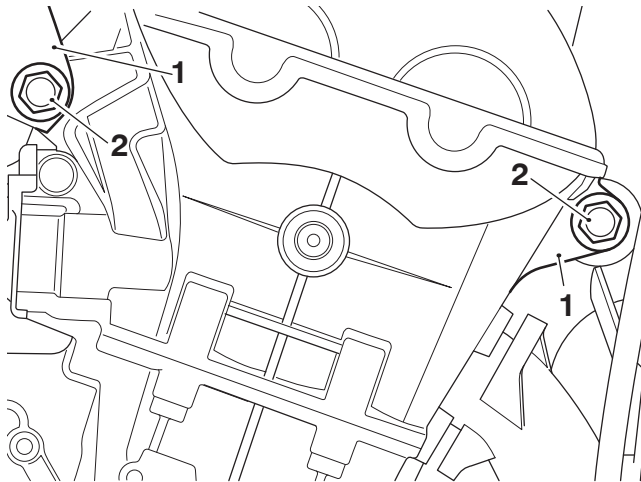

1. Top engine mountings
2. Fixings

13. Fit the right hand frame protector assembly to the top rear engine mounting point, in the orientation shown and loosely fit an M10 x 55 mm fixing and M10 lock nut from the kit.

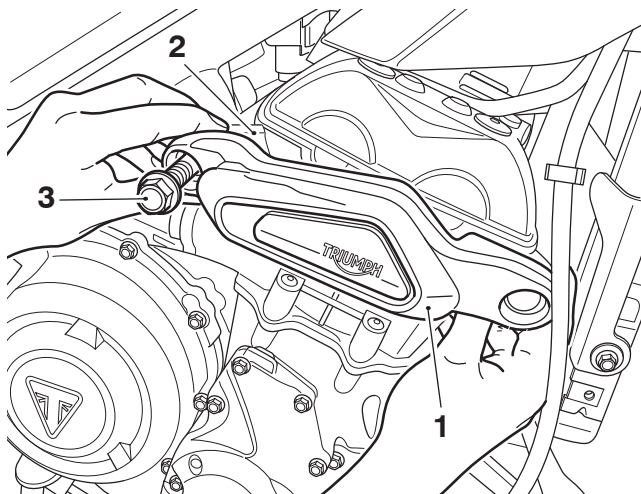

1. Frame protector assembly, right hand
2. Top rear engine mounting
3. Fixing, M10 x 55 mm

14. Rotate the frame protector assembly to align with the top front engine mounting position. Carefully rotating the radiator forwards to allow access, loosely fit the M10 x 90 mm fixing and M10 lock nut from the kit.

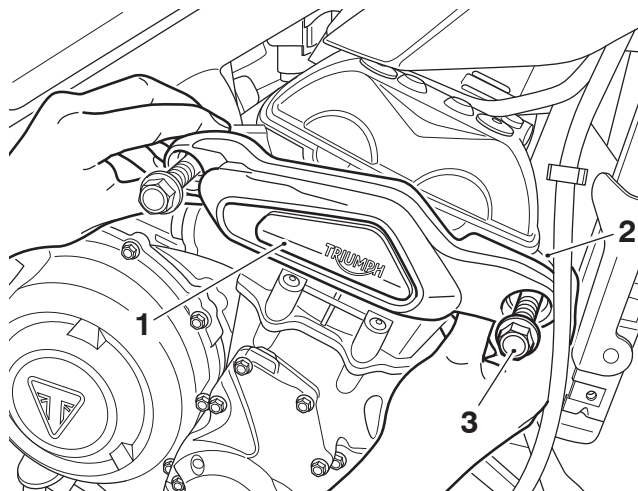

1. Frame protector, right hand
2. Top front engine mounting
3. Fixing, M10 x 90 mm

15. Tighten both frame protector fixings to 48 Nm.

Left Hand Side

16. Carefully rotate the radiator forwards to allow access to the front top engine mounting fixing lock nut. Remove the two top engine mounting fixings. Retain the fixings for reuse if the motorcycle is returned to its original condition. Discard the lock nut.

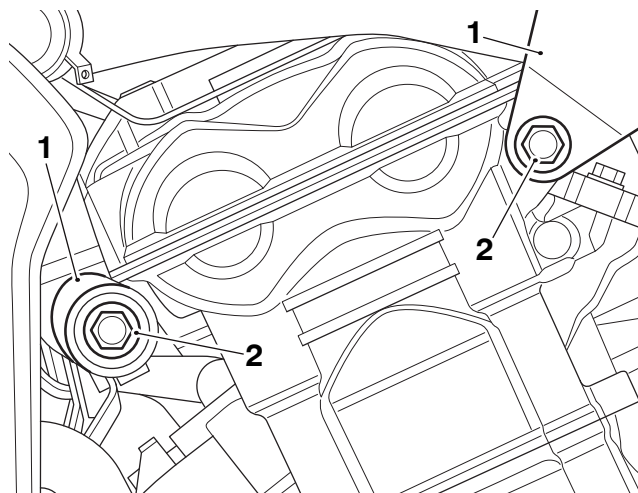

1. Top engine mountings
2. Fixings

17. Fit the spacer from the kit into the recess in the motorcycle frame at the top front engine mounting position. Fit the left hand frame protector assembly to the top front engine mounting in the orientation shown. Carefully rotating the radiator forwards to allow access, loosely fit the M10 x 130 mm fixing and M10 lock nut from the kit.

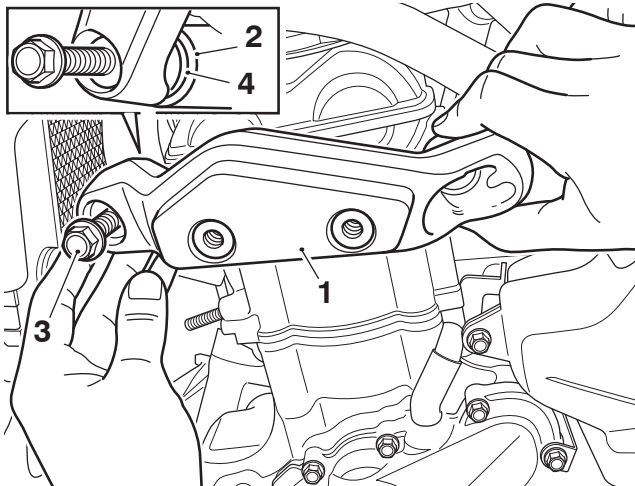

- 1. Frame protector assembly, left hand
- 2. Top front engine mounting
- 3. Fixing, M10 x 130 mm
- 4. Spacer

NOTICE

Before fitting the M10 x 45 mm fixing from the kit lubricate the threads with a smear of proprietary high temperature copper based grease.

18. Rotate the frame protector assembly to align with the top rear engine mounting position and loosely fit an M10 x 45 mm fixing from the kit.

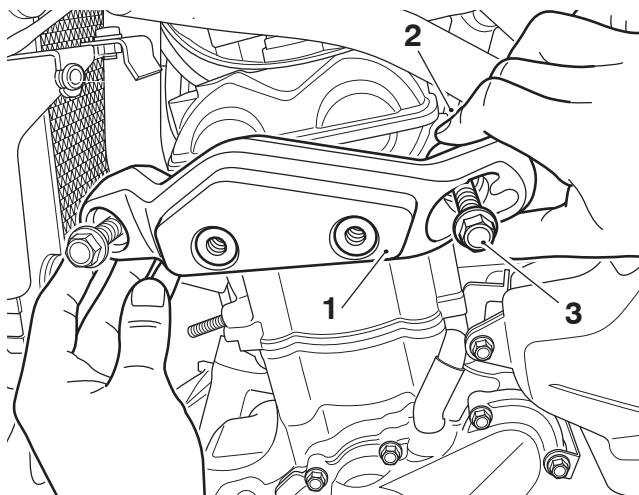

- 1. Frame protector assembly, left hand
- 2. Top rear engine mounting
- 3. Fixing, M10 x 45 mm

19. Tighten both frame protector fixings to 48 Nm.

NOTICE

When fitting the cover moulding to the support moulding make sure the locating feature on cover moulding aligns with corresponding feature in support moulding, as shown.

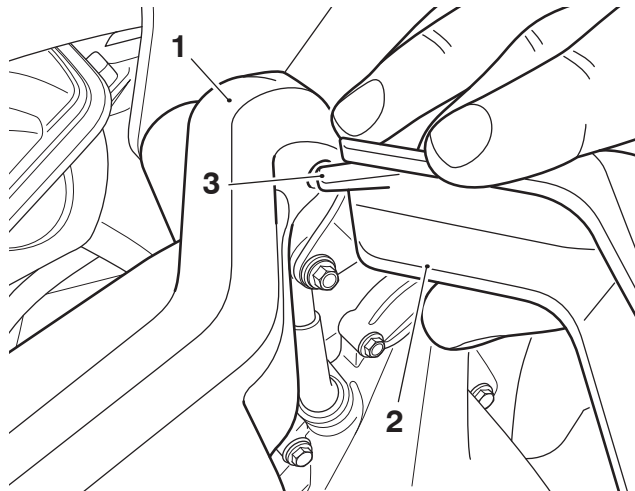

- 1. Support moulding
- 2. Cover moulding
- 3. Locating feature

20. Fit the cover moulding onto the support moulding in the orientation shown making sure the locating feature on the cover moulding is aligned with the support moulding. Fit the M6 x 25 mm fixings through the rear of the support moulding and tighten to 9 Nm.

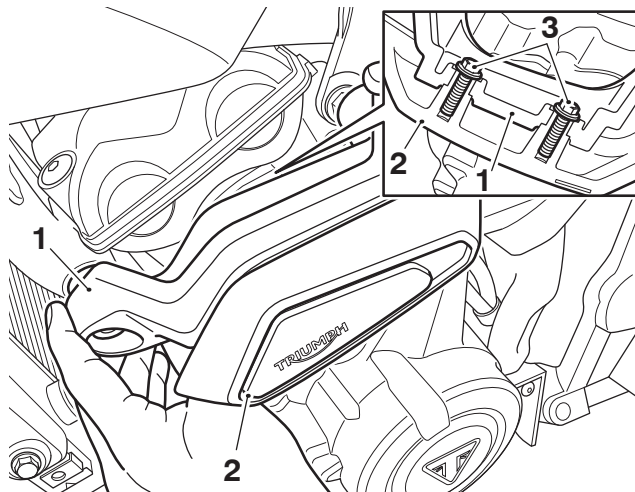

- 1. Support moulding
- 2. Cover moulding
- 3. Fixings, M6 x 25 mm

21. Refit the lower radiator bracket fixing and tighten to 6 Nm.

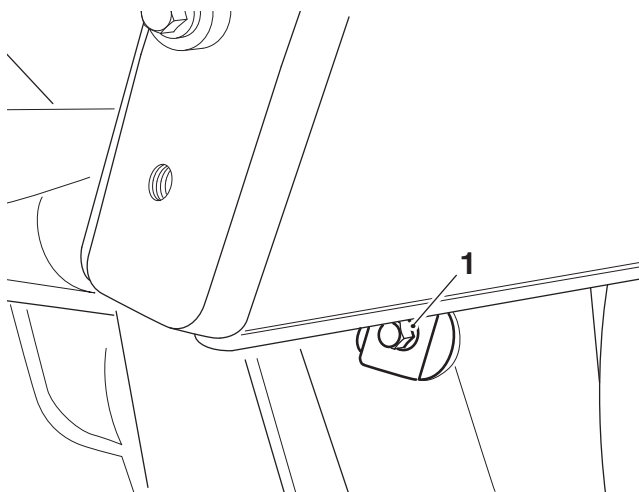

1. Lower radiator bracket fixing

22. Tighten the upper radiator mount fixing to 9 Nm.
23. Refit the compression limiters and fixings securing the radiator to the radiator support brackets on the left hand side and right hand side of the radiator. Tighten the fixings to 6 Nm.

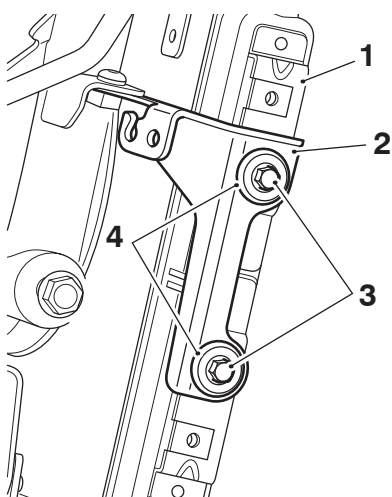

- 1. Radiator**
2. Radiator support bracket, right hand side shown
3. Fixings, right hand side shown
4. Compression limiters, right hand side shown

NOTICE

A wiring harness which becomes trapped or kinked during installation, or motorcycle operation, may result in wiring harness damage and electrical malfunctions.

24. Making sure no wiring is trapped, refit the right hand side radiator infill panel with the original compression limiters and fixings. Tighten the fixings to 3 Nm.

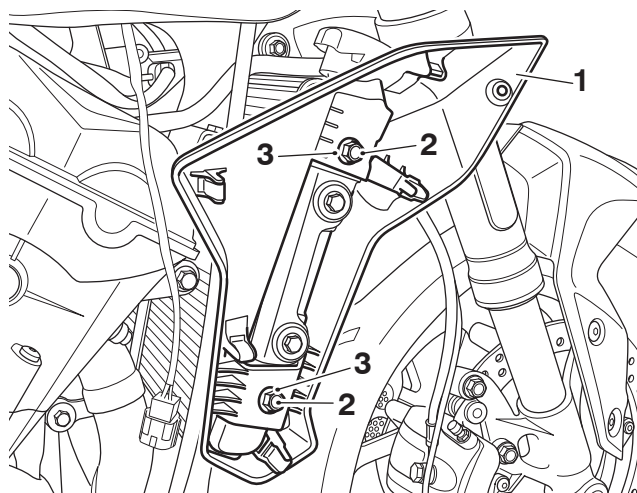

- 1. Radiator infill panel, right hand side**
2. Fixings
3. Compression limiters

25. Refit the left hand side radiator infill panel with the original compression limiters and fixings. Tighten the fixings to 3 Nm. Make sure the horn harness is routed correctly, as shown below.

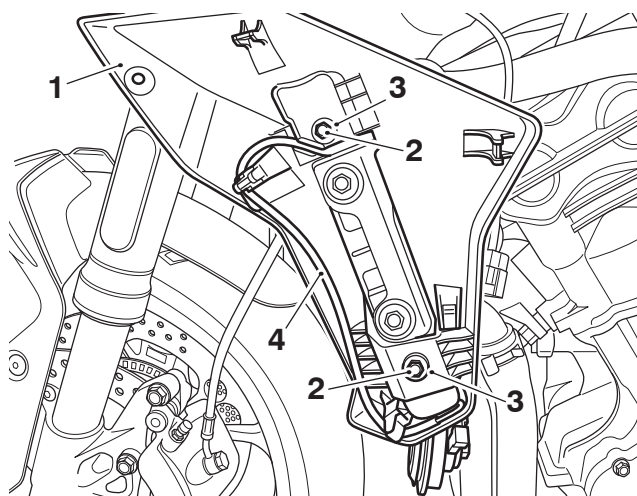

- 1. Radiator infill panel, left hand side**
2. Fixings
3. Compression limiters
4. Horn harness

26. Reconnect the horn, as described in the Service Manual.
27. If accessory fog lights are fitted connect the fog light harness connectors to the fog light subharness connectors and route and retain the fog light harnesses, as noted on removal of the radiator infill panels.

28. Refit the right hand and left hand side panels with the original fixings. Tighten the fixings to 3 Nm.

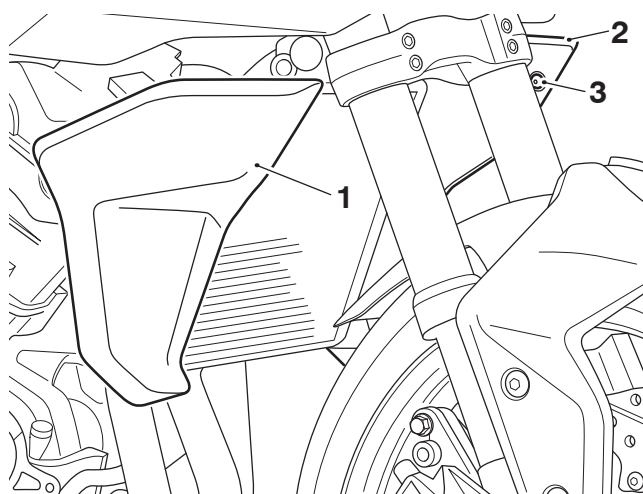

1. Side panel, right hand
2. Side panel, left hand
3. Fixings, left hand side shown

29. Reconnect the battery, as described in the Service Manual.
30. Refit the seat, as described in the Service Manual.

⚠ WARNING

After fitting the accessory kit the motorcycle will exhibit new handling characteristics.

Operate the motorcycle in a safe area free from traffic to gain familiarity with any new characteristics.

Operation of the motorcycle when not familiar with any new handling characteristics may lead to loss of motorcycle control which could result in serious injury or death.

⚠ WARNING

If, after fitting this accessory kit, you have any doubt about the performance of any aspect of the motorcycle, contact a competent person with the specialist knowledge and technical understanding of motorcycles, such as an authorised Triumph dealer.

Riding a motorcycle when there is any doubt as to any aspect of the performance of the motorcycle may lead to loss of motorcycle control which could result in serious injury or death.

⚠ WARNING

Never ride an accessory-equipped motorcycle at speeds above 80 mph (130 km/h).

Remember that the 80 mph (130 km/h) limit will be reduced by the fitting of non-approved accessories, incorrect loading, worn tyres, overall motorcycle condition and poor road or weather conditions.

The presence of accessories will cause changes in the stability and handling of the motorcycle. Failure to allow for changes in motorcycle stability may lead to loss of motorcycle control which could result in serious injury or death.

⚠ WARNING

High-speed operation should only be attempted by riders who have been instructed in the techniques necessary for high-speed riding and are familiar with the motorcycle's characteristics in all conditions.

Only operate this Triumph motorcycle at high speed in closed-course, on-road competition or on closed-course racetracks.

High-speed operation in any other circumstances is dangerous and may lead to loss of motorcycle control which could result in serious injury or death.

NOTICE

The motorcycle must not be operated above the legal road speed limit except in closed-course conditions.