



## Accessory Fitting Instructions

<b>Dresser Bar Kit, Chrome</b>	
<b>Kit Number</b>	<b>Models Affected</b>
A9780027 A9780113	Bonneville Bobber, Bonneville Bobber - Black, Bonneville Speedmaster from VIN 739143
<b>Dresser Bar Kit, Black</b>	
<b>Kit Number</b>	<b>Models Affected</b>
A9788041 A9780114	Bonneville Bobber, Bonneville Bobber - Black, Bonneville Speedmaster from VIN 739143

**Note:**

- **When fitting Dresser Bar Kit A9780027, A9780113 or A9788041, A9780114 to Bonneville Bobber models up to VIN 854155 an accessory Forward Control Mount Kit A9770195 and Forward Control Kit A9770115 must be fitted.**
- **When fitting Dresser Bar Kit A9780027, A9780113 or A9788041, A9780114 to Bonneville Bobber models from VIN 854156 an accessory Forward Control Mount Kit A9770179 and Forward Control Kit A9770115 must be fitted.**
- **When fitting Dresser Bar Kit A9780027, A9780113 or A9788041, A9780114 to Bonneville Bobber - Black models from VIN 854156 an accessory Forward Control Mount Kit A9770179 and Forward Control Kit A9770115 must be fitted.**
- **Accessory Highway Pegs must not be fitted to the black option Dresser Bar Kits A9788041, A9780114 listed above.**

Thank you for choosing this Triumph genuine accessory kit. This accessory kit is the product of Triumph's use of proven engineering, exhaustive testing, and continuous striving for superior reliability, safety and performance.

Completely read all of these instructions before commencing the installation of the accessory kit in order to become thoroughly familiar with the kit's features and the installation process.

These instructions should be considered a permanent part of your accessory kit, and should remain with it even if your accessory equipped motorcycle is subsequently sold.

**Parts Supplied**

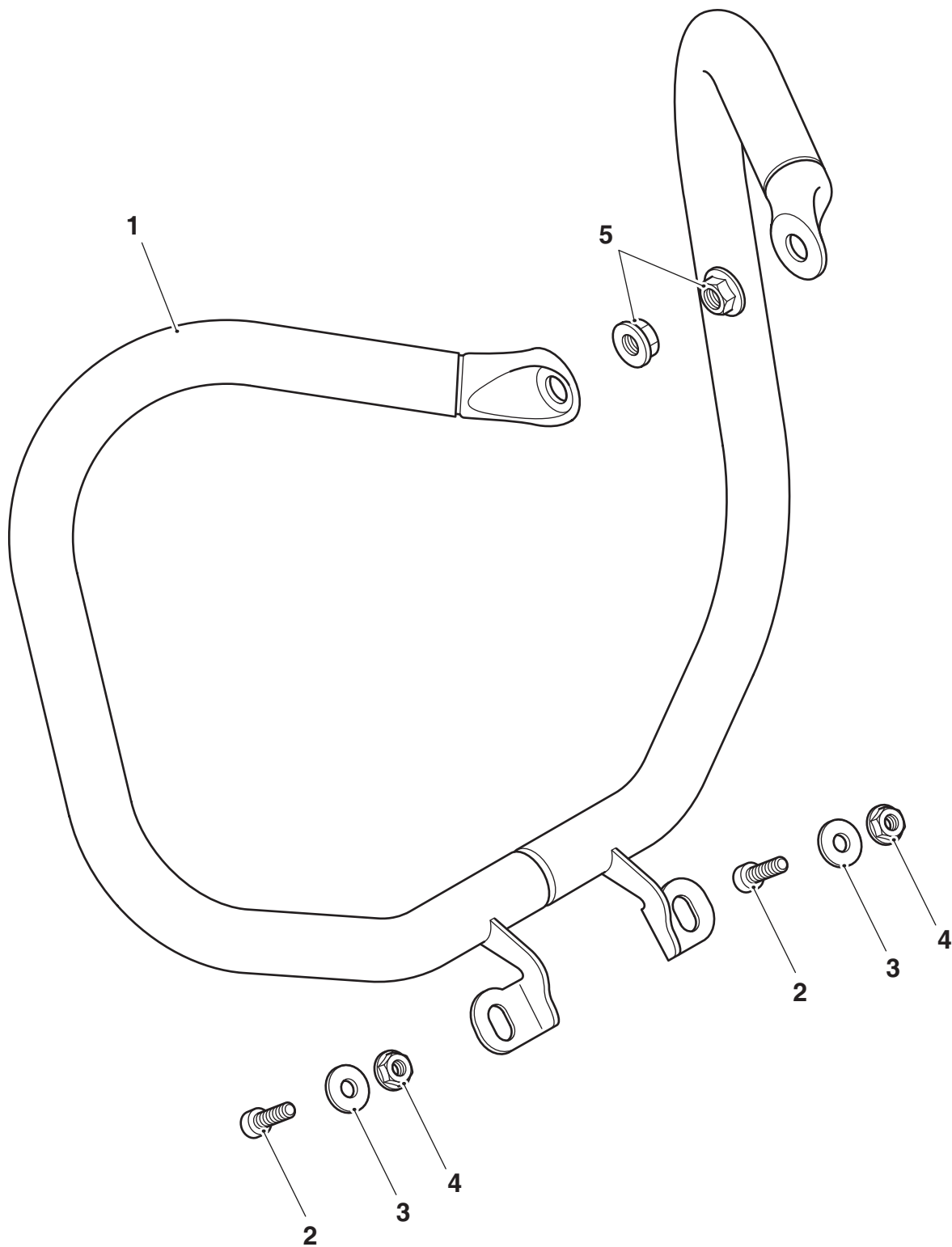

1. Dresser bar	1 off	4. Lock nut, M8	2 off
2. Fixing, M8 x 25 mm	2 off	5. Lock nut, M12	2 off
3. Washer	2 off		

**Warning**

The accessory kits covered in this instruction are designed for use on specific models of Triumph motorcycle. The accessory kits and the models applicable are listed at the start of the instruction. They should not be fitted to any other Triumph model or to any other manufacturer's motorcycle. Fitting an accessory kit to a Triumph model not listed, or to any other manufacturer's motorcycle will affect the performance, stability and handling of the motorcycle. This may affect the rider's ability to control the motorcycle and may result in loss of motorcycle control and an accident.

**Warning**

Always have Triumph approved parts, accessories and conversions fitted by a trained technician of an authorised Triumph dealer. The fitment of parts, accessories and conversions by a technician who is not of an authorised Triumph dealer may affect the handling, stability or other aspects of the motorcycle's operation which may result in loss of motorcycle control and an accident.

**Warning**

Throughout this operation, ensure that the motorcycle is stabilised and adequately supported to prevent risk of injury from the motorcycle falling.

**Warning**

A torque wrench of known accurate calibration must be used when fitting this accessory kit. Failure to tighten any of the fasteners to the correct torque specification may affect motorcycle performance, handling and stability. This may result in loss of motorcycle control and an accident.

**Warning**

If the engine has recently been running, the exhaust system will be hot. Before working on or near the exhaust system, allow sufficient time for the system to cool, as touching any part of a hot exhaust could cause burn injuries.

**Note:**

- Triumph offers a broad range of approved genuine accessories for your motorcycle. We cannot therefore cover all possible equipment variations in these instructions. For removal and installation of Triumph Genuine Accessories, always refer to the instructions supplied with the respective accessory kit. To obtain additional copies of any Triumph accessory instructions, visit [www.triumphinstructions.com](http://www.triumphinstructions.com) or contact your authorised Triumph dealer.

1. Disconnect the battery, negative (black) lead first.
2. Remove the fuel tank, as described in the Service Manual.
3. Remove the right hand side cylinder head fixing, as shown. Retain the fixing for reuse, discard the lock nut.

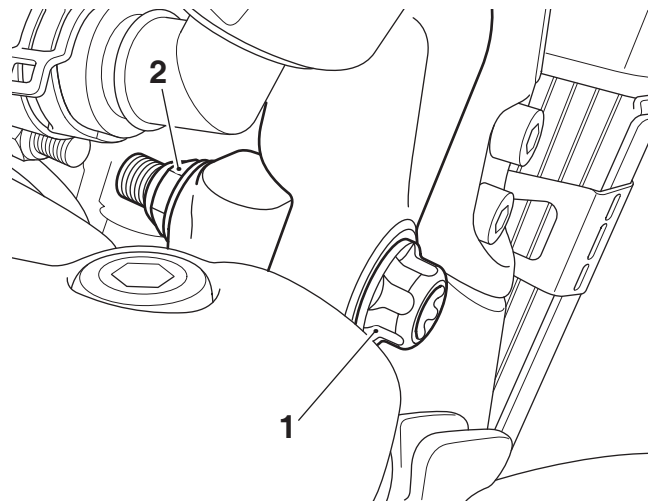

1. Fixing, cylinder head
2. Lock nut

- Remove the left hand side cylinder head fixings, as shown. Retain the washer for reuse if the motorcycle is to be returned to its original condition. Retain the fixing for reuse, discard the lock nut.

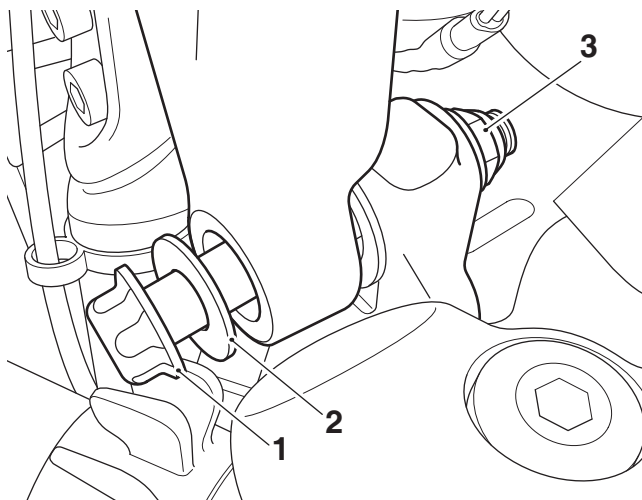

- Fixing, cylinder head
- Washer
- Lock nut

- Carefully position the dresser bar between the front forks and the motorcycle frame ensuring the upper mountings are lifted over the radiator, as shown.

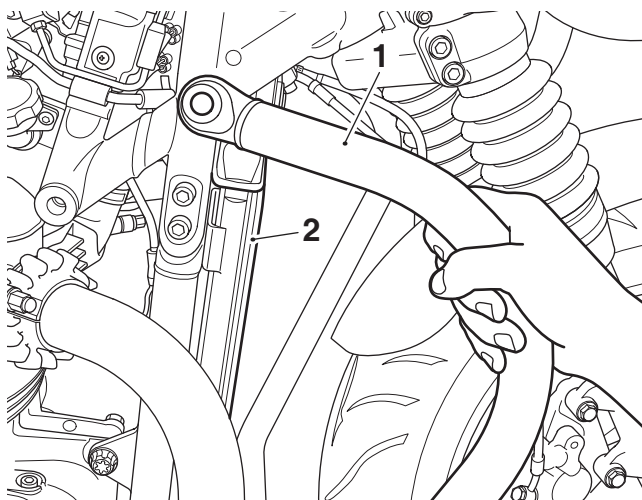

- Dresser bar
- Radiator

- Position the lower mounting brackets of the dresser bar onto the mountings provided on the control plates hanger, as shown.

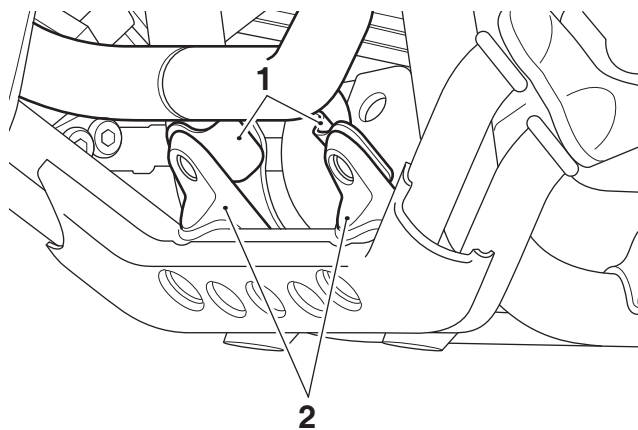

- Bottom brackets, dresser bar
- Mountings, control plates hanger

**Note:**

- When refitting the original cylinder head fixing on the left hand side of the motorcycle the original washer is not required when fitting dresser bars.
- Align the upper mountings of the dresser bar with the cylinder head mountings. Fit the original fixings and new M12 lock nuts from the kit. Do not fully tighten the fixings at this stage.

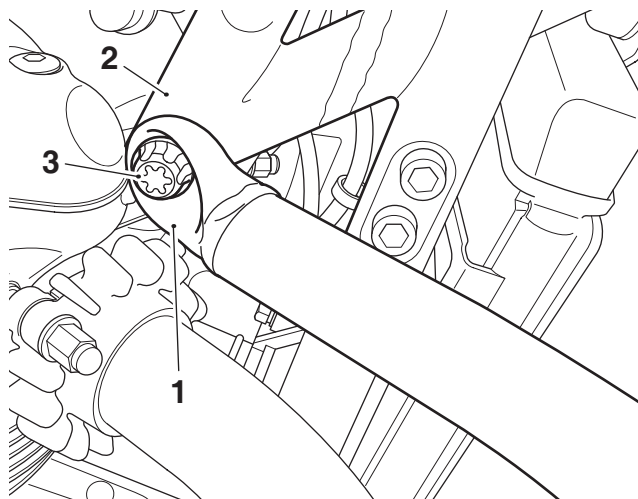

- Dresser bar upper mounting (right hand shown)
- Cylinder head mounting
- Fixing

- Fit the M8 x 25 mm fixings, washers and lock nuts provided to the left hand and right hand lower dresser bar mountings, as shown. Do not fully tighten the fixings at this stage.

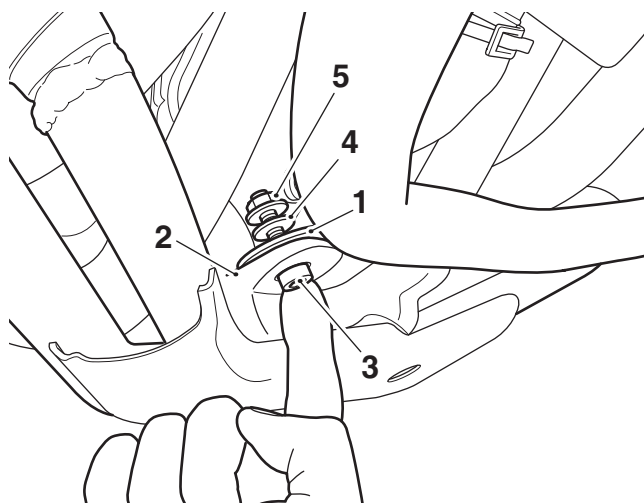

- Dresser bar lower mounting bracket (right hand shown)**
  - Control plates hanger**
  - Fixing, M8 x 25 mm**
  - Washer**
  - Lock nut, M8**
- While holding the lock nuts with a suitable spanner, tighten the lower dresser bar fixings to **28 Nm**.
  - While holding the lock nuts with a suitable spanner, tighten the cylinder head fixings to **105 Nm**.
  - Refit the fuel tank, as described in the Service Manual.
  - Reconnect the battery, positive (red) lead first and tighten the battery terminals to **4.5 Nm**.

### **Warning**

After fitting the accessory kit the motorcycle will exhibit new handling characteristics. Operate the motorcycle in a safe area free from traffic to gain familiarity with any new characteristics. Operation of the motorcycle when not familiar with any new handling characteristics may result in loss of motorcycle control and an accident.

### **Warning**

If, after fitting this accessory kit, you have any doubt about the performance of any aspect of the motorcycle, contact an authorised Triumph dealer and do not ride the motorcycle until the authorised dealer has declared it fit for use. Riding a motorcycle when there is any doubt as to any aspect of the performance of the motorcycle may result in loss of motorcycle control and an accident.

### **Warning**

Never ride an accessory-equipped motorcycle at speeds above 80 mph (130 km/h).

The presence of accessories will cause changes in the stability and handling of the motorcycle. Failure to allow for changes in motorcycle stability may result in loss of motorcycle control and an accident.

Remember that the 80 mph (130 km/h) limit will be reduced by the fitting of non-approved accessories, incorrect loading, worn tyres, overall motorcycle condition and poor road or weather conditions.

### **Warning**

The motorcycle must not be operated above the legal road speed limit except in closed-course conditions.

### **Warning**

Only operate this Triumph motorcycle at high speed in closed-course, on-road competition or on closed-course racetracks. High-speed operation should only be attempted by riders who have been instructed in the techniques necessary for high-speed riding and are familiar with the motorcycle's characteristics in all conditions.

High-speed operation in any other circumstances is dangerous and may result in loss of motorcycle control and an accident.