

Fitting Instructions:

Tiger XR, Tiger XR_T, Tiger XR_x, Tiger XC, Tiger XCA, Tiger XC_x, Tiger 800 and Tiger 800XC

A9780011 and A9780020

Thank you for choosing this Triumph genuine accessory kit. This accessory kit is the product of Triumph's use of proven engineering, exhaustive testing, and continuous striving for superior reliability, safety and performance.

Completely read all of these instructions before commencing the installation of the accessory kit in order to become thoroughly familiar with the kit's features and the installation process.

These instructions should be considered a permanent part of your accessory kit, and should remain with it even if your accessory-equipped motorcycle is subsequently sold.

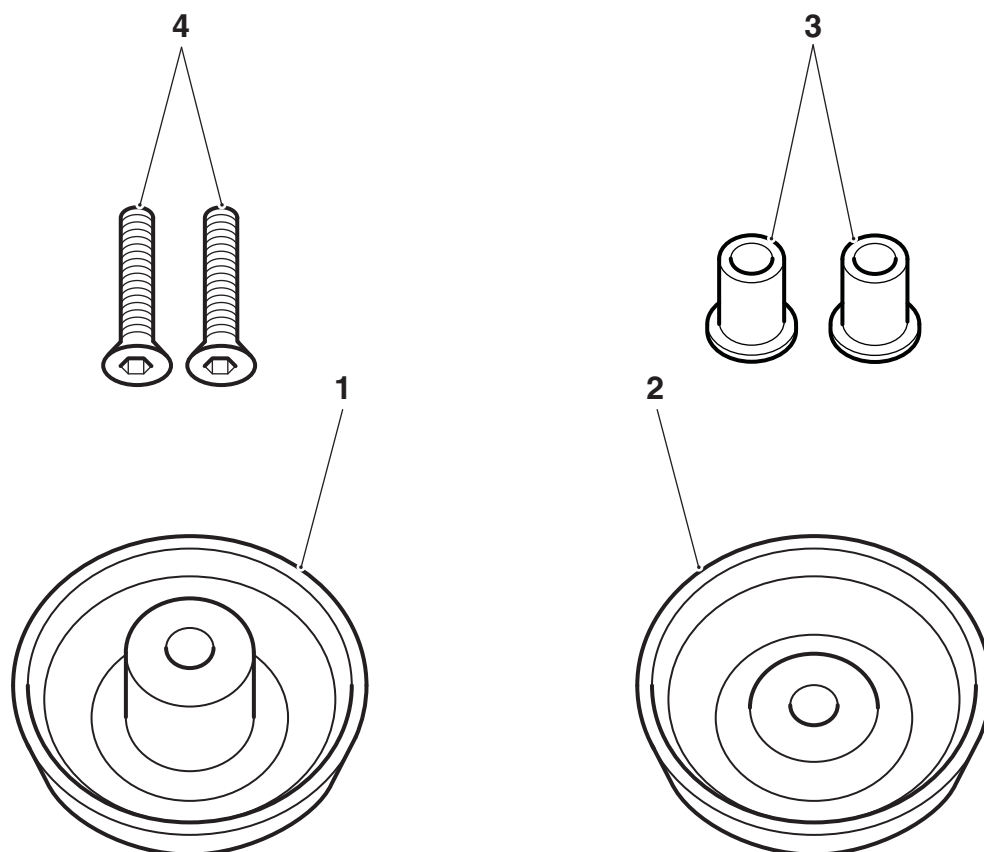

Parts Supplied:

- | | | | |
|---------------------------------|-------|----------------------|-------|
| 1. Swinging arm pivot cover, RH | 1 off | 3. Well nut, M4 | 2 off |
| 2. Swinging arm pivot cover, LH | 1 off | 4. Screw, M4 x 30 mm | 2 off |

Warning

This accessory kit is designed for use on Triumph Tiger XR, Tiger XR_T, Tiger XR_x, Tiger XC, Tiger XC_A, Tiger XC_x, Tiger 800 and Tiger 800XC motorcycles only and should not be fitted to any other manufacturer's motorcycle. Fitting this accessory kit to any other manufacturer's motorcycle will affect the performance, stability and handling of the motorcycle. This may affect the rider's ability to control the motorcycle and could cause an accident.

Warning

Always have Triumph approved parts, accessories and conversions fitted by a trained technician of an authorised Triumph dealer. The fitment of parts, accessories and conversions by a technician who is not of an authorised Triumph dealer may affect the handling, stability or other aspects of the motorcycle's operation which may result in loss of motorcycle control and an accident.

Warning

Throughout this operation, ensure that the motorcycle is stabilised and adequately supported to prevent risk of injury from the motorcycle falling.

Warning

A torque wrench of known accurate calibration must be used when fitting this accessory kit. Failure to tighten any of the fasteners to the correct torque specification may affect motorcycle performance, handling and stability. This may result in loss of motorcycle control and an accident.

1. Assemble the screw and Well nut to the left hand swinging arm pivot cover as shown below.

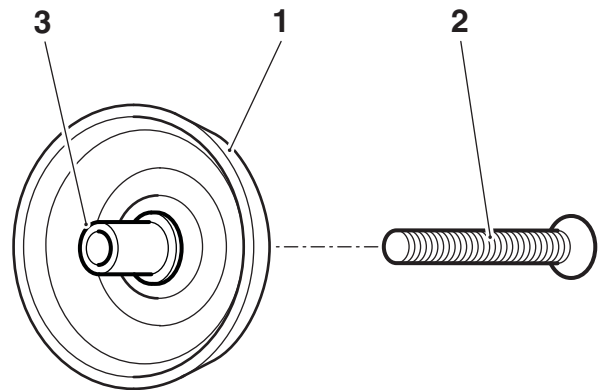

- 1. Left hand swinging arm pivot cover**
 - 2. Screw**
 - 3. Well nut**
2. Fit the cover assembly to the left hand side of the swinging arm pivot bolt. Tighten the screw to **3 Nm**. If necessary, lubricate the Well nut with a thin smear of suitable water based lubricant, such as tyre mounting paste.

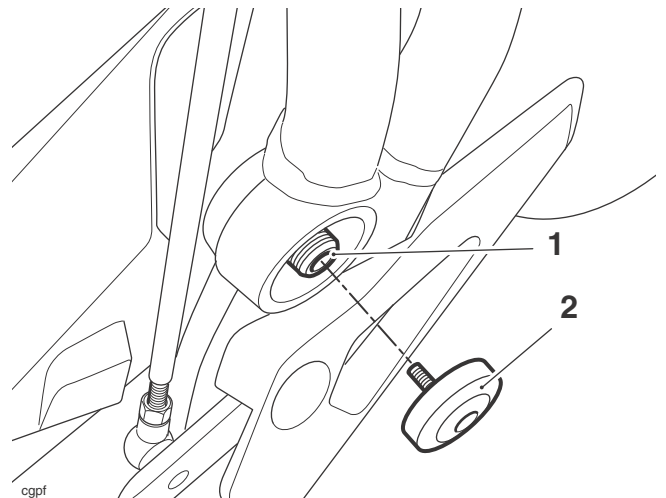

- 1. Swinging arm pivot bolt**
 - 2. Pivot cover assembly**
3. Repeat steps 1 and 2 to fit the remaining pivot cover to the right hand side of the swinging arm pivot bolt, noting the following:
 - The right hand well nut requires no lubrication;
 - If the right hand well nut will not tighten in the swinging arm pivot bolt, pre-tighten the screw as required to allow the Well nut to grip the swinging arm pivot bolt.