



## Accessory Fitting Instructions

Front Footrest Kit	
<b>Kit number</b>	<b>Models Affected</b>
A9770142	Thruxton 1200, Thruxton 1200 R, Thruxton RS, Thruxton TFC

Thank you for choosing this Triumph genuine accessory kit. This accessory kit is the product of Triumph's use of proven engineering, exhaustive testing, and continuous striving for superior reliability, safety and performance.

Completely read all of these instructions before commencing the installation of the accessory kit in order to become thoroughly familiar with the kit's features and the installation process.

These instructions should be considered a permanent part of your accessory kit, and should remain with it even if your accessory equipped motorcycle is subsequently sold.

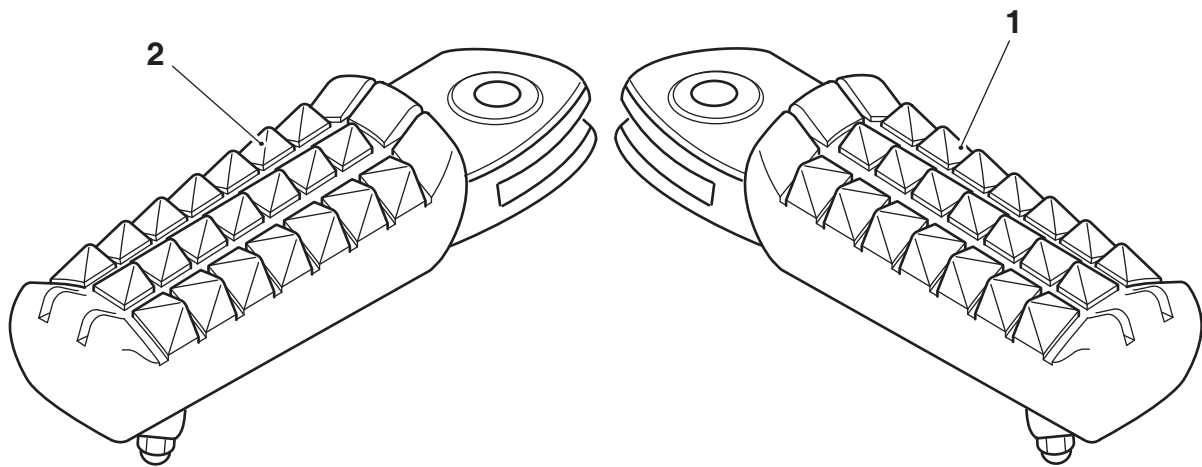

### Parts supplied:

1. Footrest, left hand	1 off	2. Footrest, right hand	1 off
------------------------	-------	-------------------------	-------

**Warning**

The accessory kits covered in this instruction are designed for use on specific models of Triumph motorcycle. The accessory kits and the models applicable are listed at the start of the instruction. They should not be fitted to any other Triumph model or to any other manufacturer's motorcycle. Fitting an accessory kit to a Triumph model not listed, or to any other manufacturer's motorcycle will affect the performance, stability and handling of the motorcycle. This may affect the rider's ability to control the motorcycle and could cause an accident.

**Warning**

Always have Triumph approved parts, accessories and conversions fitted by a trained technician of an authorised Triumph dealer. The fitment of parts, accessories and conversions by a technician who is not of an authorised Triumph dealer may affect the handling, stability or other aspects of the motorcycle's operation which may result in loss of motorcycle control and an accident.

**Warning**

Throughout this operation, ensure that the motorcycle is stabilised and adequately supported to prevent risk of injury from the motorcycle falling.

**Note:**

- **Triumph offers a broad range of approved genuine accessories for your motorcycle. We cannot therefore cover all possible equipment variations in these instructions. For removal and installation of Triumph Genuine Accessories, always refer to the instructions supplied with the respective accessory kit. To obtain additional copies of any Triumph accessory instructions, visit [www.triumphinstructions.com](http://www.triumphinstructions.com) or contact your authorised Triumph dealer.**

1. Remove the front left hand and right hand footrests, as described in the Service Manual. Retain the pivot pins, E-clips and return springs for reuse. Retain the footrests for reuse if the motorcycle is to be returned to its original condition.
2. Fit one of the original return springs to the right hand front footrest mounting, in the orientation shown. Ensure the bent section of the spring locates correctly in the location hole in the footrest mounting.

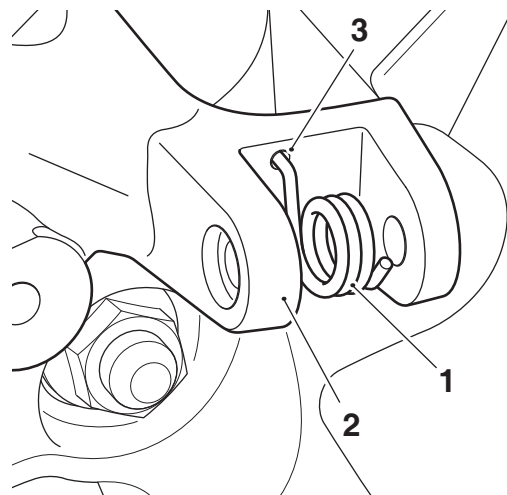

1. Return spring
2. Front footrest mounting, right hand
3. Location hole

3. Fit the right hand footrest provided in the kit as shown, ensuring the footrest, return spring and footrest mounting are aligned. Fit an original pivot pin, from the top of the footrest mounting, and secure with one of the original E-clips.

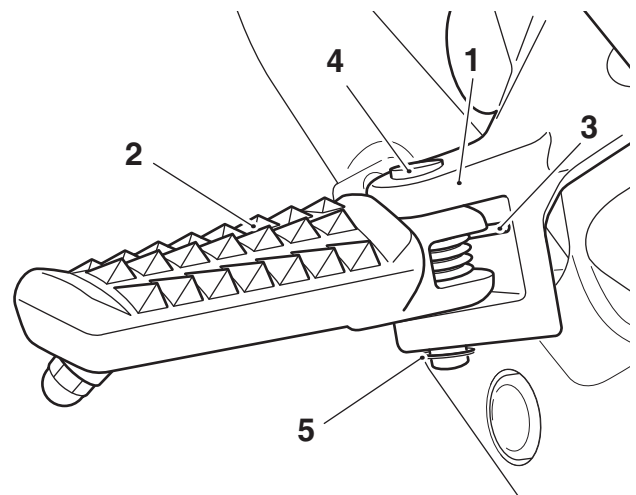

1. Front footrest mounting, right hand
2. Footrest, right hand
3. Return spring
4. Pivot pin
5. E-clip

4. Repeat steps 2 and 3 for the left hand footrest.

 **Warning**

Fitting the accessory footrests alters the position of the bank angle pegs and therefore changes the bank angle at which contact is made. Further banking the motorcycle once contact has been made may cause instability, loss of motorcycle control and an accident.

 **Warning**

If, after fitment of this accessory kit, you have any doubt about the performance of any aspect of the motorcycle, contact an authorised Triumph dealer and do not ride the motorcycle until the authorised dealer has declared it fit for use. Riding a motorcycle when there is any doubt as to any aspect of the performance of the motorcycle may result in loss of control of the motorcycle leading to an accident.

 **Warning**

Never ride an accessory equipped motorcycle at speeds above 80 mph (130 km/h).  
The presence of accessories will cause changes in the stability and handling of the motorcycle. Failure to allow for changes in motorcycle stability may lead to loss of control or an accident.  
Remember that the 80 mph (130 km/h) limit will be reduced by the fitting of non-approved accessories, incorrect loading, worn tyres, overall motorcycle condition and poor road or weather conditions.

 **Warning**

Only operate this Triumph motorcycle at high speed in closed-course, on-road competition or on closed-course racetracks. High-speed operation should only be attempted by riders who have been instructed in the techniques necessary for high-speed riding and are familiar with the motorcycle's characteristics in all conditions.  
High-speed operation in any other circumstances is dangerous and will lead to loss of motorcycle control and an accident.

 **Warning**

The motorcycle must not be operated above the legal road speed limit except in closed-course conditions.

 **Warning**

Use of a motorcycle with bank angle indicators worn beyond the maximum limit will allow the motorcycle to be banked to an unsafe angle.  
Banking to an unsafe angle may cause instability, loss of motorcycle control and an accident.