

English

Fitting Instructions:

Tiger 800XC

A9770037

Thank you for choosing this Triumph genuine accessory kit. This accessory kit is the product of Triumph's use of proven engineering, exhaustive testing, and continuous striving for superior reliability, safety and performance.

Completely read all of these instructions before commencing the installation of the accessory kit in order to become thoroughly familiar with the kit's features and the installation process.

These instructions should be considered a permanent part of your accessory kit, and should remain with it even if your accessory-equipped motorcycle is subsequently sold.

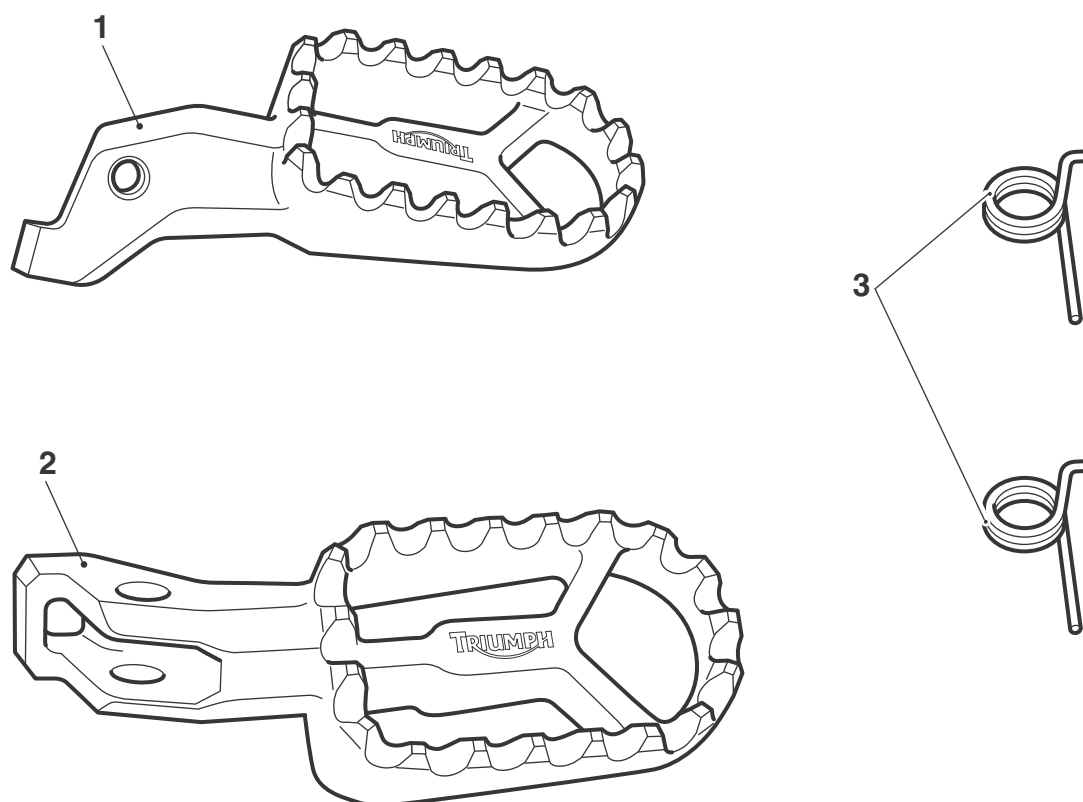

T1027

Parts Supplied:

1. Footrest, left hand	1 off	3. Spring	2 off
2. Footrest, right hand	1 off		



Warning

This accessory kit is designed for use on Triumph Tiger 800XC motorcycles only and should not be fitted to any other manufacturer's motorcycle. Fitting this accessory kit to any other manufacturer's motorcycle will affect the performance, stability and handling of the motorcycle. This may affect the rider's ability to control the motorcycle and could cause an accident.



Warning

This accessory kit must not be fitted to the Triumph Tiger 800. Fitment to the Tiger 800 could lead to loss of motorcycle control and an accident.



Warning

Always have Triumph approved parts, accessories and conversions fitted by a trained technician of an authorised Triumph dealer. The fitment of parts, accessories and conversions by a technician who is not of an authorised Triumph dealer may affect the handling, stability or other aspects of the motorcycle's operation, which may result in loss of motorcycle control and an accident.



Warning

Throughout this operation, ensure that the motorcycle is stabilised and adequately supported to prevent risk of injury from the motorcycle falling.

Note:

- **For the right hand rider's footrest, the clevis pin for the rear brake pedal must be removed. This will allow the pivot pin to be removed without being obstructed by the brake pedal.**

1. Working on the right hand side of the motorcycle, remove the clip from the clevis pin at the lower end of the rear brake master cylinder push rod and remove the clevis pin.

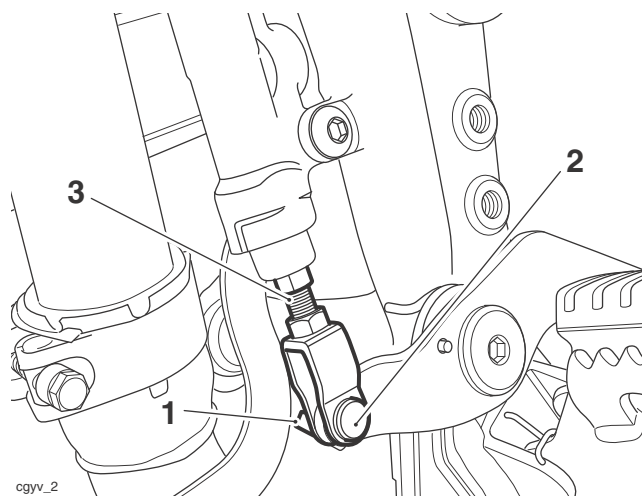

1. Clip
2. Clevis pin
3. Push rod

2. Remove the E-clip at the lower end of the pivot pin for the footrest and remove the pivot pin. Retain the E-clip and pivot pin for re-use.
3. Remove the footrest and its return spring. Retain the footrest and spring if the motorcycle is to be returned to its original condition.
4. Collect the right hand footrest and a spring from the kit.
5. Fit the spring to the footrest ensuring that the straight end of the spring is positioned as shown below.

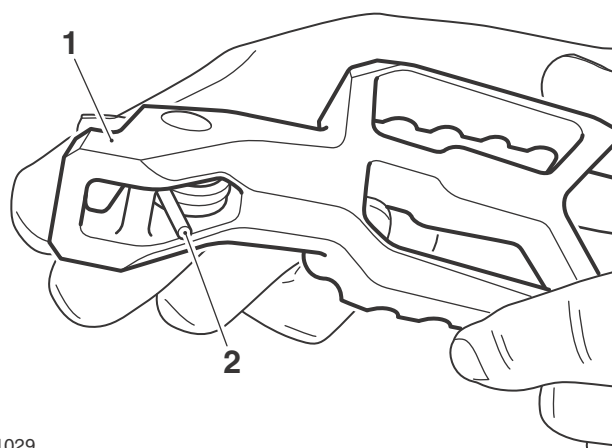

T1029

1. Footrest
2. Spring, straight end

6. Align the footrest and spring assembly to its mounting point on the motorcycle. Ensure that the bent end of the spring is aligned to the hole in the footrest mounting.

7. Refit the pivot pin and secure with the original E-clip.
8. Align the brake pedal to the push rod for the rear brake master cylinder, refit the clevis pin and secure with the original clip.
9. Check the rear brake and brake light operation. Rectify if necessary.



Warning

It is dangerous to operate the motorcycle with defective brakes; you must have your authorised Triumph dealer take remedial action before you attempt to ride the motorcycle again. Failure to take remedial action may reduce braking efficiency leading to loss of motorcycle control and an accident.

10. Repeat steps 2 to 7 for the rider's left hand footrest.



Warning

If, after fitment of this accessory kit, you have any doubt about the performance of any aspect of the motorcycle, contact an authorised Triumph dealer and do not ride the motorcycle until the authorised dealer has declared it fit for use. Riding a motorcycle when there is any doubt as to any aspect of the performance of the motorcycle may result in loss of control of the motorcycle leading to an accident.



Warning

Never ride an accessory-equipped motorcycle at speeds above 80 mph (130 km/h).

The presence of accessories will cause changes in the stability and handling of the motorcycle. Failure to allow for changes in motorcycle stability may lead to loss of control or an accident.

Remember that the 80 mph (130 km/h) limit will be reduced by the fitting of non-approved accessories, incorrect loading, worn tyres, overall motorcycle condition and poor road or weather conditions.



Warning

Only operate this Triumph motorcycle at high speed in closed-course on road competition or on closed-course racetracks. High speed operation should only be attempted by riders who have been instructed in the techniques necessary for high speed riding and are familiar with the motorcycle's characteristics in all conditions.

High speed operation in any other circumstances is dangerous and will lead to loss of motorcycle control and an accident.



Warning

The motorcycle must not be operated above the legal road speed limit except in closed-course conditions.