

Fitting Instructions: Rocket III Touring A9758068

Thank you for choosing this Triumph genuine accessory kit. This accessory kit is the product of Triumph's use of proven engineering, exhaustive testing, and continuous striving for superior reliability, safety and performance.

Completely read all of these instructions before commencing the installation of the accessory kit in order to become thoroughly familiar with the kit's features and the installation process.

These instructions should be considered a permanent part of your accessory kit, and should remain with it even if your accessory-equipped motorcycle is subsequently sold.

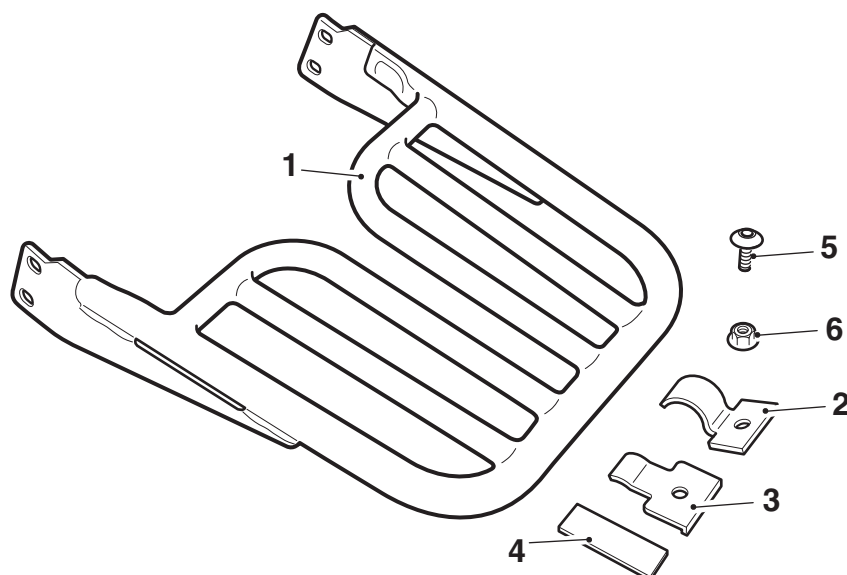

Parts Supplied:

1.	Luggage rack	1 off	4.	Adhesive pad	1 off
2.	Reflector clamp, upper	1 off	5.	Screw, M6	1 off
3.	Reflector clamp, lower	1 off	6.	Nut, M6	1 off



Warning

This accessory kit is designed for use on Triumph Rocket III Touring motorcycles only and should not be fitted to any other manufacturer's motorcycle. Fitting this accessory kit to any other manufacturer's motorcycle will affect the performance, stability and handling of the motorcycle. This may affect the rider's ability to control the motorcycle and could cause an accident.



Warning

Always have Triumph approved parts, accessories and conversions fitted by a trained technician of an authorised Triumph dealer. The fitment of parts, accessories and conversions by a technician who is not of an authorised Triumph dealer may affect the handling, stability or other aspects of the motorcycle's operation which may result in loss of motorcycle control and an accident.



Warning

Throughout this operation, ensure that the motorcycle is stabilised and adequately supported to prevent risk of injury from the motorcycle falling.



Warning

A torque wrench of known accurate calibration must be used when fitting this accessory kit. Failure to tighten any of the fasteners to the correct torque specification may result in loss of motorcycle control and an accident.

Note:

- **The luggage rack kit can only be used when the accessory quick release sissy bar is fitted to the motorcycle.**

1. Remove the original reflector from the rear fender.

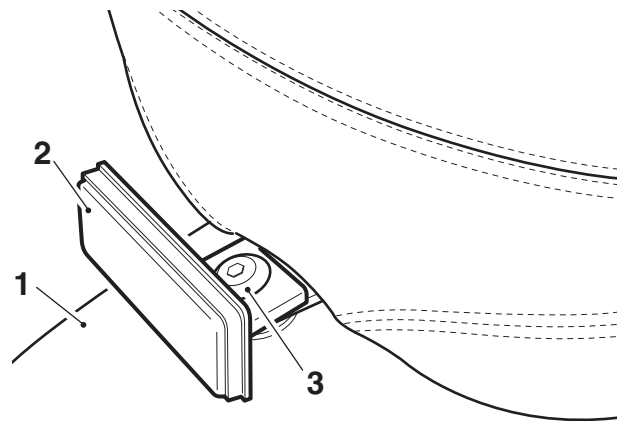

1. Rear fender

2. Reflector

3. Fixing

2. Refit the reflector fixing through the seat rear mounting bracket, into the rear fender. Tighten the fixing to **9 Nm**. Retain the reflector for reuse.
3. Remove the sissy bar from the motorcycle.
4. Remove the sissy bar clamp plates and fixings. Retain the clamp plates and fixings for reuse.

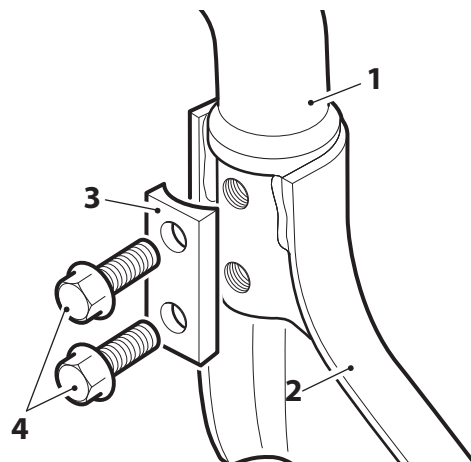

1. Sissy bar

2. Sissy bar side plate, left hand

3. Clamp plate

4. Fixing

5. Locate the luggage rack into position against the left hand sissy bar and side plate.
6. Align the left hand side luggage rack mounting with the sissy bar, left hand side plate and clamp plate fixing holes.

7. Secure the luggage rack with the original sissy bar fixings, as shown below. Do not fully tighten the fixings at this stage.

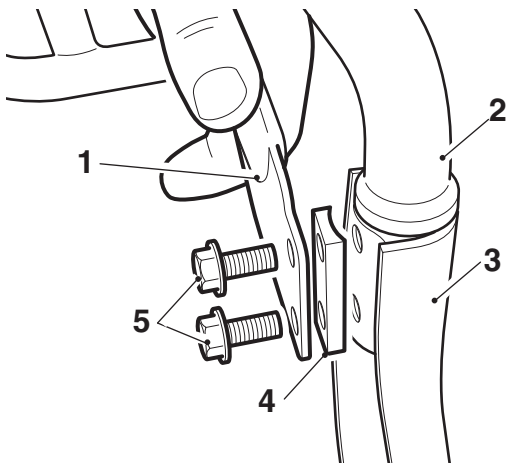

- 1. Luggage rack mounting, left hand
- 2. Sissy bar
- 3. Side plate, left hand
- 4. Clamp plate
- 5. Fixings

8. Repeat for the right hand side luggage rack fixing point.
9. Refit the sissy bar to the motorcycle and lock in position.
10. Ensure the sissy bar and luggage rack are aligned centrally and fully secured in place. Tighten the four M8 bolts to **27 Nm**.
11. Remove the protective film from the adhesive pad.
12. Wrap the adhesive pad around the rear of the luggage rack, as shown below. Ensure the adhesive pad is centrally located, the warning label on the luggage rack will provide a guide position. Note, The warning label should not be obscured by the adhesive pad.

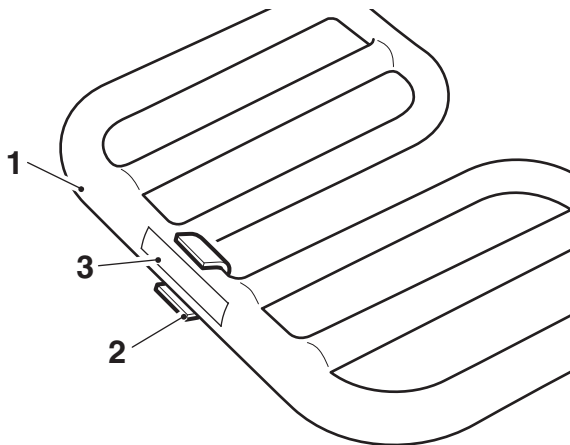

- 1. Luggage rack
- 2. Adhesive pad
- 3. Warning label

13. Fit and hold the upper and lower reflector brackets in position over the adhesive pad.

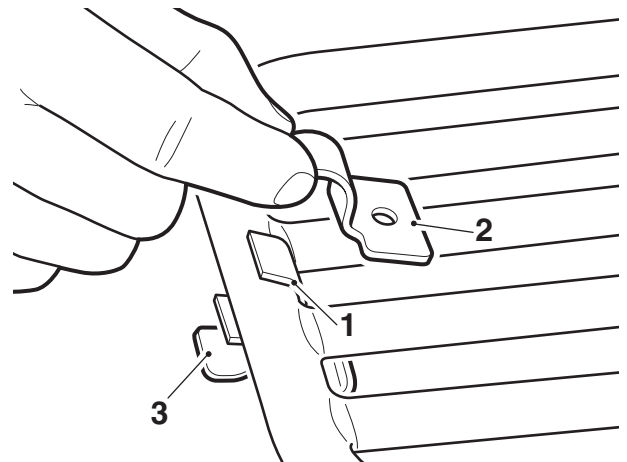

- 1. Adhesive pad
- 2. Reflector bracket, upper
- 3. Reflector bracket, lower

14. Fit the reflector onto the brackets and secure with the M6 screw and nut provided.

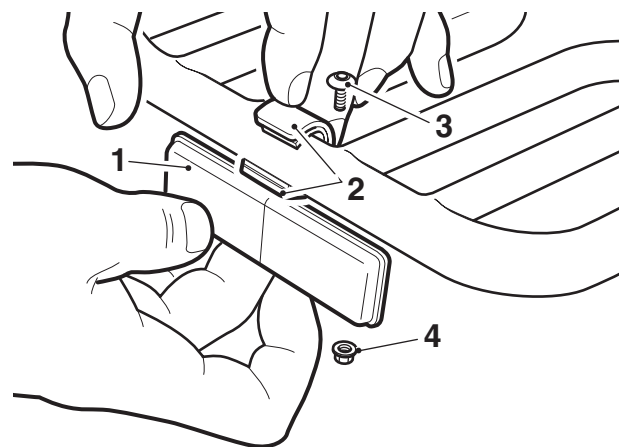

- 1. Reflector
- 2. Brackets
- 3. Screw, M6
- 4. Nut, M6

15. Align the reflector in a vertical position. Tighten the fixings to **8 Nm**.



Warning

Never ride an accessory equipped motorcycle (including those fitted with Triumph approved windscreens and luggage systems) at speeds above 80 mph (130 km/h).

The presence of accessories such as windscreens and luggage systems will cause changes in the stability and handling of the motorcycle. Failure to allow for changes in motorcycle stability may lead to loss of control or an accident.

Remember that the 80 mph (130 km/h) limit will be reduced by the fitting of non-approved accessories, incorrect loading, worn tyres, overall motorcycle condition and poor road or weather conditions.



Warning

The maximum safe load for the luggage rack is 7 Kg (15 lbs). Never exceed this loading limit as this may cause the motorcycle to become unstable leading to loss of control and an accident.



Warning

After fitting the accessory kit the motorcycle will exhibit new handling characteristics. Operate the motorcycle in a safe area free from traffic to gain familiarity with any new characteristics. Operation of the motorcycle when not familiar with any new handling characteristics may result in loss of motorcycle control and an accident.



Warning

If, after fitment of this accessory kit, you have any doubt about the performance of any aspect of the motorcycle, contact an authorised Triumph dealer and do not ride the motorcycle until the authorised dealer has declared it fit for use. Riding a motorcycle when there is any doubt as to any aspect of the performance of the motorcycle may result in loss of control of the motorcycle leading to an accident.



Warning

The motorcycle must not be operated above the legal road speed limit except in closed course conditions.



Warning

Only operate this Triumph motorcycle at high speed in closed-course on road competition or on closed course racetracks. High speed operation should only be attempted by riders who have been instructed in the techniques necessary for high speed riding and are familiar with the motorcycle's characteristics in all conditions.

High speed operation in any other circumstances is dangerous and will lead to loss of motorcycle control and an accident.