



Accessory Fitting Instructions

Backrest Upright Kit, Chrome	
Kit Number	Models Affected
A9750803	Bonneville Speedmaster from VIN 739143
The following Rack Kit must only be used when a Backrest Upright Kit is fitted.	
Luggage Rack Kit, Chrome	
Kit Number	Models Affected
A9750802 A9750845	Bonneville Speedmaster from VIN 739143

Thank you for choosing this Triumph genuine accessory kit. This accessory kit is the product of Triumph's use of proven engineering, exhaustive testing, and continuous striving for superior reliability, safety and performance.

Completely read all of these instructions before commencing the installation of the accessory kit in order to become thoroughly familiar with the kit's features and the installation process.

These instructions should be considered a permanent part of your accessory kit, and should remain with it even if your accessory equipped motorcycle is subsequently sold.

Parts Supplied: A9750803

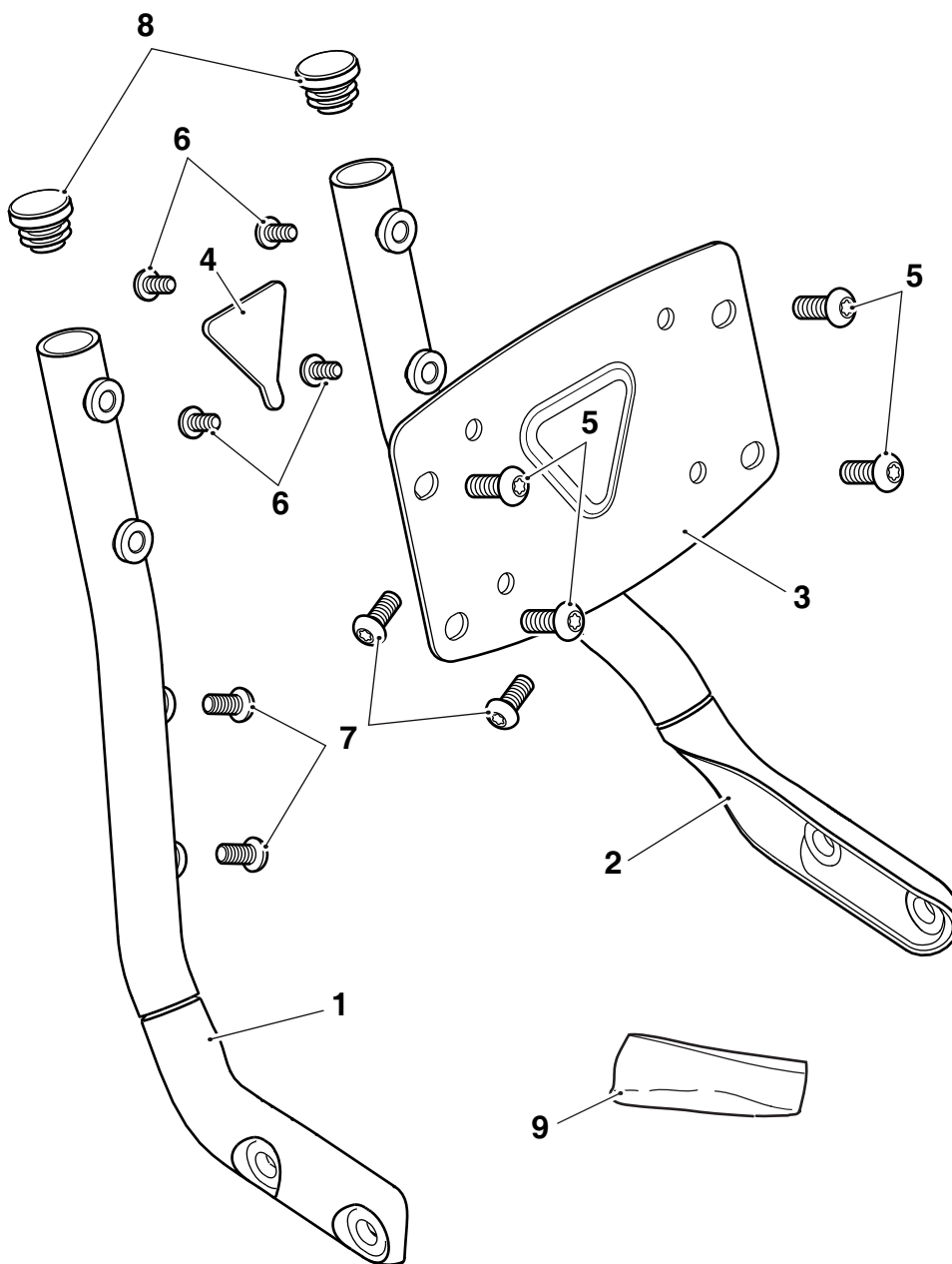

1.	Backrest upright, right hand	1 off	6.	Fixing, M6 x 12 mm	4 off
2.	Backrest upright, left hand	1 off	7.	Fixing, M6 x 20 mm	4 off
3.	Backrest plate	1 off	8.	Finisher cap	2 off
4.	Badge	1 off	9.	Cleaning wipe	1 off
5.	Fixing, M8 x 20 mm	4 off			

Parts Supplied: A9750802, A9750845

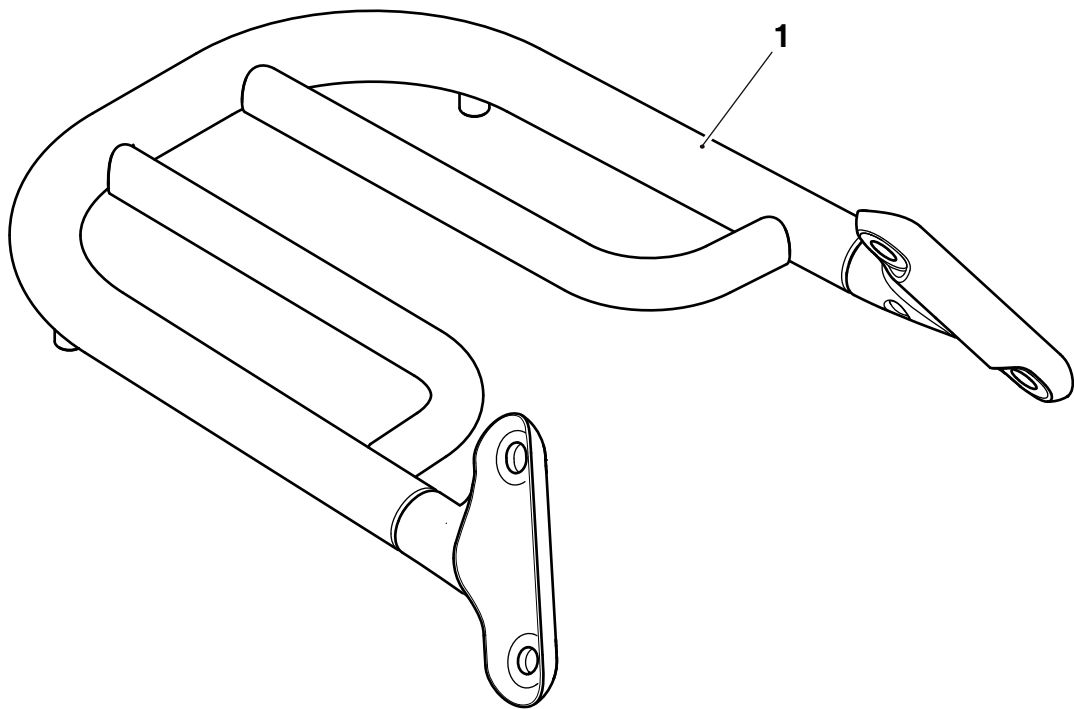

1. Luggage rack	1 off		
-----------------	-------	--	--

! Warning

Fit only genuine Triumph accessories to those models approved by Triumph as listed in the associated Triumph fitting instructions. The accessory kits covered in this instruction are designed for use on specific models of Triumph motorcycle. The accessory kits and the models applicable are listed at the start of the instruction. They should never be fitted to any other Triumph model or to any other manufacturer's motorcycle. Fitting an accessory kit to a Triumph model not listed, or to any other manufacturer's motorcycle will affect the performance, stability and handling of the motorcycle. This may affect the rider's ability to control the motorcycle and could result in an accident causing severe injuries or death.

! Warning

Make sure the motorcycle is supported. A correctly supported motorcycle will help prevent it from falling. An unstable motorcycle may fall, causing injury to the operator or damage to the motorcycle.

! Warning

A torque wrench of known accurate calibration must be used when fitting this accessory kit. Failure to tighten any of the fasteners to the correct torque specification may affect motorcycle performance, handling and stability. This may result in loss of motorcycle control and an accident.

! Warning

Always have Triumph approved parts, accessories and conversions fitted by a trained technician of an authorised Triumph dealer. The fitment of parts, accessories and conversions by a technician who is not of an authorised Triumph dealer may affect the handling, stability or other aspects of the motorcycle's operation which may result in loss of motorcycle control and an accident.

Note:

- Triumph offers a broad range of approved genuine accessories for your motorcycle. We cannot therefore cover all possible equipment variations in these instructions. For removal and installation of Triumph Genuine Accessories, always refer to the instructions supplied with the respective accessory kit. To obtain additional copies of any Triumph accessory instructions, visit www.triumphinstructions.com or contact your authorised Triumph dealer.

Backrest Upright Installation (with or without a Luggage Rack Kit)

Note:

- The luggage rack kit cannot not be fitted without a backrest upright kit.

Caution

Care should be taken when removing any original parts, or installing new parts, to ensure they do not contact any part of the rear mudguard when they are removed from, or fitted to, the motorcycle. If any part is allowed to contact the rear mudguard it could result in damage to the paintwork.

- Remove the original grab rail, as described in the Service Manual. Retain the grab rail for reuse if the motorcycle is to be returned to its original condition. Retain the fixings for reuse.
- Collect the right hand and left hand backrest uprights and finisher caps from the kit.
- Fit the finisher caps in to the left hand and right hand backrest uprights, as shown.

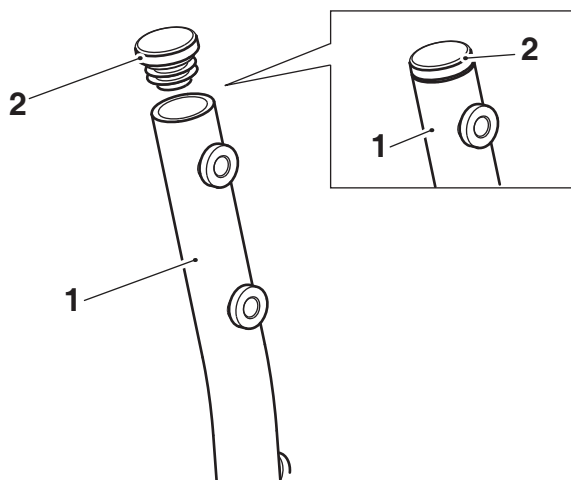

- Backrest upright, right hand shown
- Finisher cap

Note:

- For backrest upright installation without a luggage rack kit follow steps 4 to 11, then continue from step 19.
- For backrest upright installation with a luggage rack kit, continue from step 12.

Installation without a Luggage Rack Kit

- Fit the M6 x 20 mm fixings from the kit to the left hand and right hand backrest uprights, as shown. Tighten the fixings to **9 Nm**.

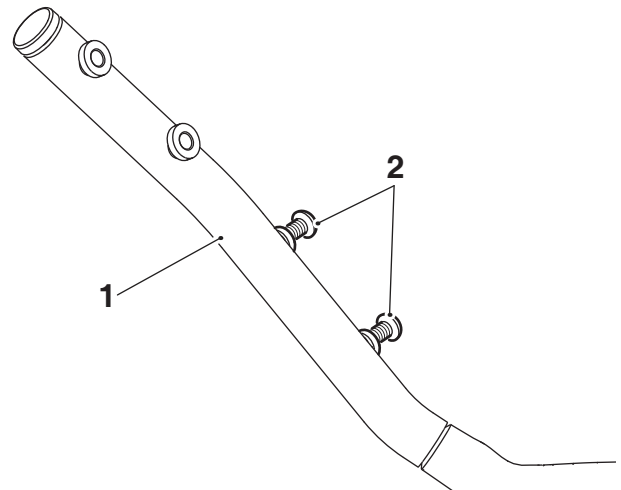

- Backrest upright, right hand shown
- Fixings, M6 x 20 mm

- Align the right hand upright with the grab rail fixing positions on the fender rail and fit the original fixings. Do not fully tighten the fixings at this stage.

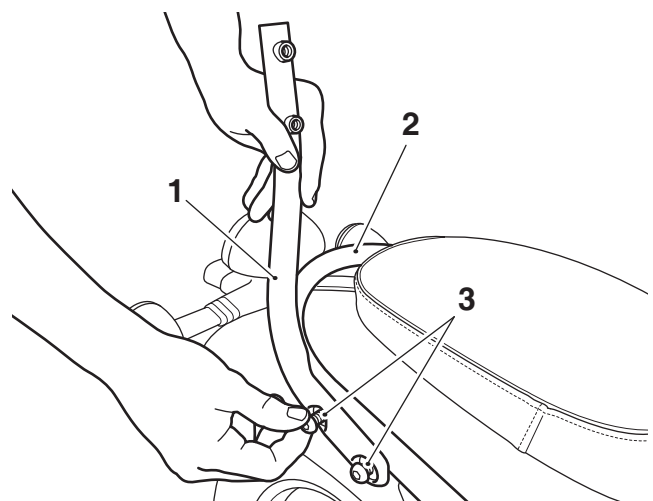

- Backrest upright, right hand
- Fender rail
- Fixings

- Fit the backrest plate to the right hand backrest upright with the triangular recess facing the rear of the motorcycle, as shown. Secure the backrest plate to the right hand upright with two M8 x 20 mm fixings from the kit. Do not fully tighten the fixings at this stage.

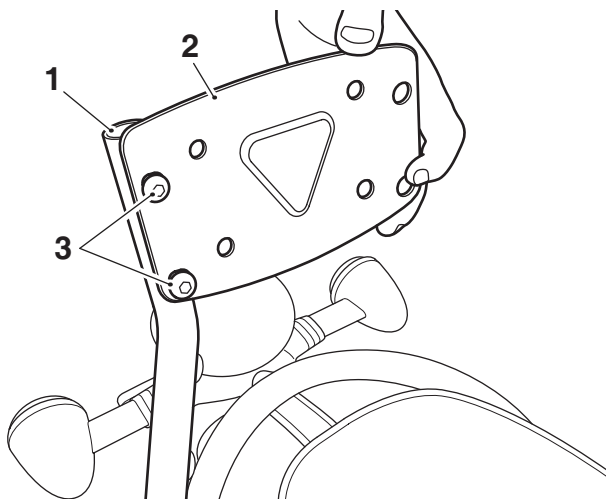

- Backrest upright, right hand
- Backrest plate
- Fixings, M8 x 20 mm

- Align the left hand upright with the fixing positions on the backrest plate and fit two M8 x 20 mm fixings from the kit. Do not fully tighten the fixings at this stage.

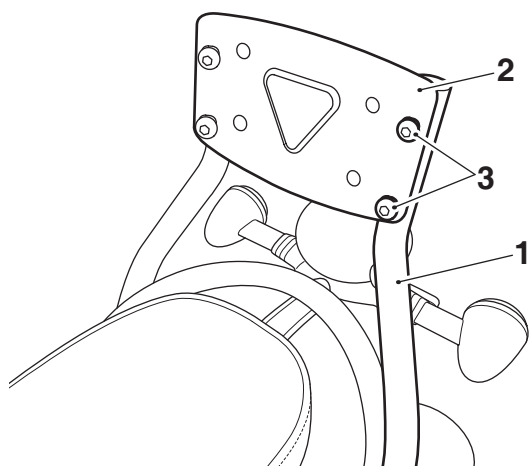

- Backrest upright, left hand
- Backrest plate
- Fixings, M8 x 20 mm

- Align the left hand upright with the fixing positions on the fender rail and fit the original fixings. Do not fully tighten the fixings at this stage.

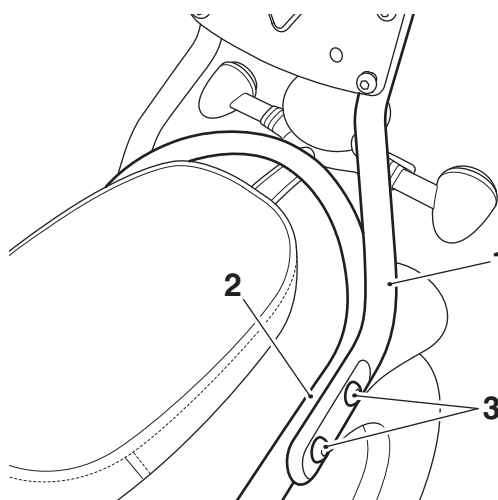

- Backrest upright, left hand side
- Fender rail
- Fixings

Note:

- Tighten the fixings in the order detailed below.**
- Tighten the right hand backrest upright fixings to **20 Nm**.
 - Tighten the left hand backrest upright fixings to **20 Nm**.
 - Tighten the backrest plate fixings to **20 Nm**.

Installation with a Luggage Rack Kit

- Align the luggage rack mountings with the fixing positions on the left hand and right hand backrest uprights. Fit the M6 x 20 mm fixings from the kit. Do not fully tighten the fixings at this stage.

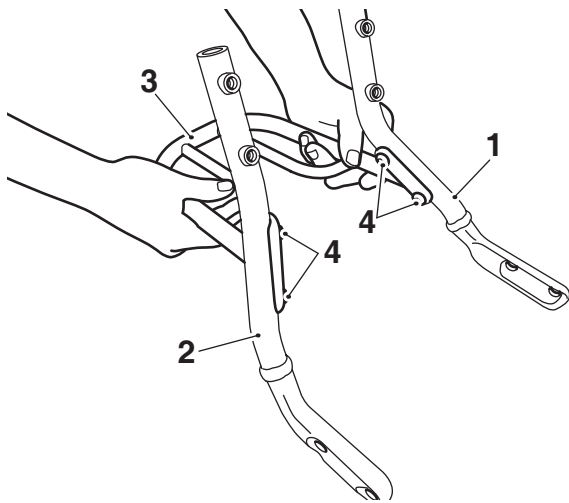

- Backrest upright, left hand
- Backrest upright, right hand
- Luggage rack
- Fixings, M6 x 20 mm

- Align the backrest uprights with the grab rail fixing positions on the fender rail and fit the original fixings. Do not fully tighten the backrest upright fixings at this stage.

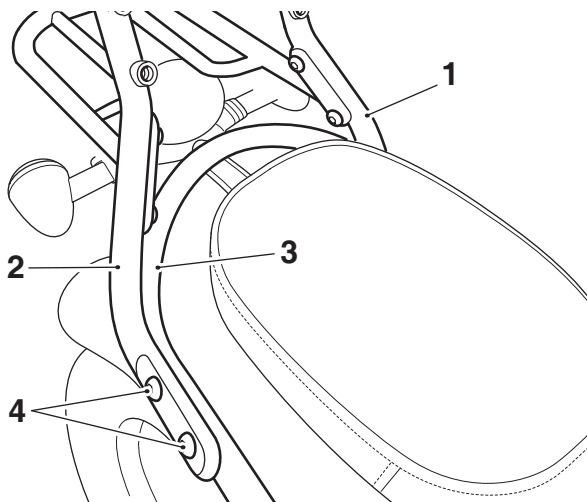

- Backrest upright, left hand
- Backrest upright, right hand
- Fender rail
- Fixings, right hand shown

- Fit the backrest plate to the left hand and right hand backrest uprights with the triangular recess facing the rear of the motorcycle, as shown. Secure the backrest plate to the right hand upright with the M8 x 20 mm fixings from the kit. Do not fully tighten the fixings at this stage.

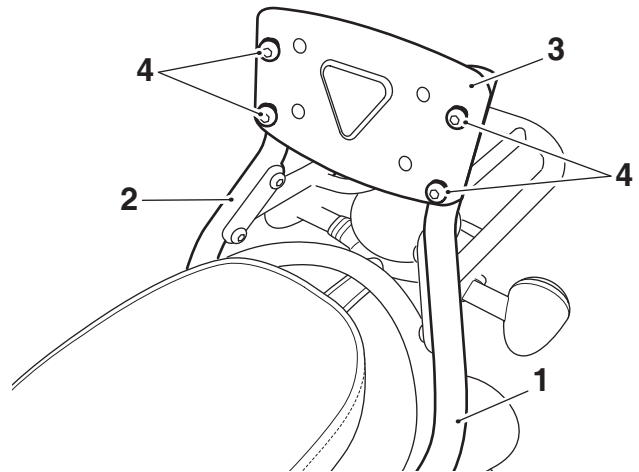

- Backrest upright, left hand
- Backrest upright, right hand
- Backrest plate
- Fixings, M8 x 20 mm

Note:

- Tighten the fixings in the order detailed below.**
- Tighten the right hand backrest upright fixings to **20 Nm**.
 - Tighten the left hand backrest upright fixings to **20 Nm**.
 - Tighten the backrest plate fixings to **20 Nm**.
 - Tighten the luggage rack fixings to **9 Nm**.

Badge and Backrest Pad Installation (with or without a Luggage Rack)

Note:

- Read the warning notices printed on the cleaning wipe packet.
 - The surface to which the badge is to affixed to the backrest plate must be clean and dry to ensure that the adhesive has a sound base to adhere to. Use the cleaning wipe supplied for this purpose.
19. Using the cleaning wipe provided, clean the recessed triangular area of the backrest plate.

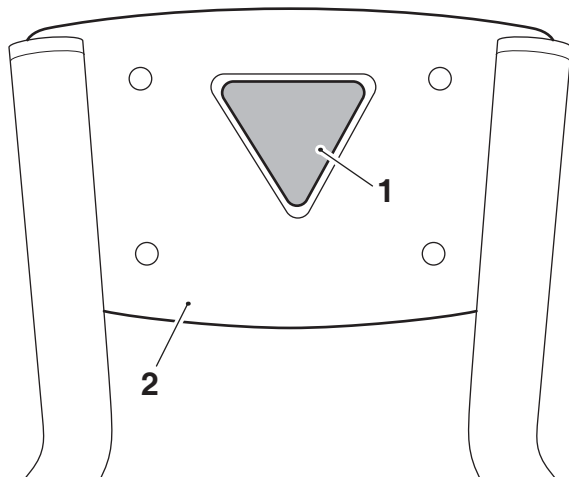

1. Cleaning area
2. Backrest plate



Caution

When fitting self-adhesive parts care must be taken to ensure positioning is correct and accurate. Once the adhesive has been attached to the mounting surface, there is no satisfactory method of removal and re-positioning if incorrectly aligned. Initial bonding is instant, full bonding is achieved after 72 hours.

20. Remove the backing strip from the badge and fit the badge into the triangular recess in the backrest plate, as shown. Press firmly to secure the badge to the backrest plate.

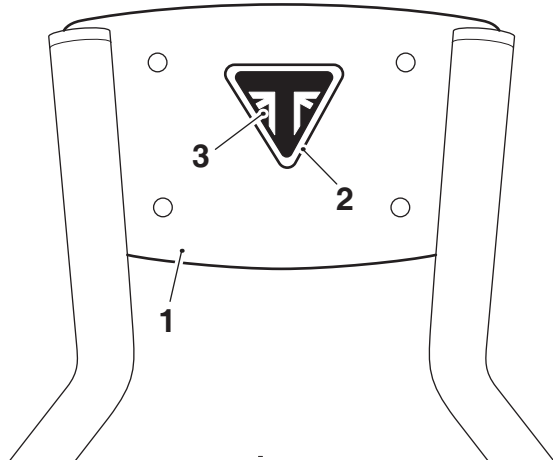

1. Backrest plate
2. Recess
3. Badge

Note:

- There are a number of different styles of backrest pad available. Refer to the Triumph Accessory Catalogue for details.
21. Align the backrest pad with the fixing holes in the backrest plate and fit four M6 x 12 mm screws from the kit. Tighten the screws to 6 Nm.

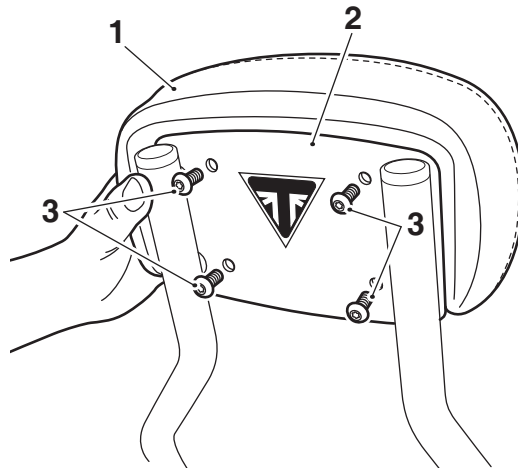

1. Backrest pad
2. Backrest plate
3. Fixings

 **Warning**

Always ensure that any load carried on a luggage rack is correctly secured such that it will not move around while the motorcycle is in motion.

An adhesive label on the luggage rack details the maximum safe load for the luggage rack, which is 3 kg (6.6 lbs).

Incorrect loading may result in an unsafe riding condition, which may result in loss of motorcycle control and an accident.

 **Warning**

Incorrect loading may result in an unsafe riding condition leading to loss of motorcycle control and an accident.

Always ensure any loads carried are evenly distributed on both sides of the motorcycle. Ensure that the load is correctly secured such that it will not move around while the motorcycle is in motion.

Always check the load security regularly (though not while the motorcycle is in motion) and ensure that the load does not extend beyond the rear of the motorcycle. Never exceed the maximum vehicle loading weight. Refer to the Owner's Handbook for the maximum loading weight specification.

This maximum loading weight is made up from the combined weight of the rider, passenger, any accessories fitted and any load carried.

For models that have adjustable suspension settings, ensure that front and rear spring preload and damping settings are suitable for the loading condition of the motorcycle. Refer to the Owner's Handbook.

Note the maximum permissible payload for the luggage rack is stated on a label inside the rack.

 **Warning**

To maintain the handling characteristics of the motorcycle when riding with luggage or with a passenger and luggage, refer to the Owner's Handbook for the correct suspension settings.

Incorrect suspension settings could significantly change the handling characteristics of the motorcycle, leading to loss of motorcycle control and an accident.

 **Warning**

After fitting the accessory kit the motorcycle will exhibit new handling characteristics. Operate the motorcycle in a safe area free from traffic to gain familiarity with any new characteristics. Operation of the motorcycle when not familiar with any new handling characteristics may result in loss of motorcycle control and an accident.

 **Warning**

If, after fitting this accessory kit, you have any doubt about the performance of any aspect of the motorcycle, contact an authorised Triumph dealer and do not ride the motorcycle until the authorised dealer has declared it fit for use. Riding a motorcycle when there is any doubt as to any aspect of the performance of the motorcycle may result in loss of motorcycle control and an accident.

 **Warning**

Never ride an accessory-equipped motorcycle at speeds above 80 mph (130 km/h).

The presence of accessories will cause changes in the stability and handling of the motorcycle. Failure to allow for changes in motorcycle stability may result in loss of motorcycle control and an accident. Remember that the 80 mph (130 km/h) limit will be reduced by the fitting of non-approved accessories, incorrect loading, worn tyres, overall motorcycle condition and poor road or weather conditions.

 **Warning**

The motorcycle must not be operated above the legal road speed limit except in closed-course conditions.

 **Warning**

Only operate this Triumph motorcycle at high speed in closed-course, on-road competition or on closed-course racetracks. High-speed operation should only be attempted by riders who have been instructed in the techniques necessary for high-speed riding and are familiar with the motorcycle's characteristics in all conditions.

High-speed operation in any other circumstances is dangerous and may result in loss of motorcycle control and an accident.