



## Accessory Fitting Instructions

Side Mounted Licence Plate Kit - USA Only	
Kit Number	Models Affected
A9750730	Bonneville Bobber, Bonneville Bobber - Black, Bonneville Bobber TFC, Bonneville Speedmaster from VIN 739143

Thank you for choosing this Triumph genuine accessory kit. This accessory kit is the product of Triumph's use of proven engineering, exhaustive testing, and continuous striving for superior reliability, safety and performance.

Completely read all of these instructions before commencing the installation of the accessory kit in order to become thoroughly familiar with the kit's features and the installation process.

These instructions should be considered a permanent part of your accessory kit, and should remain with it even if your accessory equipped motorcycle is subsequently sold.

## Parts Supplied

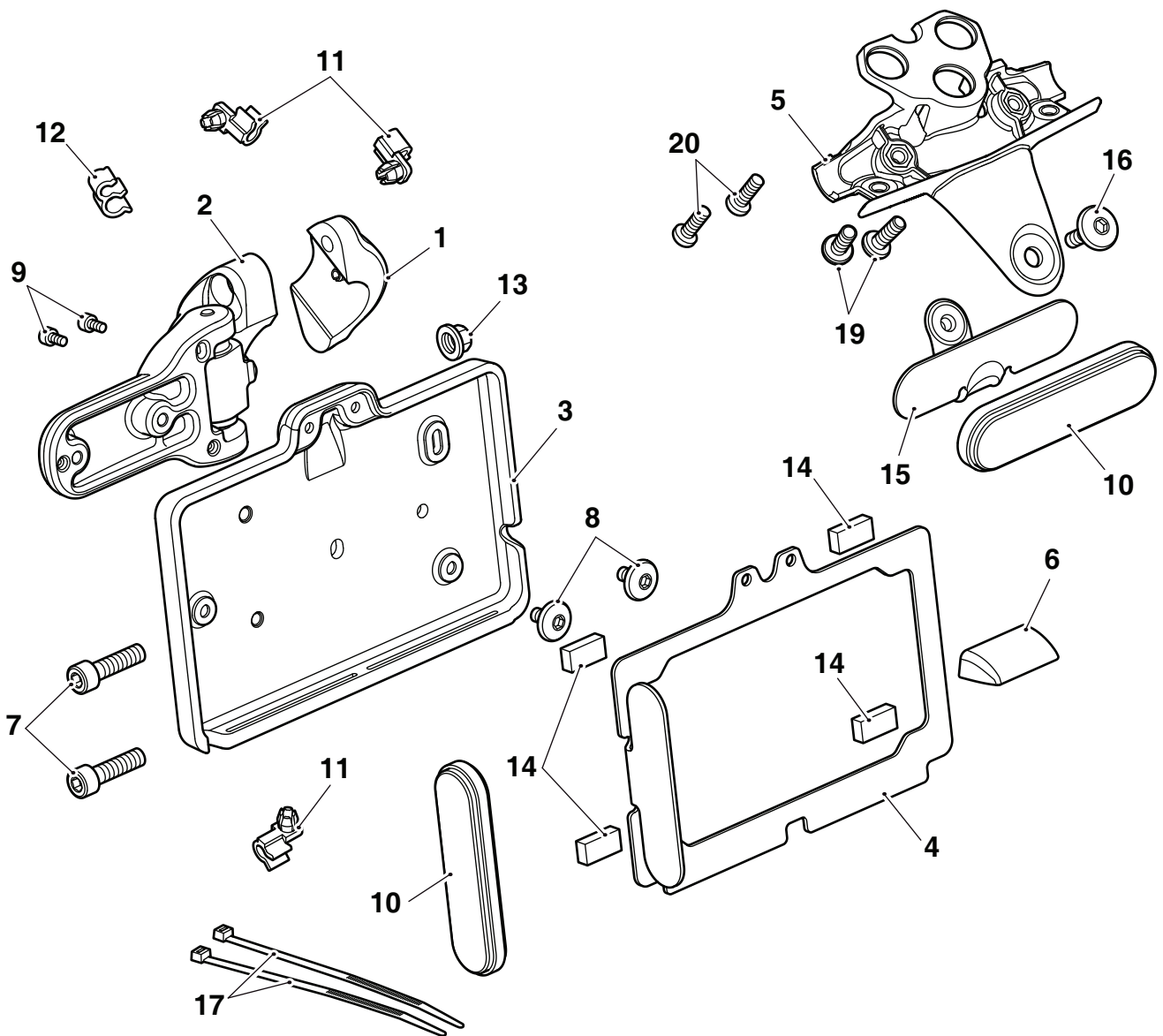

1.	Swinging arm clamp, rear	1 off	12.	Cable clip, twin	1 off
2.	Swinging arm clamp, pivoting	1 off	13.	Lock nut, M8	1 off
3.	Licence plate holder, rear	1 off	14.	Foam insert, licence plate holder	4 off
4.	Licence plate holder, front	1 off	15.	Reflector bracket	1 off
5.	Rear light mount	1 off	16.	Fixing, M6 x 20 mm	1 off
6.	Licence plate light	1 off	17.	Cable tie	2 off
7.	Fixing, M8 x 30 mm	2 off	18.	Foam tape (not shown)	1 off
8.	Fixing, M6 x 8 mm	2 off	19.	Fixing, M6 x 16 mm	2 off
9.	Fixing, M4 x 8 mm	2 off	20.	Fixing, M5 x 14 mm (encapsulated)	2 off
10.	Reflector	2 off	21.	Cleaning wipe (not shown)	3 off
11.	Cable clip	3 off			

## Warning

The accessory kits covered in this instruction are designed for use on specific models of Triumph motorcycle. The accessory kits and the models applicable are listed at the start of the instruction. They should not be fitted to any other Triumph model or to any other manufacturer's motorcycle. Fitting an accessory kit to a Triumph model not listed, or to any other manufacturer's motorcycle will affect the performance, stability and handling of the motorcycle. This may result in loss of motorcycle control and an accident.

## Warning

Always have Triumph approved parts, accessories and conversions fitted by a trained technician of an authorised Triumph dealer. The fitment of parts, accessories and conversions by a technician who is not of an authorised Triumph dealer may affect the handling, stability or other aspects of the motorcycle's operation which may result in loss of motorcycle control and an accident.

## Warning

Throughout this operation, ensure that the motorcycle is stabilised and adequately supported to prevent risk of injury from the motorcycle falling.

## Warning

A torque wrench of known accurate calibration must be used when fitting this accessory kit. Failure to tighten any of the fasteners to the correct torque specification may affect motorcycle performance, handling and stability. This may result in loss of motorcycle control and an accident.

### Note:

- **Triumph offers a broad range of approved genuine accessories for your motorcycle. We cannot therefore cover all possible equipment variations in these instructions. For removal and installation of Triumph Genuine Accessories, always refer to the instructions supplied with the respective accessory kit. To obtain additional copies of any Triumph accessory instructions, visit [www.triumphinstructions.com](http://www.triumphinstructions.com) or contact your authorised Triumph dealer.**

1. Disconnect the battery, negative (black) lead first.
2. Remove the battery as described in the Service Manual.
3. Remove the rear wheel, as described in the Service Manual.
4. Clean the swinging arm thoroughly.

### Note:

- **If a Triumph Accessory Short Mudguard Kit is fitted continue from step 25.**
5. Remove the rear light mount assembly as described in the Service Manual. Discard the fixings but retain the washers for reuse.
  6. Remove the two fixings from the rear light mount. If replacement fixings are provided in the kit discard the fixings. If new fixings are not provided in the kit retain the fixings for reuse.

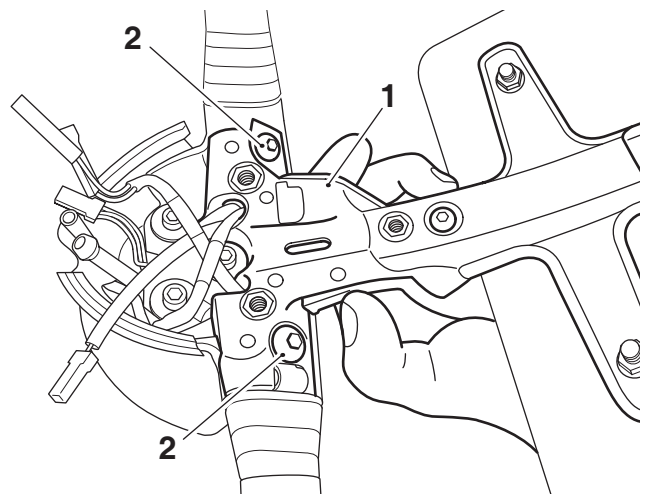

1. Rear light mount
2. Fixings

- Remove the rear light and rubber trim from the rear mount. Retain the rear light, rubber trim and fixings for reuse.

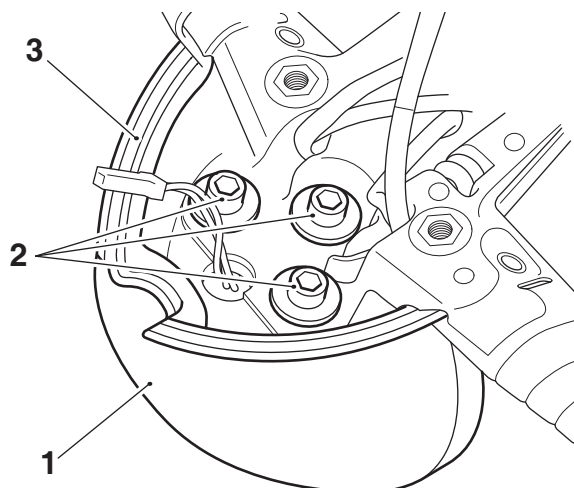

- Rear light
- Fixings
- Rubber trim

- Remove the flanged sleeves and rubber grommet seal from the rear light mount. Retain the flanged sleeves and rubber grommet seal for reuse. Retain the rear light mount for reuse if the motorcycle is to be returned to its original condition.

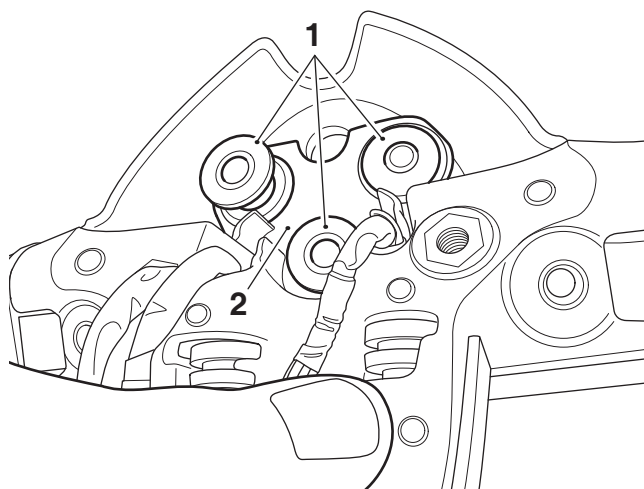

- Flanged sleeves
- Rubber grommet seal

- Fit the indicator mounting bracket to the rear light mount from the kit with the indicator harness routed through the mount as shown and secure with the M5 x 14 mm fixings if provided in the kit, or if new fixings are not provided in the kit re-use the original fixings. Tighten the fixings to **3 Nm**.

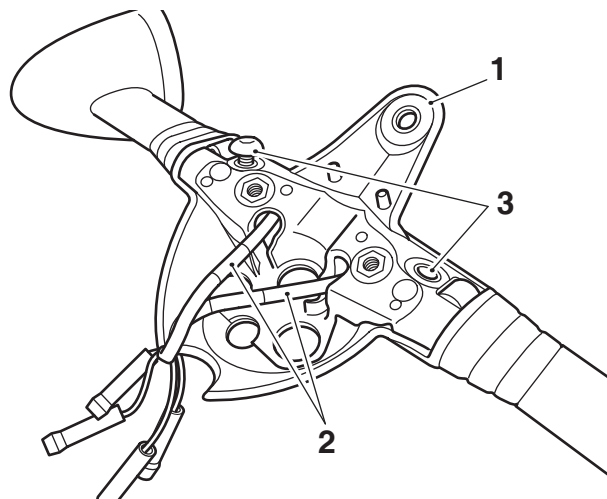

- Rear light mount
- Indicator harnesses
- Fixings, M5 x 14 mm

- Fit the rubber grommet seal to the rear light mount as shown.

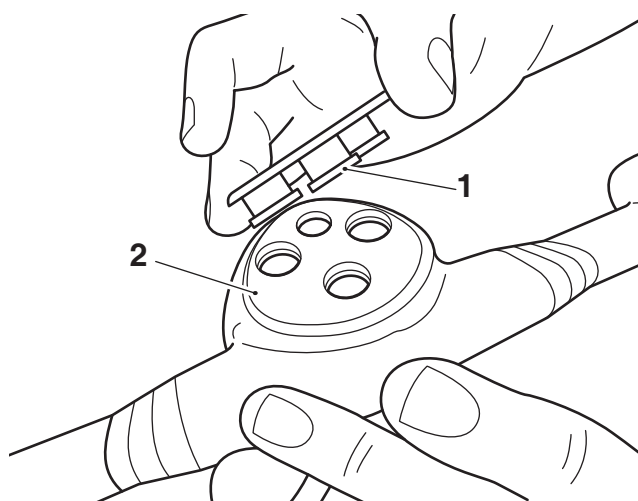

- Rubber grommet seal
- Rear light mount

11. Fit the three flanged sleeves into the rubber grommet seal as shown.

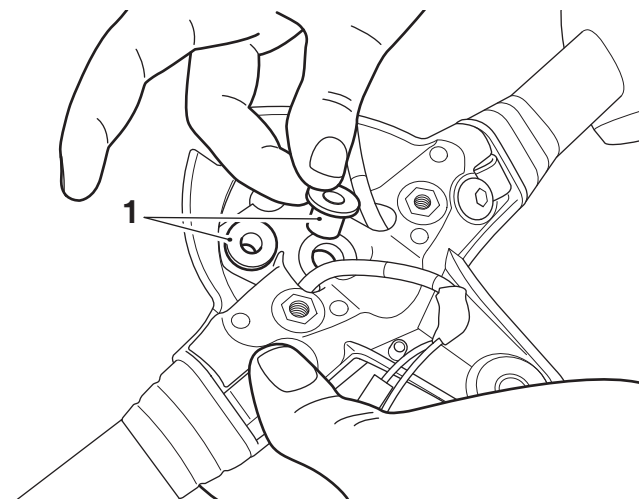

**1. Flanged sleeves**

12. Route the rear light harness through the rubber grommet seal as shown.

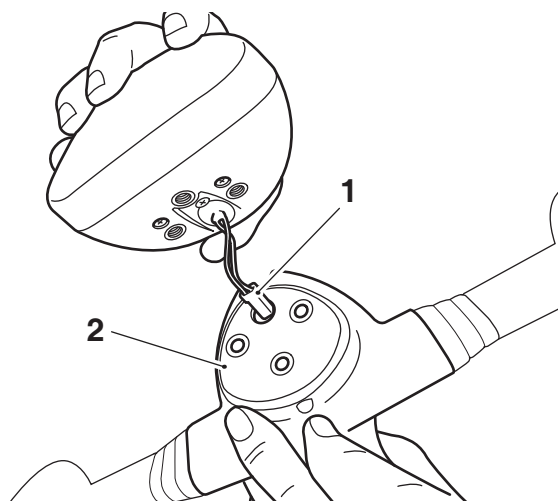

**1. Rear light harness  
2. Rubber grommet seal**

13. Fit the rear light assembly and secure with the original fixings as shown. Tighten the fixings to **3 Nm**.

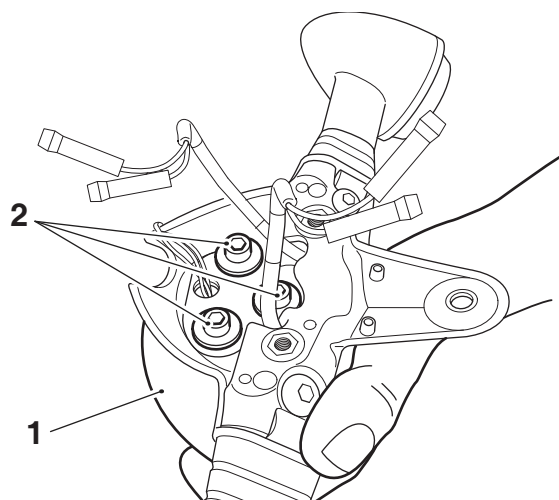

**1. Rear light  
2. Fixings**

14. Collect the reflector bracket and a reflector from the kit.  
15. Locate the licence plate light harness connector on the main wiring harness above the battery location, as shown. Remove the blanking plug.

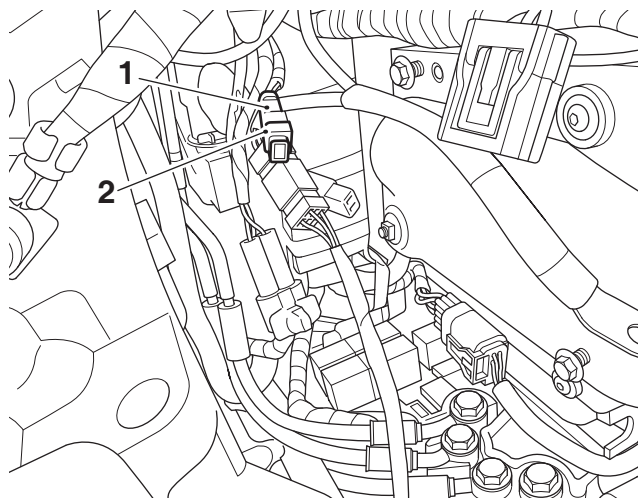

**1. Main harness licence plate light connector  
2. Blanking plug**

16. Fit the blanking plug to the licence plate light harness connector at the rear mudguard as shown.

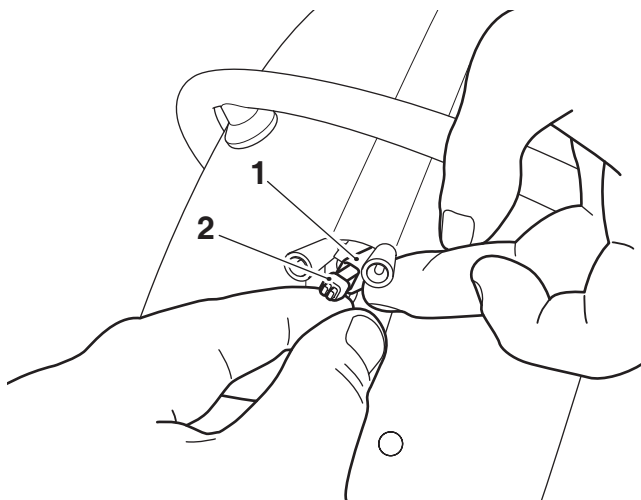

1. Licence plate light harness connector  
2. Blanking plug

17. Reconnect the rear light harness to the rear harness.
18. Reconnect the rear indicators to the rear harness. The red taped connector on the harness connects to the right hand side white indicator lead connector. The green wired connector on the rear harness connects to the left hand side white indicator lead connector. The two remaining rear harness and indicator connectors are non handed common connections.
19. Feed the harnesses through the aperture in the rear mudguard. Ensure the rubber trim is located correctly on the rear light mount and fit the rear light mount to the rear mudguard.

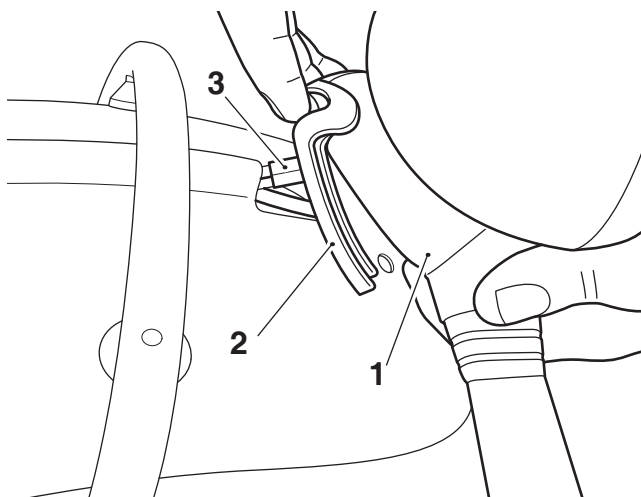

1. Rear light mount  
2. Rubber trim  
3. Harnesses

20. Fit the M6 x 16 mm rear light fixings from the kit with the original washers from the underside of the mudguard. Tighten the fixings to **8 Nm**.

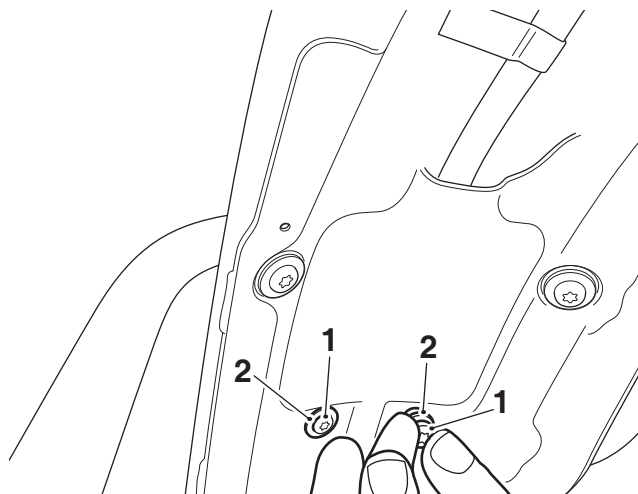

1. Fixings, M6 x 16 mm  
2. Washer

**Note:**

- Read the warning notices printed on the cleaning wipe packet provided in the kit.
  - The surface to which the reflector is affixed must be clean and dry to ensure that the adhesive has a sound base to adhere to. Use a cleaning wipe supplied for this purpose.
21. Remove the protective tape from the rear of the reflector and attach the reflector to the reflector bracket, as shown.

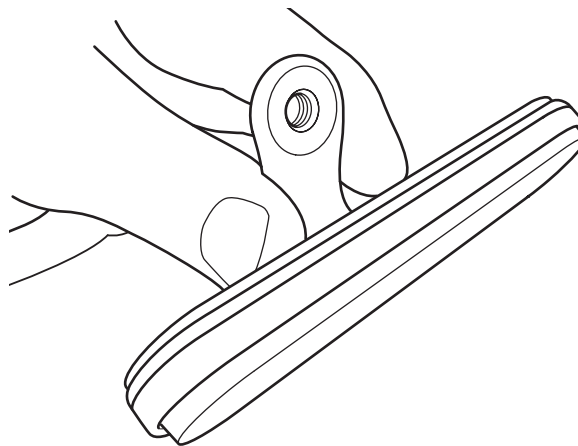

22. Fit the reflector bracket from the kit to the rear light mount and secure with the M6 x 20 mm fixing from the kit. Tighten the fixing to **8 Nm**.

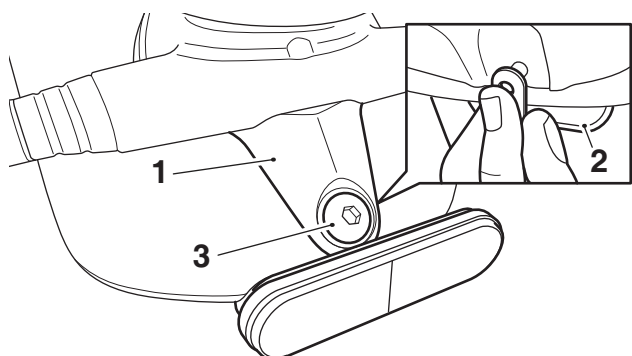

1. Rear light mount
2. Reflector bracket
3. Fixing, M6 x 20 mm

**Bonneville Bobber, Bonneville Bobber Black and Bonneville Bobber TFC Only**

23. Remove the left hand rear reflector. Retain the reflector for reuse if the motorcycle is to be returned to its original condition. Discard the lock nut. Refit the fixing with the M8 lock nut from the kit to retain the mudguard stay. Tighten the fixing to **30 Nm**.

**Bonneville Speedmaster from VIN 739143**

24. Remove the left hand rear reflector. Retain the reflector and fixing for reuse if the motorcycle is to be returned to its original condition. Discard the lock nut.

**All Models**

25. Fit a cable clip from the kit to the inside of the left hand swinging arm as shown.

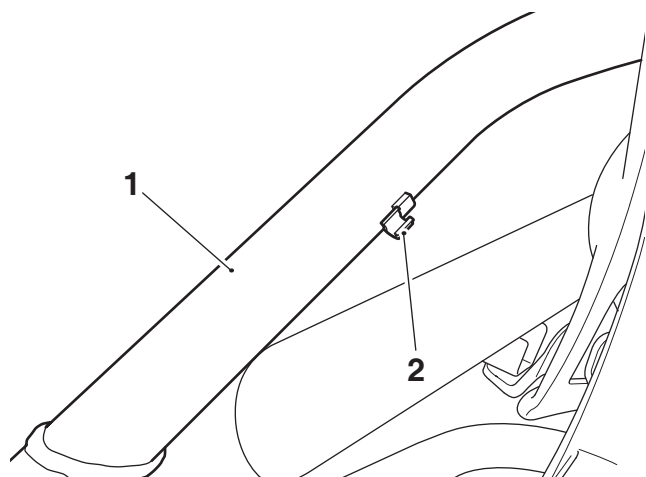

1. Swinging arm, left hand side
2. Cable clip

26. Fit a cable clip from the kit to the licence plate rear swinging arm clamp as shown.

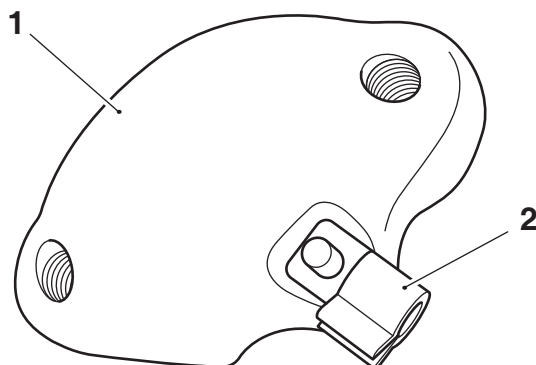

1. Rear swinging arm clamp
2. Cable clip

27. Fit the remaining cable clip to the licence plate pivoting swinging arm clamp as shown.

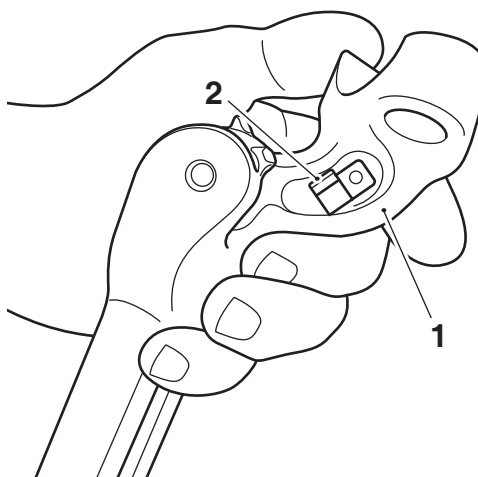

1. Pivoting swinging arm clamp
2. Cable clip

28. Fit the rear licence plate holder onto the pivoting swinging arm clamp and secure with the M6 x 8 mm fixings from the kit. Do not fully tighten the fixings at this stage.

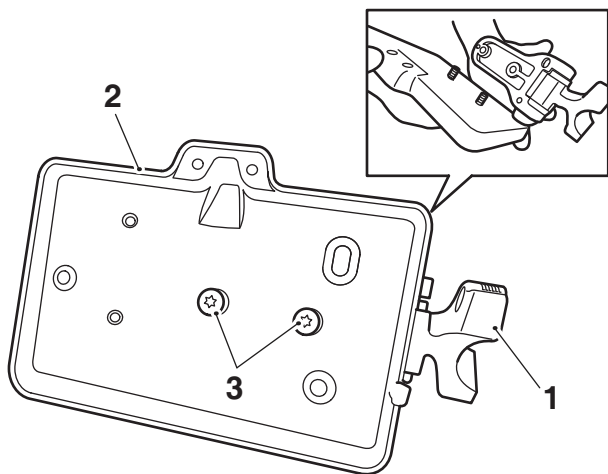

- 1. Pivoting swinging arm clamp
- 2. Rear licence plate holder
- 3. Fixing, M6 x 8 mm

29. Position the rear swinging arm clamp on the left hand swinging arm ensuring the location peg in the clamp locates correctly in the hole in the swinging arm, as shown.

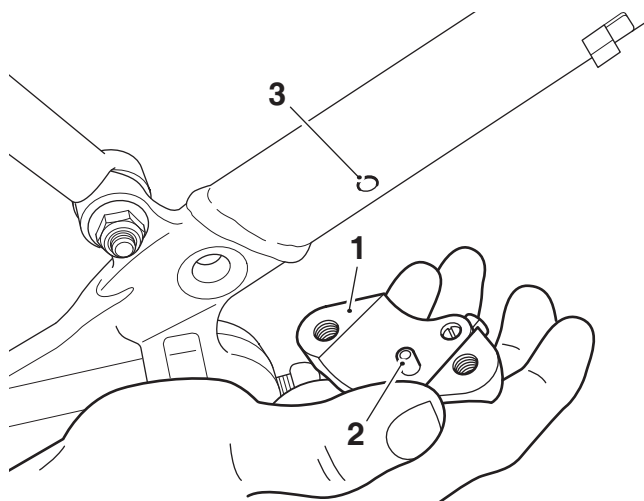

- 1. Rear swinging arm clamp
- 2. Location peg
- 3. Location hole, swinging arm

30. Align the pivoting swinging arm clamp with the rear swinging arm clamp and fit the M8 x 30 mm fixings from the kit. Tighten the fixings to **24 Nm**.

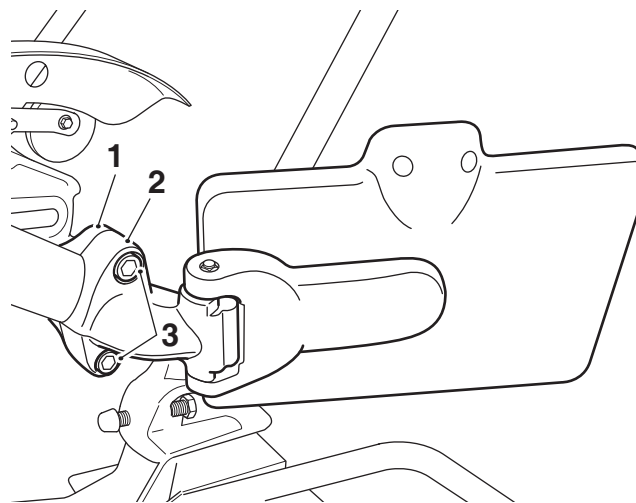

- 1. Rear swinging arm clamp
- 2. Pivoting swinging arm clamp
- 3. Fixings, M8 x 30 mm

31. Ensure the rear licence plate holder is horizontal and tighten the fixings to **12 Nm**.

**Note:**

- Read the warning notices printed on the cleaning wipe packet provided in the kit.
- The surface to which the foam pads are affixed must be clean and dry to ensure that the adhesive has a sound base to adhere to. Use a cleaning wipe supplied for this purpose.

32. Remove the protective tape from the rear of the foam pads from the kit and attach the foam pads to the rear of the front licence plate holder as shown.

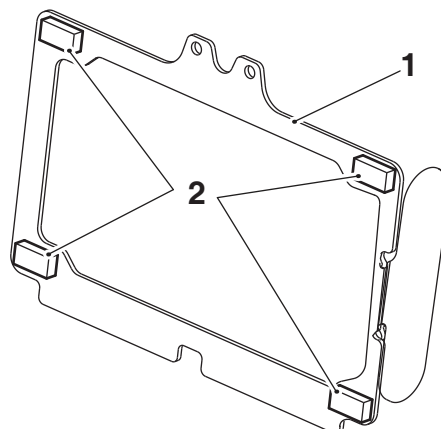

- 1. Front licence plate holder
- 2. Foam pads



**Note:**

- Read the warning notices printed on the cleaning wipe packet provided in the kit.
  - The surface to which the reflector is affixed must be clean and dry to ensure that the adhesive has a sound base to adhere to. Use a cleaning wipe supplied for this purpose.
33. Remove the protective tape from the rear of the reflector and attach a reflector from the kit to the licence plate holder, as shown.

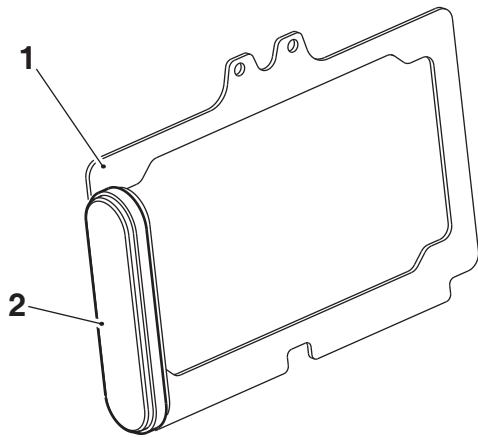

- 1. Front licence plate holder
- 2. Reflector



**Caution**

A wiring harness which becomes trapped or kinked during installation, or general motorcycle operation, may result in wiring harness damage and electrical malfunctions.

34. Route the licence plate light harness through the slot on the right hand side of the licence plate rear holder and fit the licence plate in to the rear holder. Note, the licence plate is held in place when the licence plate front holder is fitted.

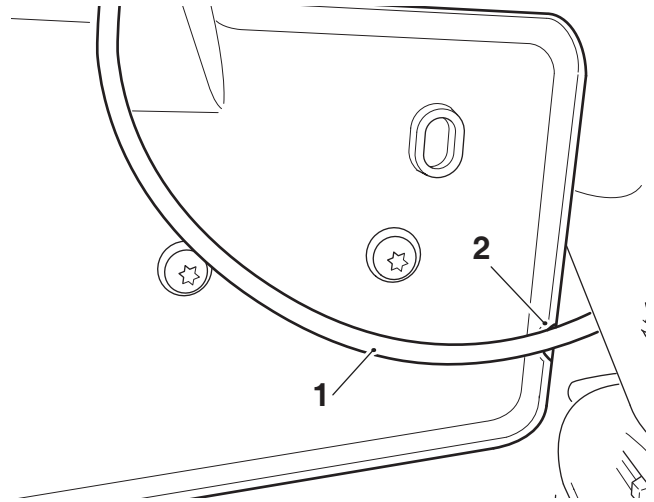

Licence plate not shown for clarity

- 1. Licence plate light harness
- 2. Slot, rear licence plate holder

35. Fit the licence plate front holder ensuring it locates correctly in the slots at the bottom of the rear holder.

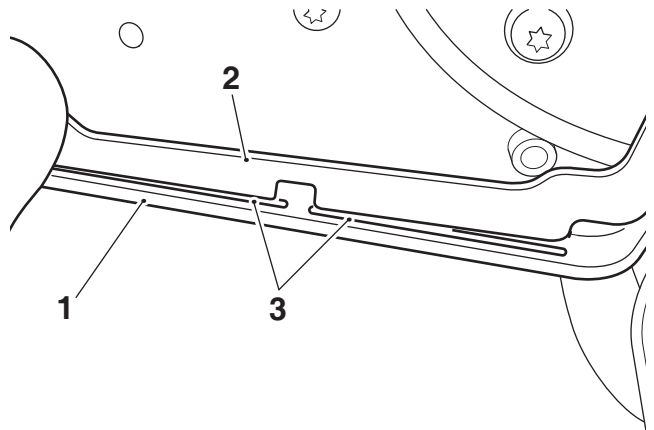

- 1. Rear licence plate holder
- 2. Front licence plate holder
- 3. Slots

36. Fit the licence plate light, aligning the light with the fixing positions at the top of the front and rear licence plate holders. Fit the M4 x 8 mm fixings provided. Tighten the fixings to **1 Nm**.

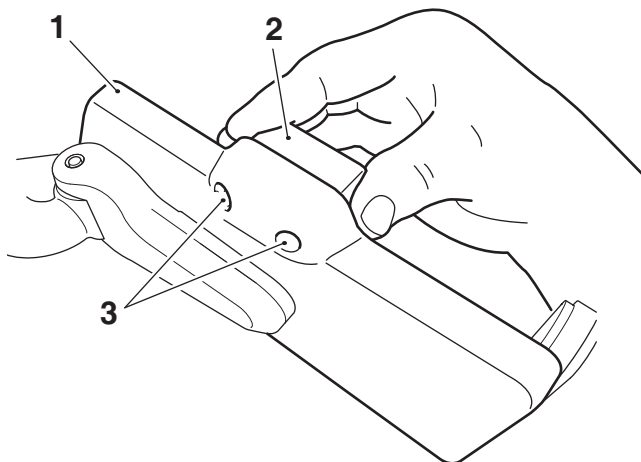

1. Rear licence plate holder  
2. Licence plate light  
3. Fixings, M4 x 8 mm

37. Attach the licence plate light harness to the cable clip in the pivoting swinging arm clamp, as shown.

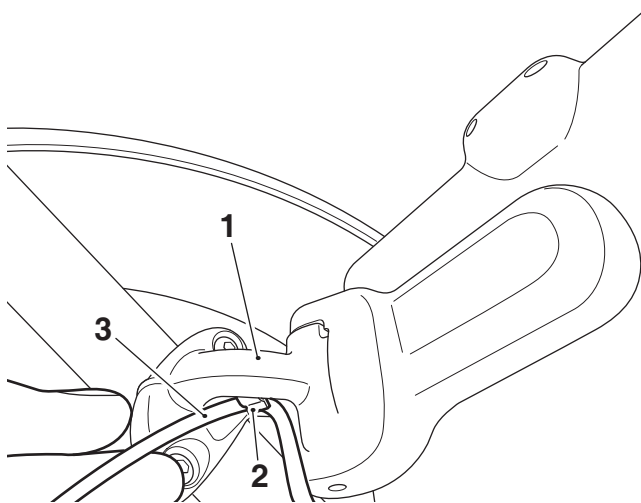

1. Pivoting swinging arm clamp  
2. Cable clip  
3. Licence plate light harness

38. Route the licence plate light harness around the swinging arm and attach to the cable clips in the rear swinging arm clamp and swinging arm as shown.

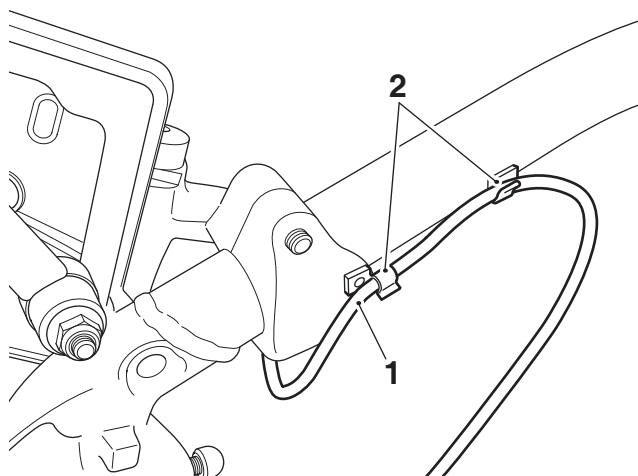

1. Licence plate light harness  
2. Cable clips



### Caution

A wiring harness which becomes trapped or kinked during installation, or general motorcycle operation, may result in wiring harness damage and electrical malfunctions.

39. Pull the licence plate light harness through the cable clips to remove any excess slack in the harness as it passes around the swinging arm. Ensure there is sufficient free movement in the harness to allow full movement of the licence plate holder pivoting assembly.
40. Route the licence plate light harness past the centre mudguard mounting bracket and then follow the routing of the rear light harness along the centre of the rear mudguard.

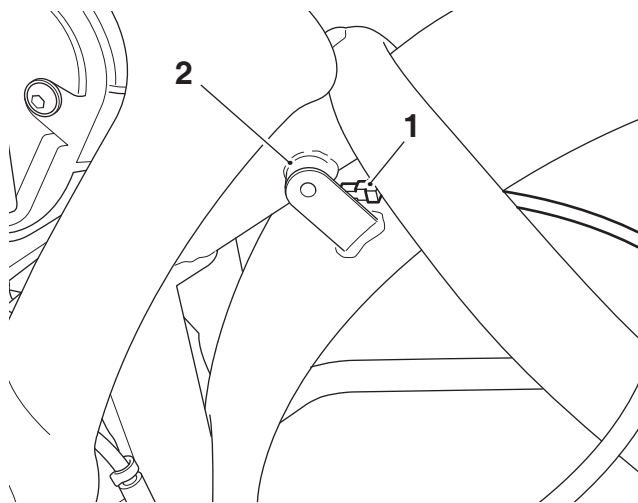

1. Licence plate light harness  
2. Centre fixing, rear mudguard

41. Route the harness back up on the left hand side of the motorcycle, inside the rear brake hose. Using the twin cable clip from the kit attach the licence plate light harness to the rear brake hose. Continue routing the harness following the routing of the rear light harness towards the battery location.

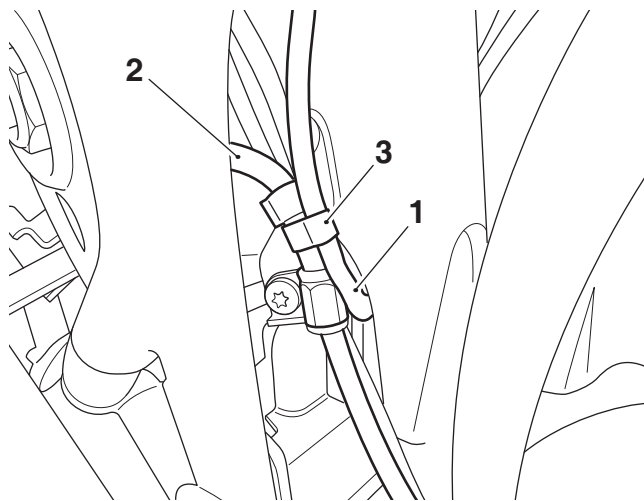

- 1. Licence plate light harness
- 2. Rear brake hose
- 3. Twin cable clip

42. Route the licence plate light harness connector through to the area above the battery location.

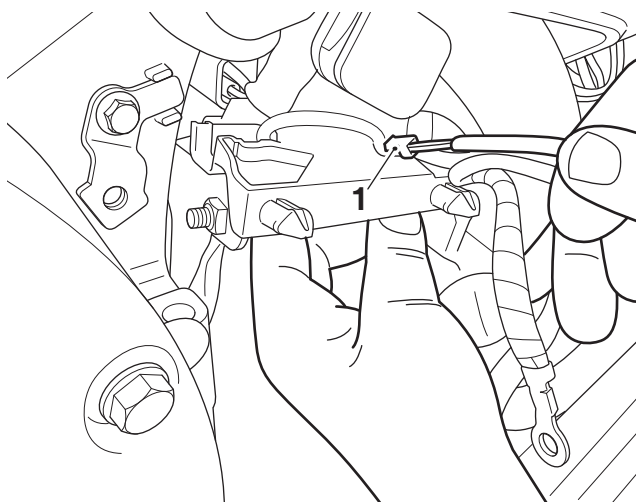

- 1. Licence plate light harness

43. Connect the licence plate light harness connector to the main wiring harness connector.

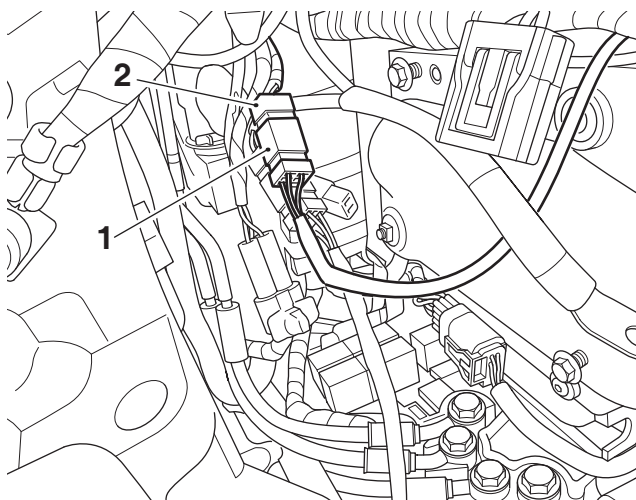

- 1. Licence plate light harness connector
- 2. Main wiring harness connector

**! Caution**

A wiring harness which becomes trapped or kinked during installation, or general motorcycle operation, may result in wiring harness damage and electrical malfunctions.

44. Secure the licence plate light harness to the swinging arm using the cable ties provided to ensure the harness follows the swinging arm tube closely.

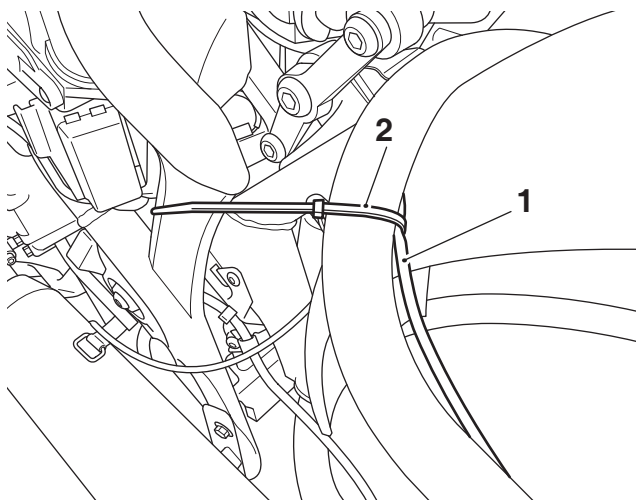

- 1. Licence plate light harness
- 2. Cable tie

 **Warning**

When cutting cable ties, always use the correct tools and personal protection equipment. Failure to use these may result in personal injury.

45. Trim off any excess cable tie.
46. Refit the battery as described in the Service Manual.
47. Reconnect the battery, positive (red) lead first and tighten the battery terminals to **4.5 Nm**.
48. Check that the indicators, rear light and licence plate light function correctly.
49. Refit the rear wheel as described in the Service Manual.

**Notice**

The motorcycle must never be ridden, or left with the side mounted licence plate holder folded back towards the swinging arm. The pivoting action of the licence plate holder is a safety feature only.

If the motorcycle is ridden, or left with the licence plate holder folded back towards the swinging arm it will contravene local laws and render the motorcycle illegal for road use.

 **Warning**

If, after fitting this accessory kit, you have any doubt about the performance of any aspect of the motorcycle, contact an authorised Triumph dealer and do not ride the motorcycle until the authorised dealer has declared it fit for use. Riding a motorcycle when there is any doubt as to any aspect of the performance of the motorcycle may result in loss of motorcycle control and an accident.

 **Warning**

Never ride an accessory-equipped motorcycle at speeds above 80 mph (130 km/h).

The presence of accessories will cause changes in the stability and handling of the motorcycle. Failure to allow for changes in motorcycle stability may result in loss of motorcycle control and an accident.

Remember that the 80 mph (130 km/h) limit will be reduced by the fitting of non-approved accessories, incorrect loading, worn tyres, overall motorcycle condition and poor road or weather conditions.

 **Warning**

The motorcycle must not be operated above the legal road speed limit except in closed-course conditions.

 **Warning**

Only operate this Triumph motorcycle at high speed in closed-course, on-road competition or on closed-course racetracks. High-speed operation should only be attempted by riders who have been instructed in the techniques necessary for high speed riding and are familiar with the motorcycle's characteristics in all conditions.

High-speed operation in any other circumstances is dangerous and may result in loss of motorcycle control and an accident.