Fitting Instructions:

Multi-Fit

Caliper Cover, Chrome - A9738194

Thank you for choosing this Triumph genuine accessory kit. This accessory kit is the product of Triumph's use of proven engineering, exhaustive testing, and continuous striving for superior reliability, safety and performance.

Completely read all of these instructions before commencing the installation of the accessory kit in order to become thoroughly familiar with the kit's features and the installation process.

These instructions should be considered a permanent part of your accessory kit, and should remain with it even if your accessory equipped motorcycle is subsequently sold.

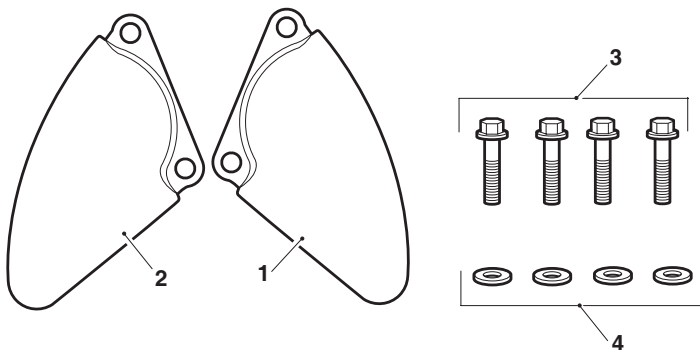

Parts Supplied:

1. Caliper cover, chrome, LH	1 off	3. Bolt, M10 x 40 mm	4 off
2. Caliper cover, chrome, RH	1 off	4. Washer, M10	4 off

! Warning

This accessory kit is designed for use on specific Triumph motorcycles only and should not be fitted to any other manufacturer's motorcycle. Consult your Triumph authorised dealer for model fitment. Fitting this accessory kit to any other Triumph model, or to any other manufacturer's motorcycle will affect the performance, stability and handling of the motorcycle. This may affect the rider's ability to control the motorcycle and could cause an accident.

! Warning

Always have Triumph approved parts, accessories and conversions fitted by a trained technician of an authorised Triumph dealer. The fitment of parts, accessories and conversions by a technician who is not of an authorised Triumph dealer may affect the handling, stability or other aspects of the motorcycle's operation which may result in loss of motorcycle control and an accident.

! Warning

Throughout this operation, ensure that the motorcycle is stabilised and adequately supported to prevent risk of injury from the motorcycle falling.

! Warning

A torque wrench of known accurate calibration must be used when fitting this accessory kit. Failure to tighten any of the fasteners to the correct torque specification may result in loss of motorcycle control and an accident.

! Warning

Never allow the brake calipers to hang on the brake hoses as this may damage the hoses. A damaged brake hose can cause a reduction in braking efficiency leading to loss of motorcycle control and an accident.

1. Remove the front left hand caliper fixings and support the caliper to prevent it hanging from the brake hose. Retain the fixings if the motorcycle is to be returned to its original condition.

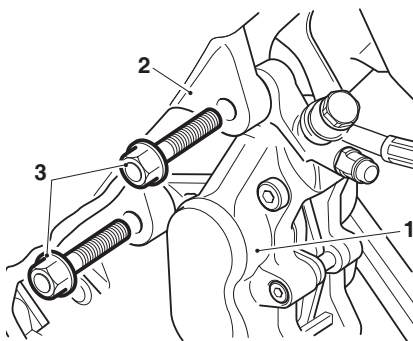
**1. Front caliper****2. Fork leg****3. Fixings**

2. Fit one of the new M10 x 40 mm bolts and washers provided into the left hand caliper cover at the top fixing position.

Note:

- **Thunderbird models only, the washers must be positioned between the bolt heads and outer face of the caliper covers, as shown below.**

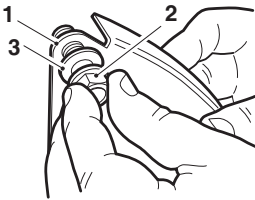
**Thunderbird Models Only****Note:**

- **All other models, the washers must be positioned between the inner face of the caliper covers and the caliper mountings, as shown below.**

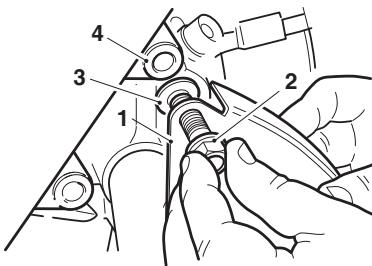
**All Other Models**

1. Caliper cover
2. Bolt, M10 x 40 mm
3. Washer, M10
4. Caliper mounting, top position

3. Locate the caliper cover to the fork leg. Align the caliper at the rear of the mounting point and secure with the M10 x 40 mm bolt and washer. Do not fully tighten the fixing at this stage.

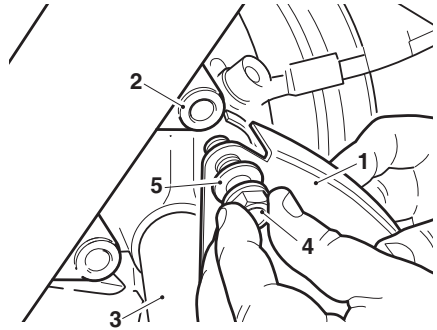

1. Caliper cover
2. Caliper mounting, top position
3. Caliper
4. Bolt, M10 x 40 mm
5. Washer, Thunderbird position shown

4. Fit the second M10 x 40 mm fixing bolt and washer to the lower caliper fixing point on the fork leg.

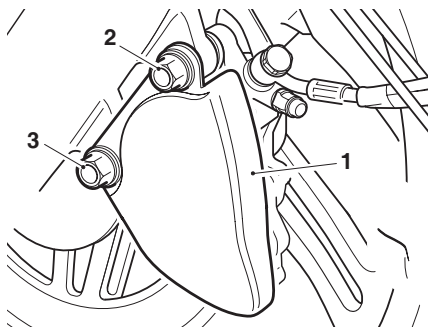

1. Caliper cover
2. Top caliper fixing
3. Bottom caliper fixing

5. Tighten both caliper fixings to **50 Nm**.
6. Repeat steps 1 to 5 for the right hand caliper cover.

Warning

If, after fitment of this accessory kit, you have any doubt about the performance of any aspect of the motorcycle, contact an authorised Triumph dealer and do not ride the motorcycle until the authorised dealer has declared it fit for use. Riding a motorcycle when there is any doubt as to any aspect of the performance of the motorcycle may result in loss of control of the motorcycle leading to an accident.

Warning

Never ride an accessory equipped motorcycle at speeds above 80 mph (130 km/h).

The presence of accessories will cause changes in the stability and handling of the motorcycle. Failure to allow for changes in motorcycle stability may lead to loss of control or an accident.

Remember that the 80 mph (130 km/h) limit will be reduced by the fitting of non-approved accessories, incorrect loading, worn tyres, overall motorcycle condition and poor road or weather conditions.

Warning

The motorcycle must not be operated above the legal road speed limit except in closed-course conditions.

Warning

Only operate this Triumph motorcycle at high speed in closed-course on road competition or on closed-course racetracks. High speed operation should only be attempted by riders who have been instructed in the techniques necessary for high speed riding and are familiar with the motorcycle's characteristics in all conditions.

High speed operation in any other circumstances is dangerous and will lead to loss of motorcycle control and an accident.