

## Fitting Instructions:

### Rocket III Touring and Thunderbird A9738114 and A9708353

Thank you for choosing this Triumph genuine accessory kit. This accessory kit is the product of Triumph's use of proven engineering, exhaustive testing, and continuous striving for superior reliability, safety and performance.

Completely read all of these instructions before commencing the installation of the accessory kit in order to become thoroughly familiar with the kit's features and the installation process.

These instructions should be considered a permanent part of your accessory kit, and should remain with it even if your accessory equipped motorcycle is subsequently sold.

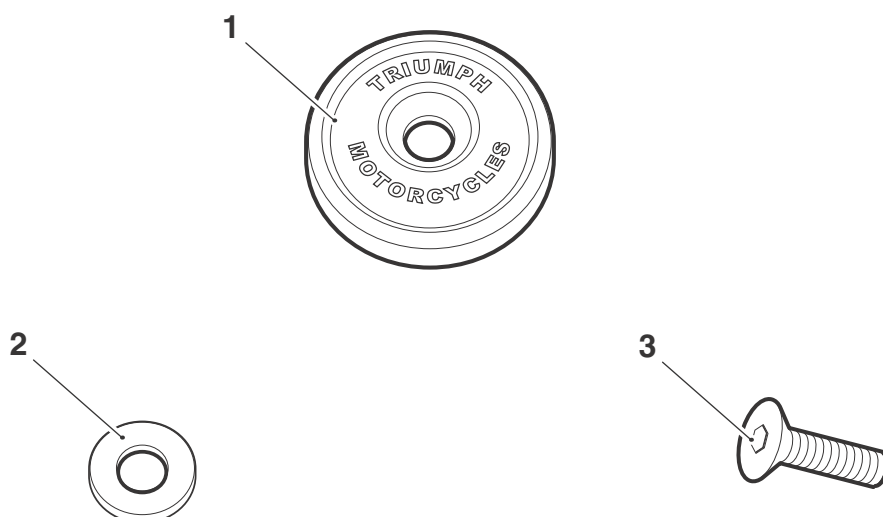

#### Parts Supplied:

1. Rear mudguard medallion embellisher	1 off	3. Screw, M6 x 25 mm	1 off
2. Washer, M6 x 14 x 2 mm (A9708353 only)	1 off		



### Warning

This accessory kit is designed for use on Triumph Rocket III Touring, Thunderbird, Thunderbird Storm, Thunderbird Commander and Thunderbird LT motorcycles only and should not be fitted to any other Triumph model or to any other manufacturer's motorcycle. Fitting this accessory kit to any other Triumph model, or to any other manufacturer's motorcycle, may interfere with the rider and could affect the handling, stability or other aspects of the motorcycle's operation which may result in loss of motorcycle control and an accident.



### Warning

Always have Triumph approved parts, accessories and conversions fitted by a trained technician of an authorised Triumph dealer. The fitment of parts, accessories and conversions by a technician who is not of an authorised Triumph dealer may affect the handling, stability or other aspects of the motorcycle's operation which may result in loss of motorcycle control and an accident.



### Warning

A torque wrench of known accurate calibration must be used when fitting this accessory kit. Failure to tighten any of the fasteners to the correct torque specification may affect motorcycle performance, handling and stability. This may result in loss of motorcycle control and an accident.



### Warning

Before starting work, ensure the motorcycle is stabilised and adequately supported. This will help prevent it from falling and causing injury to the operator or damage to the motorcycle.

#### Note:

- **These kits can only be used when the single seat option is fitted to the motorcycle.**

## Rocket III Touring, Thunderbird and Thunderbird Storm

#### Note:

- **The M6 x 14 x 2 mm washer is not required for use with the above models.**
1. Remove the original pillion seat fixing. Retain the seat and fixing if the motorcycle is to be returned to its original condition. The original rubber grommet and spacer must be left in place.
  2. Locate the medallion on the seat fixing point.

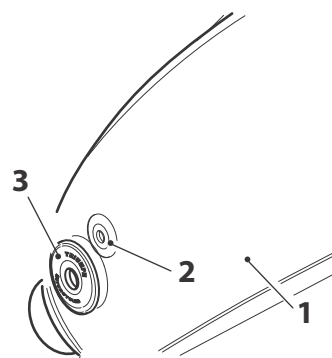

#### 1. Rear mudguard (Rocket III Touring shown)

#### 2. Seat fixing point

#### 3. Medallion

3. Orient the wording to be in the horizontal position.



### Caution

Use the correct procedure to tighten the medallion fixings. This will ensure the long-term reliability of the threaded insert.

Failure to follow the correct tightening procedure may lead to rear mudguard damage and premature failure of the threaded insert.

4. Secure the medallion to the mudguard with the M6 screw provided. Tighten the screw to **9 Nm**.

## Thunderbird Commander and Thunderbird LT

1. Remove the original pillion seat fixing. Retain the seat, fixing and washer if the motorcycle is to be returned to its original condition.
2. Locate the medallion and the washer on the seat fixing point.

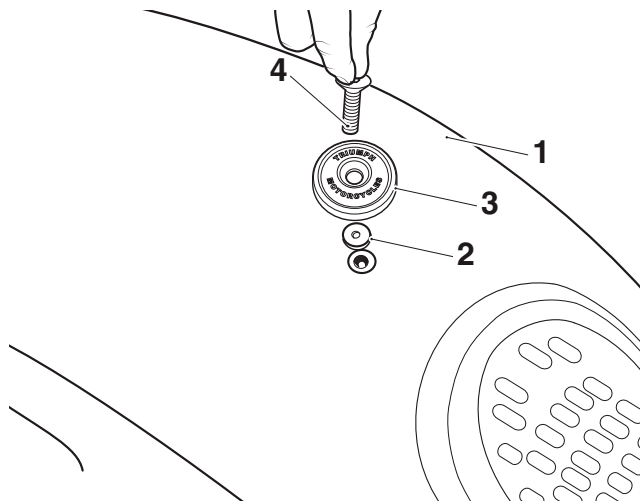

1. Mudguard
2. Washer M6 x 14 x 2 mm
3. Medallion
4. Screw M6 x 25 mm

3. Orient the wording to be in the horizontal position.



### Caution

Use the correct procedure to tighten the medallion fixings. This will ensure the long-term reliability of the threaded insert.

Failure to follow the correct tightening procedure may lead to rear mudguard damage and premature failure of the threaded insert.

### Note:

- A small gap will be visible between the medallion and mudguard due to the curvature of the rear mudguard assembly.

4. Fit the M6 x 25 mm screw and tighten to **9 Nm**.

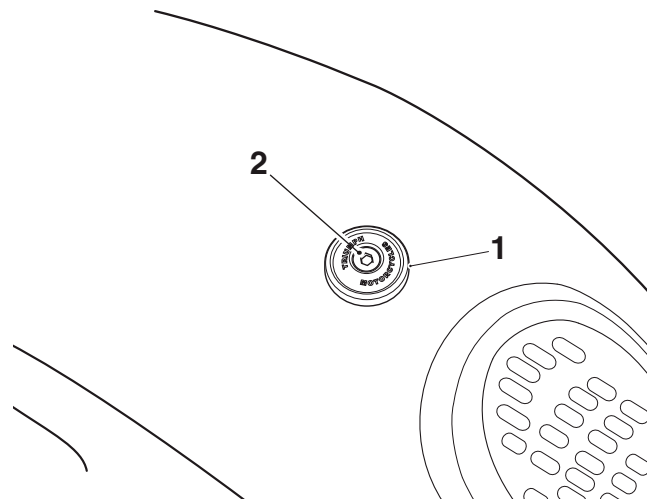

1. Medallion
2. Screw M6 x 25 mm



### Warning

After fitting the accessory kit, the motorcycle will exhibit new handling characteristics. Operate the motorcycle in a safe area free from traffic to gain familiarity with any new handling characteristics. Operation of the motorcycle when not familiar with any new handling characteristics may result in loss of motorcycle control and an accident.



### **Warning**

Never ride an accessory equipped motorcycle (including those fitted with Triumph approved windshields and luggage systems) at speeds above 80 mph (130 km/h).

The presence of accessories such as windshields and luggage systems will cause changes to the stability and handling of the motorcycle. Failure to allow for changes in motorcycle stability may lead to loss of control or an accident.

Remember that the 80 mph (130 km/h) limit will be reduced by the fitting of non-approved accessories, incorrect loading, worn tyres, overall motorcycle condition and poor road or weather conditions.



### **Warning**

This motorcycle must not be operated above the legal road speed limit except in authorised closed course conditions.



### **Warning**

If after the fitment of this accessory kit, you have any doubt about the performance of any aspect of the motorcycle, contact an authorised Triumph dealer and do not ride the motorcycle until the authorised dealer has declared it fit for use. Riding a motorcycle when there is any doubt as to any aspect of the performance of the motorcycle may result in loss of control of the motorcycle leading to an accident.