

Fitting Instructions: Rocket III / Classic / Roadster  
A9738110 and A9938142 - Fog Light Kit



 **Warning**

Always have Triumph approved parts, accessories and conversions fitted by a trained technician of an authorised Triumph Dealer. The fitment of parts, accessories and conversions by a technician who is not of an authorised Triumph dealer may affect the handling, stability or other aspects of the motorcycles operation which may result in an accident causing injury or death.

 **Warning**

This fog light kit is designed for use on Triumph Rocket III, Rocket III Classic and Rocket III Roadster motorcycles only and should not be fitted to any other Triumph model or to any other manufacturers motorcycle. Fitting this fog light kit to any other Triumph model or to any other manufacturers motorcycle, may interfere with the rider and could affect the stability and handling of the motorcycle leading to an accident causing injury or death.

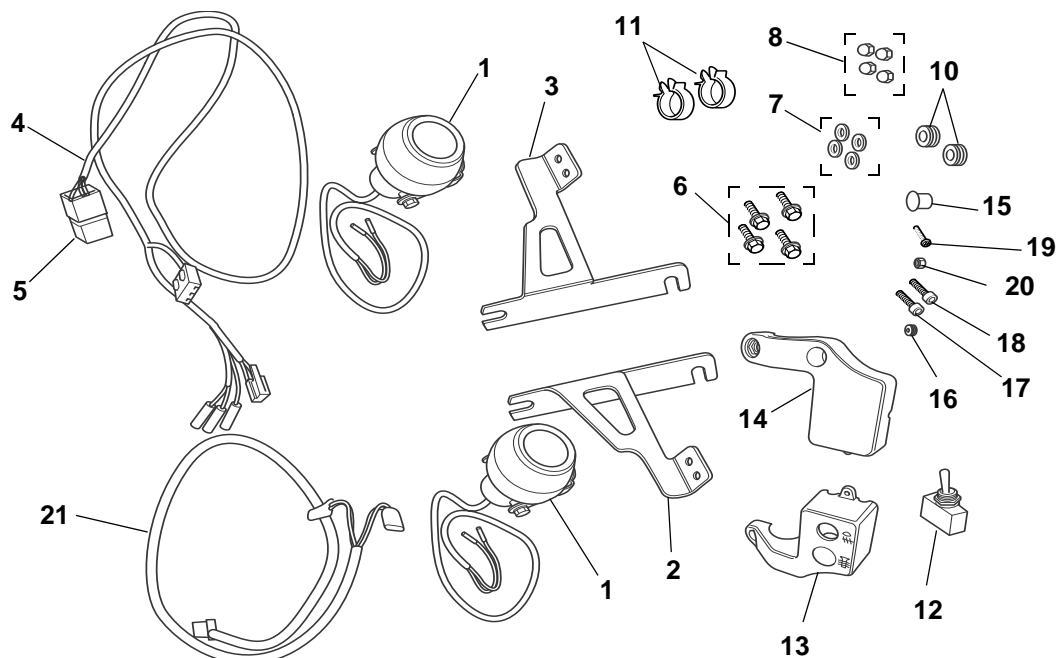

**Parts Supplied:**

1. Light unit. ....	2 off	12.Switch. ....	1 off
2. Bracket, LH. ....	1 off	13.Housing, front . . . . .	1 off
3. Bracket, RH. ....	1 off	14.Housing, rear . . . . .	1 off
4. Sub-harness, main. ....	1 off	15.Blanking plug, large . . . . .	1 off
5. Relay . . . . .	1 off	16.Blanking plug, small . . . . .	1 off
6. Bolt, M6 X 12. ....	4 off	17.Screw, M5 X 16 . . . . .	1 off
7. Washer, M6. ....	4 off	18.Screw, M5 X 12 . . . . .	1 off
8. Dome nut, M6 . . . . .	4 off	19.Screw, self tapping . . . . .	1 off
9. Cable ties (not shown). ....	5 off	20.Nut, M5 . . . . .	1 off
10.Rubber Grommet . . . . .	2 off	21.Sub-harness, switch . . . . .	1 off
11.Cable clips . . . . .	2 off		

# Fitting Instructions: Rocket III / Classic / Roadster A9738110 and A9938142 - Fog Light Kit



## Warning

Throughout this operation, ensure that the motorcycle is stabilised and adequately supported to prevent the risk of injury from the motorcycle falling.

### NOTE

- The Fog Light kit should be used in conjunction with the following kit:

#### A9738051 - Front Fixing Kit

- A maximum of two compatible front accessory kits may be fitted to the front fixing kit.
- The 3 mm spacers supplied with the front fixing kit must be used where only a single front accessory kit is fitted.

### Fog Light Fitment

1. Position the motorcycle on a paddock stand.
2. Remove the seat and disconnect the battery, negative (black) lead first.
3. Loosely secure a light unit to the right-hand bracket using the M6 x 12mm bolts, washers and dome nuts supplied.

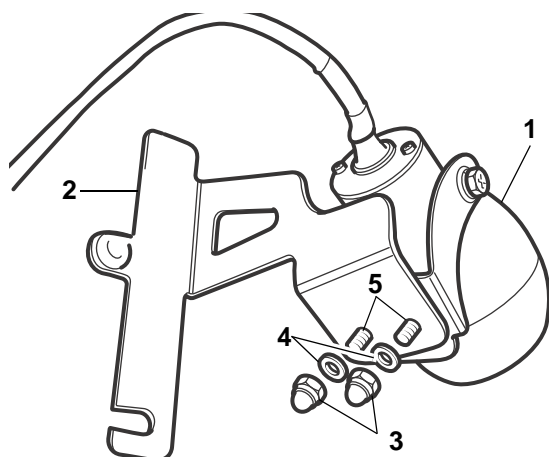

1. Light unit.
2. Right-hand bracket.
3. Domed nuts.
4. Washers.
5. Bolts.

4. Fit a rubber grommet to the fog light assembly and thread the wiring harness through the grommet as shown.

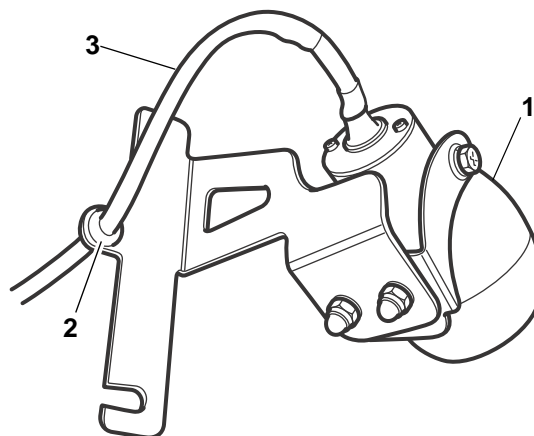

1. Light unit.
2. Rubber grommet.
3. Wiring.

5. Fit the front fixing kit in accordance with the instructions supplied in that kit.
6. Where a front fixing kit is currently fitted, align the brackets to their final positions before tightening the fixings to **19 Nm**.
7. Secure the fog light assembly to the right-hand fixing kit. Tighten the fixing kit bolts to **27 Nm**.

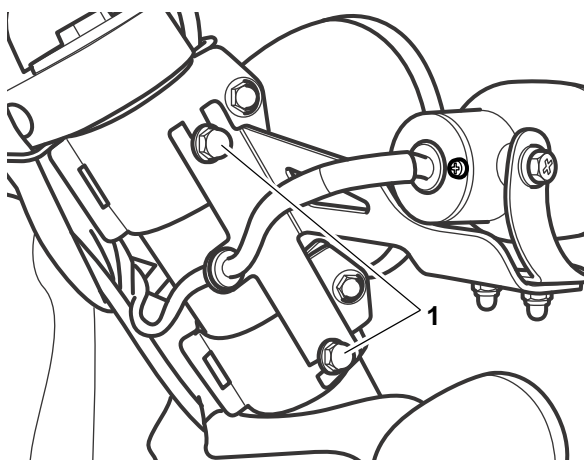

1. Fixing kit bolts.

8. Assemble the left-hand fog light assembly the same way and secure to the left-hand fixing kit. Tighten the fixing kit bolts to **27 Nm**.

## Fitting Instructions: Rocket III / Classic / Roadster A9738110 and A9938142 - Fog Light Kit



9. Adjust the fog light horizontal and vertical alignment and tighten the fixings to:  
Horizontal alignment fixings - **9 Nm**  
Vertical alignment fixings - **5 Nm**.

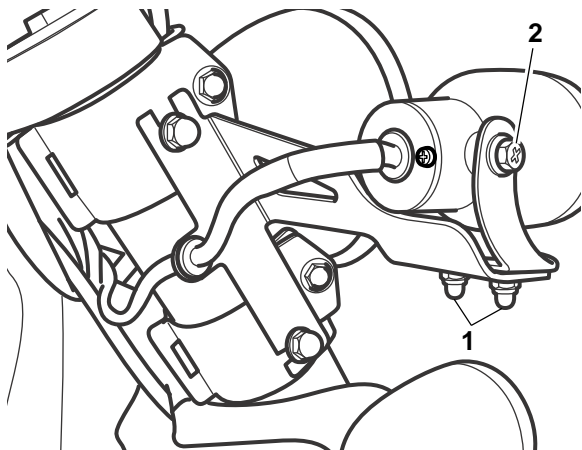

1. Horizontal alignment fixings.  
2. Vertical alignment fixings (right hand shown).

10. Release the two fixings securing the instrument pack to the handlebar clamp cover.

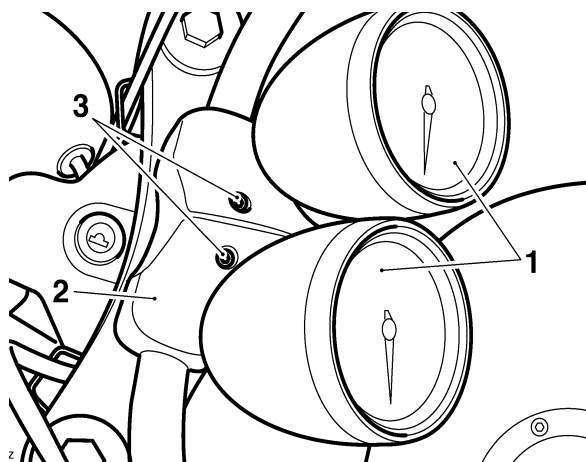

1. Instrument pack.  
2. Handlebar clamp cover.  
3. Fixings.

11. Tilt the instruments forward.

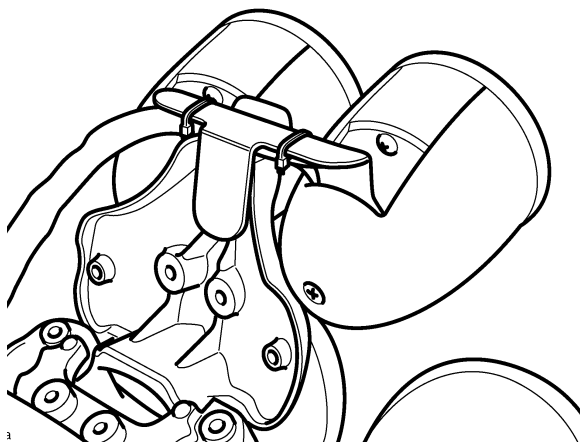

12. Release the two screws from the front and rear edges of the intake cover before sliding it downwards to release it from the two centre support studs.

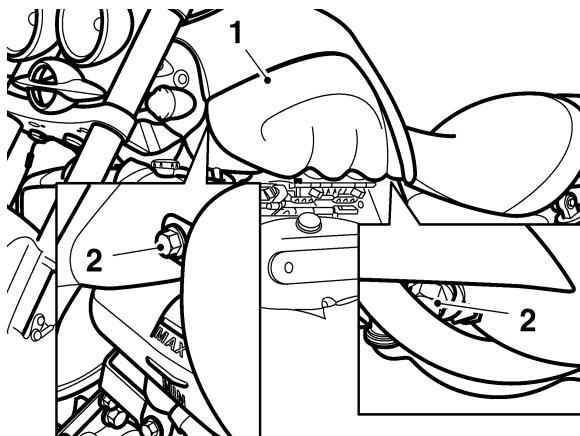

1. Intake cover.  
2. Intake cover screws.

# Fitting Instructions: Rocket III / Classic / Roadster A9738110 and A9938142 - Fog Light Kit



13. Release the single fixing from the front of the fuel tank.

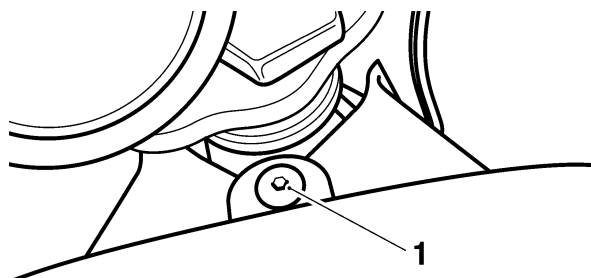

1. Fixing.

14. Pivot the fuel tank upwards at the front. Support the tank while detaching the prop from the two clips on the outside of the coil bracket.

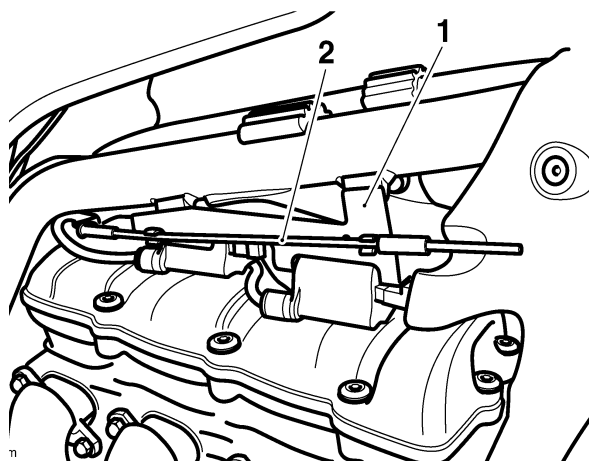

1. Coil bracket.  
2. Fuel tank prop.

15. Locate the plain end of the prop in the fuel tank fixing hole and the spherical end in the fixing bracket on the tank.

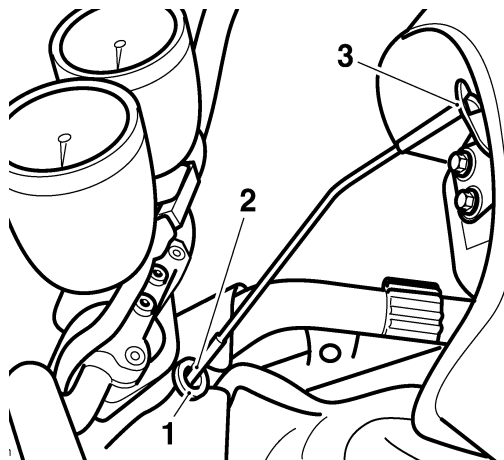

1. Fuel tank fixing hole.  
2. Prop - plain end.  
3. Prop - spherical end.

16. Remove the left hand infill panel.

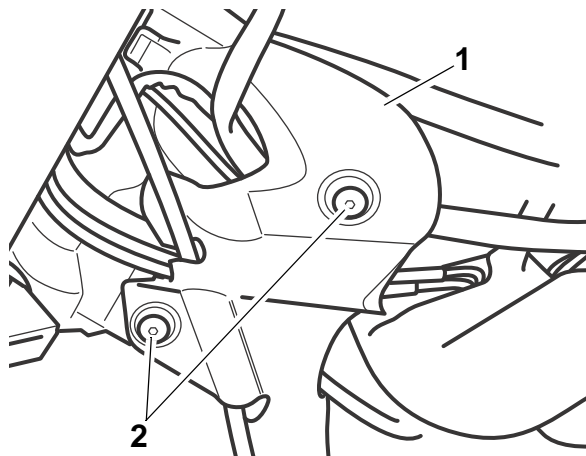

1. Left-hand infill panel.  
2. Fixings.

## Fitting Instructions: Rocket III / Classic / Roadster A9738110 and A9938142 - Fog Light Kit



17. Route the wiring from the right-hand fog light assembly in front of the headstock area and into the area underneath the fuel tank (follow the route of the right-hand switch cube wiring).

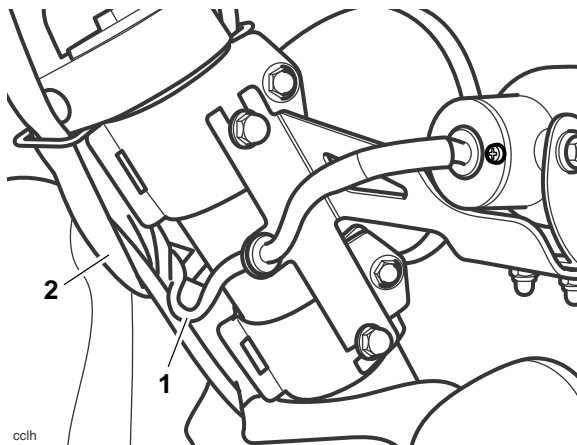

1. Right-hand fog light assembly wiring.  
2. Right-hand switch cube wiring.

18. Route the wiring from the left-hand fog light assembly into the area underneath the fuel tank (follow the route of the left-hand switch cube wiring).
19. Release the two screws securing the right-hand engine infill panel to the frame and remove the panel.
20. Raise the tool kit.
21. Release the two screws securing each side cover to the frame.

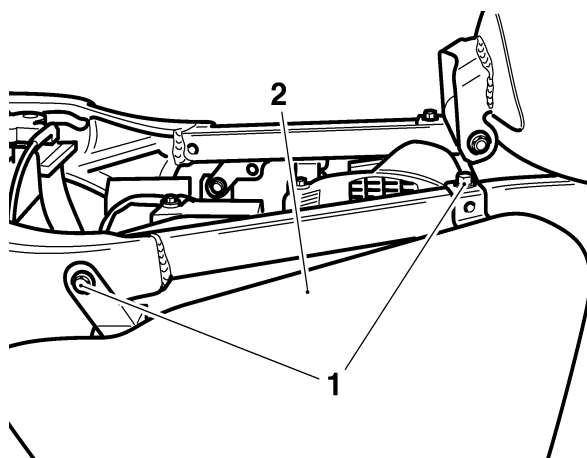

1. Screws.  
2. Side cover.

### NOTE

- During removal of the right hand side cover, disengage the seat lock from the rear of the cover.

22. Raise each side cover until clear of the mounting posts. The covers may then be removed from the motorcycle.
23. Remove the sub harness (item 4) from the kit. Mount the fog light relay connector block to the relay bracket and route the sub harness to the rear of the bracket.

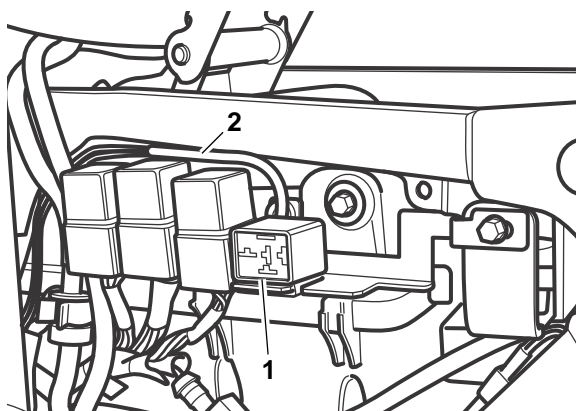

1. Fog light relay connector block.  
2. Sub harness wiring.

24. Route the sub harness alongside the main wiring harness from the relay connector and through to the right hand side of the motorcycle.
25. Secure the sub harness to the main harness using the cable ties supplied with the kit.
26. Continue to route the sub harness following the path of the main harness alongside the frame and up into the area underneath the fuel tank.

## Fitting Instructions: Rocket III / Classic / Roadster A9738110 and A9938142 - Fog Light Kit

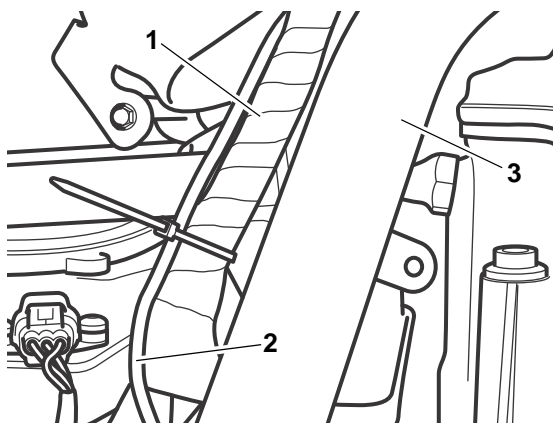

1. Main relay wiring.
2. Fog light relay wiring.
3. Right hand frame.

27. Connect the sub harness connector with the corresponding connector on the main harness (for identification purposes, the main harness connector is marked with blue tape).

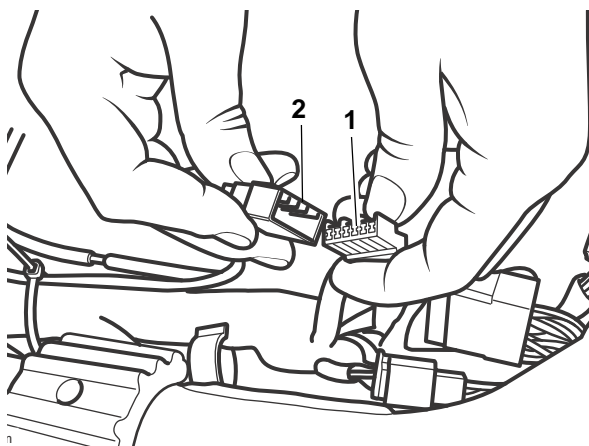

1. Main wiring harness connector.
2. Sub harness connector.

28. Connect both leads from each fog light to the corresponding leads from the sub harness. Ensure the wire colour of each fog light lead matches the colour of the sub harness lead to which it is attached.

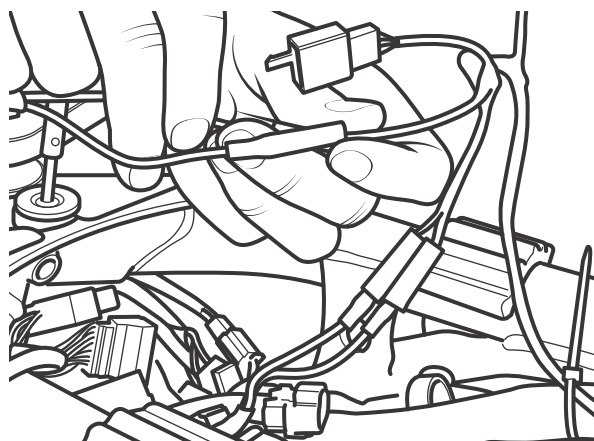

29. Fit the relay into the fog light relay connector block.

30. Take the front half of the switch housing and push the large blanking plug from the kit into the hole marked with the heated grips symbol. (Ignore this instruction if heated grips are to be fitted).

31. Unscrew the knurled knob from the switch.

32. Position the switch to the hole in the switch housing marked with the fog light symbol. Position the slot in the threaded surface uppermost (i.e. away from the graphics on the housing).

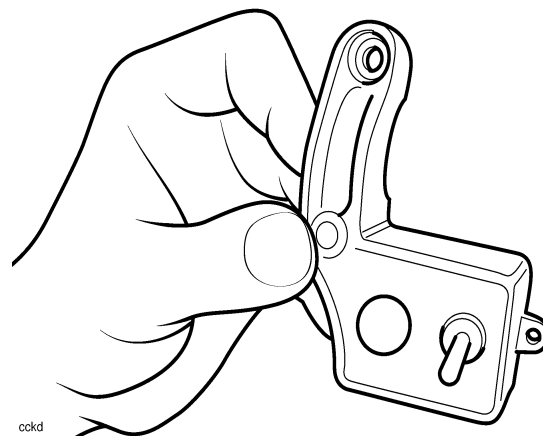

33. Secure the switch with the knurled nut and hand tighten.

34. Attach the switch sub harness to the switch terminals (either connector on the switch sub harness can be connected to either of the switch terminals).

## Fitting Instructions: Rocket III / Classic / Roadster A9738110 and A9938142 - Fog Light Kit

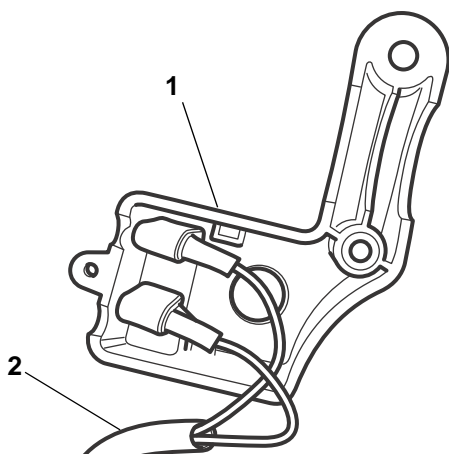

- 1. Switch housing.
- 2. Switch sub harness.

- 35. Place a small blanking plug into the smaller hole in the switch housing.
- 36. Route the switch sub-harness through the hole in the housing as shown.

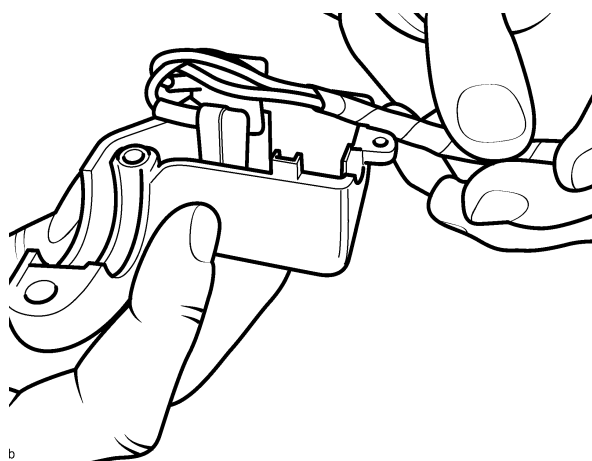

- 37. Position the front housing to the left side of the handlebar, in a position that affords easy access to the switch, without restricting access to other handlebar controls.
- 38. Attach the rear half of the housing, ensuring the small blanking plug does not become dislodged. Secure the front half to the rear with an M5 x 16 screw from the kit. Tighten the screw to **3 Nm** ensuring the wiring does not become trapped between the two halves of the housing.
- 39. Align the split line of the housing with the corresponding split line on the clutch lever. Position the switch housing as close to the clutch lever as possible.



### Warning

Ensure that access to existing handlebar controls is not restricted by the switch position chosen. Restricted access to controls could lead to loss of motorcycle control and an accident.

- 40. Using the self-tapping screw, secure the front and rear housings together at the final fixing point

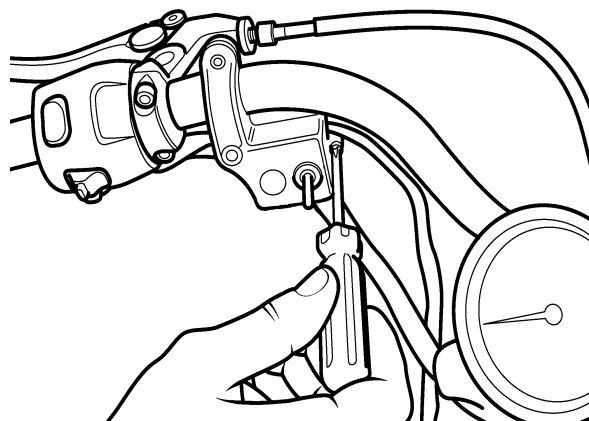

- 41. Insert the M5 nut from the kit into the recess in the upper part of the rear housing. Secure the two halves with an M5 x 12 screw from the kit. Tighten the screw to **3 Nm**.
- 42. Route the switch cable into the area under the fuel tank following the routing of the left hand switch cube wiring. Use two new cable clips from the kit to secure the wiring to the handlebar.

## Fitting Instructions: Rocket III / Classic / Roadster A9738110 and A9938142 - Fog Light Kit



43. Attach the switch sub-harness connector to the corresponding connector on the fog light sub-harness.

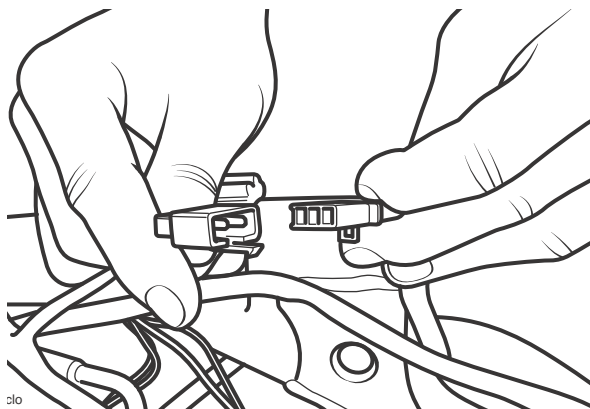

44. Refit the left hand infill panel and tighten the screws to **3 Nm**.
45. Refit the right hand engine infill panel. Tighten the fixings to **4 Nm**.
46. Ensure that the mounting post grommets are correctly installed in both side cover bases.

47. Install both covers to their mounting posts ensuring the grommets are not displaced. Ensure that the right hand cover engages correctly over the seat lock.
48. Fit and tighten the cover screws to **9 Nm** and pivot the tool kit into place.
49. Support the fuel tank and remove the tank prop.
50. Continue to support the tank while refitting the prop to the two clips on the outside of the coil bracket.

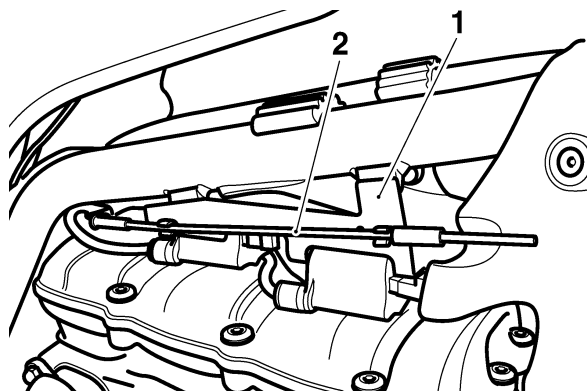

1. Coil bracket.

2. Fuel tank prop.

51. Lower the tank into position and secure with the forward fixing. Tighten the fixing to **9 Nm**.
52. Align the intake cover to the centre studs and ease into place. Fit and tighten the two screws to **9 Nm**.
53. Pivot the instruments into place. Fit the two screws and tighten to **3 Nm**.
54. Reconnect the battery, positive (red) lead first and refit the seats.
55. Remove the motorcycle from the paddock stand and recheck the correct operation of the fog lights.



### Warning

The fog light lenses become hot during use. Do not attempt to touch the fog light lenses during or just after use. Allow sufficient time for the lenses to cool before attempting to carry out any work on the fog lights. Failure to allow sufficient time for the fog light lenses to cool after use will result in burn injuries.

56. Re-check the vertical and horizontal aim of the fog lights. Adjust if necessary.

## Fitting Instructions: Rocket III / Classic / Roadster A9738110 and A9938142 - Fog Light Kit



### **Warning**

Failure to tighten any of the fasteners to the correct torque specification may result in an accident causing injury or death.

### **Warning**

Never attempt to clean or adjust the fog lights whilst riding the motorcycle. Removal of the riders hands from the handlebars whilst riding the motorcycle will diminish the ability of the rider to maintain control of the motorcycle. Attempting to clean or adjust the fog lights whilst riding the motorcycle may result in loss of control of the motorcycle leading to an accident resulting in injury or death.

### **Warning**

After fitting the fog lights the motorcycle will exhibit new handling characteristics. Operate the motorcycle in a safe area free from traffic to gain familiarity with any new handling characteristics. Operation of the motorcycle when not familiar with any new handling characteristics may result in an accident causing injury or death.

### **Warning**

Never ride an accessory equipped motorcycle at speeds above 130km/h (80 m.p.h.).  
The presence of accessories will cause changes in the stability and handling of the motorcycle.  
Failure to allow for changes in motorcycle stability may lead to loss of control or an accident.  
Remember that the 130km/h (80 m.p.h.) limit will be reduced by the fitting of non-approved accessories, incorrect loading, worn tyres, overall motorcycle condition and poor road or weather conditions.

### **Warning**

The motorcycle must not be operated above the legal road speed limit except in closed course conditions.

### **Warning**

The fog light lenses become hot during use. Do not attempt to touch the fog light lenses during or just after use. Allow sufficient time for the lenses to cool before attempting to carry out any work on the fog lights. Failure to allow sufficient time for the fog light lenses to cool after use will result in burn injuries.