

# Front Fixing Kit Fitting Instructions

## - Rocket III



### Warning

Always have Triumph approved parts, accessories and conversions fitted by a trained technician of an authorised Triumph Dealer. The fitment of parts, accessories and conversions by a technician who is not of an authorised Triumph dealer may affect the handling, stability or other aspects of the motorcycles operation which may result in an accident causing injury or death.

### Warning

This front fixing kit is designed for use on Triumph motorcycles only and should not be fitted to any other Triumph model or to any other manufacturers motorcycle. Fitting this front fixing kit to any other Triumph model or to any other manufacturers motorcycle, may interfere with the rider and could affect the stability and handling of the motorcycle leading to an accident causing injury or death.

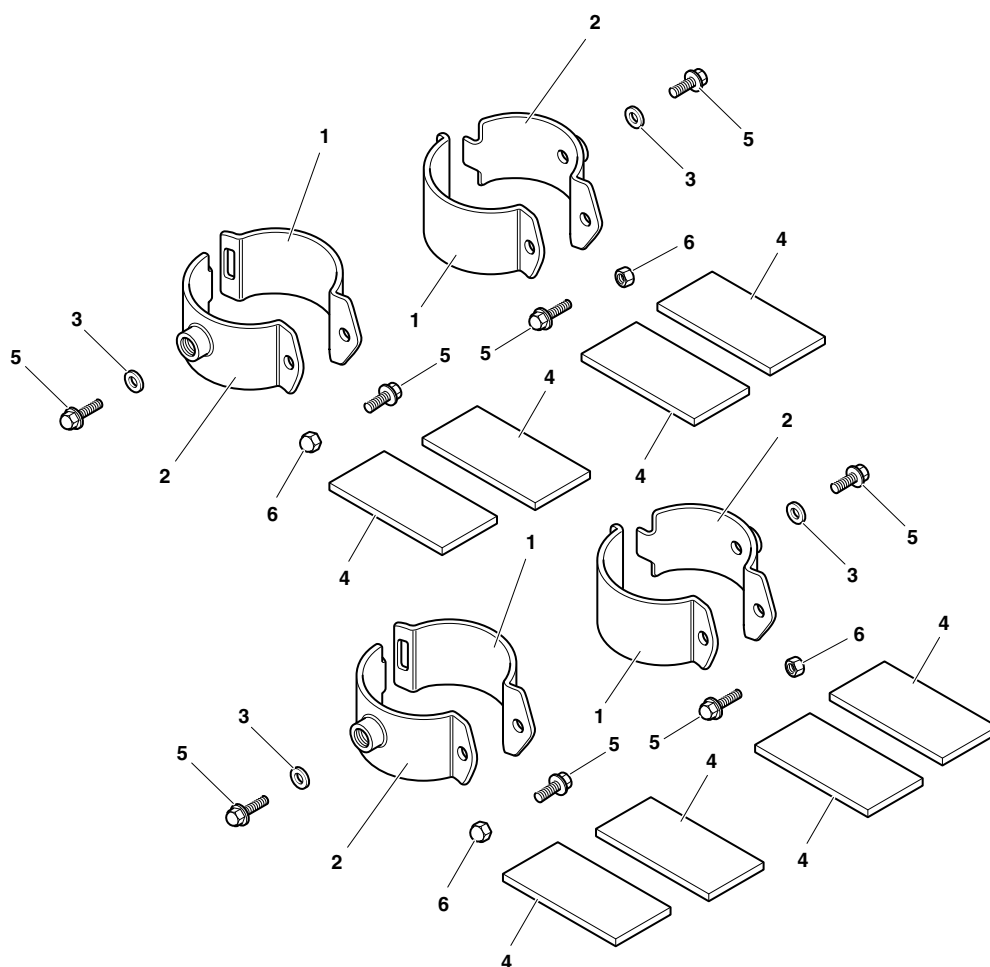

### Parts Supplied:

1. Inside clamp .....	4 off	4. Rubber strip .....	8 off
2. Outside clamp .....	4 off	5. M8 x 16 bolt .....	8 off
3. Spacer .....	4 off	6. M8 dome nut .....	4 off

# Front Fixing Kit Fitting Instructions - Rocket III



The front fixing kit must be used when fitting any of the following kits:

A9748036 - Roadster screen kit

A9748040 - Summer screen kit

A9748045 - Fly screen kit

A9738042 - Auxiliary light kit



## Warning

Ensure that the motorcycle is stabilised and adequately supported, to prevent it from falling and causing damage or injury.

1. Position the motorcycle on a paddock stand.
2. Remove the seat and disconnect the battery, negative (black) lead first.
3. Fit the 8 self adhesive rubber strips to the inside and outside clamp halves as shown below. Ensure that each strip is affixed in a central position on the clamp.

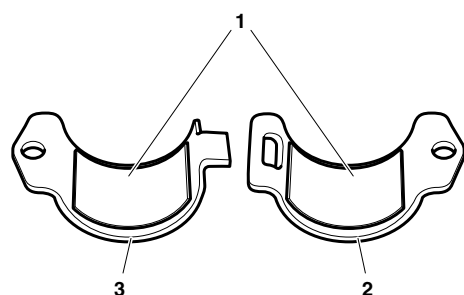

cbkl

1. Rubber strip
2. Inside clamp
3. Outside clamp

4. Refer to the illustration below and note the position of the centre-punch marks, one for each fork leg, on the underside of the top yoke.

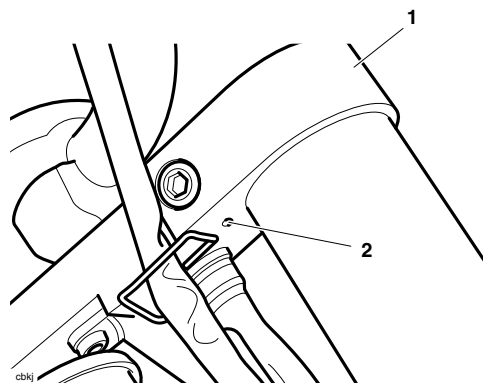

cbkj

1. Top yoke
2. Centre-punch mark

5. Fit the upper fork clamps to each fork leg as shown in the illustration below. The upper fork clamp pair must mate directly against the underside of the top yoke and the clamp split lines must align with the centre-punch marks detailed above. Secure the clamps using 2 of the M8 x 16 bolts and dome nuts supplied with the kit. Ensure that the dome nuts point outwards as illustrated below. Loosely tighten the fixings such that the clamps are secured in position but remain adjustable.

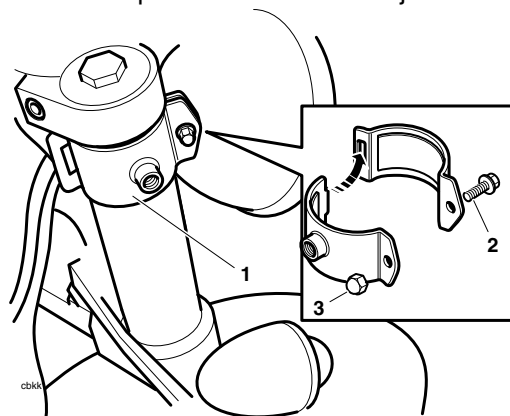

cbkk

1. Upper fork clamp pair
2. M8 x 16 bolt
3. M8 dome nut

## Front Fixing Kit Fitting Instructions - Rocket III



6. Fit the lower fork clamps in the same orientation as the upper fork clamps. The distance between the upper and lower clamps must be 61mm as illustrated below. Secure the clamps using the remaining M8 x 16 bolts and dome nuts supplied with the kit. Ensure that the dome nuts point outwards as illustrated below. Loosely tighten the fixings such that the clamps are secured in position but remain adjustable.
12. Refit the seat.
13. Remove the paddock stand.

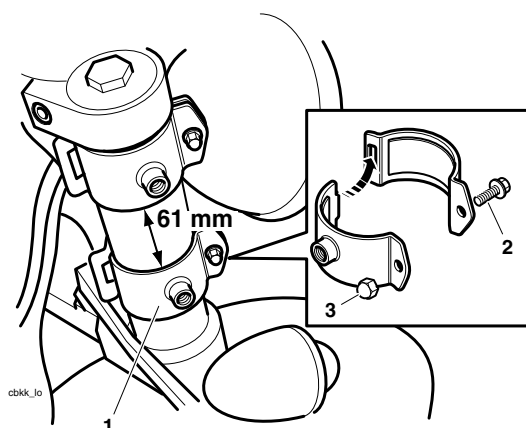

1. Lower fork clamps
2. M8 x 16 bolt
3. M8 dome nut

7. Fit a compatible front accessory kit. Compatible kits are listed at the beginning of these instructions. Separate sets of fitting instructions are provided with each of the kits.

### NOTE

- **A maximum of two compatible front accessory kits may be fitted to the front fixing kit.**

8. Align the brackets to their final position.
9. Tighten the fork clamp fixings to **19 Nm**.
10. Use the 4 remaining M8 x 16 bolts to secure the chosen front accessory against the mounting bosses. Tighten the M8 x 16 bolts to **27 Nm**.

### NOTE

- **The 3 mm spacers supplied with the kit must be used where only a single front accessory is fitted.**

11. Reconnect the battery, positive (red) lead first.