

Accessory Fitting Instructions

| Aluminium Sump Guard Kit | |
|--------------------------|---|
| Kit Number | Models Affected |
| A9708229 | Tiger Explorer, Tiger Explorer XC |
| A9708406 | Tiger Explorer, Tiger Explorer XC, Explorer XR, Explorer XR _x , Explorer XR _T , Explorer XC |
| A9708482 | Tiger 1200 XR, Tiger 1200 XR _x , Tiger 1200 XR _x (LRH), Tiger 1200 XR _T |

Thank you for choosing this Triumph genuine accessory kit. This accessory kit is the product of Triumph's use of proven engineering, exhaustive testing, and continuous striving for superior reliability, safety and performance.

Completely read all of these instructions before commencing the installation of the accessory kit in order to become thoroughly familiar with the kit's features and the installation process.

These instructions should be considered a permanent part of your accessory kit, and should remain with it even if your accessory equipped motorcycle is subsequently sold.

Parts Supplied

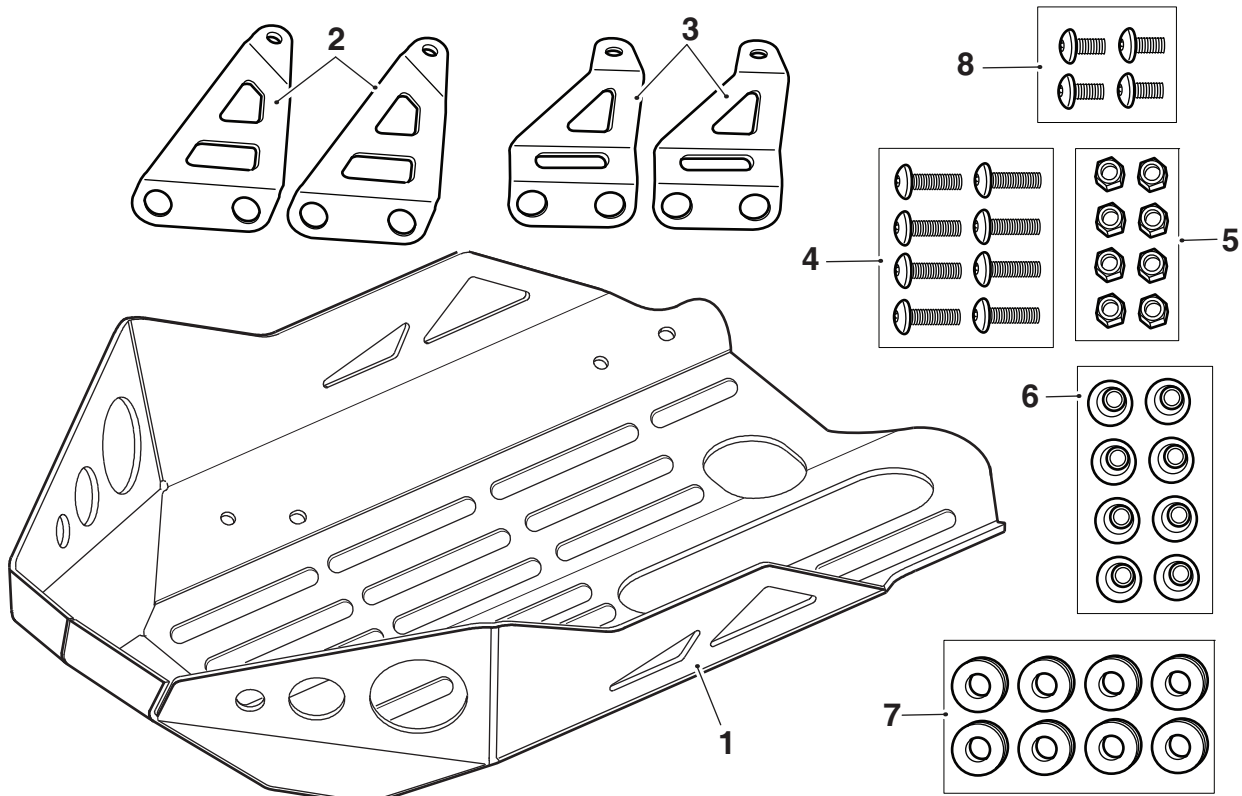

| | | | |
|--------------------------------|-------|-----------------------|-------|
| 1. Sump guard (A9708482 shown) | 1 off | 5. Nut, M6 | 8 off |
| 2. Support bracket, front | 2 off | 6. Flanged sleeve | 8 off |
| 3. Support bracket, rear | 2 off | 7. Grommet | 8 off |
| 4. Fixing, M6 x 20 mm | 8 off | 8. Fixing, M6 x 12 mm | 4 off |

Warning

The accessory kits covered in this instruction are designed for use on specific models of Triumph motorcycle. The accessory kits and the models applicable are listed at the start of the instruction. They should not be fitted to any other Triumph model or to any other manufacturer's motorcycle. Fitting an accessory kit to a Triumph model not listed, or to any other manufacturer's motorcycle will affect the performance, stability and handling of the motorcycle. This may result in loss of motorcycle control and an accident.

Warning

Always have Triumph approved parts, accessories and conversions fitted by a trained technician of an authorised Triumph dealer. The fitment of parts, accessories and conversions by a technician who is not of an authorised Triumph dealer may affect the handling, stability or other aspects of the motorcycle's operation which may result in loss of motorcycle control and an accident.

Warning

Throughout this operation, ensure that the motorcycle is stabilised and adequately supported to prevent risk of injury from the motorcycle falling.

Warning

A torque wrench of known accurate calibration must be used when fitting this accessory kit. Failure to tighten any of the fasteners to the correct torque specification may affect motorcycle performance, handling and stability. This may result in loss of motorcycle control and an accident.

Warning

If the engine has recently been running, the exhaust system will be hot. Before working on or near the exhaust system, allow sufficient time for the system to cool, as touching any part of a hot exhaust could cause burn injuries.

1. Position the motorcycle on its centre stand.
2. Remove the standard sump guard as described in the service manual. Retain the sump guard and the fixings for re-use if the motorcycle is to be returned to its original condition.
3. Install the grommets and flanged sleeves from the kit into the four mounting brackets, as shown below.

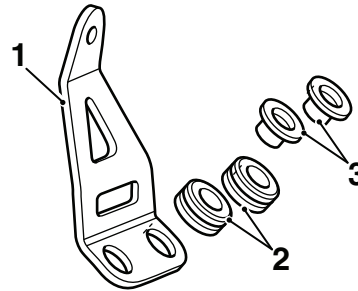

1. Bracket
2. Grommet
3. Flanged sleeve

4. Secure the mounting brackets to the aluminium sump guard using the M6 x 20 mm fixings and nuts from the kit, as shown below. Tighten the nuts to **6 Nm**.

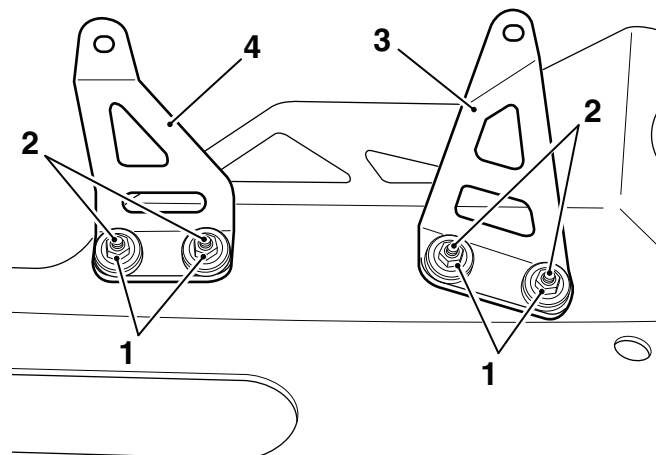

1. Nut M6
2. Fixing, M6 x 20 mm
3. Front bracket (left hand shown)
4. Rear bracket (left hand shown)

Note:

- The sidestand harness must be routed to the outer of the aluminium sump guard and securely fastened to the starter cable with the clip.
5. Position the aluminium sump guard support brackets to the crankcase, noting the position of the side stand harness and secure using the four M6 x 12 mm fixings from the kit.

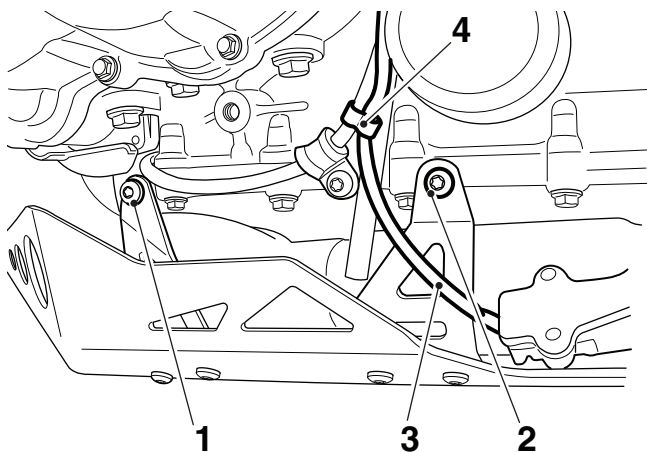

1. Fixing (front) M6 x 12 mm (left hand shown)
2. Fixing (rear) M6 x 12 mm (left hand shown)
3. Harness (side stand)
4. Clip

6. Tighten the screws to **6 Nm**.

! Caution

The sump guard does not provide complete protection from damage to the underside of the motorcycle. Care must be taken to avoid contact between the underside of the motorcycle and any hard or sharp objects. Damage to the underside of the motorcycle may occur if it is allowed to come in to contact with any hard or sharp objects.

! Caution

Do not support or jack up the motorcycle using the sump guard. Damage to the sump guard or the motorcycle itself will result if this caution is ignored.

! Warning

If, after fitment of this accessory kit, you have any doubt about the performance of any aspect of the motorcycle, contact an authorised Triumph dealer and do not ride the motorcycle until the authorised dealer has declared it fit for use. Riding a motorcycle when there is any doubt as to any aspect of the performance of the motorcycle may result in loss of control of the motorcycle leading to an accident.

! Warning

Never ride an accessory equipped motorcycle at speeds above 80 mph (130 km/h).

The presence of accessories will cause changes in the stability and handling of the motorcycle. Failure to allow for changes in motorcycle stability may lead to loss of control or an accident.

Remember that the 80 mph (130 km/h) limit will be reduced by the fitting of non-approved accessories, incorrect loading, worn tyres, overall motorcycle condition and poor road or weather conditions.

! Warning

The motorcycle must not be operated above the legal road speed limit except in closed-course conditions.

! Warning

Only operate this Triumph motorcycle at high speed in closed-course, on-road competition or on closed-course racetracks. High-speed operation should only be attempted by riders who have been instructed in the techniques necessary for high-speed riding and are familiar with the motorcycle's characteristics in all conditions.

High-speed operation in any other circumstances is dangerous and will lead to loss of motorcycle control and an accident.