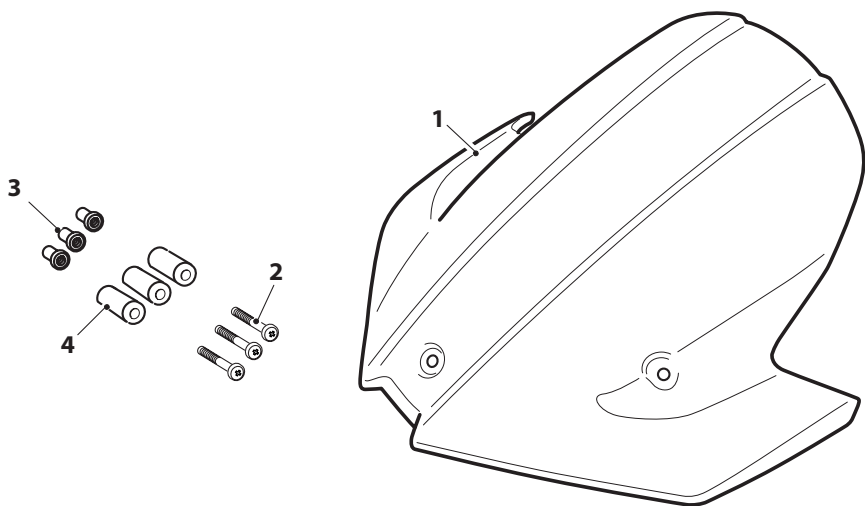

Fitting Instructions:**Street Triple****Flyscreen Visor Kit, Smoked - A9708197**

Thank you for choosing this Triumph genuine accessory kit. This accessory kit is the product of Triumph's use of proven engineering, exhaustive testing, and continuous striving for superior reliability, safety and performance.

Completely read all of these instructions before commencing the installation of the accessory kit in order to become thoroughly familiar with the kit's features and the installation process.

These instructions should be considered a permanent part of your accessory kit, and should remain with it even if your accessory equipped motorcycle is subsequently sold.

**Parts Supplied:**

- | | |
|--|----------------------------------|
| 1. Flyscreen visor, smoked 1 off | 3. Well nut, M5 3 off |
| 2. Plastic screw, M5 x 30 3 off | 4. Rubber collar 3 off |

Warning

This accessory kit is designed for use on Triumph motorcycles only and should not be fitted to any other manufacturer's motorcycle. Fitting this accessory kit to any other manufacturer's motorcycle will affect the performance, stability and handling of the motorcycle. This may affect the riders ability to control the motorcycle and could cause an accident.

Warning

Always have Triumph approved parts, accessories and conversions fitted by a trained technician of an authorised Triumph dealer. The fitment of parts, accessories and conversions by a technician who is not of an authorised Triumph dealer may affect the handling, stability or other aspects of the motorcycles operation which may result in loss of motorcycle control and an accident.

Warning

Throughout this operation, ensure that the motorcycle is stabilised and adequately supported to prevent risk of injury from the motorcycle falling.

Warning

A torque wrench of known accurate calibration must be used when fitting this accessory kit. Failure to tighten any of the fasteners to the correct torque specification may result in loss of motorcycle control and an accident.

Note:

- **If the motorcycle has a flyscreen fitted, remove it following the instructions at step 1 below. If a flyscreen is not fitted to the motorcycle proceed to step 2.**
1. Remove the three M5 retaining screws, located in the instrument facia. Remove the flyscreen, retain the screws for reuse.

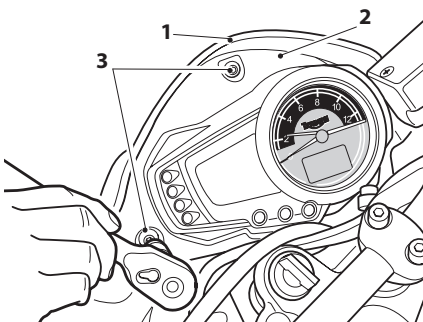

1. Flyscreen
2. Instrument facia
3. Fixing, left hand & centre shown

2. Locate the two witness marks on the underside of the flyscreen. The marks are provided to indicate the drilling position.

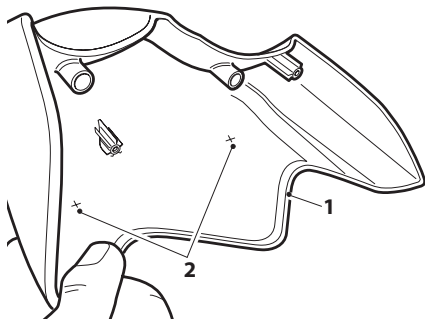

1. Flyscreen
2. Witness marks

3. Support the flyscreen on a suitable surface which will prevent damage to the finish. At each witness mark drill a 9.5 mm diameter hole, drilling from the underside of the flyscreen.

Note:

- **It is advisable to drill a small pilot hole first, before drilling to the final 9.5 mm diameter.**

4. Insert a Well nut into each of the drilled holes, from the front face of the flyscreen as shown. Ensure the head of the Well nut is flush with the flyscreen.

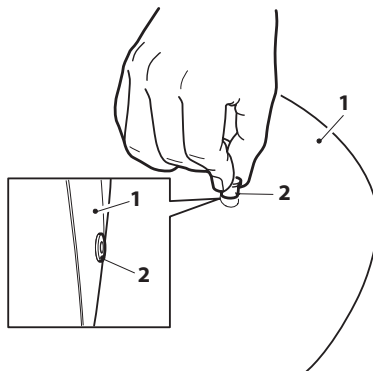

1. Flyscreen
2. Well nut

5. Fit one of the plastic screws and rubber collars to either the left hand or right hand side visor mounting hole as shown below.

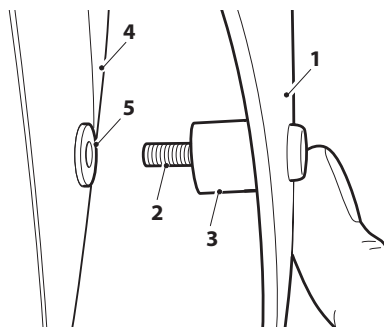

1. Visor
2. Plastic screw
3. Rubber collar
4. Flyscreen
5. Well nut

6. Position the visor on the flyscreen, aligning the plastic screw with the appropriate Well nut. Tighten the screw loosely at this stage, sufficient to retain the visor to the flyscreen.
7. Fit a second plastic screw and rubber collar to the opposite side of the visor, again tighten the screw loosely at this stage.
8. Check that the visor is positioned correctly on the flyscreen.
9. Locate a rubber collar between the flyscreen and visor at the centre visor fixing position, as shown below.

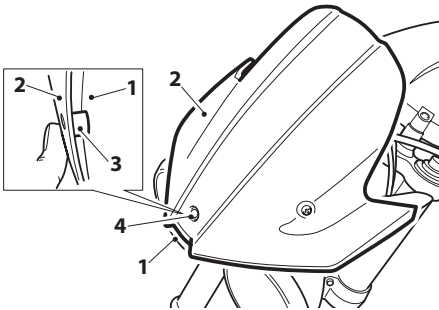

1. Flyscreen
2. Visor
3. Rubber collar
4. Visor centre fixing position

10. Using a suitable scribing tool carefully mark a drill indication point on the front face of the flyscreen, through the centre visor mounting hole and rubber collar, as shown.

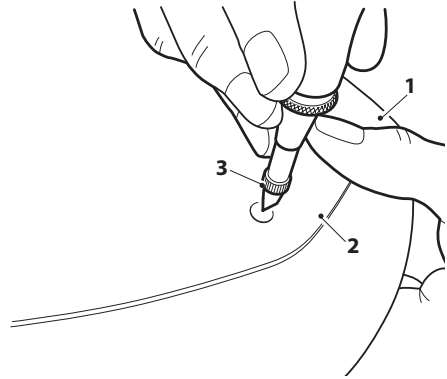

1. Flyscreen
2. Visor
3. Scribing tool

11. Remove the visor from the flyscreen placing the plastic screws and rubber collars to one side for reuse.
12. At the drill indication point marked, drill a 9.5 mm diameter hole through the flyscreen.

Note:

- **It is advisable to drill a small pilot hole first, before drilling to the final 9.5 mm diameter.**
13. Fit the remaining Well nut from the kit to the new centre hole drilled in the flyscreen.

14. Fit the visor to the flyscreen using the assembly procedure previously used for the plastic screws and rubber collars. Tighten the plastic screws to **3 Nm**.

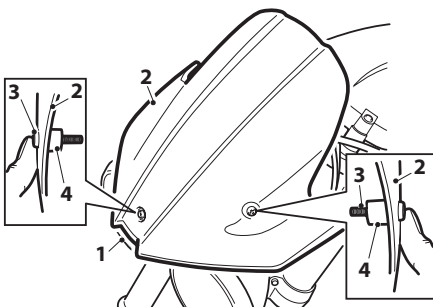

1. Flyscreen
2. Visor
3. Plastic screw
4. Rubber collar

15. Refit the flyscreen to the motorcycle and retain with the three original M5 fixings. Tighten the fixings to **3 Nm**.

Warning

After fitting the flyscreen visor kit the motorcycle will exhibit new handling characteristics. Operate the motorcycle in a safe area free from traffic to gain familiarity with any new characteristics. Operation of the motorcycle when not familiar with any new handling characteristics may result in loss of motorcycle control and an accident.

Warning

If, after fitment of this accessory kit, you have any doubt about the performance of any aspect of the motorcycle, contact an authorised Triumph dealer and do not ride the motorcycle until the authorised dealer has declared it fit for use. Riding a motorcycle when there is any doubt as to any aspect of the performance of the motorcycle may result in loss of control of the motorcycle leading to an accident.

Warning

Never ride an accessory equipped motorcycle (including those fitted with Triumph approved windscreens and luggage systems) at speeds above 80 mph (130 km/h).

The presence of accessories such as windscreens and luggage systems will cause changes in the stability and handling of the motorcycle. Failure to allow for changes in motorcycle stability may lead to loss of control or an accident. Remember that the 80 mph (130 km/h) limit will be reduced by the fitting of non-approved accessories, incorrect loading, worn tyres, overall motorcycle condition and poor road or weather conditions.