

Fitting Instructions:

Speed Triple 1050 from VIN 461332, Street Triple from VIN 480782 and Street Triple R from VIN 482182 A9708188

Thank you for choosing this Triumph genuine accessory kit. This accessory kit is the product of Triumph's use of proven engineering, exhaustive testing, and continuous striving for superior reliability, safety and performance.

Completely read all of these instructions before commencing the installation of the accessory kit in order to become thoroughly familiar with the kit's features and the installation process.

These instructions should be considered a permanent part of your accessory kit, and should remain with it even if your accessory-equipped motorcycle is subsequently sold.

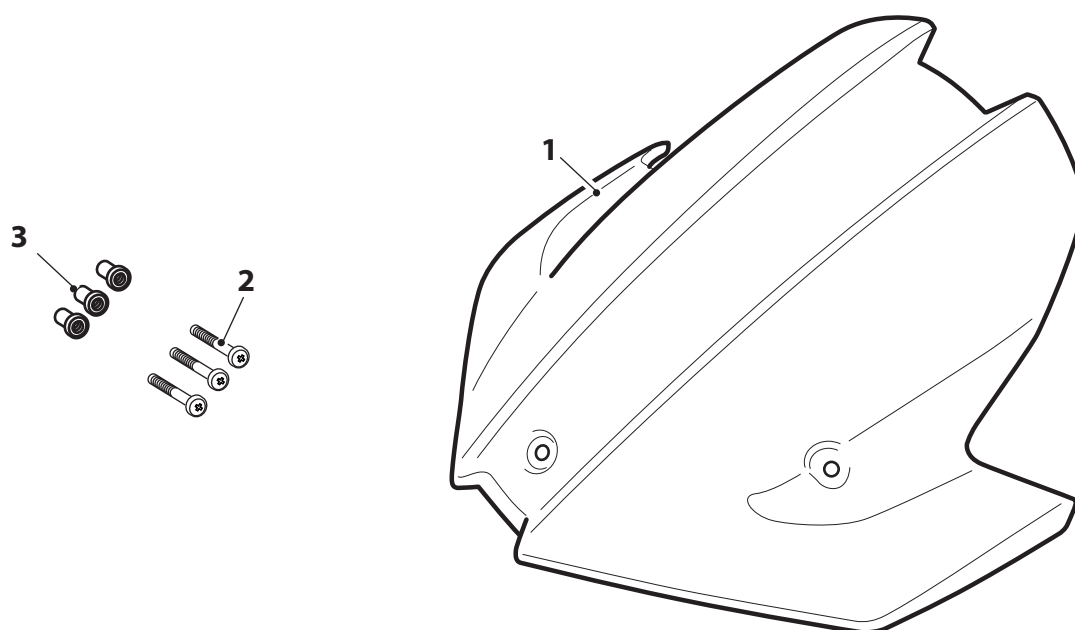

Parts Supplied:

1. Flyscreen visor	1 off	3. Well nut, M5	3 off
2. Screw, M5	3 off		



Warning

This accessory kit is designed for use on Triumph Speed Triple 1050 motorcycles from VIN 461332, Street Triple motorcycles from VIN 480782 and Street Triple R motorcycles from VIN 482182 only and should not be fitted to any other manufacturer's motorcycle. Fitting this accessory kit to any other manufacturer's motorcycle will affect the performance, stability and handling of the motorcycle. This may affect the rider's ability to control the motorcycle and could cause an accident.



Warning

Always have Triumph approved parts, accessories and conversions fitted by a trained technician of an authorised Triumph dealer. The fitment of parts, accessories and conversions by a technician who is not of an authorised Triumph dealer may affect the handling, stability or other aspects of the motorcycle's operation which may result in loss of motorcycle control and an accident.



Warning

Throughout this operation, ensure that the motorcycle is stabilised and adequately supported to prevent risk of injury from the motorcycle falling.



Warning

A torque wrench of known accurate calibration must be used when fitting this accessory kit. Failure to tighten any of the fasteners to the correct torque specification may result in loss of motorcycle control and an accident.

1. Position the motorcycle on a paddock stand.

Note:

- **If the motorcycle has a flyscreen fitted, remove it following the instructions at step 2 below.**
 - **If a flyscreen is not fitted to the motorcycle proceed to step 3.**
2. Remove the four M5 retaining screws, located in the infill panel. Remove the flyscreen, retain the screws for re-use.

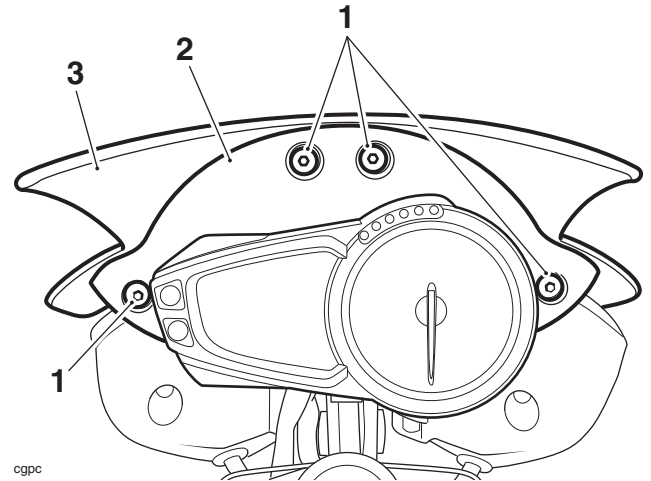

cgpc

1. Fixings
2. Infill panel
3. Flyscreen

3. Locate the three witness marks on the underside of the flyscreen. The marks are provided to indicate the drilling position.

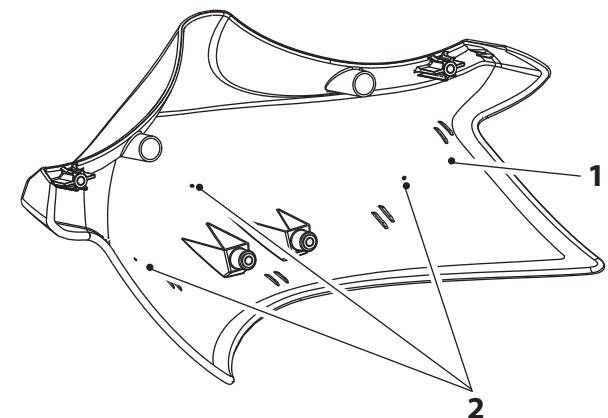

1. Flyscreen
2. Witness marks

Note:

- **It is advisable to drill a small pilot hole first, before drilling to the final 9.5 mm diameter.**
4. Support the flyscreen on a suitable surface which will prevent damage to the finish. At each witness mark carefully drill a 9.5 mm diameter hole, drilling from the underside of the flyscreen.
 5. Insert a Well nut into each of the drilled holes, from the front face of the flyscreen as shown. Ensure the head of the Well nut is flush with the flyscreen.

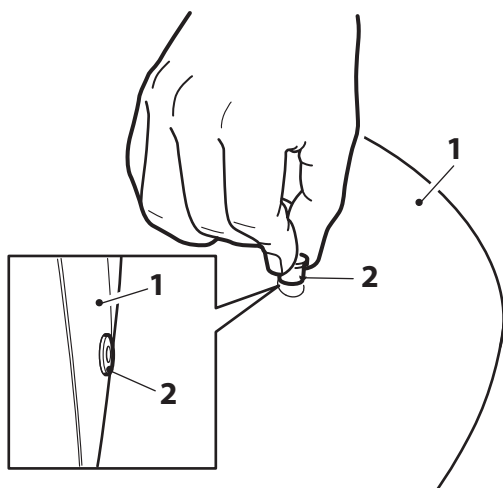

1. Flyscreen

2. Well nut

6. Fit one of the M5 screws to either the left hand or right hand side visor mounting hole as shown below.

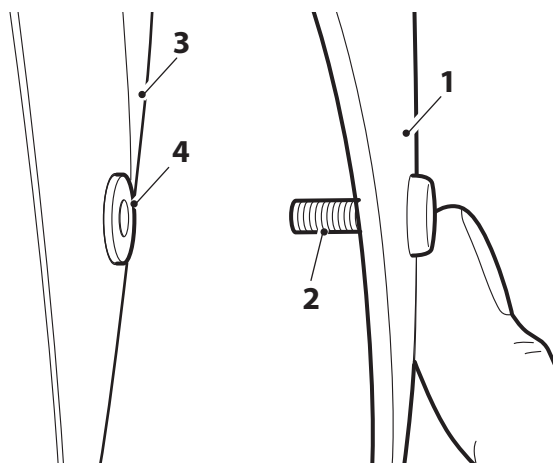

1. Visor

2. M5 screw

3. Flyscreen

4. Well nut

7. Position the visor on the flyscreen, aligning the M5 screw with the appropriate Well nut. Do not fully tighten the screw at this stage.
8. Fit a second M5 screw to the opposite side of the visor. Do not fully tighten the screw at this stage.

9. Fit the final M5 screw to the visor's centre hole. Do not fully tighten the screw at this stage.
10. Check that the visor is positioned correctly on the flyscreen and tighten the M5 screws to **0.5 Nm**.

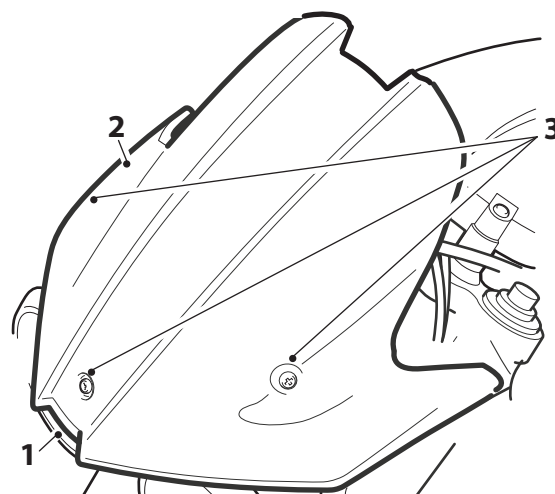

1. Flyscreen

2. Visor

3. M5 screws

11. Fit the flyscreen and visor assembly to the motorcycle and retain with the four original M5 fixings. Tighten the fixings to **3 Nm**.



Warning

Move the handlebar to the left and right full lock while checking that the mirrors do not restrict the steering by contacting the flyscreen visor assembly.

Operation of the motorcycle with restricted steering may result in loss of motorcycle control and an accident.



Caution

Move the handlebar to the left and right full lock while checking that the mirrors do not contact the flyscreen visor assembly when moving the handlebar.

Damage to the flyscreen visor assembly will result if the mirrors contact it. If the mirrors do make contact adjust their position.

12. If the mirrors contact the flyscreen visor assembly when on full lock, adjust the mirrors such that they will not contact it and they give rear visibility in the riding position.
13. Remove the motorcycle from the paddock stand.



Warning

After fitting the accessory kit the motorcycle will exhibit new handling characteristics. Operate the motorcycle in a safe area free from traffic to gain familiarity with any new characteristics. Operation of the motorcycle when not familiar with any new handling characteristics may result in loss of motorcycle control and an accident.



Warning

If, after fitment of this accessory kit, you have any doubt about the performance of any aspect of the motorcycle, contact an authorised Triumph dealer and do not ride the motorcycle until the authorised dealer has declared it fit for use. Riding a motorcycle when there is any doubt as to any aspect of the performance of the motorcycle may result in loss of control of the motorcycle leading to an accident.



Warning

Never ride an accessory equipped motorcycle at speeds above 80 mph (130 km/h). The presence of accessories will cause changes in the stability and handling of the motorcycle. Failure to allow for changes in motorcycle stability may lead to loss of control or an accident. Remember that the 80 mph (130 km/h) limit will be reduced by the fitting of non-approved accessories, incorrect loading, worn tyres, overall motorcycle condition and poor road or weather conditions.



Warning

Never attempt to clean the flyscreen visor while riding the motorcycle. Removal of the rider's hands from the handlebars while riding the motorcycle will diminish the ability of the rider to maintain control of the motorcycle. Attempting to clean the flyscreen visor while riding the motorcycle may result in loss of control of the motorcycle and an accident.



Warning

The flyscreen visor is not a substitute for a safety helmet or eye protection. Sports screens are designed to provide wind protection and increased riding comfort. They are not designed to provide protection in the event of a collision with another vehicle, the road, birds or any other object. When riding a motorcycle both rider and passenger must always wear a safety helmet, eye protection, gloves and trousers (close fitting around the knees and ankle). Although full protection is not possible, wearing the correct protective clothing can reduce the risk of injury when riding.



Warning

The motorcycle must not be operated above the legal road speed limit except in closed-course conditions.



Warning

Only operate this Triumph motorcycle at high speed in closed-course on road competition or on closed-course race tracks. High speed operation should only be attempted by riders who have been instructed in the techniques necessary for high speed riding and are familiar with the motorcycle's characteristics in all conditions. High speed operation in any other circumstances is dangerous and will lead to loss of motorcycle control and an accident.