

## Fitting Instructions: Adjustable Rider Backrest



Thank you for choosing this Triumph genuine accessory kit. This accessory kit is the product of Triumph's use of proven engineering, exhaustive testing, and continuous striving for superior reliability, safety and performance.

Completely read all of these instructions before commencing the installation of the accessory kit in order to become thoroughly familiar with the kit's features and the installation process.

These instructions should be considered a permanent part of your accessory kit, and should remain with it even if your accessory equipped motorcycle is subsequently sold.



### Warning

This accessory kit is designed for use on Triumph motorcycles only and should not be fitted to any other Triumph model or to any other manufacturers motorcycle. Fitting this accessory kit to any other manufacturers motorcycle, may interfere with the rider and could affect the handling, stability or other aspects of the motorcycles operation which may result in loss of motorcycle control and an accident.

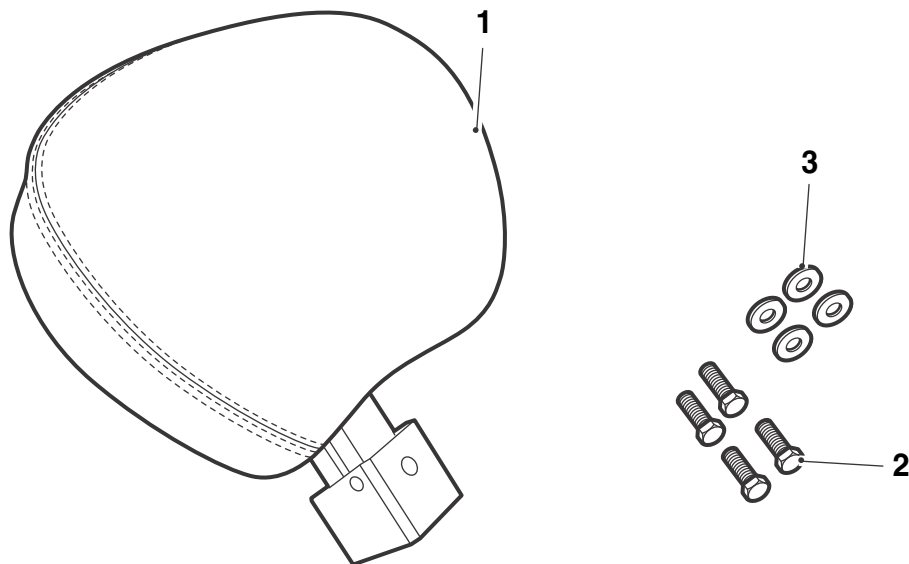

### Parts Supplied:

- |                                       |       |                         |       |
|---------------------------------------|-------|-------------------------|-------|
| 1. Backrest assembly . . . . .        | 1 off | 3. Washer, M6 . . . . . | 4 off |
| 2. Screw, hex head, M6 x 20 . . . . . | 4 off |                         |       |

## Warning

Always have Triumph approved parts, accessories and conversions fitted by a trained technician of an authorised Triumph dealer. The fitment of parts, accessories and conversions by a technician who is not of an authorised Triumph dealer may affect the handling, stability or other aspects of the motorcycles operation which may result in loss of motorcycle control and an accident.

## Warning

A torque wrench of known accurate calibration must be used when fitting this accessory kit. Failure to tighten any of the fasteners to the correct torque specification may affect motorcycle performance, handling and stability. This may result in loss of motorcycle control and an accident.

## Warning

After fitting the accessory kit the motorcycle will exhibit new handling characteristics. Operate the motorcycle in a safe area free from traffic to gain familiarity with any new characteristics. Operation of the motorcycle when not familiar with any new handling characteristics may result in loss of motorcycle control and an accident.

### Note:

- **The adjustable backrest kit has been designed for fitment to the accessory seat. The backrest CANNOT be fitted to the standard seat.**

1. Remove the seat, as described in the service manual.
2. Remove the two trim blank fixings as shown below and remove the trim blank from the seat. Retain the trim blank and fixings if the seat is to be returned to its original condition.

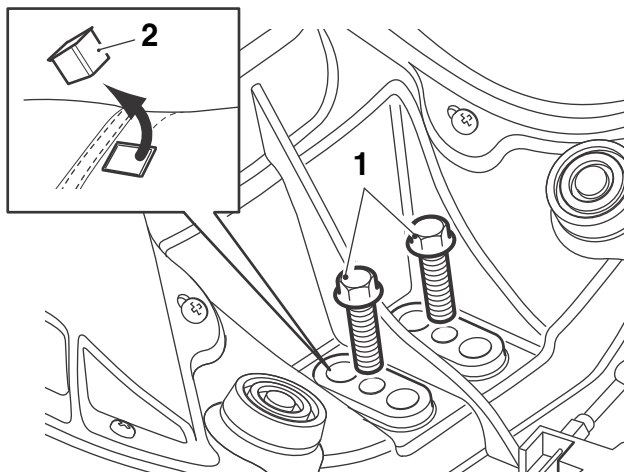

1. Trim blank fixing
2. Trim blank

3. Fit the backrest assembly into the seat aperture as shown below.

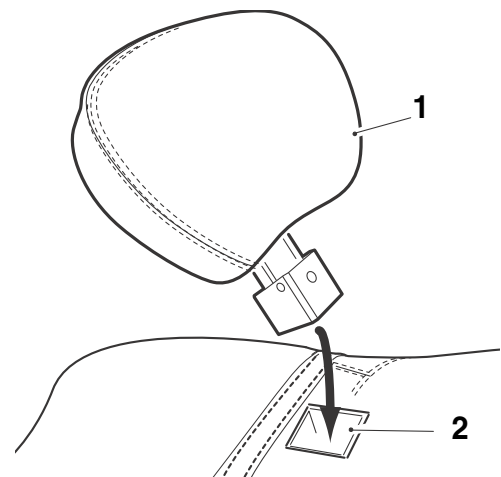

1. Backrest assembly
2. Seat aperture

4. Turn the seat upside down. Push the backrest assembly firmly into its recess, ensuring the fixing holes are aligned. Fit the four washers and screw fixings provided to secure the backrest to the seat, as shown below. Tighten the fixings to a torque value of **10 Nm**.

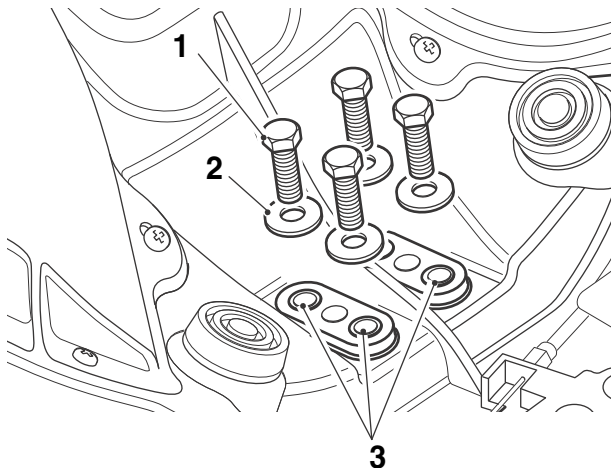

1. Screw fixing
2. Washer
3. Fixing holes

5. Refit the seat, as described in the service manual.
6. Check that the backrest is correctly adjusted, as described below, and that the fasteners are fully tightened.

## Backrest Adjustment

1. To adjust the recline of the backrest push the backrest forward to no more than 45° and rotate the adjustment wheel, as shown below, until the desired recline is achieved. There are six adjustment positions available.

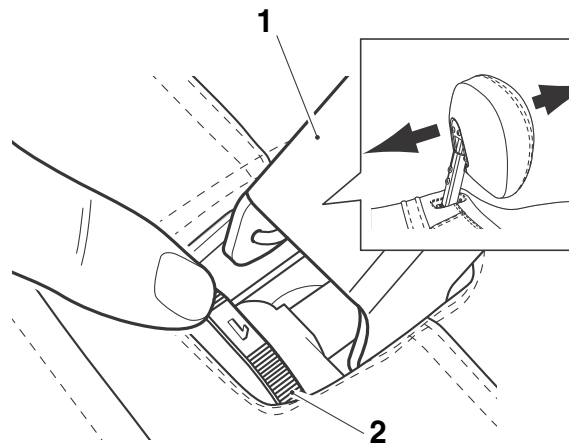

1. Backrest
2. Adjustment wheel

2. To adjust the backrest height, slacken the two screw fixings shown below and raise, or lower, the backrest into the desired position. Re-tighten the fixings to a torque value of **8 Nm**.

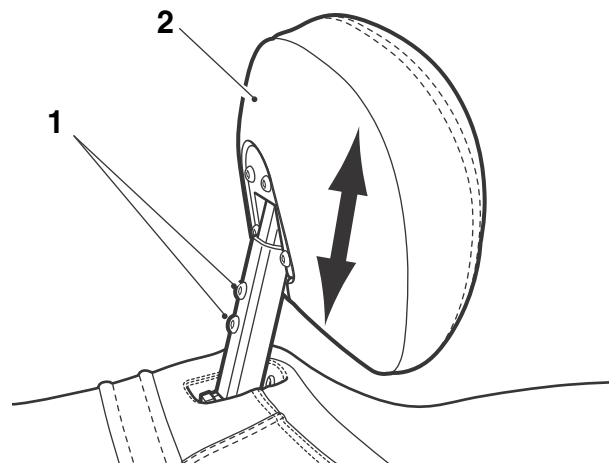

1. Screw fixing
2. Backrest



### Warning

After fitting the accessory kit the motorcycle will exhibit new handling characteristics. Operate the motorcycle in a safe area free from traffic to gain familiarity with any new characteristics. Operation of the motorcycle when not familiar with any new handling characteristics may result in loss of motorcycle control and an accident.



### Warning

If, after fitment of this accessory kit, you have any doubt about the performance of any aspect of the motorcycle, contact an authorised Triumph dealer and do not ride the motorcycle until the authorised dealer has declared it fit for use. Riding a motorcycle when there is any doubt as to any aspect of the performance of the motorcycle may result in loss of control of the motorcycle leading to an accident.



### Warning

Never ride an accessory equipped motorcycle at speeds above 80 mph (130 km/h).

The presence of accessories will cause changes in the stability and handling of the motorcycle. Failure to allow for changes in motorcycle stability may lead to loss of control or an accident.

Remember that the 80 mph (130 km/h) limit will be reduced by the fitting of non-approved accessories, incorrect loading, worn tyres, overall motorcycle condition and poor road or weather conditions.



### Warning

This motorcycle must not be operated above the legal road speed limit except in authorised closed course conditions.



### Warning

Only operate this Triumph motorcycle at high speed in closed-course on road competition or on closed course racetracks. High speed operation should only be attempted by riders who have been instructed in the techniques necessary for high speed riding and are familiar with the motorcycle's characteristics in all conditions.

High speed operation in any other circumstances is dangerous and will lead to loss of motorcycle control and an accident.