

Fitting Instructions: Street Triple Hugger Kit - A9708112



Thank you for choosing this Triumph genuine accessory kit. This accessory kit is the product of Triumph's use of proven engineering, exhaustive testing, and continuous striving for superior reliability, safety and performance.

Completely read all of these instructions before commencing the installation of the accessory kit in order to become thoroughly familiar with the kit's features and the installation process.

These instructions should be considered a permanent part of your accessory kit, and should remain with it even if your accessory equipped motorcycle is subsequently sold.

Warning

This accessory kit is designed for use on Triumph Street Triple motorcycles only and should not be fitted to any other Triumph model or to any other manufacturers motorcycle. Fitting this accessory kit to any other Triumph model, or to any other manufacturers motorcycle, may interfere with the rider and could affect the handling, stability or other aspects of the motorcycles operation which may result in loss of motorcycle control and an accident.

Warning

Always have Triumph approved parts, accessories and conversions fitted by a trained technician of an authorised Triumph dealer. The fitment of parts, accessories and conversions by a technician who is not of an authorised Triumph dealer may affect the handling, stability or other aspects of the motorcycles operation which may result in loss of motorcycle control and an accident.

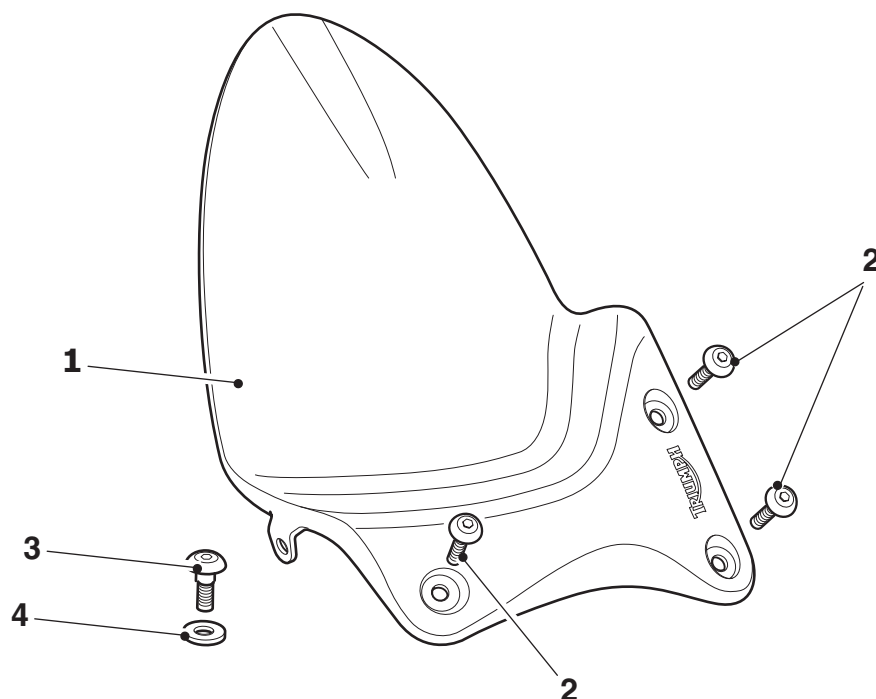

Parts Supplied:

1. Hugger, rear tyre	1 off	3. Screw, M5 x 17 shouldered	1 off
2. Screw, M5 x 16 socket head . . .	3 off	4. Washer, M5	1 off

Warning

Throughout this operation, ensure that the motorcycle is stabilised and adequately supported on a paddock stand to prevent risk of injury from the motorcycle falling.

Warning

A torque wrench of known accurate calibration must be used when fitting this accessory kit. Failure to tighten any of the fasteners to the correct torque specification may result in loss of motorcycle control and an accident.

1. Remove the rear wheel as described in the service manual.
2. Remove the front 'P' clip retaining the rear brake hose to the swinging arm. Retain the fixings if the motorcycle is to be returned to its original condition.

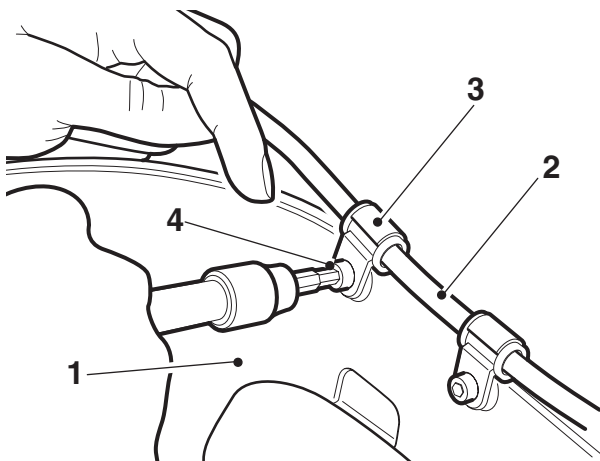

1. Swinging arm
2. Rear brake hose
3. Front 'P' clip
4. Fixing

3. Remove the three rubber caps and screws from the swinging arm. Retain the caps and screws if the motorcycle is to be returned to its original condition.

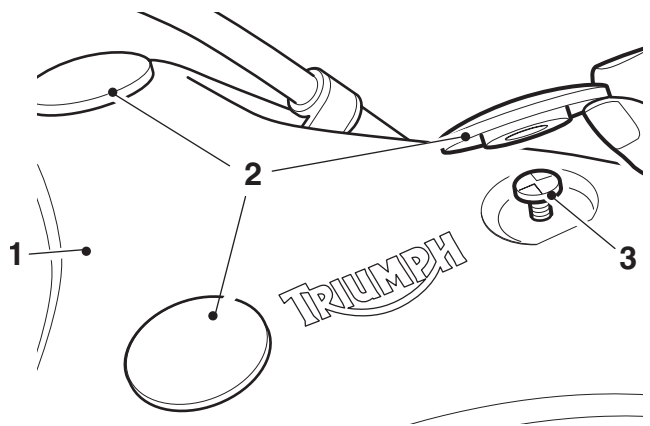

1. Swinging arm
2. Rubber cap
3. Screw

4. Locate the hugger in position on the swinging arm and loosely fit the three M5 x 16 screws provided.

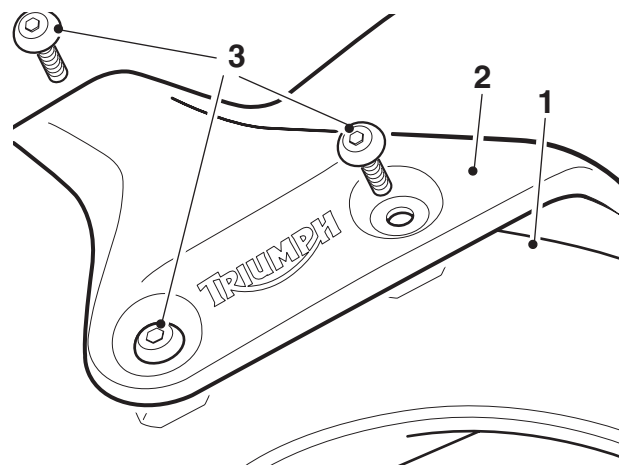

1. Swinging arm
2. Hugger
3. Screw, M5 x 16

5. Fit the M5 x 17 shouldered screw, hugger, washer and brake hose front 'P' clip to the swinging arm as shown below. Tighten the screw to **9Nm**.

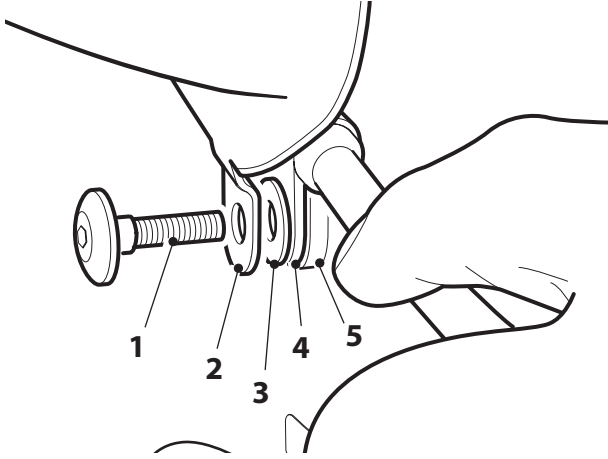

1. Shouldered screw, M5 x 17
 2. Hugger
 3. Washer
 4. 'P' clip
 5. Swinging arm
6. Refit the rear wheel as described in the service manual.
 7. Check the hugger is located centrally over the rear tyre and does not foul on any component. Tighten the three fixings to **3Nm**.
 8. Remove the paddock stand.

! Warning

After fitting the accessory kit the motorcycle will exhibit new handling characteristics. Operate the motorcycle in a safe area free from traffic to gain familiarity with any new characteristics. Operation of the motorcycle when not familiar with any new handling characteristics may result in loss of motorcycle control and an accident.

! Warning

If, after fitment of this accessory kit, you have any doubt about the performance of any aspect of the motorcycle, contact an authorised Triumph dealer and do not ride the motorcycle until the authorised dealer has declared it fit for use. Riding a motorcycle when there is any doubt as to any aspect of the performance of the motorcycle may result in loss of control of the motorcycle leading to an accident.

! Warning

Never ride an accessory equipped motorcycle at speeds above 80 mph (130 km/h). The presence of accessories will cause changes in the stability and handling of the motorcycle. Failure to allow for changes in motorcycle stability may lead to loss of control or an accident. Remember that the 80 mph (130km/h) limit will be reduced by the fitting of non-approved accessories, incorrect loading, worn tyres, overall motorcycle condition and poor road or weather conditions.

! Warning

The motorcycle must not be operated above the legal road speed limit except in closed course conditions.

! Warning

Only operate this Triumph motorcycle at high speed in closed-course on road competition or on closed course racetracks. High speed operation should only be attempted by riders who have been instructed in the techniques necessary for high speed riding and are familiar with the motorcycle's characteristics in all conditions. High speed operation in any other circumstances is dangerous and will lead to loss of motorcycle control and an accident.