



Accessory Fitting Instructions

Heated Seat Kit - Passenger	
Kit Number	Models Affected
A9701449	Tiger 1200 GT, Tiger 1200 GT Pro, Tiger 1200 Rally Pro

Thank you for choosing this Triumph genuine accessory kit. This accessory kit is the product of Triumph's use of proven engineering, exhaustive testing, and continuous striving for superior reliability, safety and performance.

Completely read all of these instructions before commencing the installation of the accessory kit in order to become thoroughly familiar with the kit's features and the installation process.

These instructions should be considered a permanent part of your accessory kit, and should remain with it even if your accessory equipped motorcycle is subsequently sold.

Parts supplied:

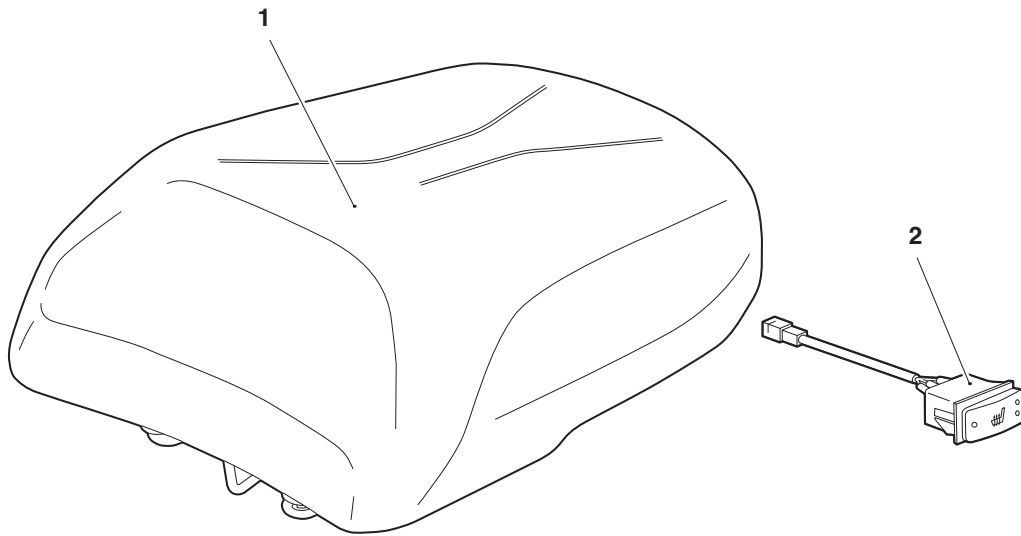

1. Heated seat, passenger	1 off	2. Switch, heated seat	1 off
---------------------------	-------	------------------------	-------

 **Warning**

Fit only genuine Triumph accessories to those models approved by Triumph as listed in the associated Triumph fitting instructions. The accessory kits covered in this instruction are designed for use on specific models of Triumph motorcycle. The accessory kits and the models applicable are listed at the start of the instruction. They should never be fitted to any other Triumph model or to any other manufacturer's motorcycle. Fitting an accessory kit to a Triumph model not listed, or to any other manufacturer's motorcycle will affect the performance, stability and handling of the motorcycle. This may affect the rider's ability to control the motorcycle and could result in an accident causing severe injuries or death.

 **Warning**

Always have Triumph approved parts, accessories and conversions fitted by a trained technician of an authorised Triumph dealer. The fitment of parts, accessories and conversions by a technician who is not of an authorised Triumph dealer may affect the handling, stability or other aspects of the motorcycle's operation which may result in loss of motorcycle control and an accident.

 **Warning**

Throughout this operation, make sure that the motorcycle is stabilised and adequately supported to prevent risk of injury from the motorcycle falling.

 **Warning**

A torque wrench of known accurate calibration must be used when fitting this accessory kit. Failure to tighten any of the fasteners to the correct torque specification may affect motorcycle performance, handling and stability. This may result in loss of motorcycle control and an accident.

Note:

- **Triumph offers a broad range of approved genuine accessories for your motorcycle. We cannot therefore cover all possible equipment variations in these instructions. For removal and installation of Triumph Genuine Accessories, always refer to the instructions supplied with the respective accessory kit. To obtain additional copies of any Triumph accessory instructions, visit www.triumphinstructions.com or contact your authorised Triumph dealer.**

 **Warning**

Always make sure that the newly installed wiring does not chafe against other parts of the motorcycle such that it may be rubbed through and cause an electrical problem. In addition, always make sure that the newly installed wiring will not restrict steering movement. Both conditions are hazardous and could give rise to a dangerous riding condition resulting in a fire, loss of motorcycle control and an accident.

 **Caution**

If removing heated seats for any reason, always disconnect the heated seat harness. Do not allow the heated seats to hang freely on the sub-harness as this would result in irreparable damage to the heated seat.

 **Caution**

To prevent damage to the seats or seat covers care must be taken not to drop the seats. Do not lean the seats against the motorcycle or any surface which may damage the seats or seat covers. Always place the seats, with the seat cover facing upwards, on a clean flat surface which is covered with a soft cloth. Never place any item on the seats which may cause damage or staining to the seat covers.

1. Remove the rider and passenger seats as described in the Service Manual.
2. Disconnect the battery as described in the Service Manual.

Note:

- **To remove phone tray fully, disconnect the USB connector and alarm reed switch connector (if fitted).**

- Remove the phone tray from the motorcycle as described in the Service Manual. Retain the plastic fixings and phone tray for reuse.

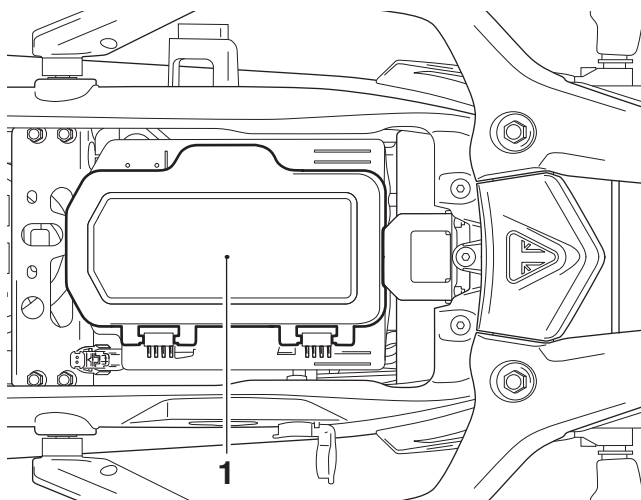

1. Phone tray

- Taking care not to damage the blanking plug or body panel, remove the heated passenger seat switch blanking plug on the left hand side of the motorcycle. Retain the blanking plug if the motorcycle is to be returned to its original condition.

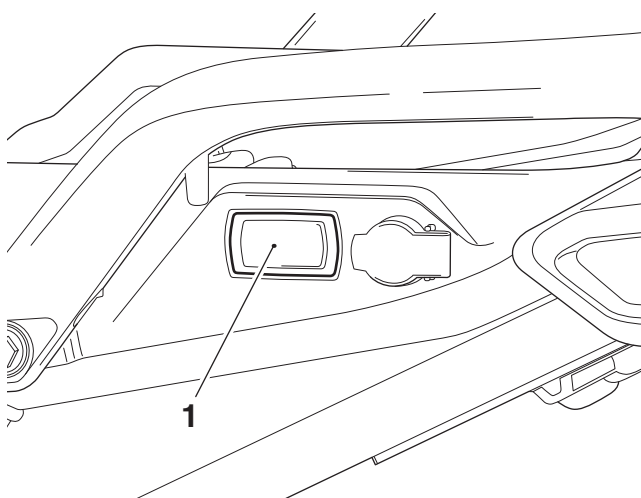

1. Blanking plug

- Route the heated seat switch harness from the kit through the aperture, fit the switch into the aperture in the orientation shown, making sure the locking pegs are located fully.

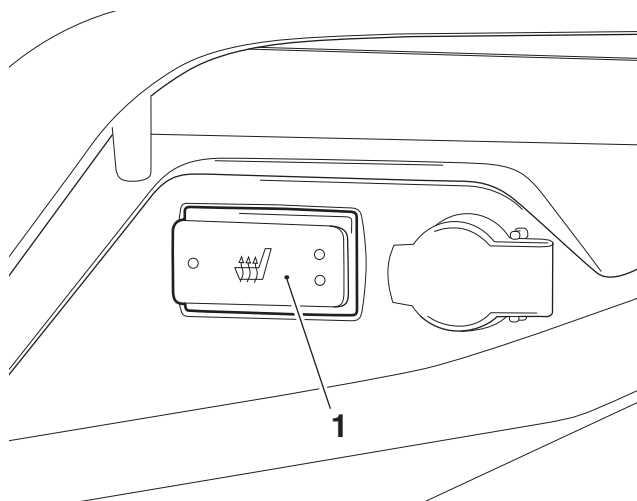

1. Heated seat switch

 Caution
<p>Blanking plugs are fitted to the harness electrical connectors to prevent water ingress. If the blanking plugs are removed for any reason, they should always be refitted. The harness electrical connectors should never be left exposed without the blanking plugs fitted as this may lead to a malfunction, or premature failure of components.</p>

- Locate the main wiring harness connector on the left side of the motorcycle, as shown. Remove the blanking plug from the main harness connector. Retain the blanking plug for reuse if the motorcycle is to be returned to its original condition. Connect the heated seat switch harness to the main wiring harness connector.

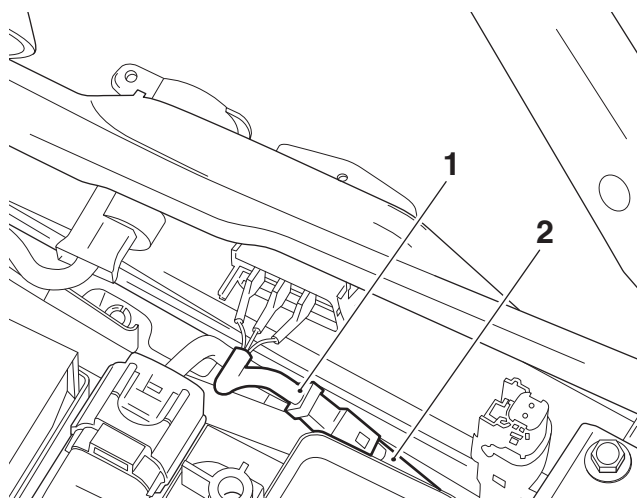

1. Heated seat harness connector
2. Main wiring harness connector

- Refit the phone tray, as described in the Service Manual.

Caution

Blanking plugs are fitted to the harness electrical connectors to prevent water ingress. If the blanking plugs are removed for any reason, they should always be refitted. The harness electrical connectors should never be left exposed without the blanking plugs fitted as this may lead to a malfunction, or premature failure of components.

- Remove the blanking plug from the passenger heated seat main harness connector. Retain the blanking plug if the motorcycle is to be returned to its original condition.

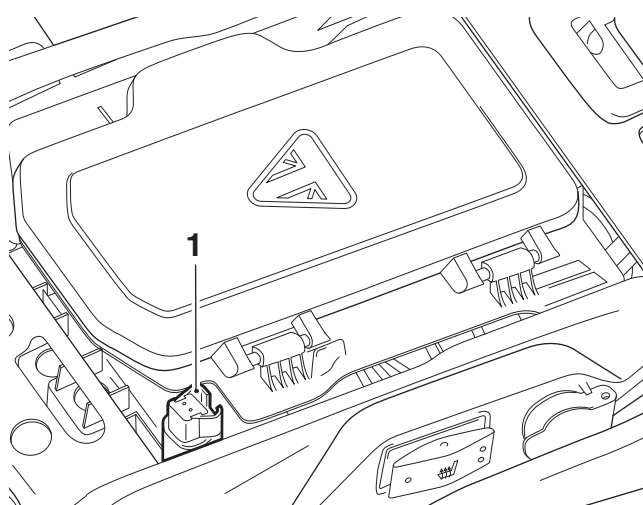

1. Blanking plug

- Connect the heated passenger seat connector to the main wiring harness connector.
- Reconnect the battery as described in the Service Manual.

Caution

A wiring harness which becomes trapped or kinked during installation, or general motorcycle operation, may result in wiring harness damage and electrical malfunctions.

- Fit the seats as described in the Service Manual. Make sure that the harness for the heated seat does not become trapped between the seat and the frame.

Heated Seat Operation

Note:

- The heated seats will only heat when the engine is running.
- The system is designed to offer a variable level of heat at the seats from warm to hot.

Note:

- The heated seat is operated by the switch provided in the accessory kit.
- The heated seat switch has three operating modes as described below:
 - OFF - central position;
 - HOT - two dots (rocker switch depressed);
 - WARM - one dot (rocker switch depressed).

Multifunction Display

When the heated seats are switched on, the heated seats symbol will appear in the multifunction display and the selected heat level for each seat will be displayed, as shown below. When the heated seats are switched off, after a short delay, the heated seats symbol will disappear from the multifunction display.

Note:

The instruments have multiple layout options which change the position of the heated seat symbols. The symbol graphic will not change based on the instrument layout.

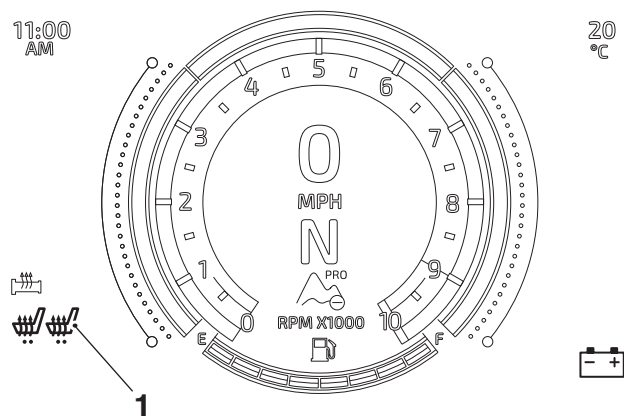

1. Heated passenger seat (hot selected), illuminated Red

For maximum benefit in cold conditions, switch the heated seats to the hot setting initially and then reduce the heat level by switching to the warm setting when the seat has warmed up.

The heated seats are protected by a chassis ECM which will automatically cut power in the event of an overload.

Power can be restored to the heated seats by turning the ignition switch off, then on again, provided that the condition that caused the fault has been rectified.

In the event of a more serious overload, fuse number PS 3 protects the heated seats. Refer to the label in the fuse box lid for fuse amperage.

Low Power Voltage Cut Off

If a low voltage is detected the heated seats switches will power off. The heated seats will not function again until the voltage rises to a nominal level.

The switch will not power back on automatically even if the voltage rises to the nominal level. The ignition must be switched off then on again to activate the heated seats.

Heated Seat System Testing

1. Operate the switch in all positions and check that the heated seat/s warm up and switch off as required.

Warning

After fitting the accessory kit the motorcycle will exhibit new handling characteristics. Operate the motorcycle in a safe area free from traffic to gain familiarity with any new characteristics. Operation of the motorcycle when not familiar with any new handling characteristics may result in loss of motorcycle control and an accident.

Warning

If, after fitment of this accessory kit, you have any doubt about the performance of any aspect of the motorcycle, contact an authorised Triumph dealer and do not ride the motorcycle until the authorised dealer has declared it fit for use. Riding a motorcycle when there is any doubt as to any aspect of the performance of the motorcycle may result in loss of motorcycle control and an accident.

Warning

Never ride an accessory equipped motorcycle at speeds above 80 mph (130 km/h).

The presence of accessories will cause changes in the stability and handling of the motorcycle. Failure to allow for changes in motorcycle stability may result in loss of motorcycle control and an accident.

Remember that the 80 mph (130 km/h) limit will be reduced by the fitting of non-approved accessories, incorrect loading, worn tyres, overall motorcycle condition and poor road or weather conditions.

Warning

The motorcycle must not be operated above the legal road speed limit except in closed-course conditions.

Warning

Only operate this Triumph motorcycle at high speed in closed-course, on-road competition or on closed-course racetracks. High-speed operation should only be attempted by riders who have been instructed in the techniques necessary for high-speed riding and are familiar with the motorcycle's characteristics in all conditions.

High-speed operation in any other circumstances is dangerous and may result in loss of motorcycle control and an accident.