

Fitting Instructions: Dual Touring Seat

Warning

Always have Triumph approved parts, accessories and conversions fitted by a trained technician of an authorised Triumph dealer. The fitting of parts, accessories and conversions by a technician who is not of an authorised Triumph dealer may affect the handling, stability or other aspects of the motorcycle operation, which may result in an accident causing injury or death.

Warning

These seats are designed for use solely on the Triumph Rocket III & Rocket III Classic and should not be fitted to any other Triumph model or to any motorcycle of other manufacturers. Fitting these seats to any other Triumph model or to any motorcycle of other manufacturers may interfere with the rider and could affect the stability and handling of the motorcycle leading to an accident causing injury or death.

Warning

Throughout this operation, ensure that the motorcycle is stabilised and adequately supported to prevent the risk of injury from the motorcycle falling.

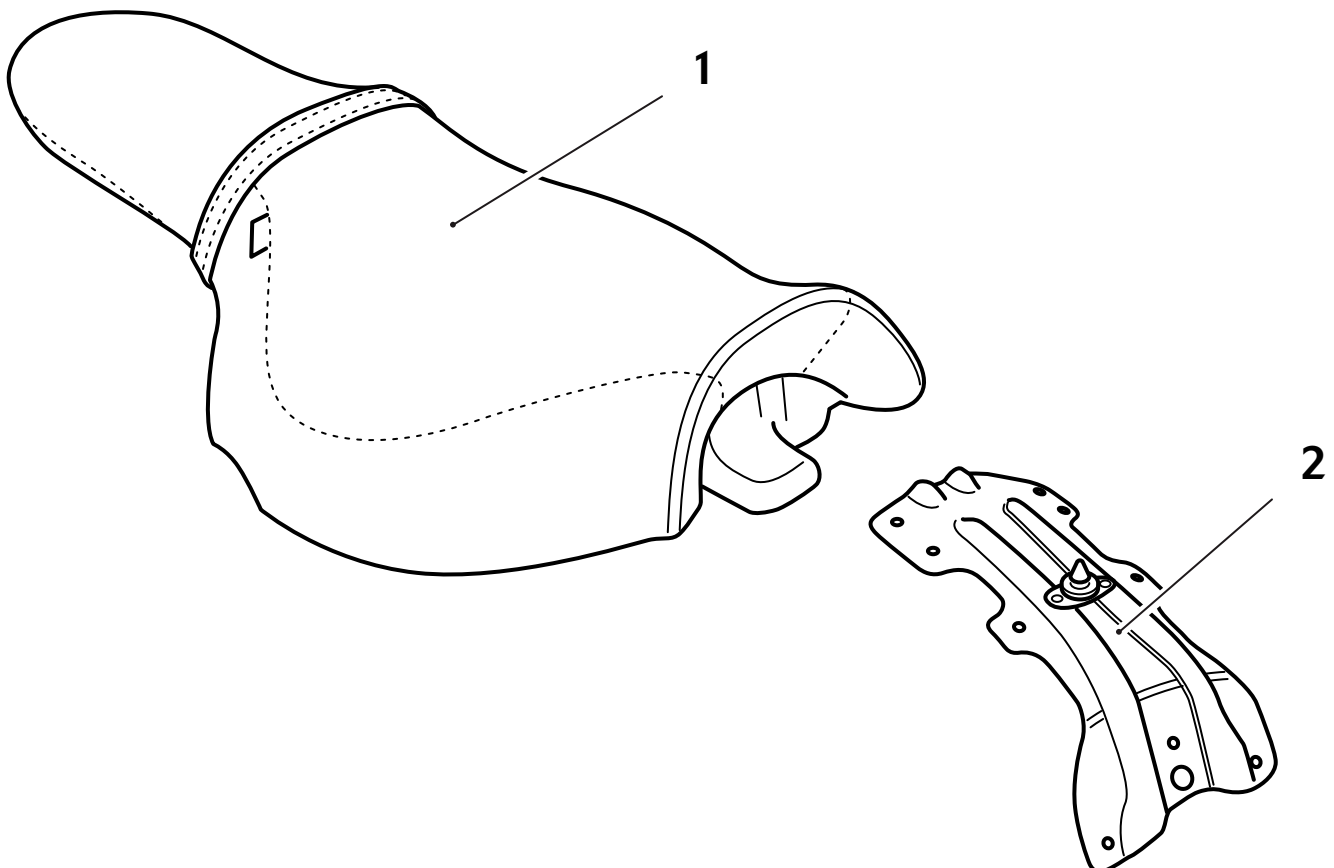

Parts Supplied:

1. Dual seat 1 off

2. Mounting plate 1 off

1. Remove the front and pillion seats.

NOTE

- Retain the original seats for re-use if required.
 - Retain the three M6 bolts and washers that hold the pillion seat for later use.
2. Assemble the mounting plate from the kit with the three original M6 bolts and washers as shown below. Tighten the bolts to **9 Nm**.

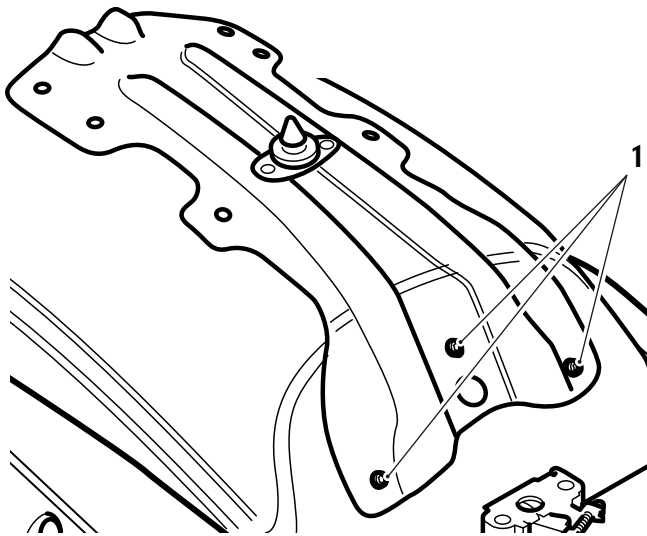

1.Fixings

3. Position the seat to the fuel tank and seat locks and press down on the lock areas to secure it.
4. Ensure the seat is correctly fitted by pulling upwards in the area of the seat locks. If correctly fitted, the seat will not detach from either lock or the tongue location beneath the fuel tank.

