



Accessory Fitting Instructions

Screen Kit	
Kit Number	Models Affected
A9700999	Rocket 3 R, Rocket 3 TFC, Rocket 3 R Black, Rocket 3 R Storm

Thank you for choosing this Triumph genuine accessory kit. This accessory kit is the product of Triumph's use of proven engineering, exhaustive testing, and continuous striving for superior reliability, safety and performance.

Completely read all of these instructions before commencing the installation of the accessory kit in order to become thoroughly familiar with the kit's features and the installation process.

These instructions should be considered a permanent part of your accessory kit, and should remain with it even if your accessory equipped motorcycle is subsequently sold.

Parts Supplied

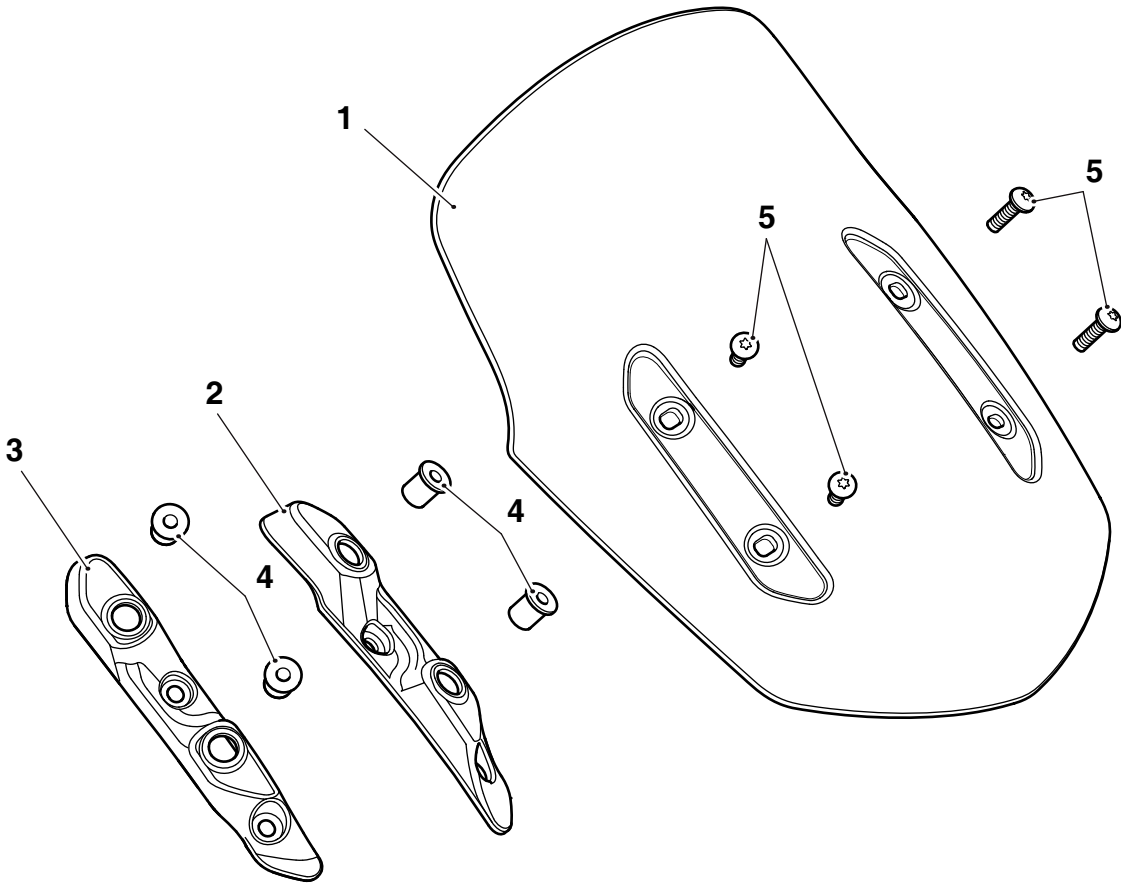

1. Screen	1 off	4. Well nut, M6	4 off
2. Screen Mounting, left hand	1 off	5. Fixing, M6 x 20 mm	4 off
3. Screen Mounting, right hand	1 off		



Warning

Fit only genuine Triumph accessories to those models approved by Triumph as listed in the associated Triumph fitting instructions. The accessory kits covered in this instruction are designed for use on specific models of Triumph motorcycle. The accessory kits and the models applicable are listed at the start of the instruction. They should never be fitted to any other Triumph model or to any other manufacturer's motorcycle. Fitting an accessory kit to a Triumph model not listed, or to any other manufacturer's motorcycle will affect the performance, stability and handling of the motorcycle. This may affect the rider's ability to control the motorcycle and could result in an accident causing severe injuries or death.



Warning

Always have Triumph approved parts, accessories and conversions fitted by a trained technician of an authorised Triumph dealer. The fitment of parts, accessories and conversions by a technician who is not of an authorised Triumph dealer may affect the handling, stability or other aspects of the motorcycle's operation which may result in loss of motorcycle control and an accident.



Warning

Make sure the motorcycle is supported. A correctly supported motorcycle will prevent it from falling. An unstable motorcycle may fall, causing injury to the operator or damage to the motorcycle.



Warning

A torque wrench of known accurate calibration must be used when fitting this accessory kit. Failure to tighten any of the fasteners to the correct torque specification may affect motorcycle performance, handling and stability. This may result in loss of motorcycle control and an accident.

Note:

- Triumph offers a broad range of approved genuine accessories for your motorcycle. We cannot therefore cover all possible equipment variations in these instructions. For removal and installation of Triumph Genuine Accessories, always refer to the instructions supplied with the respective accessory kit. To obtain additional copies of any Triumph accessory instructions, visit www.triumphinstructions.com or contact your authorised Triumph dealer.

- Remove the four flyscreen fixings, left hand and right hand flyscreen finishers and flyscreen. Retain the flyscreen, finishers and fixings for reuse.

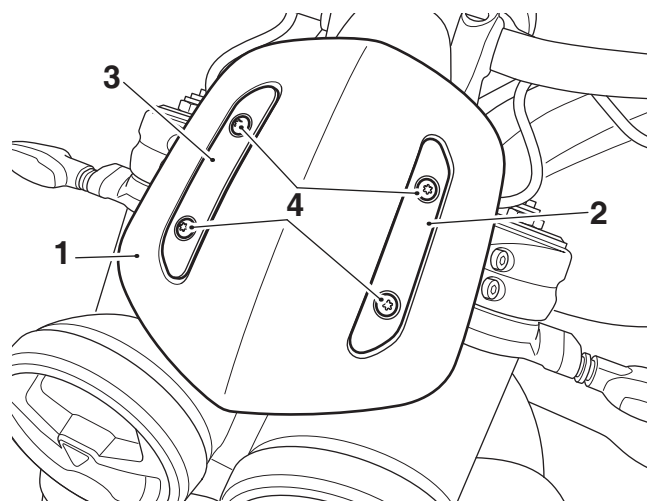

1. Flyscreen
2. Finisher, left hand
3. Finisher, right hand
4. Fixings

2. Refit the flyscreen and align it with the original fixing positions. Fit the left hand and right hand screen mountings from the kit and secure with the original fixings. Tighten the fixings to **5 Nm**.

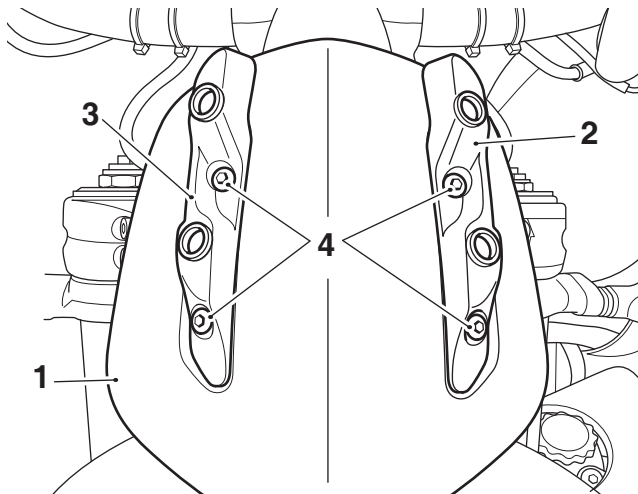

1. Flyscreen
2. Screen mounting, left hand
3. Screen mounting, right hand
4. Fixings

3. Fit the four well nuts from the kit into the left hand and right hand screen mountings, as shown.

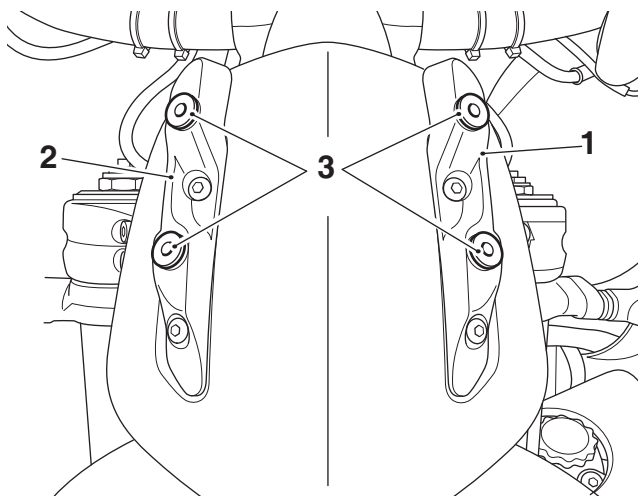

1. Screen mounting, left hand
2. Screen mounting, right hand
3. Well nuts



Caution

Care must be taken when fitting the screen. Damage to the screen surfaces could result from inadequate care during the assembly process.

4. Position the screen from the kit onto the screen mountings and align the screen fixing positions with the well nuts. Fit the original right hand finisher into the screen recess and loosely fit two M6 x 20 mm fixings from the kit.

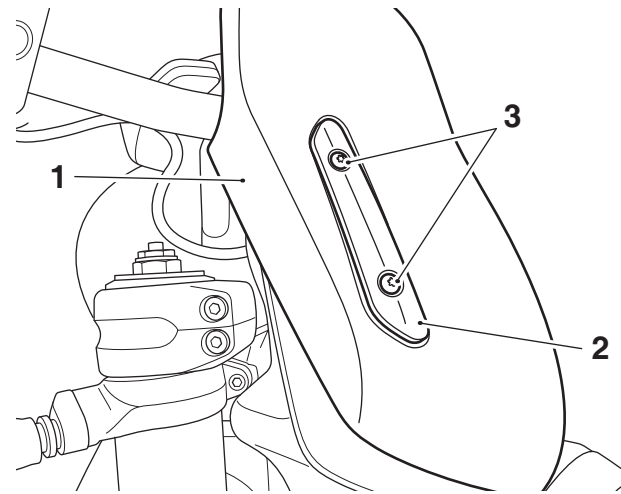

1. Screen
2. Finisher, right hand
3. Fixings, M6 x 20 mm

5. Fit the original left hand finisher and loosely fit two M6 x 20 mm fixings from the kit. Ensure the screen is aligned centrally on the flyscreen and the left hand and right hand finishers are correctly located in the screen recesses. Tighten the four fixings to **1 Nm**.

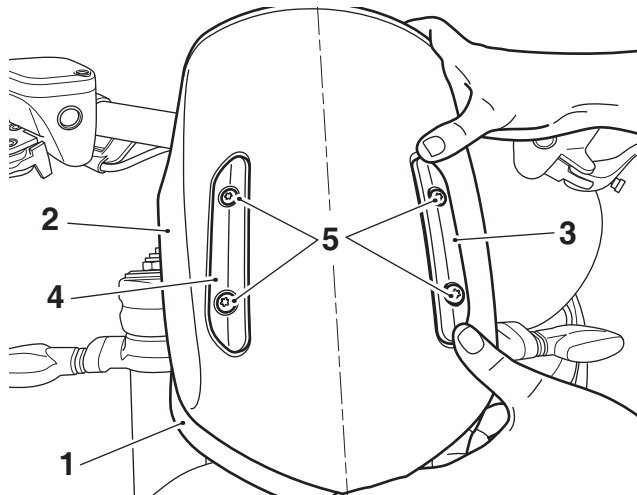

1. Flyscreen
2. Screen
3. Finisher, left hand
4. Finisher, right hand
5. Fixings, M6 x 20 mm



Warning

After fitting the accessory screen the motorcycle will exhibit new handling characteristics. Operate the motorcycle in a safe area free from traffic to gain familiarity with any new characteristics. Operation of the motorcycle when not familiar with any new handling characteristics may result in loss of motorcycle control and an accident.



Warning

Never attempt to clean the accessory screen while riding the motorcycle. Removal of the rider's hands from the handlebars while riding the motorcycle will diminish the ability of the rider to maintain control of the motorcycle. Attempting to clean the accessory screen while riding the motorcycle may result in loss of motorcycle control and an accident.



Warning

The accessory screen is not a substitute for a safety helmet or eye protection. Accessory screens are designed to provide wind protection and increased riding comfort. They are not designed to provide protection in the event of a collision with another vehicle, the road, birds or any other object. When riding a motorcycle both rider and passenger must always wear a safety helmet, eye protection, gloves and trousers (close fitting around the knees and ankle). Although full protection is not possible, wearing correct protective clothing can reduce the risk of injury when riding.



Warning

If, after fitting this accessory kit, you have any doubt about the performance of any aspect of the motorcycle, contact an authorised Triumph dealer and do not ride the motorcycle until the authorised dealer has declared it fit for use. Riding a motorcycle when there is any doubt as to any aspect of the performance of the motorcycle may result in loss of motorcycle control and an accident.



Warning

Never ride an accessory-equipped motorcycle at speeds above 80 mph (130 km/h).

The presence of accessories will cause changes in the stability and handling of the motorcycle. Failure to allow for changes in motorcycle stability may result in loss of motorcycle control and an accident.

Remember that the 80 mph (130 km/h) limit will be reduced by the fitting of non-approved accessories, incorrect loading, worn tyres, overall motorcycle condition and poor road or weather conditions.



Warning

The motorcycle must not be operated above the legal road speed limit except in closed-course conditions.



Warning

Only operate this Triumph motorcycle at high speed in closed-course, on-road competition or on closed-course racetracks. High-speed operation should only be attempted by riders who have been instructed in the techniques necessary for high-speed riding and are familiar with the motorcycle's characteristics in all conditions.

High-speed operation in any other circumstances is dangerous and may result in loss of motorcycle control and an accident.