



## Accessory Fitting Instructions

| Bellypan Kit |                         |
|--------------|-------------------------|
| Kit Number   | Models Affected         |
| A9700685     | Trident from VIN AC6898 |

Thank you for choosing this Triumph genuine accessory kit. This accessory kit is the product of Triumph's use of proven engineering, exhaustive testing, and continuous striving for superior reliability, safety and performance.

Completely read all of these instructions before commencing the installation of the accessory kit in order to become thoroughly familiar with the kit's features and the installation process.

These instructions should be considered a permanent part of your accessory kit, and should remain with it even if your accessory equipped motorcycle is subsequently sold.

### Parts Supplied:

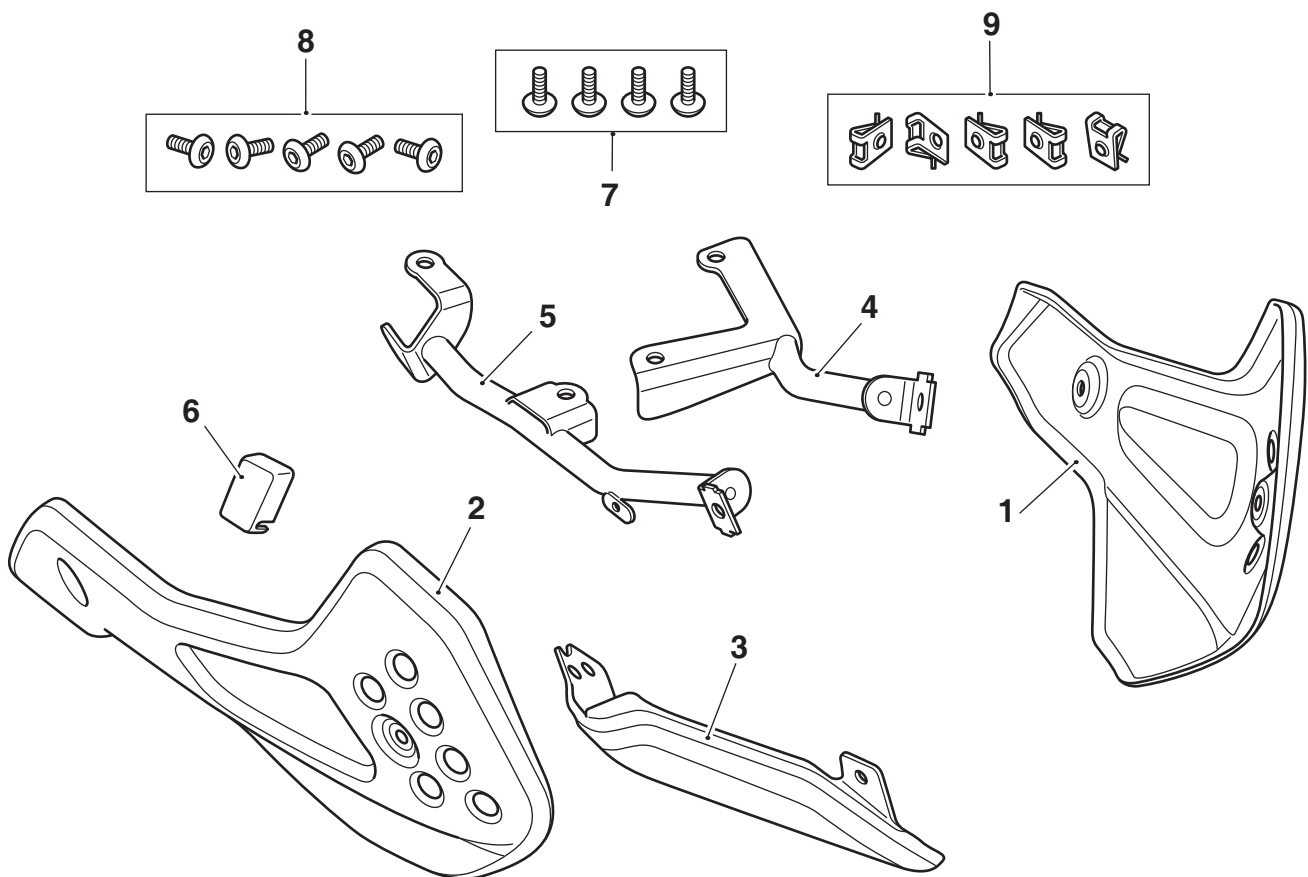

|    |                      |       |    |                                   |       |
|----|----------------------|-------|----|-----------------------------------|-------|
| 1. | Bellypan, left hand  | 1 off | 6. | Bung                              | 1 off |
| 2. | Bellypan, right hand | 1 off | 7. | Fixing, M5 x 16 mm                | 4 off |
| 3. | Bellypan cover       | 1 off | 8. | Fixing, M5 x 12 mm (encapsulated) | 5 off |
| 4. | Bracket, left hand   | 1 off | 9. | Captive nut                       | 5 off |
| 5. | Bracket, right hand  | 1 off |    |                                   |       |

**Warning**

Fit only genuine Triumph accessories to those models approved by Triumph as listed in the associated Triumph fitting instructions. The accessory kits covered in this instruction are designed for use on specific models of Triumph motorcycle. The accessory kits and the models applicable are listed at the start of the instruction. They should never be fitted to any other Triumph model or to any other manufacturer's motorcycle. Fitting an accessory kit to a Triumph model not listed, or to any other manufacturer's motorcycle will affect the performance, stability and handling of the motorcycle. This may affect the rider's ability to control the motorcycle and could result in an accident causing severe injuries or death.

**Warning**

Always have Triumph approved parts, accessories and conversions fitted by a trained technician of an authorised Triumph dealer. The fitment of parts, accessories and conversions by a technician who is not of an authorised Triumph dealer may affect the handling, stability or other aspects of the motorcycle's operation which may result in loss of motorcycle control and an accident.

**Warning**

Throughout this operation, ensure that the motorcycle is stabilised and adequately supported to prevent risk of injury from the motorcycle falling.

**Warning**

A torque wrench of known accurate calibration must be used when fitting this accessory kit. Failure to tighten any of the fasteners to the correct torque specification may affect motorcycle performance, handling and stability. This may result in loss of motorcycle control and an accident.

**Warning**

If the engine has recently been running, the exhaust system will be hot. Before working on or near the exhaust system, allow sufficient time for the system to cool, as touching any part of a hot exhaust could cause burn injuries.

**Note:**

- Triumph offers a broad range of approved genuine accessories for your motorcycle. We cannot therefore cover all possible equipment variations in these instructions. For removal and installation of Triumph Genuine Accessories, always refer to the instructions supplied with the respective accessory kit. To obtain additional copies of any Triumph accessory instructions, visit [www.triumphinstructions.com](http://www.triumphinstructions.com) or contact your authorised Triumph dealer.

- Remove the fixing from the catalytic converter heat shield and pull the heat shield towards the header pipes as shown to remove it from the motorcycle. Retain the heat shield and fixing for reuse if the motorcycle is to be returned to its original condition.

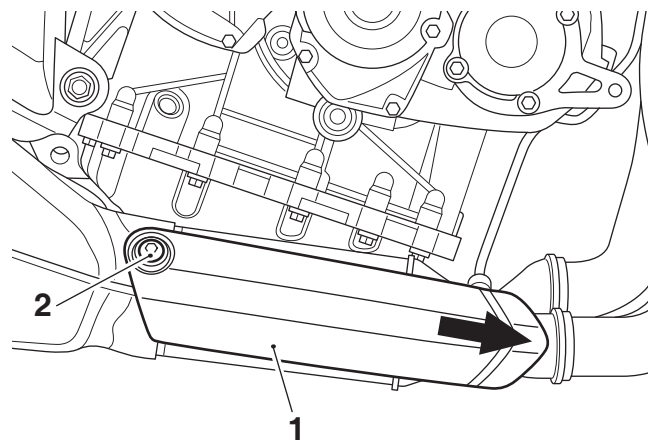

- Heat shield, catalytic converter
- Fixing

- Remove the captive nut from the catalytic converter heat shield fixing position. Retain the captive nut for reuse if the motorcycle is to be returned to its original condition.

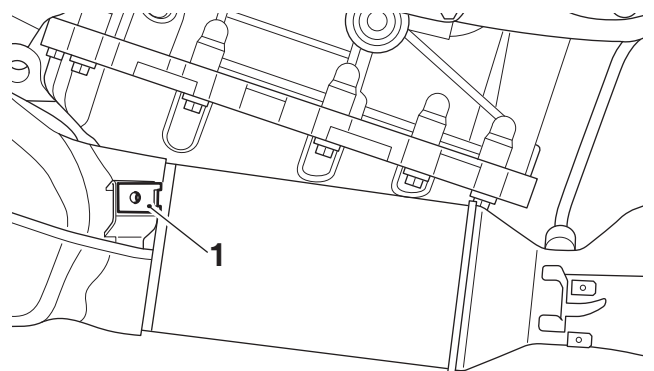

- Captive nut

- Fit the right hand mounting bracket to the engine sump in the orientation shown with two M5 x 16 mm fixings from the kit. Tighten the fixings to **6 Nm**.

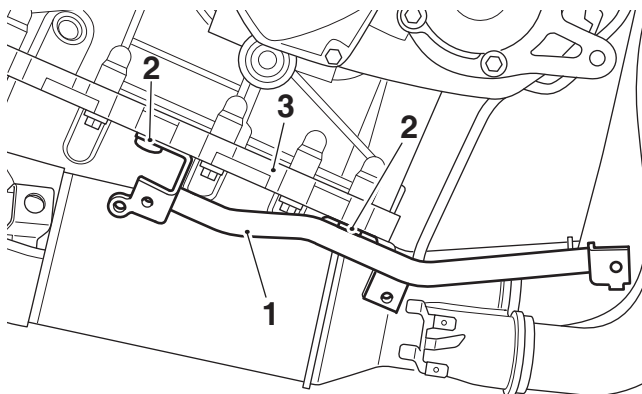

- Mounting bracket, right hand
- Fixings, M5 x 16 mm
- Sump

- Fit three captive nuts from the kit onto the right hand mounting bracket in the orientation shown.

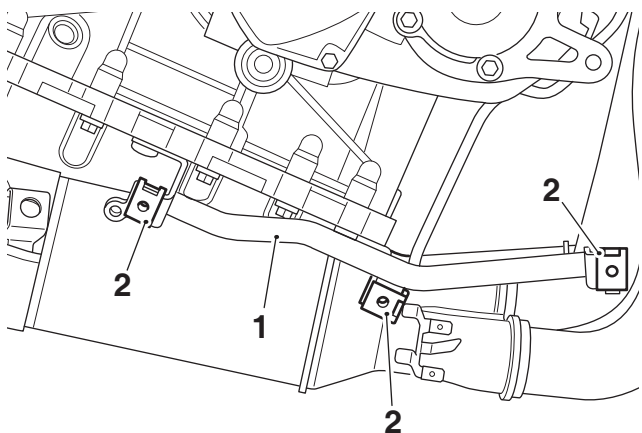

- Mounting bracket, right hand
- Captive nuts

- Fit the left hand mounting bracket to the engine sump in the orientation shown with two M5 x 16 mm fixings from the kit. Tighten the fixings to **6 Nm**.

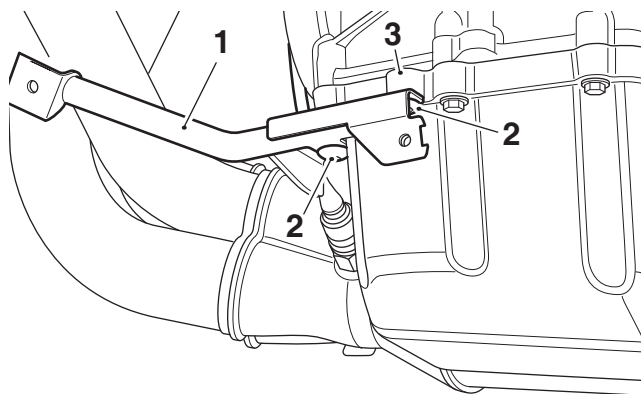

- Mounting bracket, left hand
- Fixings, M5 x 16 mm
- Sump

- Fit two captive nuts from the kit onto the left hand mounting bracket in the orientation shown.

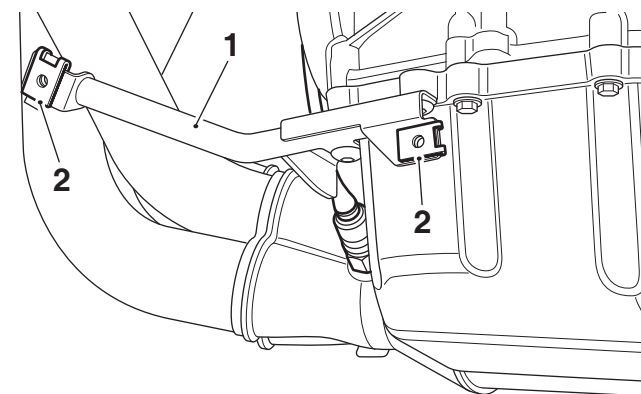

- Mounting bracket, left hand
- Captive nuts

- Fit the bung from the kit to the catalytic converter heat shield fixing position in the orientation shown.

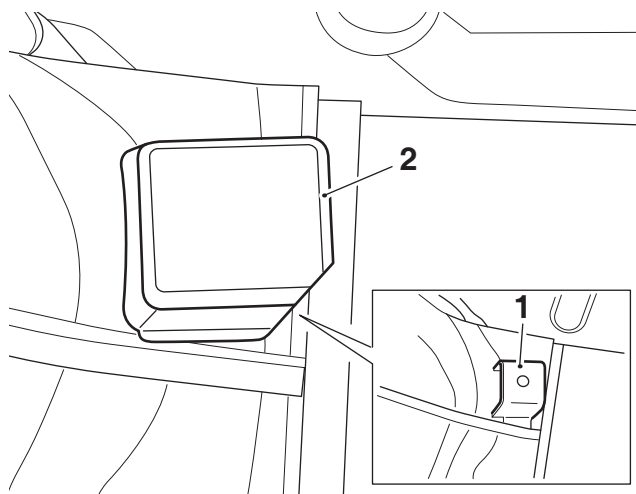

- Fixing position, catalytic converter heat shield
- Bung

- Position the bellypan cover from the kit on to the right hand mounting bracket in the orientation shown. Fit an M5 x 12 mm fixing from the kit to the cover front fixing position as shown. Do not fully tighten the fixing at this stage. Make sure the anti-rotation feature on the bellypan cover locates correctly in the hole in the mounting bracket. Tighten the fixing to 5 Nm.

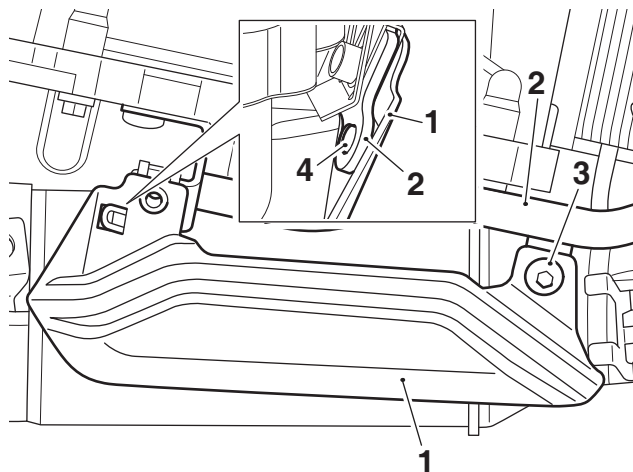

- Bellypan cover
- Mounting bracket, right hand
- Fixing, M5 x 12 mm
- Anti-rotation feature

- Position the right hand bellypan from the kit over the bellypan cover on to the right hand mounting bracket in the orientation shown. Fit two M5 x 12 mm fixings from the kit. Tighten the fixings to 5 Nm.

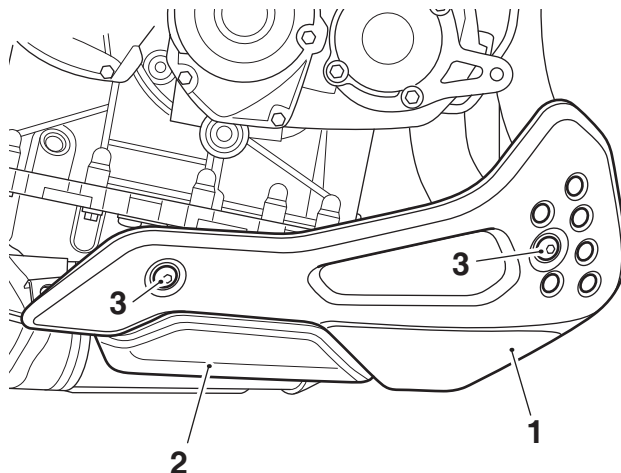

- Bellypan, right hand
- Bellypan cover
- Fixings, M5 x 12 mm

- Position the left hand bellypan from the kit on to the left hand mounting bracket in the orientation shown. Fit two M5 x 12 mm fixings from the kit. Tighten the fixings to 5 Nm.

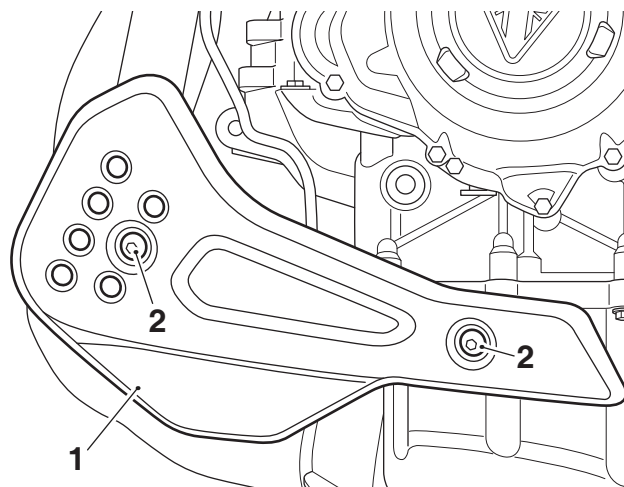

- Bellypan, right hand
- Fixings, M5 x 12 mm

 **Warning**

After fitting the accessory kit the motorcycle will exhibit new handling characteristics. Operate the motorcycle in a safe area free from traffic to gain familiarity with any new characteristics. Operation of the motorcycle when not familiar with any new handling characteristics may result in loss of motorcycle control and an accident.

 **Warning**

If, after fitting this accessory kit, you have any doubt about the performance of any aspect of the motorcycle, contact an authorised Triumph dealer and do not ride the motorcycle until the authorised dealer has declared it fit for use. Riding a motorcycle when there is any doubt as to any aspect of the performance of the motorcycle may result in loss of control of the motorcycle leading to an accident.

 **Warning**

Never ride an accessory-equipped motorcycle at speeds above 80 mph (130 km/h).  
The presence of accessories will cause changes in the stability and handling of the motorcycle. Failure to allow for changes in motorcycle stability may lead to loss of control or an accident.  
Remember that the 80 mph (130 km/h) limit will be reduced by the fitting of non-approved accessories, incorrect loading, worn tyres, overall motorcycle condition and poor road or weather conditions.

 **Warning**

The motorcycle must not be operated above the legal road speed limit except in closed-course conditions.

 **Warning**

Only operate this Triumph motorcycle at high speed in closed-course, on-road competition or on closed-course racetracks. High-speed operation should only be attempted by riders who have been instructed in the techniques necessary for high speed riding and are familiar with the motorcycle's characteristics in all conditions.

High-speed operation in any other circumstances is dangerous and will lead to loss of motorcycle control and an accident.