



Accessory Fitting Instructions

Windshield Kit	
Kit Number	Models Affected
A9700379	Bonneville Speedmaster from VIN 739143 up to VIN AE2305 without instrument embellisher (see below)
A9701470 A9701471	Bonneville Speedmaster from VIN AC1201 with instrument embellisher (see below)

Thank you for choosing this Triumph genuine accessory kit. This accessory kit is the product of Triumph's use of proven engineering, exhaustive testing, and continuous striving for superior reliability, safety and performance.

Completely read all of these instructions before commencing the installation of the accessory kit in order to become thoroughly familiar with the kit's features and the installation process.

These instructions should be considered a permanent part of your accessory kit, and should remain with it even if your accessory equipped motorcycle is subsequently sold.

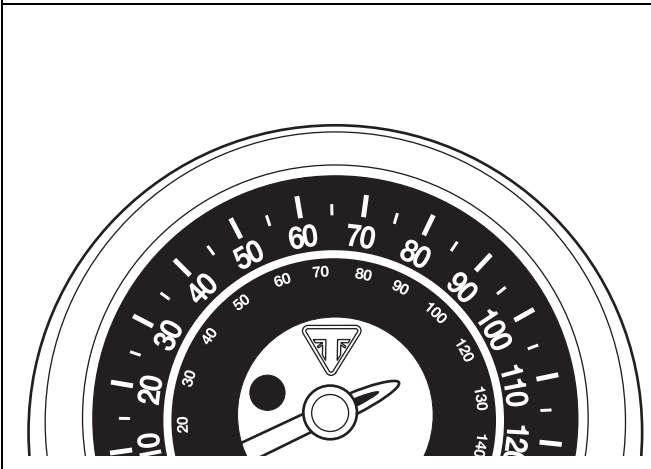
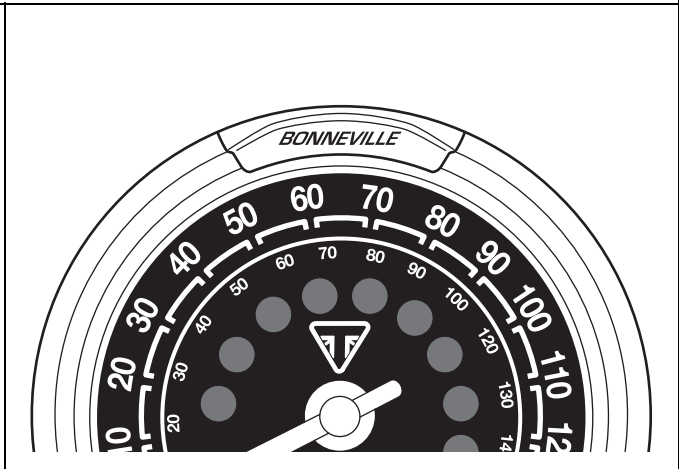
Instrument Identification	
	
Without Embellisher	With Embellisher

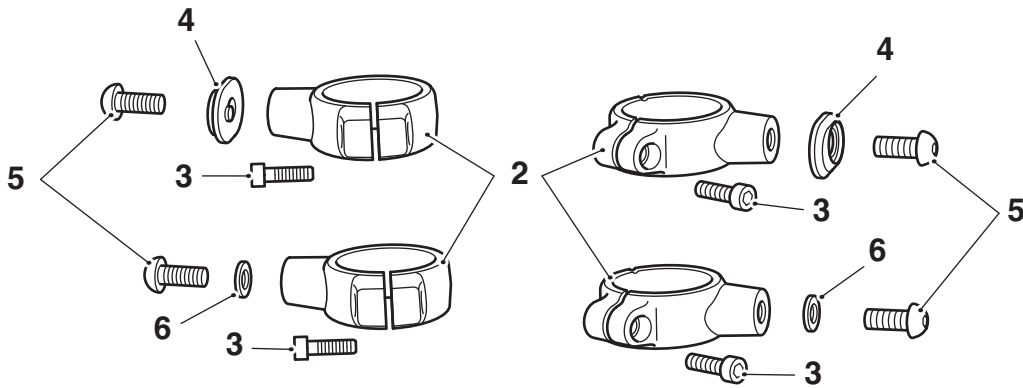
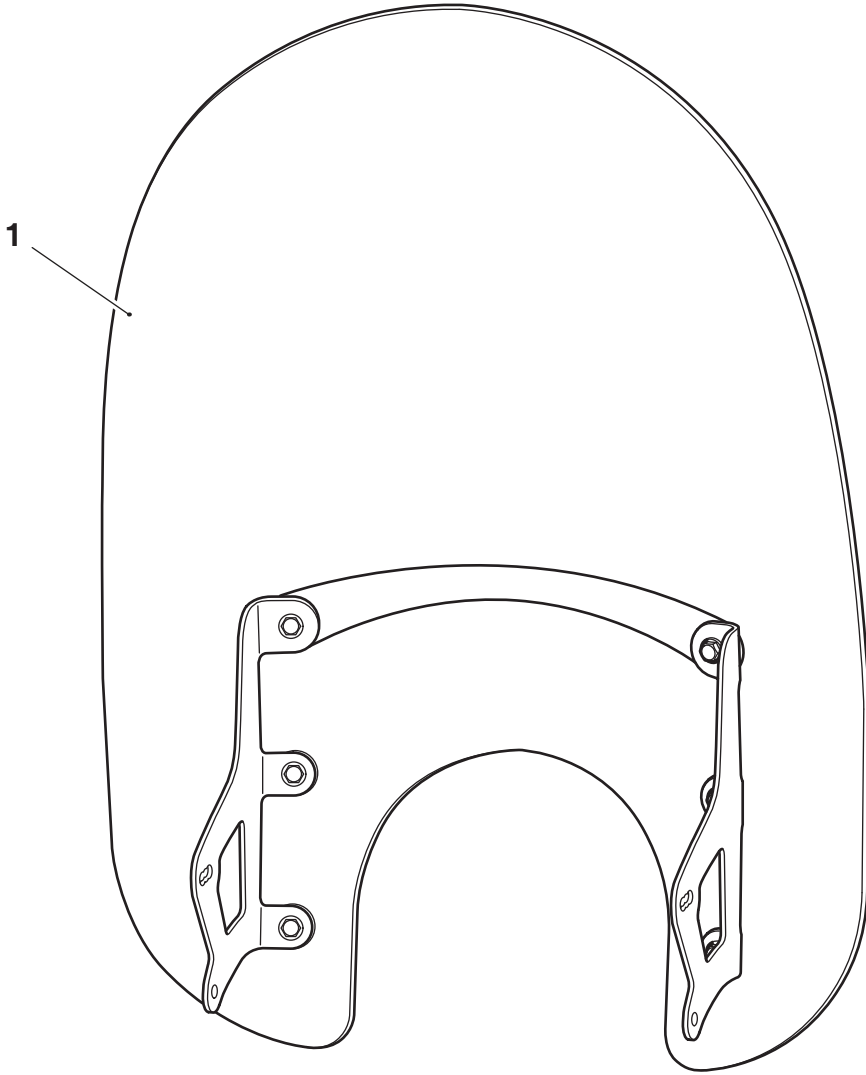

1. Windshield	1 off	4. Finisher cap	2 off
2. Fork clamp	4 off	5. Fixing, M8 x 20 mm	4 off
3. Fixing, M6 x 20 mm	4 off	6. Washer, M8	2 off

Warning

Fit only genuine Triumph accessories to those models approved by Triumph as listed in the associated Triumph fitting instructions. The accessory kits covered in this instruction are designed for use on specific models of Triumph motorcycle. The accessory kits and the models applicable are listed at the start of the instruction. They should never be fitted to any other Triumph model or to any other manufacturer's motorcycle. Fitting an accessory kit to a Triumph model not listed, or to any other manufacturer's motorcycle will affect the performance, stability and handling of the motorcycle. This may affect the rider's ability to control the motorcycle and could result in an accident causing severe injuries or death.

Warning

Always have Triumph approved parts, accessories and conversions fitted by a trained technician of an authorised Triumph dealer. The fitment of parts, accessories and conversions by a technician who is not of an authorised Triumph dealer may affect the handling, stability or other aspects of the motorcycle's operation which may result in loss of motorcycle control and an accident.

Warning

Make sure the motorcycle is supported. A correctly supported motorcycle will help prevent it from falling. An unstable motorcycle may fall, causing injury to the operator or damage to the motorcycle.

Warning

A torque wrench of known accurate calibration must be used when fitting this accessory kit. Failure to tighten any of the fasteners to the correct torque specification may affect motorcycle performance, handling and stability. This may result in loss of motorcycle control and an accident.

Note:

- Triumph offers a broad range of approved genuine accessories for your motorcycle. **We cannot therefore cover all possible equipment variations in these instructions. For removal and installation of Triumph Genuine Accessories, always refer to the instructions supplied with the respective accessory kit. To obtain additional copies of any Triumph accessory instructions, visit www.triumphinstructions.com or contact your authorised Triumph dealer.**

- Disconnect the battery, negative (black) lead first.
- Ensure the headlight is correctly aligned, following the procedure described in the Service Manual.
- Remove the upper yoke as described in the Service Manual. Retain the fixings for reuse.
- Fit two fork clamps provided in the kit onto the left hand and right hand fork legs. Ensure the fork clamp joints are positioned towards the rear of the motorcycle and the screen mounts are orientated outwards, as shown below.

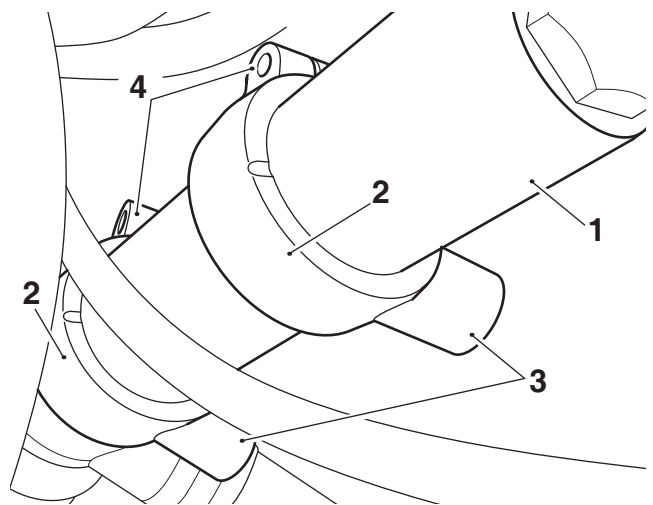

- Fork leg, left hand side shown**
- Fork clamps**
- Screen mounts**
- Clamp joints**

- Refit the upper yoke on to the fork legs and secure with the original fixings, as described in the Service Manual.
- Refit the handlebars, handlebar clamp and fixings, as described in the Service Manual.



Caution

Care must be taken when fitting the new windshield. Damage to the windshield could result from inadequate care during the fitting process.

7. Position the windshield assembly on the motorcycle aligning the bottom windshield mounting bracket fixing positions with the lower fork leg clamps. Fit the M8 x 20 mm fixings and M8 washers from the kit. Do not fully tighten the fixings at this stage.

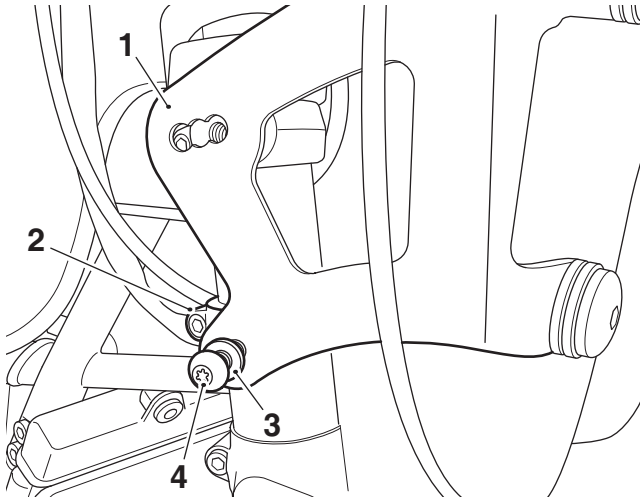

1. Windshield mounting bracket, right hand side shown
2. Lower fork leg clamp
3. Washer, M8
4. Fixing, M8 x 20 mm

8. Align the windshield mounting bracket upper fixing positions with the upper fork leg clamps. Note there are three alignment positions provided in the windshield bracket. Select the appropriate alignment position to suit the preferred windshield angle.

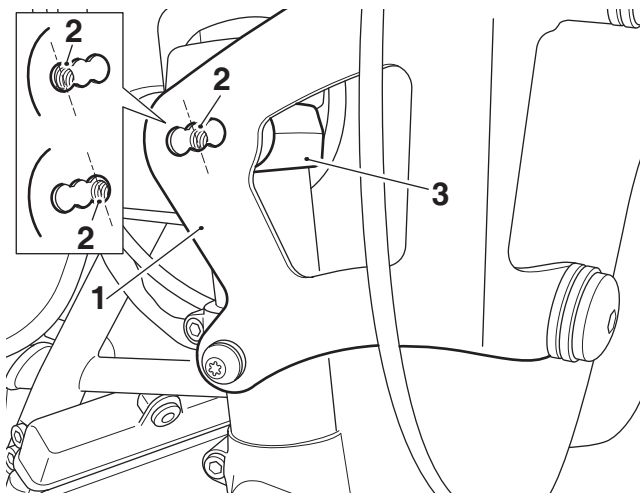

1. Windshield mounting bracket, right hand side shown
2. Alignment positions
3. Upper fork leg clamp

9. Fit the finisher caps and M8 x 20 mm fixings to the windshield mounting bracket upper positions. Note, orientate the finisher caps to ensure the location peg on the rear of the finisher cap fits correctly in one of the unused fixing positions in the windshield mounting bracket. Tighten the fixings to **23 Nm**.

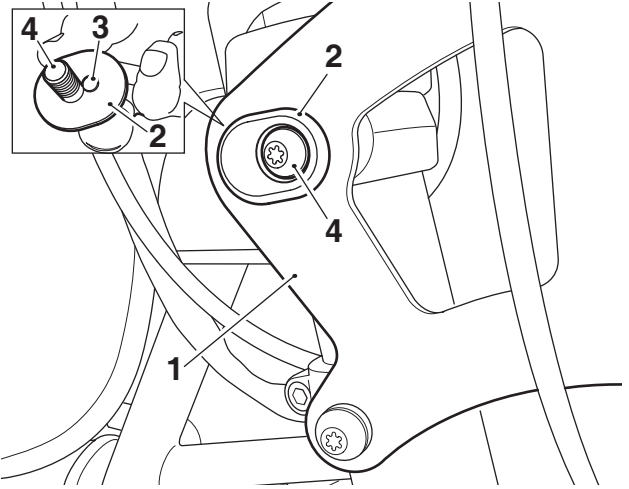

1. Windshield mounting bracket, right hand side shown
2. Finisher cap
3. Location peg
4. Fixing, M8 x 20 mm

10. Tighten the windshield mounting bracket lower fixings to **23 Nm**.
11. Adjust the position of the windshield so it is central on the motorcycle and an even gap of 10 mm around the headlight is achieved. Fit the M6 x 20 mm fork leg clamp fixings from the kit and tighten to **9 Nm**.

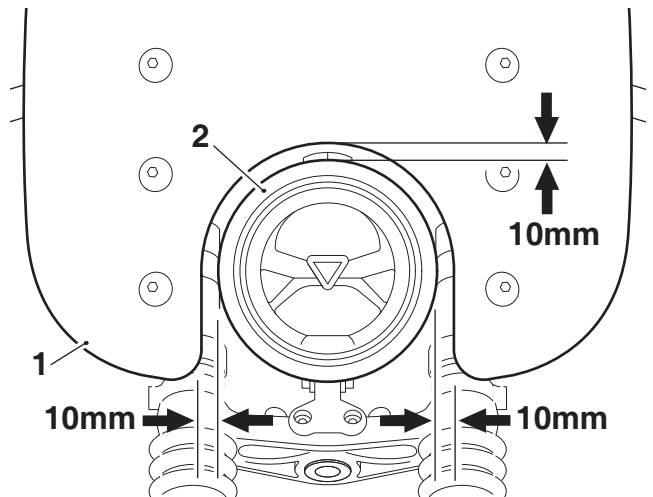

1. Windshield
2. Headlight

12. Reconnect the battery, positive (red) lead first.

 **Caution**

Move the handlebars to left and right full lock while checking that the windshield does not contact the fuel tank, hoses, cables, wiring harnesses or any other part of the motorcycle. Contact may result in damage to the fuel tank, hoses, cables, wiring harnesses or other parts of the motorcycle. Adjust the windshield as required to ensure the windshield does not contact any part of the motorcycle.

 **Warning**

Move the handlebars to left and right full lock while checking that the windshield does not restrict full lock operation or contact any hoses, cables or wiring harnesses. Any component that will restrict the steering may result in loss of motorcycle control and an accident.

 **Warning**

After fitting the windshield the motorcycle will exhibit new handling characteristics. Operate the motorcycle in a safe area free from traffic to gain familiarity with any new characteristics. Operation of the motorcycle when not familiar with any new handling characteristics may result in loss of motorcycle control and an accident.

 **Warning**

Never attempt to clean the windshield while riding the motorcycle. Removal of the rider's hands from the handlebars while riding the motorcycle will diminish the ability of the rider to maintain control of the motorcycle. Attempting to clean the windshield while riding the motorcycle may result in loss of motorcycle control and an accident.

 **Warning**

The windshield is not a substitute for a safety helmet or eye protection. Windshields are designed to provide wind protection and increased riding comfort. They are not designed to provide protection in the event of a collision with another vehicle, the road, birds or any other object. When riding a motorcycle both rider and passenger must always wear a safety helmet, eye protection, gloves and trousers (close fitting around the knees and ankle). Although full protection is not possible, wearing correct protective clothing can reduce the risk of injury when riding.

 **Warning**

If, after fitting this accessory kit, you have any doubt about the performance of any aspect of the motorcycle, contact an authorised Triumph dealer and do not ride the motorcycle until the authorised dealer has declared it fit for use. Riding a motorcycle when there is any doubt as to any aspect of the performance of the motorcycle may result in loss of motorcycle control and an accident.

 **Warning**

Never ride an accessory-equipped motorcycle at speeds above 80 mph (130 km/h).

The presence of accessories will cause changes in the stability and handling of the motorcycle. Failure to allow for changes in motorcycle stability may result in loss of motorcycle control and an accident.

Remember that the 80 mph (130 km/h) limit will be reduced by the fitting of non-approved accessories, incorrect loading, worn tyres, overall motorcycle condition and poor road or weather conditions.

 **Warning**

The motorcycle must not be operated above the legal road speed limit except in closed-course conditions

 **Warning**

Only operate this Triumph motorcycle at high speed in closed-course, on-road competition or on closed-course racetracks. High-speed operation should only be attempted by riders who have been instructed in the techniques necessary for high-speed riding and are familiar with the motorcycle's characteristics in all conditions.

High-speed operation in any other circumstances is dangerous and will lead to loss of motorcycle control and an accident.