

English

Fitting Instructions:

Thunderbird

A9700224

Thank you for choosing this Triumph genuine accessory kit. This accessory kit is the product of Triumph's use of proven engineering, exhaustive testing, and continuous striving for superior reliability, safety and performance.

Completely read all of these instructions before commencing the installation of the accessory kit in order to become thoroughly familiar with the kit's features and the installation process.

These instructions should be considered a permanent part of your accessory kit, and should remain with it even if your accessory equipped motorcycle is subsequently sold.

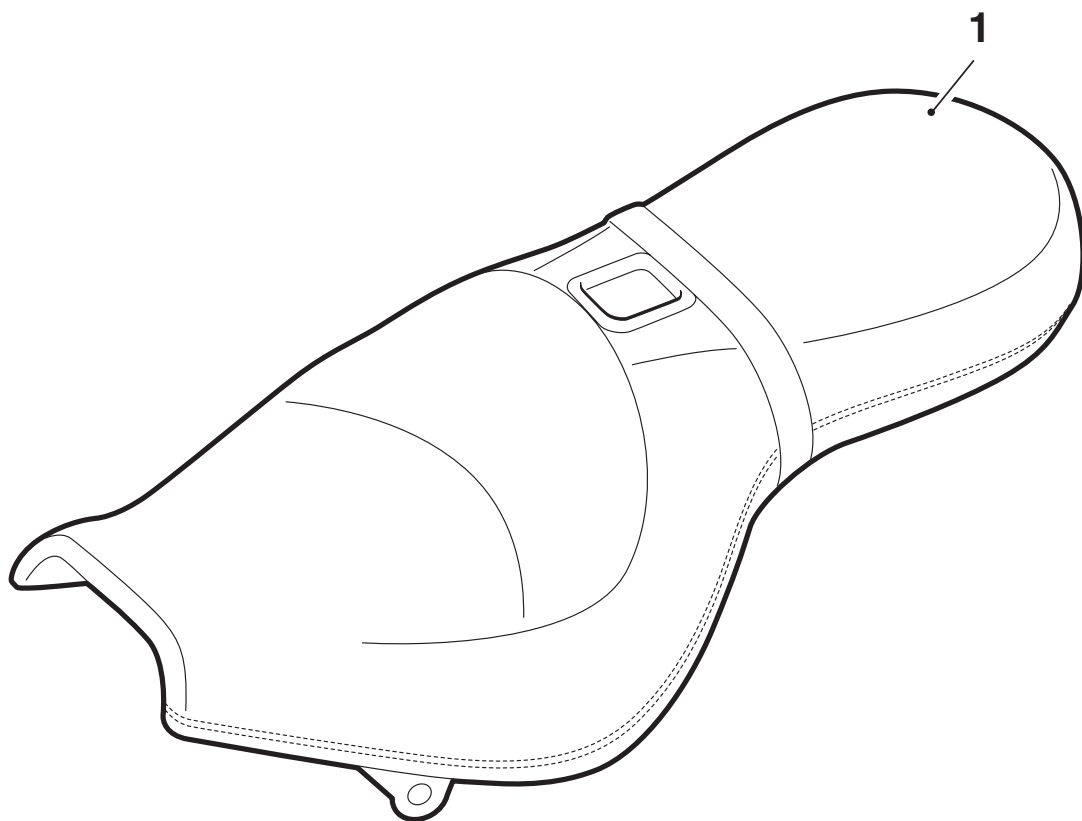

Parts Supplied:

- | | | |
|----|-----------|-------|
| 1. | Dual seat | 1 off |
|----|-----------|-------|

Warning

This accessory kit is designed for use on Triumph Thunderbird motorcycles only and should not be fitted to any other manufacturer's motorcycle. Fitting this accessory kit to any other manufacturer's motorcycle will affect the performance, stability and handling of the motorcycle. This may affect the rider's ability to control the motorcycle and could cause an accident.

Warning

Always have Triumph approved parts, accessories and conversions fitted by a trained technician of an authorised Triumph dealer. The fitment of parts, accessories and conversions by a technician who is not of an authorised Triumph dealer may affect the handling, stability or other aspects of the motorcycle's operation which may result in loss of motorcycle control and an accident.

Warning

Throughout this operation, ensure that the motorcycle is stabilised and adequately supported to prevent risk of injury from the motorcycle falling.

Warning

A torque wrench of known accurate calibration must be used when fitting this accessory kit. Failure to tighten any of the fasteners to the correct torque specification may result in loss of motorcycle control and an accident.

Warning

Fitting of this accessory kit requires removal of the original pillion seat. Ensure the Owner's Handbook is removed from the pillion seat and carried with the motorcycle at all times.

1. Remove both seats as described in the service manual. Retain both seats if the motorcycle is to be returned to its original condition. Retain the fixings for reuse.
2. Remove the pillion seat mounting bracket from the rear fender. Retain the mounting bracket, screws and washers if the motorcycle is to be returned to its original condition.

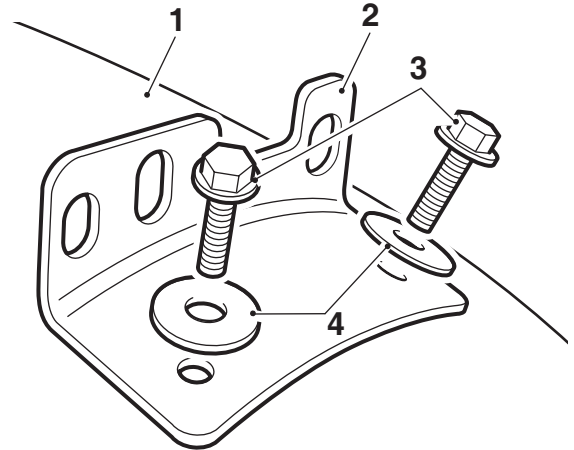

1. Rear fender
2. Mounting bracket, pillion seat
3. Screws
4. Washers

3. Engage the seat's tongue under the fuel tank and align the side fixings with the frame fixing points. Fit the original side fixings, do not fully tighten at this stage.

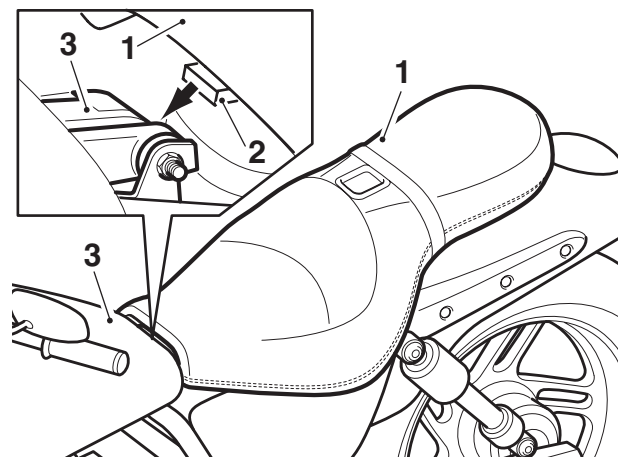

1. Seat
2. Seat tongue
3. Fuel tank

4. Align the seat rear fixing bracket with the original pillion seat rear fixing point on the fender. Fit the original fixing and tighten to **10 Nm**.

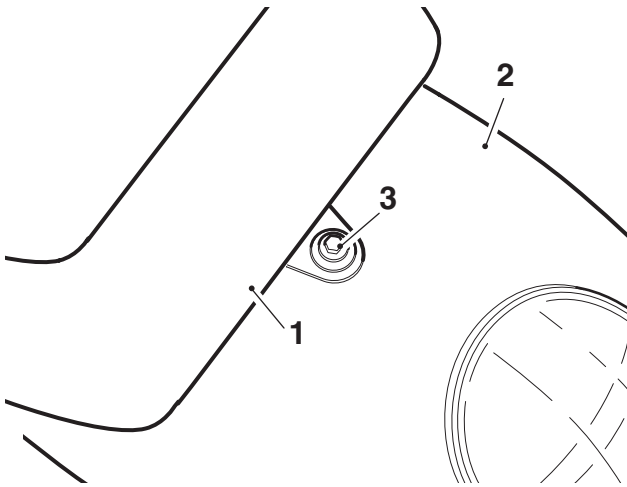

1. Seat
2. Rear fender
3. Fixing

5. Tighten the side fixings to **9 Nm**.

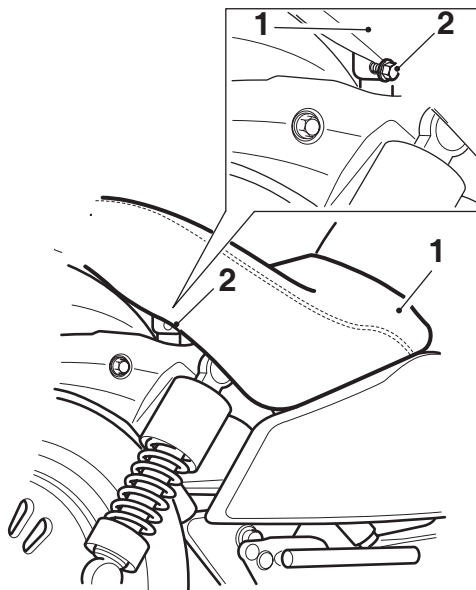

1. Seat
2. Side fixing (right hand shown)

Warning

To prevent detachment of the seat during riding, after fitting always grasp the seat and pull firmly upwards. If the seat is not correctly secured it may detach from the motorcycle. A loose or detached seat could cause loss of motorcycle control and an accident.

Warning

If, after fitment of this accessory kit, you have any doubt about the performance of any aspect of the motorcycle, contact an authorised Triumph dealer and do not ride the motorcycle until the authorised dealer has declared it fit for use. Riding a motorcycle when there is any doubt as to any aspect of the performance of the motorcycle may result in loss of control of the motorcycle leading to an accident.

Warning

Never ride an accessory equipped motorcycle at speeds above 80 mph (130 km/h).

The presence of accessories will cause changes in the stability and handling of the motorcycle. Failure to allow for changes in motorcycle stability may lead to loss of control or an accident.

Remember that the 80 mph (130 km/h) limit will be reduced by the fitting of non-approved accessories, incorrect loading, worn tyres, overall motorcycle condition and poor road or weather conditions.

Warning

The motorcycle must not be operated above the legal road speed limit except in closed-course conditions.

Warning

Only operate this Triumph motorcycle at high speed in closed-course on road competition or on closed-course racetracks. High speed operation should only be attempted by riders who have been instructed in the techniques necessary for high speed riding and are familiar with the motorcycle's characteristics in all conditions.

High speed operation in any other circumstances is dangerous and will lead to loss of motorcycle control and an accident.