



Accessory Fitting Instructions

Fox RSU	
Kit number	Models Affected
A9648048	Bonneville Bobber, Bonneville Bobber Black

Thank you for choosing this Triumph genuine accessory kit. This accessory kit is the product of Triumph's use of proven engineering, exhaustive testing, and continuous striving for superior reliability, safety and performance.

Completely read all of these instructions before commencing the installation of the accessory kit in order to become thoroughly familiar with the kit's features and the installation process.

These instructions should be considered a permanent part of your accessory kit, and should remain with it even if your accessory equipped motorcycle is subsequently sold.

Parts supplied

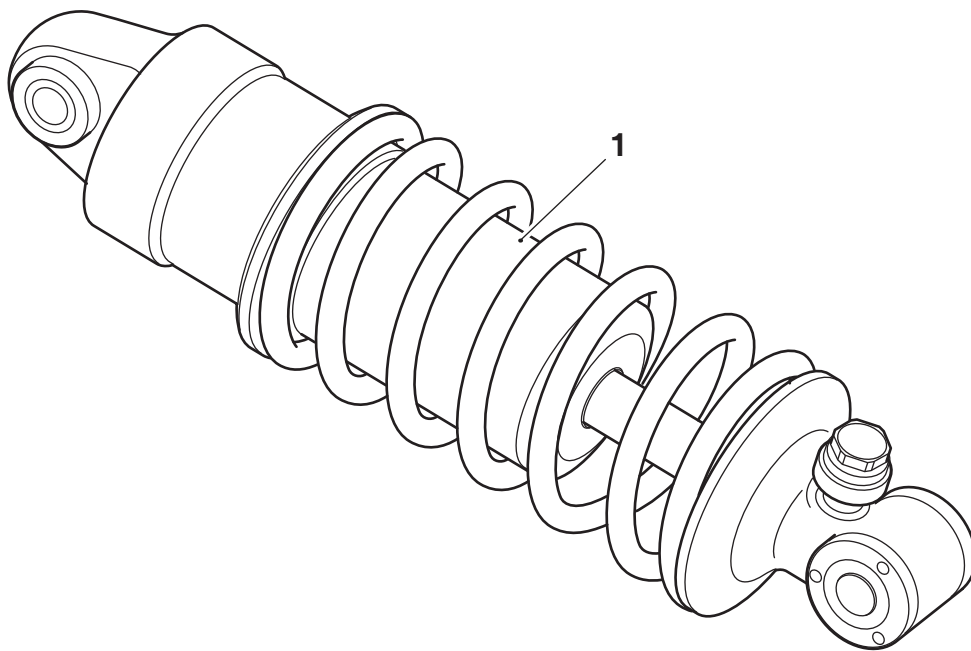

1. Rear suspension unit	1 off	
-------------------------	-------	--

Warning

The accessory kits covered in this instruction are designed for use on specific models of Triumph motorcycle. The accessory kits and the models applicable are listed at the start of the instruction. They should not be fitted to any other Triumph model or to any other manufacturer's motorcycle. Fitting an accessory kit to a Triumph model not listed, or to any other manufacturer's motorcycle will affect the performance, stability and handling of the motorcycle. This may result in loss of motorcycle control and an accident.

Warning

Always have Triumph approved parts, accessories and conversions fitted by a trained technician of an authorised Triumph dealer. The fitment of parts, accessories and conversions by a technician who is not of an authorised Triumph dealer may affect the handling, stability or other aspects of the motorcycle's operation which may result in loss of motorcycle control and an accident.

Warning

Throughout this operation, ensure that the motorcycle is stabilised and adequately supported to prevent risk of injury from the motorcycle falling.

Warning

A torque wrench of known accurate calibration must be used when fitting this accessory kit. Failure to tighten any of the fasteners to the correct torque specification may affect motorcycle performance, handling and stability. This may result in loss of motorcycle control and an accident.

Note:

- **Triumph offers a broad range of approved genuine accessories for your motorcycle. We cannot therefore cover all possible equipment variations in these instructions. For removal and installation of Triumph Genuine Accessories, always refer to the instructions supplied with the respective accessory kit. To obtain additional copies of any Triumph accessory instructions, visit www.triumphinstructions.com or contact your authorised Triumph dealer.**

Rear Suspension Installation

1. Remove the rear suspension unit, as described in the Service Manual. Retain the suspension unit for reuse if the motorcycle is to be returned to its original condition. Retain the fixings for reuse.
2. Collect the rear suspension unit from the kit.

Note:

- **When fitting the accessory rear suspension unit the damping adjuster must be positioned towards the rear of the motorcycle and visible from the top of the suspension unit.**
 - **Lock nuts can be re-used providing resistance can be felt when the locking portion passes over the thread of the bolt or stud. Always use the correct replacement lock nut as recommended in the Triumph parts catalogue.**
3. Using the original fixings fit the rear suspension unit as described in the Service Manual. Ensure the damping adjuster is positioned towards the rear of the motorcycle and visible from the top of the suspension unit, as shown.

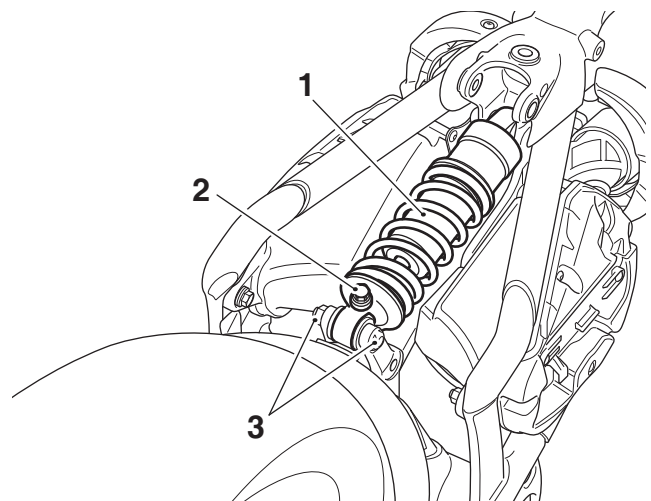

Seat removed for clarity

1. Rear suspension unit
2. Damping adjuster
3. Fixings (rear shown)

Suspension Setting

Note:

- The accessory suspension unit has rebound damping adjustment.
- The details given in the table below are only a guide. Setting requirements may vary for a riders weight and personal preferences.

The standard rear suspension setting provides a comfortable ride and good handling characteristics for general riding. The following table shows suggested settings for rear suspension under different conditions.

Damping	
Preference	Rear Rebound Damping ¹
Standard	9
Comfort (softer)	20
Sport (firmer)	1

¹ Number of clicks anticlockwise from the fully clockwise position noting that the first stop (click) is counted as 1.

Rear Suspension Rebound Damping Adjustment

Note:

- The setting is measured as the number of adjuster clicks anticlockwise from the fully clockwise position.
- The accessory suspension units are supplied with the rebound damping adjuster set at the Standard Solo Riding settings, as shown in the damping suspension table.

1. To change the rebound damping setting, rotate the adjuster clockwise to increase, or anticlockwise to decrease.

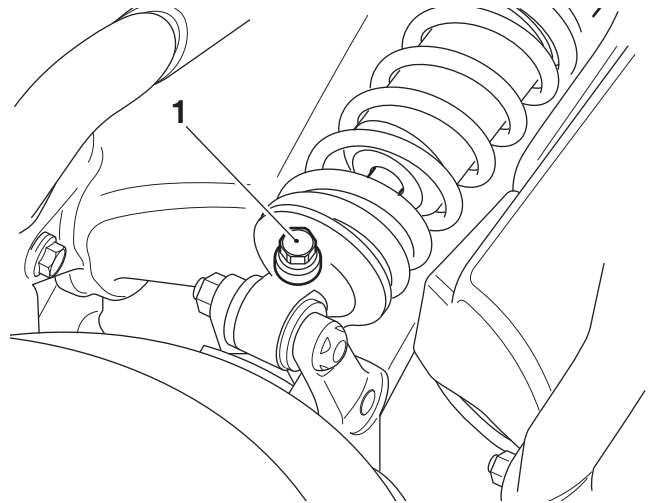

1. Rear suspension damping adjuster

Servicing



Warning

Contents under pressure.

Never attempt to open this rear suspension unit. Never attempt to service this rear suspension unit.

Never incinerate, puncture, or disassemble this rear suspension unit.

Opening this rear suspension unit may result in severe injuries or even death.

For service, return this rear suspension unit to an authorised FOX service centre.



The rear suspension unit is a sealed unit and does not have any internally user serviceable parts.



Warning

If, after fitting this accessory kit, you have any doubt about the performance of any aspect of the motorcycle, contact an authorised Triumph dealer and do not ride the motorcycle until the authorised dealer has declared it fit for use. Riding a motorcycle when there is any doubt as to any aspect of the performance of the motorcycle may result in loss of motorcycle control and an accident.



Warning

Never ride an accessory-equipped motorcycle at speeds above 80 mph (130 km/h).

The presence of accessories will cause changes in the stability and handling of the motorcycle. Failure to allow for changes in motorcycle stability may result in loss of motorcycle control and an accident.

Remember that the 80 mph (130 km/h) limit will be reduced by the fitting of non-approved accessories, incorrect loading, worn tyres, overall motorcycle condition and poor road or weather conditions.



Warning

The motorcycle must not be operated above the legal road speed limit except in closed-course conditions.



Warning

Only operate this Triumph motorcycle at high speed in closed-course, on-road competition or on closed-course racetracks. High-speed operation should only be attempted by riders who have been instructed in the techniques necessary for high speed riding and are familiar with the motorcycle's characteristics in all conditions.

High-speed operation in any other circumstances is dangerous and may lead to loss of motorcycle control and an accident.