



Accessory Fitting Instructions

Thank you for choosing this Triumph genuine accessory kit. This accessory kit is the product of Triumph's use of proven engineering, exhaustive testing, and continuous striving for superior reliability, safety and performance.

Completely read all of these instructions before commencing the installation of the accessory kit in order to become thoroughly familiar with the kit's features and the installation process.

These instructions should be considered a permanent part of your accessory kit, and should remain with it even if your accessory equipped motorcycle is subsequently sold.

Handlebar Kits	
Kit Number	Models
Roadster Handlebar	
A9638216	Rocket 3 GT, Rocket 3 GT Triple Black, Rocket 3 GT Storm
Fitting Kit - Roadster Handlebar	
A9638202	Rocket 3 GT, Rocket 3 GT Triple Black, Rocket 3 GT Storm
Kit A9638216 must only be fitted using kit A9638202.	
Touring Handlebar	
A9638217	Rocket 3 R, Rocket 3 R Black, Rocket 3 R Storm
Fitting Kit - Touring Handlebar	
A9638203	Rocket 3 R, Rocket 3 R Black, Rocket 3 R Storm
Kit A9638217 must only be fitted using kit A9638203.	

Parts supplied

A9638216

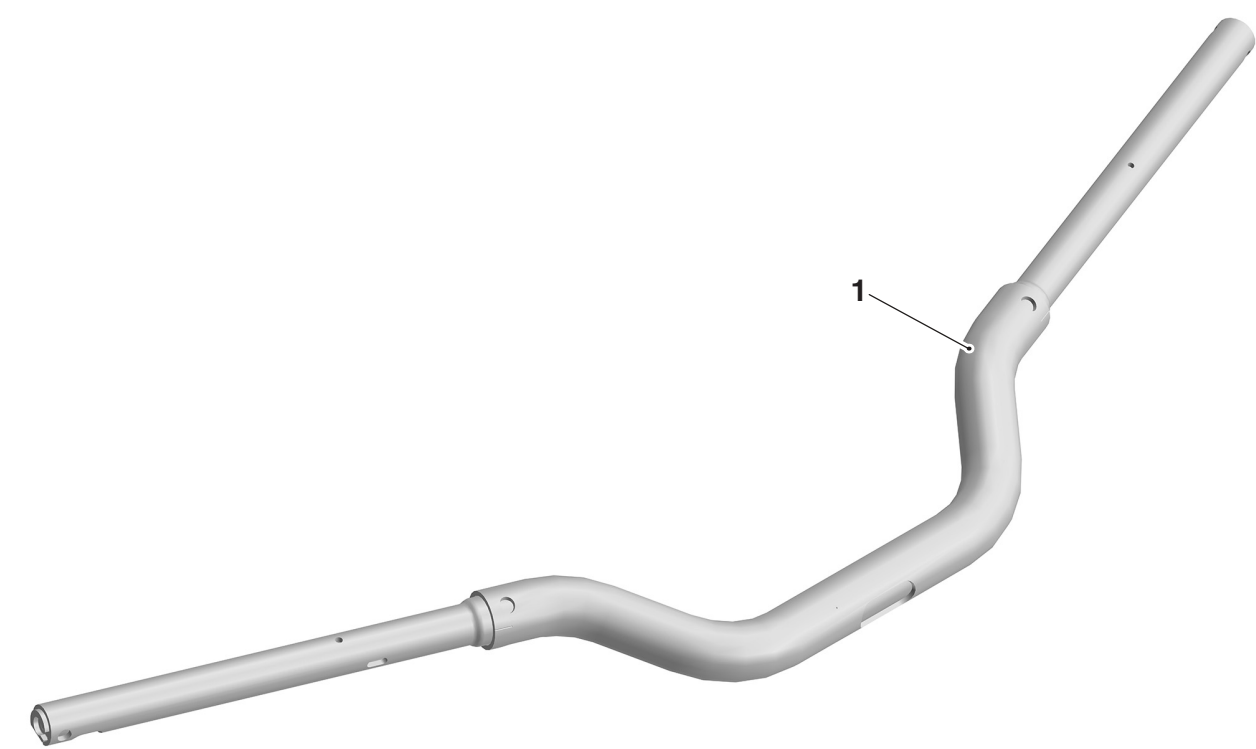

1. Handlebar	1 off
--------------	-------

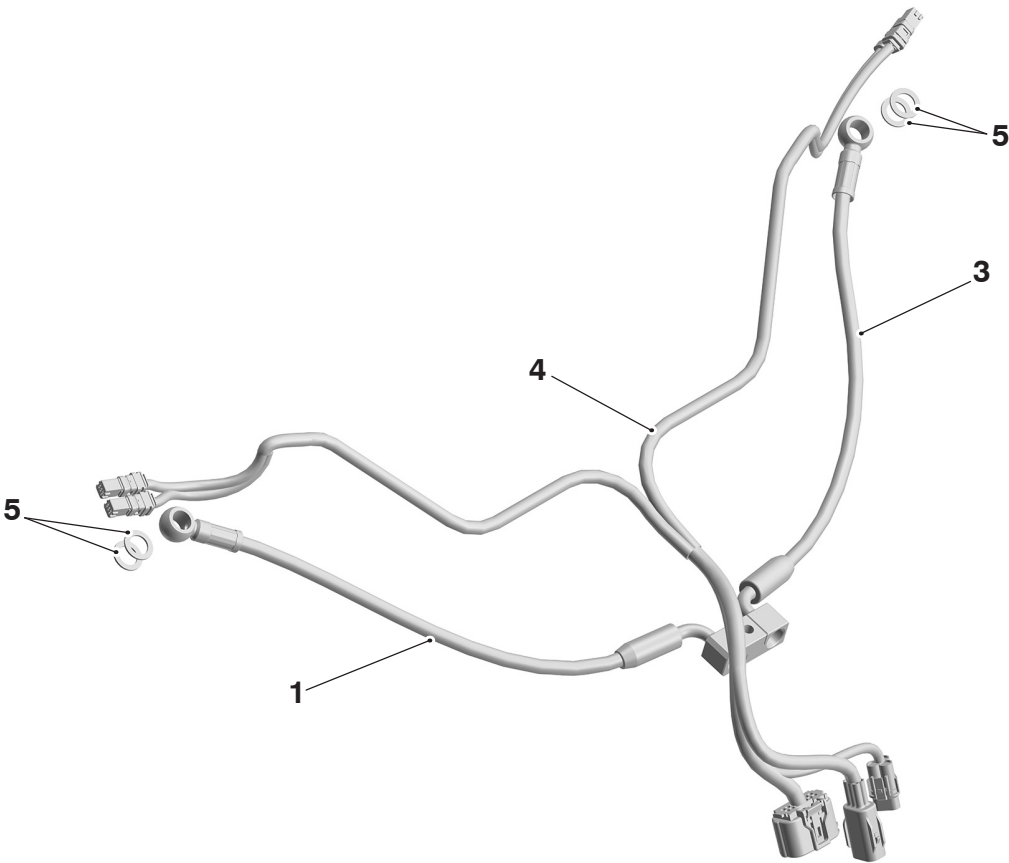

1. Brake line, upper section	1 off	4. Handlebar sub-harness	1 off
2. Brake line, lower section - not included in all kits (not shown)	1 off	5. Sealing washer	4 off
3. Clutch line	1 off		

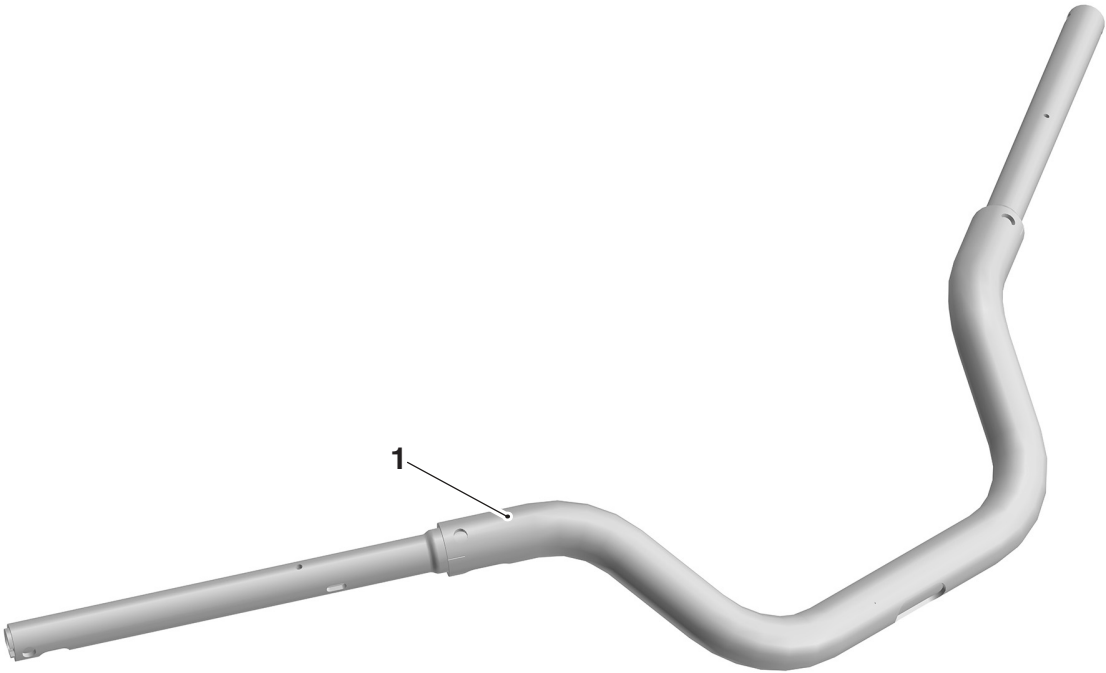

1. Handlebar	1 off
--------------	-------

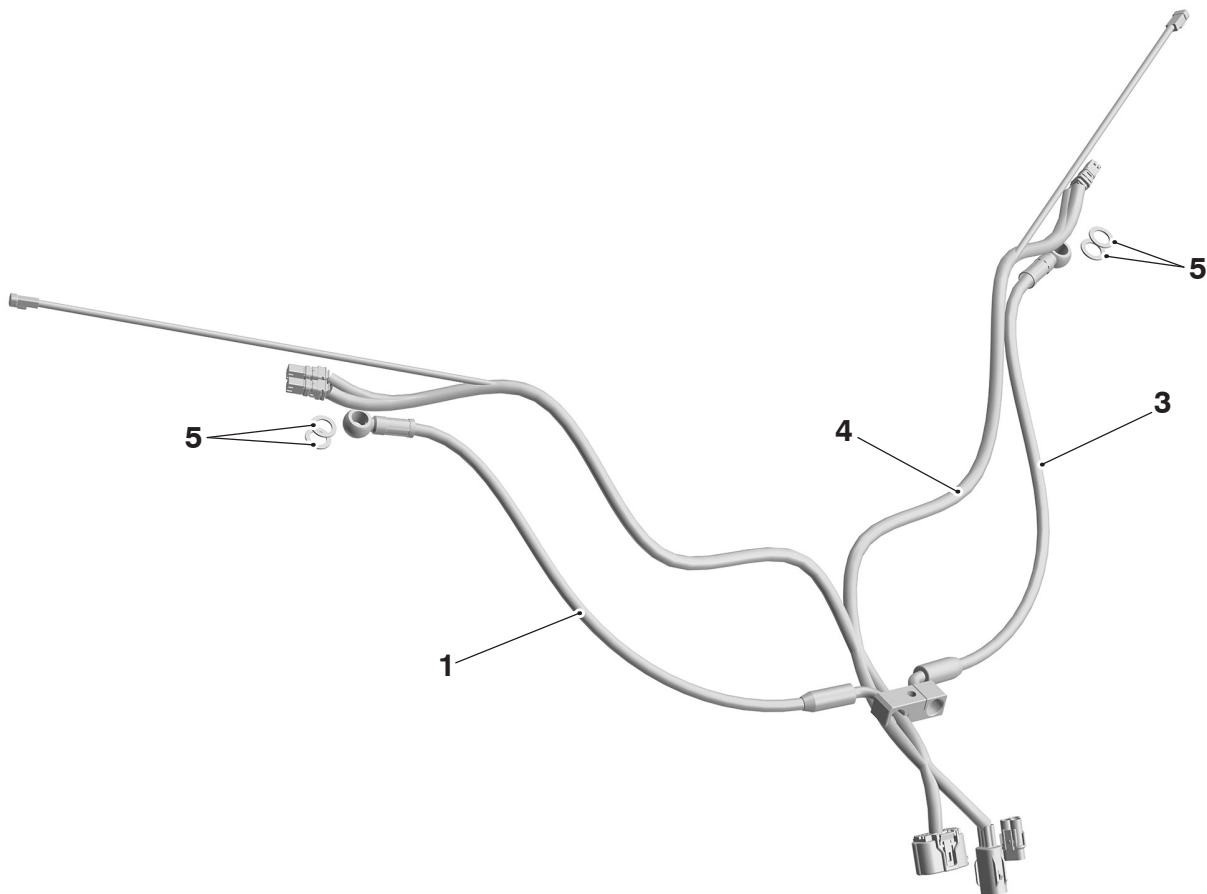

1. Brake line, upper section	1 off	4. Handlebar sub-harness	1 off
2. Brake line, lower section - not included in all kits (not shown)	1 off	5. Sealing washer	4 off
3. Clutch line	1 off		

⚠ WARNING

Fit only genuine Triumph accessories to those models approved by Triumph as listed in the associated Triumph fitting instructions.

The accessory kits covered in this instruction are designed for use on specific models of Triumph motorcycle. The accessory kits and the models applicable are listed at the start of the instruction. They should never be fitted to any other Triumph model or to any other manufacturer's motorcycle.

Fitting an accessory kit to a Triumph model not listed, or to any other manufacturer's motorcycle, will affect the performance, stability and handling of the motorcycle.

Failure to follow the advice above may lead to loss of motorcycle control which could result in serious injury or death.

⚠ WARNING

Always have Triumph approved parts, accessories and conversions fitted by a competent person with the specialist knowledge and technical understanding of motorcycles, such as an authorised Triumph dealer.

The fitment of parts, accessories and conversions by a person without the specialist knowledge and technical understanding of motorcycles may affect the handling, stability or other aspects of the motorcycle's operation.

Failure to follow the advice above may lead to loss of motorcycle control which could result in serious injury or death.

⚠ WARNING

A torque wrench of known accurate calibration must be used when fitting this accessory kit.

Failure to tighten any of the fasteners to the correct torque specification may affect motorcycle performance, handling and stability.

Failure to follow the advice above may lead to loss of motorcycle control which could result in serious injury or death.

⚠ WARNING

Make sure the motorcycle is stabilised and adequately supported.

Do not support the motorcycle on any ancillary component, the exhaust system or any other non structural parts of the motorcycle frame.

A correctly supported motorcycle will help prevent it from falling.

An unstable motorcycle may fall resulting in motorcycle damage, serious injury or death.

NOTICE

Triumph offers a broad range of approved genuine accessories for your motorcycle.

We cannot therefore cover all possible equipment variations in these instructions. For removal and installation of Triumph Genuine Accessories, always refer to the instructions supplied with the respective accessory kit.

To obtain additional copies of any Triumph accessory instructions, visit www.triumphinstructions.com or contact your authorised Triumph dealer.

Removal of Handlebar

1. Remove the seats as described in the Service Manual.
2. Disconnect the battery, as described in the Service Manual.

NOTICE

When removing the instrument panel make sure it is supported correctly and not allowed to hang from the wiring harness.

Allowing the instrument panel to hang from the wiring harness unsupported could result in the wiring harness or wiring harness connection to be compromised which could lead to electrical malfunctions.

NOTICE

Do not press directly onto the instrument panel display screen.

Pressing directly on the instrument panel display screen may damage the instrument panel.

3. While supporting the instrument panel remove the two fixings securing the instrument panel to the instrument panel mounting. Retain the fixings for reuse.

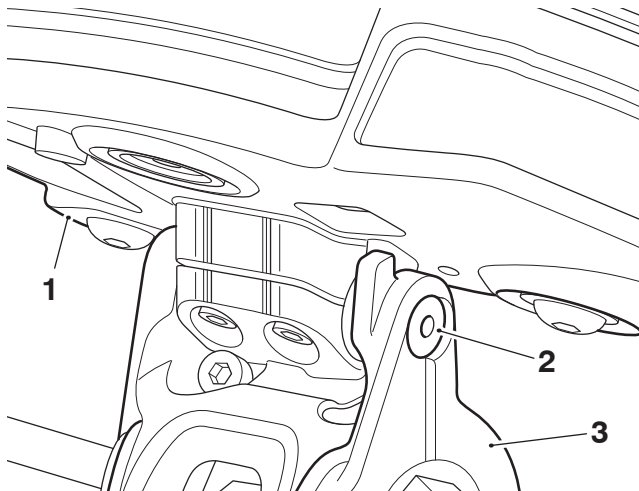

1. Instrument panel
2. Fixings, right hand side shown
3. Instrument panel mounting

4. Remove the wiring harness connector cover from the instrument panel. Retain harness connector cover and fixing for reuse. Unhook the wiring harness from the wire harness guide.

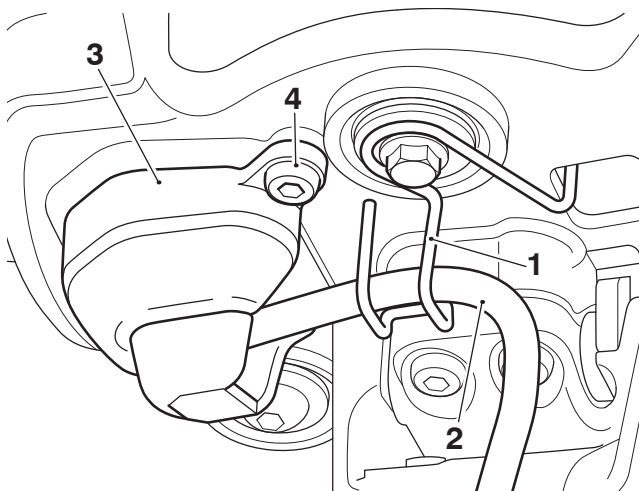

1. Wire harness guide
2. Wiring harness
3. Harness connector cover
4. Fixing

5. Disconnect the electrical connector from the instrument panel. Place the instrument panel, with the display screen facing upwards, on a clean, flat surface which is covered with a soft cloth.

6. Remove the riser cover panel as described in the Service Manual.
7. Remove the two rear fixings from the instrument panel riser. Retain the fixings for reuse.

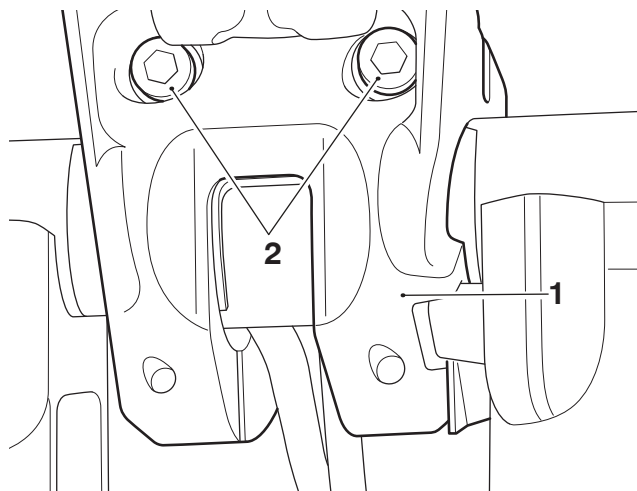

1. Instrument panel riser
2. Fixings

8. Remove the two fixings securing the front clamp of the instrument panel mounting. Remove the front clamp and instrument panel riser. Retain the front clamp, instrument panel riser, fixings and instrument riser bushes for reuse.

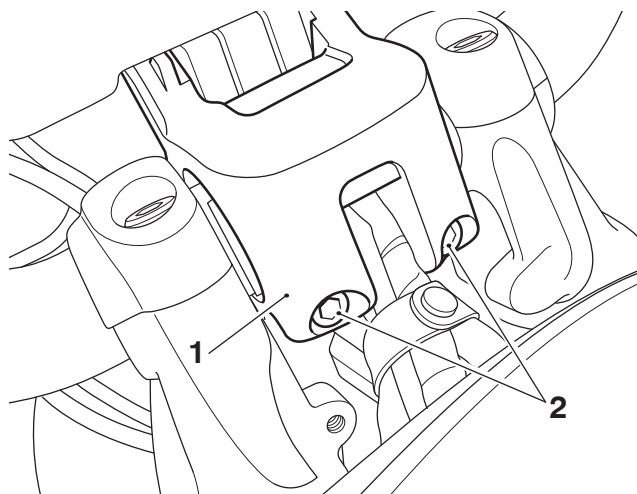

1. Instrument panel mounting, front clamp
2. Fixings

9. Remove the flyscreen and finishers, as described in the Service Manual.

10. Disconnect the handlebar sub-harness connectors from the main wiring harness.

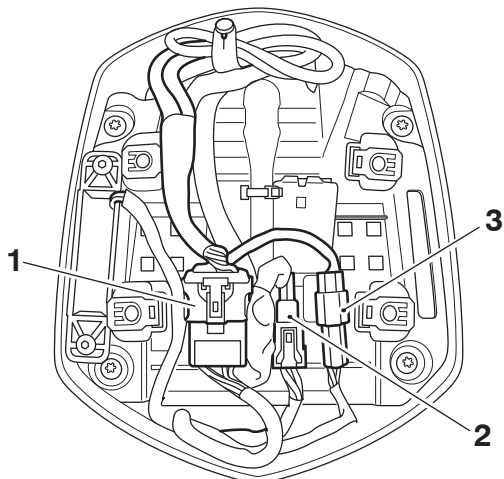

- 1. Sub-harness 1
- 2. Twist grip position sensor connection
- 3. Sub-harness 2

11. Remove the rubber strap retaining the subharness to the main wiring harness. Retain the rubber strap for reuse.

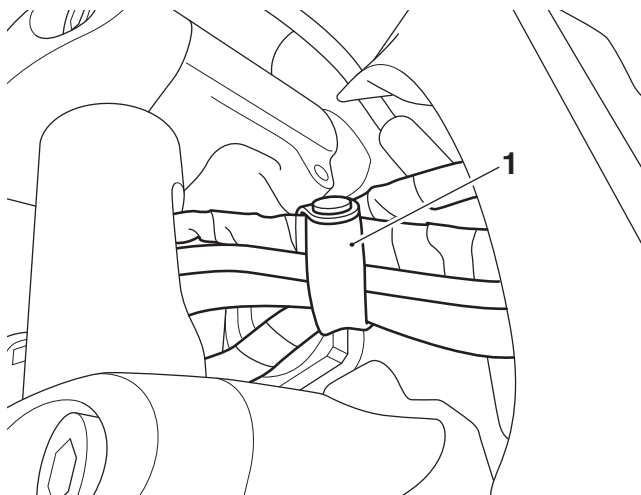

- 1. Rubber strap

12. Remove the handlebar sub-harness, noting its routing, as described in the Service Manual.

NOTICE

To prevent paint damage, do not spill brake fluid onto any area of the bodywork.

Spilled brake fluid will damage paintwork.

- 13. Drain the brake fluid from the front master cylinder and clutch master cylinder, as described in the Service Manual.
- 14. Remove the flyscreen mounting fixings, as described in the Service Manual. Retain the fixings for reuse
- 15. Remove the front brake master cylinder line noting its routing, as described in the Service Manual. Retain the union bolt for reuse. Retain the brake line for reuse if the motorcycle is to be returned to its original condition. Discard the sealing washers.
- 16. Remove the clutch master cylinder line, as described in the Service Manual. Retain the union bolt for reuse. Retain the clutch line for reuse if the motorcycle is to be returned to its original condition. Discard the sealing washers.

17. Remove the following components from the handlebars, as described in the Service Manual. Make sure all parts are suitably supported and do not damage the motorcycle:
 - ▼ Clutch lever, master cylinder.
 - ▼ Brake lever, master cylinder.
 - ▼ Left hand and right hand switch housings.
 - ▼ Left hand and right hand handlebar grips.
 - ▼ Twist grip position sensor.
 - ▼ Mirrors.
18. Remove the handlebar clamp fixings and handlebar clamps from the risers. Remove the handlebars. Retain the handlebar clamps and fixings for reuse. Retain the handlebars for reuse if the motorcycle is to be returned to its original condition.

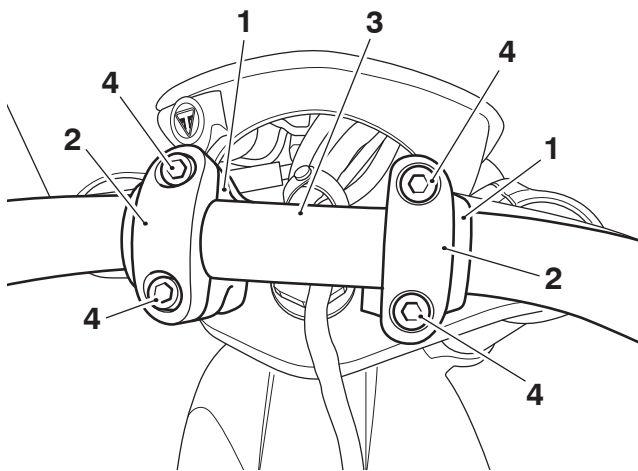

1. Risers
2. Handlebar clamps
3. Handlebar
4. Fixings

Installation of Accessory Handlebars

19. Fit the twist grip position sensor on to the accessory handlebars, as described in the Service Manual.

NOTICE

A wiring harness which becomes trapped or kinked during installation, or motorcycle operation, may result in wiring harness damage and electrical malfunctions.

20. Route the accessory sub-harness back to the handlebars following the routing of the original sub-harness, as noted on removal.
21. Fit the following components to the accessory handlebars as described in the Service Manual:
 - ▼ Left hand and right hand switch housings.
 - ▼ Clutch lever, master cylinder.
 - ▼ Brake lever, master cylinder.
 - ▼ Left hand and right hand handlebar grips.
 - ▼ Mirrors.

22. Position the handlebar assembly centrally on to the risers. Fit the handlebar clamps on to the risers and secure with the original fixings. Do not fully tighten the fixings at this stage.
23. Align the mark on the handlebar centre section with the front split line of the right hand riser and clamp, as shown. First tighten the front handlebar clamp fixings to 26 Nm, then tighten the rear fixings to 26 Nm.

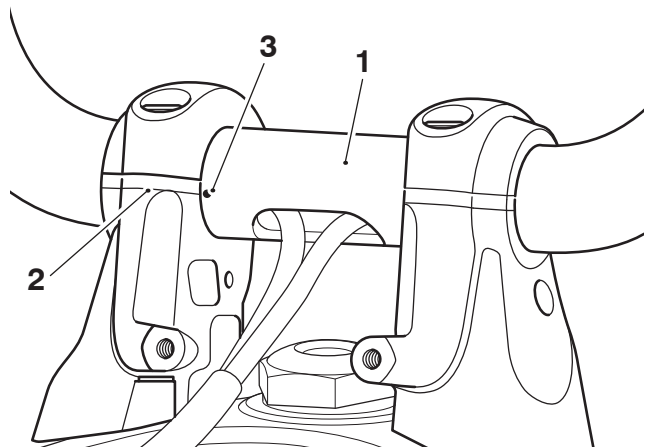

1. Handlebar
2. Split line, handlebar clamp and riser
3. Alignment mark

24. Collect the front brake line from the kit.

NOTICE

If the front brake line in the kit includes both upper and lower sections, the upper section must be removed using a 10 mm spanner and the lower section discarded.

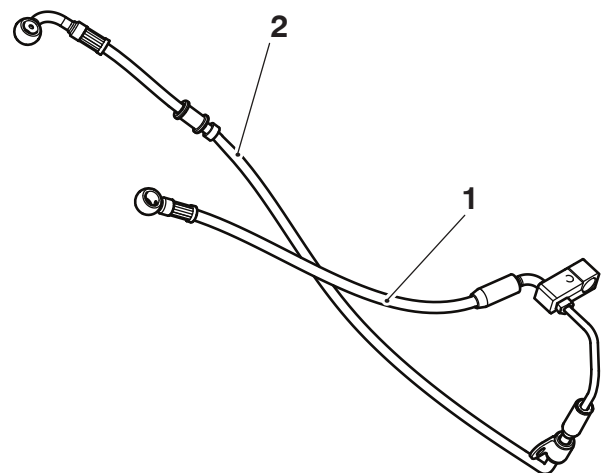

1. Front brake line, upper section
2. Front brake line, lower section

NOTICE

The method of fitting the accessory front brake line and clutch line is the same as that for the original parts.

25. Fit the new front brake master cylinder line, as noted for removal, with the sealing washers provided in the kit and original union bolt.

⚠ WARNING

Ensure absolute cleanliness when adding brake fluid to the brake fluid reservoir.

Do not allow moisture or debris to enter the cylinder as this will adversely affect the brake fluid properties.

Do not use brake fluid from a container which has been opened for any period of time. Always use brake fluid from a sealed container.

Always check for fluid leakage around hydraulic fittings and for damage to hoses.

Failure to follow the advice above may lead to loss of motorcycle control which could result in serious injury or death.

⚠ WARNING

Brake fluid is hygroscopic which means it will absorb moisture from the air.

Any absorbed moisture will greatly reduce the boiling point of the brake fluid causing a reduction in braking efficiency.

Because of this, always replace brake fluid in accordance with scheduled maintenance requirements.

Always use new brake fluid from a sealed container and never use fluid from an unsealed container or from one which has been previously opened.

Do not mix different brands or grades of brake fluid.

Check for fluid leakage around brake fittings, seals and joints and also check the brake hoses for splits, deterioration and damage.

Always rectify any faults before riding.

Failure to follow the advice above may lead to loss of motorcycle control which could result in serious injury or death.

26. Fill the brake fluid reservoir with new DOT 4 brake fluid and bleed the front brakes, as described in the Service Manual.
27. To inspect the brake fluid level, check the level of fluid visible in the window on the brake fluid reservoir.

⚠ WARNING

It is dangerous to operate the motorcycle with defective brakes.

The fault must be checked and rectified by a competent person with the specialist knowledge and technical understanding of motorcycles, such as an authorised Triumph dealer.

Failure to follow the advice above may lead to loss of motorcycle control which could result in serious injury or death..

28. Fit the new clutch line, as noted for removal, with the sealing washers provided in the kit and original union bolt.
29. Fill the clutch master cylinder fluid reservoir with new DOT 4 brake fluid and bleed the clutch system, as described in the Service Manual.
30. To inspect the brake fluid level, check the level of fluid visible in the window on the brake fluid reservoir.
31. Refit the flyscreen mounting with the original fixings, as described in the Service Manual.
32. Connect the accessory sub-harness to the main wiring harness connections on the flyscreen mounting, as shown.

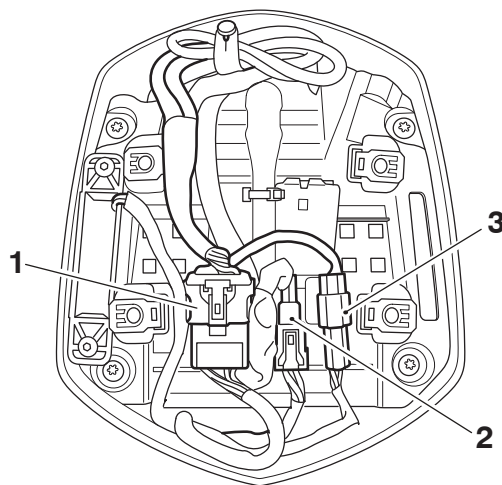

1. Sub-harness 1

2. Twist grip position sensor connection

3. Sub-harness 2

33. Connect the sub-harness connections to the handlebar switch housings as described in the Service Manual.

NOTICE

When refitting the instrument panel riser and front clamp make sure the instrument riser and front clamp bushes are located correctly. Handlebar risers and clamps not shown for clarity.

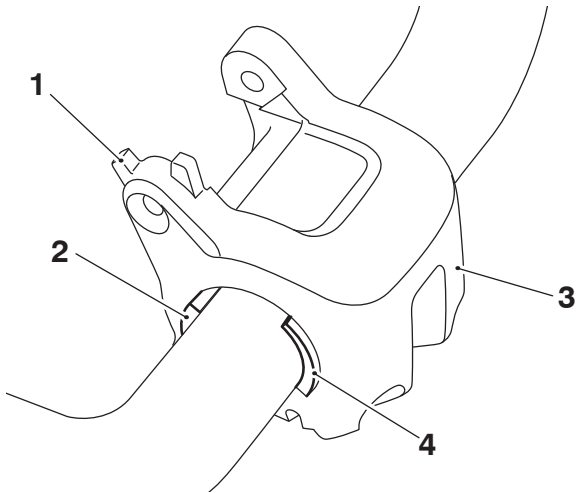

- 1. Instrument panel riser
- 2. Instrument panel riser bush
- 3. Front clamp
- 4. Front clamp bush

34. Refit the instrument panel riser and front clamp with the original fixings. Note the shorter fixings are fitted to the upper instrument panel riser fixing and the longer fixings to the lower instrument panel mounting front clamp. Tighten the shorter fixings first to 9 Nm, then tighten the longer fixings to 9 Nm.

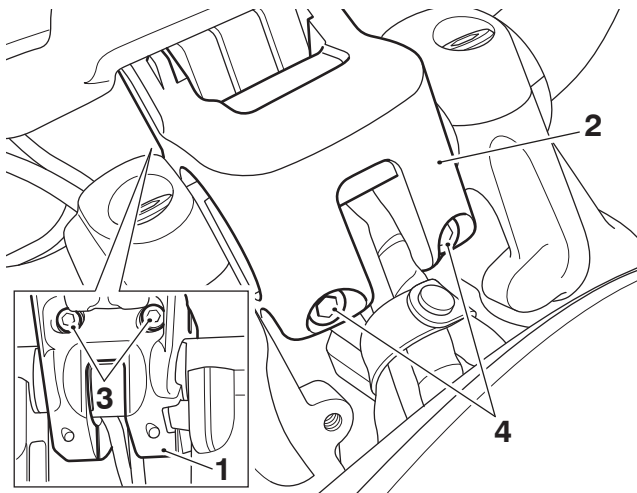

- 1. Instrument panel riser
- 2. Instrument panel mounting, front clamp
- 3. Fixings, shorter
- 4. Fixings, longer

- 35. Reconnect the electrical connector to the instrument panel.
- 36. Refit the wiring harness connector cover to the instrument panel with the original fixing. Tighten the fixing to 3 Nm. Fit the wiring harness into the wire guard, as shown.

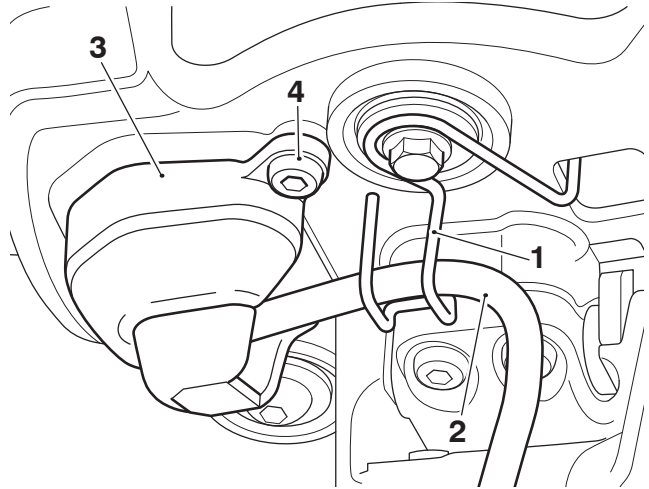

- 1. Wire harness guide
- 2. Wiring harness
- 3. Harness connector cover
- 4. Fixing

37. Refit the instrument panel to the instrument panel mounting with the original fixings. Tighten the fixings to 5.5 Nm.

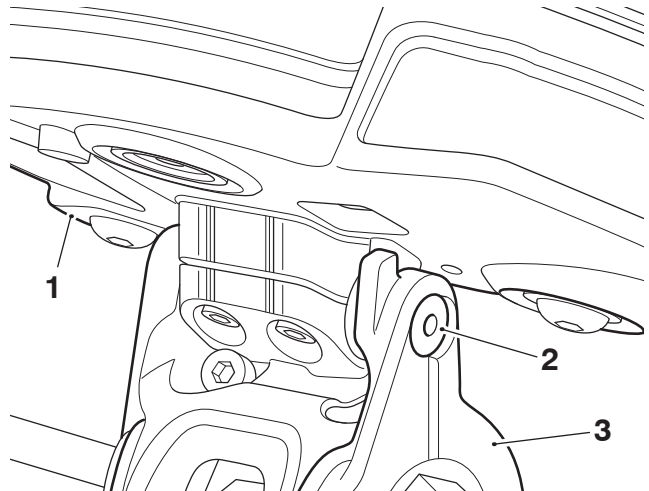

- 1. Instrument panel
- 2. Fixings, right hand side shown
- 3. Instrument panel mounting

38. Fit the original rubber strap to secure the subharness to the main wiring harness.

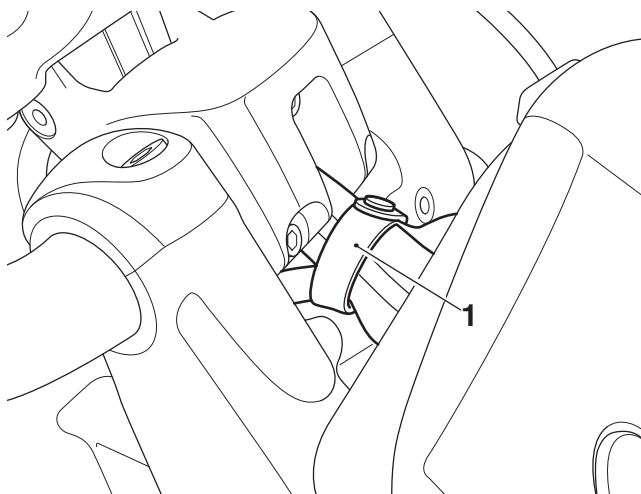

1. Rubber strap

39. Refit the riser cover panel as described in the Service Manual.
40. Reconnect the battery, as described in the Service Manual.
41. Test the direction indicators, rear light, headlight and all other switch gear functions to confirm they function correctly.
42. Refit the flyscreen and finishers as described in the Service Manual.
43. Adjust any mirrors fitted to the correct position.

⚠ WARNING

Move the handlebars to left and right full lock while checking that handlebars do not contact the fuel tank or restrict the steering.

Any restriction in steering may lead to loss of motorcycle control which could result in serious injury or death.

⚠ WARNING

Move the handlebars to the left and right full lock checking that the cables and harness do not bind.

A cable or harness that binds will restrict the steering and may lead to loss of motorcycle control which could result in serious injury or death.

⚠ WARNING

After fitting the accessory kit the motorcycle will exhibit new handling characteristics.

Operate the motorcycle in a safe area free from traffic to gain familiarity with any new characteristics.

Operation of the motorcycle when not familiar with any new handling characteristics may lead to loss of motorcycle control which could result in serious injury or death.

⚠ WARNING

If, after fitting this accessory kit, you have any doubt about the performance of any aspect of the motorcycle, contact a competent person with the specialist knowledge and technical understanding of motorcycles, such as an authorised Triumph dealer.

Riding a motorcycle when there is any doubt as to any aspect of the performance of the motorcycle may lead to loss of motorcycle control which could result in serious injury or death.

⚠ WARNING

Never ride an accessory-equipped motorcycle at speeds above 80 mph (130 km/h).

Remember that the 80 mph (130 km/h) limit will be reduced by the fitting of non-approved accessories, incorrect loading, worn tyres, overall motorcycle condition and poor road or weather conditions.

The presence of accessories will cause changes in the stability and handling of the motorcycle. Failure to allow for changes in motorcycle stability may lead to loss of motorcycle control which could result in serious injury or death.

⚠ WARNING

High-speed operation should only be attempted by riders who have been instructed in the techniques necessary for high-speed riding and are familiar with the motorcycle's characteristics in all conditions.

Only operate this Triumph motorcycle at high speed in closed-course, on-road competition or on closed-course racetracks.

High-speed operation in any other circumstances is dangerous and may lead to loss of motorcycle control which could result in serious injury or death.

NOTICE

The motorcycle must not be operated above the legal road speed limit except in closed-course conditions.