

Fitting Instructions: Tiger 1050 and Tiger Sport A9638015

Thank you for choosing this Triumph genuine accessory kit. This accessory kit is the product of Triumph's use of proven engineering, exhaustive testing, and continuous striving for superior reliability, safety and performance.

Completely read all of these instructions before commencing the installation of the accessory kit in order to become thoroughly familiar with the kit's features and the installation process.

These instructions should be considered a permanent part of your accessory kit, and should remain with it even if your accessory-equipped motorcycle is subsequently sold.

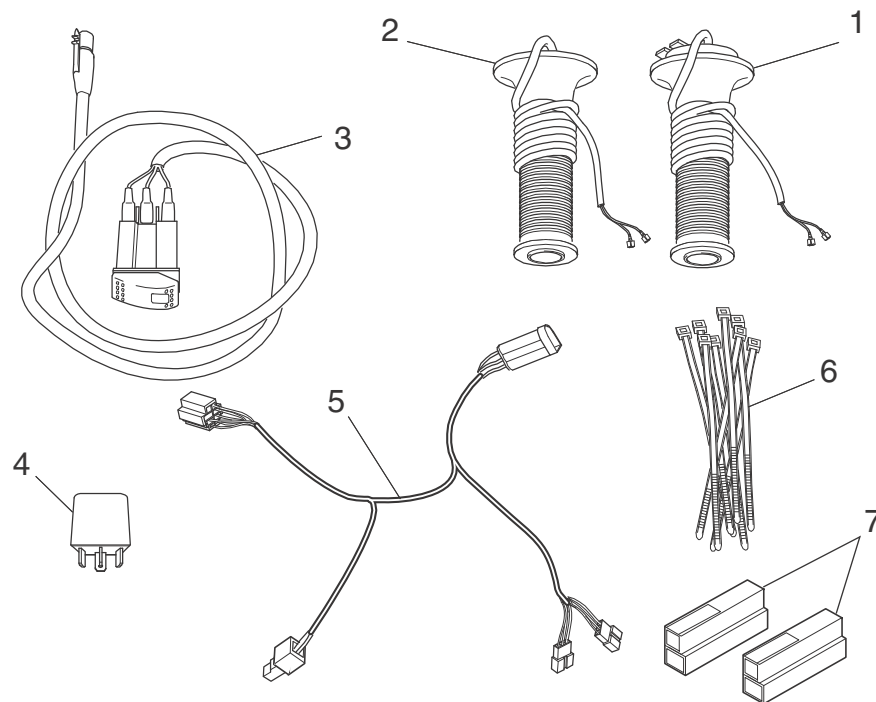

Parts Supplied:

1. Grip, right hand	1 off	5. Sub-harness	1 off
2. Grip, left hand	1 off	6. Cable ties	10 off
3. Switch and cable	1 off	7. Connector blocks	2 off
4. Relay	1 off		

Warning

This accessory kit is designed for use on Triumph Tiger 1050 and Tiger Sport motorcycles only and should not be fitted to any other Triumph model or to any other manufacturer's motorcycle. Fitting this accessory kit to any other Triumph model, or to any other manufacturer's motorcycle will affect the performance, stability and handling of the motorcycle. This may affect the rider's ability to control the motorcycle and could cause an accident.

Warning

Always have Triumph approved parts, accessories and conversions fitted by a trained technician of an authorised Triumph dealer. The fitment of parts, accessories and conversions by a technician who is not of an authorised Triumph dealer may affect the handling, stability or other aspects of the motorcycle's operation which may result in loss of motorcycle control and an accident.

Warning

Always ensure that the newly installed wiring does not chafe against other parts of the motorcycle such that it may be rubbed through and cause an electrical problem. In addition, always ensure that the newly installed wiring will not restrict steering movement. Both conditions are hazardous and could give rise to a dangerous riding condition resulting in a fire, loss of motorcycle control and an accident.

Warning

Throughout this operation, ensure that the motorcycle is stabilised and adequately supported on a paddock stand to prevent risk of injury from the motorcycle falling.

Warning

A torque wrench of known accurate calibration must be used when fitting this accessory kit. Failure to tighten any of the fasteners to the correct torque specification may result in loss of motorcycle control and an accident.

Heated Grip Installation

1. Remove the seat and disconnect the battery, negative (black) lead first.
2. Remove the cockpit fairing, as described in the Service Manual.
3. Remove the handlebar end weights.
4. On the left hand handlebar, remove the switch housing screws and allow the switch housing to hang free of the handlebar.
5. Remove the handlebar grip.
6. On the right hand handlebar, remove the switch housing screws and allow the switch housing to hang free of the handlebar.

Note:

- **To gain access to the switch housing screws it may be necessary to slacken the front brake/master cylinder clamp screws and rotate the assembly out of the way.**

Warning

Do not allow the master cylinder to invert as this will introduce air into the brake system and may also cause brake fluid to leak resulting in damage to bodywork.

A dangerous riding condition, leading to loss of motorcycle control and an accident could result if this warning is ignored.

7. On the twist grip, slide off the rubber boot and release the screws which secure the two halves of the twist grip guide to each other.

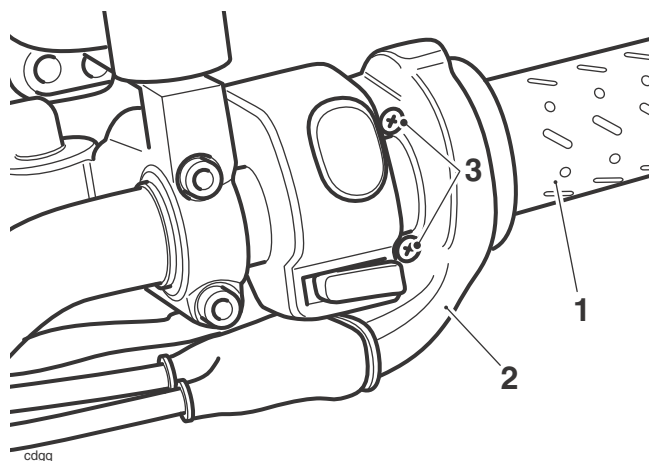

1. Twist grip
2. Twist grip guide
3. Screws

Note:

- Prior to detaching the throttle cables from the twist grip, clearly identify the opening and closing cables so that they may be refitted in the correct positions.
8. Separate the two halves of the guide then release the inner cables from the twist grip.

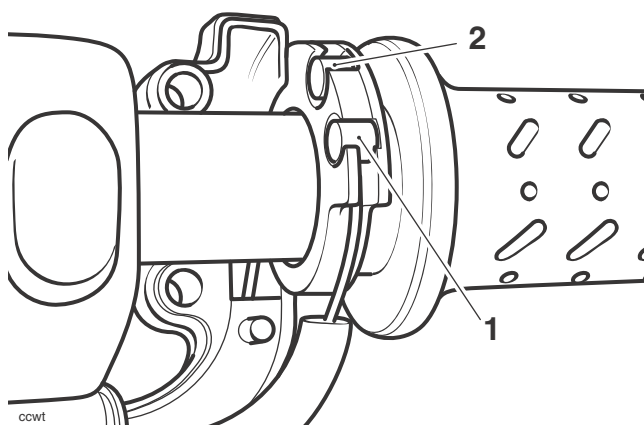

1. Closing cable
2. Opening cable

9. Remove the handlebar grip.

Motorcycles with Chrome Finish Steel Handlebar

10. Thread the right hand (throttle) grip heating element cable into the end of the handlebar and out through the hole in the underside, as shown.

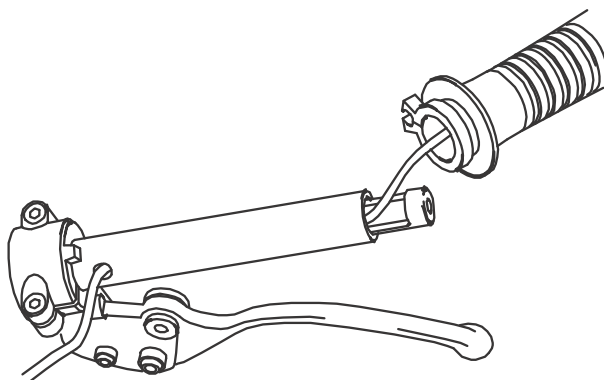

Heated Grip Installation (right hand shown)

11. Carefully fit the grip ensuring that the cables are located in the cut-away area of the handlebar end weight mounting insert and cannot be trapped.

Note:

- The handlebar may have been manufactured with the handlebar end weight mounting insert installed in one of two positions. Identify the location of the insert and ensure the cables are routed correctly inside the twist grip.
12. If the handlebar end weight mounting insert is positioned as shown below, the cables should be routed such that they run in an anti-clockwise direction from the heated grip to the centre of the handlebar as shown.

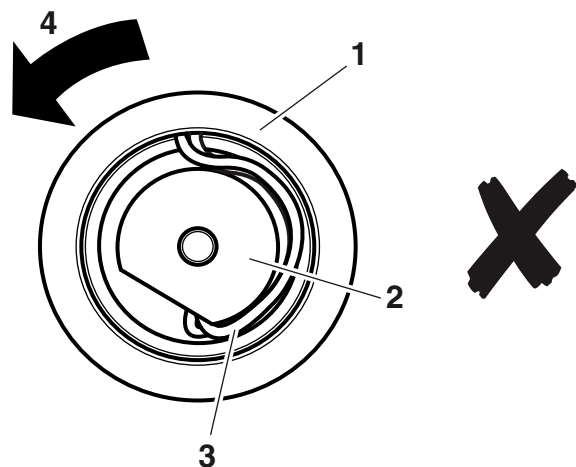
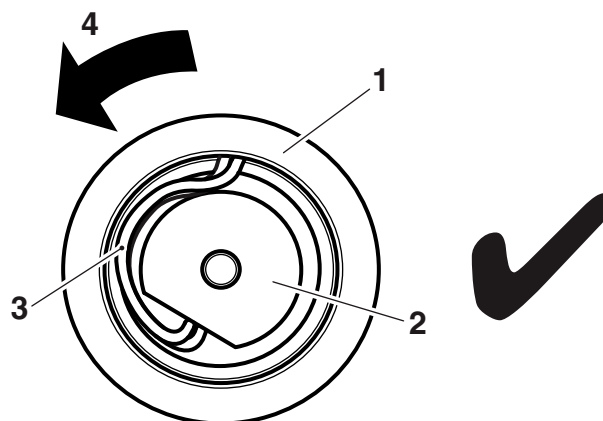

1. Heated grip (throttle side)
2. Handlebar end weight mounting insert
3. Heated grip cables
4. Throttle opening direction

13. If the handlebar end weight mounting insert is positioned as shown below, the cables should be routed such that they enter the cut-out in the insert as shown.

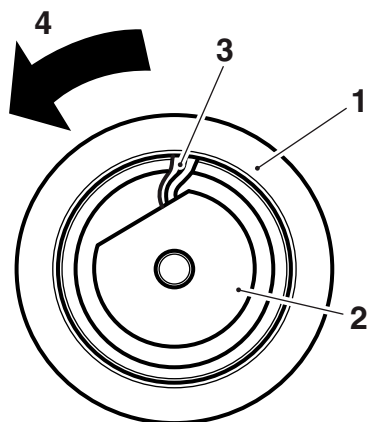

- 1. Heated grip (throttle side)
- 2. Handlebar end weight mounting insert
- 3. Heated grip cables
- 4. Throttle opening direction

14. Ensure that the grip is flush with the handlebar and reconnect the throttle cables as noted before detaching them.

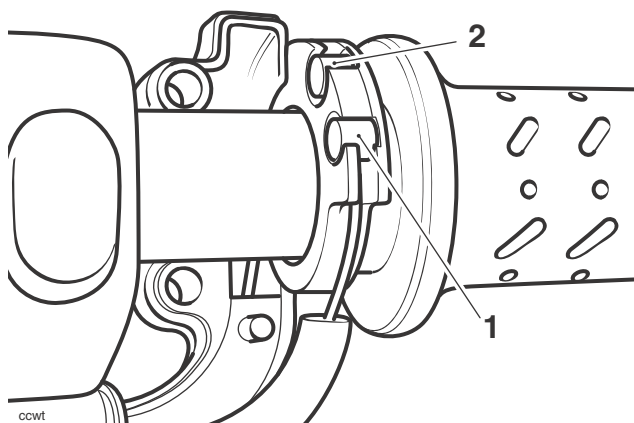

- 1. Closing cable
- 2. Opening cable

15. Assemble the two halves of the cable guide ensuring that the outer cables are correctly located in the guide and the guide is positioned on the handlebars as prior to removal. Tighten the screws to **3 Nm**.

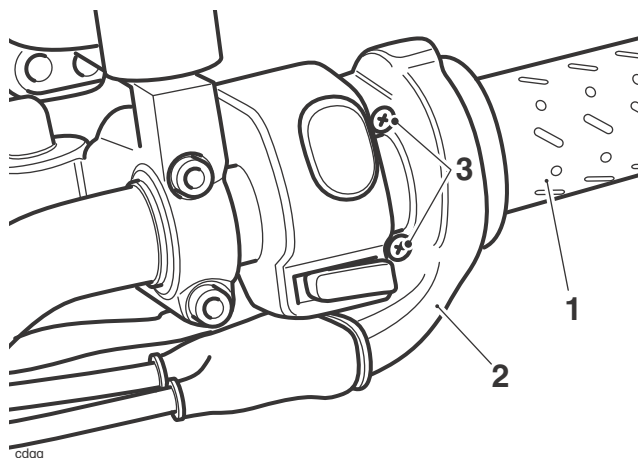

- 1. Twist grip
- 2. Twist grip guide
- 3. Screws

Motorcycles with Anodised Finish Aluminium Handlebars, including Oversized Handlebar Kits A9630104 or A9630105

16. Thread the right hand (throttle) grip heating element cable into the large hole in the handlebar end weight mounting and out through the hole in the underside of the handlebar, as shown.

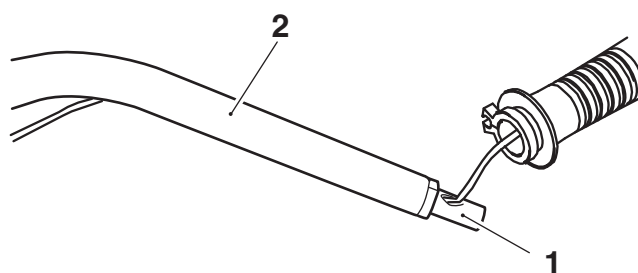

- 1. End weight mounting
- 2. Handlebar

17. Carefully fit the grip to the handlebar until the end of the grip is flush with the handlebar. Ensure that the cables do not become trapped and that there is enough cable slack to form a loop outside the grip, as shown below.

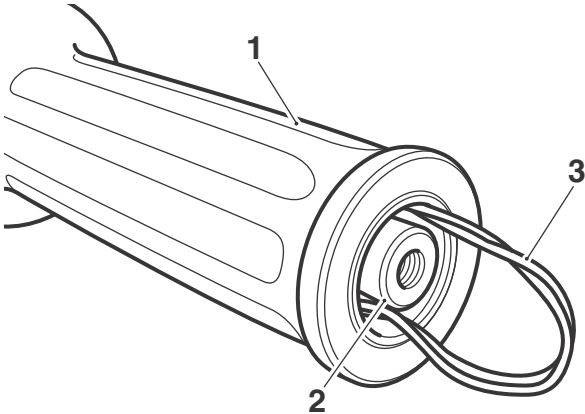

cgba

1. Grip
2. Handlebar
3. Cables loop

18. Ensure that the grip is flush with the handlebar and reconnect the throttle cables as noted before detaching them.

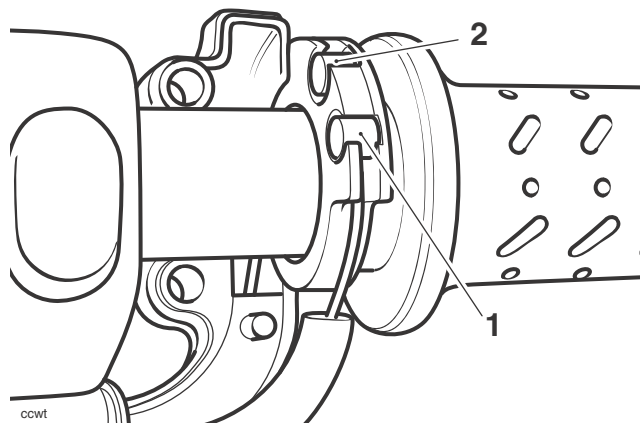

ccwt

1. Closing cable
2. Opening cable

19. Assemble the two halves of the cable guide ensuring that the outer cables are correctly located in the guide and the guide is positioned on the handlebars as prior to removal. Tighten the screws to **3 Nm**.

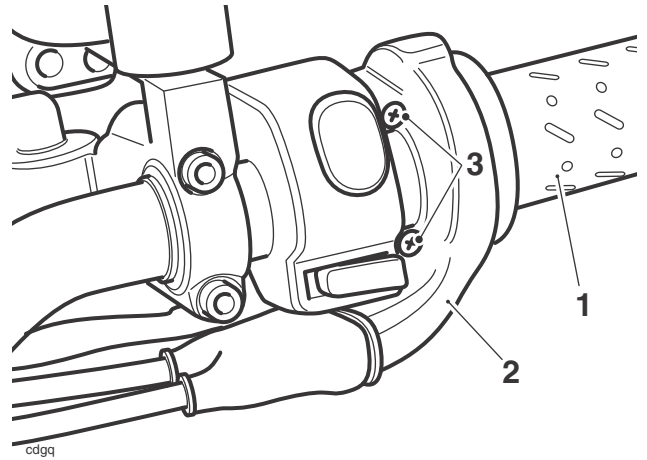

cdgq

1. Twist grip
2. Twist grip guide
3. Screws

20. Carefully pull the cable back through the hole in the underside of the handlebar until the loop of the cables is just inside the end of the grip, as shown below.

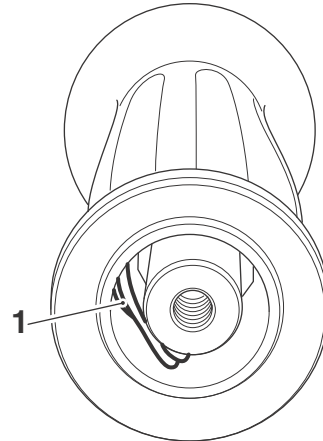

cgbg

1. Cables loop
21. Ensure there is enough slack in the cables for the twist grip to rotate and for the cables not to become trapped.

All Models

22. Carefully check that the twist grip rotates smoothly through its full range of movement, and is not restricted in any way. If any tightness or resistance is felt, check and rectify the cause before riding the motorcycle.
23. Refit the right hand switch housing ensuring that the boss locates in the dowel hole. Tighten the securing screws to **4 Nm**.



Caution

When securing electrical cable ties ensure that there is enough slack in the cables to allow for cable movement. Over-tightening of the cables may result in wiring harness damage and electrical malfunctions.

24. Ensuring the throttle is fully closed, and the cable inside the twist grip has adequate slack to allow correct throttle operation, secure the right hand heated grip cable to the right hand switch cube cable, approximately 40 mm from cable exit hole on the handlebar with a cable tie from the kit.
25. Check that there is 2 - 3 mm of free play at the throttle twist grip. Adjust if necessary.



Warning

Operation of the motorcycle with an incorrectly adjusted, incorrectly routed or damaged throttle cable could interfere with the operation of the brakes, clutch or the throttle itself. Any of these conditions could result in loss of motorcycle control and an accident.



Warning

Move the handlebars to the left and right full lock while checking that the cables and harness do not bind. A cable or harness that binds will restrict the steering and may cause loss of control and an accident.

26. Re-secure the front brake lever/master cylinder by aligning the clamp split line with the dot mark on the handlebar and tightening the clamp bolts, upper first, to **15 Nm**.
27. Refit the right hand handlebar end weight. Tighten the end weight fixing to **5 Nm**.

28. Fit the left hand heated grip in the same way as for the right, again ensuring that the heating element cable is located correctly and cannot be trapped. Secure the left hand grip by aligning and tightening the two self-tapping screws, as shown below.

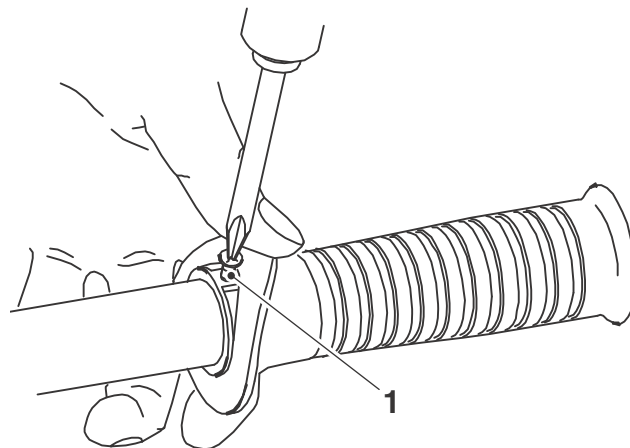

1. Self-tapping screw (1 of 2 shown)

29. Refit the left hand switch housing. Tighten the screws to **4 Nm**.
30. Refit the left hand handlebar end weight. Tighten the end weight fixing to **5 Nm**.

Operating Switch Installation

1. Locate the left hand cockpit infill panel removed during cockpit removal.
2. The switch aperture location is marked on the reverse of the left hand cockpit infill panel. Carefully cut out the marked area, and adjust the length of the aperture to give a secure mounting when the switch is installed.

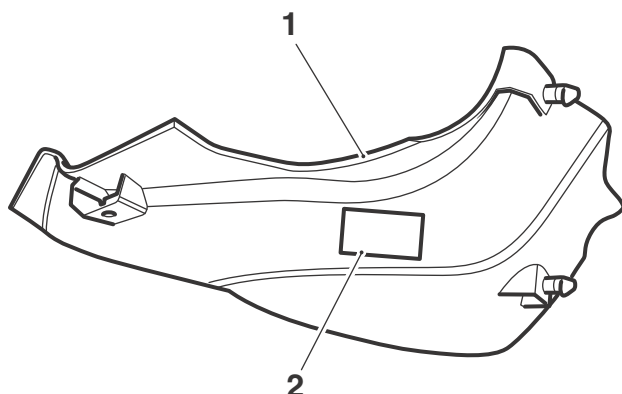

1. Left hand fairing infill panel
2. Area to be cut out

3. Feed the switch cable through the cut-out from above and secure the switch (push fit), ensuring that when the panel is refitted, the switch symbol will be towards the front of the motorcycle.
4. Temporarily refit the infill panel to the fairing, securing with the rear screw. Do not tighten the screw. The infill panel cannot be refitted completely until the cockpit is refitted.



Caution

When securing electrical cable ties ensure that there is enough slack in the cables to allow for cable movement. Over-tightening of the cables may result in wiring harness damage and electrical malfunctions.

5. Route the switch cable to the inside front of the cockpit. Secure the cable with cable ties to help prevent the wires becoming trapped or stretched by the steering mechanism.

Sub-Harness Installation

1. Attach the supplied terminal blocks to the handlebar grip wires ensuring the correct orientation of the terminals.

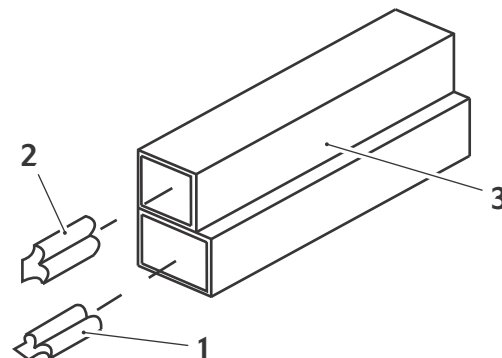

1. Black terminal
2. Brown terminal
3. Connector block



Warning

When securing electrical cables with cable ties ensure the cable ties are fully tight. Ensure there is slack in the cable.

Failure to follow this warning may result in damage to the electrical cables which may lead to loss of motorcycle control and an accident.

2. Route the two heating cable wires to the inside front of the cockpit following the route of the respective switch cube wiring. Secure the cables with cable ties to help prevent the wires becoming trapped or stretched by the steering mechanism.
3. Secure the cables to the existing harnesses using the cable ties supplied.
4. Recover the heated grips sub-harness and relay from the kit and connect the relay to the sub-harness.

5. Identify the 3-way connector on the main wiring harness (located centrally above the headlight) and remove the blanking plug.

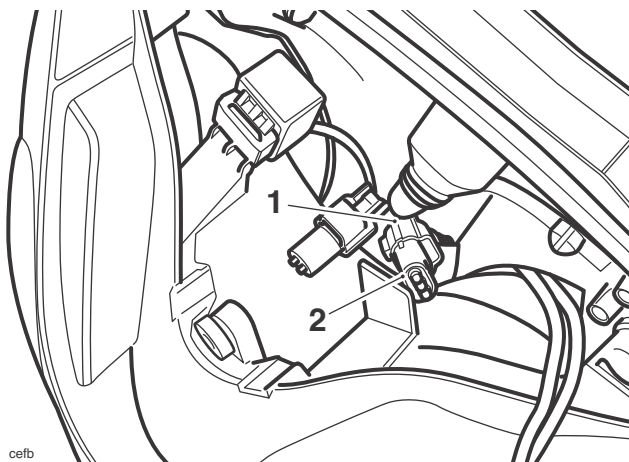

1. Heated grip connector
2. Blanking plug

6. Connect the sub-harness power plug to the 3-way connector.

Note:

- **Retain the 3-way connector blanking plug for use if the motorcycle is returned to original condition.**
7. Connect the cables from the operating switch and handlebar grips to the corresponding connectors on the sub-harness, as shown below, ensuring that the grip cable wires are connected black to black and brown to brown.

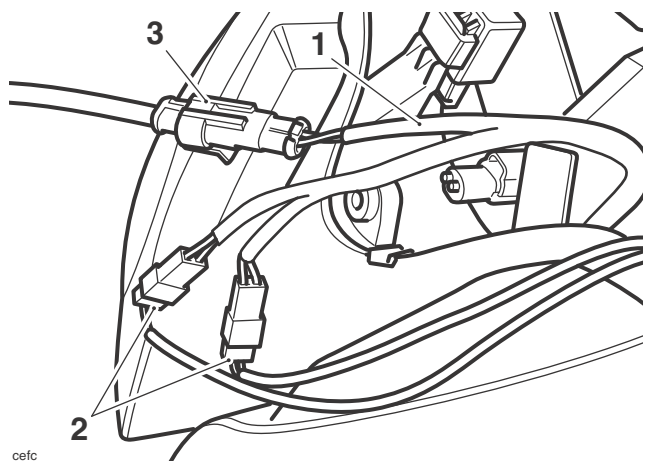

1. Sub-harness
2. Heated grip connectors
3. Operating switch connector

8. Secure the heated grips relay to the tang on the headlight assembly.

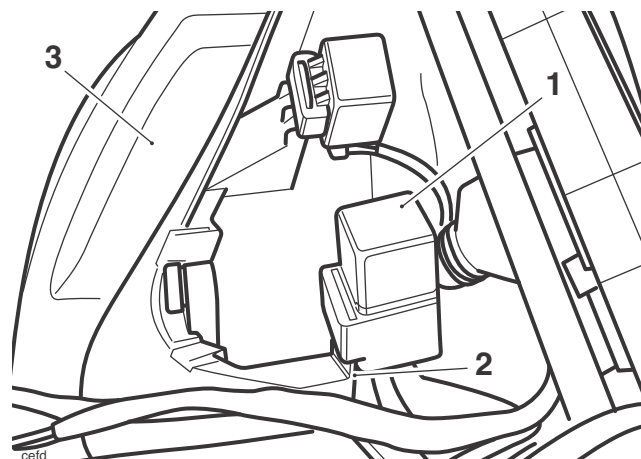

1. Relay
2. Relay mounting tang
3. Headlight assembly



Warning

When fitting and connecting the sub-harness, route the cables to follow existing harnesses where possible and ensure no cables can be trapped or stretched by the steering mechanism.



Caution

When securing electrical cable ties ensure that there is enough slack in the cables to allow for cable movement. Over-tightening of the cables may result in wiring harness damage and electrical malfunctions.

9. Secure the sub-harness and all loose cables to the existing harness using the cable ties supplied, ensuring that the steering mechanism is not hampered and that the cables cannot be trapped or stretched.

Note:

- **The operating switch cable has been supplied to a specific length, the resistance within the wires being critical to the correct operation of the heated grips circuit, and must not be shortened.**
10. Refit the cockpit fairing as described in the Service Manual.



Warning

Do not coil excess cable. Coiling excess cable could cause restriction of the steering and entrapment of the wires leading to a dangerous riding condition, loss of motorcycle control and an accident.

Warning

Ensure that steering movement is not restricted by turning the handlebars through their full range of movement while checking that they move freely from left to right.

11. Reconnect the battery, positive (red) lead first and refit the seat.

To Test the Heated Grip System

1. Run the engine to avoid draining the battery.

Warning

Before running the engine, ensure the working area is adequately ventilated to avoid the risk of asphyxiation from the inhalation of exhaust fumes.

2. Operate the switch in both positions and check for heating.

Note:

- **The heated grip system is protected by a fuse. For replacement of the fuse, refer to the Owner's Handbook.**

Operation

The three position switch is connected to the ignition circuit. The handlebar grips will only heat when the ignition is switched on.

The system is designed to offer two levels of heat at the grips, 'HOT' or 'WARM'.

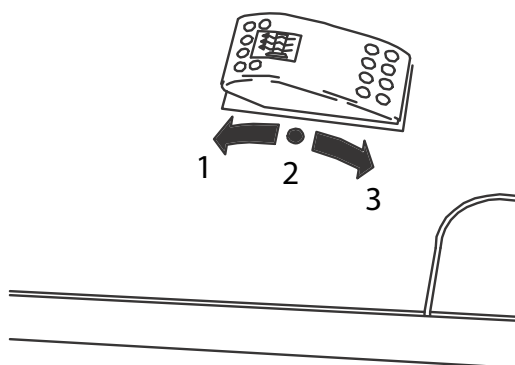

1. **HOT (use only until grips are warm)**
2. **OFF**
3. **WARM**

For maximum benefit in cold conditions, position the switch to the 'HOT' position initially and then to the 'WARM' position when the grips have warmed up.

Warning

If, after fitting this accessory kit, you have any doubt about the performance of any aspect of the motorcycle, contact an authorised Triumph dealer and do not ride the motorcycle until the authorised dealer has declared it fit for use. Riding a motorcycle when there is any doubt as to any aspect of the performance of the motorcycle may result in loss of control of the motorcycle leading to an accident.

Warning

Never ride an accessory equipped motorcycle at speeds above 80 mph (130 km/h).

The presence of accessories will cause changes in the stability and handling of the motorcycle. Failure to allow for changes in motorcycle stability may lead to loss of control or an accident.

Remember that the 80 mph (130 km/h) limit will be reduced by the fitting of non-approved accessories, incorrect loading, worn tyres, overall motorcycle condition and poor road or weather conditions.

Warning

The motorcycle must not be operated above the legal road speed limit except in closed course conditions.

Warning

Only operate this Triumph motorcycle at high speed in closed course, on-road competition or on closed course racetracks. High speed operation should only be attempted by riders who have been instructed in the techniques necessary for high speed riding and are familiar with the motorcycle's characteristics in all conditions.

High speed operation in any other circumstances is dangerous and will lead to loss of motorcycle control and an accident.