



Accessory Fitting Instructions

Low Handlebar Kit	
Kit Number	Models Affected
A9630197	Bonneville Bobber
A9630550	Bonneville Bobber Black

Riser Finisher Kit	
Kit Number	Models Affected
A9630228	Bonneville Bobber

Thank you for choosing this Triumph genuine accessory kit. This accessory kit is the product of Triumph's use of proven engineering, exhaustive testing, and continuous striving for superior reliability, safety and performance.

Completely read all of these instructions before commencing the installation of the accessory kit in order to become thoroughly familiar with the kit's features and the installation process.

These instructions should be considered a permanent part of your accessory kit, and should remain with it even if your accessory equipped motorcycle is subsequently sold.

Parts Supplied: A9630197, A9630550

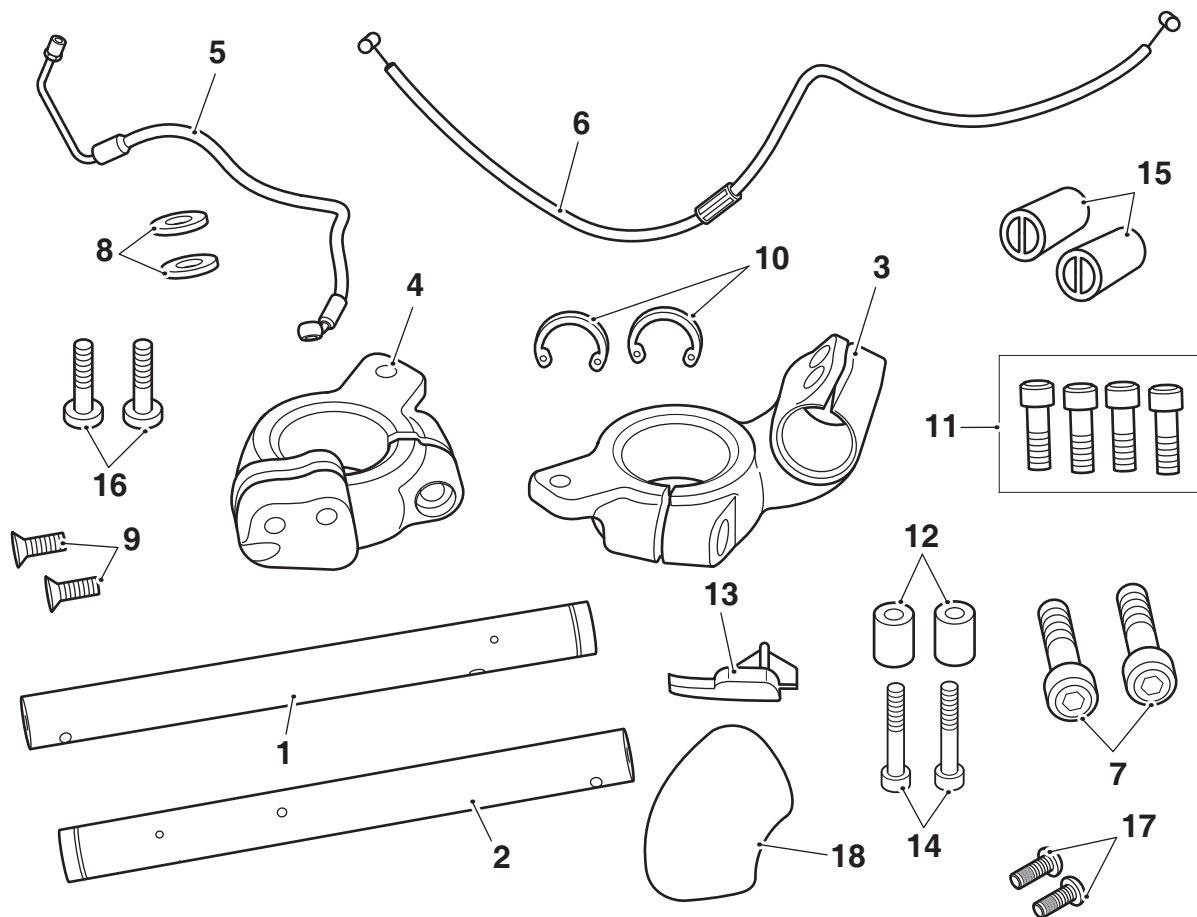

1.	Handlebar, right hand	1 off	11.	Fixing, M6 x 20 mm (cap head)	4 off
2.	Handlebar, left hand	1 off	12.	Spacer	2 off
3.	Riser, left hand	1 off	13.	Plastic plug	1 off
4.	Riser, right hand	1 off	14.	Fixing, M6 x 40 mm	2 off
5.	Brake hose	1 off	15.	Blanking plug	2 off
6.	Clutch cable	1 off	16.	Fixing, M6 x 27 mm	2 off
7.	Fixing, M8 x 35 mm	2 off	17.	Fixing, M5 x 12 mm	2 off
8.	Sealing washer (brake hose)	2 off	18.	Protective film	1 off
9.	Fixing, M6 x 20 mm	2 off	19.	Cleaning wipe (not shown)	1 off
10.	Circlip	2 off			

Parts Supplied: A9630228

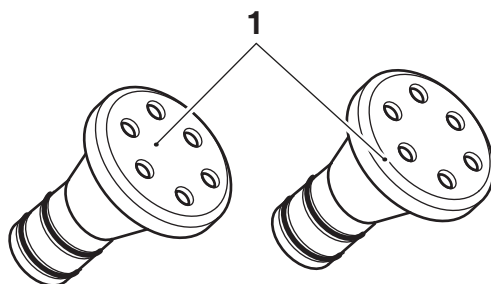

1.	Finisher	2 off		
----	----------	-------	--	--

Warning

The accessory kits covered in this instruction are designed for use on specific models of Triumph motorcycle. The accessory kits and the models applicable are listed at the start of the instruction. They should not be fitted to any other Triumph model or to any other manufacturer's motorcycle. Fitting an accessory kit to a Triumph model not listed, or to any other manufacturer's motorcycle will affect the performance, stability and handling of the motorcycle. This may affect the rider's ability to control the motorcycle and may result in loss of motorcycle control and an accident.

Warning

Always have Triumph approved parts, accessories and conversions fitted by a trained technician of an authorised Triumph dealer. The fitment of parts, accessories and conversions by a technician who is not of an authorised Triumph dealer may affect the handling, stability or other aspects of the motorcycle's operation which may result in loss of motorcycle control and an accident.

Warning

Throughout this operation, ensure that the motorcycle is stabilised and adequately supported to prevent risk of injury from the motorcycle falling.

Warning

A torque wrench of known accurate calibration must be used when fitting this accessory kit. Failure to tighten any of the fasteners to the correct torque specification may affect motorcycle performance, handling and stability. This may result in loss of motorcycle control and an accident.

Note:

- **Triumph offers a broad range of approved genuine accessories for your motorcycle. We cannot therefore cover all possible equipment variations in these instructions. For removal and installation of Triumph Genuine Accessories, always refer to the instructions supplied with the respective accessory kit. To obtain additional copies of any Triumph accessory instructions, visit www.triumphinstructions.com or contact your authorised Triumph dealer.**

1. Remove the seat, as described in the Service Manual.
2. Disconnect the battery, negative (black) lead first.
3. Remove the fuel tank, as described in the Service Manual.

Caution

To prevent damage, ensure that any displaced brake fluid does not come into contact with any part of the bodywork.

4. Drain the brake fluid from the front master cylinder. Attach a tube to the right hand brake caliper bleed nipple. Release the bleed nipple and allow the brake fluid to drain into a suitable container. Pull and release the brake lever until all fluid has been expelled from the master cylinder.
5. Remove the front brake hose front union bolt from the master cylinder, placing a cloth under the hose connection to absorb any remaining fluid which may be displaced. Retain the union bolt for reuse, discard the sealing washers.
6. Remove the front brake hose noting its routing. Retain the brake hose for reuse if the motorcycle is to be returned to its original condition.
7. Remove the harness guide from the left hand side of the motorcycle. Retain the harness guide for reuse. Discard the fixings.

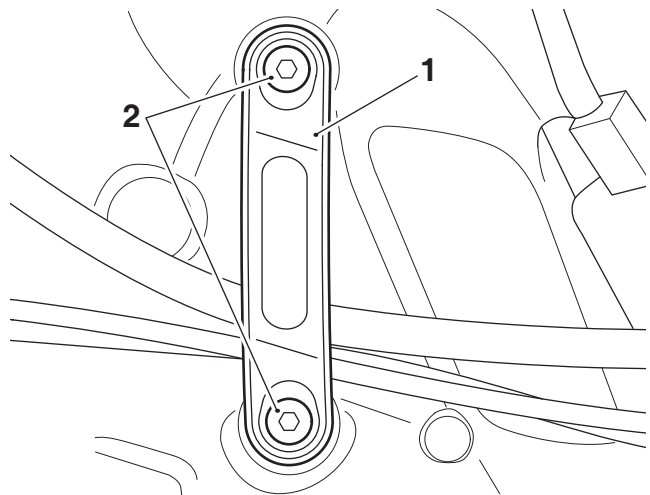

1. Harness guide
2. Fixings

8. Remove the clutch cable, as described in the Service Manual. Retain the clutch cable for reuse if the motorcycle is to be returned to its original condition.
9. Remove the bar end finishers as described in the Service Manual.

10. Loosen the riser fixings on the underside of the top yoke. Do not remove the fixings at this stage.
11. Remove the handlebar clamp and fixings. Retain the handlebar clamp and fixings for reuse if the motorcycle is to be returned to its original condition.

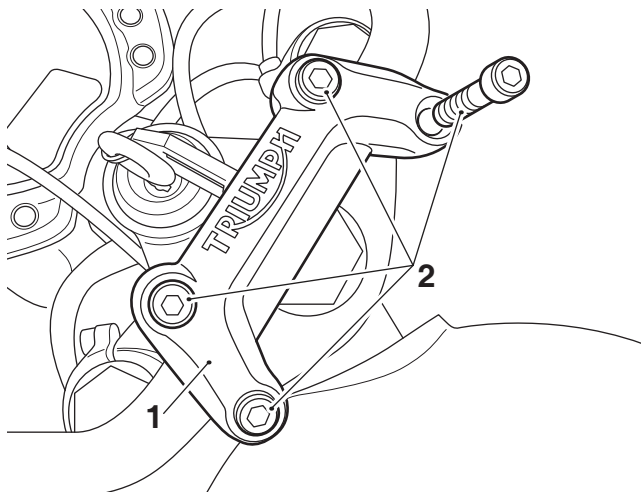

1. Handlebar clamp
2. Fixings

12. Remove the following components from the handlebars, as described in the Service Manual, taking note of any harness routing. Ensure all parts are suitably supported and do not damage the motorcycle.
 - Clutch lever assembly.
 - Brake lever, master cylinder.
 - Indicator harness rubber strap.
 - Left hand and right hand switch housings.
 - Left hand and right hand handlebar grips.
 - Twist grip position sensor.
 - Mirrors.
13. Remove the handlebars from the risers. Retain the handlebars for reuse if the motorcycle is to be returned to its original condition.
14. Remove the risers, rubber bushes and sleeves from the upper yoke. Retain the risers, rubber bushes, sleeves and all fixings for reuse if the motorcycle is to be returned to its original condition.

15. Remove the cable guides from the underside of the instrument housing. Retain two of the fixings for reuse. Retain the cable guides and remaining fixings for reuse if the motorcycle is to be returned to its original condition.

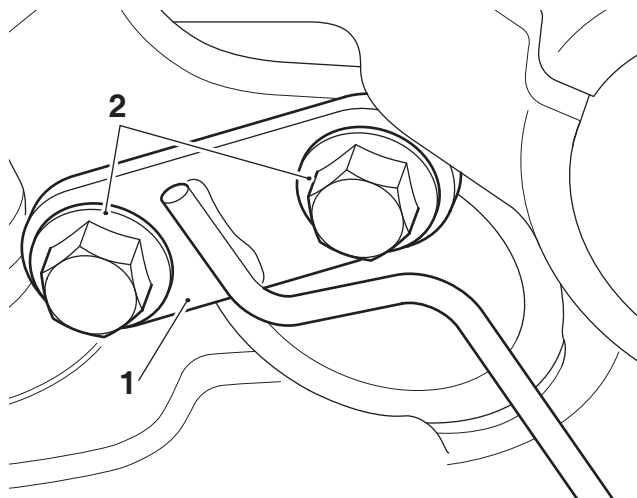

1. Cable guide, left hand side shown
2. Fixings

16. Fit the M6 x 27 mm fixings from the kit to the inner fixing positions to secure the instrument housing to the upper yoke as shown.

A9630550 Kit Only

 Fit the original M6 x 16 mm fixings to the outer instrument housing fixing positions, as shown.

Tighten all fixings to **6 Nm**.

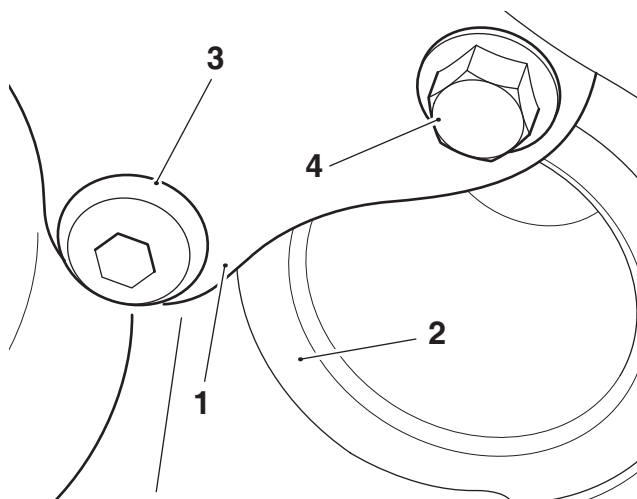

1. Instrument housing, left hand side shown
2. Upper yoke
3. Fixing, M6 x 27 mm
4. Fixing, M6 x 16 mm (A9630550 only)

17. Remove the upper yoke as described in the Service Manual.
18. Remove the cable guide from the left hand fork leg.

19. Remove the two headlight mounting bracket fixings to allow access to the rear of the headlight. Retain the fixings for reuse.

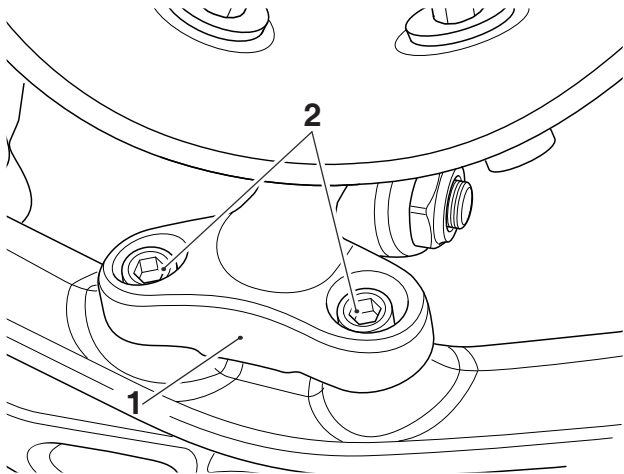

1. Headlight mounting bracket
2. Fixings

20. Carefully rotate the headlight bowl forwards to allow access to the rear of the headlight bowl.

Note:

- Read the warning notices printed on the cleaning wipe packet provided in the kit.
- The surface to which the protective film is affixed must be clean and dry to ensure that the adhesive has a sound base to adhere to. Use a cleaning wipe supplied for this purpose.

21. Clean the headlight bowl using the cleaning wipe provided in the kit.
22. Collect the protective film from the kit and peel off the protective backing.
23. Align the top edge of the film with the centre line of the headlight bowl and the inner curved section of the film 2 mm in to the flat section of the headlight bowl, as shown below.

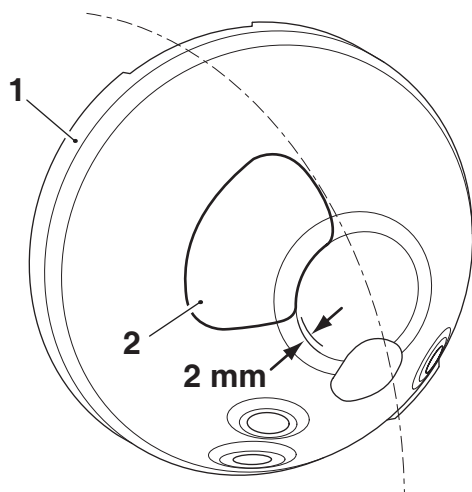

1. Headlight bowl
2. Protective film

24. Ensure any creases in the protective film are worked out to the edge of the film.
25. Refit the headlight bowl with the original mounting bracket fixings. Tighten the fixings to **7 Nm**.

! Caution

Do not remove the plastic wedges from the handlebar risers until the risers have been fitted and positioned correctly on the forks. If the plastic wedges are removed before fitting and positioning the risers on the forks it could result in damage to the forks.

26. Fit the left hand low handlebar riser from the kit on to the front fork, as shown.

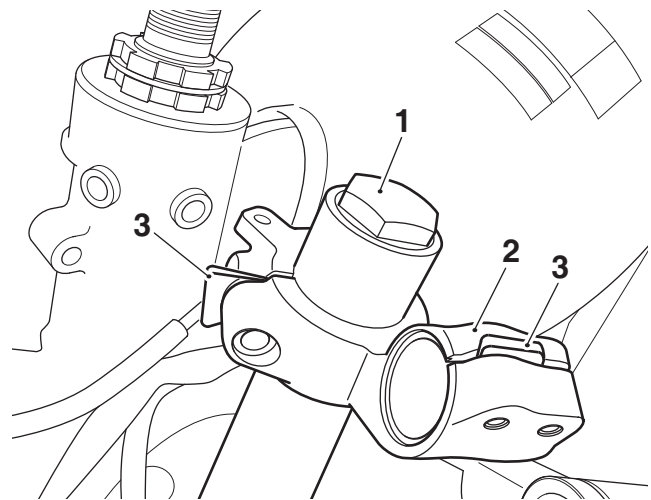

1. Front fork
2. Handlebar riser
3. Plastic wedges

27. Repeat step 26 for the right hand side.
28. Refit the top yoke, as described in the Service Manual.

29. Position the handlebar risers to the underside of the top yoke, remove the plastic wedges.

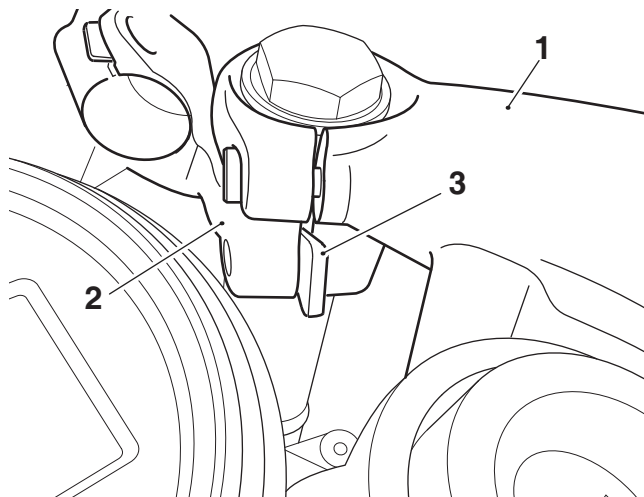

1. Top yoke
2. Handlebar riser
3. Plastic wedge

30. Fit the M6 x 40 mm fixings and spacers provided in the kit and secure the handlebar riser orientation feature to the underside of the upper yoke. Tighten the fixings to **5 Nm**.

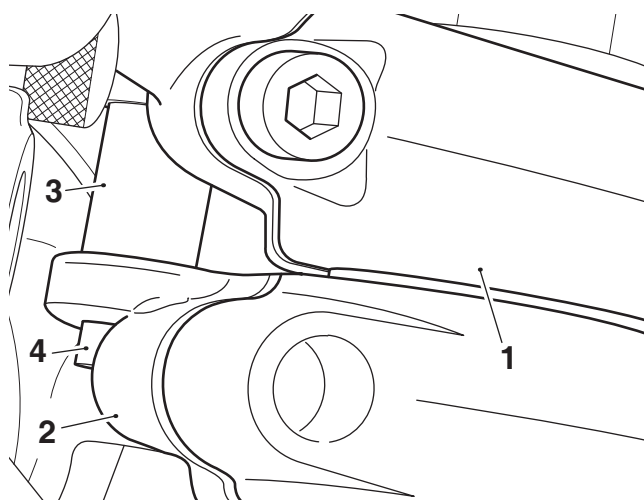

1. Upper yoke
2. Handlebar riser, left hand shown
3. Spacer
4. Fixing, M6 x 40 mm

31. Fit the M8 x 35 mm fixings to the handlebar risers. Tighten to **20 Nm**.

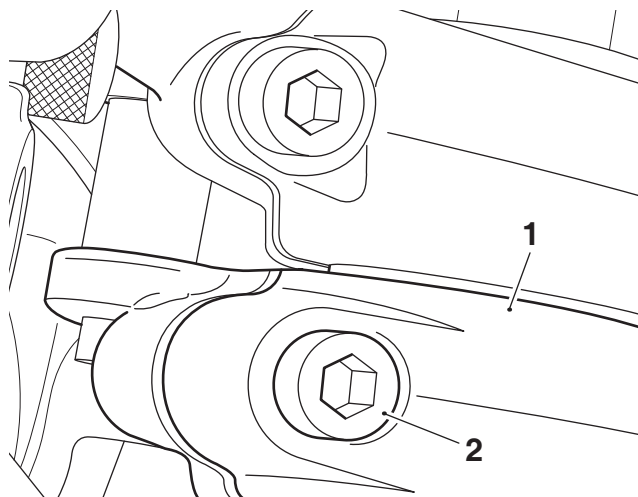

1. Handlebar riser, left hand shown
2. Fixing, M8 x 35 mm

Note:

- The left hand handlebar has two alignment marks next to the circlip groove, the right hand handlebar has one alignment mark.

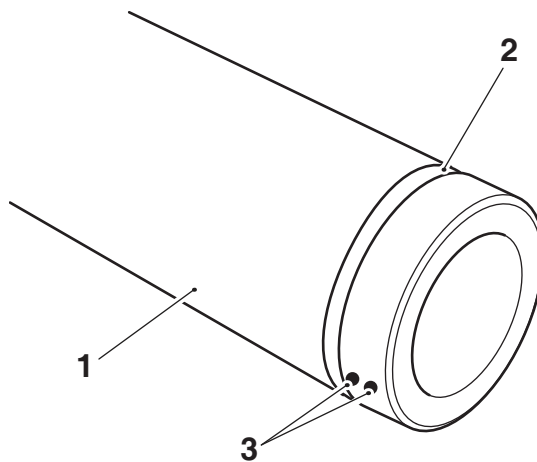

1. Left hand handlebar
2. Circlip groove
3. Alignment marks

32. If refitting the standard handlebar grips, fit the plastic plug provided in the kit into the slot in the left hand handlebar.

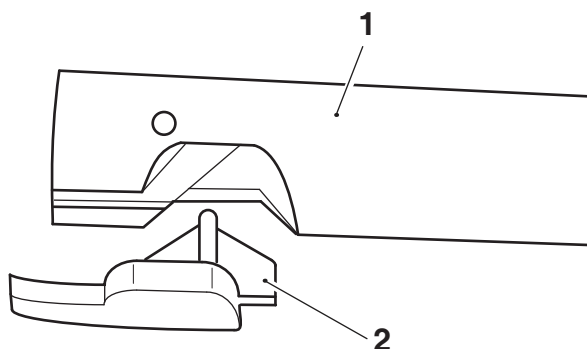

1. Handlebar, left hand
2. Plastic plug

33. Refit the following components to the handlebars as described in the Service Manual:
- Left hand and right hand switch housings.
 - Clutch lever assembly.
 - Brake lever, master cylinder.
 - Twist grip position sensor.
 - Left hand and right hand handlebar grips.
 - Mirrors.



Caution

Do not remove the plastic wedges from the handlebar risers until the handlebars have been fitted and positioned correctly in the risers. If the plastic wedges are removed before fitting and positioning the handlebars in the risers it could result in damage to the handlebars.

34. Slide the left hand handlebar through the handlebar riser until the circlip groove in the end of the handlebar is exposed.

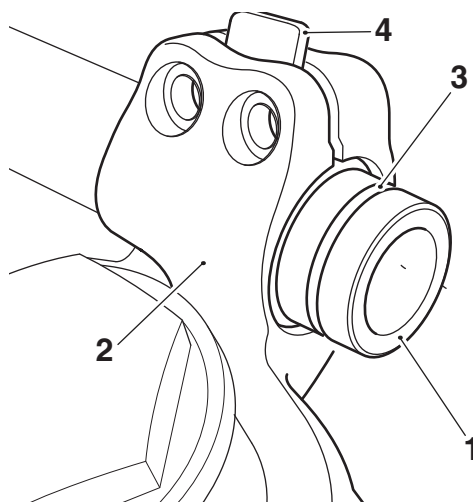

1. Handlebar
2. Handlebar riser
3. Circlip groove
4. Plastic wedge

35. Fit the new circlip provided in the kit into the groove on the handlebar.

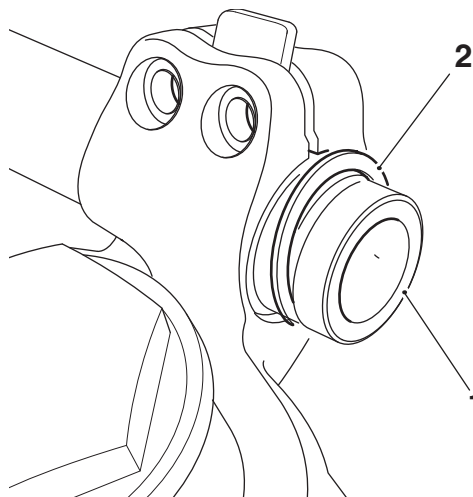

1. Handlebar
2. Circlip

36. Slide the handlebar back through the handlebar riser until the circlip abuts the riser.

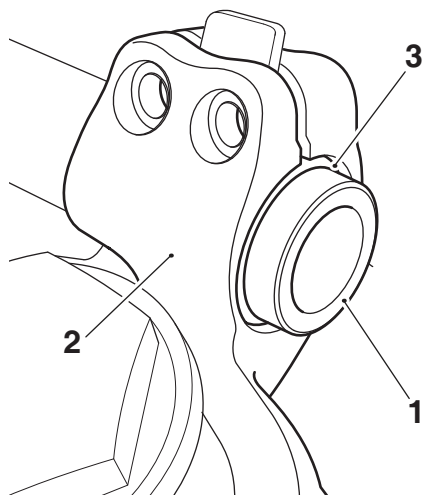

- 1. Handlebar
- 2. Handlebar riser
- 3. Circlip

37. Repeat steps 34 to 36 for the right hand side.

Note:

- **The left hand handlebar has two alignment marks next to the circlip groove, the right hand handlebar has one alignment mark.**

38. Rotate the handlebars to align the alignment marks on the handlebars and handlebar risers. Remove the plastic wedges from the handlebar risers.

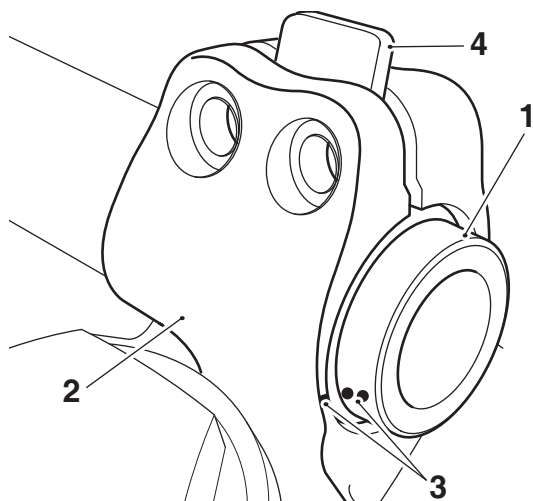

- 1. Handlebar, left hand shown
- 2. Handlebar riser
- 3. Alignment marks
- 4. Plastic wedge

39. Fit the M6 x 20 mm fixings to the handlebar risers and tighten to **8.5 Nm**.

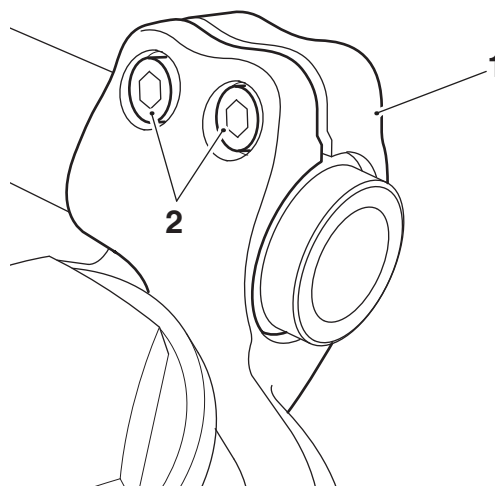

- 1. Handlebar riser, left hand shown
- 2. Fixing, M6 x 20 mm

40. Fit and adjust the clutch cable provided in the kit, as described in the Service Manual.

41. Refit the harness guide on the left hand side of the motorcycle using the M5 x 12 mm fixings provided in the kit ensuring the rubber stops on the clutch cable are positioned either side of the harness guide, as shown below. Tighten the fixings to **2.5 Nm**.

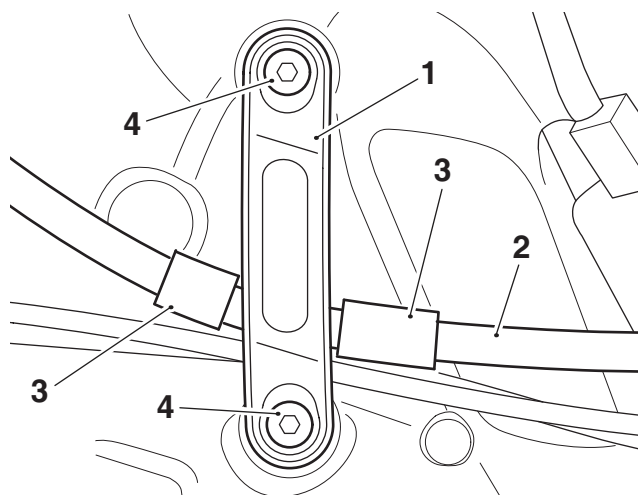

- 1. Harness guide
- 2. Clutch cable
- 3. Rubber stops
- 4. Fixings, M5 x 12 mm

42. Position any excess harness tidily into the recess behind the headstock.

43. Refit the rubber strap to secure the indicator harness to the clutch cable.

44. Fit the new front brake hose, as noted for removal, with the sealing washers provided in the kit and original union bolt. Adjust the position of the brake hose until the brake hose front union sits against the stop face on the master cylinder. Route the brake hose inside the right hand fork leg as shown.

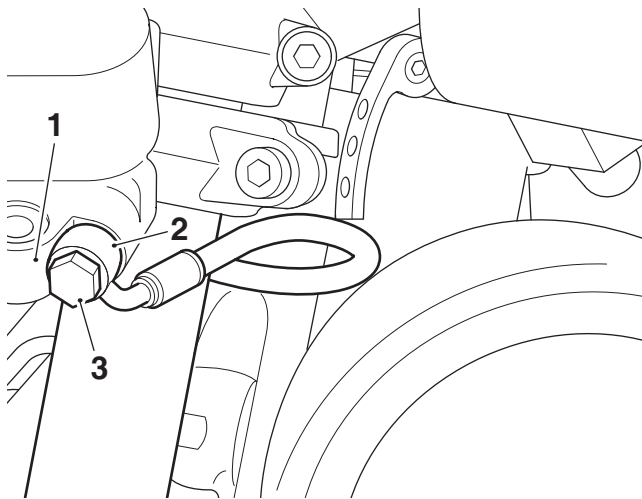

1. Master cylinder
2. Brake hose front union
3. Union bolt

45. Tighten the front brake hose front union bolt to **25 Nm**. Tighten the front brake hose rear union fixing to **15 Nm**.
46. Refit the bar end finishers using the M6 x 20 mm fixings provided in the kit. Tighten the fixings to **5 Nm**.

Warning

Use only DOT 4 specification brake fluid as specified in the Service Manual. The use of brake fluids other than those DOT 4 fluids listed in the Service Manual may reduce the efficiency of the braking system and may result in loss of motorcycle control and an accident.

Warning

Ensure absolute cleanliness when adding brake fluid to the brake fluid reservoir. Do not allow moisture or debris to enter the cylinder as this will adversely affect the fluid properties. Always use fluid from a sealed container and do not use fluid from a container which has been opened for any period of time. Always check for fluid leakage around hydraulic fittings and for damage to hoses. A dangerous riding condition leading to an accident could result if this warning is ignored.

47. To refill the braking system and bleed the front brakes, refer to the Service Manual.

48. To inspect the brake fluid level, check the level of fluid visible in the window on the brake fluid reservoir.
49. Examine the brake system for correct operation and fluid leaks. Rectify as necessary.

Warning

It is dangerous to operate the motorcycle with defective brakes; you must have your authorised Triumph dealer take remedial action before you ride the motorcycle again. Failure to take remedial action may result in reduced braking efficiency which may result in loss of motorcycle control and an accident.

50. Fit the blanking plugs provided into the handlebars as shown.

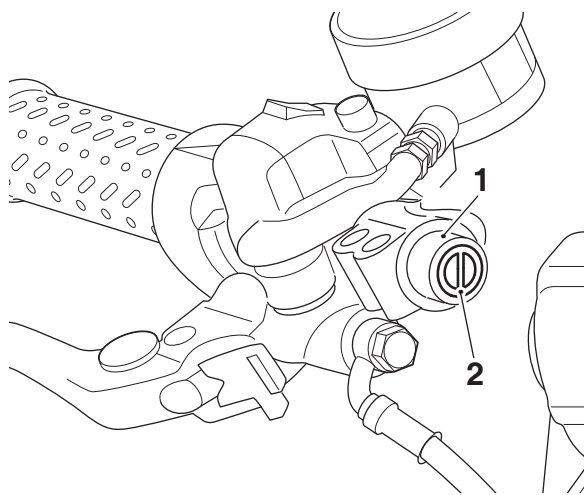

1. Handlebars, right hand shown
2. Blanking plugs

51. Refit the fuel tank, as described in the Service Manual.
52. Reconnect the battery, positive (red) lead first and tighten the battery terminals to **4.5 Nm**.
53. Refit the seat, as described in the Service Manual.
54. Adjust any mirrors fitted to the correct position.

Warning

Move the handlebars to left and right full lock while checking that handlebars do not contact the fuel tank or restrict the steering. Any restriction in steering may result in loss of motorcycle control and an accident.

! Warning

Move the handlebars to left and right full lock while checking that cables and harnesses do not bind. Cables or harnesses that bind will restrict the steering and may result in loss of motorcycle control and an accident.

Fitting a Riser Finisher Kit

55. If required a riser finisher kit A9630228 is available from your Triumph authorised dealer. The finishers are fitted into the vacant handlebar riser mounting holes in the upper yoke as shown.

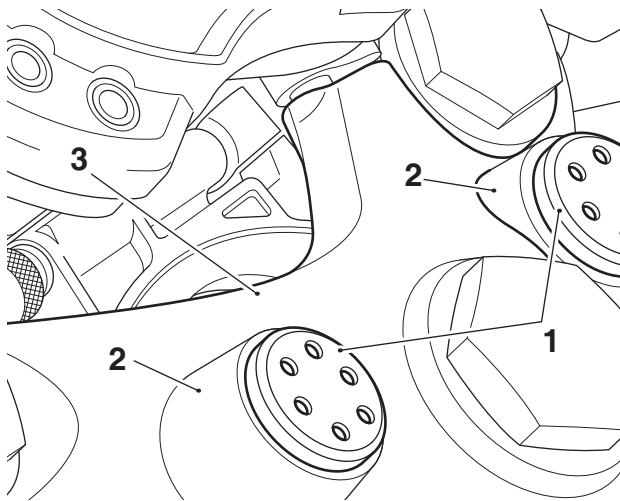

- 1. Finisher
- 2. Riser mountings
- 3. Upper yoke

! Warning

If, after fitting this accessory kit, you have any doubt about the performance of any aspect of the motorcycle, contact an authorised Triumph dealer and do not ride the motorcycle until the authorised dealer has declared it fit for use. Riding a motorcycle when there is any doubt as to any aspect of the performance of the motorcycle may result in loss of motorcycle control and an accident.

! Warning

Never ride an accessory-equipped motorcycle at speeds above 80 mph (130 km/h).

The presence of accessories will cause changes in the stability and handling of the motorcycle. Failure to allow for changes in motorcycle stability may result in loss of motorcycle control and an accident.

Remember that the 80 mph (130 km/h) limit will be reduced by the fitting of non-approved accessories, incorrect loading, worn tyres, overall motorcycle condition and poor road or weather conditions.

! Warning

The motorcycle must not be operated above the legal road speed limit except in closed-course conditions.

! Warning

Only operate this Triumph motorcycle at high speed in closed-course, on-road competition or on closed-course racetracks. High-speed operation should only be attempted by riders who have been instructed in the techniques necessary for high-speed riding and are familiar with the motorcycle's characteristics in all conditions.

High-speed operation in any other circumstances is dangerous and may result in loss of motorcycle control and an accident.