



## Accessory Fitting Instructions

High Handlebar Kit - Chrome, Graphite Risers	
Kit Number	Models Affected
A9630251 A9630391	Bonneville Bobber, Bonneville Bobber Black, Bonneville Speedmaster
High Handlebar Kit - Chrome, Black Risers	
Kit Number	Models Affected
A9630257	Bonneville Bobber, Bonneville Bobber Black, Bonneville Speedmaster
High Handlebar Kit - Black, Graphite Risers	
Kit Number	Models Affected
A9630250 A9630258 A9630569	Bonneville Bobber, Bonneville Bobber Black, Bonneville Speedmaster
High Handlebar Kit - Black, Black Risers	
Kit Number	Models Affected
A9630256 A9630262	Bonneville Bobber, Bonneville Bobber Black, Bonneville Speedmaster
<b>The high handlebar kits listed above must be fitted with one of the cable kits listed below.</b>	
Cable Kit - High Handlebar	
Kit Number	Models Affected
A9630201	Bonneville Bobber, Bonneville Bobber Black
A9630253	Bonneville Bobber, Bonneville Bobber Black
A9630556	Bonneville Speedmaster from VIN 739143 up to VIN AE2305 without instrument embellisher (see page 2)
A9630662	Bonneville Speedmaster from VIN AC1201 with instrument embellisher (see page 2)

Thank you for choosing this Triumph genuine accessory kit. This accessory kit is the product of Triumph's use of proven engineering, exhaustive testing, and continuous striving for superior reliability, safety and performance.

Completely read all of these instructions before commencing the installation of the accessory kit in order to become thoroughly familiar with the kit's features and the installation process.

These instructions should be considered a permanent part of your accessory kit, and should remain with it even if your accessory equipped motorcycle is subsequently sold.

Instrument Identification

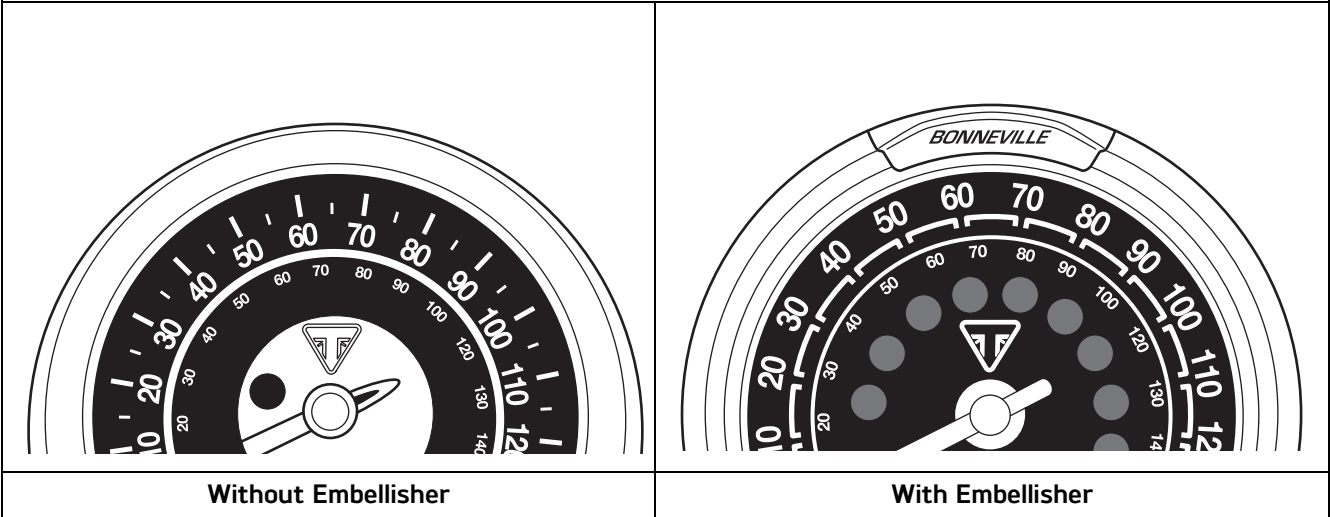

Parts Supplied: A9630250, A9630251, A9630256, A9630262, A9630257, A9630258, A9630391, A9630569

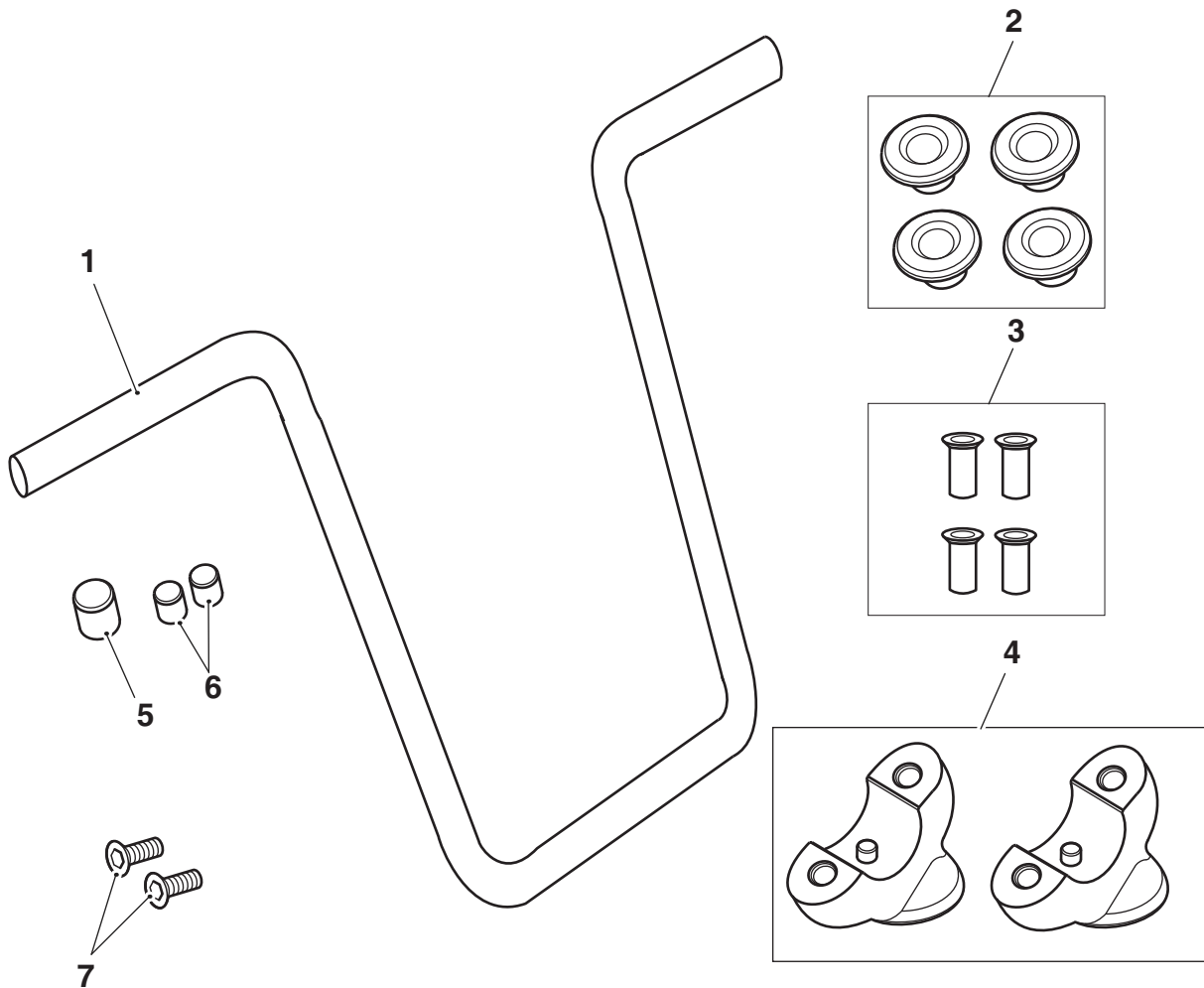

1.	Handlebar	1 off	5.	Plastic cap, 17 mm diameter	1 off
2.	Rubber bush	4 off	6.	Plastic cap, 14 mm diameter	2 off
3.	Flanged sleeve	4 off	7.	Fixing, M6 x 20 mm	2 off
4.	Riser	2 off			

Parts Supplied: A9630201, A9630253, A9630556, A9630662

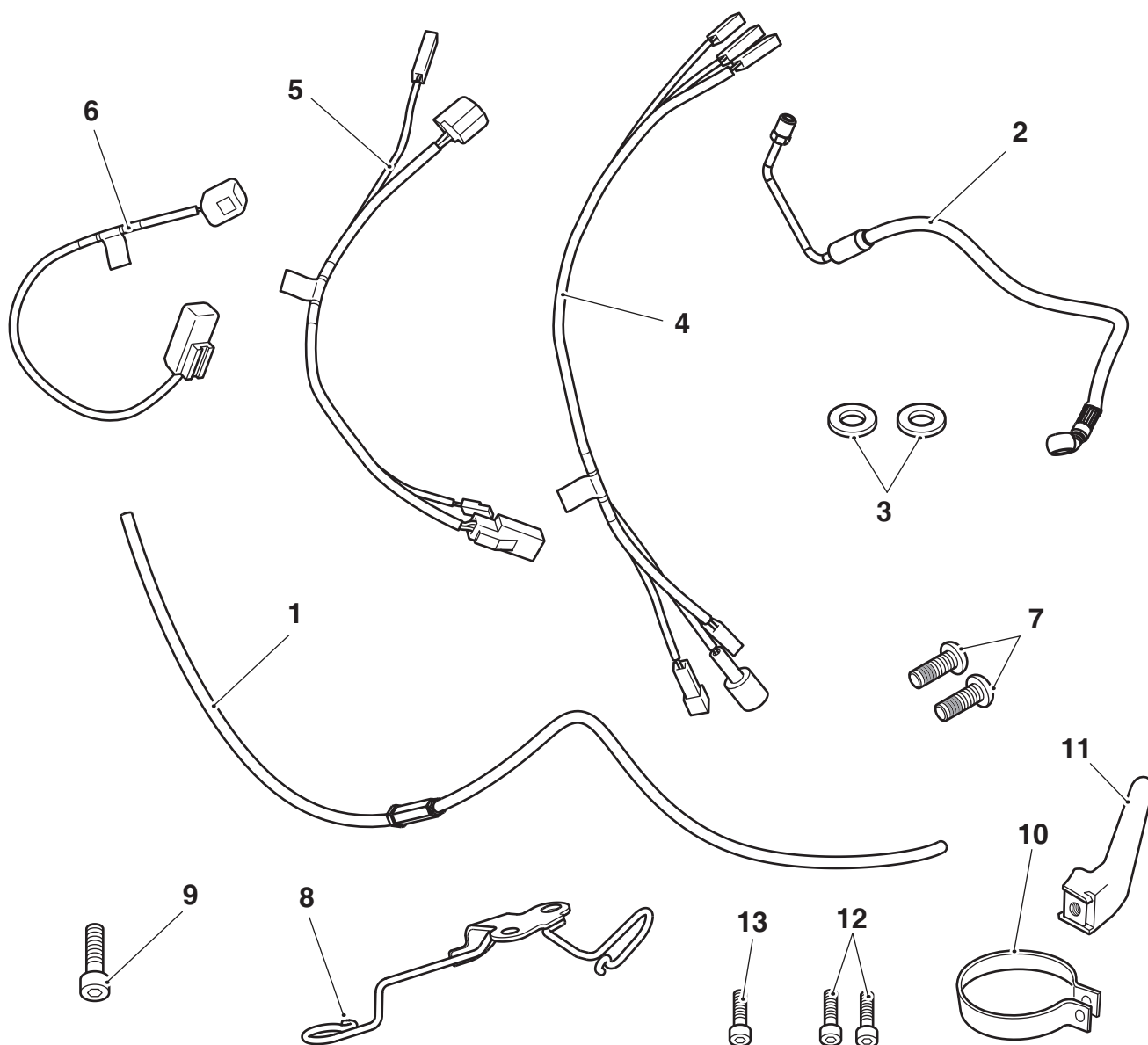

1.	Clutch cable	1 off	8.	Cable guide (not supplied in all kits)	1 off
2.	Brake hose	1 off	9.	Fixing, M6 x 16 mm encapsulated (not supplied in all kits)	1 off
3.	Sealing washer (brake hose)	2 off	10.	Cable guide clamp (A9630556 only)	1 off
4.	Extension harness, left hand	1 off	11.	Cable guide (A9630556 only)	1 off
5.	Extension harness, right hand	1 off	12.	Fixing, M5 x 10 mm (A9630556 only)	2 off
6.	Extension harness, twist grip position sensor	1 off	13.	Fixing, M5 x 10 mm (A9630662 only)	1 off
7.	Fixing, M5 x 12 mm	2 off			

 **Warning**

Fit only genuine Triumph accessories to those models approved by Triumph as listed in the associated Triumph fitting instructions. The accessory kits covered in this instruction are designed for use on specific models of Triumph motorcycle. The accessory kits and the models applicable are listed at the start of the instruction. They should never be fitted to any other Triumph model or to any other manufacturer's motorcycle. Fitting an accessory kit to a Triumph model not listed, or to any other manufacturer's motorcycle will affect the performance, stability and handling of the motorcycle. This may affect the rider's ability to control the motorcycle and could result in an accident causing severe injuries or death.

 **Warning**

Always have Triumph approved parts, accessories and conversions fitted by a trained technician of an authorised Triumph dealer. The fitment of parts, accessories and conversions by a technician who is not of an authorised Triumph dealer may affect the handling, stability or other aspects of the motorcycle's operation which may result in loss of motorcycle control and an accident.

 **Warning**

Make sure the motorcycle is supported. A correctly supported motorcycle will help prevent it from falling. An unstable motorcycle may fall, causing injury to the operator or damage to the motorcycle.

 **Warning**

A torque wrench of known accurate calibration must be used when fitting this accessory kit. Failure to tighten any of the fasteners to the correct torque specification may affect motorcycle performance, handling and stability. This may result in loss of motorcycle control and an accident.

**Note:**

- **Triumph offers a broad range of approved genuine accessories for your motorcycle. We cannot therefore cover all possible equipment variations in these instructions. For removal and installation of Triumph Genuine Accessories, always refer to the instructions supplied with the respective accessory kit. To obtain additional copies of any Triumph accessory instructions, visit [www.triumphinstructions.com](http://www.triumphinstructions.com) or contact your authorised Triumph dealer.**

**Notice**

Many States prohibit the fitment of high handlebars to any motorcycle.

Many states limit the height of motorcycle handlebars.

You must check your local laws before fitment of any high handlebars.

Never fit high handlebars to any motorcycle registered in any state that prohibits high handlebars.

Never fit handlebars that exceed the height limits in any state that permits high handlebars.

1. Disconnect the battery, negative (black) lead first.
2. Remove the fuel tank, as described in the Service Manual.

 **Caution**

To prevent damage, make sure that any displaced brake fluid does not come into contact with any part of the bodywork.

3. Drain the brake fluid from the front master cylinder. Attach a tube to the right hand brake caliper bleed nipple. Release the bleed nipple and allow the brake fluid to drain into a suitable container. Pull and release the brake lever until all fluid has been expelled from the master cylinder.
4. Remove the front brake hose front union bolt from the master cylinder, placing a cloth under the hose connection to absorb any remaining fluid which may be displaced. Retain the union bolt for reuse, discard the two sealing washers.
5. Remove the front brake hose noting its routing. Retain the brake hose for reuse if the motorcycle is to be returned to its original condition.

- Remove the harness guide from the left hand side of the motorcycle headstock. Retain the harness guide for reuse. Discard the fixings.

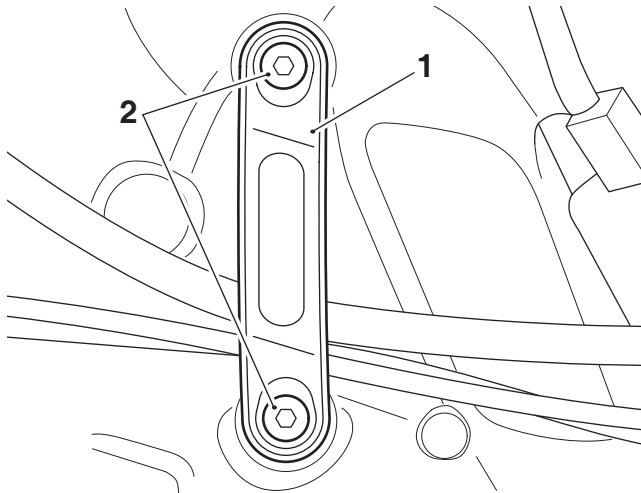

- Harness guide
- Fixings

- Remove the clutch cable, as described in the Service Manual. Retain the clutch cable for reuse if the motorcycle is to be returned to its original condition.

**Bonneville Speedmaster from VIN 739143 up to VIN AE2305 without instrument embellisher Only**

- Remove the clutch cable protective clip from the clutch cable. Retain the clutch cable protective clip for reuse.

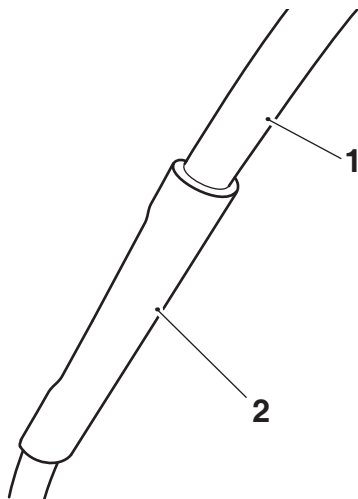

- Clutch cable
- Clutch cable protective clip

**All Models**

- Remove the bar end finishers as described in the Service Manual.
- Remove the handlebar clamp and fixings. Retain the handlebar clamp and fixings for reuse.

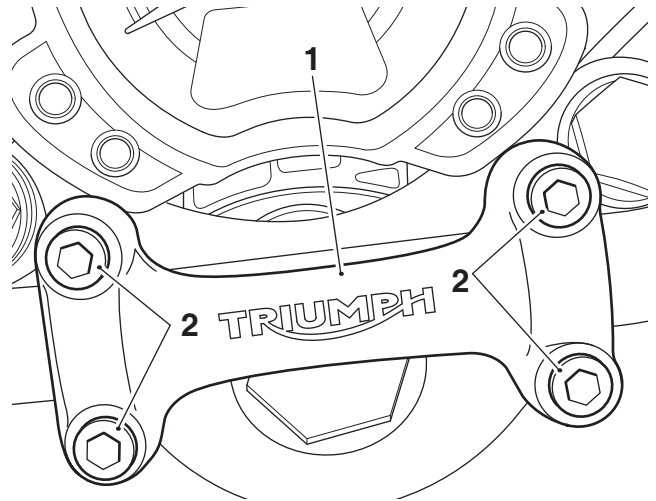

- Handlebar clamp
- Fixings

- Remove the following components from the handlebars, as described in the Service Manual. Make sure all parts are suitably supported and do not damage the motorcycle.
  - Clutch lever assembly.
  - Brake lever, master cylinder.
  - Indicator harness rubber strap.
  - Left hand and right hand switch housings.
  - Left hand and right hand handlebar grips.
  - Twist grip position sensor.
  - Mirrors.
- Remove the handlebars from the risers. Retain the handlebars for reuse if the motorcycle is to be returned to its original condition.

13. Remove the risers. Retain the risers for reuse if the motorcycle is to be returned to its original condition. Retain the fixings and washers for reuse.

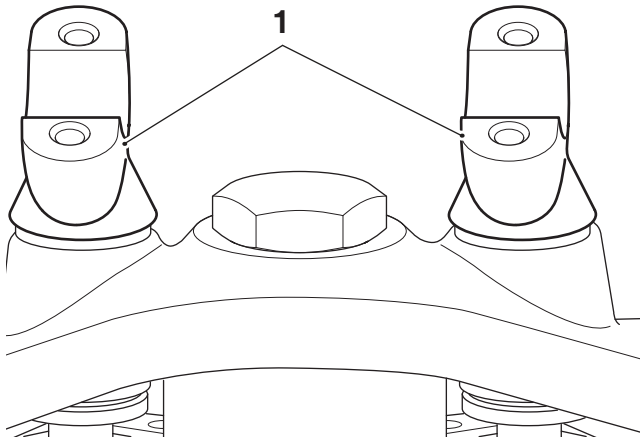

1. Risers



### Warning

The original riser mounting rubber bushes and spacers in the upper yoke must be replaced with the new rubber bushes and flanged sleeves provided in the high handlebar kit. If the original rubber bushes and spacers are not replaced with the new rubber bushes and flanged sleeves from the kit it may result in loss of motorcycle control and an accident.

14. Remove the four rubber bushes and spacers from the riser mountings in the upper yoke. Retain the original rubber bushes and spacers for reuse if the motorcycle is to be returned to its original condition.

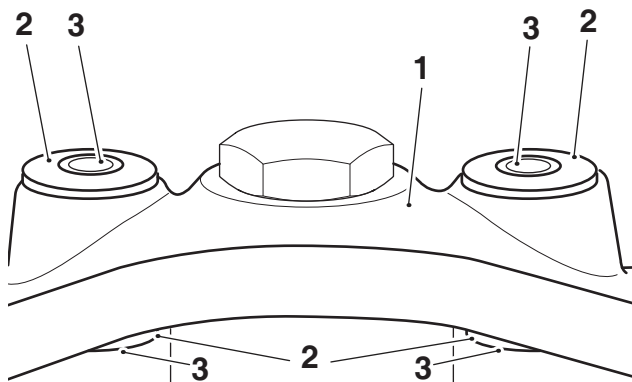

1. Upper yoke  
2. Rubber bush  
3. Spacer

15. Fit the new rubber bushes and flanged sleeves provided in the high handlebar kit into the riser mountings in the upper yoke, in the orientation shown below.

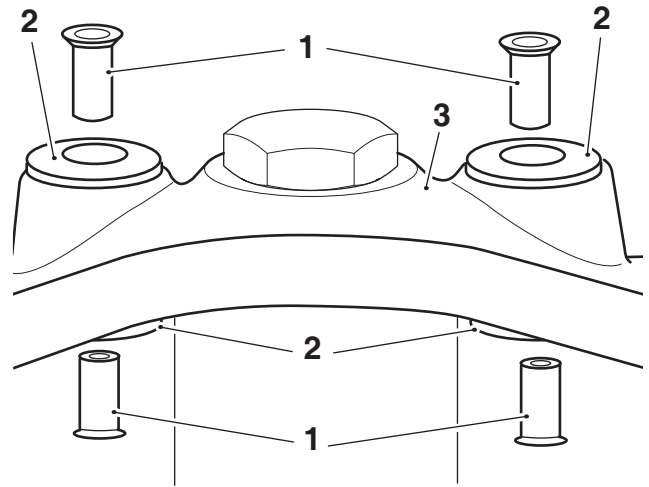

1. Flanged sleeves  
2. Rubber bushes  
3. Upper yoke

16. Fit the risers provided in the high handlebar kit with the original washers and fixings. Do not fully tighten the fixings at this stage.
17. Fit the following components to the high handlebars as described in the Service Manual
- Left hand and right hand switch housings.
  - Clutch lever assembly.
  - Brake lever, master cylinder.
  - Twist grip position sensor.
  - Left hand and right hand handlebar grips.
  - Mirrors.
18. Remove the snap on wiring harness cover from the left hand side of the motorcycle. Retain the harness cover for reuse.

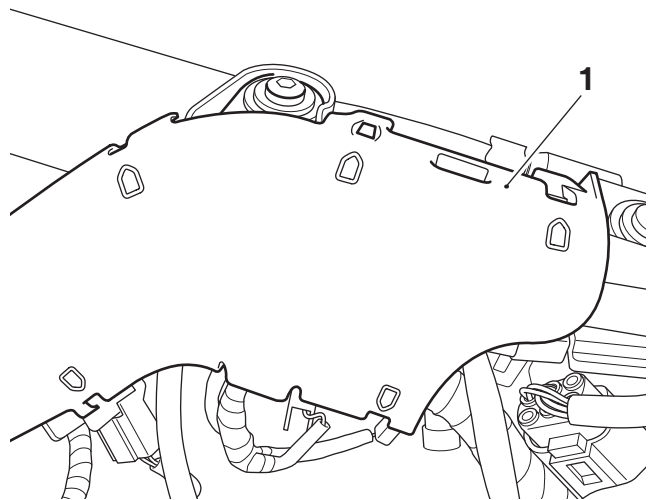

1. Wiring harness cover

19. Disconnect the left and right hand switch housing and twist grip position sensor harness connectors from the main wiring harness, as shown below. If the motorcycle does not have daytime running lights leave the blanking plug in place.

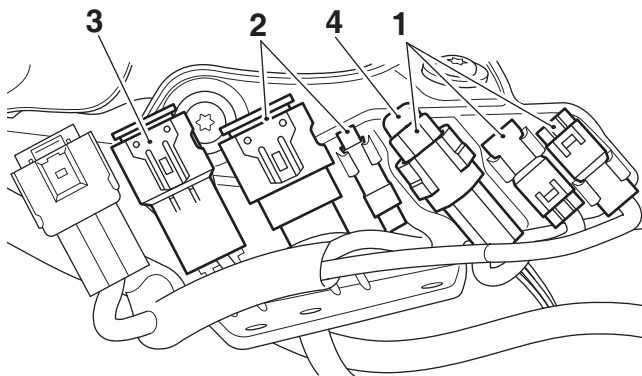

1. Left hand switch housing harness connectors
2. Right hand switch housing harness connectors
3. Twist grip position sensor harness connector
4. Blanking plug

20. Pull the switch housing and twist grip position sensor harnesses towards the front of the motorcycle. Note the routing of the harnesses through the gaps in the headstock.
21. Position the high handlebar assembly centrally on to the risers. The handlebars should be positioned in the risers such that the pins in the risers are inserted into the holes in the handlebars. Fit the handlebar clamp on to the risers and secure with the original fixings. Do not fully tighten the fixings at this stage.

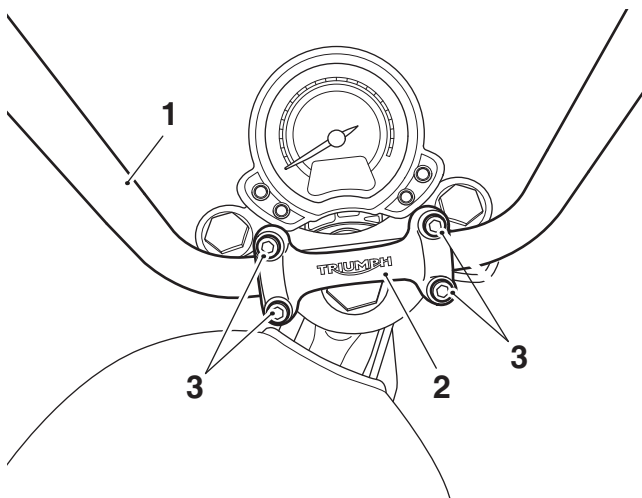

1. Handlebar
2. Handlebar clamp
3. Fixings

22. Tighten the riser to upper yoke fixings to **38 Nm**.

23. First tighten the front handlebar clamp fixings to **24 Nm**, then tighten the rear fixings to **24 Nm**.

**Note:**

- **When fitting the left hand switch harness extension the black harness connector must be positioned towards the front of the motorcycle.**

24. Connect the left hand, right hand and twist grip position sensor harness extensions from the kit to the switch housing and twist grip position sensor harness connectors and the main wiring harness connectors as shown below. If the motorcycle does not have daytime running lights leave the blanking plug in place.

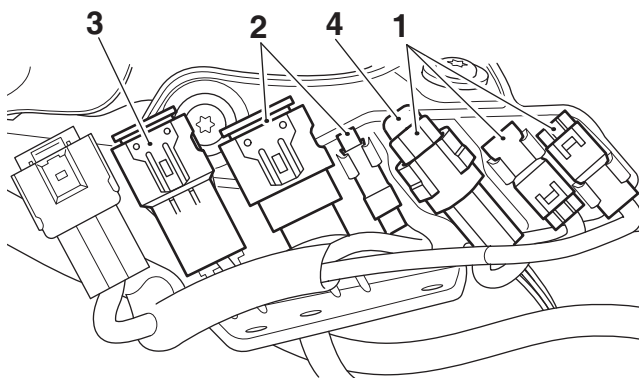

1. Left hand switch housing extension harness connectors
2. Right hand switch housing extension harness connectors
3. Twist grip position sensor extension harness connector
4. Blanking plug

25. Route the extension harnesses towards the front of the motorcycle following the routing of the switch housing and twist grip position sensor harnesses, as previously noted.

 <b>Caution</b>
A wiring harness which becomes trapped or kinked during installation, or general motorcycle operation, may result in wiring harness damage and electrical malfunctions.

26. Refit the snap on wiring harness cover making sure the wiring harness cover does not trap any wiring harness.
27. Fit the new front brake hose, as noted for removal, with the sealing washers provided in the kit and original union bolt. Adjust the position of the brake hose until the brake hose front union sits against the stop face on the master cylinder.

28. Tighten the front brake hose front union bolt to **25 Nm**. Tighten the front brake hose rear union fixing to **15 Nm**.
29. Fit the 17 mm diameter plastic cap from the high handlebar kit to the front brake hose front union bolt.

**Bonneville Bobber, Bonneville Bobber Black Models Only**

**Note:**

- If the cable kit contains a cable guide follow steps 30 to 35, then continue from step 56.
- If the cable kit does not contain a cable guide follow steps 34 and 35 then continue from step 56.

30. Remove the clutch cable guide from the left hand fork leg. Retain the cable guide for reuse if the motorcycle is to be returned to its original condition.
31. Remove the harness guide from the underside of the upper yoke on the left hand side. Retain the harness guide for reuse if the motorcycle is to be returned to its original condition. Retain the longer fixing for reuse, discard the shorter fixing.

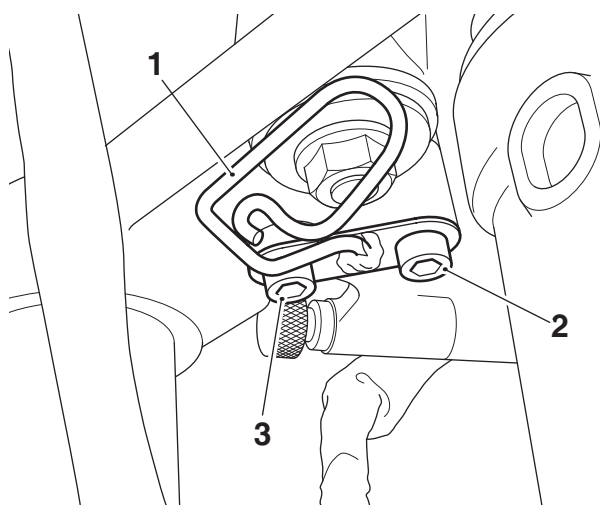

1. Harness guide
2. Longer fixing
3. Shorter fixing

32. Fit the cable guide provided in the cable kit in the orientation shown. Fit the original longer fixing and M6 x 16 mm encapsulated fixing provided in the kit in the positions shown. Tighten the fixings to **6 Nm**.

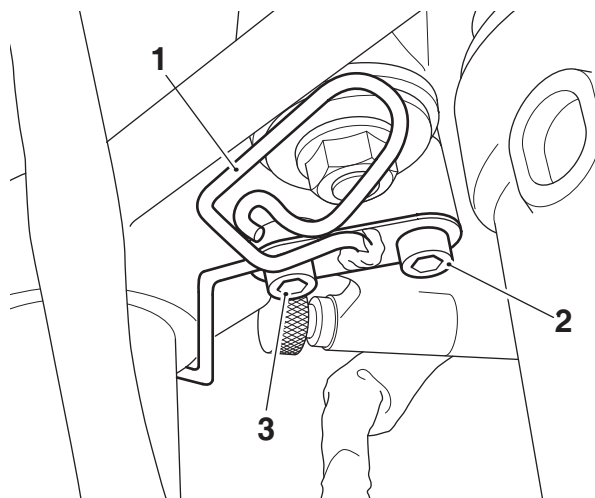

1. Cable guide
2. Longer fixing
3. Fixing, M6 x 16 mm

33. Fit the clutch cable into the cable guide, as shown.

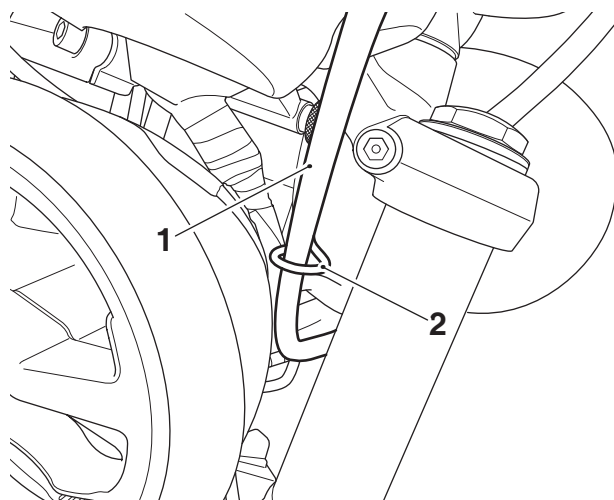

1. Clutch cable
2. Cable guide

34. Fit the clutch cable provided in the kit, as described in the Service Manual.
35. Following the original routing of the left hand switch housing harness through the headstock, as previously noted, fit the switch housing harness into the cable guide.



**Bonneville Speedmaster from VIN 739143 up to VIN AE2305 without instrument embellisher Models Only**

36. Fit the clutch cable provided in the kit, as described in the Service Manual.
37. Fit the cable guide clamp and cable guide provided in the kit to the right hand fork leg in the orientation shown. Fit an M5 x 10 mm fixing, provided, do not fully tighten the fixing at this stage.

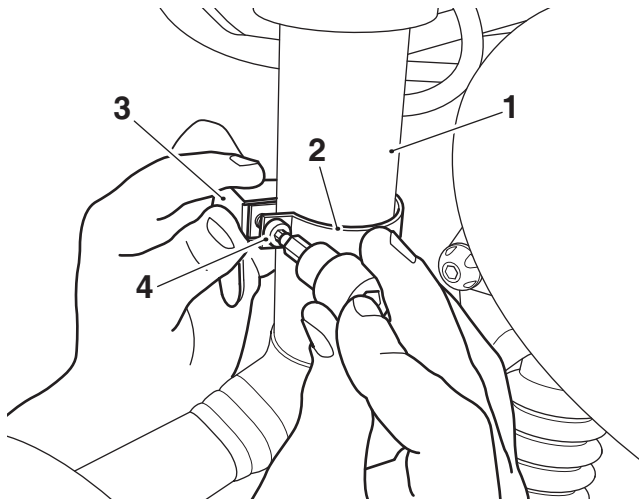

1. Fork leg, right hand
2. Cable guide clamp
3. Cable guide
4. Fixing, M5 x 10 mm

38. Position the cable guide at the underside of the top yoke, with the front edge of the guide aligned with the split line of the top yoke, as shown. Tighten the fixing to **3 Nm**.

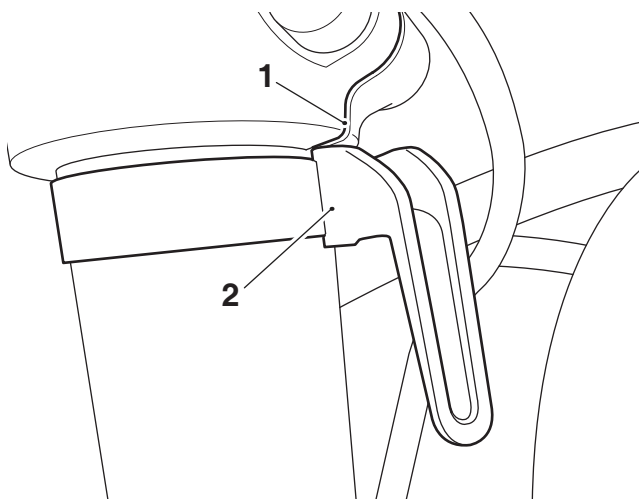

1. Split line, top yoke
2. Front edge, cable guide

39. Make sure the brake hose is clear of both the headlight bowl and instruments when located in the cable guide.

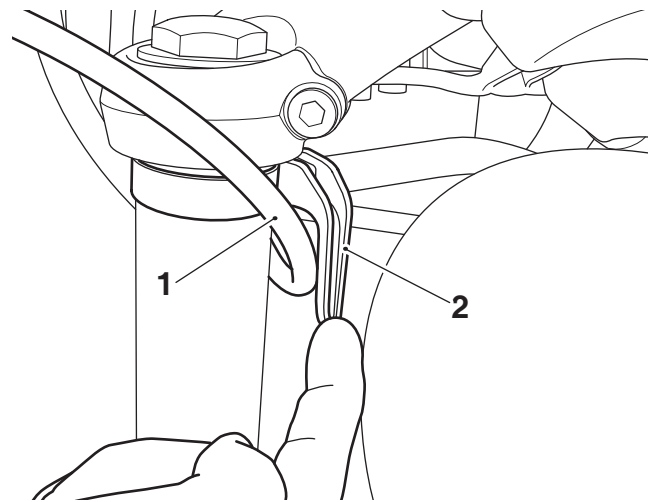

1. Brake hose
2. Cable guide

40. Remove the original fixing from the cable guide on the left hand fork leg and fit an M5 x 10 mm fixing provided in the kit. Do not fully tighten the fixing at this stage. Lower the cable guide on the fork leg.

41. Cut a piece of masking tape approximately 45 mm long. Draw a vertical datum line across the tape as shown. Measure 30 mm from the datum line and draw a parallel line, which will be used for the cable clip alignment, as shown.

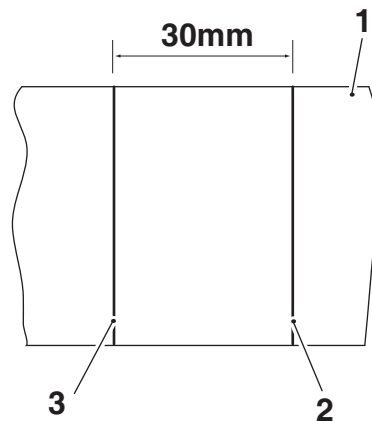

1. Masking tape
2. Datum line
3. Parallel alignment line

42. Keeping the top edge of the masking tape in line with the underside of the top yoke, align the datum line on the masking tape with the split line of the top yoke. Wrap the masking tape around the fork leg as shown.

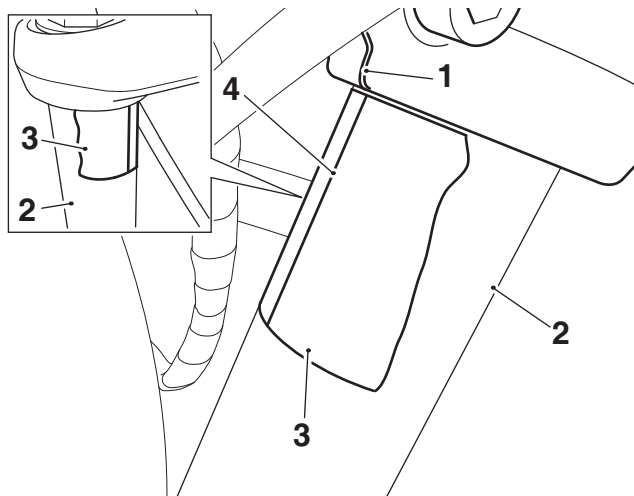

- 1. Split line, top yoke
- 2. Fork leg
- 3. Masking tape
- 4. Datum line

43. Position the clutch cable guide with the top edge of the guide clamp 55 mm from the underside of the top yoke as shown. Rotate the clutch cable guide until the split line in the guide clamp is aligned with the parallel alignment line drawn on the masking tape as shown. Tighten the fixing to **3 Nm**.

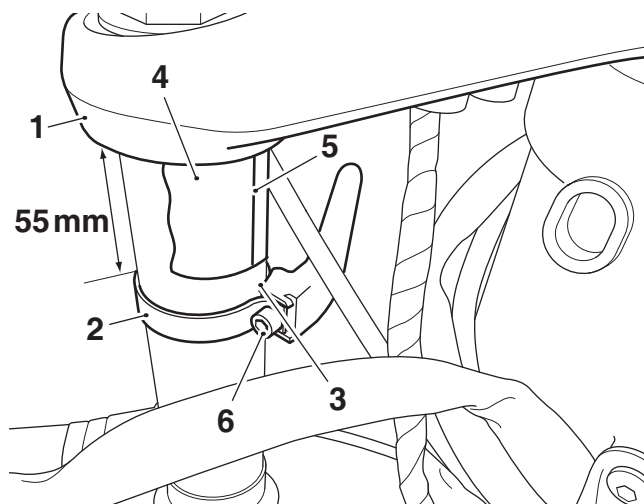

- 1. Top yoke
- 2. Clutch cable guide clamp
- 3. Split line, clutch cable guide clamp
- 4. Masking tape
- 5. Parallel alignment line
- 6. Fixing

44. Remove the masking tape.

45. Make sure the clutch cable is clear of both the headlight bowl and instruments when it is fitted to the repositioned cable guide.

46. Fit the original clutch cable protective clip to the clutch cable making sure it remains in contact with the cable guide when the handlebars are turned from left hand to right hand full lock positions.

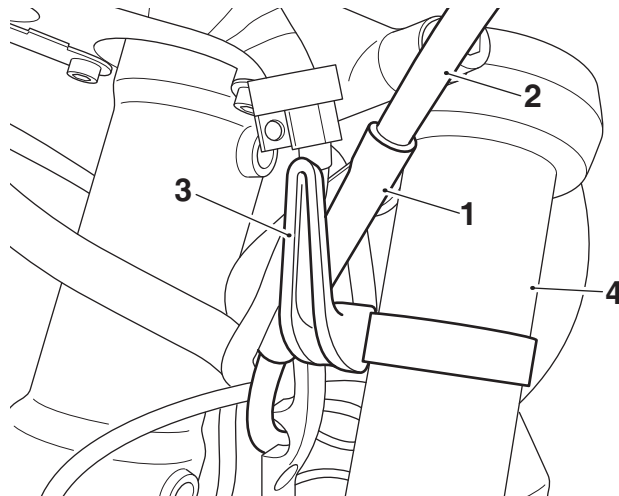

- 1. Clutch cable protective clip
- 2. Clutch cable
- 3. Cable guide
- 4. Fork leg

**Bonneville Speedmaster from VIN AC1201 with instrument embellisher Models Only**

47. Remove the clutch cable guide clamp and cable guide from the left hand fork leg. Retain the cable guide clamp and cable guide for reuse, discard the fixing.

48. Remove the harness guide from the underside of the upper yoke on the left hand side. Retain the harness guide for reuse if the motorcycle is to be returned to its original condition. Retain the longer fixing for reuse, discard the shorter fixing.

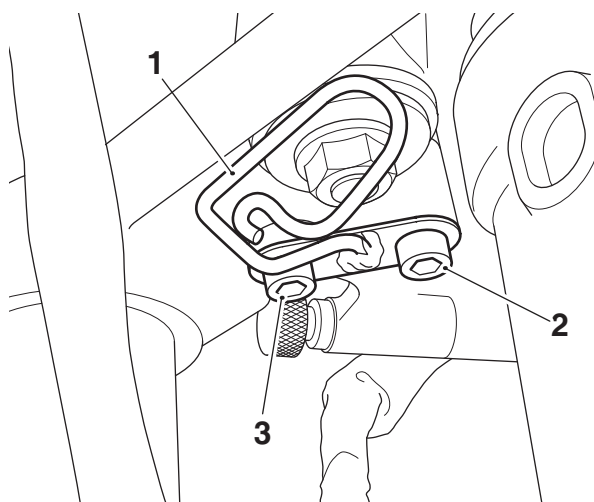

- 1. Harness guide
- 2. Longer fixing
- 3. Shorter fixing

49. Fit the cable guide provided in the cable kit in the orientation shown. Fit the original longer fixing and M6 x 16 mm encapsulated fixing provided in the kit in the positions shown. Tighten the fixings to **6 Nm**.

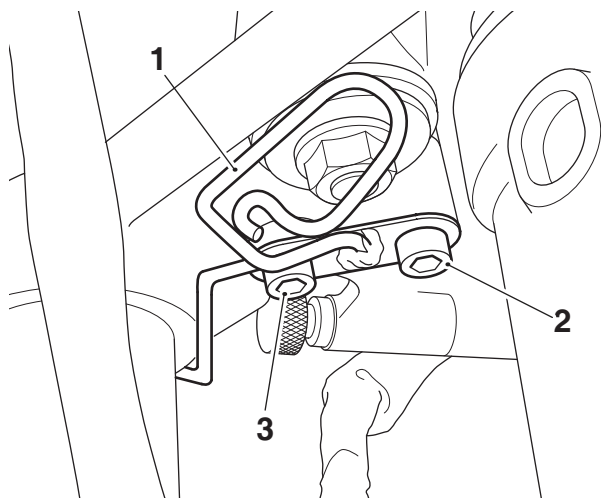

- 1. Cable guide
- 2. Longer fixing
- 3. Fixing, M6 x 16 mm

50. Fit the clutch cable into the cable guide, as shown.

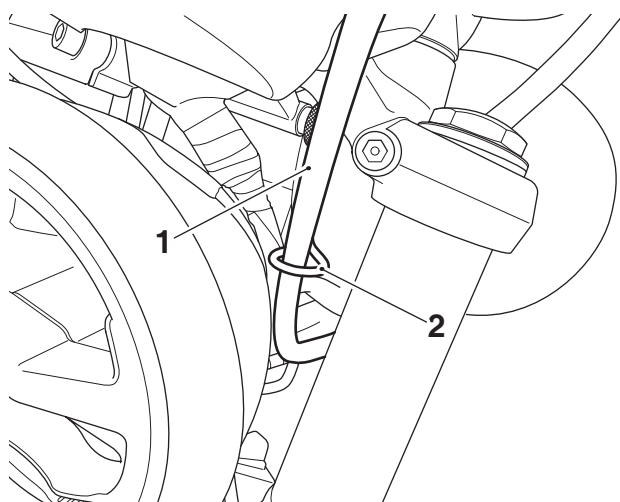

- 1. Clutch cable
- 2. Cable guide

51. Fit the clutch cable provided in the kit, as described in the Service Manual.

52. Following the original routing of the left hand switch housing harness through the headstock, as previously noted, fit the switch housing harness into the cable guide.

53. Fit the cable guide clamp and cable guide that were removed from the left hand fork leg onto the right hand fork leg in the orientation shown. Fit the M5 x 10 mm fixing provided, do not fully tighten the fixing at this stage.

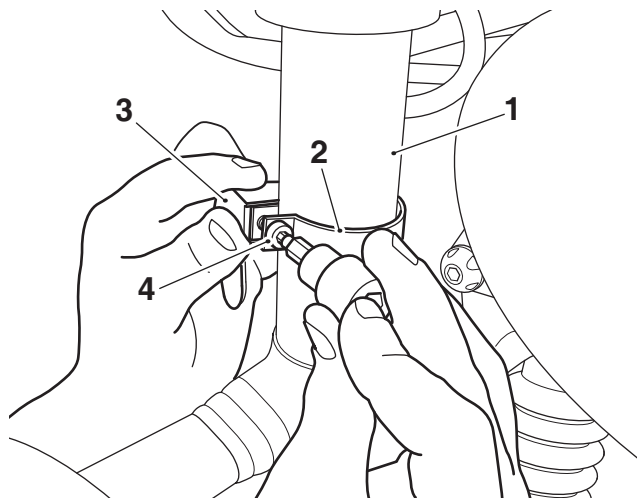

- 1. Fork leg, right hand
- 2. Cable guide clamp
- 3. Cable guide
- 4. Fixing, M5 x 10 mm

54. Position the cable guide clamp 12 mm from the underside of the top yoke, with the front edge of the cable guide aligned with the split line of the top yoke, as shown. Tighten the fixing to **3 Nm**.

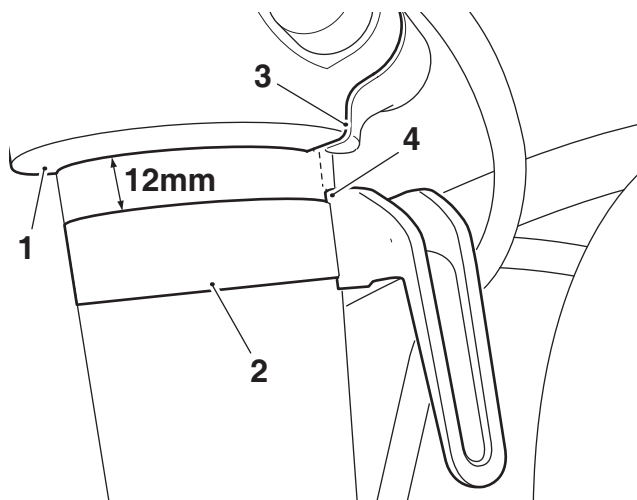

- 1. Top yoke
- 2. Cable guide clamp
- 3. Split line, top yoke
- 4. Front edge, cable guide

55. Make sure the brake hose is clear of both the headlight bowl and instruments when located in the cable guide.

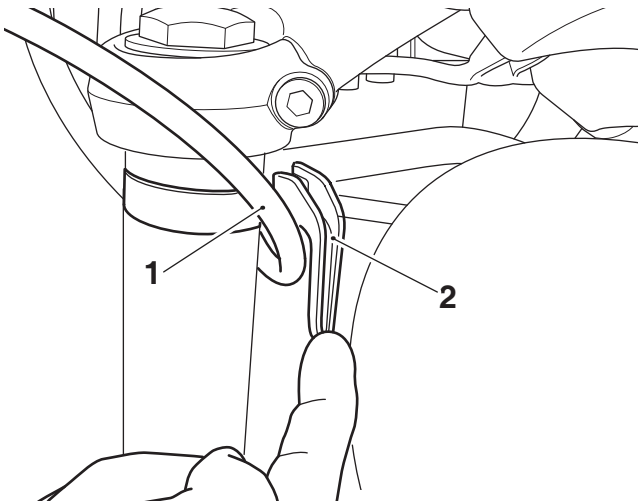

1. Brake hose  
2. Cable guide

#### All Models

56. Refit the harness guide on the left hand side of the motorcycle making sure the clutch cable is positioned at the bottom of the harness guide, as shown. Fit the M5 x 12 mm fixings provided in the kit. Tighten the fixings to **2.5 Nm**.

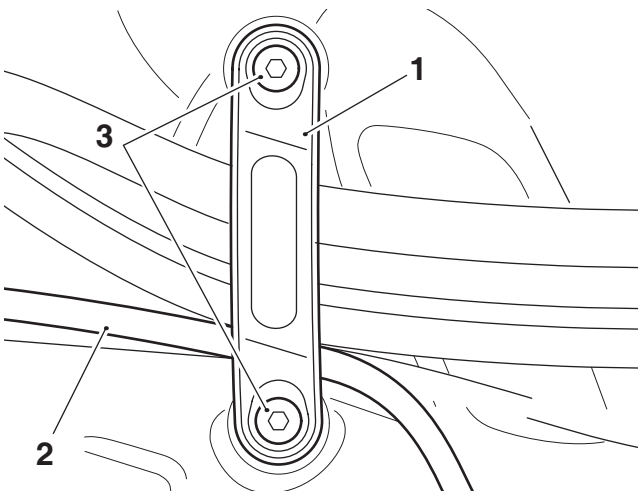

1. Harness guide  
2. Clutch cable  
3. Fixings, M5 x 12 mm

57. Making sure the left hand and right hand switch harnesses run down the front of the handlebars, secure the harnesses to the handlebars with the four original rubber straps, as shown.

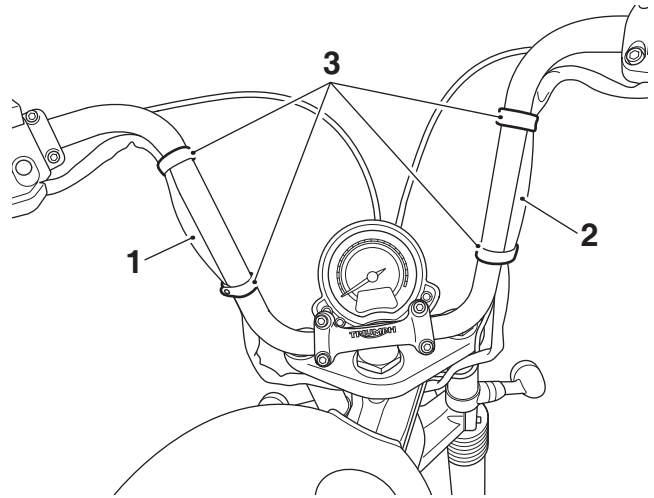

1. Switch harness, left hand  
2. Switch harness, right hand  
3. Rubber strap

58. Position the harness connectors and any excess harness tidily into the recess behind the headstock as shown.

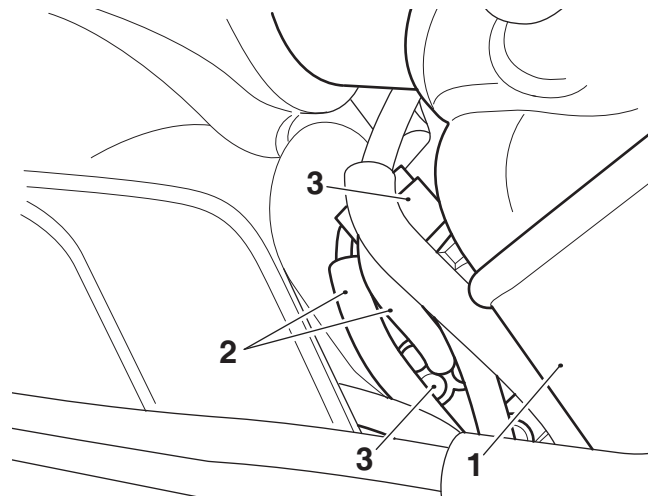

1. Headstock  
2. Harnesses  
3. Harness connectors

59. Refit the rubber strap to secure the indicator harnesses to the clutch cable.  
60. Refit the bar end finishers using the M6 x 20 mm fixings provided in the kit. Tighten the fixings to **5 Nm**.

**Warning**

Use only DOT 4 specification brake fluid as specified in the Service Manual. The use of brake fluids other than those DOT 4 fluids listed in the Service Manual may reduce the efficiency of the braking system and may result in loss of motorcycle control and an accident.

**Warning**

Make sure of absolute cleanliness when adding brake fluid to the brake fluid reservoir. Do not allow moisture or debris to enter the cylinder as this will adversely affect the fluid properties. Always use fluid from a sealed container and do not use fluid from a container which has been opened for any period of time. Always check for fluid leakage around hydraulic fittings and for damage to hoses. A dangerous riding condition leading to an accident could result if this warning is ignored.

61. Fill the brake fluid reservoir with new DOT 4 brake fluid and bleed the front brakes, as described in the Service Manual.
62. To inspect the brake fluid level, check the level of fluid visible in the window on the brake fluid reservoir.
63. Examine the brake system for correct operation and fluid leaks. Rectify as necessary.

**Warning**

It is dangerous to operate the motorcycle with defective brakes; you must have your authorised Triumph dealer take remedial action before you ride the motorcycle again. Failure to take remedial action may result in reduced braking efficiency which may result in loss of motorcycle control and an accident.

64. Reconnect the battery, positive (red) lead first and tighten the battery terminals to **4.5 Nm**.
65. Test the direction indicators, rear light, headlight and all other switch gear functions to confirm they function correctly.
66. Refit the fuel tank, as described in the Service Manual.

67. Fit the 14 mm diameter plastic caps from the high handlebar kit to the clutch lever pivot pin retaining nut and front brake lever pivot pin retaining nut.

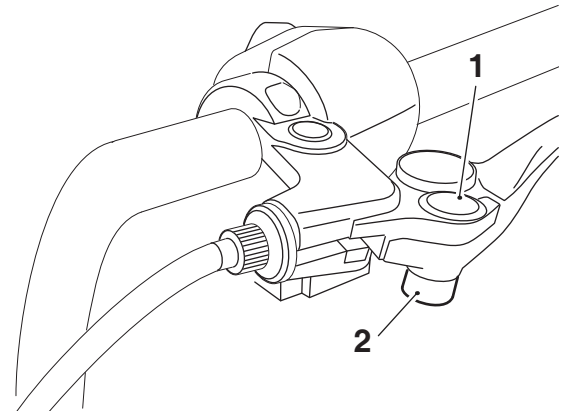

1. Pivot pin, clutch lever shown
2. Plastic cap, 14 mm diameter

68. Adjust any mirrors fitted to the correct position.

**Warning**

Move the handlebars to left and right full lock while checking that handlebars do not contact the fuel tank or restrict the steering. Any restriction in steering may result in loss of motorcycle control and an accident.

**Warning**

Move the handlebars to left and right full lock while checking that cables and harnesses do not bind. Cables or harnesses that bind will restrict the steering and may result in loss of motorcycle control and an accident.

**Warning**

If, after fitting this accessory kit, you have any doubt about the performance of any aspect of the motorcycle, contact an authorised Triumph dealer and do not ride the motorcycle until the authorised dealer has declared it fit for use. Riding a motorcycle when there is any doubt as to any aspect of the performance of the motorcycle may result in loss of motorcycle control and an accident.



### Warning

Never ride an accessory-equipped motorcycle at speeds above 80 mph (130 km/h).

The presence of accessories will cause changes in the stability and handling of the motorcycle. Failure to allow for changes in motorcycle stability may result in loss of motorcycle control and an accident.

Remember that the 80 mph (130 km/h) limit will be reduced by the fitting of non-approved accessories, incorrect loading, worn tyres, overall motorcycle condition and poor road or weather conditions.



### Warning

The motorcycle must not be operated above the legal road speed limit except in closed-course conditions.



### Warning

Only operate this Triumph motorcycle at high speed in closed-course, on-road competition or on closed-course racetracks. High-speed operation should only be attempted by riders who have been instructed in the techniques necessary for high-speed riding and are familiar with the motorcycle's characteristics in all conditions.

High-speed operation in any other circumstances is dangerous and may result in loss of motorcycle control and an accident.