



Accessory Fitting Instructions

Thank you for choosing this Triumph genuine accessory kit. This accessory kit is the product of Triumph's use of proven engineering, exhaustive testing, and continuous striving for superior reliability, safety and performance.

Completely read all of these instructions before commencing the installation of the accessory kit in order to become thoroughly familiar with the kit's features and the installation process.

These instructions should be considered a permanent part of your accessory kit, and should remain with it even if your accessory equipped motorcycle is subsequently sold.

Air Filter Cover Kits	
Air Filter Dust Cover	
Kit Number	Models
A9610139	TF250-X
Air Filter Rain Cover	
Kit Number	Models
A9610140	TF250-X
Air Filter Sand Cover	
Kit Number	Models
A9610141	TF250-X

Parts supplied

A9610139

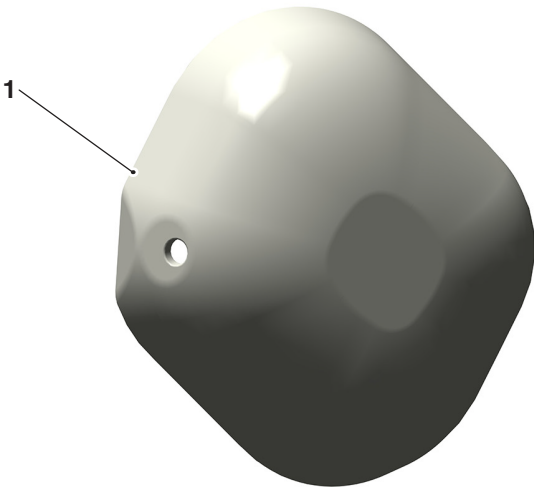

1. Air filter dust cover	1 off
--------------------------	-------

A9610140

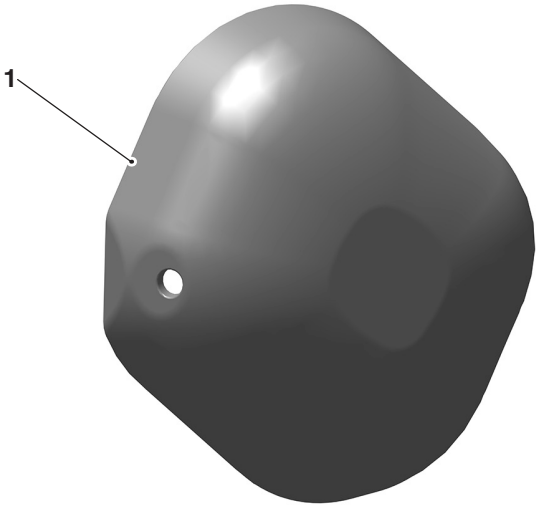

1. Air filter rain cover	1 off
--------------------------	-------

A9610141

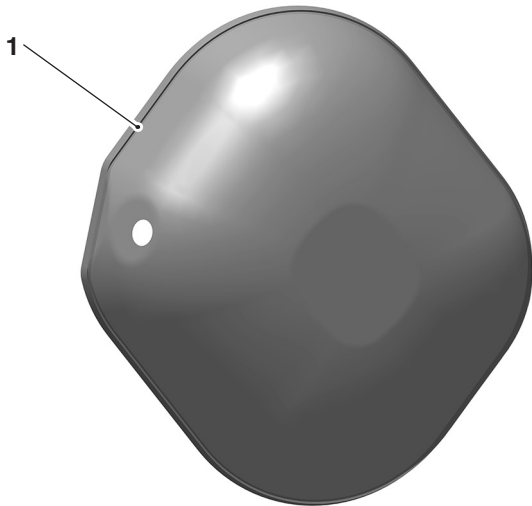

1. Air filter sand cover	1 off
--------------------------	-------

⚠ WARNING

Fit only genuine Triumph accessories to those models approved by Triumph as listed in the associated Triumph fitting instructions.

The accessory kits covered in this instruction are designed for use on specific models of Triumph motorcycle. The accessory kits and the models applicable are listed at the start of the instruction. They should never be fitted to any other Triumph model or to any other manufacturer's motorcycle.

Fitting an accessory kit to a Triumph model not listed, or to any other manufacturer's motorcycle, will affect the performance, stability and handling of the motorcycle.

Failure to follow the advice above may lead to loss of motorcycle control which could result in serious injury or death.

⚠ WARNING

Always have Triumph approved parts, accessories and conversions fitted by a competent person with the specialist knowledge and technical understanding of motorcycles, such as an authorised Triumph dealer.

The fitment of parts, accessories and conversions by a person without the specialist knowledge and technical understanding of motorcycles may affect the handling, stability or other aspects of the motorcycle's operation.

Failure to follow the advice above may lead to loss of motorcycle control which could result in serious injury or death.

⚠ WARNING

A torque wrench of known accurate calibration must be used when fitting this accessory kit.

Failure to tighten any of the fasteners to the correct torque specification may affect motorcycle performance, handling and stability.

Failure to follow the advice above may lead to loss of motorcycle control which could result in serious injury or death.

⚠ WARNING

Make sure the motorcycle is stabilised and adequately supported.

Do not support the motorcycle on any ancillary component, the exhaust system or any other non structural parts of the motorcycle frame.

A correctly supported motorcycle will help prevent it from falling.

An unstable motorcycle may fall resulting in motorcycle damage, serious injury or death.

NOTICE

Triumph offers a broad range of approved genuine accessories for your motorcycle.

We cannot therefore cover all possible equipment variations in these instructions. For removal and installation of Triumph Genuine Accessories, always refer to the instructions supplied with the respective accessory kit.

To obtain additional copies of any Triumph accessory instructions, visit www.triumphinstructions.com or contact your authorised Triumph dealer.

NOTICE

The dust cover is used when riding in dusty environment.

For maximum benefit of the dust cover, soak it in an air filter oil, and when saturated squeeze out the excess oil until there is an even coating of oil on the dust cover.

To clean the dust cover refer to the cleaning procedure for the air filter in the Owner's Handbook.

NOTICE

The sand cover is used in sandy environment, and is recommended to be fitted over the dust cover.

Do not oil the sand cover.

To clean the sand cover, wash the sand cover in warm soapy water to remove the dirt particles. Then rinse in clear water.

Make sure the sand cover is completely dry before fitting it to the air filter.

NOTICE

The rain cover is used in wet environment.

Do not oil the rain cover.

To clean the rain cover, soak it in a proprietary foam air filter cleaner and Squeeze the rain cover to remove the dirt particles.

Wash the rain cover in warm soapy water to remove the filter cleaner. Then rinse in clear water.

Make sure the rain cover is completely dry before fitting it to the air filter.

NOTICE

Check the air filter cover before every race and, if required clean the air filter covers.

Make sure to use appropriate cleaning procedure for dust, sand and rain covers.

1. Remove the air filter cover panel as described in the Service Manual.
2. Detach the retaining strap from its spigot.

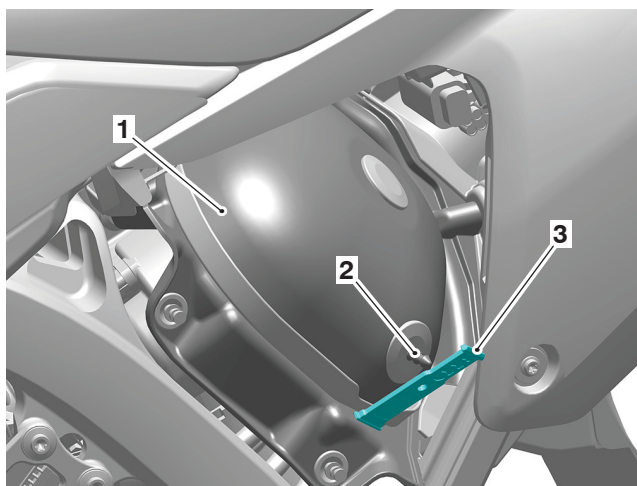

1. Air filter
2. Spigot
3. Retaining strap

3. Remove the air filter assembly.
4. Align the air filter cover over the original air filter.
5. Make sure that the arrow on the air filter cover is in the same orientation as the arrow marking on the air filter.

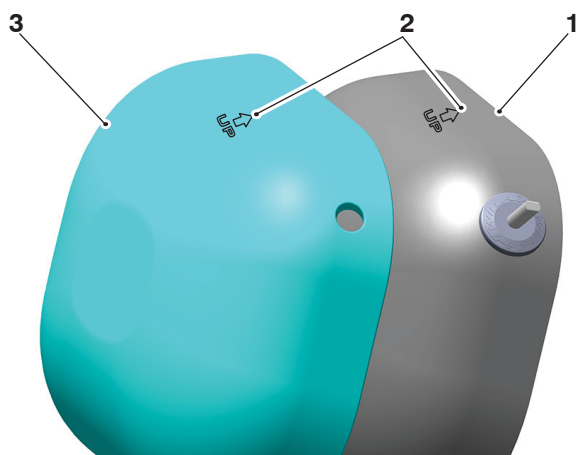

1. Air filter
2. Arrow markings
3. Air filter cover

6. Attach the air filter cover to the spigot.

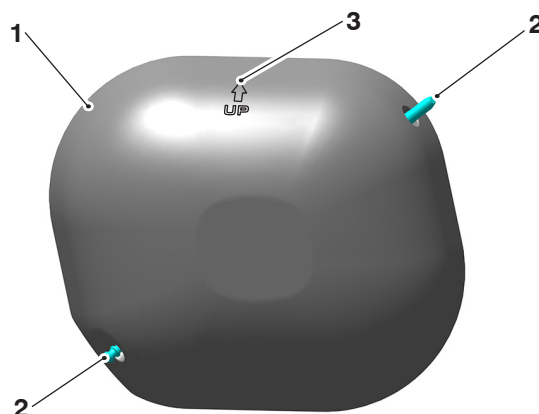

1. Air filter cover
2. Spigot
3. Arrow marking

7. Apply Twin Air specified air filter sealant to the sealing area of the air filter, as shown below.

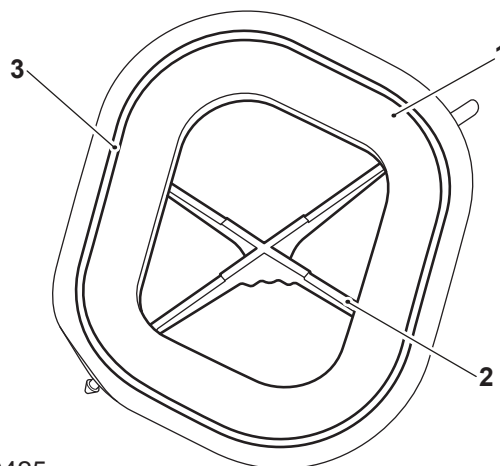

TP0425

1. Air filter
2. Filter cage
3. Sealing area

8. Position the air filter to the airbox with the arrow on the air filter cover pointing upwards.

9. Fit the air filter to the airbox. Make sure the spigot fits into the spigot housing.

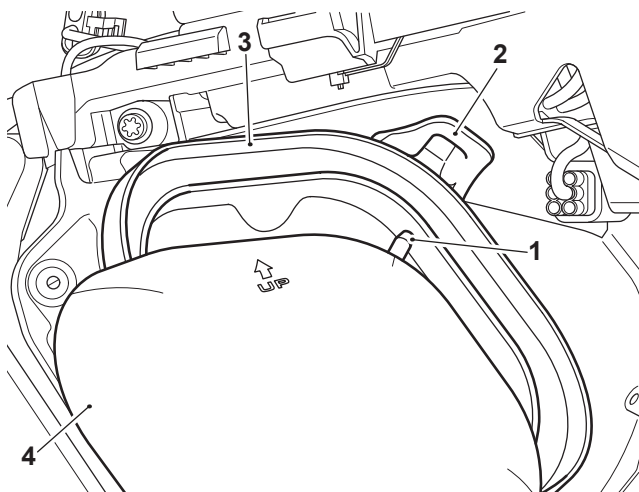

1. Spigot
2. Spigot housing
3. Airbox
4. Air filter cover

10. Make sure the air filter cover is inserted into the airbox.
11. Secure the air filter with its retaining strap secured to the spigot.

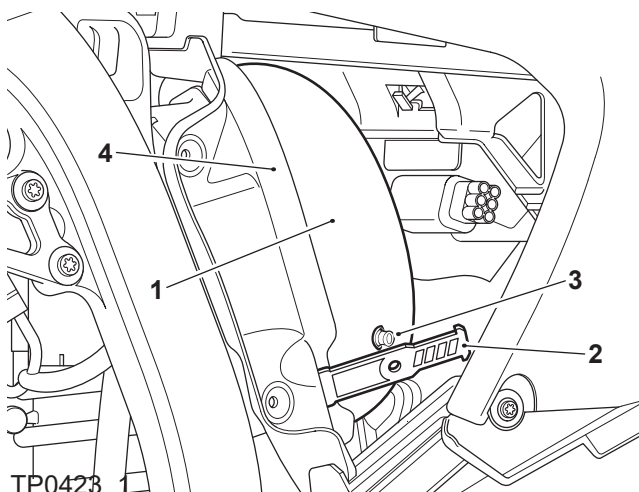

1. Air filter cover
2. Retaining strap
3. Spigot
4. Airbox

12. Refit the air filter panel as described in the Service Manual.

⚠ WARNING

After fitting the accessory kit the motorcycle will exhibit new handling characteristics.

Operate the motorcycle in a safe area free from traffic to gain familiarity with any new characteristics.

Operation of the motorcycle when not familiar with any new handling characteristics may lead to loss of motorcycle control which could result in serious injury or death.

⚠ WARNING

If, after fitting this accessory kit, you have any doubt about the performance of any aspect of the motorcycle, contact a competent person with the specialist knowledge and technical understanding of motorcycles, such as an authorised Triumph dealer.

Riding a motorcycle when there is any doubt as to any aspect of the performance of the motorcycle may lead to loss of motorcycle control which could result in serious injury or death.

⚠ WARNING

Never ride an accessory-equipped motorcycle at speeds above 80 mph (130 km/h).

Remember that the 80 mph (130 km/h) limit will be reduced by the fitting of non-approved accessories, incorrect loading, worn tyres, overall motorcycle condition and poor road or weather conditions.

The presence of accessories will cause changes in the stability and handling of the motorcycle. Failure to allow for changes in motorcycle stability may lead to loss of motorcycle control which could result in serious injury or death.

⚠ WARNING

High-speed operation should only be attempted by riders who have been instructed in the techniques necessary for high-speed riding and are familiar with the motorcycle's characteristics in all conditions.

Only operate this Triumph motorcycle at high speed in closed-course, on-road competition or on closed-course racetracks.

High-speed operation in any other circumstances is dangerous and may lead to loss of motorcycle control which could result in serious injury or death.

NOTICE

The motorcycle must not be operated above the legal road speed limit except in closed-course conditions.