



Accessory Fitting Instructions

Thank you for choosing this Triumph genuine accessory kit. This accessory kit is the product of Triumph's use of proven engineering, exhaustive testing, and continuous striving for superior reliability, safety and performance.

Completely read all of these instructions before commencing the installation of the accessory kit in order to become thoroughly familiar with the kit's features and the installation process.

These instructions should be considered a permanent part of your accessory kit, and should remain with it even if your accessory equipped motorcycle is subsequently sold.

Sports Pannier Kit	
Kit Number	Models
Sport Panniers, Pair	
A9510535, A9510694	Rocket 3 R, Rocket 3 GT, Rocket 3 TFC, Rocket 3 GT Triple Black, Rocket 3 R Black
A9510690, A9518569	Rocket 3 R, Rocket 3 R Storm, Rocket 3 GT, Rocket 3 GT Storm, Rocket 3 TFC, Rocket 3 GT Triple Black, Rocket 3 R Black
Pannier Rail Kit	
A9518172	Rocket 3 R, Rocket 3 R Storm, Rocket 3 GT, Rocket 3 GT Storm, Rocket 3 TFC, Rocket 3 GT Triple Black, Rocket 3 R Black

Parts supplied

A9510535, A9510694, A9510690, A9518569

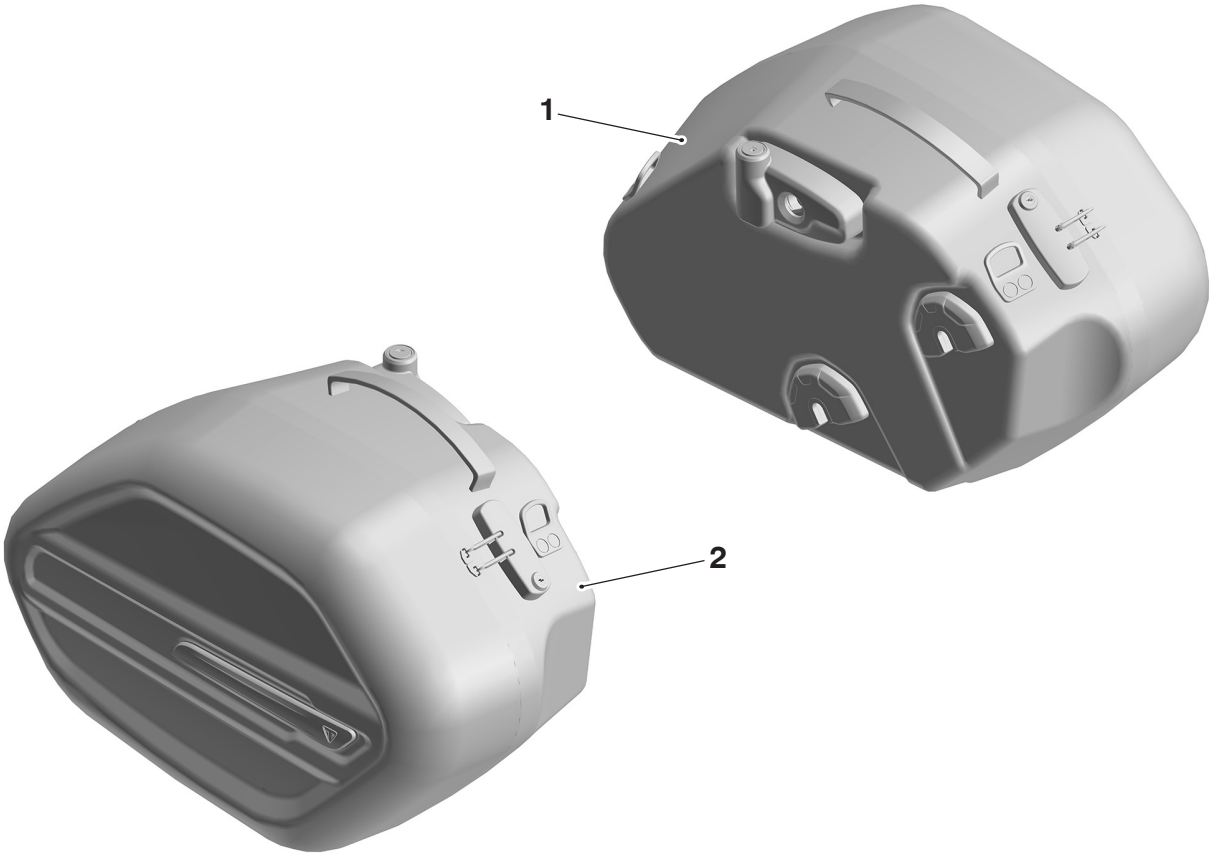

1. Pannier, left hand	1 off	2. Pannier, right hand	1 off
-----------------------	-------	------------------------	-------

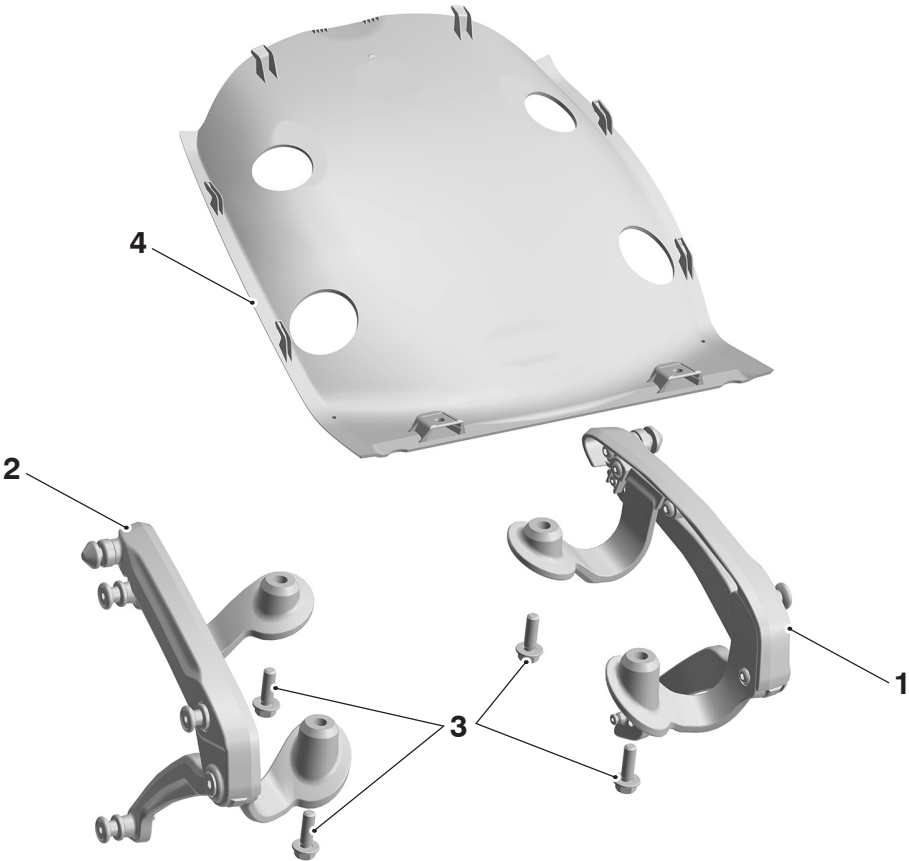

1. Pannier rail, left hand	1 off	3. Fixing M8 x 25 mm	4 off
2. Pannier rail, right hand	1 off	4. Rear mudguard undertray 1 off	1 off

⚠ WARNING

Fit only genuine Triumph accessories to those models approved by Triumph as listed in the associated Triumph fitting instructions.

The accessory kits covered in this instruction are designed for use on specific models of Triumph motorcycle. The accessory kits and the models applicable are listed at the start of the instruction. They should never be fitted to any other Triumph model or to any other manufacturer's motorcycle.

Fitting an accessory kit to a Triumph model not listed, or to any other manufacturer's motorcycle, will affect the performance, stability and handling of the motorcycle.

Failure to follow the advice above may lead to loss of motorcycle control which could result in serious injury or death.

⚠ WARNING

Always have Triumph approved parts, accessories and conversions fitted by a competent person with the specialist knowledge and technical understanding of motorcycles, such as an authorised Triumph dealer.

The fitment of parts, accessories and conversions by a person without the specialist knowledge and technical understanding of motorcycles may affect the handling, stability or other aspects of the motorcycle's operation.

Failure to follow the advice above may lead to loss of motorcycle control which could result in serious injury or death.

⚠ WARNING

A torque wrench of known accurate calibration must be used when fitting this accessory kit.

Failure to tighten any of the fasteners to the correct torque specification may affect motorcycle performance, handling and stability.

Failure to follow the advice above may lead to loss of motorcycle control which could result in serious injury or death.

⚠ WARNING

Make sure the motorcycle is stabilised and adequately supported.

Do not support the motorcycle on any ancillary component, the exhaust system or any other non structural parts of the motorcycle frame.

A correctly supported motorcycle will help prevent it from falling.

An unstable motorcycle may fall resulting in motorcycle damage, serious injury or death.

NOTICE

Triumph offers a broad range of approved genuine accessories for your motorcycle.

We cannot therefore cover all possible equipment variations in these instructions. For removal and installation of Triumph Genuine Accessories, always refer to the instructions supplied with the respective accessory kit.

To obtain additional copies of any Triumph accessory instructions, visit www.triumphinstructions.com or contact your authorised Triumph dealer.

Pannier Rail Installation

1. Remove the rider and passenger seats as described in the Service Manual.
2. Remove the rear mudguard undertray as described in the Service Manual. Retain the fixings for reuse. Retain the undertray for reuse if the motorcycle is to be returned to its original condition.
3. Collect the rear mudguard undertray from the kit and fit using the original fixings, as described in the Service Manual.



1. Rear mudguard undertray

NOTICE

A wiring harness which becomes trapped or kinked during installation, or motorcycle operation, may result in wiring harness damage and electrical malfunctions.

4. Look through the holes in the underside of the rear mudguard undertray and check if there are any wiring harnesses routed over the pannier rail mounting bosses on the motorcycle frame. If necessary move any harnesses to the side, clear of the mounting bosses, before fitting a pannier rail.

5. Fit the right hand pannier rail from the kit to the right hand side of the motorcycle in the orientation shown.
6. Position the pannier rail mountings through the access holes in the rear mudguard undertray. Fit two M8 x 25 mm fixings from the kit. Tighten the fixings to **20 Nm**.
7. Lower the pannier rail arm until it clicks in to place.
8. Repeat steps 4 to 7 for the left hand pannier rail.
9. Refit the rider and passenger seats as described in the Service Manual.

Fitment of Lock Barrel

1. Remove the four fixings from inside the pannier which secure the pannier lock housing. Retain the fixings for reuse.

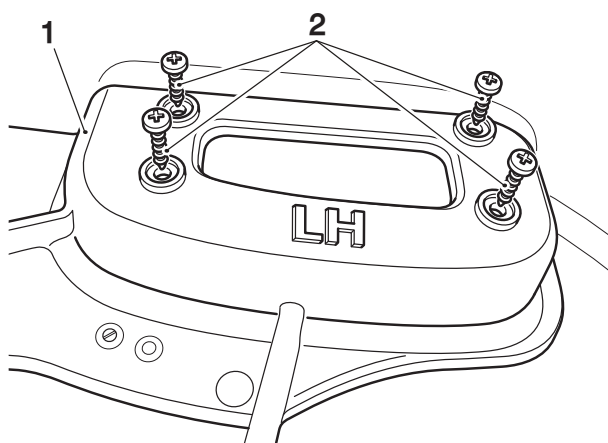

1. Pannier
2. Fixings

2. Remove the pannier lock housing from the pannier.

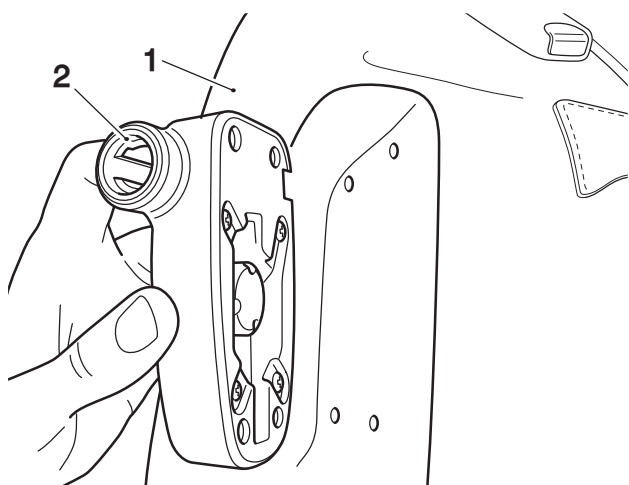

1. Pannier
2. Fixings

3. Remove the cover from the rear of the pannier lock housing. Retain the cover and fixings for reuse.

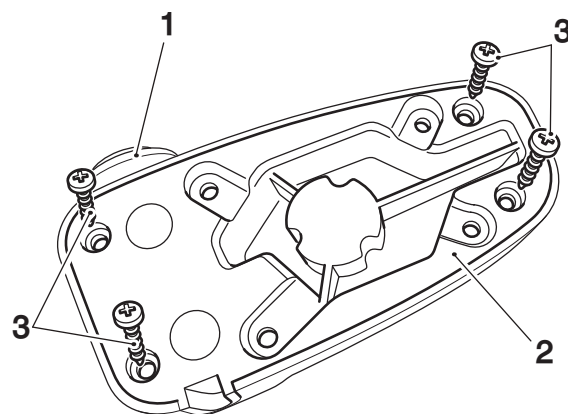

1. Pannier lock housing
2. Rear cover, pannier lock housing
3. Fixings

4. Remove the latch plate, spring, cam plate and fixing from the pannier lock housing noting their position and orientation for reassembly.

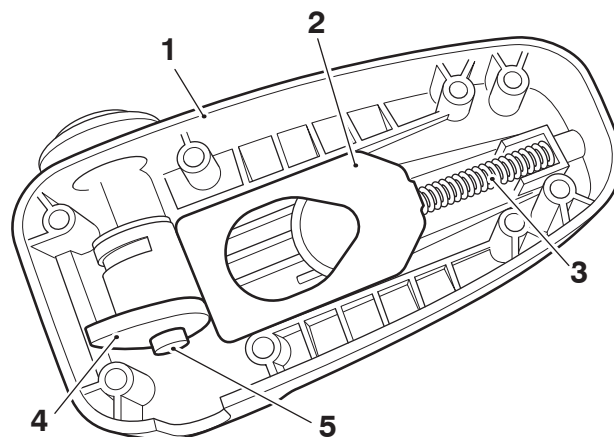

1. Pannier lock housing
2. Latch plate
3. Spring
4. Cam plate
5. Fixing

NOTICE

Do not remove the ignition key from the lock barrel when the lock barrel has been removed from its protective case or latch assembly.

If the key is removed when the lock barrel has been removed from the protective case or latch assembly, the lock barrel will be in an unstable condition and the internal components will become unassembled and may be lost which will prevent fitment of the lock barrel.

The ignition key must only be removed when the lock barrel has been fitted into the pannier.

5. Fit the ignition key in to the lock barrel lock supplied with the motorcycle when new.
6. Turn the ignition key clockwise to remove the lock barrel from its protective case.

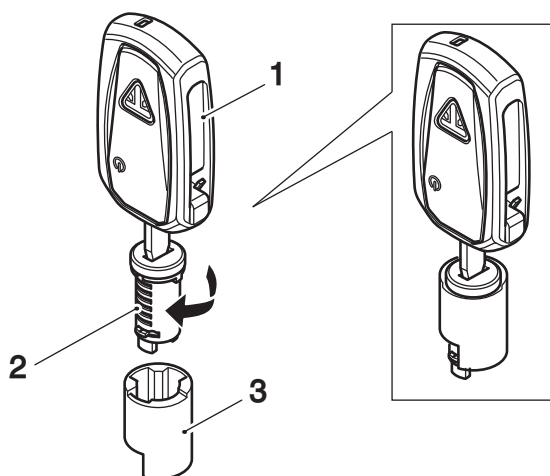

1. Ignition key
2. Lock barrel
3. Protective case

NOTICE

The lock barrel will only fit one way.

7. Align the tumblers on the lock barrel to the slot in the pannier lock housing and push the barrel into position until it clicks into place.

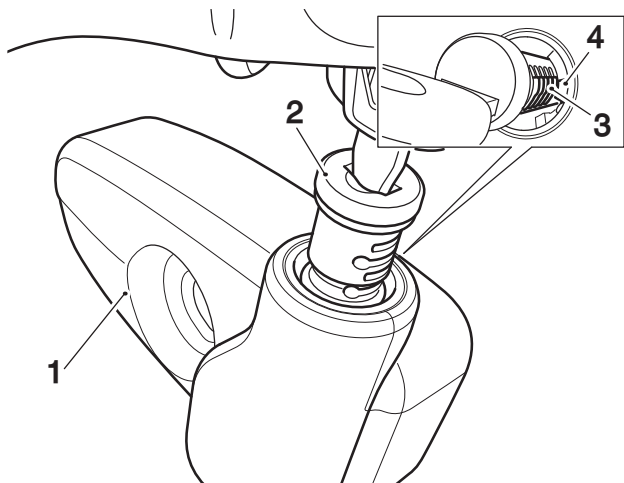

1. Pannier lock housing
2. Lock barrel
3. Tumblers
4. Slot

8. Fit the cam plate on to the base of the lock barrel in the orientation shown and fit the original cam plate fixing. Tighten the fixing to **3 Nm**.

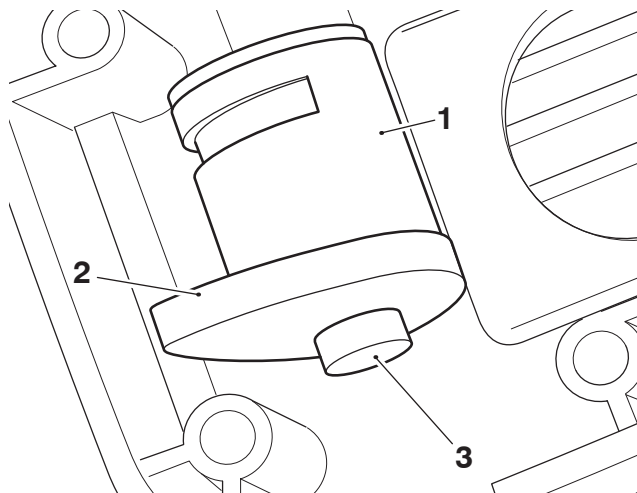

1. Pannier lock housing
2. Lock barrel
3. Tumblers
4. Slot

9. Refit the latch plate and spring in to the lock housing as shown.

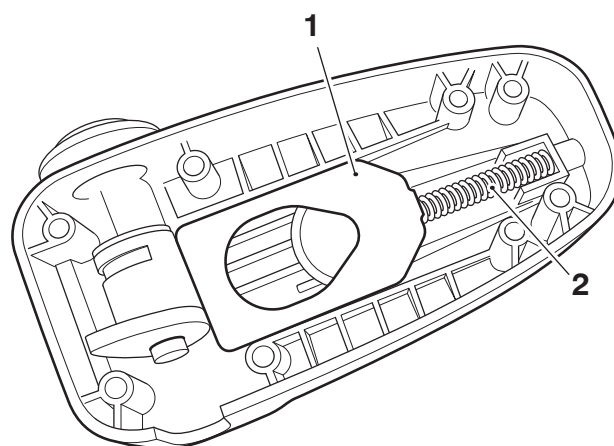

1. Latch plate
2. Spring

10. Refit the pannier lock housing rear cover with the original fixings. Tighten the fixings to **3 Nm**.
11. Check the operation of the barrel. Remove the key.
12. Refit the pannier lock housing to the pannier with the original fixings. Tighten the fixings to **3 Nm**.
13. Repeat steps 1 to 12 to fit a lock barrel to the remaining pannier.

Pannier Installation

⚠ WARNING

The panniers must always be fitted to both sides of the motorcycle. Never ride the motorcycle with only one pannier installed.

Riding the motorcycle with one pannier installed may cause the motorcycle to become unstable which may lead to loss of motorcycle control.

Failure to follow the advice above could result in serious injury or death.

1. Fit the lower and front pannier mounts on the rear of the pannier on to the bobbins on the pannier rail.
2. Push the pannier down to fully engage the pannier mounts on to the pannier rail bobbins. The pannier latch mount should be aligned with the pannier lock when the pannier mounts are fully engaged.
3. Push the top of the pannier inwards to fully engage the pannier latch mount on to the pannier rail in to the pannier lock. There should be an audible click sound from the pannier latch mount when the pannier is fully engaged.
4. Pull the pannier away from the pannier rail to ensure it is correctly engaged on the pannier rail and cannot become detached.
5. To release the pannier, insert the ignition key in to the pannier lock, turn the key and the pannier latch will be released from the pannier rail. Lift the pannier to disengage it from the front and lower bobbins on the pannier rail.

Programming the Pannier Zip Locks

NOTICE

The panniers incorporate combination zip locks to secure the pannier lids when closed, as shown below.

The zip locks are set to a factory default combination code of 0 0 0. To change the combination code to a personal setting, follow the steps below.

Ensure the chosen personal combination code is remembered, or stored securely.

To reset a personal combination code replace 0 0 0 at step 1 with the current personal code. Repeat step 2 with a new personal code.

6. Ensure the zip lock numerical dials are set to the factory default setting of 0 0 0. Press and hold down the reset button on the side of the lock with a suitable tool until an audible click sound is heard.

7. Set the zip lock to the chosen personal three digit code by turning the numerical dials on the lock to the chosen values, e.g. 7 2 9. Push the lock release button in the direction shown and hold the release button in position until an audible click sound is heard. The zip lock has now been reset to the personal three digit code.

Fitting the Rain Cover

NOTICE

The Pannier Kit may not be supplied with rain covers or inner bags.

If the Pannier Kit is supplied with rain covers, the rain covers with eyelets must be used and any additional rain covers discarded.

If the Pannier Kit includes inner bags these are to be used inside the panniers when using rain covers to improve the water resistance of the panniers.

The label on the inside of the rain cover provides identification for the top of the rain cover.

If the rain cover includes eyelets these provide identification for the bottom of the rain cover.

8. Fit the rain cover over the pannier with the identification label at the top and eyelets at the bottom.
9. Secure the rain cover to the pannier by attaching the latch and clasp of the strap on the rain cover, over the pannier rail at the rear of the pannier.

Care of Panniers

NOTICE

Use of chemicals or high-pressure spray washers is not recommended for cleaning the panniers. Using chemicals or pressure washers may damage the panniers.

NOTICE

The panniers are constructed from natural materials therefore scratches and scuffs will develop naturally, enhancing the appearance of the panniers.

To maintain the appearance of your product, we recommend that you periodically clean the panniers. Your Triumph panniers are natural products and a lack of care can result in damage and permanent wear.

Frequent, regular cleaning is an essential part of the maintenance of your panniers. If regularly cleaned, the appearance will be preserved for many years. Cleaning with cold water and a sponge is essential at all times but particularly so after exposure to sea breezes, sea water, dusty or muddy roads and in winter when roads are treated for ice and snow. A brush can be used to remove dirt or grit in extreme circumstances.

Do not use hot water or household detergent, as the use of such products will lead to premature deterioration.

Although, under the terms of your motorcycle warranty, cover is provided, the owner is expected to observe this reasonable advice which will safeguard against premature deterioration and enhance the appearance of the motorcycle.

Follow these simple instructions below to maintain the look of the panniers:

- Do not use household cleaning products, bleach, detergents containing bleach or any kind of solvent to clean the panniers; use a damp sponge only.
- Do not immerse the panniers in water.
- Do not store items such as damp or wet clothing inside the panniers as this can cause damage to the materiel or the stored items.
- Avoid direct heat from fires and radiators which can dry out and distort the panniers.
- Avoid direct sunlight for extended periods which can dry out and discolour the materiel.
- Do not dry the panniers by applying direct heat to them at any time.
- If the panniers do get wet, absorb any excess water with a soft clean cloth then leave the product to dry naturally at room temperature.
- Avoid exposing the panniers to high levels of salt, for example sea/salt water or road surfaces that have been treated during the winter for ice and snow.
- If exposure to salt is unavoidable, clean your product immediately after each exposure using a damp sponge then leave the product to dry naturally at room temperature.
- Allow mud to dry before wiping off. Use a soft cloth to remove the mud then leave them to dry naturally at room temperature.
- Gently clean any minor marks with a damp sponge then leave them to dry naturally at room temperature.
- Place the product into a fabric bag or cardboard box to protect them when in storage. Do not put the panniers into a plastic bag.

WARNING

After fitting the accessory kit the motorcycle will exhibit new handling characteristics.

Operate the motorcycle in a safe area free from traffic to gain familiarity with any new characteristics.

Operation of the motorcycle when not familiar with any new handling characteristics may lead to loss of motorcycle control which could result in serious injury or death.

WARNING

If, after fitting this accessory kit, you have any doubt about the performance of any aspect of the motorcycle, contact a competent person with the specialist knowledge and technical understanding of motorcycles, such as an authorised Triumph dealer.

Riding a motorcycle when there is any doubt as to any aspect of the performance of the motorcycle may lead to loss of motorcycle control which could result in serious injury or death.

WARNING

Never ride an accessory-equipped motorcycle at speeds above 80 mph (130 km/h).

Remember that the 80 mph (130 km/h) limit will be reduced by the fitting of non-approved accessories, incorrect loading, worn tyres, overall motorcycle condition and poor road or weather conditions.

The presence of accessories will cause changes in the stability and handling of the motorcycle. Failure to allow for changes in motorcycle stability may lead to loss of motorcycle control which could result in serious injury or death.

WARNING

High-speed operation should only be attempted by riders who have been instructed in the techniques necessary for high-speed riding and are familiar with the motorcycle's characteristics in all conditions.

Only operate this Triumph motorcycle at high speed in closed-course, on-road competition or on closed-course racetracks.

High-speed operation in any other circumstances is dangerous and may lead to loss of motorcycle control which could result in serious injury or death.

NOTICE

The motorcycle must not be operated above the legal road speed limit except in closed-course conditions.