



## Accessory Fitting Instructions

Thank you for choosing this Triumph genuine accessory kit. This accessory kit is the product of Triumph's use of proven engineering, exhaustive testing, and continuous striving for superior reliability, safety and performance.

Completely read all of these instructions before commencing the installation of the accessory kit in order to become thoroughly familiar with the kit's features and the installation process.

These instructions should be considered a permanent part of your accessory kit, and should remain with it even if your accessory equipped motorcycle is subsequently sold.

Tank Bag Kit	
Kit Number	Models
A9518171	Rocket 3 R, Rocket 3 R Black, Rocket 3 R Storm, Rocket 3 TFC, Rocket 3 GT, Rocket 3 GT Triple Black, Rocket 3 GT Storm

### Parts supplied



1. Tank Bag	1 off	2. Front mounting harness	1 off
-------------	-------	---------------------------	-------

### NOTICE

Chrome Line Edition models only

The use of tank bags, tank-mounted accessories, or abrasive rider clothing may cause damage to the chrome finish and must not be used.

Guidance on cleaning and storage is given in the Owner's Handbook.

**⚠ WARNING**

Fit only genuine Triumph accessories to those models approved by Triumph as listed in the associated Triumph fitting instructions.

The accessory kits covered in this instruction are designed for use on specific models of Triumph motorcycle. The accessory kits and the models applicable are listed at the start of the instruction. They should never be fitted to any other Triumph model or to any other manufacturer's motorcycle.

Fitting an accessory kit to a Triumph model not listed, or to any other manufacturer's motorcycle, will affect the performance, stability and handling of the motorcycle.

Failure to follow the advice above may lead to loss of motorcycle control which could result in serious injury or death.

**⚠ WARNING**

Always have Triumph approved parts, accessories and conversions fitted by a competent person with the specialist knowledge and technical understanding of motorcycles, such as an authorised Triumph dealer.

The fitment of parts, accessories and conversions by a person without the specialist knowledge and technical understanding of motorcycles may affect the handling, stability or other aspects of the motorcycle's operation.

Failure to follow the advice above may lead to loss of motorcycle control which could result in serious injury or death.

**⚠ WARNING**

A torque wrench of known accurate calibration must be used when fitting this accessory kit.

Failure to tighten any of the fasteners to the correct torque specification may affect motorcycle performance, handling and stability.

Failure to follow the advice above may lead to loss of motorcycle control which could result in serious injury or death.

**⚠ WARNING**

Make sure the motorcycle is stabilised and adequately supported.

Do not support the motorcycle on any ancillary component, the exhaust system or any other non structural parts of the motorcycle frame.

A correctly supported motorcycle will help prevent it from falling.

An unstable motorcycle may fall resulting in motorcycle damage, serious injury or death.

**NOTICE**

Triumph offers a broad range of approved genuine accessories for your motorcycle.

We cannot therefore cover all possible equipment variations in these instructions. For removal and installation of Triumph Genuine Accessories, always refer to the instructions supplied with the respective accessory kit.

To obtain additional copies of any Triumph accessory instructions, visit [www.triumphinstructions.com](http://www.triumphinstructions.com) or contact your authorised Triumph dealer.

**⚠ DANGER**

Do not use a mobile phone or adjust any GPS device while the motorcycle is in motion.

Telephone calls, texting or any attempt to use your mobile device for any purpose while riding the motorcycle is dangerous.

Failure to follow the advice above will result in serious injury or death.

**⚠ WARNING**

Install the tank bag only in the position described below.

Installation of the tank bag in any other position on the motorcycle will affect the handling, stability or other aspects of the motorcycle's operation.

Failure to follow the advice above may lead to loss of motorcycle control which could result in serious injury or death.

**⚠ WARNING**

Remove the shoulder strap(s) from the tank bag before mounting to the motorcycle.

Operation of the motorcycle with the shoulder strap(s) fitted may result in loss of motorcycle control.

Failure to follow the advice above may lead to loss of motorcycle control which could result in serious injury or death.

**NOTICE**

This tank bag is not to be used on Chrome Edition models.

1. Remove the seat as described in the Service Manual.

2. Remove the tank strap rear fixing, retain the fixing for reuse.

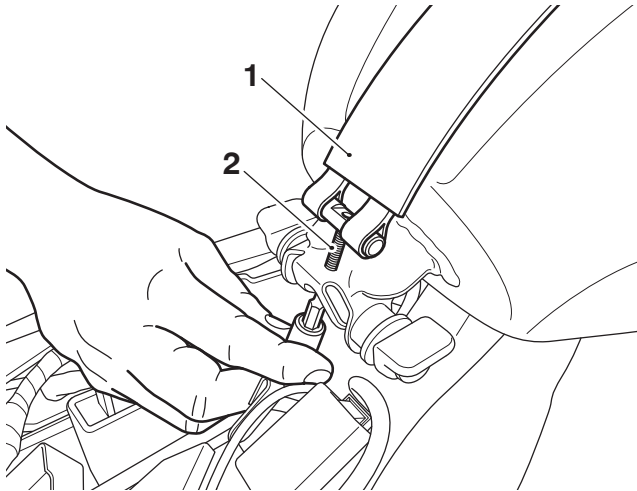

1. Tank strap
2. Fixing
3. Detach the tank strap from the front mounting latch.

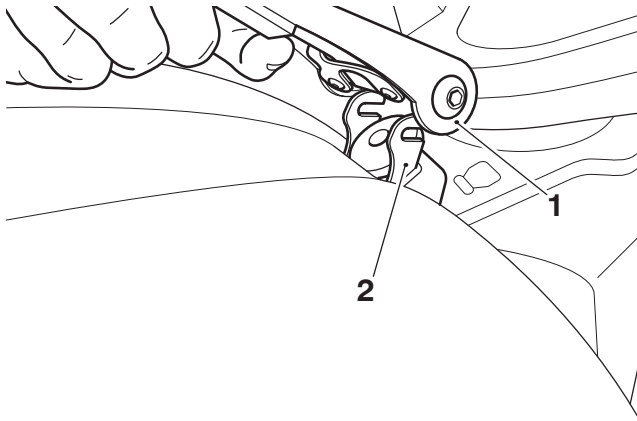

1. Tank strap
2. Front mounting latch

4. Remove the two fixings securing the retaining plate to the underside of the tank strap front mounting. Retain the fixings and retaining plate for reuse.

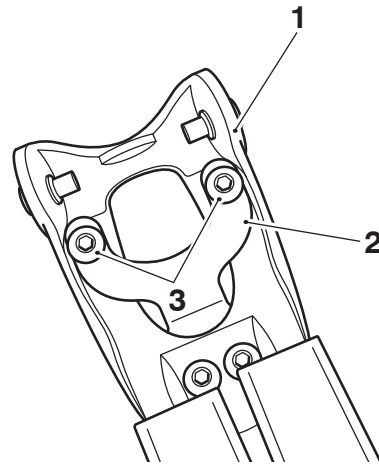

1. Tank strap front mounting
2. Retaining plate
3. Fixings
5. Fit the loop section of the front mounting harness through the front tank strap mounting, as shown.

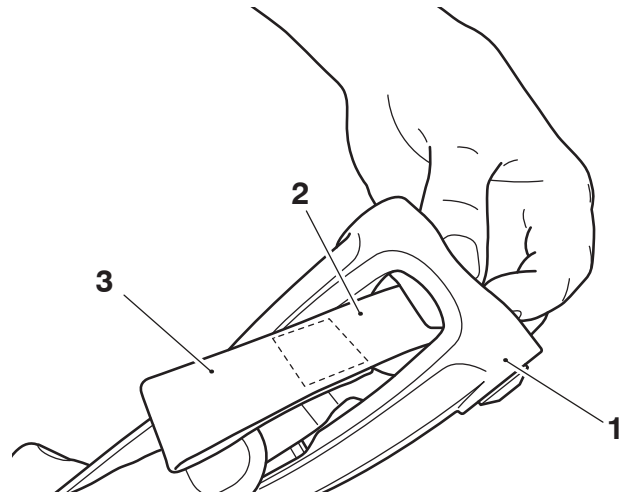

1. Tank strap front mounting
2. Front mounting harness
3. Loop section

- Refit the retaining plate making sure the front mounting harness is positioned between the retaining plate and tank strap mounting, as shown. Fit the original fixings and tighten to **2.5 Nm**.

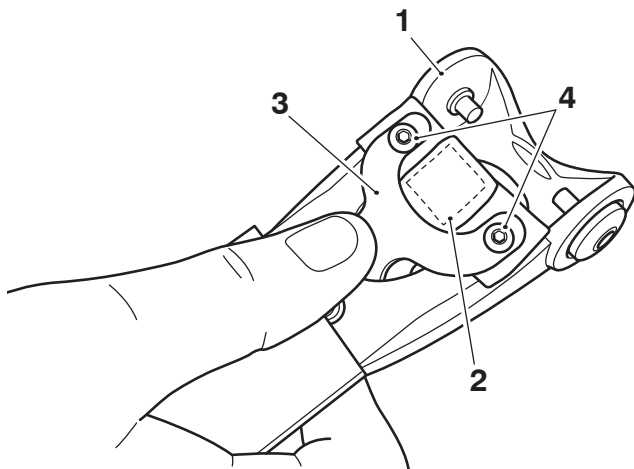

- Tank strap front mounting
- Front mounting harness
- Retaining plate
- Fixings

### NOTICE

Make sure the fuel tank and underside of the tank strap are clean and dry prior to fitting.

- Attach the tank strap to the front mounting latch.

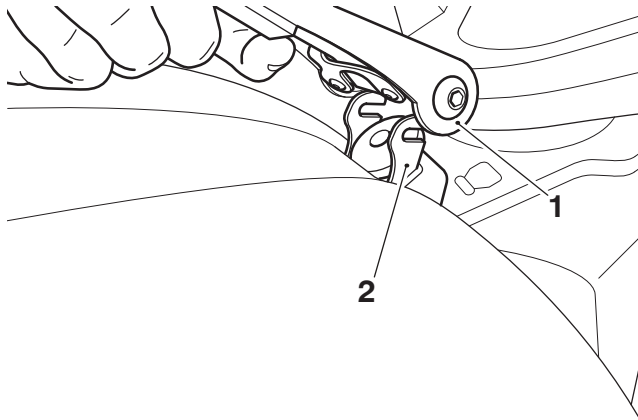

- Tank strap
- Front mounting latch

- Refit the tank strap rear fixing and tighten to **1.5 Nm**.

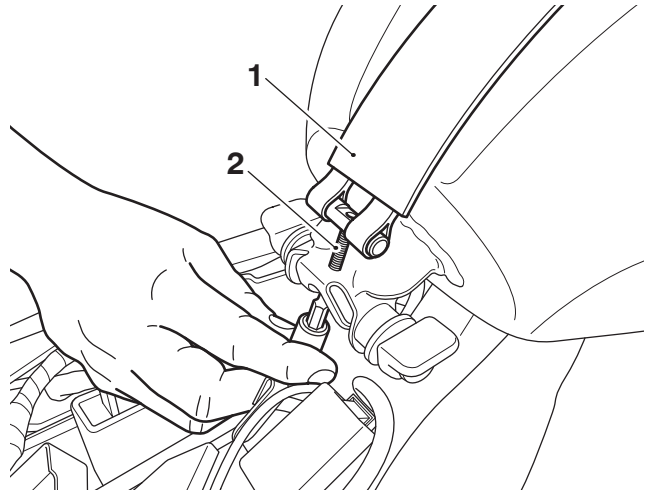

- Tank strap
- Fixing

- Refit the seat as described in the Service Manual.

### Installing the Tank Bag

### NOTICE

Make sure the fuel tank and underside of the tank strap are clean and dry prior to fitting.

- Position the tank bag on the fuel tank and fit the G-clip of the tank bag retaining strap through the loop section of the front mounting harness making sure it locates fully as shown.

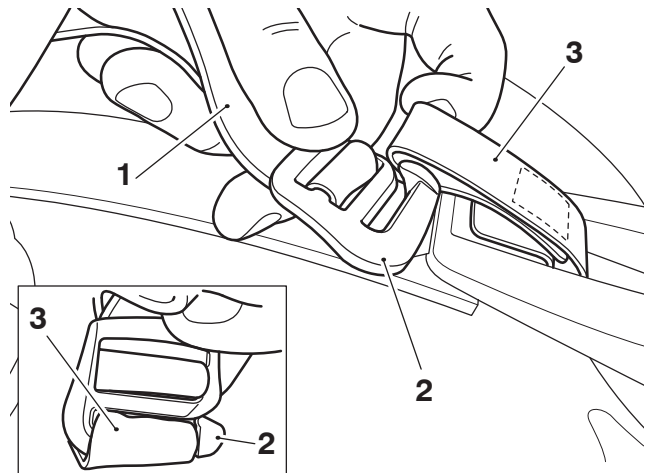

- Tank bag retaining strap
- G-clip
- Loop section, front mounting harness

- Position the tank bag to the desired position centrally on the fuel tank making sure the magnetic sections of the tank bag are located on the fuel tank as shown.

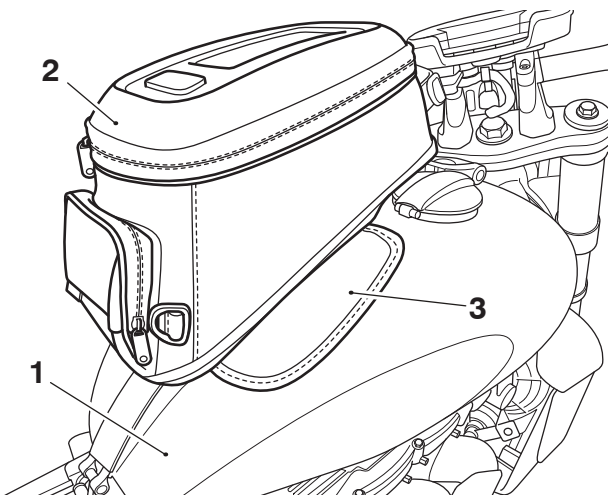

- Fuel tank
- Tank bag
- Magnetic section, right hand side shown

- Pull the loose end of the tank bag retaining strap to tension the strap against the front mounting harness and feed any excess strap through the loop on the tank strap.

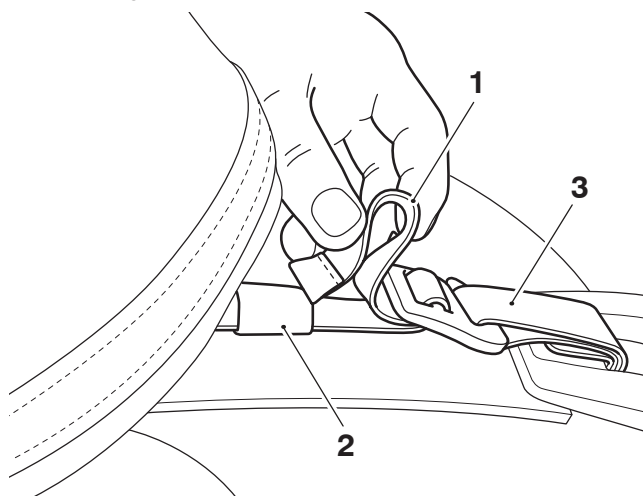

- Tank strap
- Loop
- Front mounting harness

## Installing the Rain Cover

### NOTICE

Locate the label on the inside of the rain cover, this provides identification for the front of the rain cover.

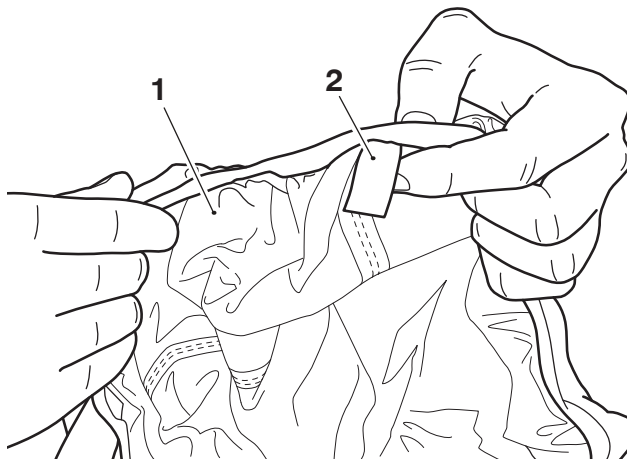

- Rain cover
- Label

- Fit the rain cover over the tank bag with the identification label at the front.

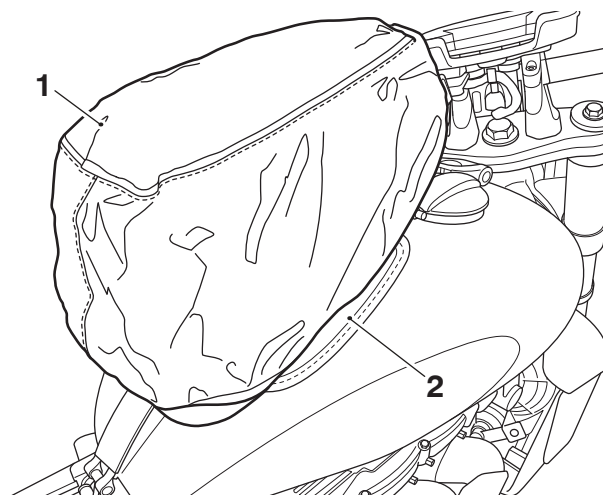

- Rain cover
- Tank bag

### ⚠ WARNING

The maximum safe load for the tank bag is 3 kg (6.6 lbs).

Never exceed the maximum safe load limit as this may lead to loss of motorcycle control which could result in serious injury or death.

## Cleaning

### **NOTICE**

Use of chemicals or high-pressure spray washers is not recommended for cleaning the bag. Using chemicals or pressure washers may damage the bag.

To help maintain its appearance, clean the tank bad using a sponge or cleaning cloth with low alkaline soap and water.

### **⚠ WARNING**

After fitting the accessory kit the motorcycle will exhibit new handling characteristics.

Operate the motorcycle in a safe area free from traffic to gain familiarity with any new characteristics.

Operation of the motorcycle when not familiar with any new handling characteristics may lead to loss of motorcycle control which could result in serious injury or death.

### **⚠ WARNING**

If, after fitting this accessory kit, you have any doubt about the performance of any aspect of the motorcycle, contact a competent person with the specialist knowledge and technical understanding of motorcycles, such as an authorised Triumph dealer.

Riding a motorcycle when there is any doubt as to any aspect of the performance of the motorcycle may lead to loss of motorcycle control which could result in serious injury or death.

### **⚠ WARNING**

Never ride an accessory-equipped motorcycle at speeds above 80 mph (130 km/h).

Remember that the 80 mph (130 km/h) limit will be reduced by the fitting of non-approved accessories, incorrect loading, worn tyres, overall motorcycle condition and poor road or weather conditions.

The presence of accessories will cause changes in the stability and handling of the motorcycle. Failure to allow for changes in motorcycle stability may lead to loss of motorcycle control which could result in serious injury or death.

### **⚠ WARNING**

High-speed operation should only be attempted by riders who have been instructed in the techniques necessary for high-speed riding and are familiar with the motorcycle's characteristics in all conditions.

Only operate this Triumph motorcycle at high speed in closed-course, on-road competition or on closed-course racetracks.

High-speed operation in any other circumstances is dangerous and may lead to loss of motorcycle control which could result in serious injury or death.

### **NOTICE**

The motorcycle must not be operated above the legal road speed limit except in closed-course conditions.