



Accessory Fitting Instructions

Thank you for choosing this Triumph genuine accessory kit. This accessory kit is the product of Triumph's use of proven engineering, exhaustive testing, and continuous striving for superior reliability, safety and performance.

Completely read all of these instructions before commencing the installation of the accessory kit in order to become thoroughly familiar with the kit's features and the installation process.

These instructions should be considered a permanent part of your accessory kit, and should remain with it even if your accessory equipped motorcycle is subsequently sold.

Tank Bag 12L	
Kit Number	Models
A9518029	Scrambler 1200 XE from VIN BP0885, Scrambler 1200 X

Parts supplied

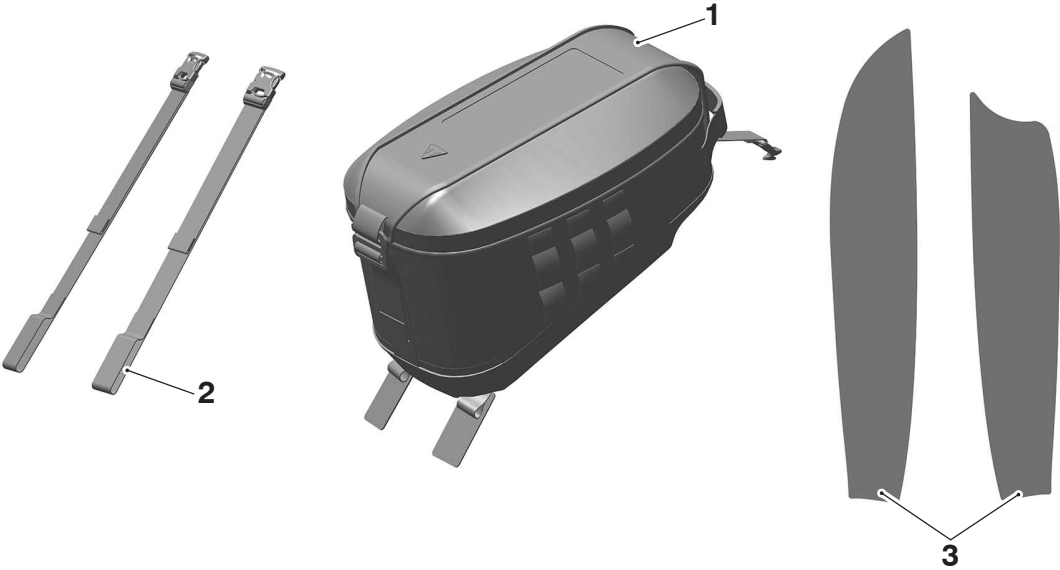

1. Tank Bag, Waxed cotton	1 off	3. Protective film	1 off
2. Rear mounting strap	2 off		

⚠ DANGER

Do not use a mobile phone or adjust any GPS device while the motorcycle is in motion.
Telephone calls, texting or any attempt to use your mobile device for any purpose while riding the motorcycle is dangerous.
Failure to follow the advice above will result in serious injury or death.

NOTICE

This tank bag is not to be used on Chrome Edition models.

⚠ WARNING

Fit only genuine Triumph accessories to those models approved by Triumph as listed in the associated Triumph fitting instructions.

The accessory kits covered in this instruction are designed for use on specific models of Triumph motorcycle. The accessory kits and the models applicable are listed at the start of the instruction. They should never be fitted to any other Triumph model or to any other manufacturer's motorcycle.

Fitting an accessory kit to a Triumph model not listed, or to any other manufacturer's motorcycle, will affect the performance, stability and handling of the motorcycle.

Failure to follow the advice above may lead to loss of motorcycle control which could result in serious injury or death.

⚠ WARNING

Always have Triumph approved parts, accessories and conversions fitted by a competent person with the specialist knowledge and technical understanding of motorcycles, such as an authorised Triumph dealer.

The fitment of parts, accessories and conversions by a person without the specialist knowledge and technical understanding of motorcycles may affect the handling, stability or other aspects of the motorcycle's operation.

Failure to follow the advice above may lead to loss of motorcycle control which could result in serious injury or death.

⚠ WARNING

A torque wrench of known accurate calibration must be used when fitting this accessory kit.

Failure to tighten any of the fasteners to the correct torque specification may affect motorcycle performance, handling and stability.

Failure to follow the advice above may lead to loss of motorcycle control which could result in serious injury or death.

⚠ WARNING

Make sure the motorcycle is stabilised and adequately supported.

Do not support the motorcycle on any ancillary component, the exhaust system or any other non structural parts of the motorcycle frame.

A correctly supported motorcycle will help prevent it from falling.

An unstable motorcycle may fall resulting in motorcycle damage, serious injury or death.

NOTICE

Triumph offers a broad range of approved genuine accessories for your motorcycle.

We cannot therefore cover all possible equipment variations in these instructions. For removal and installation of Triumph Genuine Accessories, always refer to the instructions supplied with the respective accessory kit.

To obtain additional copies of any Triumph accessory instructions, visit www.triumphinstructions.com or contact your authorised Triumph dealer.

Strap Installation

Rear Strap Installation

1. Remove the seat, as described in the Owner's Handbook.
2. Take one of the rear mounting straps from the kit and feed the loop end of the strap under the frame on the right hand side of the motorcycle, as shown. Make sure the strap is tight to the frame and does not trap any pipework or wiring harnesses.

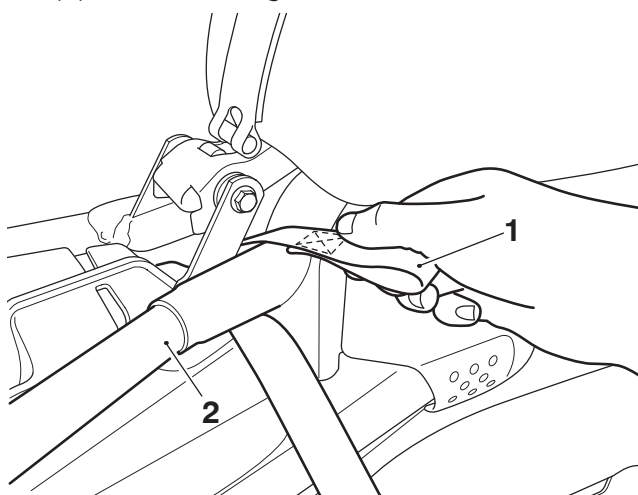

1. Loop, rear mounting strap
2. Motorcycle frame

3. Pass the other end of the harness, with clip, through the loop and pull tight to secure the harness to the motorcycle frame, as shown below.

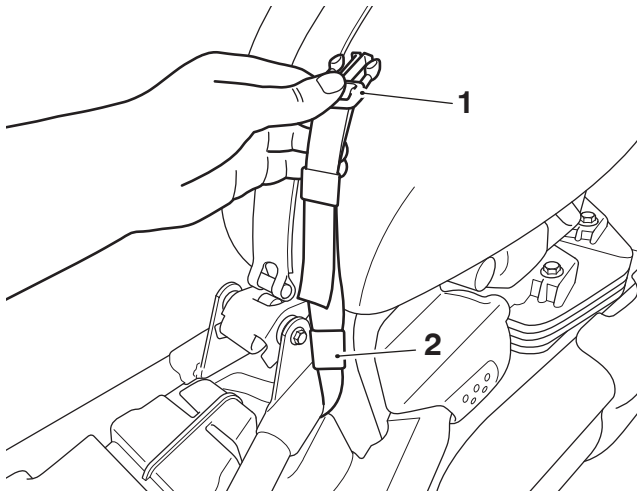

1. Clip
2. Loop

4. Repeat steps 2 and 3 for the second rear mounting strap, on the left hand side of the motorcycle.
5. Refit the seat, as described in the Owner's Handbook.

Positioning the Tank Bag

6. Fit the base of the front tank bag strap retaining clip through the fuel tank strap eyelet in the orientation shown below. Tank bag removed for clarity.

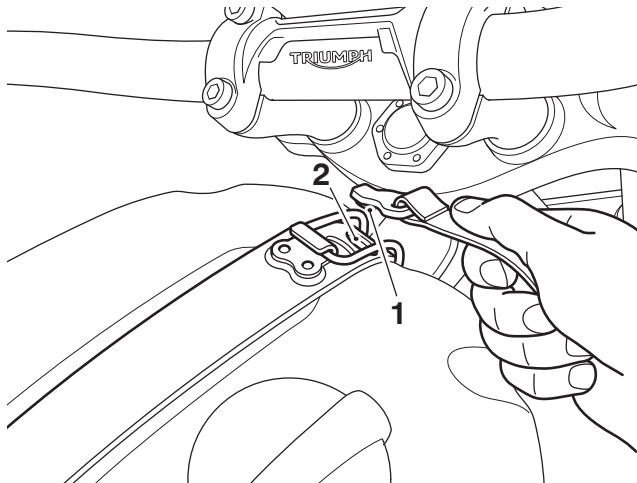

1. Front tank bag strap retaining clip
2. Fuel tank strap eyelet

7. Rotate the front tank bag strap retaining clip anticlockwise through 90 degrees until the tank bag strap is facing the rear of the motorcycle.

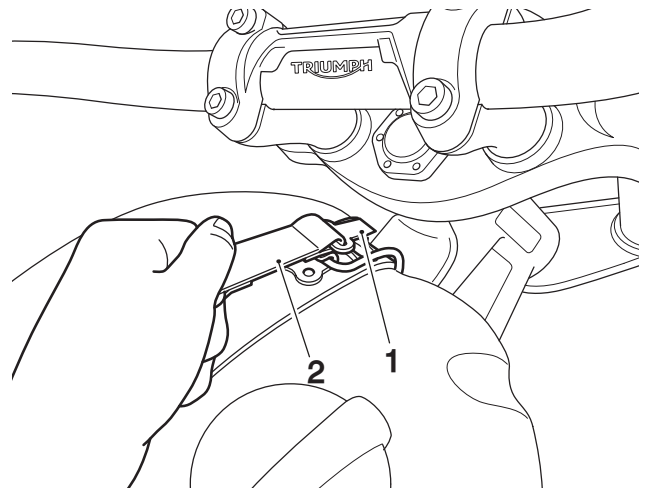

1. Tank bag strap retaining clip
2. Front tank bag strap

8. Position the tank bag centrally on the fuel tank.

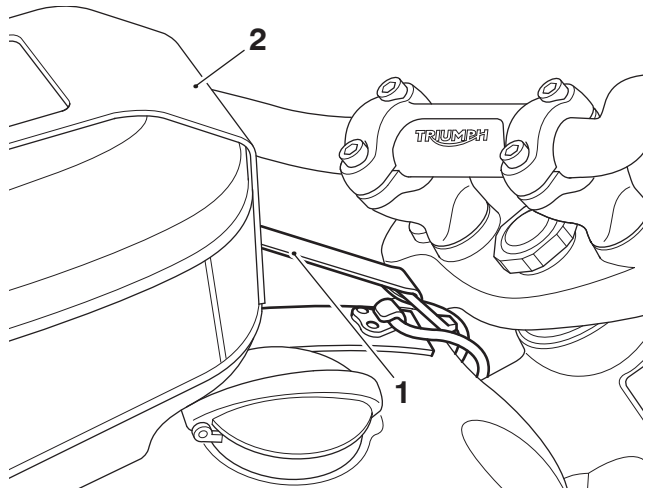

1. Front tank bag strap
2. Tank bag

9. Attach the clips on the rear of the tank bag to the clips on the rear straps.

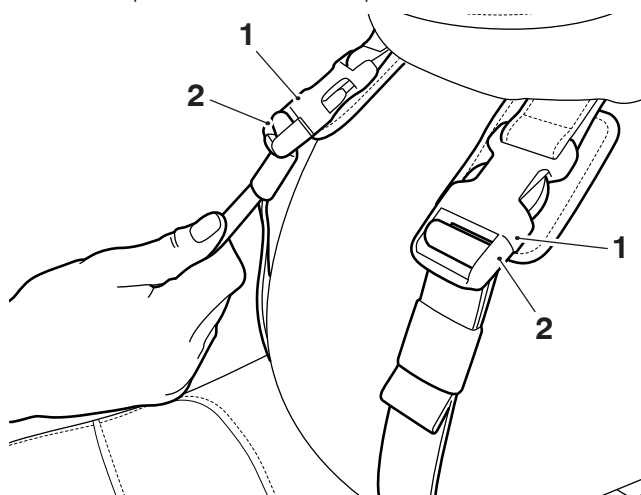

1. Clip, female
2. Clip, male

10. Adjust the rear straps to make sure the tank bag is held securely on the fuel tank.

Fitment of Protective Film

Left hand side of the fuel tank

11. Using a strip of masking tape under the webbing loop mark the front position of the tank bag on the tank strap making sure the rear edge of the tape is aligned with the front edge of the tank bag, as shown. Repeat with a second strip of masking tape to mark the rear edge of the tank bag on the tank strap.

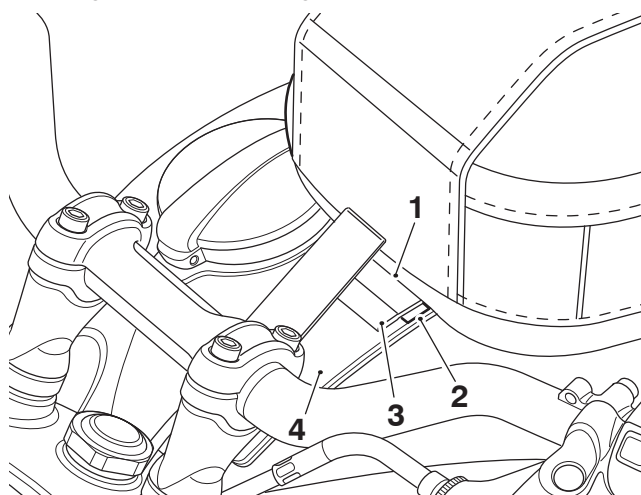

1. Tank bag, front edge
2. Masking tape
3. Webbing loop
4. Tank strap

12. Remove the tank bag from the fuel tank.

NOTICE

Before using any degreasing or cleaning agents, always test a small area of paintwork first, especially if applying to fresh paintwork. Some degreasing or cleaning agents may damage the paintwork.

13. Clean the fuel tank thoroughly by using a suitable panel cleaner to remove any polish or grease from the painted surface.
14. Spray clean water onto the fuel tank.

NOTICE

With clean hands, spray water onto your fore finger and thumb before peeling any film off the backing paper. This will prevent fingerprints appearing on the adhesive surface of the film.

15. Peel the left hand protective film from the backing paper while continually spraying clean water on to the adhesive side of the film.
16. Lay the left hand protective film onto the fuel tank, starting at the front. The front edge of the protective film should be positioned approximately 12 mm ahead of the front masking tape mark. The bottom edge of the film should lay approximately 12 mm below the rear tape mark. Make sure the inside edge of the protective film is positioned 0-3 mm over the start of the radius into the recessed tank strap surface.

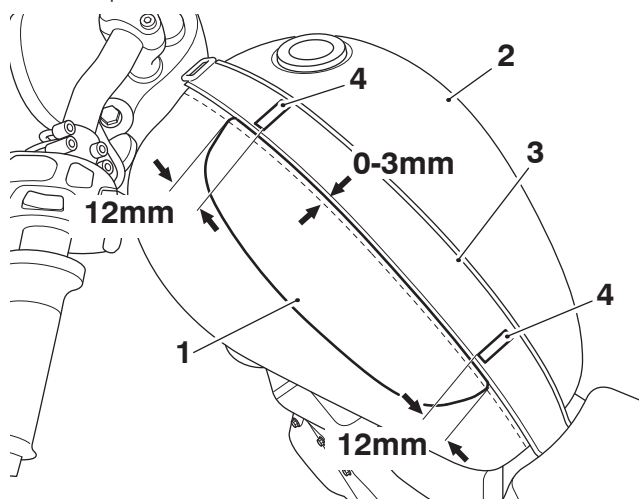

1. Protective film
2. Fuel tank
3. Tank strap
4. Masking tape

NOTICE

For best results, push firmly over the protective film using a semi-rigid film squeegee that will not mark the surface. Make sure the squeegee is wet to allow it to glide on the protective film surface.

When dealing with curved surfaces, tension will need to be applied for the film to take to the contours of the surface. Pull gently in the direction required and the film will naturally take to the curvature of the fuel tank.

If any wrinkles appear in the film, work them out towards the closest edge using the squeegee or your thumb to gently spread the film. Avoid going across the wrinkle, this may create a crease in the film.

17. Carefully apply suitable pressure to wrap the protective film over the tank making sure air bubbles and fluid are not trapped between the protective film and fuel tank.
18. First apply pressure at the front of the protective strip and work downwards to remove any fluid and air bubbles.

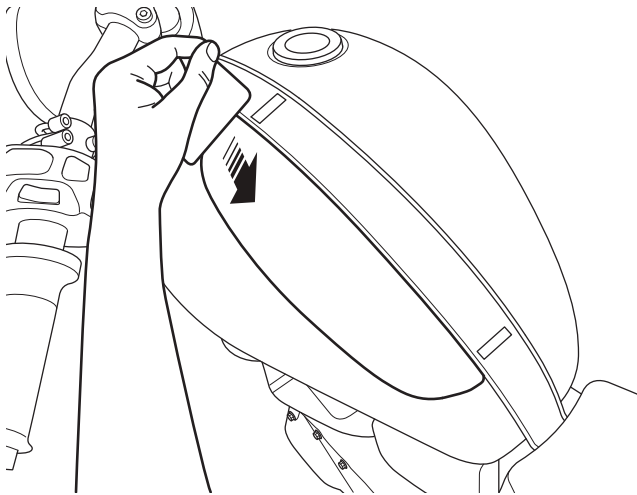

19. Continue working the protective film until all areas are secured, then dry off any excess fluid with a paper towel.
20. Should an edge of the protective strip not adhere to the fuel tank, hold it down for 20 to 30 seconds using your thumb. The heat transfer will help to activate the protective film adhesive in that area.

Right hand side of the fuel tank

NOTICE

With clean hands, spray water onto your fore finger and thumb before peeling any film off the backing paper. This will prevent fingerprints appearing on the adhesive surface of the film.

21. Peel the right hand protective film from the backing paper while continually spraying clean water on to the adhesive side of the film.
22. Lay the right hand protective film onto the fuel tank, starting at the bottom. The lower edge of the film should be positioned approximately 12 mm below the rear masking tape mark. Make sure the inside edge of the protective film is positioned 0-3 mm over the start of the radius into the recessed tank strap surface.

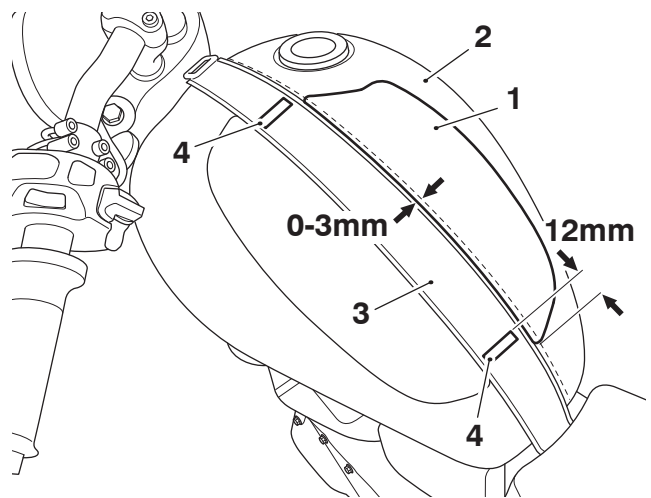

1. Protective film
2. Fuel tank
3. Tank strap
4. Masking tape

23. Remove the masking tape from the tank strap.
24. Refit the tank bag.
25. Check there is no significant side to side, or upwards movement of the tank bag. It should not be possible to lift the tank bag away from the fuel tank when the tank bag rear straps are adjusted correctly. If necessary re-adjust the tank bag rear straps.

Riding Without Tank Bag Fitted

26. If riding without the tank bag, remove the seat, as described on the Owner's Handbook, and store the rear straps in the area below the seat. Make sure the rear straps do not interfere with the seat's front mounting. Refit the seat.

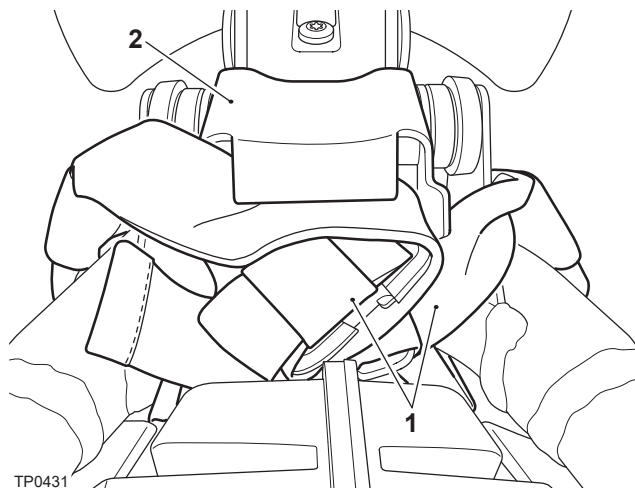

1. Rear straps
2. Seat's front mounting

Care of Tank Bag

NOTICE

Use of chemicals or high-pressure spray washers is not recommended for cleaning the bag. Using chemicals or pressure washers may damage the bag.

NOTICE

The bag is constructed from natural materials therefore scratches and scuffs will develop naturally, enhancing the appearance of the tank bag.

To maintain the appearance of your product, we recommend that you periodically clean the bag. Your Triumph bag is made from natural products and a lack of care can result in damage and permanent wear.

Frequent, regular cleaning is an essential part of the maintenance of your bag. If regularly cleaned, the appearance will be preserved for many years. Cleaning with cold water and a sponge is essential at all times but particularly so after exposure to sea breezes, sea water, dusty or muddy roads and in winter when roads are treated for ice and snow. A brush can be used to remove dirt or grit in extreme circumstances.

Do not use hot water or household detergent, as the use of such products will lead to premature deterioration.

Although, under the terms of your motorcycle warranty, cover is provided, the owner is expected to observe this reasonable advice which will safeguard against premature deterioration and enhance the appearance of the motorcycle.

Follow these simple instructions below to maintain the look of the bag:

- Do not use household cleaning products, bleach, detergents containing bleach or any kind of solvent to clean the bag; use a damp sponge only.
- Do not immerse the bag in water.
- Do not store items such as damp or wet clothing inside the bag as this can cause damage to the material or the stored items.
- Avoid direct heat from fires and radiators which can dry out and distort the bag.
- Avoid direct sunlight for extended periods which can dry out and discolour the material.
- Do not dry the bag by applying direct heat to them at any time.
- If the bag does get wet, absorb any excess water with a soft clean cloth then leave the product to dry naturally at room temperature.
- Avoid exposing the bag to high levels of salt, for example sea/salt water or road surfaces that have been treated during the winter for ice and snow.
- If exposure to salt is unavoidable, clean your bag immediately after each exposure using a damp sponge then leave the bag to dry naturally at room temperature.
- Allow mud to dry before wiping off. Use a soft cloth to remove the mud then leave the bag to dry naturally at room temperature.
- Gently clean any minor marks with a damp sponge then leave the bag to dry naturally at room temperature.
- Place the bag into a fabric bag or cardboard box to protect them when in storage. Do not put the bag into a plastic bag.

⚠ WARNING

The maximum safe load for the tank bag is 3 kg (6.6 lbs). Never exceed this loading limit as this may cause the motorcycle to become unstable leading to loss of control and an accident.

⚠ WARNING

After fitting the accessory kit the motorcycle will exhibit new handling characteristics.

Operate the motorcycle in a safe area free from traffic to gain familiarity with any new characteristics.

Operation of the motorcycle when not familiar with any new handling characteristics may lead to loss of motorcycle control which could result in serious injury or death.

⚠ WARNING

If, after fitting this accessory kit, you have any doubt about the performance of any aspect of the motorcycle, contact a competent person with the specialist knowledge and technical understanding of motorcycles, such as an authorised Triumph dealer.

Riding a motorcycle when there is any doubt as to any aspect of the performance of the motorcycle may lead to loss of motorcycle control which could result in serious injury or death.

⚠ WARNING

Never ride an accessory-equipped motorcycle at speeds above 80 mph (130 km/h).

Remember that the 80 mph (130 km/h) limit will be reduced by the fitting of non-approved accessories, incorrect loading, worn tyres, overall motorcycle condition and poor road or weather conditions.

The presence of accessories will cause changes in the stability and handling of the motorcycle. Failure to allow for changes in motorcycle stability may lead to loss of motorcycle control which could result in serious injury or death.

⚠ WARNING

High-speed operation should only be attempted by riders who have been instructed in the techniques necessary for high-speed riding and are familiar with the motorcycle's characteristics in all conditions.

Only operate this Triumph motorcycle at high speed in closed-course, on-road competition or on closed-course racetracks.

High-speed operation in any other circumstances is dangerous and may lead to loss of motorcycle control which could result in serious injury or death.

NOTICE

The motorcycle must not be operated above the legal road speed limit except in closed-course conditions.