



Accessory Fitting Instructions

Thank you for choosing this Triumph genuine accessory kit. This accessory kit is the product of Triumph's use of proven engineering, exhaustive testing, and continuous striving for superior reliability, safety and performance.

Completely read all of these instructions before commencing the installation of the accessory kit in order to become thoroughly familiar with the kit's features and the installation process.

These instructions should be considered a permanent part of your accessory kit, and should remain with it even if your accessory equipped motorcycle is subsequently sold.

Tail Bag Kit	
Kit Number	Models
A9518002	Scrambler 1200 XE from VIN BP0885, Scrambler 1200 X

Parts supplied

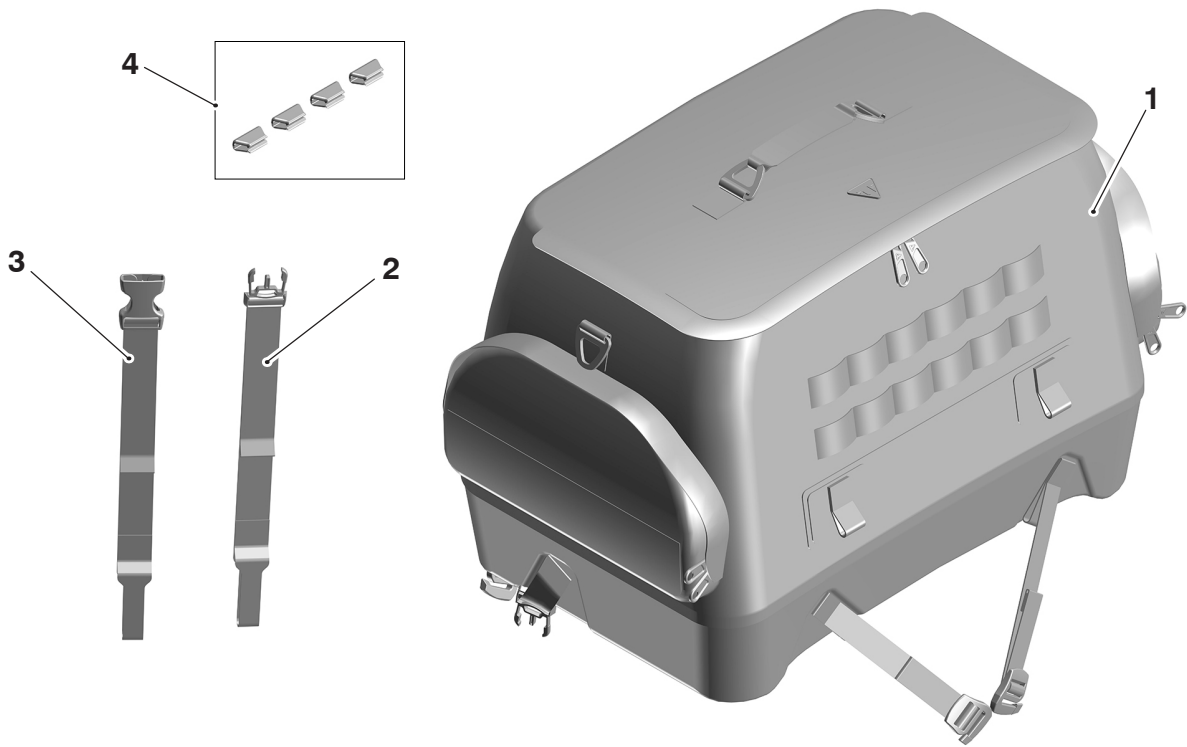

1. Tail bag	1 off	2. Retaining strap, male clip	1 off
3. Retaining strap, female clip	1 off	4. Clips	4 off

⚠ WARNING

Fit only genuine Triumph accessories to those models approved by Triumph as listed in the associated Triumph fitting instructions.

The accessory kits covered in this instruction are designed for use on specific models of Triumph motorcycle. The accessory kits and the models applicable are listed at the start of the instruction. They should never be fitted to any other Triumph model or to any other manufacturer's motorcycle.

Fitting an accessory kit to a Triumph model not listed, or to any other manufacturer's motorcycle, will affect the performance, stability and handling of the motorcycle.

Failure to follow the advice above may lead to loss of motorcycle control which could result in serious injury or death.

⚠ WARNING

Always have Triumph approved parts, accessories and conversions fitted by a competent person with the specialist knowledge and technical understanding of motorcycles, such as an authorised Triumph dealer.

The fitment of parts, accessories and conversions by a person without the specialist knowledge and technical understanding of motorcycles may affect the handling, stability or other aspects of the motorcycle's operation.

Failure to follow the advice above may lead to loss of motorcycle control which could result in serious injury or death.

⚠ WARNING

A torque wrench of known accurate calibration must be used when fitting this accessory kit.

Failure to tighten any of the fasteners to the correct torque specification may affect motorcycle performance, handling and stability.

Failure to follow the advice above may lead to loss of motorcycle control which could result in serious injury or death.

⚠ WARNING

Make sure the motorcycle is stabilised and adequately supported.

Do not support the motorcycle on any ancillary component, the exhaust system or any other non structural parts of the motorcycle frame.

A correctly supported motorcycle will help prevent it from falling.

An unstable motorcycle may fall resulting in motorcycle damage, serious injury or death.

NOTICE

Triumph offers a broad range of approved genuine accessories for your motorcycle.

We cannot therefore cover all possible equipment variations in these instructions. For removal and installation of Triumph Genuine Accessories, always refer to the instructions supplied with the respective accessory kit.

To obtain additional copies of any Triumph accessory instructions, visit www.triumphinstructions.com or contact your authorised Triumph dealer.

Fitment of Retaining Straps to Luggage Rack

⚠ WARNING

If the motorcycle is fitted with a luggage rack the tail bag must be fitted to the luggage rack and not to the bench seat.

Fitting a tail bag to a bench seat and carrying additional load on a luggage rack may cause the motorcycle to become unstable and lead to loss of motorcycle control which could result in serious injury or death.

1. Collect the retaining strap with the female clip from the kit.
2. Feed the loop end of the retaining strap through the rear slot underneath the grab rail on the left side of the luggage rack. Pass the clip through the loop, and tighten as shown.

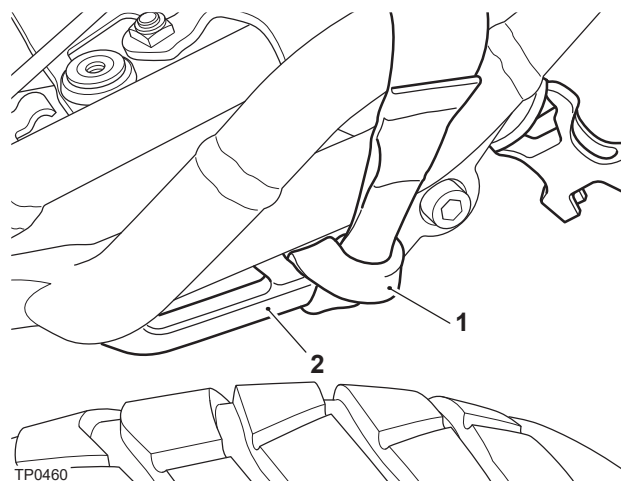

1. Retaining strap, female clip
2. Grab rail slot
3. Collect the retaining strap with the male clip from the kit.
4. Feed the loop end of the retaining strap through the rear slot underneath the grab rail on the right side of the luggage rack. Pass the clip through the loop, and tighten.

- Attach the clips to the luggage rack on both sides.

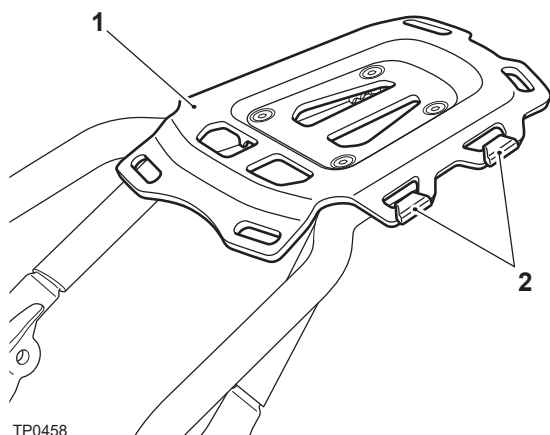

- Luggage rack
- Clips

- Position the tail bag with the Triumph logo facing to the rear.
- Slide the tail bag onto the luggage rack, making sure the luggage rack goes through the sleeve on the underside of the bag.
- Attach the left hand retaining strap to the left hand fixed clip on the left side of the tail bag.

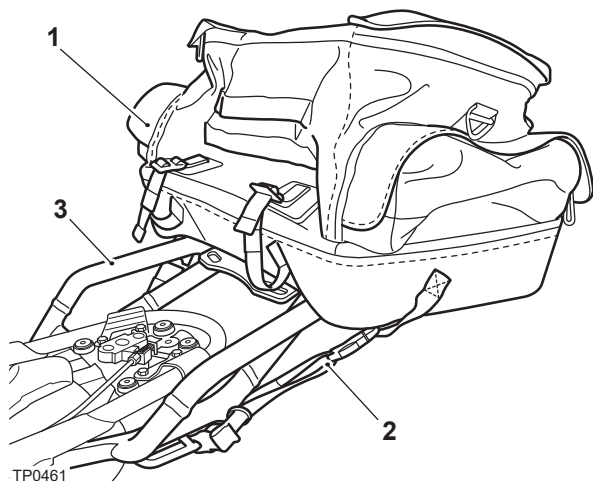

- Tail bag
- Retaining strap
- Luggage rack

- Repeat for the right hand side.
- Make sure the G-clip straps on both sides are attached to the retaining loops on the bag.
- Adjust the straps all around making sure the tail bag is secure.

- Make sure any loose strap is rolled and secured in the securing loop.

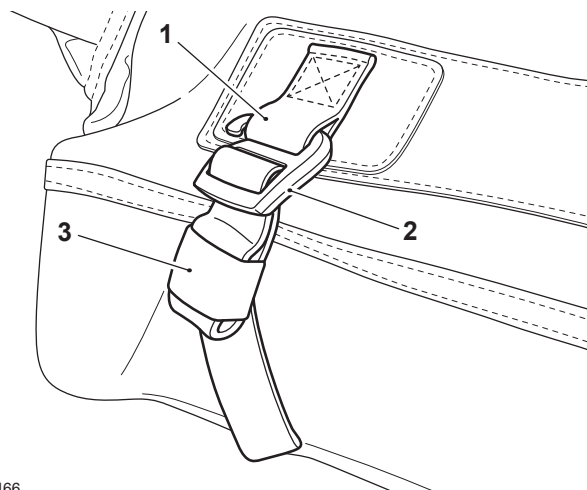

- Retaining loop
- G-clip
- Securing loop

NOTICE

Any excess unsecured strap close to motorcycle components may cause damage to the motorcycle.

Fitment of Retaining Straps to a Bench Seat

NOTICE

The male and female clip retaining straps are not required when fitting the tail bag to the bench seat.

- Remove the seat as described in the Service Manual.
- Locate the webbing loops on the underside of the seat.

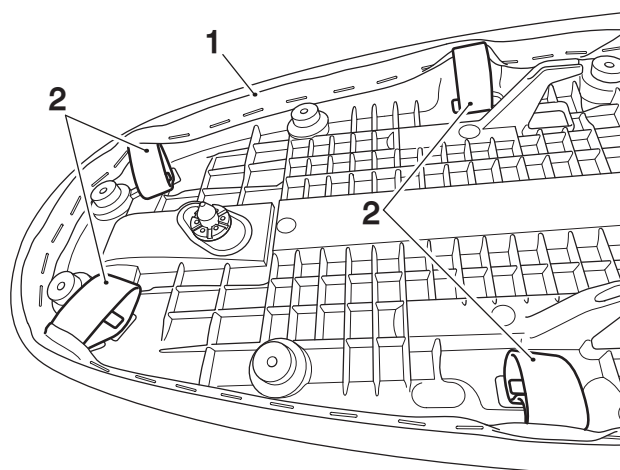

- Seat base
- Webbing loops

15. Release the webbing loops from the retaining hooks on the seat base.

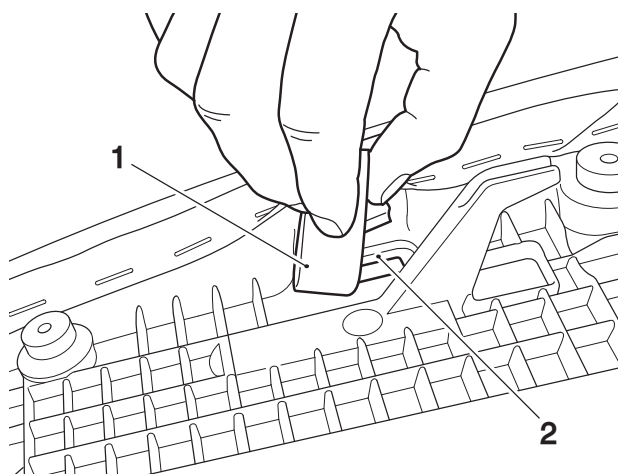

- 1. Webbing loop**
2. Retaining hook

16. Refit the seat as described in the Service Manual making sure the webbing loops are positioned on the outside of the seat, left hand side shown.

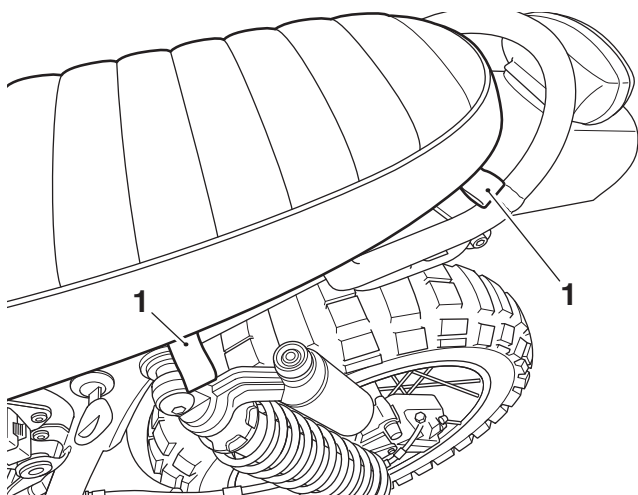

- 1. Webbing loops**

17. Position the tail bag on rear of the seat with the Triumph logo facing the rear.

18. Fit the front G-clip fixed to the tail bag onto the front webbing loop on the left hand side of the seat.

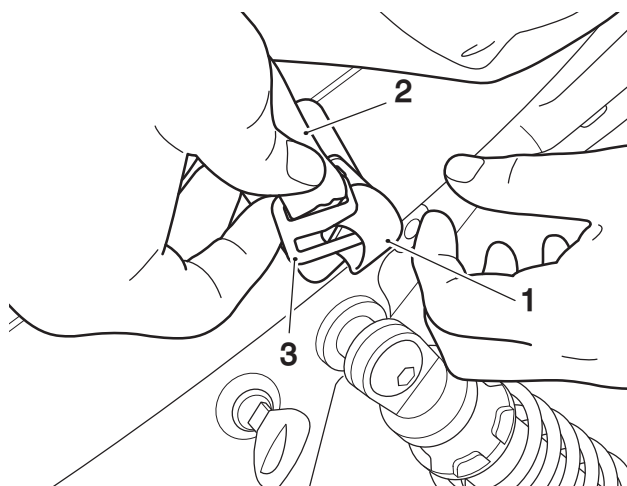

- 1. Webbing loop**
2. Retaining strap
3. G-clip, outer section

19. Fit the rear G-clip on the fixed luggage onto the rear webbing loop on the left hand side of the seat.

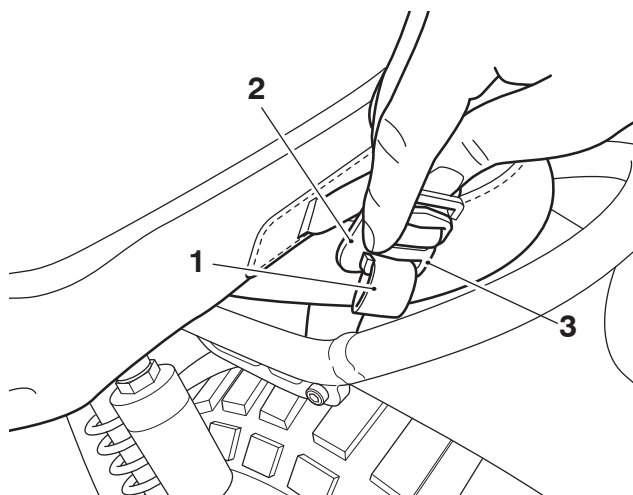

- 1. Webbing loop**
2. Retaining strap
3. G-clip, inner section

20. Repeat step 17 and 18 for the right hand side of the seat.
21. Adjust the straps all around making sure the tail bag is secure.

22. Make sure any loose strap is rolled and secured in the securing loop on the retaining strap.

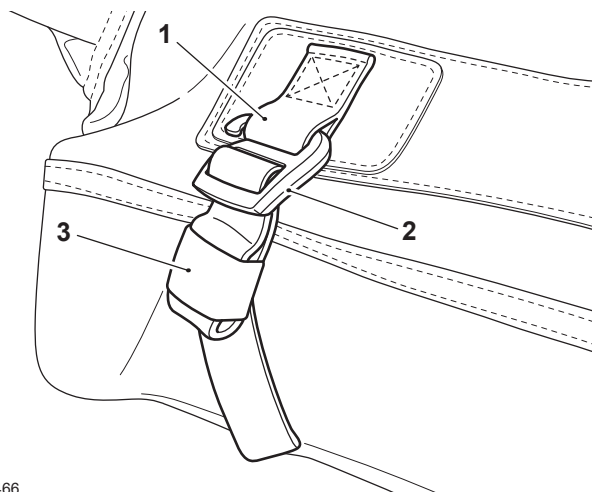

TP0466

- 1. Retaining loop
- 2. G-clip
- 3. Securing loop

NOTICE

Any excess unsecured strap close to motorcycle components may cause damage to the motorcycle.

Care of Tail Bag

NOTICE

Use of chemicals or high-pressure spray washers is not recommended for cleaning the bag. Using chemicals or pressure washers may damage the bag.

NOTICE

The bag is constructed from natural materials therefore scratches and scuffs will develop naturally, enhancing the appearance of the tank bag.

To maintain the appearance of your product, we recommend that you periodically clean the bag. Your Triumph bag is made from natural products and a lack of care can result in damage and permanent wear.

Frequent, regular cleaning is an essential part of the maintenance of your bag. If regularly cleaned, the appearance will be preserved for many years. Cleaning with cold water and a sponge is essential at all times but particularly so after exposure to sea breezes, sea water, dusty or muddy roads and in winter when roads are treated for ice and snow. A brush can be used to remove dirt or grit in extreme circumstances.

Do not use hot water or household detergent, as the use of such products will lead to premature deterioration.

Although, under the terms of your motorcycle warranty, cover is provided, the owner is expected to observe this reasonable advice which will safeguard against premature deterioration and enhance the appearance of the motorcycle.

Follow these simple instructions below to maintain the look of the bag:

- Do not use household cleaning products, bleach, detergents containing bleach or any kind of solvent to clean the bag; use a damp sponge only.
- Do not immerse the bag in water.
- Do not store items such as damp or wet clothing inside the bag as this can cause damage to the material or the stored items.
- Avoid direct heat from fires and radiators which can dry out and distort the bag.
- Avoid direct sunlight for extended periods which can dry out and discolour the material.
- Do not dry the bag by applying direct heat to them at any time.
- If the bag does get wet, absorb any excess water with a soft clean cloth then leave the product to dry naturally at room temperature.
- Avoid exposing the bag to high levels of salt, for example sea/salt water or road surfaces that have been treated during the winter for ice and snow.
- If exposure to salt is unavoidable, clean your bag immediately after each exposure using a damp sponge then leave the bag to dry naturally at room temperature.
- Allow mud to dry before wiping off. Use a soft cloth to remove the mud then leave the bag to dry naturally at room temperature.
- Gently clean any minor marks with a damp sponge then leave the bag to dry naturally at room temperature.
- Place the bag into a fabric bag or cardboard box to protect them when in storage. Do not put the bag into a plastic bag.

⚠ WARNING

Always ensure that any load carried on the luggage rack is correctly secured such that it will not move around while the motorcycle is in motion.

An adhesive label on the luggage rack details the maximum safe load for the luggage rack, which is 3 kg (6.6 lbs).

Incorrect loading may result in an unsafe riding condition.

Failure to follow the advice above could result in serious injury or death.

⚠ WARNING

After fitting the accessory kit the motorcycle will exhibit new handling characteristics.

Operate the motorcycle in a safe area free from traffic to gain familiarity with any new characteristics.

Operation of the motorcycle when not familiar with any new handling characteristics may lead to loss of motorcycle control which could result in serious injury or death.

⚠ WARNING

If, after fitting this accessory kit, you have any doubt about the performance of any aspect of the motorcycle, contact a competent person with the specialist knowledge and technical understanding of motorcycles, such as an authorised Triumph dealer.

Riding a motorcycle when there is any doubt as to any aspect of the performance of the motorcycle may lead to loss of motorcycle control which could result in serious injury or death.

⚠ WARNING

Never ride an accessory-equipped motorcycle at speeds above 80 mph (130 km/h).

Remember that the 80 mph (130 km/h) limit will be reduced by the fitting of non-approved accessories, incorrect loading, worn tyres, overall motorcycle condition and poor road or weather conditions.

The presence of accessories will cause changes in the stability and handling of the motorcycle. Failure to allow for changes in motorcycle stability may lead to loss of motorcycle control which could result in serious injury or death.

⚠ WARNING

High-speed operation should only be attempted by riders who have been instructed in the techniques necessary for high-speed riding and are familiar with the motorcycle's characteristics in all conditions.

Only operate this Triumph motorcycle at high speed in closed-course, on-road competition or on closed-course racetracks.

High-speed operation in any other circumstances is dangerous and may lead to loss of motorcycle control which could result in serious injury or death.

NOTICE

The motorcycle must not be operated above the legal road speed limit except in closed-course conditions.