



Accessory Fitting Instructions

Thank you for choosing this Triumph genuine accessory kit. This accessory kit is the product of Triumph's use of proven engineering, exhaustive testing, and continuous striving for superior reliability, safety and performance.

Completely read all of these instructions before commencing the installation of the accessory kit in order to become thoroughly familiar with the kit's features and the installation process.

These instructions should be considered a permanent part of your accessory kit, and should remain with it even if your accessory equipped motorcycle is subsequently sold.

Rugged Pannier	
Kit Number	Models
A9518007	Scrambler 1200 X, Scrambler 1200 XE from VIN BP0885
Pannier Fit Kit	
Kit Number	Models
A9510700	Scrambler 1200 X, Scrambler 1200 XE from VIN BP0885

Parts Supplied: A9518007

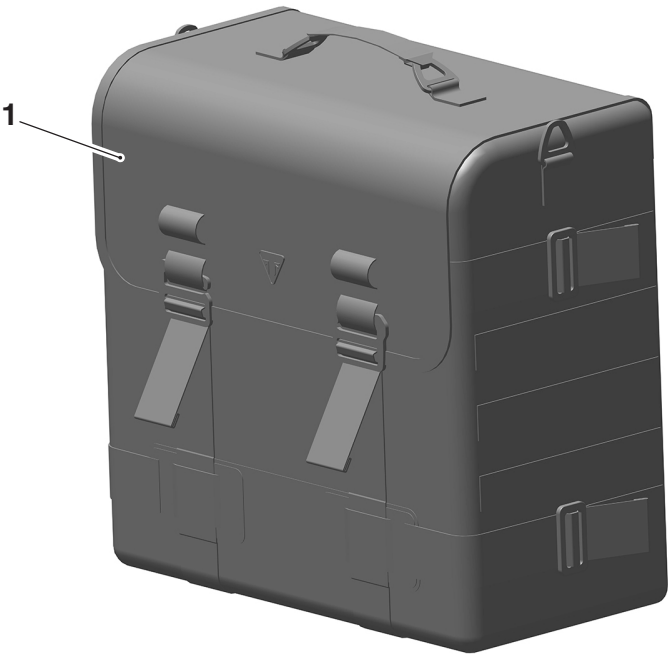

1. Rugged pannier	1 off
-------------------	-------

Parts Supplied: A9510700

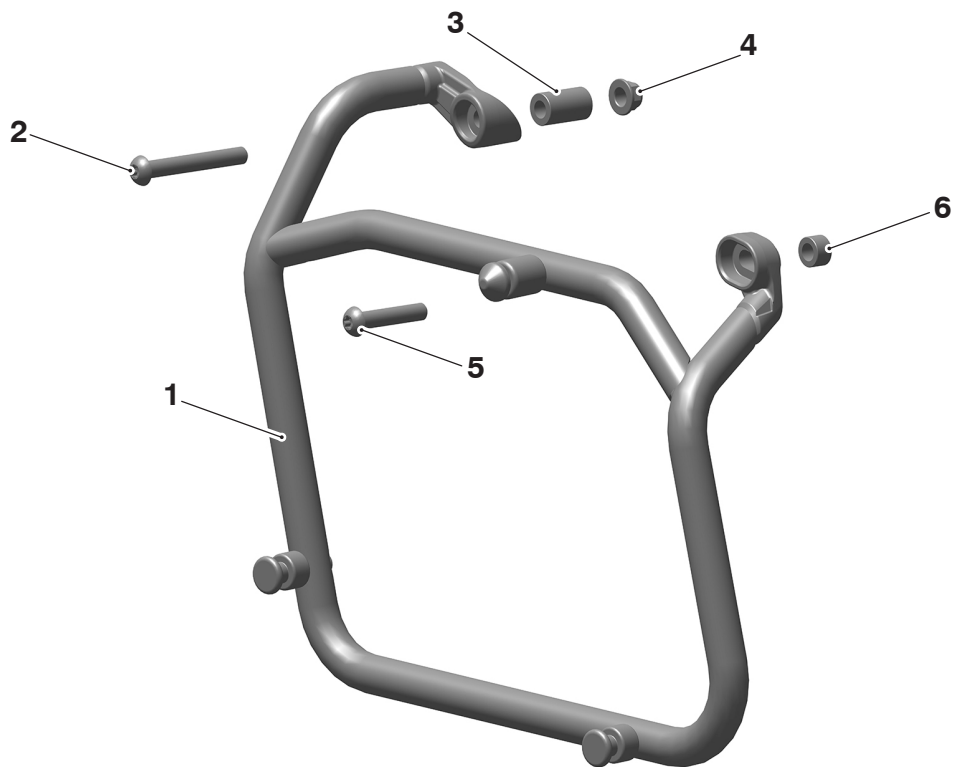

1. Pannier rail	1 off	4. Lock nut, M8	1 off
2. Fixing, M8 x 60 mm	3 off	5. Fixing, M8 x 40 mm	1 off
3. Spacer, 25 mm	3 off	6. Spacer, 8.5 mm	1 off

⚠ WARNING

Fit only genuine Triumph accessories to those models approved by Triumph as listed in the associated Triumph fitting instructions.

The accessory kits covered in this instruction are designed for use on specific models of Triumph motorcycle. The accessory kits and the models applicable are listed at the start of the instruction. They should never be fitted to any other Triumph model or to any other manufacturer's motorcycle.

Fitting an accessory kit to a Triumph model not listed, or to any other manufacturer's motorcycle, will affect the performance, stability and handling of the motorcycle.

Failure to follow the advice above may lead to loss of motorcycle control which could result in serious injury or death.

⚠ WARNING

Always have Triumph approved parts, accessories and conversions fitted by a competent person with the specialist knowledge and technical understanding of motorcycles, such as an authorised Triumph dealer.

The fitment of parts, accessories and conversions by a person without the specialist knowledge and technical understanding of motorcycles may affect the handling, stability or other aspects of the motorcycle's operation.

Failure to follow the advice above may lead to loss of motorcycle control which could result in serious injury or death.

⚠ WARNING

A torque wrench of known accurate calibration must be used when fitting this accessory kit.

Failure to tighten any of the fasteners to the correct torque specification may affect motorcycle performance, handling and stability.

Failure to follow the advice above may lead to loss of motorcycle control which could result in serious injury or death.

⚠ WARNING

Make sure the motorcycle is stabilised and adequately supported.

Do not support the motorcycle on any ancillary component, the exhaust system or any other non structural parts of the motorcycle frame.

A correctly supported motorcycle will help prevent it from falling.

An unstable motorcycle may fall resulting in motorcycle damage, serious injury or death.

NOTICE

Triumph offers a broad range of approved genuine accessories for your motorcycle.

We cannot therefore cover all possible equipment variations in these instructions. For removal and installation of Triumph Genuine Accessories, always refer to the instructions supplied with the respective accessory kit.

To obtain additional copies of any Triumph accessory instructions, visit www.triumphinstructions.com or contact your authorised Triumph dealer.

Fitment of Pannier Rail

1. Remove the seat and underseat moulding, as described in the Service Manual.
2. Remove the grab rail fixings, front and rear, from the left hand side of the motorcycle. Retain the fixings for reuse if the motorcycle is to be returned to its original condition.
3. Fit the 8.5 mm spacer and M8 x 40 mm fixing from the kit to the pannier rail rear mounting position, as shown.

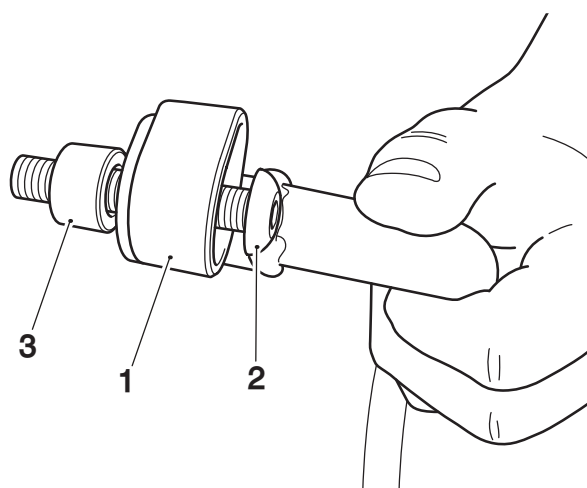

1. Pannier rail rear mounting
2. Fixing, M8 x 40 mm
3. Spacer, 8.5 mm

4. Align the pannier rail with the rear grab rail fixing position on the left hand side of the motorcycle. Fit the M8 x 40 mm fixing to the grab rail, do not fully tighten the fixing at this stage.

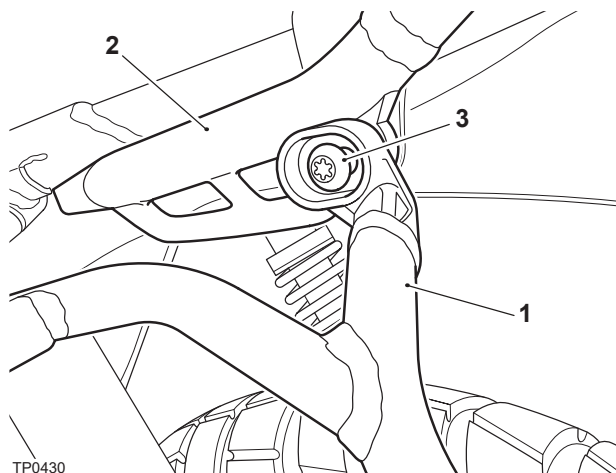

1. Pannier rail
2. Grab rail
3. Fixing, M8 x 40 mm

5. Fit the 25 mm spacer and M8 x 60 mm fixing from the kit to the pannier rail front mounting position, as shown. Align the pannier rail with the front grab rail fixing position.

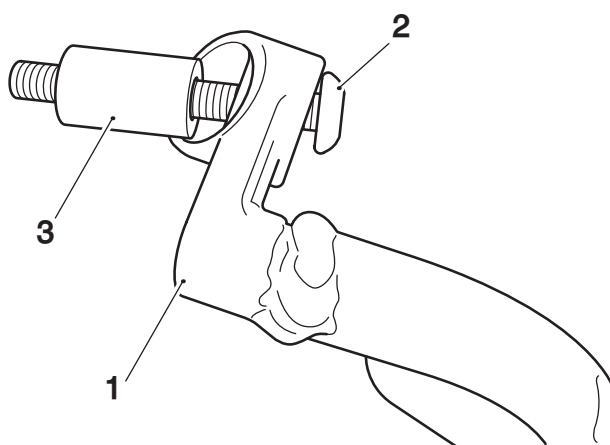

1. Pannier rail front mounting
2. Fixing, M8 x 60 mm
3. Spacer, 25 mm

6. Align the pannier rail with the front grab rail fixing position. Fit the M8 x 60 mm fixing through the grab rail and motorcycle frame and fit the M8 lock nut from the kit, as shown.

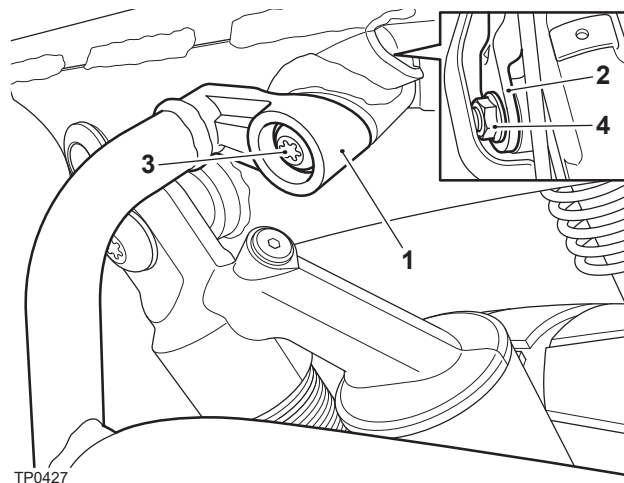

1. Pannier rail
2. Grab rail
3. Fixing, M8 x 60 mm
4. Lock nut, M8

7. Tighten the pannier rail fixings to **28 Nm**.

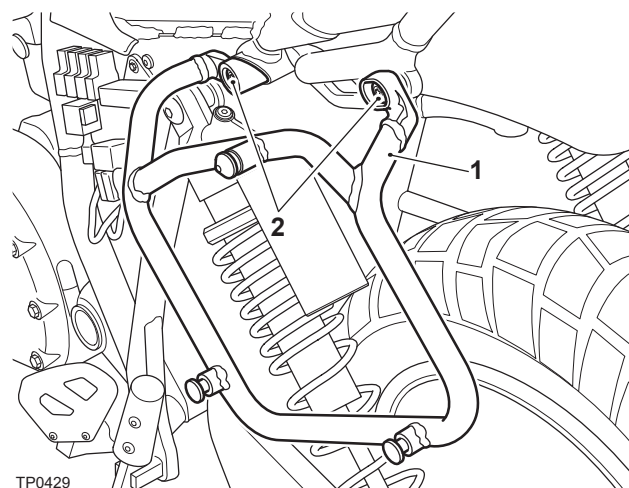

1. Pannier rail
2. Fixings

8. Refit the seat and underseat moulding, as described in the Service Manual.

Fitment of Lock Barrel

1. Fit the ignition key in to the lock barrel lock supplied with the motorcycle when new.

- Turn the ignition key clockwise to remove the lock barrel from its protective case.

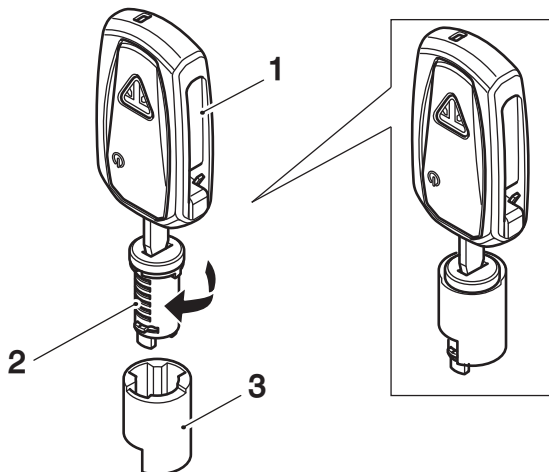

- Ignition key
- Lock barrel
- Protective case

NOTICE

The lock barrel will only fit one way.

- Align the tumblers on the lock barrel to the slot in the pannier lock housing and push the barrel into position until it clicks into place.

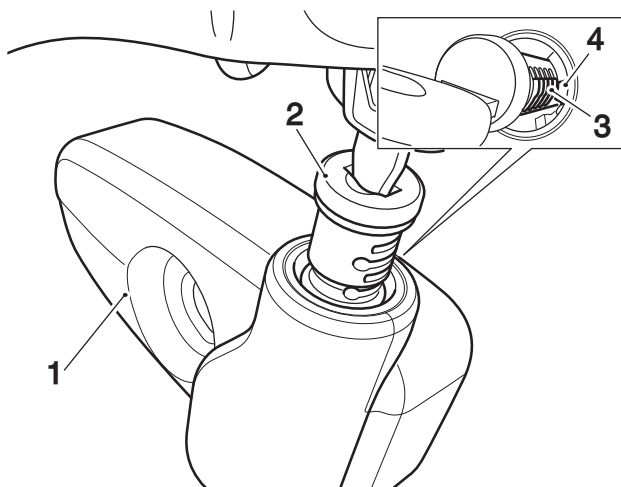

- Pannier lock housing
- Lock barrel
- Tumblers
- Slot

- Check the operation of the barrel. Remove the key.

Pannier Installation

- Align the three pannier mounts on the rear of the pannier with the pegs on the pannier rail.

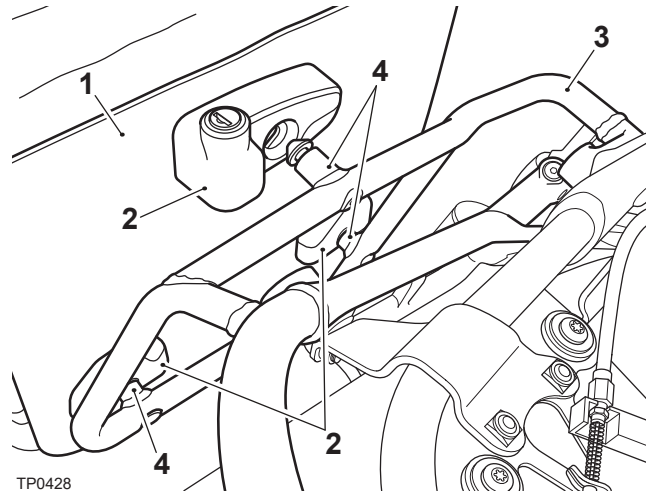

TP0428

- Pannier bag
- Pannier mounts
- Pannier rail
- Pegs

- Push the pannier towards the frame of the motorcycle to fully engage the pannier mounts on the pegs. There should be an audible click sound from the pannier latch mount when the pannier is fully engaged.
- Pull the pannier away from the frame to make sure it is correctly engaged on the pannier rail and cannot become detached. Make sure any loose straps are tight and neatly stowed.
- Use the key to release the pannier.

Closing the Pannier

- When the contents have been placed in the pannier, pull the waterproof compartment up and while holding the top of the top closed fold it over repeatedly to take up any excess space. Clip the compartment ends together to secure waterproof compartment.
- Close the pannier and secure with the G-clips.

7. Make sure all loose strap is fed back through the securing loops on both sides as shown.

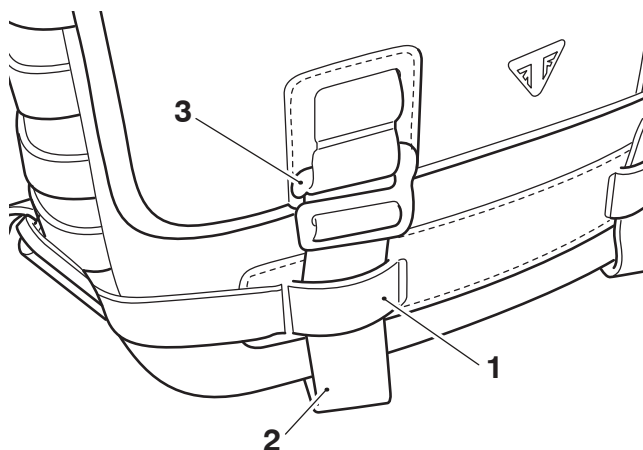

1. Securing loop
2. Strap
3. G-clip

⚠ WARNING

The maximum safe load for the pannier is 5 kg (11 lbs).

Never exceed the maximum safe load limit as this may lead to loss of motorcycle control which could result in serious injury or death.

Care of Panniers

NOTICE

Use of chemicals or high-pressure spray washers is not recommended for cleaning the panniers. Using chemicals or pressure washers may damage the panniers.

NOTICE

The panniers are constructed from natural materials therefore scratches and scuffs will develop naturally, enhancing the appearance of the panniers.

To maintain the appearance of your product, we recommend that you periodically clean the panniers. Your Triumph panniers are natural products and a lack of care can result in damage and permanent wear.

Frequent, regular cleaning is an essential part of the maintenance of your panniers. If regularly cleaned, the appearance will be preserved for many years. Cleaning with cold water and a sponge is essential at all times but particularly so after exposure to sea breezes, sea water, dusty or muddy roads and in winter when roads are treated for ice and snow. A brush can be used to remove dirt or grit in extreme circumstances.

Do not use hot water or household detergent, as the use of such products will lead to premature deterioration.

Although, under the terms of your motorcycle warranty, cover is provided, the owner is expected to observe this reasonable advice which will safeguard against premature deterioration and enhance the appearance of the motorcycle.

Follow these simple instructions below to maintain the look of the panniers:

- Do not use household cleaning products, bleach, detergents containing bleach or any kind of solvent to clean the panniers; use a damp sponge only.
- Do not immerse the panniers in water.
- Do not store items such as damp or wet clothing inside the panniers as this can cause damage to the material or the stored items.
- Avoid direct heat from fires and radiators which can dry out and distort the panniers.
- Avoid direct sunlight for extended periods which can dry out and discolour the material.
- Do not dry the panniers by applying direct heat to them at any time.
- If the panniers do get wet, absorb any excess water with a soft clean cloth then leave the product to dry naturally at room temperature.
- Avoid exposing the panniers to high levels of salt, for example sea/salt water or road surfaces that have been treated during the winter for ice and snow.
- If exposure to salt is unavoidable, clean your product immediately after each exposure using a damp sponge then leave the product to dry naturally at room temperature.
- Allow mud to dry before wiping off. Use a soft cloth to remove the mud then leave them to dry naturally at room temperature.
- Gently clean any minor marks with a damp sponge then leave them to dry naturally at room temperature.
- Place the product into a fabric bag or cardboard box to protect them when in storage. Do not put the panniers into a plastic bag.

⚠ WARNING

After fitting the accessory kit the motorcycle will exhibit new handling characteristics.

Operate the motorcycle in a safe area free from traffic to gain familiarity with any new characteristics.

Operation of the motorcycle when not familiar with any new handling characteristics may lead to loss of motorcycle control which could result in serious injury or death.

⚠ WARNING

If, after fitting this accessory kit, you have any doubt about the performance of any aspect of the motorcycle, contact a competent person with the specialist knowledge and technical understanding of motorcycles, such as an authorised Triumph dealer.

Riding a motorcycle when there is any doubt as to any aspect of the performance of the motorcycle may lead to loss of motorcycle control which could result in serious injury or death.

⚠ WARNING

Never ride an accessory-equipped motorcycle at speeds above 80 mph (130 km/h).

Remember that the 80 mph (130 km/h) limit will be reduced by the fitting of non-approved accessories, incorrect loading, worn tyres, overall motorcycle condition and poor road or weather conditions.

The presence of accessories will cause changes in the stability and handling of the motorcycle. Failure to allow for changes in motorcycle stability may lead to loss of motorcycle control which could result in serious injury or death.

⚠ WARNING

High-speed operation should only be attempted by riders who have been instructed in the techniques necessary for high-speed riding and are familiar with the motorcycle's characteristics in all conditions.

Only operate this Triumph motorcycle at high speed in closed-course, on-road competition or on closed-course racetracks.

High-speed operation in any other circumstances is dangerous and may lead to loss of motorcycle control which could result in serious injury or death.

NOTICE

The motorcycle must not be operated above the legal road speed limit except in closed-course conditions.