



Accessory Fitting Instructions

Mobile Phone Holder Kit. 140 mm x 90 mm	
Kit number	Models Affected
A9510323	Thrupton 1200, Thrupton 1200 R
Mobile Phone Holder Kit. 160 mm x 100 mm	
Kit number	Models Affected
A9510324	Thrupton 1200, Thrupton 1200 R
Mobile Phone Holder Kit. 70 mm x 130 mm	
Kit number	Models Affected
A9510325	Thrupton 1200, Thrupton 1200 R

Note:

- **The Mobile Phone Holder Kit must not be fitted to a motorcycle when a Tank Bag Kit is fitted.**

Thank you for choosing this Triumph genuine accessory kit. This accessory kit is the product of Triumph's use of proven engineering, exhaustive testing, and continuous striving for superior reliability, safety and performance.

Completely read all of these instructions before commencing the installation of the accessory kit in order to become thoroughly familiar with the kit's features and the installation process.

These instructions should be considered a permanent part of your accessory kit, and should remain with it even if your accessory-equipped motorcycle is subsequently sold.

Parts supplied

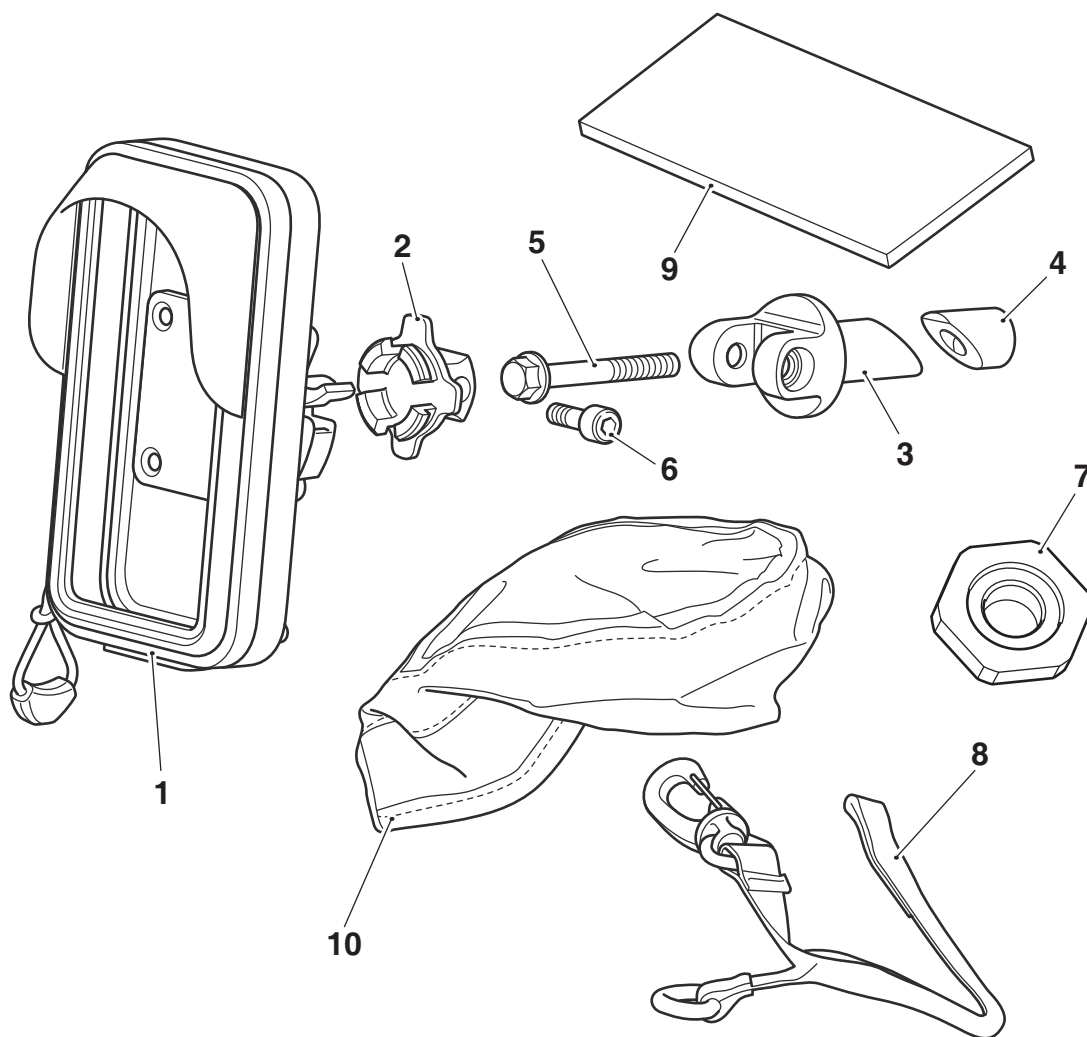

1. Holder, mobile phone	1 off	6. Screw, M6 x 16 mm	1 off
2. Mounting, phone holder	1 off	7. Nut, top yoke	1 off
3. Stem	1 off	8. Security strap	1 off
4. Tapered nut	1 off	9. Packing	1 off
5. Screw, M6 x 40 mm	1 off	10. Rain cover	1 off

Warning

The accessory kits covered in this instruction are designed for use on specific models of Triumph motorcycle. The accessory kits and the models applicable are listed at the start of the instruction. They should not be fitted to any other Triumph model or to any other manufacturer's motorcycle. Fitting an accessory kit to a Triumph model not listed, or to any other manufacturer's motorcycle will affect the performance, stability and handling of the motorcycle. This may affect the rider's ability to control the motorcycle and could cause an accident.

Warning

Always have Triumph approved parts, accessories and conversions fitted by a trained technician of an authorised Triumph dealer. The fitment of parts, accessories and conversions by a technician who is not of an authorised Triumph dealer may affect the handling, stability or other aspects of the motorcycle's operation which may result in loss of motorcycle control and an accident.

Warning

Throughout this operation, ensure that the motorcycle is stabilised and adequately supported to prevent risk of injury from the motorcycle falling.

Note:

- **Triumph offers a broad range of approved genuine accessories for your motorcycle. We cannot therefore cover all possible equipment variations in these instructions. For removal and installation of Triumph Genuine Accessories, always refer to the instructions supplied with the respective accessory kit. To obtain additional copies of any Triumph accessory instructions, visit www.triumphinstructions.com or contact your authorised Triumph dealer.**

Installing the Stem Assembly

1. Remove the original top yoke nut, as described in the Service Manual.

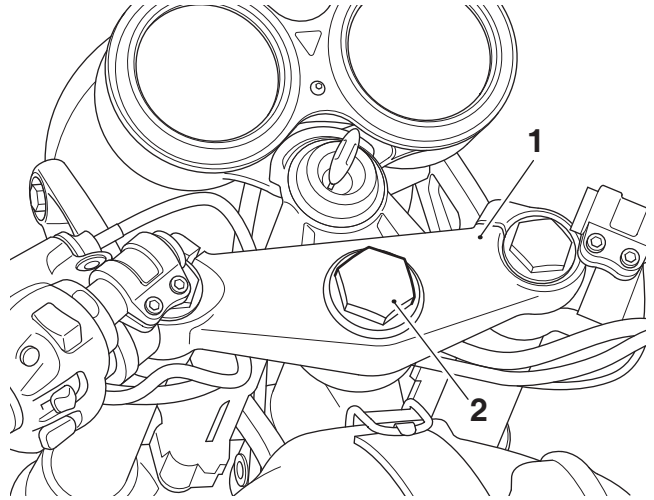

1. Top yoke
2. Nut

2. Fit the new top yoke nut provided and tighten to the torque specified for the original nut in the Service Manual.

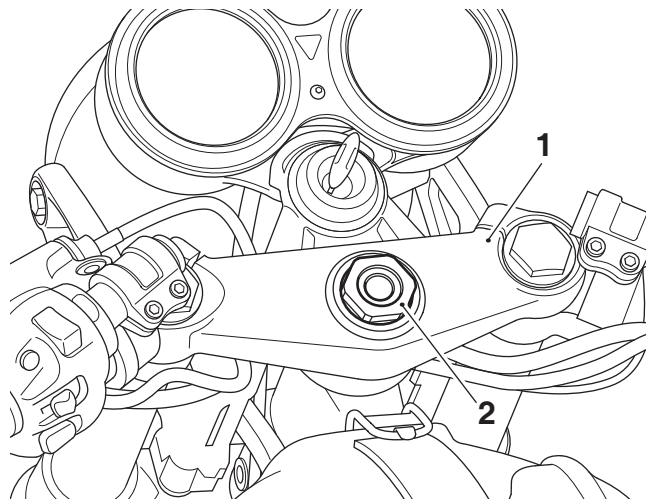

1. Top yoke
2. Nut

3. Collect the stem, tapered nut and M6 x 40 mm screw from the kit.

- Loosely assemble the stem, tapered nut and M6 x 40 mm screw, as shown below.

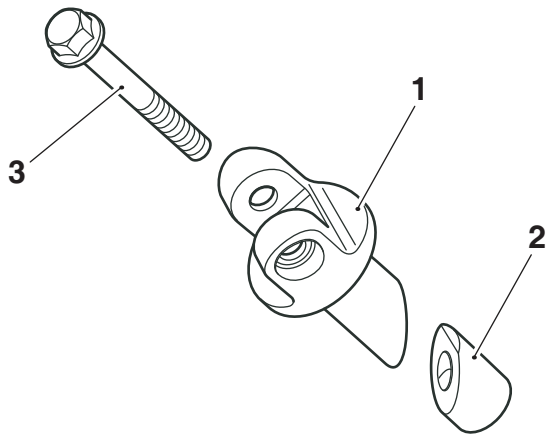

- Stem
- Tapered nut
- Screw, M6 x 40 mm

- Fit the stem assembly into the headstock, through the hole in the new top yoke nut. Ensure the aperture in the stem is aligned centrally, as shown. Tighten the screw to **8 Nm**.

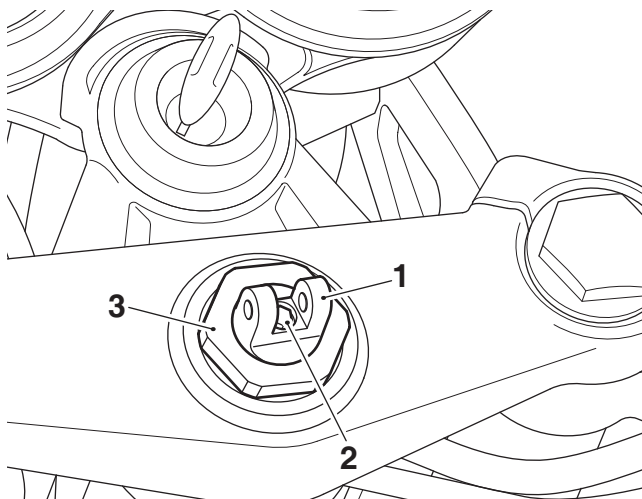

- Stem assembly
- Screw
- Nut, top yoke

- Fit the phone holder mounting to the stem, as shown and secure with the M6 x 16 mm screw. Do not fully tighten the screw at this stage.

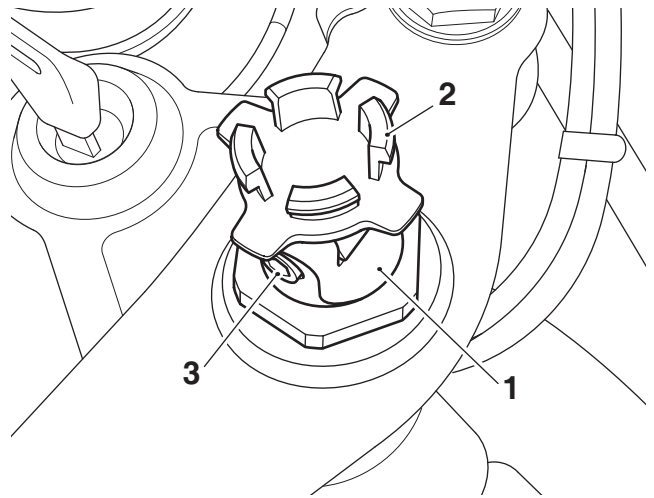

- Stem
- Mounting, phone holder
- Screw, M6 x 16 mm

Installing and Removing the Phone Holder

- Loosely fit the security strap around the stem on the top yoke and feed the plain end of the strap through the D-ring. Do not pull the strap tight around the stem at this stage to allow access to the M6 x 16 mm screw.

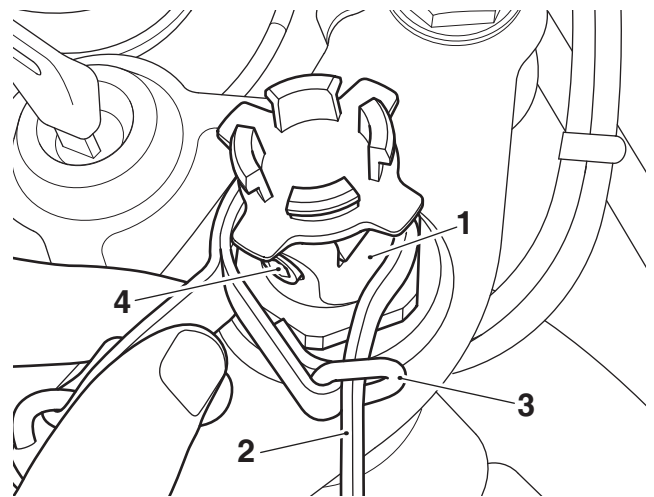

- Stem
- Security strap, plain end
- D-ring
- Screw, M6 x 16 mm

- Align the notch on the phone holder with the corresponding slot in the phone holder mounting and press the phone holder onto the mounting until a "click" is heard.

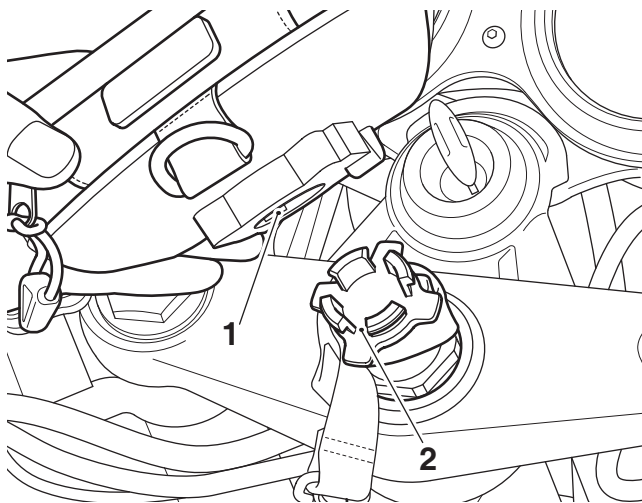

- Notch, phone holder
- Slot, phone holder mounting

- Adjust the phone holder to the desired position and tighten the M6 x 16 mm screw to **8 Nm**.



Caution

Move the handlebar to the left and right full lock while checking that the phone holder does not contact the fuel tank, or any other part of the motorcycle. This will result in damage to the fuel tank, or other parts of the motorcycle. Adjust the phone holder position as required to ensure the phone holder does not contact any part of the motorcycle.



Warning

When mounting a phone holder to the mounting, ensure the view to the instruments is not impaired.

If the view to the instruments is impaired, the rider may not be in full control of the motorcycle which could lead to an accident.



Warning

Move the handlebars to left and right full lock while checking that the phone holder does not restrict full lock operation. Any component that will restrict the steering may cause loss of control of the motorcycle and an accident.

- Pull the plain end of the security strap through the D-ring until the strap is tight around the phone holder stem. Fold the strap back around the stem to attach the hook and loop sections of the straps together.

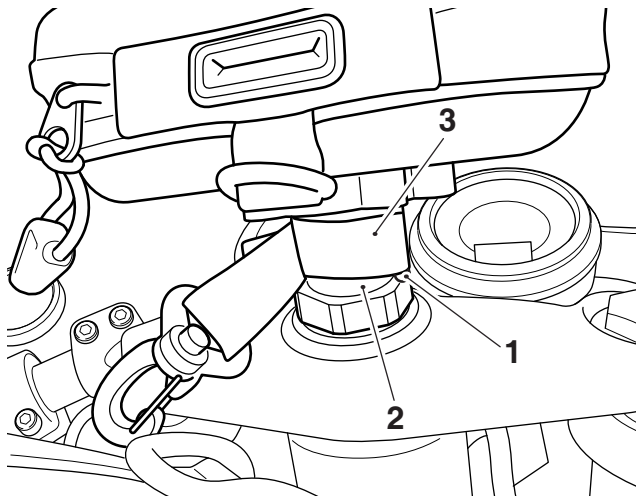

- D-ring
- Stem
- Straps, hook and loop sections

- Attach the security strap clip to the D-ring on the phone holder.

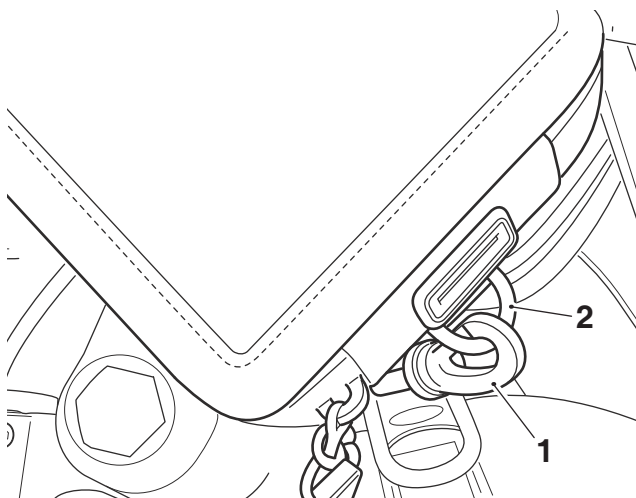

- Clip, security strap
- D-ring, phone holder

- To remove the phone holder first release the security strap from the D-ring on the phone holder.

13. Locate the red release lever on the right hand underside of the phone holder. Press the release lever and lift the phone holder clear of the mounting.

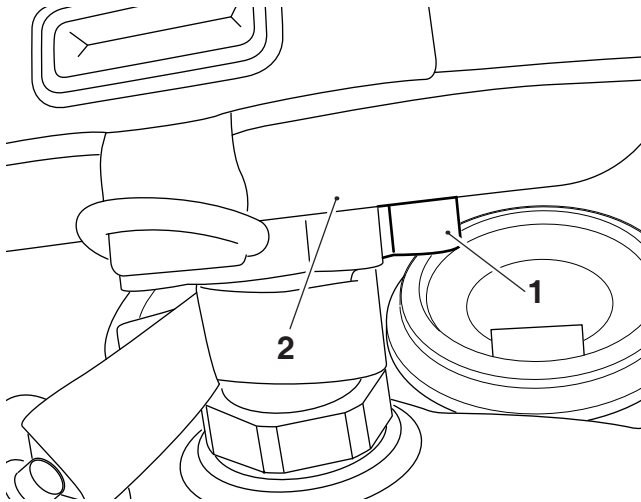

1. Release lever
2. Phone holder

Fitting a Mobile Phone into the Phone Holder

1. Unzip the clear cover on the phone holder and peel back the hook and loop straps, as shown.

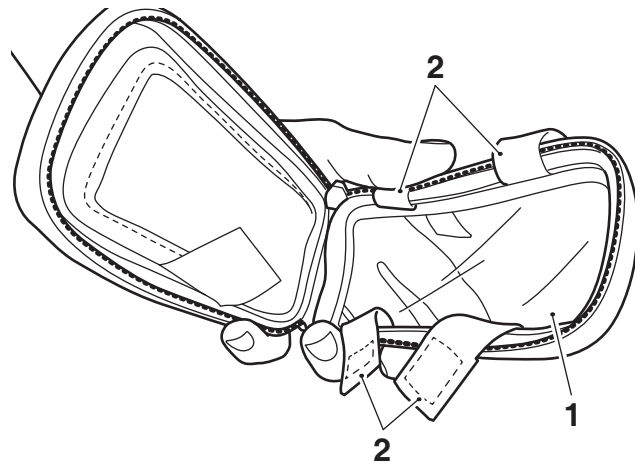

1. Clear cover, phone holder
2. Hook and loop straps

2. Place the mobile phone in the phone holder with the phone screen towards the clear plastic cover and secure in place with the hook and loop straps. If necessary, use the packing from the kit to ensure the mobile phone is correctly held in place.

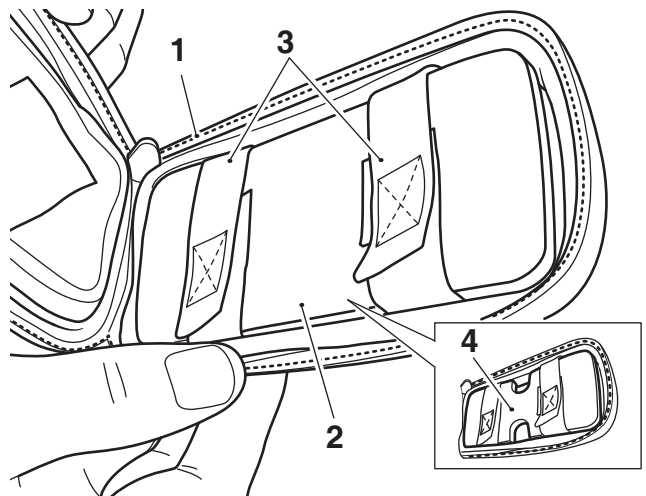

1. Phone holder
2. Mobile phone
3. Hook and loop straps
4. Packing

3. Ensure the zip on the phone holder is fully closed when the mobile phone has been installed.

Installing the Rain Cover

1. Slide the rain cover over the phone holder, as shown.

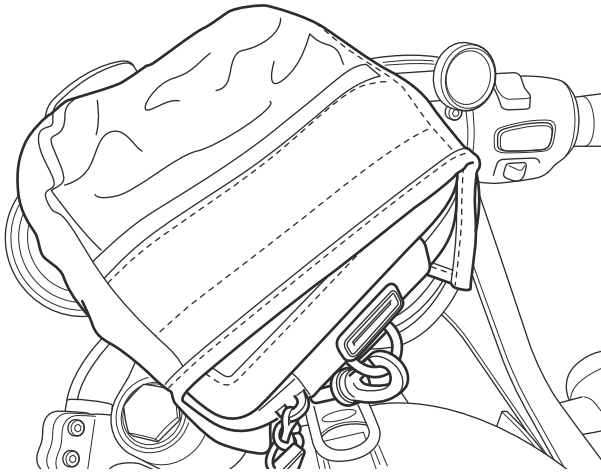

2. Squeeze the flaps on the rain cover together to attach the hook and loop pads and retain the rain cover in position.

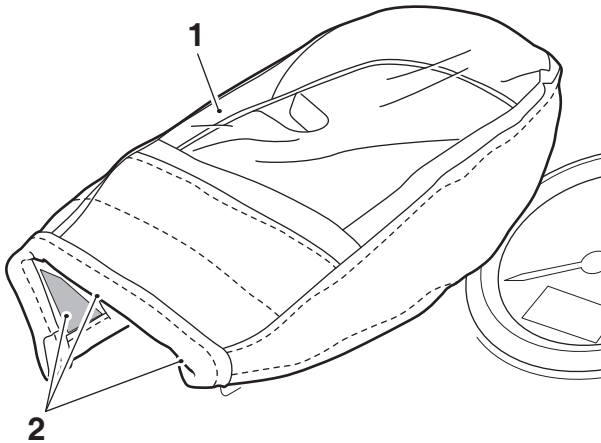

1. Rain cover
2. Hook and loop pads

3. During heavy rain conditions remove the mobile phone from the holder and place it in a suitable IP rated protector. The rain cover is only shower proof.



Danger

Do not use a mobile phone while you ride. Do not text while you ride. Do not attempt to adjust any GPS device while you ride. Telephone calls, texting or any attempt to use your mobile device for any purpose will distract you, this will cause accidents that can seriously injure or kill riders, passengers, occupants in other vehicles and pedestrians.



Warning

When connecting a power harness to the mobile phone holder, ensure the harness is routed correctly and cannot contact any hot surfaces of the motorcycle or interfere with any of the motorcycle controls. Contact with a hot surface may result in wiring harness damage and electrical malfunctions. Any interference with the motorcycle controls may cause loss of motorcycle control and an accident.



Warning

The maximum safe load for the phone holder is 250 grams (9 oz).

Never exceed the safe load limit as this may cause the motorcycle to become unstable leading to loss of motorcycle control and an accident.



Warning

After fitting the accessory kit the motorcycle will exhibit new handling characteristics. Operate the motorcycle in a safe area free from traffic to gain familiarity with any new characteristics. Operation of the motorcycle when not familiar with any new handling characteristics may result in loss of motorcycle control and an accident.

 **Warning**

If, after fitting this accessory kit, you have any doubt about the performance of any aspect of the motorcycle, contact an authorised Triumph dealer and do not ride the motorcycle until the authorised dealer has declared it fit for use. Riding a motorcycle when there is any doubt as to any aspect of the performance of the motorcycle may lead to loss of motorcycle control and an accident.

 **Warning**

Never ride an accessory-equipped motorcycle at speeds above 80 mph (130 km/h).

The presence of accessories will cause changes in the stability and handling of the motorcycle. Failure to allow for changes in motorcycle stability may lead to loss of control or an accident.

Remember that the 80 mph (130 km/h) limit will be reduced by the fitting of non-approved accessories, incorrect loading, worn tyres, overall motorcycle condition and poor road or weather conditions.

 **Warning**

The motorcycle must not be operated above the legal road speed limit except in closed-course conditions.

 **Warning**

Only operate this Triumph motorcycle at high speed in closed-course, on-road competition or on closed-course racetracks. High-speed operation should only be attempted by riders who have been instructed in the techniques necessary for high-speed riding and are familiar with the motorcycle's characteristics in all conditions.

High-speed operation in any other circumstances is dangerous and will lead to loss of motorcycle control and an accident.