

### Fitting Instructions:

### Street Triple, Street Triple R, Street Triple Rx, Daytona 675 and Daytona 675R A9510104

Thank you for choosing this Triumph genuine accessory kit. This accessory kit is the product of Triumph's use of proven engineering, exhaustive testing, and continuous striving for superior reliability, safety and performance.

Completely read all of these instructions before commencing the installation of the accessory kit in order to become thoroughly familiar with the kit's features and the installation process.

These instructions should be considered a permanent part of your accessory kit, and should remain with it even if your accessory-equipped motorcycle is subsequently sold.

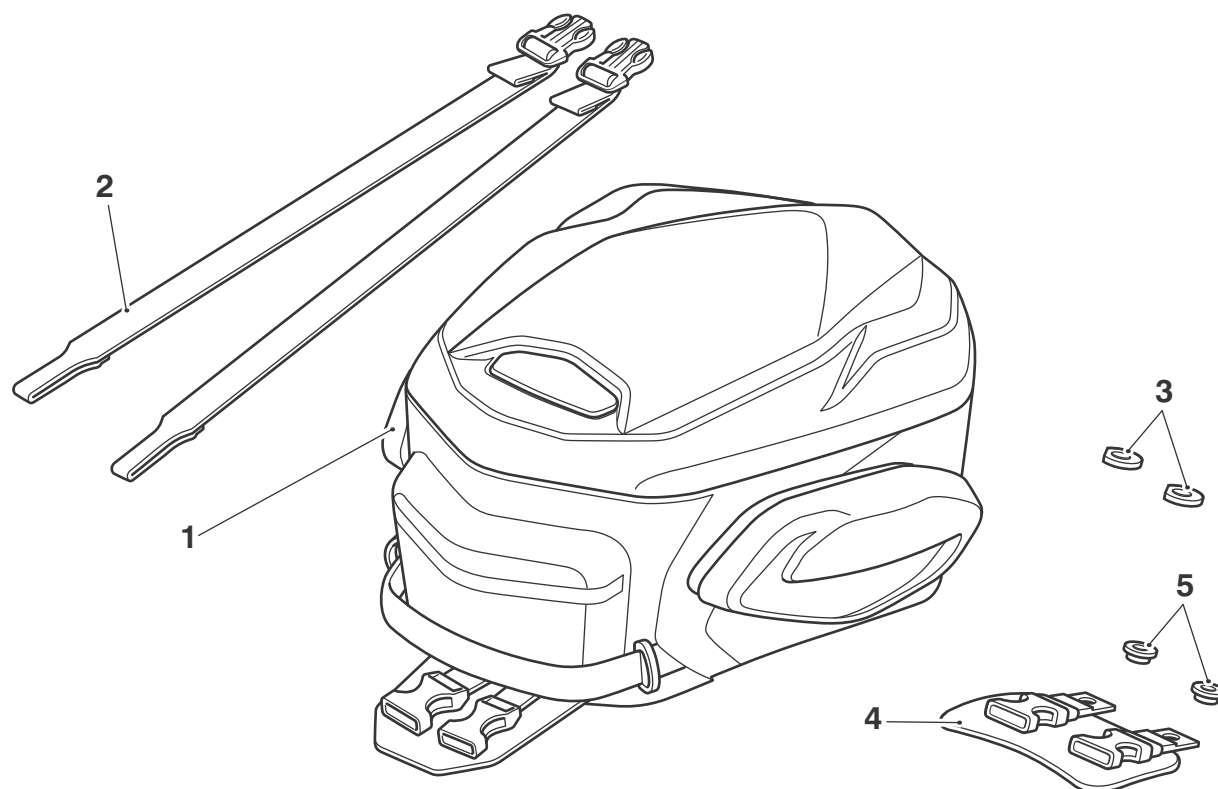

### Parts Supplied:

1. Tank bag, 15 - 20 litres	1 off	4. Front mount	1 off
2. Rear mounting strap	2 off	5. Compression limiter	2 off
3. D-washer (Street Triple to VIN 560476, Street Triple R to VIN 560476, Daytona 675 to VIN 564947 and Daytona 675R to VIN 564947 only)	2 off		

### **Warning**

This accessory kit is designed for use on Triumph Street Triple, Street Triple R, Street Triple Rx, Daytona 675 and Daytona 675R motorcycles only and should not be fitted to any other manufacturer's motorcycle. Fitting this accessory kit to any other manufacturer's motorcycle will affect the performance, stability and handling of the motorcycle. This may affect the rider's ability to control the motorcycle and could cause an accident.

### **Warning**

Always have Triumph approved parts, accessories and conversions fitted by a trained technician of an authorised Triumph dealer. The fitment of parts, accessories and conversions by a technician who is not of an authorised Triumph dealer may affect the handling, stability or other aspects of the motorcycle's operation, which may result in loss of motorcycle control and an accident.

### **Warning**

Throughout this operation, ensure that the motorcycle is stabilised and adequately supported to prevent risk of injury from the motorcycle falling.

### **Warning**

A torque wrench of known accurate calibration must be used when fitting this accessory kit. Failure to tighten any of the fasteners to the correct torque specification may result in loss of motorcycle control and an accident.

### **Warning**

Install the tank bag only in the positions described below. Installation of the tank bag in any other position on the motorcycle will affect the handling, stability or other aspects of the motorcycle's operation, which may result in loss of motorcycle control and an accident.

### **Warning**

Remove the shoulder strap(s) from the tank bag before mounting to the motorcycle.  
Operation of the motorcycle with the shoulder strap(s) fitted may result in loss of motorcycle control and an accident.

## Installing the Tank Bag Front Mount

### Note:

- **When using the tank bag, always pack heavier items at the bottom of the bag.**

1. Remove the seat, as described in the Owner's Handbook.
2. Remove the two front fuel tank fixings. Retain the screws for re-use, retain the washers if the motorcycle is to be returned to its original condition.

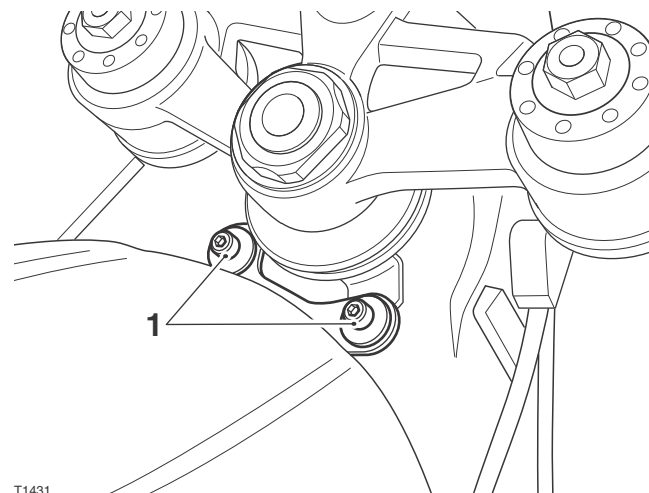

T1431

### 1. Fuel tank fixings

**Street Triple to VIN 560476,  
Street Triple R to VIN 560476,  
Daytona 675 to VIN 564947 and  
Daytona 675R to VIN 564947**

3. Collect the front mount, compression limiters and D-washers from the kit.
4. Fit the compression limiters, D-washers and original fixings to the front mount, as shown.

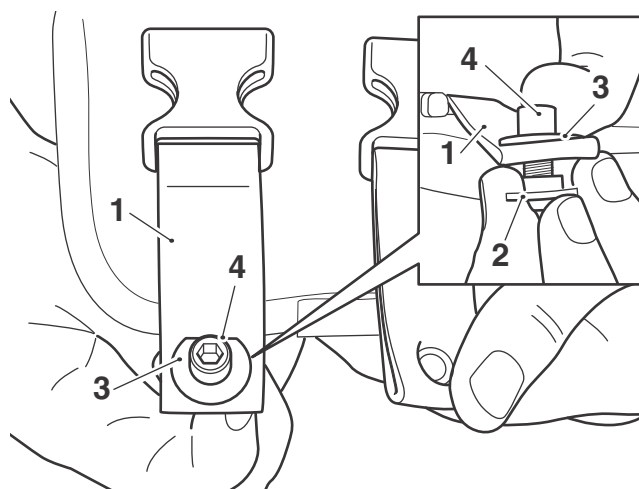

1. Front mount
2. Compression limiter
3. D-washer
4. Fixing

**Note:**

- **When fitting the front mount to the fuel tank fixing position, ensure the compression limiters remain correctly located in the front mount.**

5. Place the front mount into position, aligning the compression limiters with the front fuel tank fixing locations. Fit the two D-washers, with the flat section of the washer towards the fuel tank, and secure the front mount with the original fixings. Tighten the fixings to **9 Nm**.

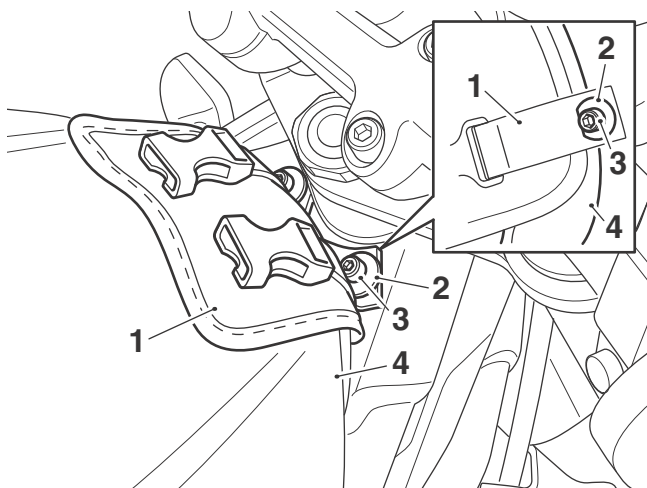

1. Front mount
2. D-washer
3. Fixing
4. Fuel tank

**Street Triple from VIN 560477,  
Street Triple R from VIN 560477,  
Street Triple Rx from 681920,  
Daytona 675 from VIN 564948 and  
Daytona 675R from VIN 564948**

6. Collect the front mount and compression limiters from the kit.

7. Fit the compression limiters to the front mount, as shown.

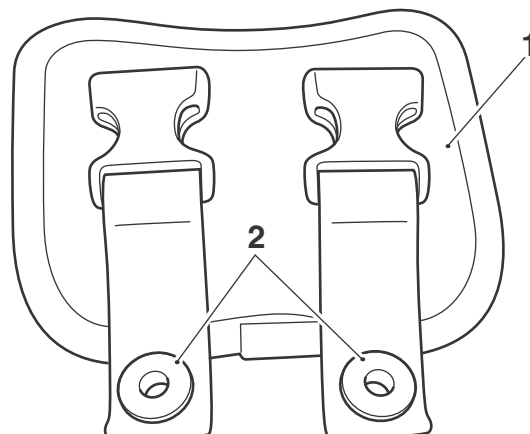

1. Front mount
2. Compression limiter

8. Place the front mount into position, aligning the compression limiters with the front fuel tank fixing locations. Secure the front mount with the original fuel tank fixings. Tighten the fixings to **9 Nm**.

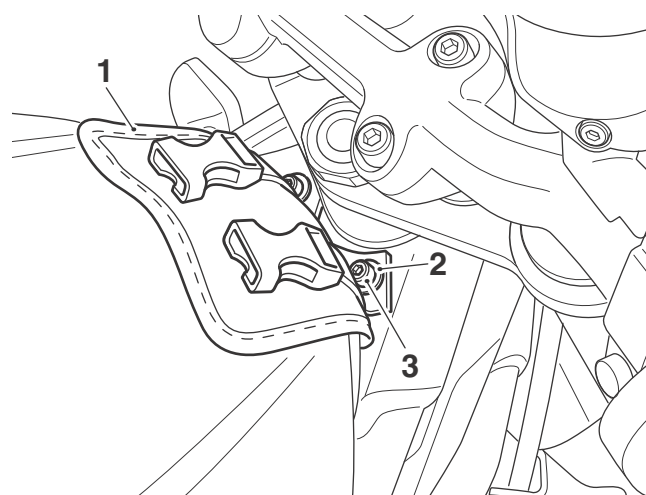

1. Front strap
2. Compression limiter
3. Fixing

---

## Installing the Rear Straps

9. Feed the loop end of one of the rear straps through the fuel tank rear hinge point.

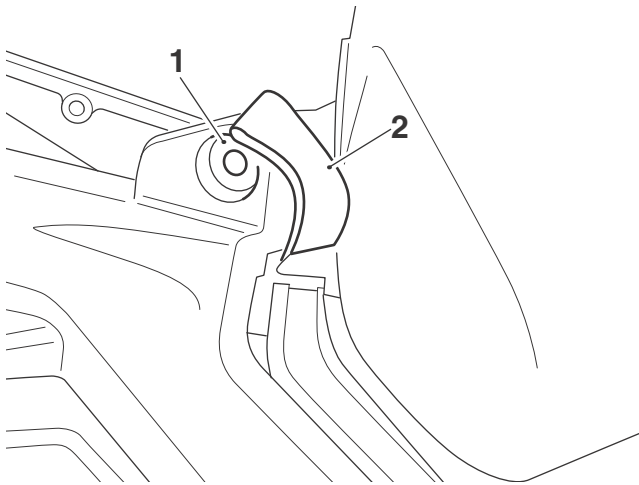

- 1. Rear hinge point, fuel tank (right hand shown)**  
**2. Rear strap**

10. Pass the other end of the strap, with clip, through the loop and pull tight to secure at the fuel tank hinge. Ensure the strap remains flat around the hinge point and sits within the bracket extension on the fuel tank.

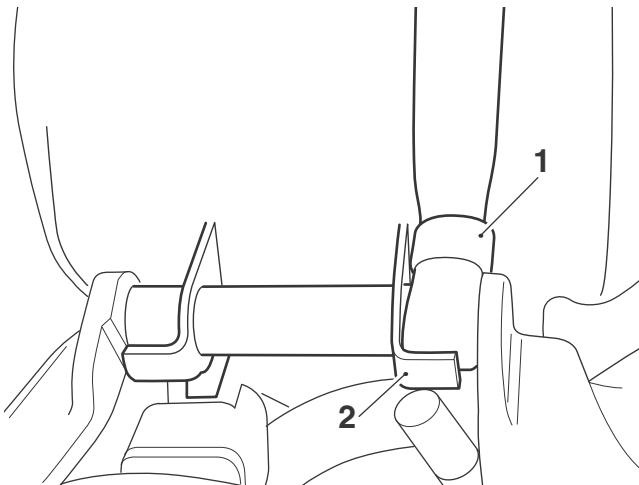

- 1. Rear strap**  
**2. Bracket extension**

11. Repeat steps 9 and 10 for the second rear strap at the opposite side of the fuel tank hinge point.

12. Ensure, when fitted, both rear straps are of equal length when pulled up to the top of the fuel tank, as shown. Adjust the straps as necessary.

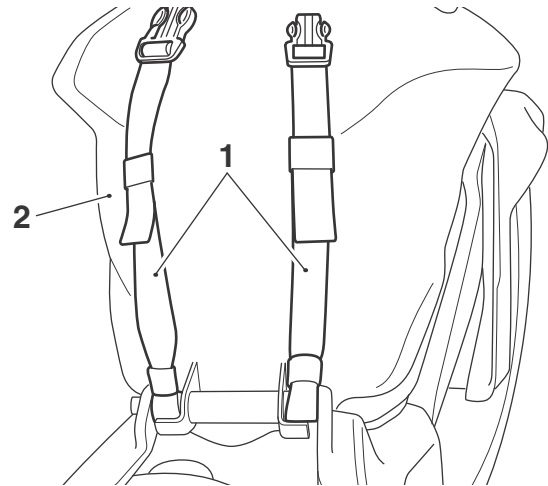

- 1. Rear strap**  
**2. Fuel tank**

## Installing the Tank Bag

### Note:

- **Ensure the underside of the tank bag is clean and dry prior to fitting.**

13. Position the tank bag on the fuel tank and attach the retaining clips at the front of the tank bag to the front mount.

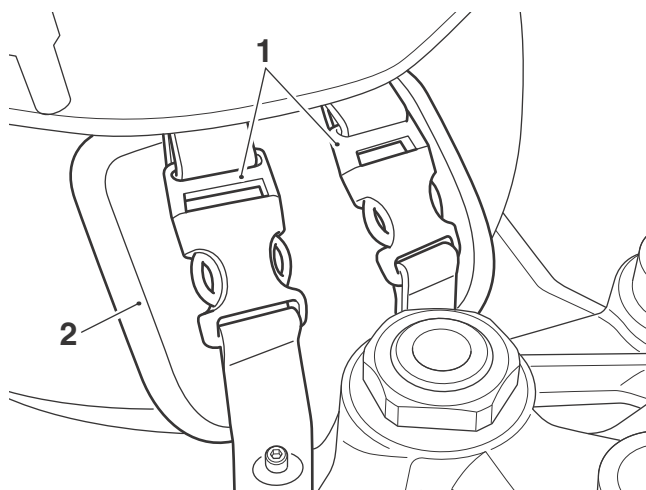

1. Retaining clips, tank bag

2. Front mount

14. Attach the clips on the rear of the tank bag to the rear straps.

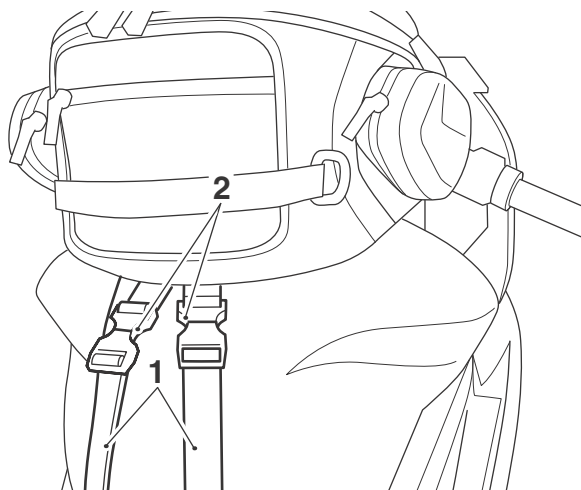

1. Rear straps

2. Retaining clips, tank bag

15. Adjust the rear straps to ensure the tank bag is held securely on the fuel tank.
16. Check there is no significant side to side, or upwards movement of the tank bag. It should not be possible to lift the tank bag away from fuel tank when the tank bag rear straps are adjusted correctly. If necessary re-adjust the tank bag rear straps.

## Installing the Rain Cover

17. Position the rain cover over the tank bag, as shown below.

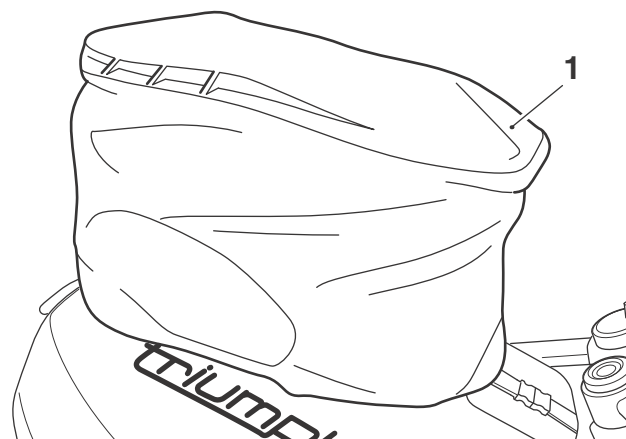

1. Rain cover

## Cleaning



### Caution

Use of chemicals or high-pressure spray washers is not recommended for cleaning the tank bag. Using chemicals or pressure washers may damage the tank bag.

To help maintain its appearance, clean the tank bag using a sponge or cleaning cloth with low alkaline soap and water.



### Warning

The maximum safe load for the tank bag is 3 kg (6.6 lbs). Never exceed this loading limit as this may cause the motorcycle to become unstable leading to loss of control and an accident.



### Warning

After fitting the accessory kit the motorcycle will exhibit new handling characteristics. Operate the motorcycle in a safe area free from traffic to gain familiarity with any new characteristics. Operation of the motorcycle when not familiar with any new handling characteristics may result in loss of motorcycle control and an accident.



### **Warning**

If, after fitment of this accessory kit, you have any doubt about the performance of any aspect of the motorcycle, contact an authorised Triumph dealer and do not ride the motorcycle until the authorised dealer has declared it fit for use. Riding a motorcycle when there is any doubt as to any aspect of the performance of the motorcycle may result in loss of control of the motorcycle, leading to an accident.



### **Warning**

Never ride an accessory-equipped motorcycle at speeds above 80 mph (130 km/h). The presence of accessories will cause changes in the stability and handling of the motorcycle. Failure to allow for changes in motorcycle stability may lead to loss of control or an accident. Remember that the 80 mph (130 km/h) limit will be reduced by the fitting of non-approved accessories, incorrect loading, worn tyres, overall motorcycle condition and poor road or weather conditions.



### **Warning**

The motorcycle must not be operated above the legal road speed limit except in closed course conditions.



### **Warning**

Only operate this Triumph motorcycle at high speed in closed course, on-road competitions or on closed course race tracks. High speed operation should only be attempted by riders who have been instructed in the techniques necessary for high speed riding and are familiar with the motorcycle's characteristics in all conditions. High speed operation in any other circumstances is dangerous and will lead to loss of motorcycle control and an accident.