

Fitting Instructions:

Tiger Sport

A9508156 and A9508076

Thank you for choosing this Triumph genuine accessory kit. This accessory kit is the product of Triumph's use of proven engineering, exhaustive testing, and continuous striving for superior reliability, safety and performance.

Completely read all of these instructions before commencing the installation of the accessory kit in order to become thoroughly familiar with the kit's features and the installation process.

These instructions should be considered a permanent part of your accessory kit, and should remain with it even if your accessory-equipped motorcycle is subsequently sold.

A9508076

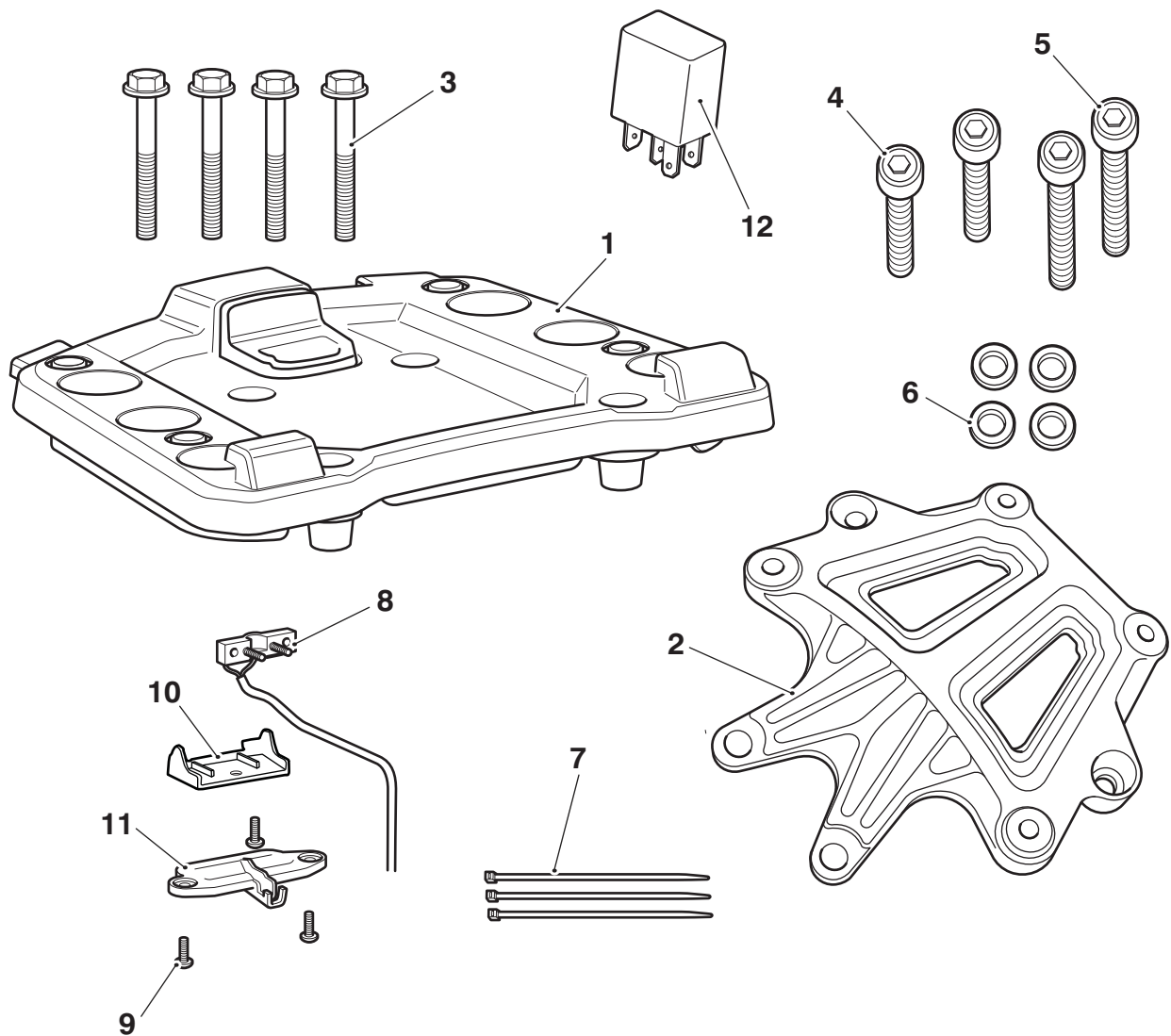

Parts Supplied:

1. Sliding carriage assembly	1 off	7. Cable tie	3 off
2. Rear rack	1 off	8. Sub harness	1 off
3. Hex head screw, M8 x 35 mm	4 off	9. Screw, self tapping	3 off
4. Cap head screw, M8 x 30 mm	2 off	10. Harness cover	1 off
5. Cap head screw, M8 x 40 mm	2 off	11. Moulding, terminal support	1 off
6. Washer, M8	4 off	12. Relay	1 off

A9508156

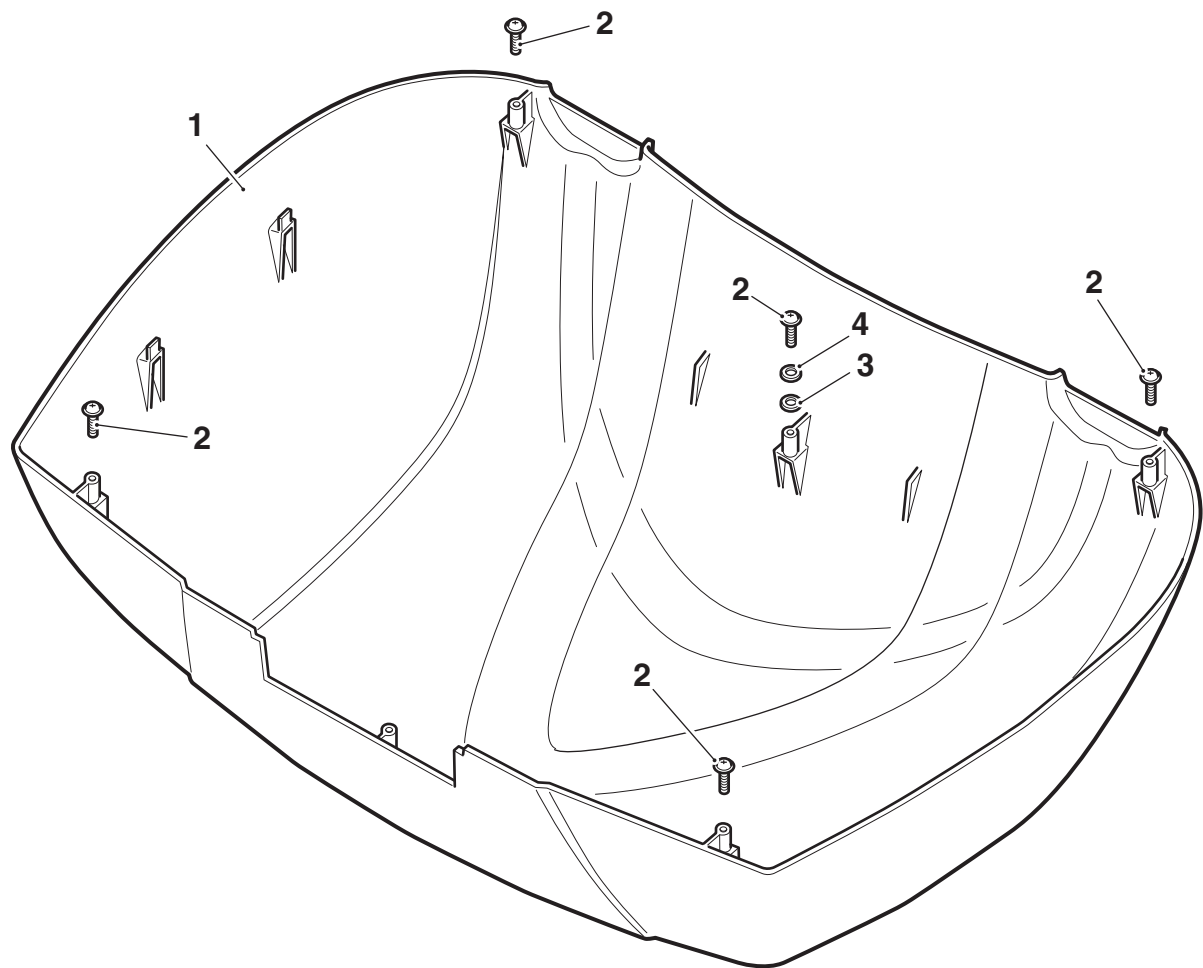

Parts Supplied:

1. Lid cover	1 off	3. Washer, rubber	1 off
2. Screw, M4 x 18 mm	5 off	4. Washer	1 off



Warning

This accessory kit is designed for use on Triumph Tiger Sport motorcycles only and should not be fitted to any other Triumph model or to any other manufacturer's motorcycle. Fitting this accessory kit to any other Triumph model, or to any other manufacturer's motorcycle, may interfere with the rider and could affect the handling, stability or other aspects of the motorcycle's operation, which may result in loss of motorcycle control and an accident.



Warning

Always have Triumph approved parts, accessories and conversions fitted by a trained technician of an authorised Triumph dealer. The fitment of parts, accessories and conversions by a technician who is not of an authorised Triumph dealer may affect the handling, stability or other aspects of the motorcycle's operation, which may result in loss of motorcycle control and an accident.



Warning

When fitting this accessory kit, ensure that the motorcycle is stabilised and adequately supported to prevent risk of injury from the motorcycle falling.



Warning

Failure to tighten any of the fasteners to the correct torque specification may result in loss of motorcycle control and an accident. Always use a calibrated torque wrench.

Note:

- The accessory kits **A9508076 - sliding carriage** and **A9508156 - lid cover**, must be used in conjunction with top box **T2350299**, **T2351021**, **T2351028**, **T2351080**, **T2351085** and **T2356395**.

Sliding Carriage - A9508076

1. Position the motorcycle on a paddock stand.
2. Remove the seat, as described in the Owner's Handbook.
3. Disconnect the battery, negative (black) lead first.
4. Locate the sliding carriage, harness, terminal support moulding and a self tapping screw from the kit.
5. Slide the connectors on the harness into their corresponding holes in the underside of the sliding carriage. Ensure that the cables are positioned as shown below.

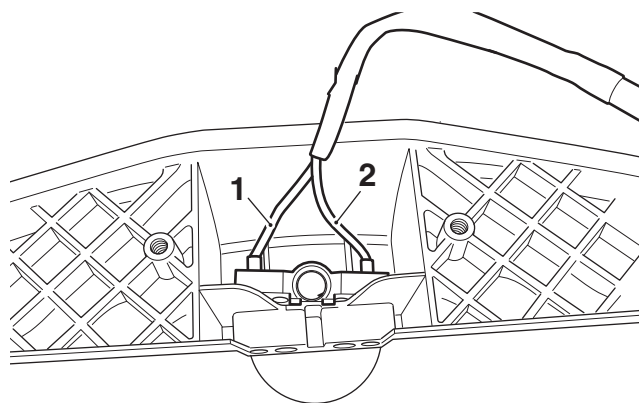

T0996

1. Red cable
2. Black cable

6. Position the terminal support moulding over the harness connectors and secure in position with the screw. Tighten the screw to **1.5 Nm**.

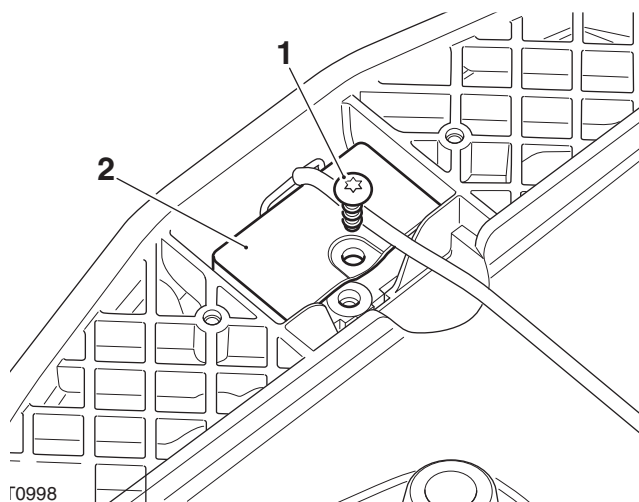

T0998

1. Screw
2. Moulding

7. Recover the two remaining self tapping screws from the kit and fit the harness cover to the underside of the sliding carriage. Tighten the screws to **1.5 Nm**. Secure the harness to its cover with the cable tie supplied, as shown below. Trim off any excess from the cable tie.

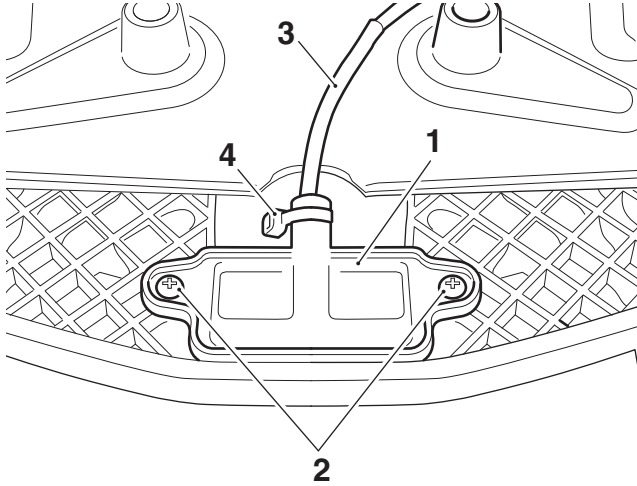

- 1. Harness cover
- 2. Screws
- 3. Harness
- 4. Cable tie

Installing the Rear Rack

8. Remove the two covers from the rear of the grab handles to expose the rear fixing locations for the rear rack. Retain the covers and fixings for use if the motorcycle is returned to its original condition.

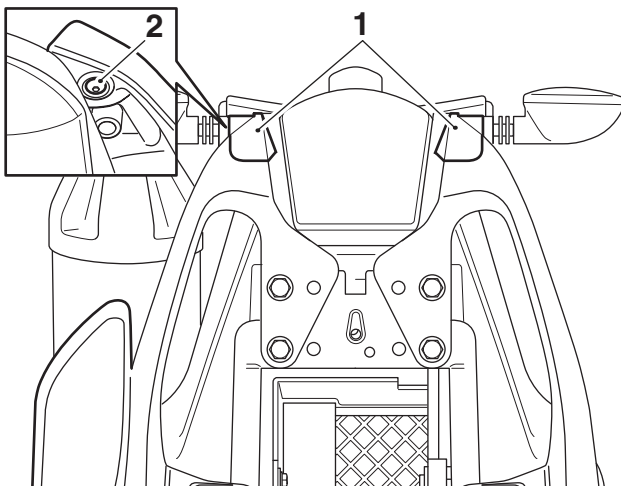

- 1. Cover
- 2. Fixing (right hand shown)

9. Place the rear rack on the grab handles, as shown, aligning the front and rear fixing positions with the threaded mounting holes in the grab handles.

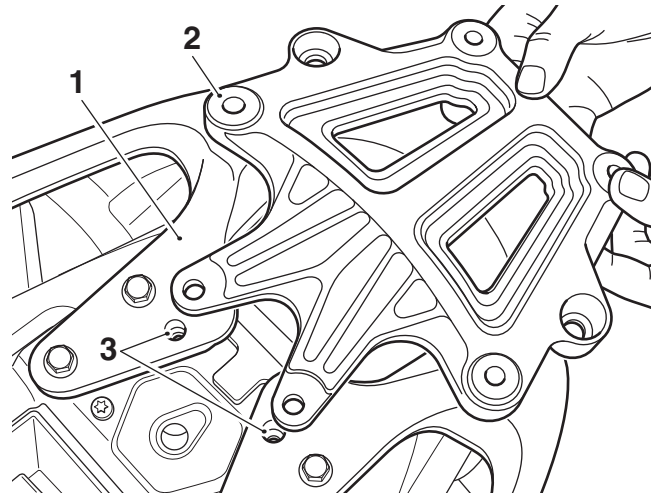

- 1. Grab handles
- 2. Rear rack
- 3. Mounting holes (rear not shown)

10. To secure the rear rack to the grab handles, fit two M8 x 30 mm cap head screws and M8 washers to the rear fixing positions and two M8 x 40 mm cap head screws and M8 washers to the front fixing positions, as shown below. Do not fully tighten the fixings at this stage.

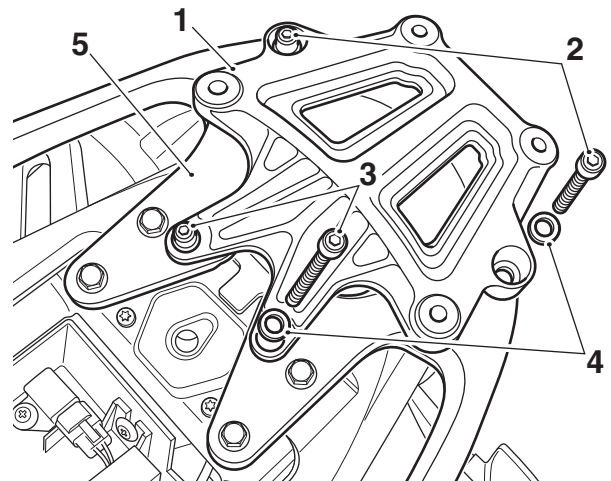

- 1. Rear rack
- 2. Cap head screw, M8 x 30 mm
- 3. Cap head screw, M8 x 40 mm
- 4. Washer, M8
- 5. Grab handles

Installing the Sliding Carriage

11. Feed the sliding carriage harness under the rear rack toward the front of the motorcycle, as shown.

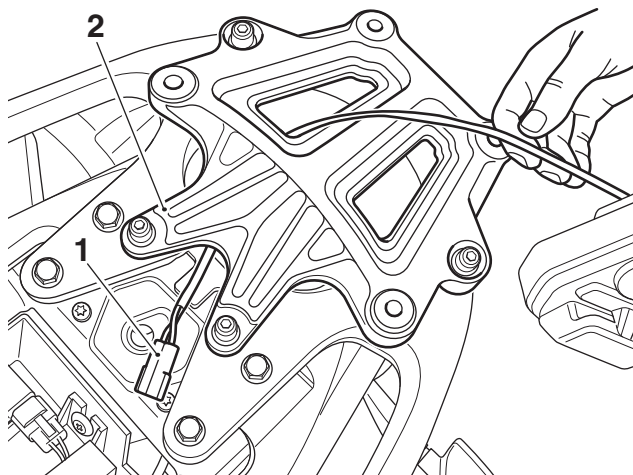

1. Sliding carriage harness
2. Rear rack

12. Tighten the four rear rack fixings to **24 Nm**.
13. Align the sliding carriage to the rear rack, fit the four M8 x 35 mm hex head screws from the kit and tighten to **27 Nm**.

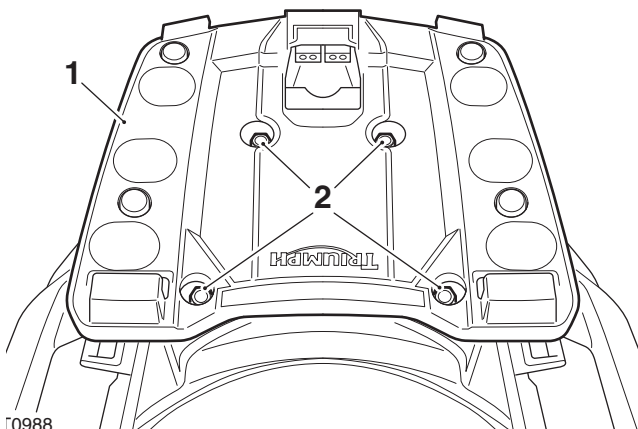

T0988

1. Sliding carriage
2. Hex head screw, M8 x 35 mm



Warning

The sliding carriage must be allowed to move from side to side on the slide plate. If the sliding carriage is not free to move from side to side when the top box is fitted, the stability and handling characteristics of the motorcycle may be affected, leading to loss of control and an accident.

14. Fit the relay provided into the spare socket at the main harness relay block as shown.

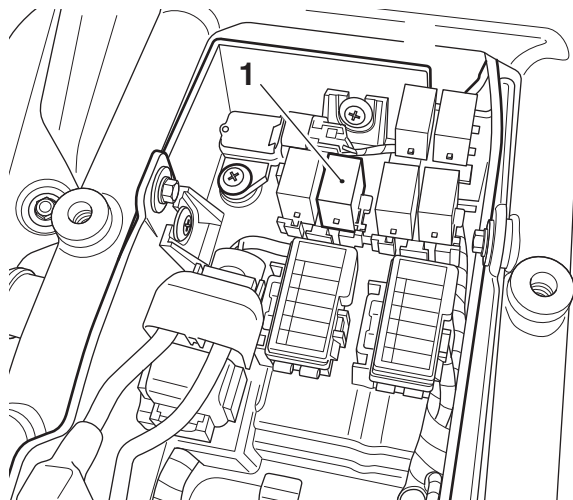

1. Relay



Warning

The top box sliding carriage is intended for fitment of the Triumph Genuine Accessory top box only. The Triumph Genuine Accessory top box must be allowed to move freely from side to side when fitted to the sliding carriage. Riding the motorcycle with the Triumph Genuine Accessory top box incorrectly fitted and/or a payload greater than 10 kg may cause the motorcycle to become unstable leading to loss of motorcycle control and an accident.

15. The main harness connector for the sliding carriage connection is located through an aperture in the rear of the battery tray. Carefully pull the main harness back through the aperture, until the harness connector is accessible in the battery tray.

Note:

- The main harness connector may be secured to the rear of the battery tray with a fir tree clip. The fir tree clip must be removed before pulling the connector through the aperture.
- The fir tree clip is located directly below the aperture. To gain access, release the scrivets and ease the fuse box tray forwards. Replace the fuse box tray and scrivets once the fir tree clip has been removed and the connector retrieved.

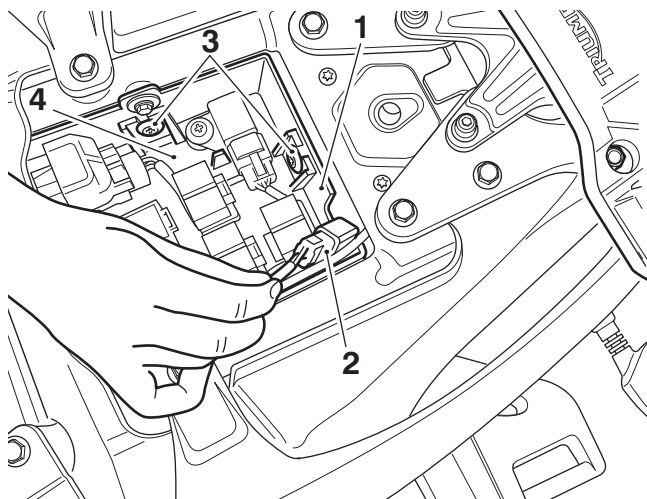

1. Battery tray
2. Main harness connector
3. Scrivets
4. Fuse box tray

16. Remove the blanking plug from the main harness connector and connect the sliding carriage harness to the main harness. Retain the blanking plug for use if the motorcycle is returned to its original condition.

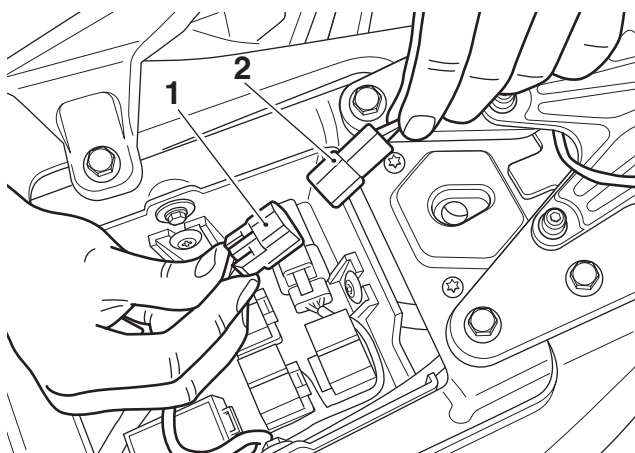

1. Main harness connector
2. Sliding carriage harness connector

17. Route the sliding carriage harness along the left hand side of the grab handles and secure the harness to the grab handles using a cable tie provided, as shown. Trim off any excess from the cable tie.

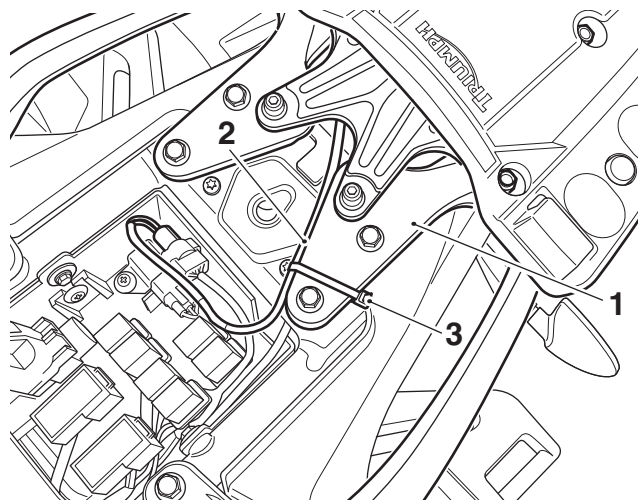

1. Grab handles
2. Sliding carriage harness
3. Cable tie

18. The remaining sliding carriage harness should be positioned tidily in the rear of the battery tray and secured to the ambient air pressure sensor with a cable tie from the kit. Trim off any excess from the cable tie.

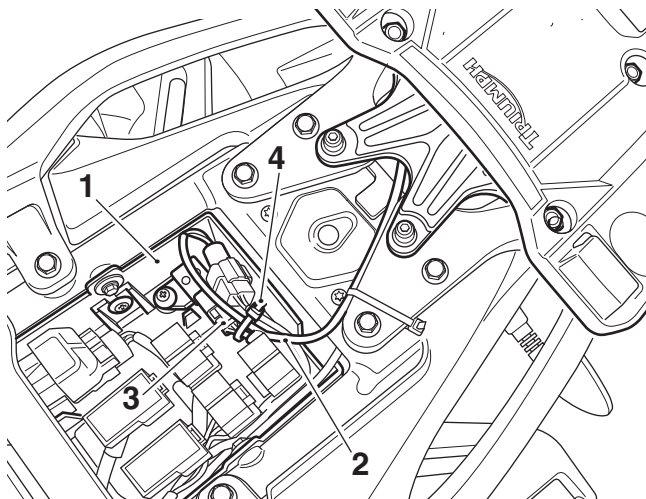

1. Battery tray
2. Sliding carriage harness
3. Ambient air pressure sensor
4. Cable tie

19. Reconnect the battery, positive (red) lead first.
20. Refit the seat as described in the Owner's Handbook.

Top Box - Lid Cover A9508156



Caution

Care must be taken when working on the top box. Damage to the top box surfaces may result from inadequate care while fitting the painted panel.

1. Lay the top box on a flat, clean and soft surface.
2. Retrieve the painted panel from the kit. Fit the panel to the lid ensuring that it fits inside the latch plate surround.

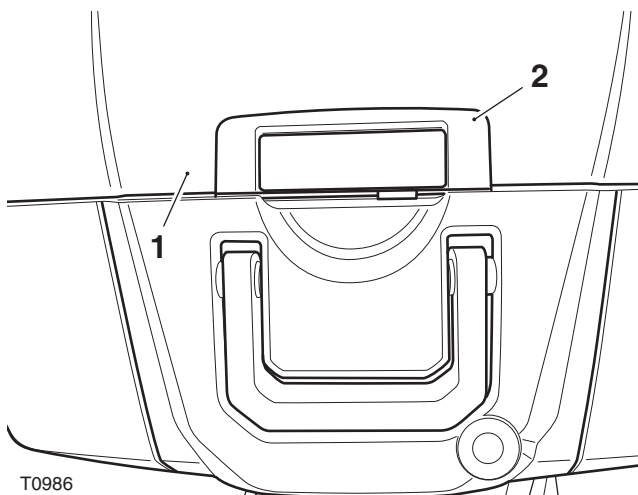

1. Painted panel

2. Latch plate surround

3. Retrieve the five self-tapping screws, one metal washer and one rubber washer from the kit. Fit the metal washer to one of the screws then fit the rubber washer to the same screw.
4. Carefully open the top box lid, ensuring that the painted cover remains tight to the lid and will rest on the clean soft surface when fully open.
5. Fit the self-tapping screws to the locations indicated below and tighten to **1.5 Nm**.

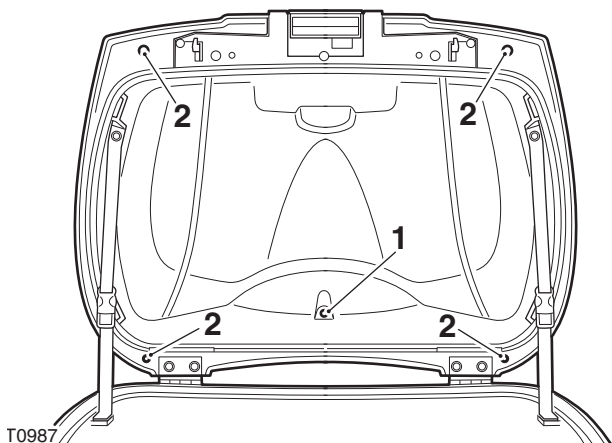

1. Screw with washers

2. Screws without washers

Fitting the Lock Barrel to the Top Box - T2350299, T2351021 T2351028, T2351080, T2351085 and T2356395

1. Fit the ignition key into the lock barrel lock supplied with the motorcycle when new.

Note:

- **The lock barrel will only fit one way.**
2. Align the locking device on the lock barrel to the slot in the lock housing in the top box, as indicated in the illustration below.

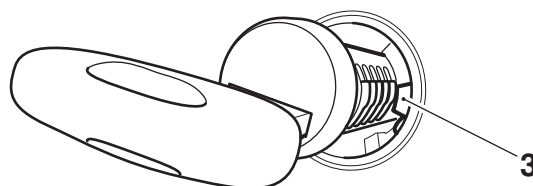
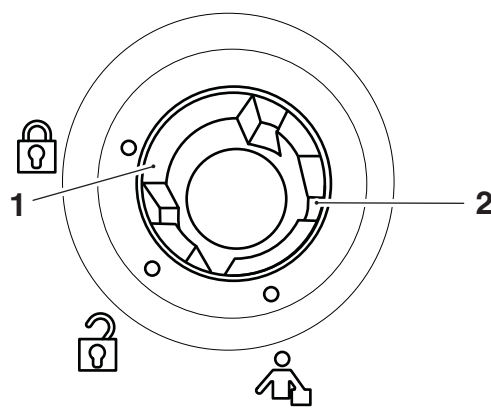

1. Slot

2. Housing

3. Locking device

3. Push the barrel into position in the top box until it clicks into place.
4. Check the operation of the barrel.

Mounting the Top Box - T2350299, T2351021 T2351028, T2351080, T2351085 and T2356395

1. Remove the rubber cover covering the electrical connectors on the sliding carriage.

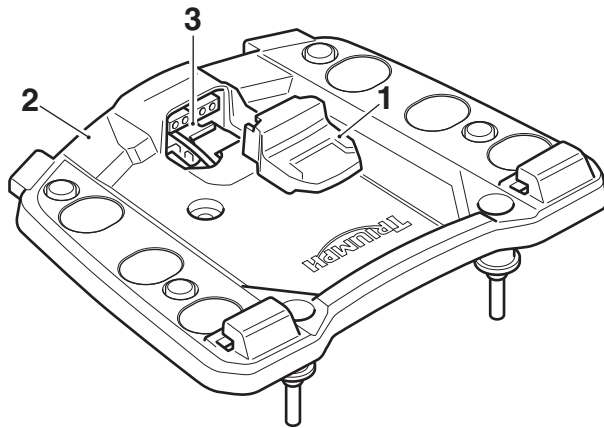

T0991

1. Rubber cover
2. Sliding carriage
3. Electrical connectors

Note:

- To lock, open or release the top box, the key slot must align with the corresponding symbols around the barrel as shown.
2. Insert the key into the lock. Turn the key to the RELEASE position and lift the carrying handle to its fully raised position.

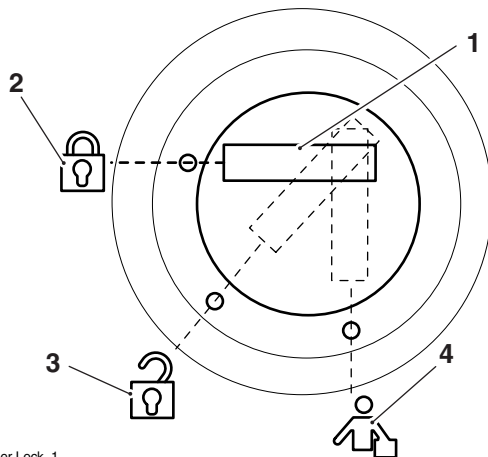

Pannier Lock_1

1. Key slot (shown in LOCK position)
2. Lock position symbol
3. Unlock position symbol
4. Release position symbol

3. Position the top box such that the mounting slots on the bottom of the top box locate with the mounting hooks on the sliding carriage.

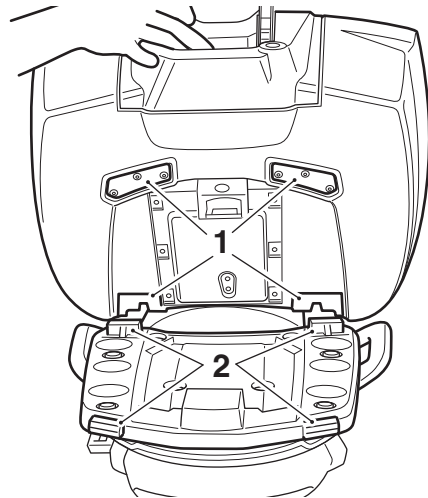

T0985

1. Mounting slots
2. Mounting hooks

4. Lower the top box until it sits flat on the sliding carriage then push forwards to fully engage its mountings.
5. Lock the top box to the sliding carriage by turning the key to the RELEASE position, put the carrying handle to the fully closed position then turn the key to the LOCK position. An audible click can be heard when the carrying handle is put into the fully closed position and the top box is correctly latched to the sliding carriage.

If an audible click cannot be heard when the carrying handle is put into the fully closed position, the top box may not be correctly latched to the sliding carriage.

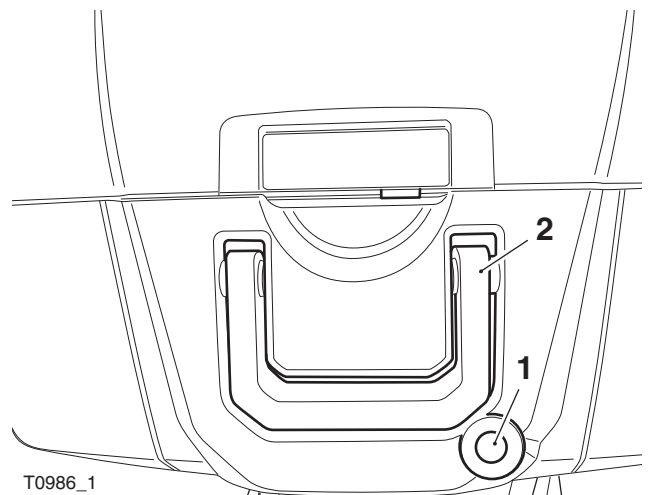

T0986_1

1. Lock
2. Carrying handle in the fully closed position



Warning

To prevent detachment of the top box while riding, after fitting always grasp the top box and pull firmly upwards and to the rear. If the top box is not correctly secured, it will detach from the sliding carriage. A loose or detached top box could cause loss of motorcycle control and an accident.

Note:

- **It is recommended to have the top box in the locked condition while riding the motorcycle.**
6. Check that the top box is securely locked to the sliding carriage.

Removing the Top Box

1. Insert the key and turn it to the RELEASE position.
2. Lift the carrying handle to the fully raised position, pull the top box rearwards and remove it from the sliding carriage.

Top Box Operation

1. To unlock the lid of the top box, insert the key. Turn the key to the UNLOCK position, then operate the lid latch handle and lift to open the lid.

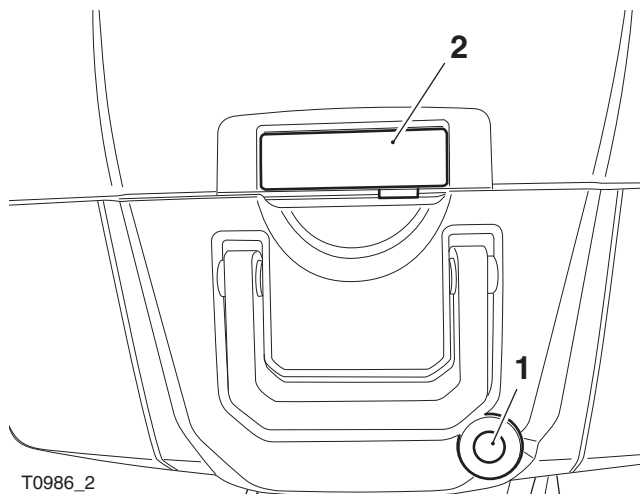

T0986_2

1. Lock

2. Lid latch handle

2. To lock the lid of the top box, fully close the lid, turn the key to the LOCK position and remove the key.

Auxiliary Power Socket

Fuse box 1, fuse number 5 (10 A) protects the auxiliary power socket on the motorcycle and the auxiliary power socket in the top box when fitted.

Use the table below as a guide for the maximum current that should be drawn through the auxiliary sockets.

Heated Grips (if fitted)	Auxiliary power socket(s) maximum rated power
OFF	6 A (72 W) @ 12 V shared between the two sockets if the top box is fitted
ON	3 A (36 W) @ 12 V shared between the two sockets if the top box is fitted

Note:

- **Power is only supplied to the auxiliary power socket when the ignition switch is turned to the ON position.**



Warning

The maximum safe load for the top box, when fitted to the Triumph Tiger Sport, is 10 kg. Never exceed this loading limit as this may cause the motorcycle to become unstable, leading to loss of control and an accident.



Warning

Always ensure that any load carried in the top box is correctly secured such that it will not move around while the motorcycle is in motion.

Never exceed the maximum vehicle loading weight which is described in the Owner's Handbook.

Incorrect loading may result in an unsafe riding condition, which could lead to loss of motorcycle control and an accident.



Warning

To maintain the handling characteristics of the motorcycle when riding with luggage or with a passenger and luggage, refer to the Owner's Handbook for the correct suspension settings.

Incorrect suspension settings could significantly change the handling characteristics of the motorcycle, leading to loss of motorcycle control and an accident.



Warning

After fitting the accessory kit the motorcycle will exhibit new handling characteristics. Operate the motorcycle in a safe area free from traffic to gain familiarity with any new characteristics. Operation of the motorcycle when not familiar with any new handling characteristics may result in loss of motorcycle control and an accident.



Warning

If, after fitment of this accessory kit, you have any doubt about the performance of any aspect of the motorcycle, contact an authorised Triumph dealer and do not ride the motorcycle until the authorised dealer has declared it fit for use. Riding a motorcycle when there is any doubt as to any aspect of the performance of the motorcycle may result in loss of control of the motorcycle, leading to an accident.



Warning

Never ride an accessory-equipped motorcycle at speeds above 80 mph (130 km/h). The presence of accessories will cause changes in the stability and handling of the motorcycle. Failure to allow for changes in motorcycle stability may lead to loss of control or an accident. Remember that the 80 mph (130 km/h) limit will be reduced by the fitting of non-approved accessories, incorrect loading, worn tyres, overall motorcycle condition and poor road or weather conditions.



Warning

The motorcycle must not be operated above the legal road speed limit except in closed course conditions.



Warning

Only operate this Triumph motorcycle at high speed in closed course, on-road competition or on closed course racetracks. High speed operation should only be attempted by riders who have been instructed in the techniques necessary for high speed riding and are familiar with the motorcycle's characteristics in all conditions. High speed operation in any other circumstances is dangerous and will lead to loss of motorcycle control and an accident.