



## Accessory Fitting Instructions

Top Box Mount Kit	
Kit Number	Models Affected
A9500897	Tiger Sport from VIN AU7774
Top Box, Twin Helmet, Kit	
Kit Number	Models Affected
A9500894	Tiger Sport from VIN AU7774
Top Box Infill Panel Kit	
Kit Number	Models Affected
A9500904-XX	Tiger Sport from VIN AU7774

**Note:**

- **The Accessory Top Box and Top Box Mount Kits listed above must only be used when an Accessory Luggage Rack Kit A9500896 is fitted to the motorcycle.**

Thank you for choosing this Triumph genuine accessory kit. This accessory kit is the product of Triumph's use of proven engineering, exhaustive testing, and continuous striving for superior reliability, safety and performance.

Completely read all of these instructions before commencing the installation of the accessory kit in order to become thoroughly familiar with the kit's features and the installation process.

These instructions should be considered a permanent part of your accessory kit, and should remain with it even if your accessory equipped motorcycle is subsequently sold.

Parts Supplied: A9500897

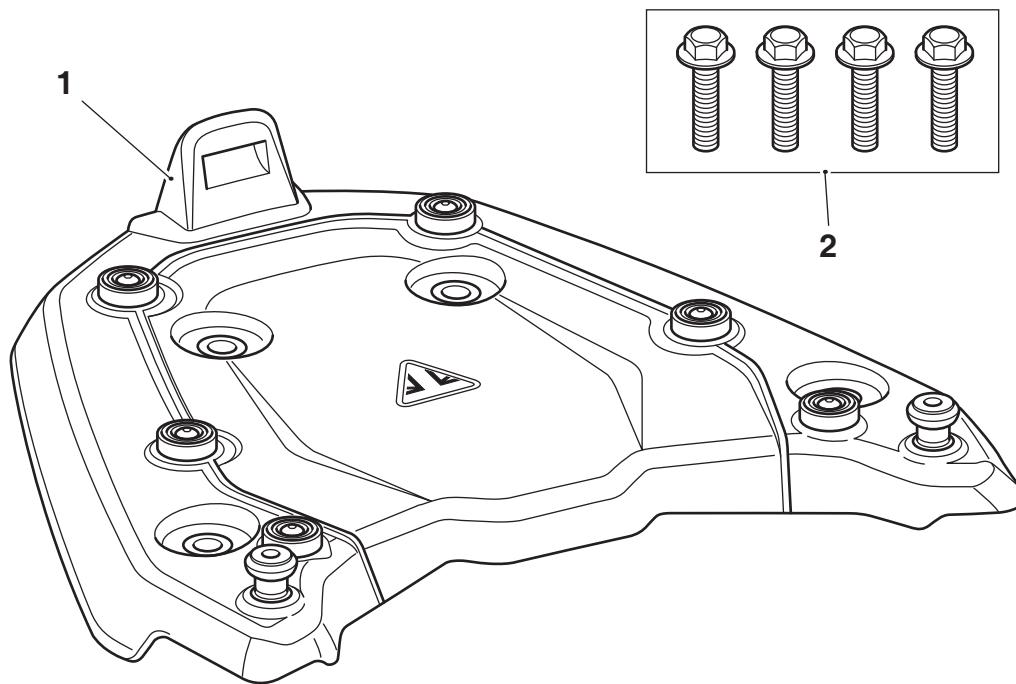

1. Top box mount assembly	1 off	2. Fixing, M8 x 30 mm	4 off
---------------------------	-------	-----------------------	-------

Parts Supplied: A9500894

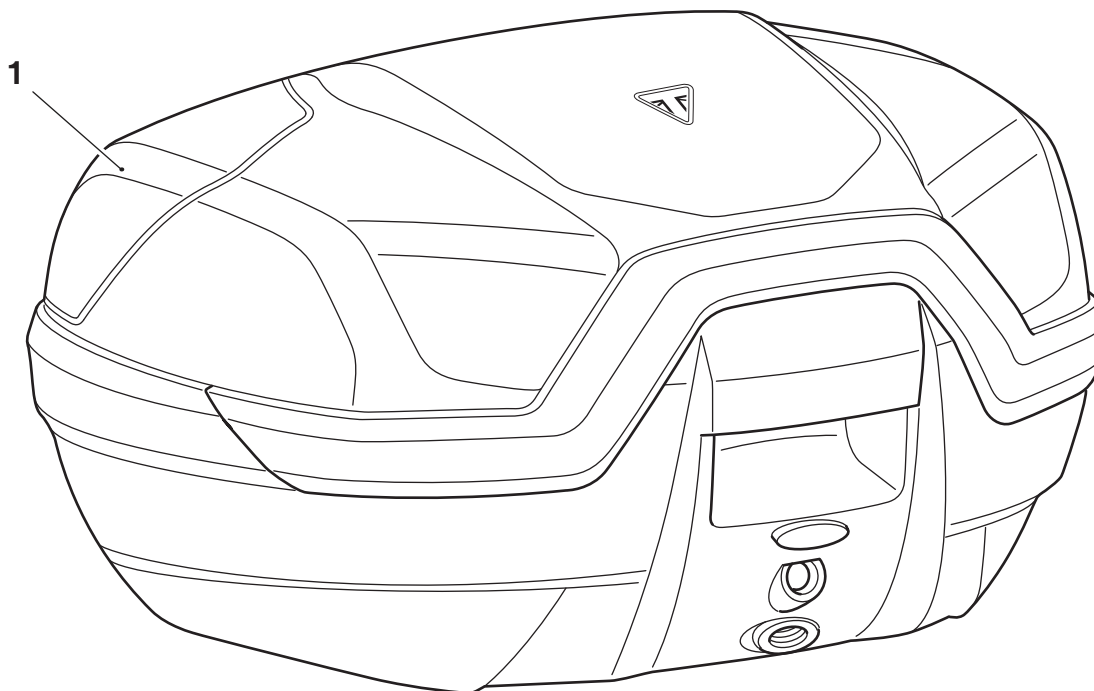

1. Top box	1 off		
------------	-------	--	--

Parts Supplied: A9500904

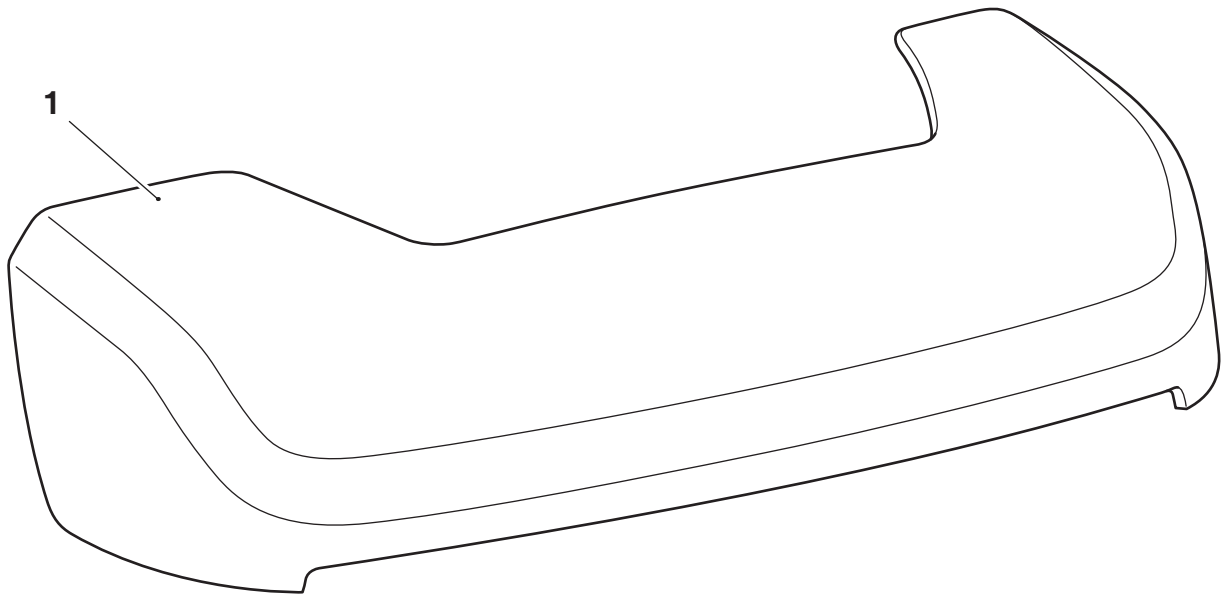

1. Top box infill panel, painted	1 off		
----------------------------------	-------	--	--

**Warning**

Fit only genuine Triumph accessories to those models approved by Triumph as listed in the associated Triumph fitting instructions. The accessory kits covered in this instruction are designed for use on specific models of Triumph motorcycle. The accessory kits and the models applicable are listed at the start of the instruction. They should never be fitted to any other Triumph model or to any other manufacturer's motorcycle. Fitting an accessory kit to a Triumph model not listed, or to any other manufacturer's motorcycle will affect the performance, stability and handling of the motorcycle. This may affect the rider's ability to control the motorcycle and could result in an accident causing severe injuries or death.

**Warning**

Make sure the motorcycle is supported. A correctly supported motorcycle will help prevent it from falling. An unstable motorcycle may fall, causing injury to the operator or damage to the motorcycle.

**Warning**

A torque wrench of known accurate calibration must be used when fitting this accessory kit. Failure to tighten any of the fasteners to the correct torque specification may affect motorcycle performance, handling and stability. This may result in loss of motorcycle control and an accident.

**Warning**

Always have Triumph approved parts, accessories and conversions fitted by a trained technician of an authorised Triumph dealer. The fitment of parts, accessories and conversions by a technician who is not of an authorised Triumph dealer may affect the handling, stability or other aspects of the motorcycle's operation which will result in loss of motorcycle control and an accident.

**Note:**

- Triumph offers a broad range of approved genuine accessories for your motorcycle. We cannot therefore cover all possible equipment variations in these instructions. For removal and installation of Triumph Genuine Accessories always refer to the instructions supplied with the respective accessory kit. To obtain additional copies of any Triumph accessory instructions, visit [www.triumphinstructions.com](http://www.triumphinstructions.com) or contact your authorised Triumph dealer.

**Top Box Mount Fitment**

1. Remove the four firtree plugs fitted to the mounting holes in the luggage rack. Retain the firtree plugs for reuse if the top box mount kit is removed.

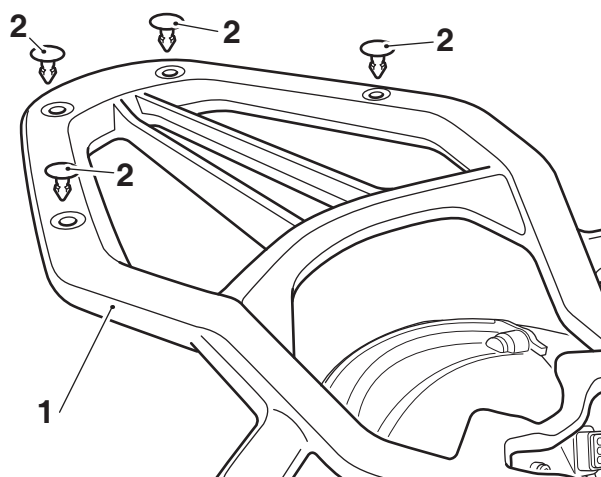

1. Luggage rack
2. Firtree plugs

2. Position the top box mount assembly onto the luggage rack and align the fixing hole positions. Fit the four M8 x 30 mm fixings from the kit and tighten to **19 Nm**.

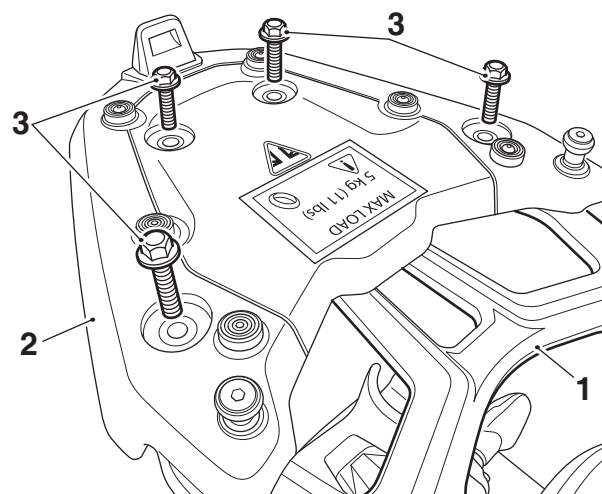

1. Luggage rack
2. Top box mount assembly
3. Fixings, M8 x 30 mm

**Lock Barrel Fitment**

 <b>Caution</b>
<p>Do not remove the ignition key from the lock barrel when the lock barrel has been removed from its protective case or latch assembly.</p> <p>If the key is removed when the lock barrel has been removed from the protective case or latch assembly, the lock barrel will be in an unstable condition and the internal components will become unassembled and may be lost which will prevent fitment of the lock barrel.</p> <p>The ignition key must only be removed when the lock barrel has been fitted into the top box.</p>

1. Fit the ignition key in to the lock barrel lock supplied with the motorcycle when new.

- Turn the ignition key clockwise to remove the lock barrel from its protective case.

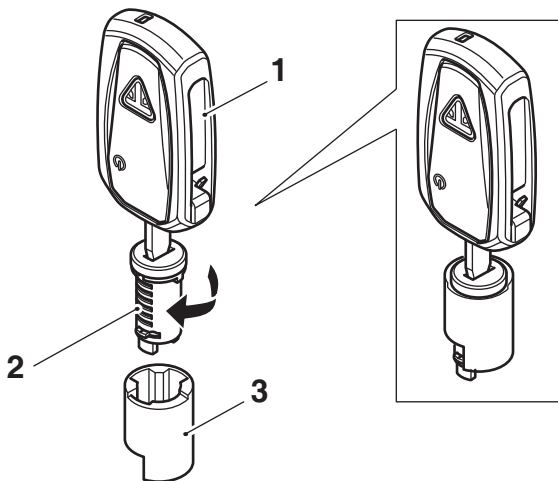

- Ignition key
- Lock barrel
- Protective case

**Note:**

- The lock barrel will only fit one way.
- Align the tumblers to the slot and push the barrel into position until it clicks into place.

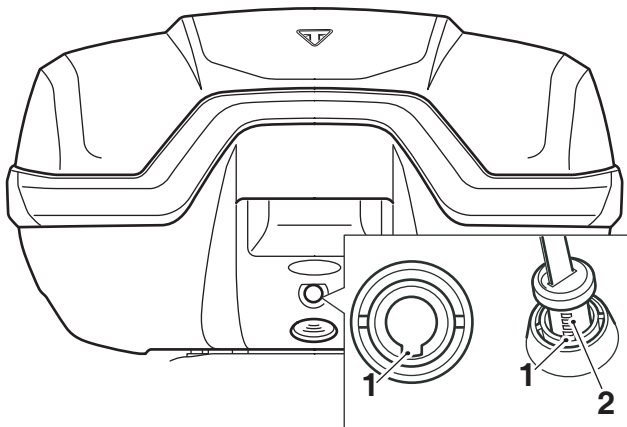

- Slot
- Tumblers

- Check the operation of the lock barrel. Remove the ignition key.

## Fitting the Top Box

- The top box lock has two positions, as shown below. Insert the key in the lock and turn to the UNLOCK position.

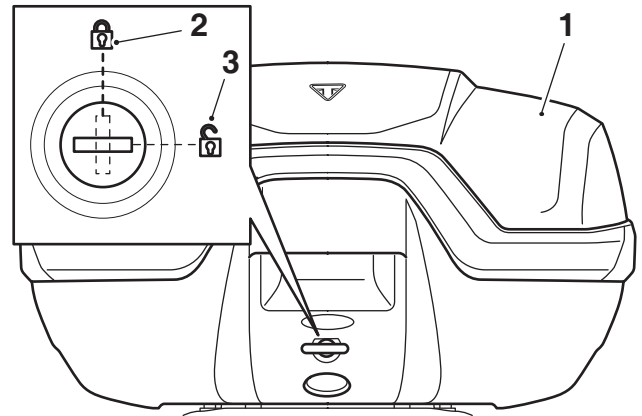

- Top box
- Lock, LOCK position
- Lock, UNLOCK position

- Position the top box such that the mounting slots on the bottom of the top box locate with the bobbins on the top box mount assembly.

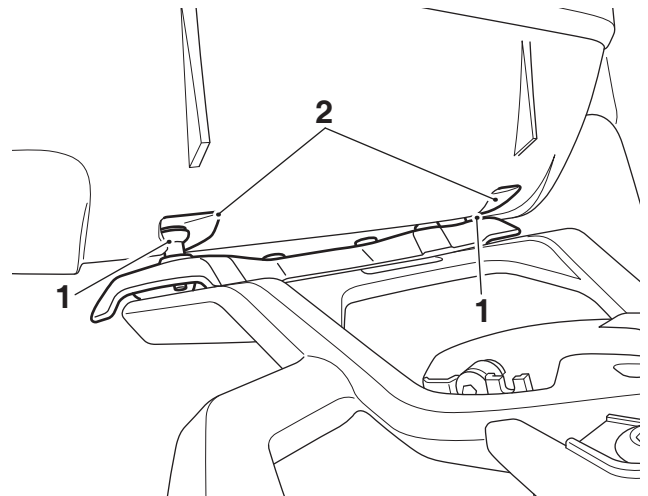

- Mounting slots
- Bobbins

**Note:**

- **The top box will lock to the mount assembly when the latch on the mount assembly aligns to the locking mechanism of the top box.**
3. Push the top box forwards against the bobbins and lower the rear of the top box until the locking mechanism engages with the rear latch.

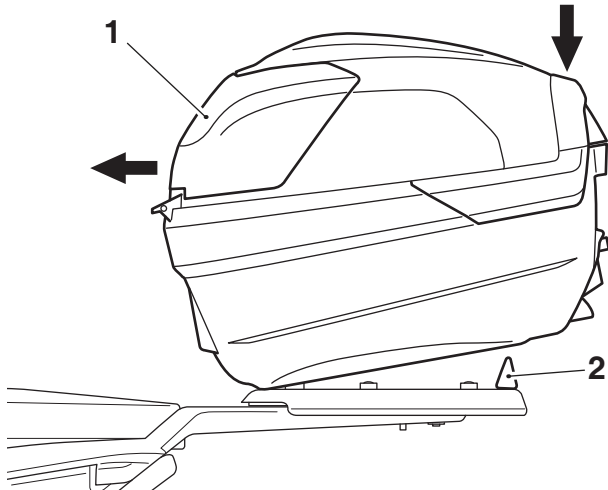

1. Top box
2. Latch

4. Lock the top box to the top box mount assembly by pushing downwards to fully engage it. An audible click can be heard when the locking mechanism on the bottom surface of the top box is correctly latched to the top box mount assembly. If an audible click cannot be heard the top box may not be correctly latched to the top box mount assembly.

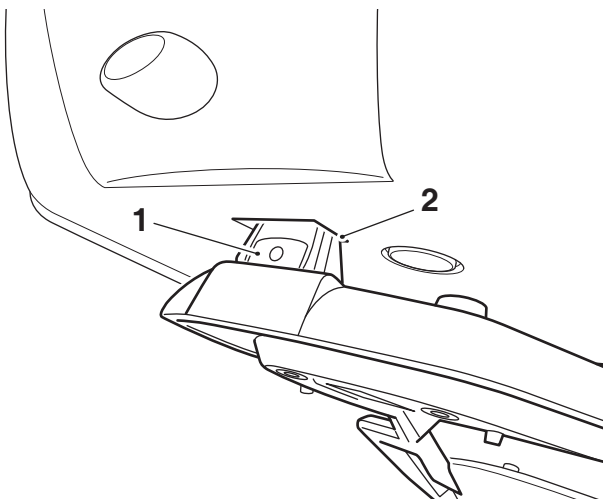

1. Latch
2. Locking mechanism

**Note:**

- **There should be no movement between the top box and top box mount assembly when checking that the top box is correctly secured**

**Warning**

To prevent detachment of the top box while riding, after fitting always grasp the top box and pull firmly upwards and to the rear. If the top box is not correctly secured, it will detach from the top box mount assembly. A loose or detached top box could cause loss of motorcycle control and an accident.

**Note:**

- **The top box must be in the locked condition while riding the motorcycle.**
5. To lock the top box onto the top box mount assembly, insert the key in the lock and turn to the LOCK position, as shown below. Note, this will also lock the top box lid.

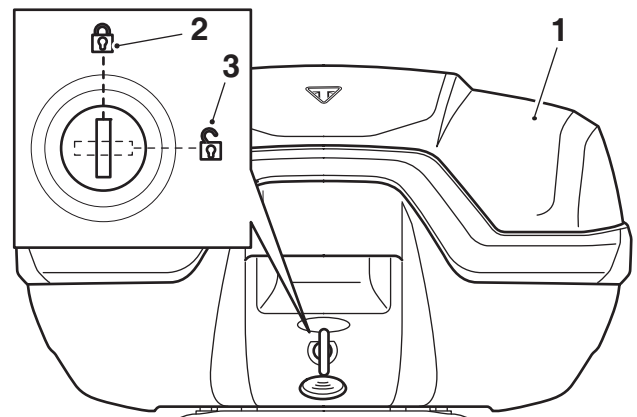

1. Top box
2. Lock, LOCK position
3. Lock, UNLOCK position

6. Check that the top box is securely locked to the top box mount assembly.



## Warning

An incorrectly mounted top box may detach whilst riding, resulting in a dangerous riding condition.

Before riding, always make sure that the top box is mounted correctly. Make sure that the lock barrel is turned to the LOCK position and the key removed.

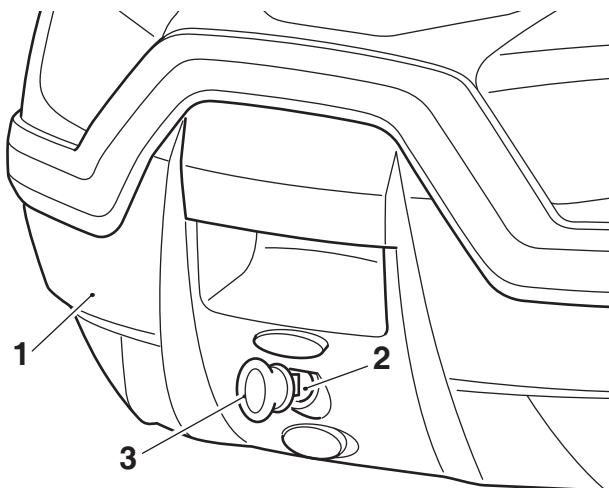

1. Top box
2. Lock position
3. Key

A top box that detaches whilst riding may cause loss of motorcycle control and an accident and/or injury to other road users.

## Top Box Operation

1. To open the top box lid, turn the key to the UNLOCK position and press the button above the lock on the top box. Always make sure the lock is returned to the LOCK position and the key removed after the top box lid is closed.

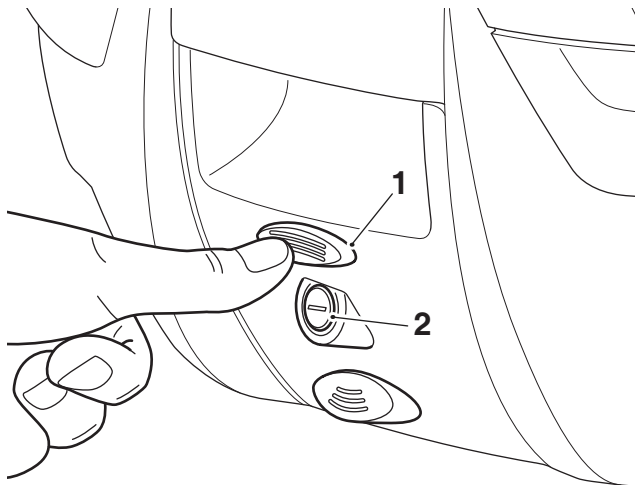

1. Top button
2. Lock

## Removing the Top Box

2. To remove the top box from the mount platform, insert the key in the lock and turn the key to the UNLOCK position. Press the button below the lock on the top box, this will release the top box from the mount platform.

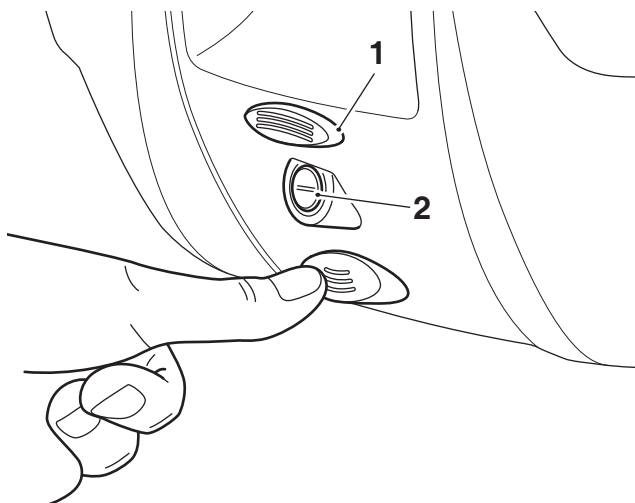

1. Bottom button
2. Lock

3. Lift the rear of the top box to release the locking mechanism from the rear latch. Slide the top box rearward to disengage the front mounting hooks and lift the top box away from the mount platform.

**Note:**

- **The following Infill panel replacement section is only applicable when replacing the original infill panel with an accessory painted infill panel.**

**Top Box Infill Panel Replacement**

1. Open the top box lid. While supporting the infill panel remove the twelve infill panel fixings from the top box lid. Retain the fixings for reuse.

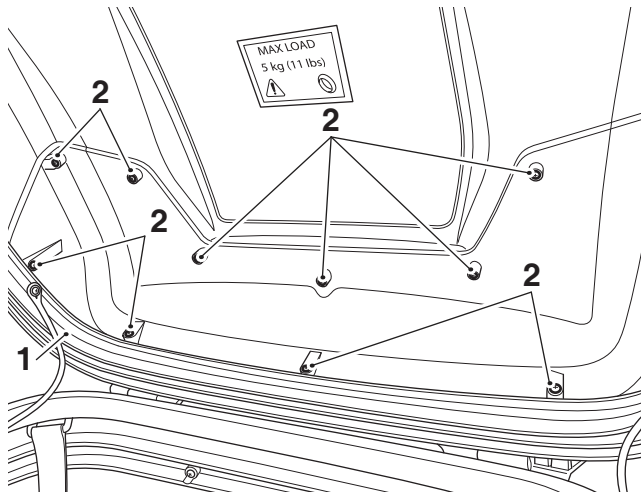

1. Top box lid
2. Infill panel fixings

2. Remove the original infill panel from the top box lid. Retain the infill panel for reuse if the accessory painted infill panel is removed.
3. Fit the painted infill panel from the kit onto the top box lid, as shown.

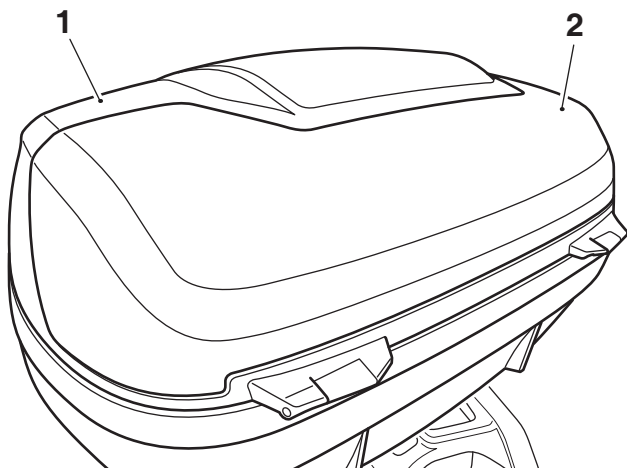

1. Top box lid
2. Infill panel

4. Fit two of the original fixings to the lower outer fixing positions, as show. Note, it may be necessary to apply a small amount of pressure to the infill panel against the top box to align the fixing holes. Tighten the fixings to **1.5 Nm**.

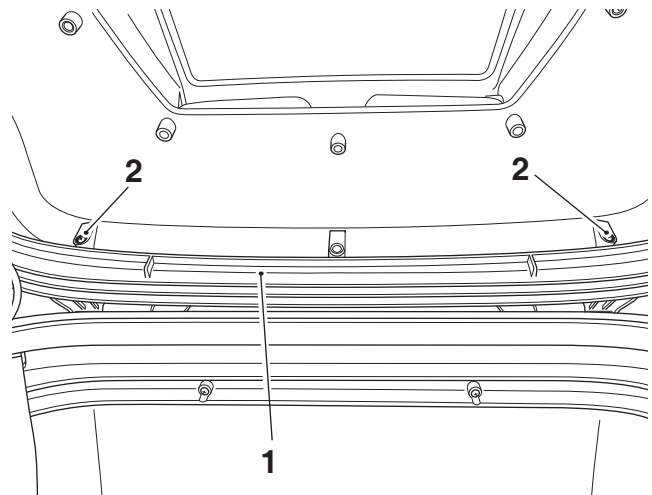

1. Top box lid
2. Fixings

5. Fit the remaining ten original fixings to secure the infill panel to the top box lid. Tighten the fixings to **1.5 Nm**.

**Warning**

The maximum safe load for the top box is 5 kg (11 lbs). Never exceed this loading limit as this may cause the motorcycle to become unstable leading to loss of motorcycle control and an accident.

**Warning**

After fitting or removing the top box, operate the motorcycle in a safe area free from traffic to gain familiarity with the new handling characteristics. Operation when not familiar with the new characteristics of the motorcycle may result in loss of motorcycle control and an accident.





## Warning

Incorrect loading may result in an unsafe riding condition leading to loss of motorcycle control and an accident.

Always make sure any loads carried are evenly distributed on the motorcycle. Make sure that the load is correctly secured such that it will not move around while the motorcycle is in motion.

Evenly distribute the load within the top box. Pack heavy items at the bottom of the top box.

Always check the load security regularly (though not while the motorcycle is in motion) and make sure that the load does not extend beyond the rear of the motorcycle. Never exceed the maximum vehicle loading weight. Refer to the Owner's Handbook for the maximum loading weight specification.

This maximum loading weight is made up from the combined weight of the rider, passenger, any accessories fitted and any load carried.

For models that have adjustable suspension settings, make sure that front and rear spring preload and damping settings are suitable for the loading condition of the motorcycle. Refer to the Owner's Handbook.

Note the maximum permissible payload for the top box is stated on a label inside the top box.

## Top Box Release Mechanism Lubrication

### Note:

- **Periodic lubrication of the top box release mechanism is advised to maintain a reliable and trouble free operation of the release mechanism.**

1. Open the top box lid and locate the four fixings retaining the latch housing to the top box. While supporting the latch housing, remove the fixings. Retain the fixings for reuse.

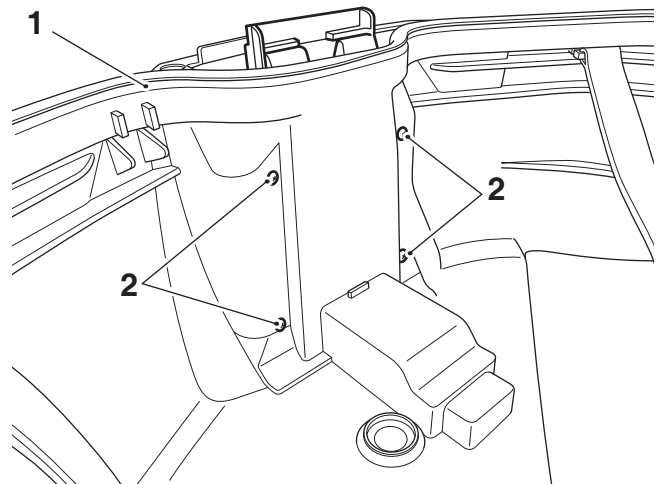

1. Top box
2. Fixings

2. Remove the latch housing from the top box by moving the lower edge of the housing out from the top box to clear the release button, then move the latch housing down and away from the top box.

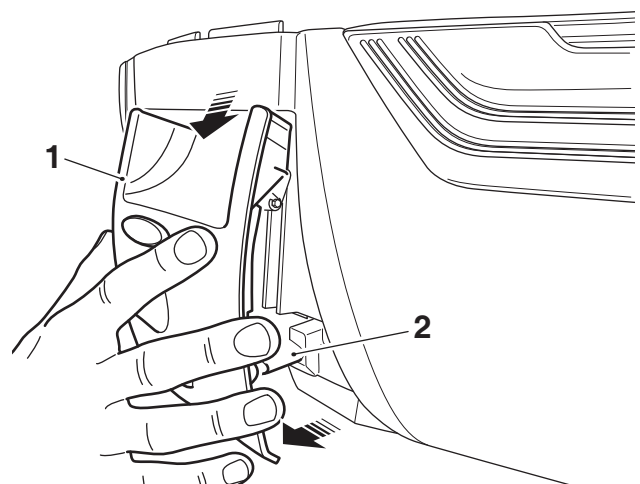

1. Latch housing
2. Release button

- Remove the release button from the top box. Retain the release button for reuse.

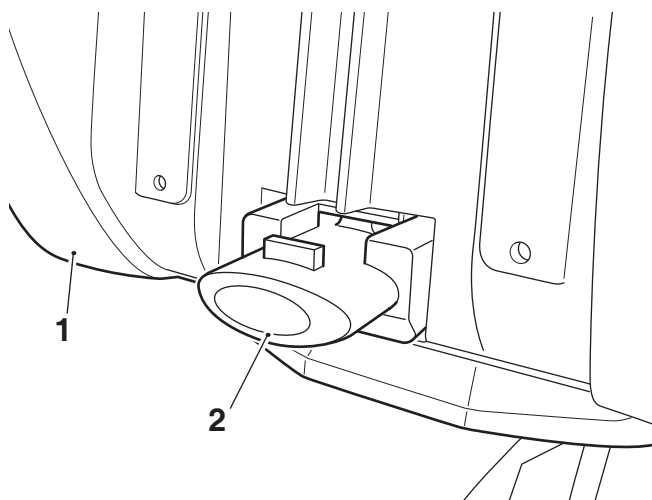

- Top box
- Release button

- Apply lubricant to the sides of the top box release mechanism.

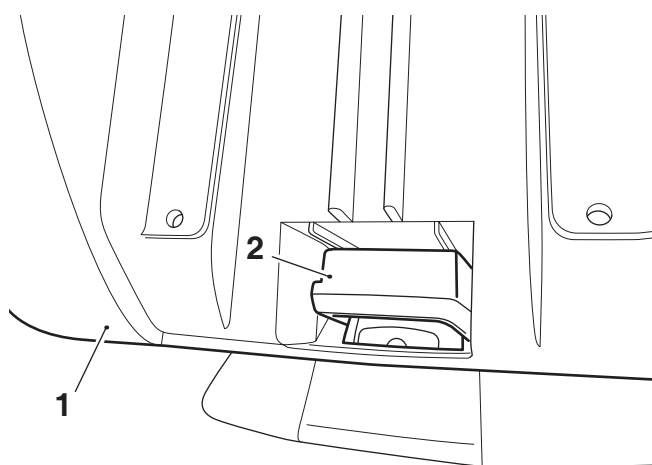

- Top box
- Release mechanism

- Refit the release button and latch housing to the top box using the original fixings. Tighten the fixings to **1.5 Nm**.

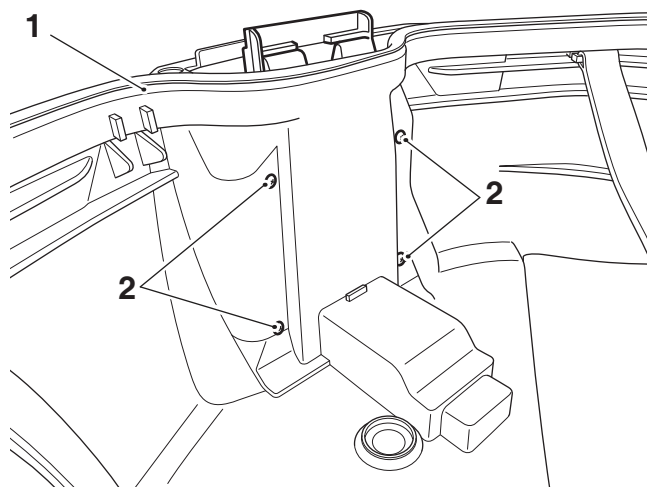

- Top box
- Fixings

### Cleaning the Luggage System

All parts of the luggage system fitted to your motorcycle must be cleaned regularly to avoid deterioration of their appearance.

#### Washing

Prepare a mixture of cold water and mild automotive cleaner. Do not use a highly alkaline soap as commonly found at commercial car washes because it leaves a residue.

Wash the luggage system with a soft cloth. Do not use an abrasive scouring pad or steel wool. They will damage the finish.

Rinse the luggage system thoroughly.

Make sure no soap or water enters the inside compartment.

Dry the luggage system as far as possible with a soft cloth.

#### Protecting

When the luggage system is dry, protect with a colourless lubricating spray.

 <b>Caution</b>
<p>The use of abrasive cleaners and polishes will damage the system and must not be used.</p>

It is recommended that regular protection be applied to the system as this will both protect and enhance the system's appearance.

**Note:**

- **It is recommended to use the Triumph inner bags to protect both the luggage contents and the inner surfaces of the luggage.**



**Warning**

If, after fitment of this accessory kit, you have any doubt about the performance of any aspect of the motorcycle, contact an authorised Triumph dealer and do not ride the motorcycle until the authorised dealer has declared it fit for use. Riding a motorcycle when there is any doubt as to any aspect of the performance of the motorcycle may result in loss of control of the motorcycle leading to an accident.



**Warning**

Never ride an accessory-equipped motorcycle, or a motorcycle carrying a payload of any kind, at speeds above 80 mph (130 km/h). In either/both of these conditions, speeds in excess of 80 mph (130 km/h) should not be attempted even where the legal speed limit permits this.

The presence of accessories and/or payload will cause changes in the stability and handling of the motorcycle.

Failure to allow for changes in motorcycle stability may lead to loss of motorcycle control or an accident.

When riding at high speed, always be aware that various motorcycle configuration and environmental factors can adversely affect the stability of your motorcycle. For example:

- Incorrectly balanced loads on both sides of the motorcycle.
- Incorrectly adjusted front and rear suspension settings.
- Incorrectly adjusted tyre pressures.
- Excessively or unevenly worn tyres.
- Side winds and turbulence from other vehicles.
- Loose clothing.

Remember that the 80 mph (130 km/h) absolute limit will reduce by the fitting of non-approved accessories, incorrect loading, worn tyres, overall motorcycle condition and poor road or weather conditions.



**Warning**

Only operate this Triumph motorcycle at high speed in closed-course, on-road competition or on closed-course racetracks. High-speed operation should only be attempted by riders who have been instructed in the techniques necessary for high-speed riding and are familiar with the motorcycle's characteristics in all conditions.

High-speed operation in any other circumstances is dangerous and will lead to loss of motorcycle control and an accident.



**Warning**

This motorcycle must not be operated above the legal road speed limit except in authorised closed-course conditions.