



## Accessory Fitting Instructions

<b>Pannier Kit</b>	
<b>Kit Number</b>	<b>Models Affected</b>
A9500891	Tiger Sport from VIN AU7774
<b>Pannier Infill Panel Kit</b>	
<b>Kit Number</b>	<b>Models Affected</b>
A9500906-XX	Tiger Sport from VIN AU7774

Thank you for choosing this Triumph genuine accessory kit. This accessory kit is the product of Triumph's use of proven engineering, exhaustive testing, and continuous striving for superior reliability, safety and performance.

Completely read all of these instructions before commencing the installation of the accessory kit in order to become thoroughly familiar with the kit's features and the installation process.

These instructions should be considered a permanent part of your accessory kit, and should remain with it even if your accessory equipped motorcycle is subsequently sold.

Parts Supplied: A9500891

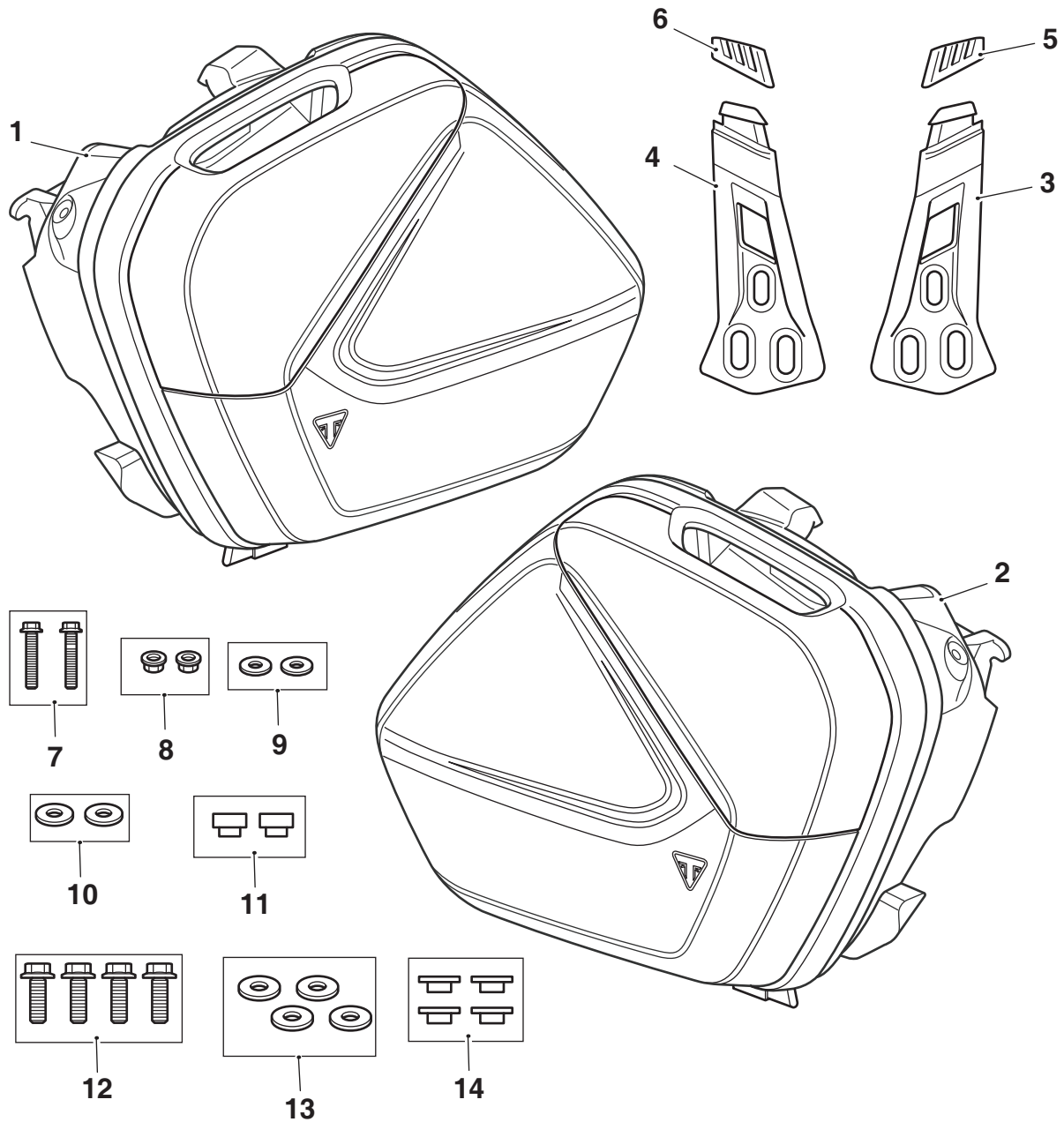

1.	Pannier, left hand	1 off	8.	Lock nut, M6	2 off
2.	Pannier, right hand	1 off	9.	Washer, M6, (14 mm diameter)	2 off
3.	Third mount, left hand	1 off	10.	Washer, M6, (18 mm diameter)	2 off
4.	Third mount, right hand	1 off	11.	Flanged sleeve, M6	2 off
5.	Third mount rubber, left hand	1 off	12.	Fixing, M8 x 25 mm	4 off
6.	Third mount rubber, right hand	1 off	13.	Washer, M8	4 off
7.	Fixing, M6 x 35 mm	2 off	14.	Flanged sleeve	4 off

**Parts Supplied: A9500906-XX**

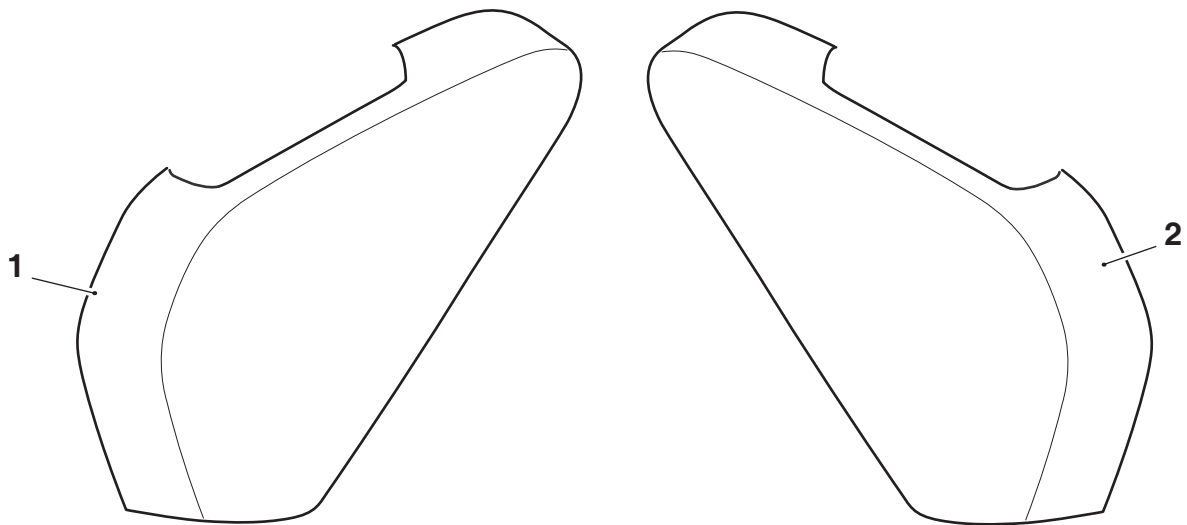

1. Pannier infill panel, left hand	1 off	2. Pannier infill panel, right hand	1 off
------------------------------------	-------	-------------------------------------	-------

**Warning**

Fit only genuine Triumph accessories to those models approved by Triumph as listed in the associated Triumph fitting instructions. The accessory kits covered in this instruction are designed for use on specific models of Triumph motorcycle. The accessory kits and the models applicable are listed at the start of the instruction. They should never be fitted to any other Triumph model or to any other manufacturer's motorcycle. Fitting an accessory kit to a Triumph model not listed, or to any other manufacturer's motorcycle will affect the performance, stability and handling of the motorcycle. This may affect the rider's ability to control the motorcycle and could result in an accident causing severe injuries or death.

**Warning**

Always have Triumph approved parts, accessories and conversions fitted by a trained technician of an authorised Triumph dealer. The fitment of parts, accessories and conversions by a technician who is not of an authorised Triumph dealer may affect the handling, stability or other aspects of the motorcycle's operation which will result in loss of motorcycle control and an accident.

**Warning**

Make sure the motorcycle is supported. A correctly supported motorcycle will help prevent it from falling. An unstable motorcycle may fall, causing injury to the operator or damage to the motorcycle.

**Warning**

A torque wrench of known accurate calibration must be used when fitting this accessory kit. Failure to tighten any of the fasteners to the correct torque specification may affect motorcycle performance, handling and stability. This may result in loss of motorcycle control and an accident.

**Note:**

- Triumph offers a broad range of approved genuine accessories for your motorcycle. We cannot therefore cover all possible equipment variations in these instructions. For removal and installation of Triumph Genuine Accessories always refer to the instructions supplied with the respective accessory kit. To obtain additional copies of any Triumph accessory instructions, visit [www.triumphinstructions.com](http://www.triumphinstructions.com) or contact your authorised Triumph dealer.

**Lock Barrel Fitment**

**Caution**

Do not remove the ignition key from the lock barrel when the lock barrel has been removed from its protective case or latch assembly.

If the key is removed when the lock barrel has been removed from the protective case or latch assembly, the lock barrel will be in an unstable condition and the internal components will become unassembled and may be lost which will prevent fitment of the lock barrel.

The ignition key must only be removed when the lock barrel has been fitted into the pannier.

1. Fit the ignition key in to the lock barrel supplied with the motorcycle when new.
2. Turn the ignition key clockwise to remove the lock barrel from its protective case.

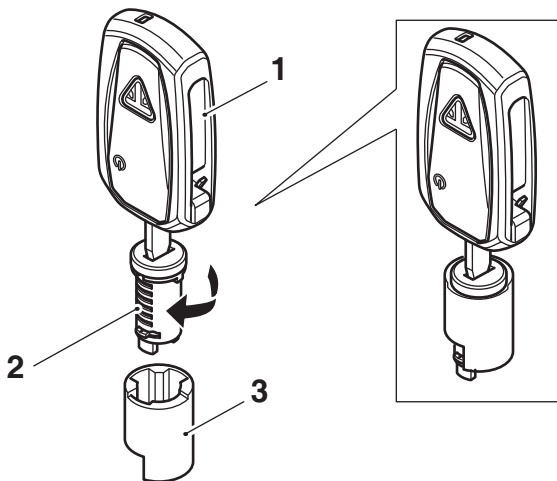

1. Ignition key
2. Lock barrel
3. Protective case

**Note:**

- The lock barrel will only fit one way.

3. Align the tumblers to the slot and push the barrel into position until it clicks into place.

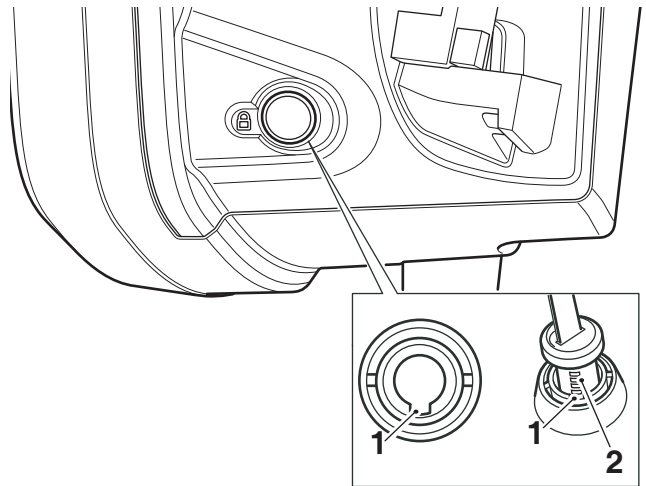

1. Slot
2. Tumblers

4. Check the operation of the lock barrel. Remove the ignition key.

**Fitting the Pannier Third Mounts**

1. Fit the right hand third mount rubber from the kit to the right hand third mount.

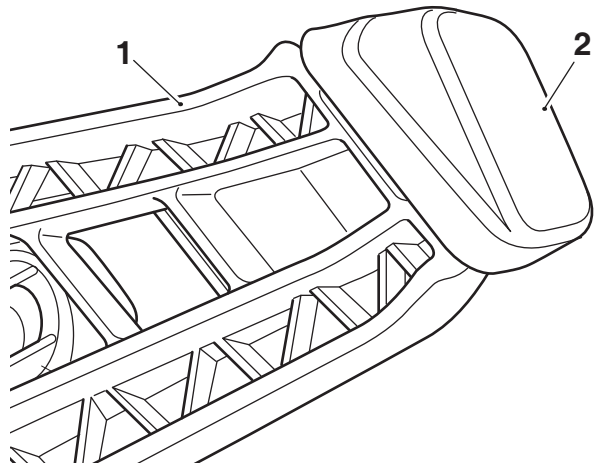

1. Third mount, right hand
2. Third mount rubber, right hand

- Fit an M6 x 35 mm fixing with a 14 mm diameter M6 washer from the kit through the hole in the right hand side footrest mount heel guard with the head of the fixing and washer positioned on the footrest side of the mount. Fit an M6 flanged sleeve onto the fixing threads in the orientation shown below.

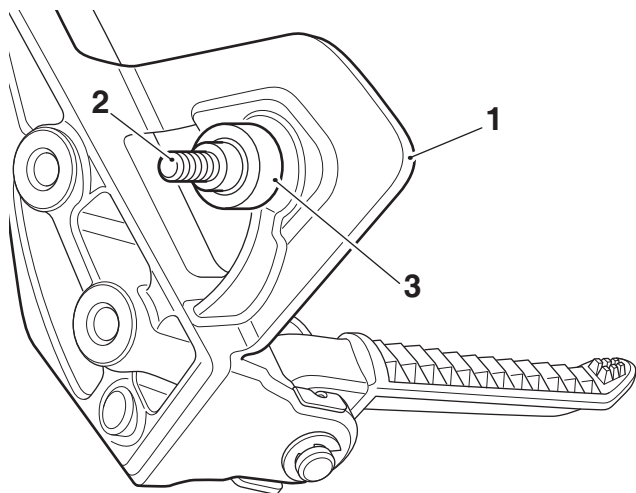

- Footrest mount, right hand side
- Fixing, M6 x 35 mm
- Flanged sleeve, M6

- Collect the right hand third mount, two M8 x 25 mm fixings, two M8 washers and two M8 flanged sleeves from the kit.
- Fit the M8 washers on to the M8 x 25 mm fixings.
- Fit the M8 x 25 mm fixings with washers to the right hand third mount with the heads of the fixings on the inner side of the mount. Fit the two M8 flanged sleeves on to the fixings in the orientation shown below.

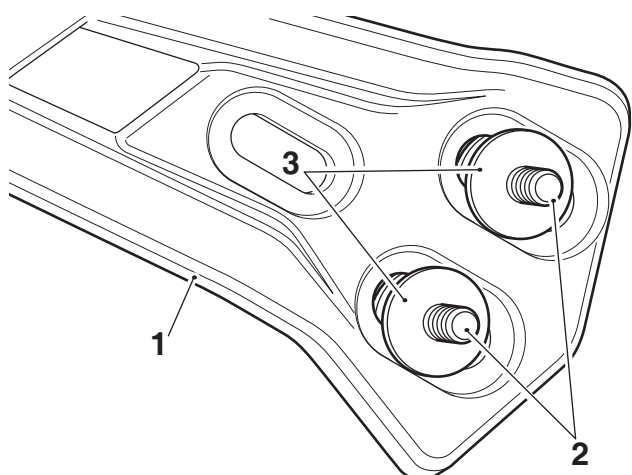

- Third mount, right hand
- Fixings, M8 x 25 mm
- Flanged sleeves, M8

- Position the right hand third mount on the inner face of the right hand footrest mount. Fit the M8 x 25 mm fixings making sure the M6 x 35 mm fixing and flanged sleeve are correctly positioned in the slot in the third mount. Do not fully tighten the fixings at this stage.

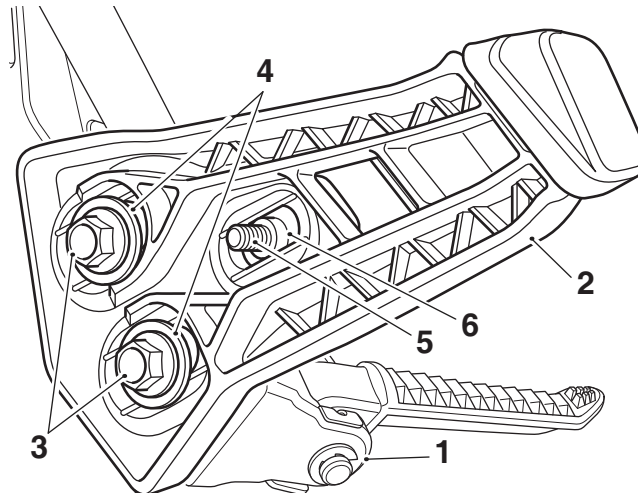

- Footrest mount, right hand
- Third mount, right hand
- Fixings, M8 x 25 mm
- Washers, M8
- Fixing M6 x 35 mm
- Flanged sleeve, M6

- Fit an 18 mm diameter M6 washer and M6 lock nut from the kit to the M6 x 35 mm fixing. Do not fully tighten the fixing at this stage.

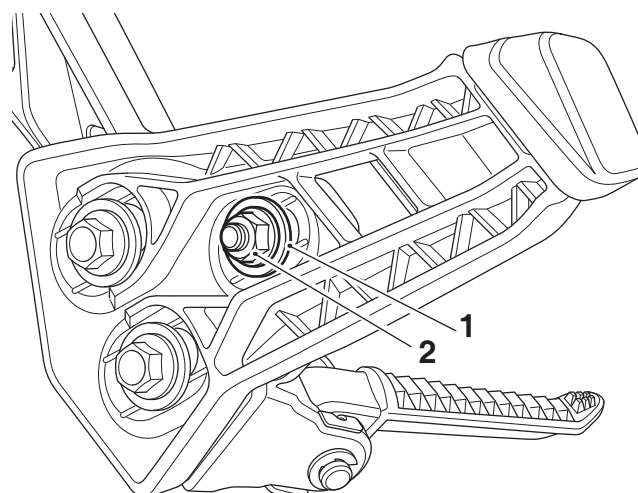

- Washer, M6 (18 mm diameter)
- Lock nut, M6

### Setting the position of the Third Mount

8. The pannier lock has two positions, as shown below. Insert the key in the lock and turn to the UNLOCK position.

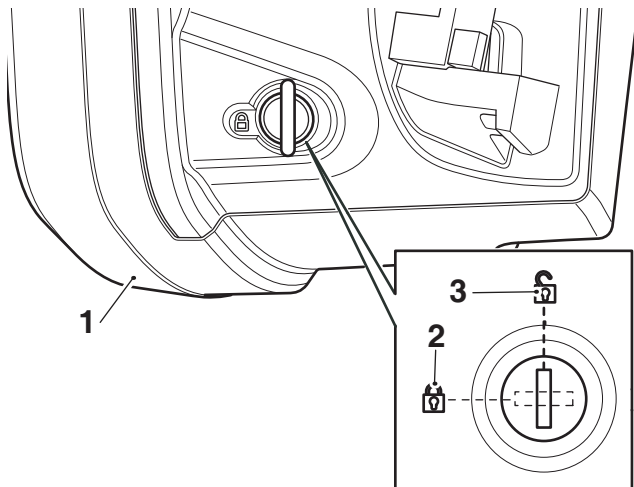

1. Pannier
2. Lock, LOCK position
3. Lock, UNLOCK position

9. Lift the latch handle at the front of the right hand pannier to retract the locking mechanism

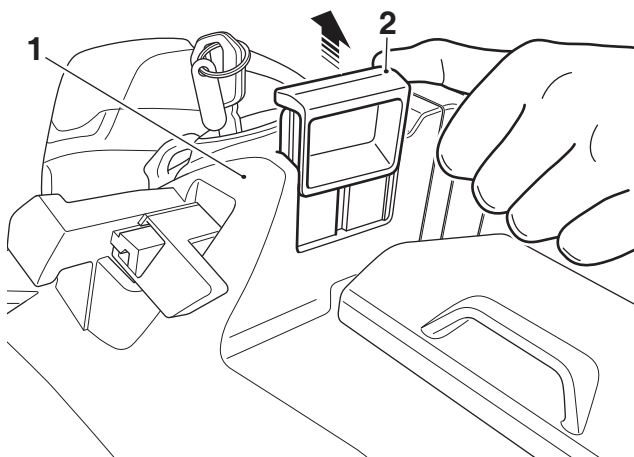

1. Pannier
2. Latch handle

10. Fit the right hand pannier to the right hand side of the motorcycle making sure the pannier mounts are pushed fully into the pannier mounts on the motorcycle. Slide the pannier in the pannier mounts as far as possible towards the rear of the motorcycle

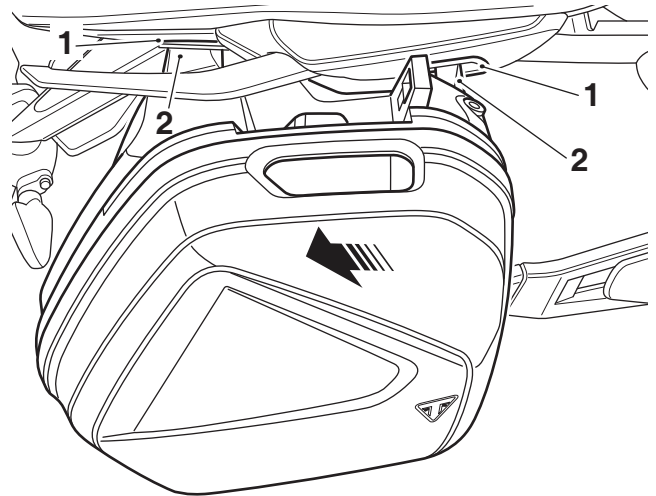

1. Pannier mounts, motorcycle
2. Pannier mounts, pannier

11. Adjust the position of the right hand third mount until there is between 2mm to 3mm clearance between the third mount and the bottom pannier mount, as shown.

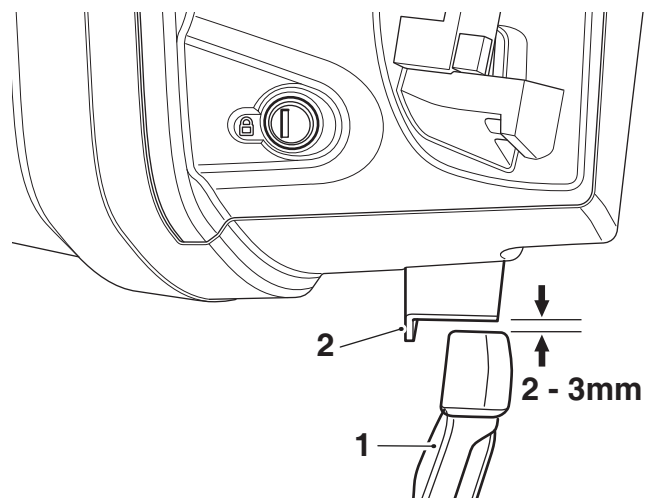

1. Third mount, right hand
2. Pannier bottom mount

12. With the third mount adjusted tighten the M6 x 35 mm fixing to **10 Nm** and the two M8 x 25 mm fixings to **22 mm** using an appropriate tool.
13. Remove and refit the pannier, if correctly aligned the pannier should easily engage on the lower mount, without excessive clearance, adjust the position of the third mount if necessary.
14. Remove the pannier from the motorcycle.
15. Repeat steps 1 to 14 for the left hand pannier third mount.

**Note:**

- **When the pannier is correctly fitted there should be no colour section visible at the rear pannier mount.**

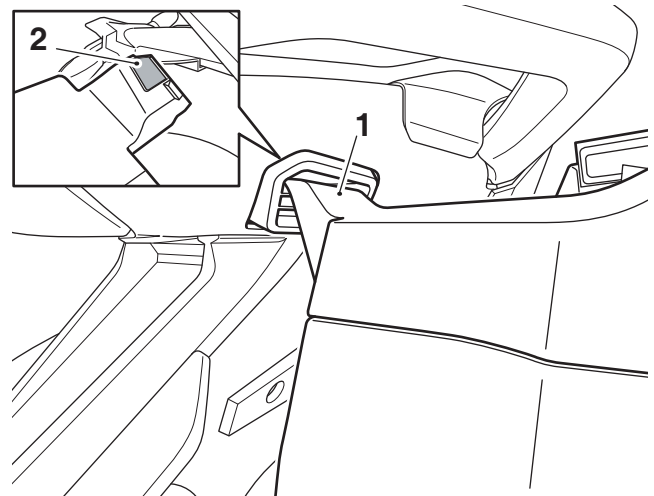

1. Rear pannier mount
2. Colour section

1. The pannier lock has two positions, as shown below. Insert the key in the lock and turn to the UNLOCK position.

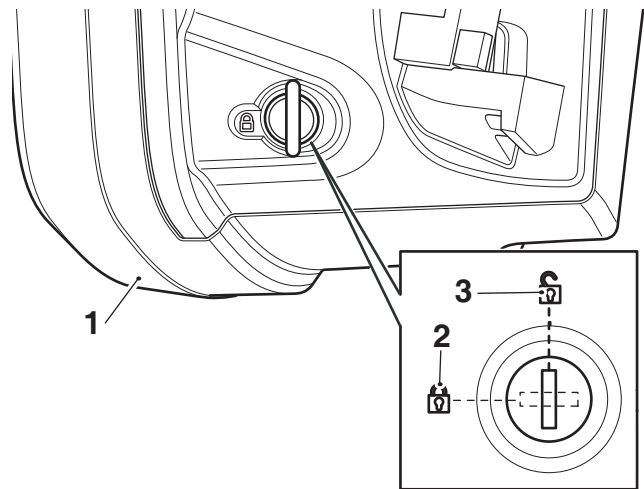

1. Pannier
2. Lock, LOCK position
3. Lock, UNLOCK position

**Fitting the Panniers**

**Warning**

An incorrectly mounted pannier may detach whilst riding, resulting in a dangerous riding condition. Before riding, always make sure that the panniers are mounted correctly. Make sure that the lock barrel is turned to the LOCK position and the key removed.

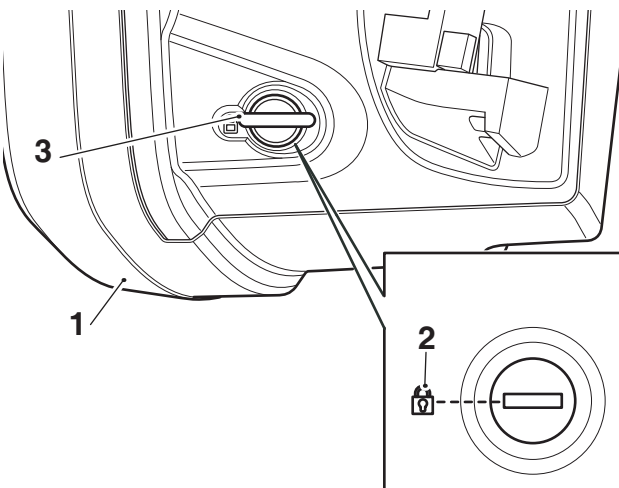

1. Pannier
2. Lock position
3. Key

A pannier that detaches whilst riding may cause loss of motorcycle control and an accident and/or injury to other road users.



2. Lift the latch handle at the front of the right hand pannier to retract the locking mechanism

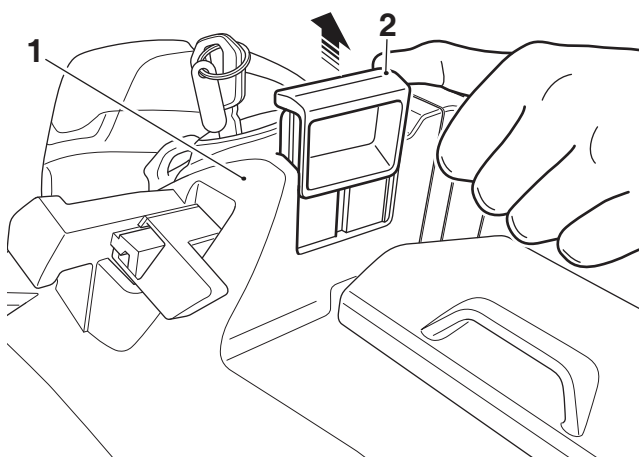

1. Pannier
2. Latch handle

3. Fit the right hand pannier to the right hand side of the motorcycle making sure the upper pannier mounts are pushed fully into the pannier mounts on the motorcycle.

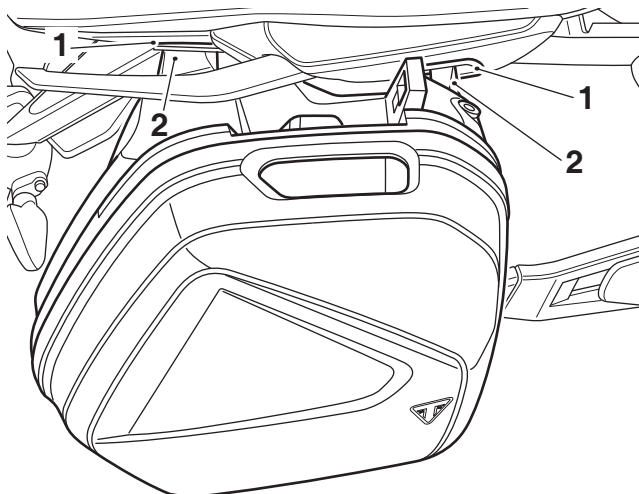

1. Pannier mounts, motorcycle
2. Pannier mounts, pannier

4. Slide the pannier forwards in the pannier mounts making sure the pannier bottom mount locates onto the third mount.

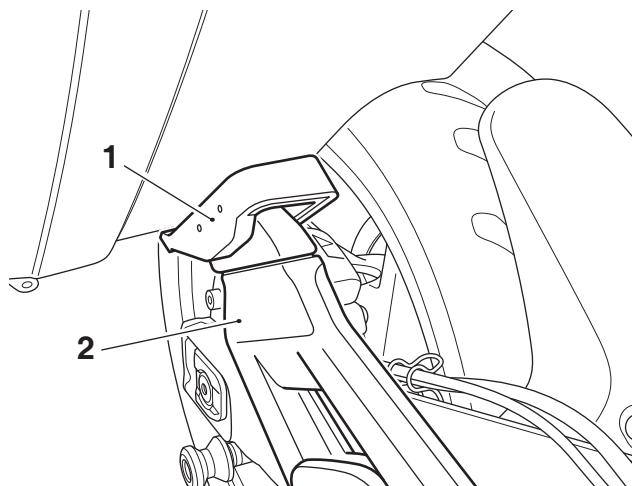

1. Pannier bottom mount
2. Third mount

5. Press the latch handle fully in to the pannier. There should be no colour section on the latch handle visible when the pannier is correctly latched to the pannier mounts.

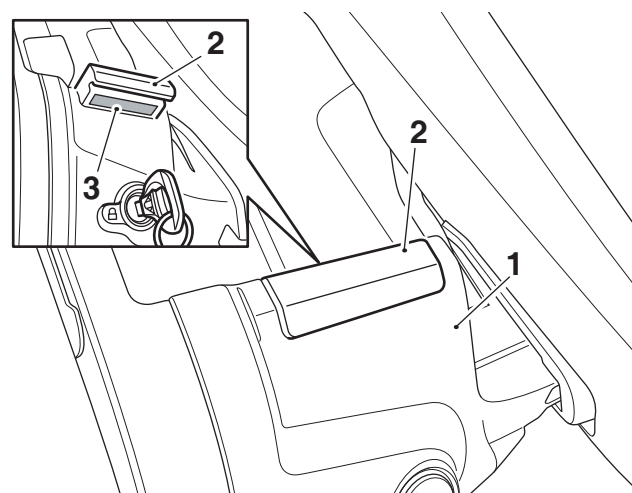

1. Pannier
2. Latch handle
3. Colour section



- To lock the pannier latch handle turn to the LOCK position, as shown below. Note, this will also lock the pannier lid.

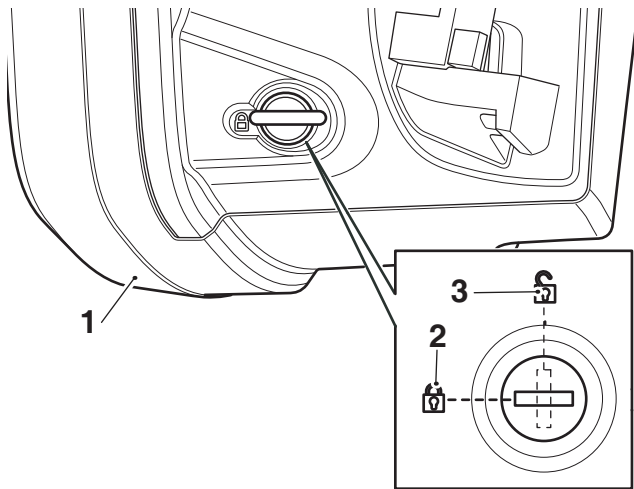

- Pannier
- Lock, LOCK position
- Lock, UNLOCK position

- To remove the pannier insert the key in the lock and turn to the UNLOCK position. Lift the pannier latch handle and slide the pannier rearwards clear of the third mount. The pannier can now be removed from the motorcycle.



### Warning

To prevent detachment of a pannier while riding, after fitting always grasp the pannier and pull firmly outwards and to the rear. If the pannier is not correctly secured, it will detach from the pannier mounts on the motorcycle. A loose or detached pannier could cause loss of motorcycle control and an accident.

#### Note:

- The panniers must be in the locked condition while riding the motorcycle.
- Repeat steps 1 to 7 for the left hand pannier fitment.

## Pannier Operation

- To open the pannier lid, turn the key to the UNLOCK position and lift the pannier lid release handle at the top of the pannier. Always make sure the lock is returned to the LOCK position and the key removed after the pannier lid is closed.

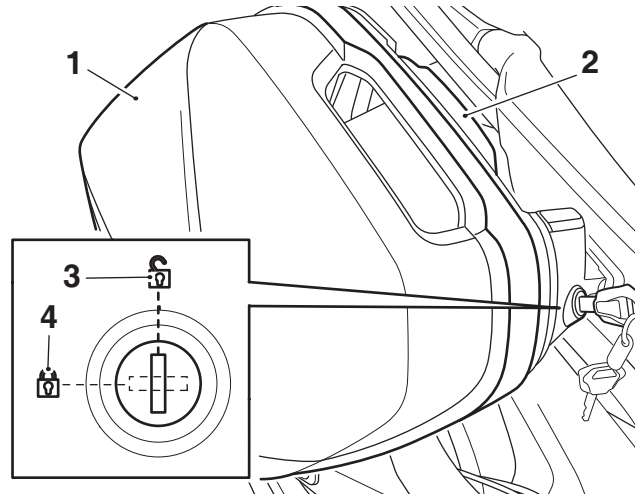

- Pannier lid
- Pannier lid release handle
- Lock, UNLOCK position
- Lock, LOCK position

#### Note:

- When the pannier lid is correctly closed and locked there should be no colour section visible on the pannier lid latch.

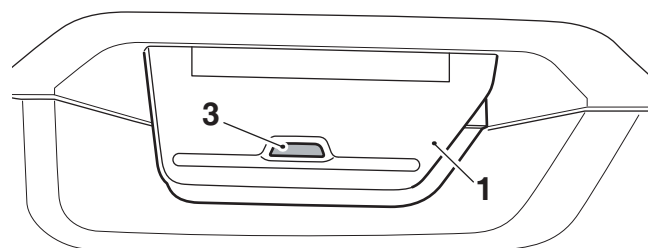
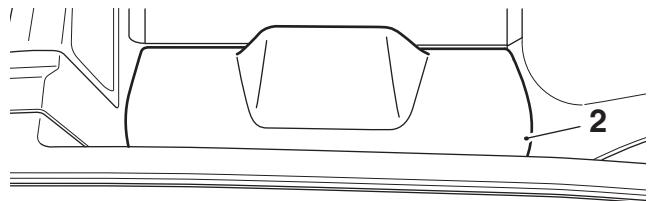

- Pannier lid latch
- Pannier lid release handle
- Colour section

**Note:**

- The following Infill panel replacement section is only applicable when replacing the original infill panels with painted accessory infill panels.

**Pannier Infill Panel Replacement**

1. Open one of the pannier lids. While supporting the infill panel remove the eight infill panel fixings from the pannier lid. Retain the fixings for reuse.

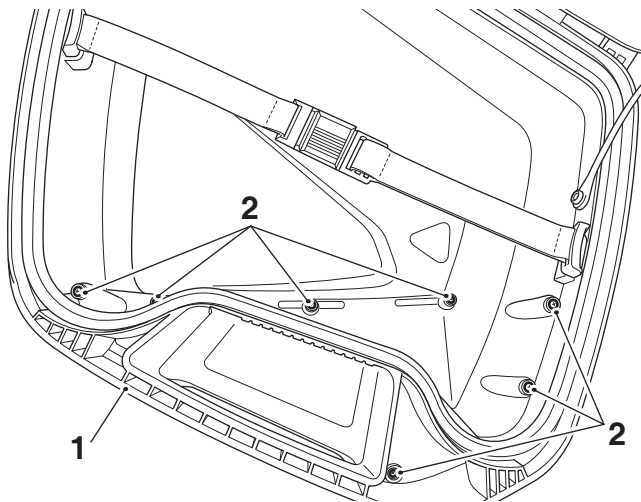

1. Pannier lid
2. Infill panel fixings

2. Remove the original infill panel from the pannier lid. Retain the infill panel for reuse if the accessory painted infill panel is removed.
3. Fit the painted infill panel from the kit onto the pannier lid, as shown.

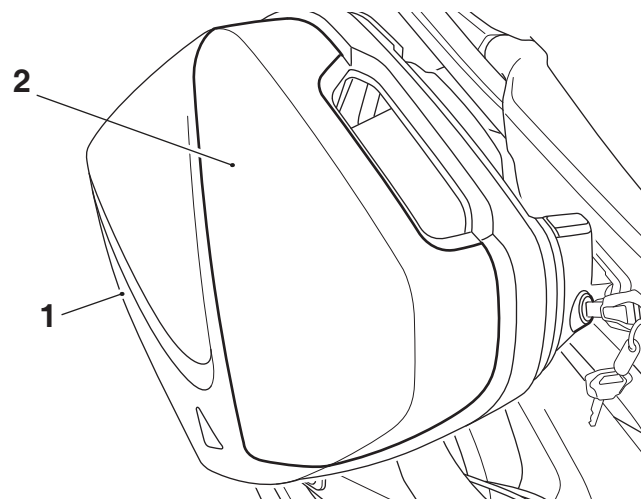

1. Pannier lid
2. Infill panel

4. Note, it may be necessary to apply a small amount of pressure to the infill panel against the pannier lid to align the fixing holes. Fit the eight original fixings and tighten to **1.5 Nm**.

5. Repeat steps 1 to 4 for the second pannier.

**Warning**

The maximum safe load for the each pannier is 5 kg (11 lbs). Never exceed this loading limit as this may cause the motorcycle to become unstable leading to loss of motorcycle control and an accident.

**Warning**

After fitting or removing the panniers, operate the motorcycle in a safe area free from traffic to gain familiarity with the new handling characteristics. Operation when not familiar with the new characteristics of the motorcycle may result in loss of motorcycle control and an accident.

**Warning**

The panniers are designed to be fitted as a pair. Never ride the motorcycle with only one pannier installed. Riding the motorcycle with one pannier installed may cause the motorcycle to become unstable leading to loss of motorcycle control and an accident.

**Warning**

Incorrect loading may result in an unsafe riding condition leading to loss of motorcycle control and an accident.

Always make sure any loads carried are evenly distributed on the motorcycle. Make sure that the load is correctly secured such that it will not move around while the motorcycle is in motion.

Evenly distribute the load within the pannier. Pack heavy items at the bottom of the pannier.

Always check the load security regularly (though not while the motorcycle is in motion) and make sure that the load does not extend beyond the rear of the motorcycle. Never exceed the maximum vehicle loading weight. Refer to the Owner's Handbook for the maximum loading weight specification.

This maximum loading weight is made up from the combined weight of the rider, passenger, any accessories fitted and any load carried.

For models that have adjustable suspension settings, make sure that front and rear spring preload and damping settings are suitable for the loading condition of the motorcycle. Refer to the Owner's Handbook.

## Cleaning the Luggage System

All parts of the luggage system fitted to your motorcycle must be cleaned regularly to avoid deterioration of their appearance.

### Washing

Prepare a mixture of cold water and mild automotive cleaner. Do not use a highly alkaline soap as commonly found at commercial car washes because it leaves a residue.

Wash the luggage system with a soft cloth. Do not use an abrasive scouring pad or steel wool. They will damage the finish.

Rinse the luggage system thoroughly.

Make sure no soap or water enters the inside compartment.

Dry the luggage system as far as possible with a soft cloth.

### Protecting

When the luggage system is dry, protect with a colourless lubricating spray.



### Caution

The use of abrasive cleaners and polishes will damage the system and must not be used.

It is recommended that regular protection be applied to the system as this will both protect and enhance the system's appearance.

### Note:

- **It is recommended to use the Triumph inner bags to protect both the luggage contents and the inner surfaces of the luggage.**



### Warning

If, after fitment of this accessory kit, you have any doubt about the performance of any aspect of the motorcycle, contact an authorised Triumph dealer and do not ride the motorcycle until the authorised dealer has declared it fit for use. Riding a motorcycle when there is any doubt as to any aspect of the performance of the motorcycle may result in loss of control of the motorcycle leading to an accident.



### Warning

Never ride an accessory-equipped motorcycle, or a motorcycle carrying a payload of any kind, at speeds above 80 mph (130 km/h). In either/both of these conditions, speeds in excess of 80 mph (130 km/h) should not be attempted even where the legal speed limit permits this.

The presence of accessories and/or payload will cause changes in the stability and handling of the motorcycle.

Failure to allow for changes in motorcycle stability may lead to loss of motorcycle control or an accident.

When riding at high speed, always be aware that various motorcycle configuration and environmental factors can adversely affect the stability of your motorcycle. For example:

- Incorrectly balanced loads on both sides of the motorcycle.
- Incorrectly adjusted front and rear suspension settings.
- Incorrectly adjusted tyre pressures.
- Excessively or unevenly worn tyres.
- Side winds and turbulence from other vehicles.
- Loose clothing.

Remember that the 80 mph (130 km/h) absolute limit will reduce by the fitting of non-approved accessories, incorrect loading, worn tyres, overall motorcycle condition and poor road or weather conditions.



### Warning

Only operate this Triumph motorcycle at high speed in closed-course, on-road competition or on closed-course racetracks. High-speed operation should only be attempted by riders who have been instructed in the techniques necessary for high-speed riding and are familiar with the motorcycle's characteristics in all conditions.

High-speed operation in any other circumstances is dangerous and will lead to loss of motorcycle control and an accident.



### Warning

This motorcycle must not be operated above the legal road speed limit except in authorised closed-course conditions.